



**British Infantry Tank Mk.III**

# Valentine Mk. II



**\*\*SPECIAL THANKS:** Mr. Ossie Orsbourn-UK Vis  
Mr. Scott Taylor-Canada Vis

Vickers-Armstrong started two new tank projects in 1934: high-speed A9 medium tank, and infantry support A10 tank. By 1936, the British Army categorized their tank inventory as Cruiser Tank and Infantry Tank. The A9 was categorized as Cruiser Tank, whereas the A10 was categorized as Heavy Cruiser Tank, because its armour thickness and speed were considered underperformance.

In the meantime, Vickers-Armstrong conducted a private venture by adopting A10 Cruiser Tank chassis with thicker armours, rendering a new Infantry Tank. The project, known as Valentine, was submitted to the War Office on February 1938. At first, the Valentine was not favoured because of limited internal compartment. Yet Europe was under shadow of war at that time, and Valentine Tank largely shared components from A9 and A10 tanks, which became advantage in mass production. Highly reliable, the Valentine saw services in many theaters after mass production; also built under license in Canada and supplied to the USSR. It became the most produced British tank in WWII.

Operation Crusader in 1941, North Africa, was the first combat that Valentine participated. With a new diesel engine, the Valentine Mk.II enjoyed better battle Survivability. Skirts on both sides mitigated dust effectively, and an auxiliary external fuel tank provides longer operation range. A total of 700 Valentine Mk.II was produced.

1934年、イギリスのビッカース・アームストロング社は、2種類の新型戦車の開発を開始した。高い速力のA9中戦車と歩兵支援用のA10戦車である。1936年までに、イギリス陸軍は、戦車の項目を巡航戦車と歩兵戦車とに分類した。A9は巡航戦車に分類されたが、A10は装甲厚と速度が不十分だったため、重巡航戦車として分類された。

その間にも、ビッカース・アームストロング社では自主的にA10戦車の車体の装甲を厚くして新たに歩兵戦車とする作業を進めていた。バレンタイン歩兵戦車と命名される事になるこの戦車の計画は、1938年2月に英国陸軍省に提出された。車内空間の狭さから、当初は不評であったが、折りしもヨーロッパに戦争の影が近づいてきており、また部品の多くがA9、A10戦車と共通であったため量産に有利と判断され、採用が決定した。バレンタイン歩兵戦車は高い信頼性によって、多くの戦域で使用され、カナダではライセンス生産が行われ、ソビエト軍に対しても供給された。最終的に第二次大戦中に最も多く生産されたイギリス戦車となったのである。

1941年北アフリカ戦線、クルセーダー作戦がバレンタイン歩兵戦車の初陣となった。ディーゼルエンジンを搭載したバレンタインMk. IIは、激しい戦闘の中で、高い生存性を発揮した。両側面に装備したスカートは、ホコリの影響を軽減し、車外に装備した予備燃料タンクによって航続距離が大幅に増加したのだった。バレンタイン歩兵戦車Mk. IIは、総数700輛あまりが製造されたのである。

自1934年起，英國的維克斯·阿爾斯壯公司著手開發兩種新型戰車，分別為能進行高速運動的A9中型戰車與用於步兵支援的A10戰車。到了1936年，陸軍開始依戰車的性能將所屬的戰車區分為巡航戰車與步兵戰車。A9被歸類於巡航戰車，而A10卻因裝甲厚度與速度皆不能達到預期，僅勉強的將其歸類為重巡航戰車。

即此同時，維克斯·阿爾斯壯公司將正處於開發中的A10巡航戰車底盤，以增厚裝甲的方式，獨自開發一款步兵戰車，在1938年2月將這個被命名為華倫坦的戰車計畫提交給英國戰爭部，雖然因為砲塔與車內空間的狹小，華倫坦步兵戰車最初並未獲得青睞。但由於此時歐洲的情勢急需大量戰車的部署，華倫坦因為大量沿用A9與A10的零組件，在量產上亟具優勢。由於性能可靠，在量產後大量配備於各個戰域之中，並又授權加拿大生產，再根據租借法案軍援蘇聯，因此華倫坦成為大戰期間英國生產數量最高的戰車。

華倫坦初次參與戰鬥是1941年北非的十字軍作戰，換裝了柴油引擎的華倫坦Mk.II，擁有更佳的戰場生存能力。車身兩側的側裙有效的減少了履帶揚起的塵沙。增加的車外油箱提供了更大的續航距離，華倫坦Mk.II型共生產達到七百台的數量。

### Illustration:圖示說明



### Method For Applying Decals:

1. Clean Model Surface With Wet Cloth.
2. Cut Out Of Decal Sheet And Dip Them In Warm Water For 15 Seconds.
3. Place it on proper position on model.
4. Slide off base paper leaving decals on Model With Wet Finger Tip.
5. Move Decals To Exact Position, Push Out Excess Water Under Decal With Soft Cotton Cloth.
6. When Decals Get Dry Then Complete.

### 水貼紙使用說明:

1. 將模型表面擦乾淨
2. 將貼紙剪下泡入溫水中浸泡約15秒
3. 將泡濕之貼紙取出置於欲貼處旁
4. 用指尖輕推貼紙表面使其滑出底紙
5. 將貼紙調整至適當位置並輕擦拭水份
6. 待其自然乾燥後即完成

### Color list: 塗料表

| Color        | Brand | Gunze Sangyo |          |                | Humbrol | Revell | Lifecolor |
|--------------|-------|--------------|----------|----------------|---------|--------|-----------|
|              |       | Hobby Color  | Mr.Color | Mr.Color Spray |         |        |           |
| Khaki green  | 卡其綠   | H60          | C54      |                |         |        |           |
| Steel        | 黑鐵    | H18          | C28      | J28            | 53      | 91     | LC76      |
| Tire black   | 輪胎黑   | H77          | C33+C62  |                | 85      | 302    | LC02      |
| Silver       | 銀     | H8           | C8       | J8             | 11      | 90     | LC74      |
| Flat white   | 消光白   | H11          | C62      | J62            | 34      | 05     | LC01      |
| Wood brown   | 木棕    | H37          | C43      |                | 169     |        | FS12      |
| Red brown    | 紅褐    | H47          | C41      |                | 160     | 383    | UA085     |
| Black        | 黑     | H2           | C2       | J2             | 21      | 7      | LC52      |
| Sail color   | 帆布    | H85          | C45      |                | 28      |        | UA099     |
| Flat black   | 消光黑   | H12          | C33      | J33            | 33      | 8      | LC02      |
| Tar black    | 瀝青    | H12          | TC12     | J33            | 33      | 8      | UA301     |
| Dark earth   | 深土    | H72          | C22      |                | 29      | 87     | UA72      |
| Azure blue   | 湛藍    |              | C370     |                | 47      |        | UA37      |
| Middle stone | 岩石    | H71          | C21      |                | 84      |        | UA97      |
| Sand         | 沙     | H66          | C19      |                | 63      | 16     | UF08      |

# Infantry Tank Mk.III Valentine

## Valentine I

Equipped with an AEC 135hp V6 petrol engine, based on A10 Cruiser Tank.

The Valentine I was designed to support Matilda Infantry Tank.

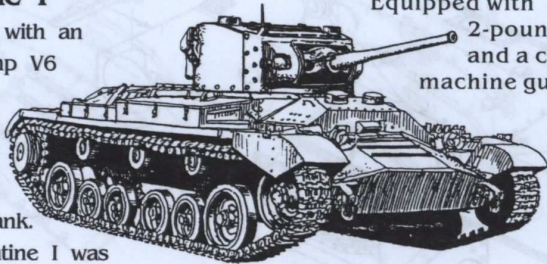

Equipped with 2-pounder gun and a co-axial machine gun.

## Valentine II

Was equipped with an AEC 131hp diesel engine.

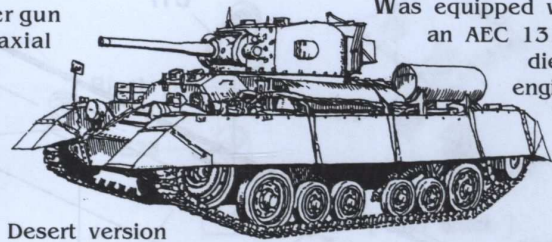

Desert version came with skirts on sides and dispensable external fuel tank.

## Valentine III

A larger turret was installed with commander exit.

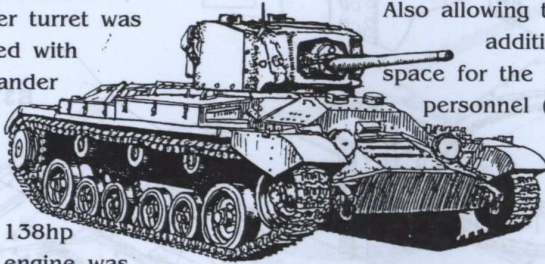

Also allowing the addition of space for the 3<sup>rd</sup> personnel (loader).

GMC 138hp diesel engine was installed after Mk. IV. Most of them were supplied to other countries for aid. A co-axial machine gun provided by the Soviet was also equipped.

## Valentine VIII

Based on Mk. III, equipped with a 6-pounder gun, with the removal of co-axial machine gun. Two personnel in the turret.

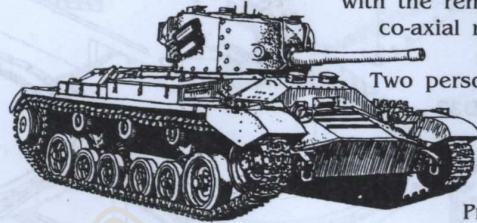

Produced from March 1942.

## Valentine X

Equipped with GMC 165hp diesel engine. Produced from 1943.

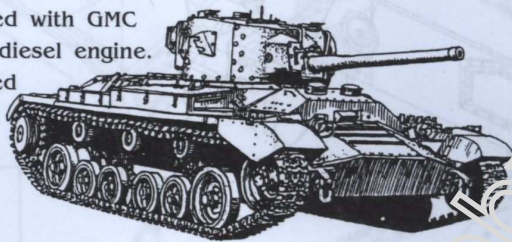

## Valentine XI

Based on Mk. X with a new 75mm gun, produced from 1943. This is the last development version.

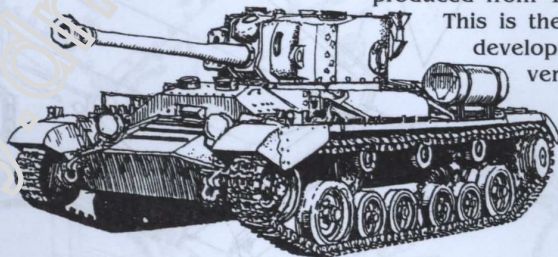

## Bishop self-propelled howitzer

A combination of Valentine chassis and 25-pounder howitzer.

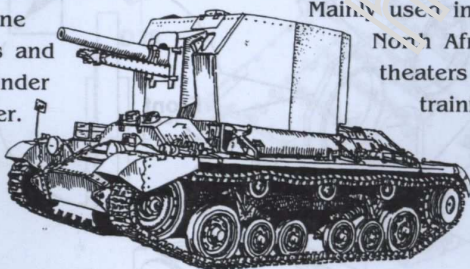

Mainly used in the North African theaters and trainings.

## Archer Tank Destroyer

Equipped with the 17-pounder gun, which is able to confront German 88mm gun. The gun barrel is mounted to the rear. Production commenced from March 1944, 665 units were produced.



## Valentine DD

The Duplex Drive (DD) system is an amphibious swimming tank version. It worked by erecting a 'flotation screen' around the tank.



It comes with a propeller powered by the tank's engine to drive them in the water. Compressed air bottles and pipes are to inflate the rubber tubes to give the curtain rigidity.

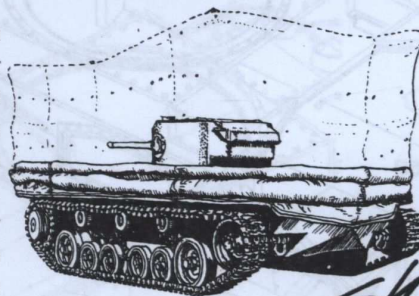

There were 685 Valentine IIIs and VIIIs converted to DD version since June 1942, mainly for training purposes.

*Shin.ueda*  
上田 信

1

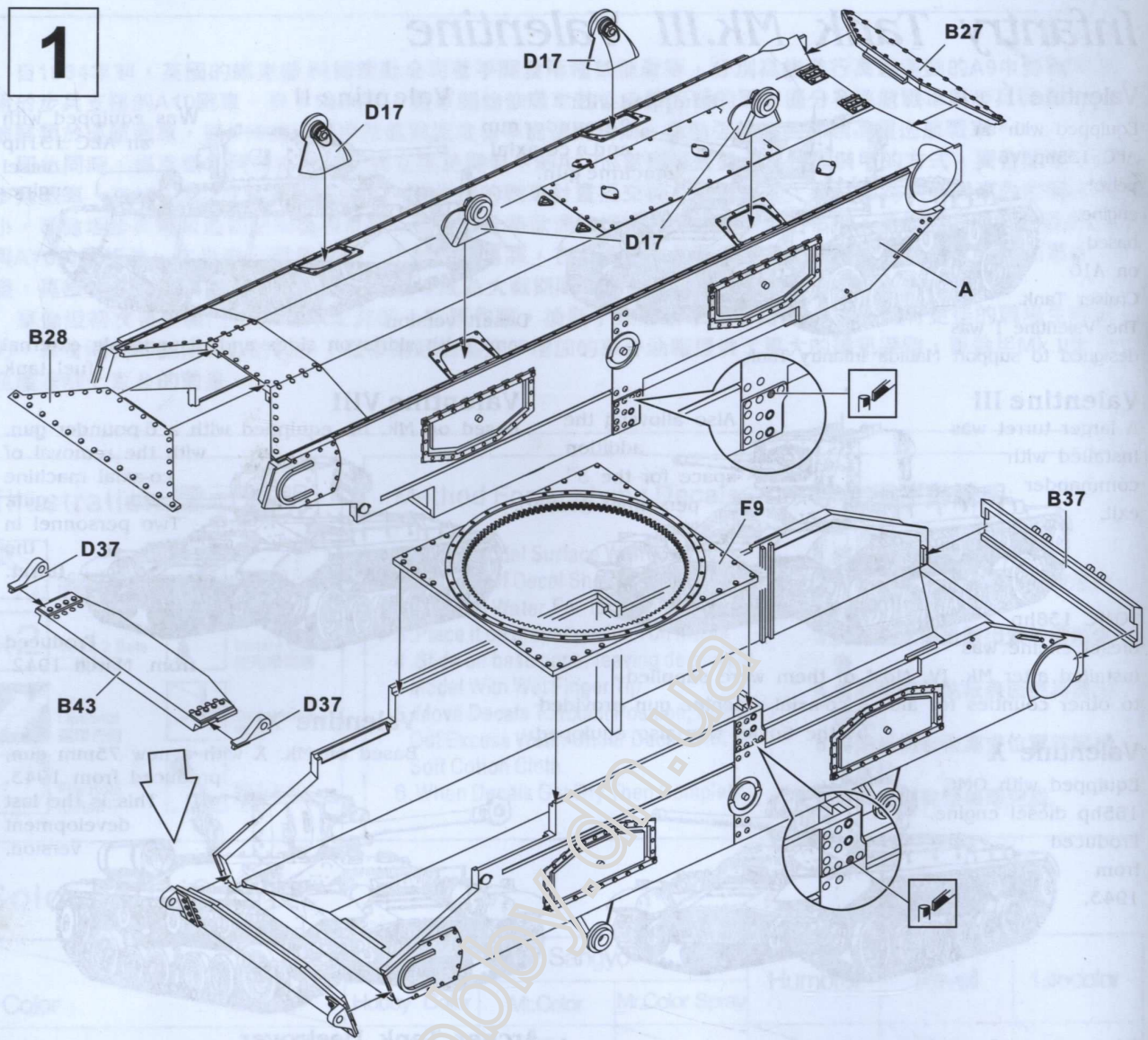

2

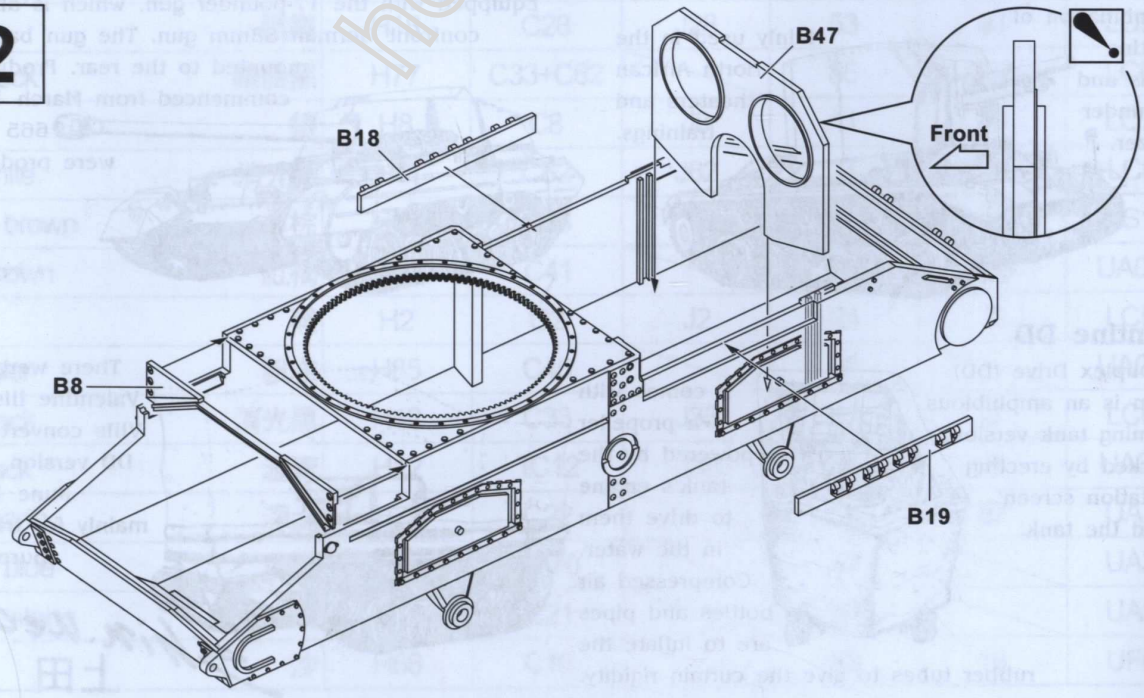

3

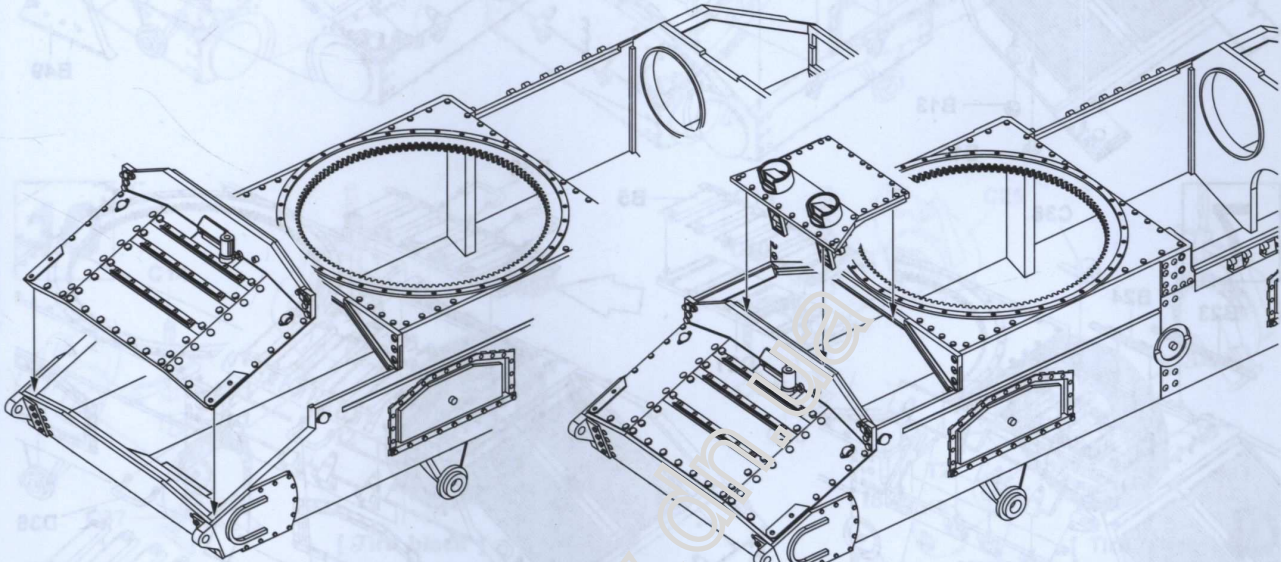
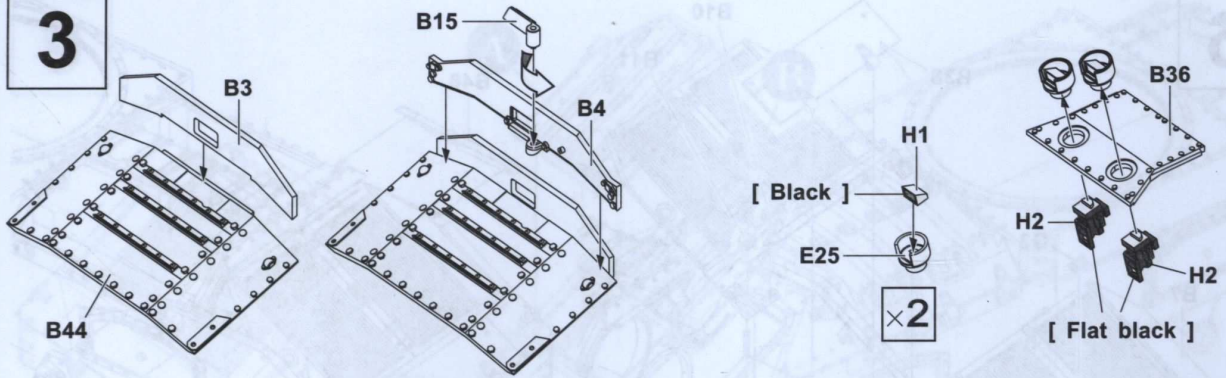

4

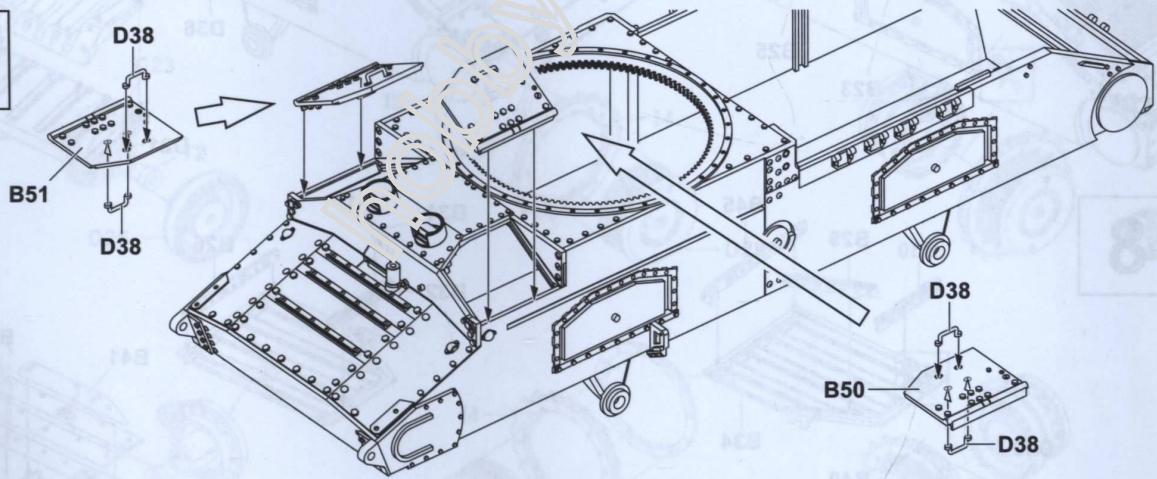

5

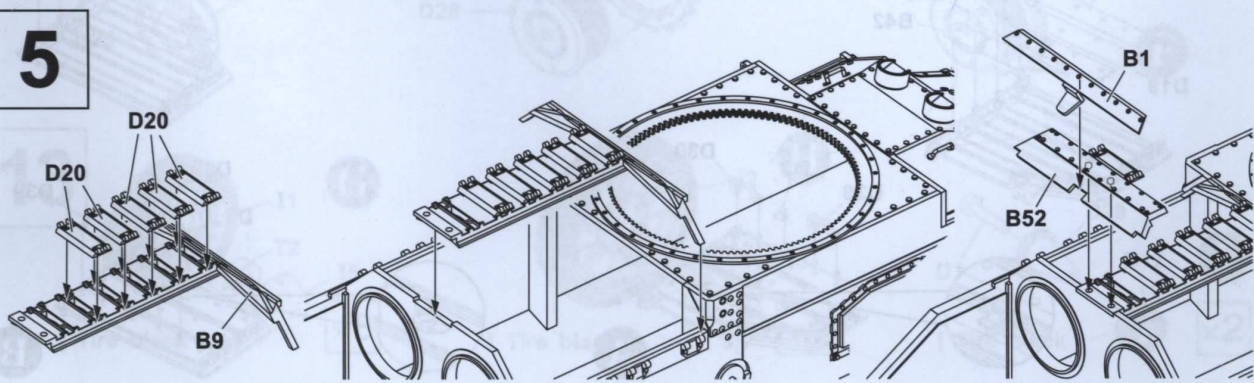

6

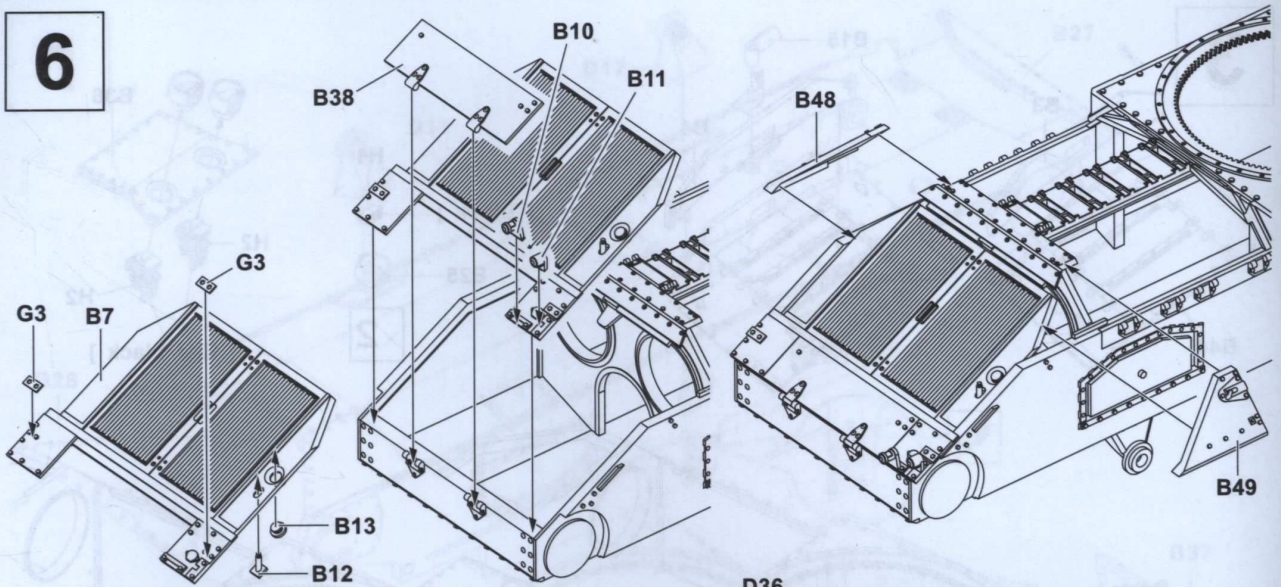

7

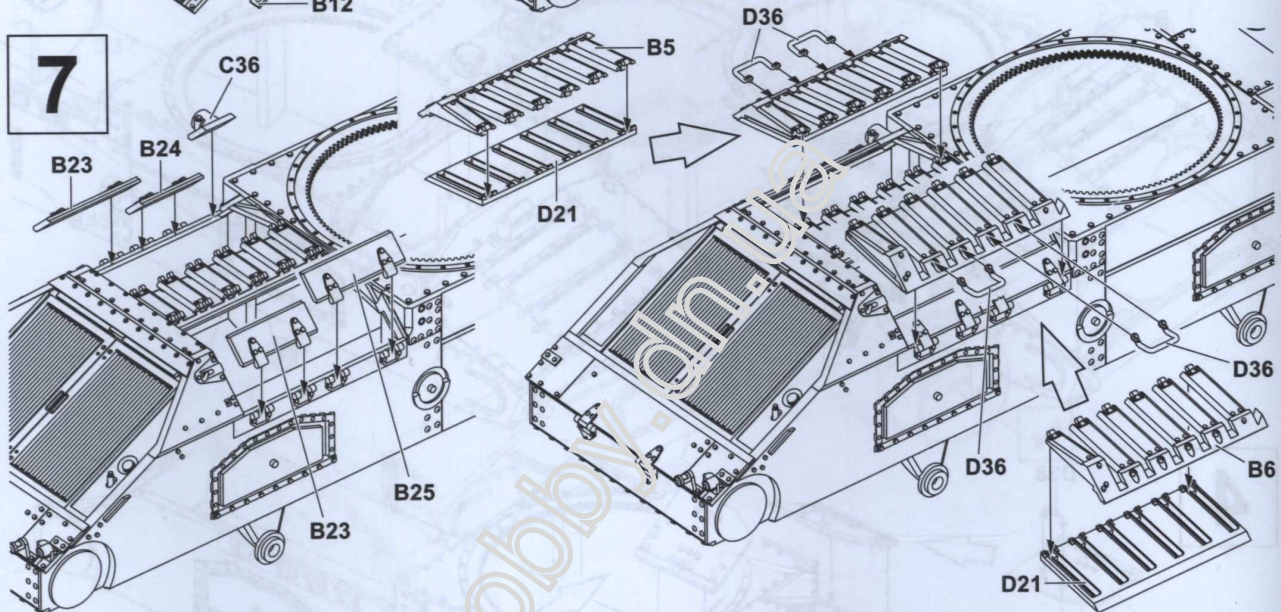

8

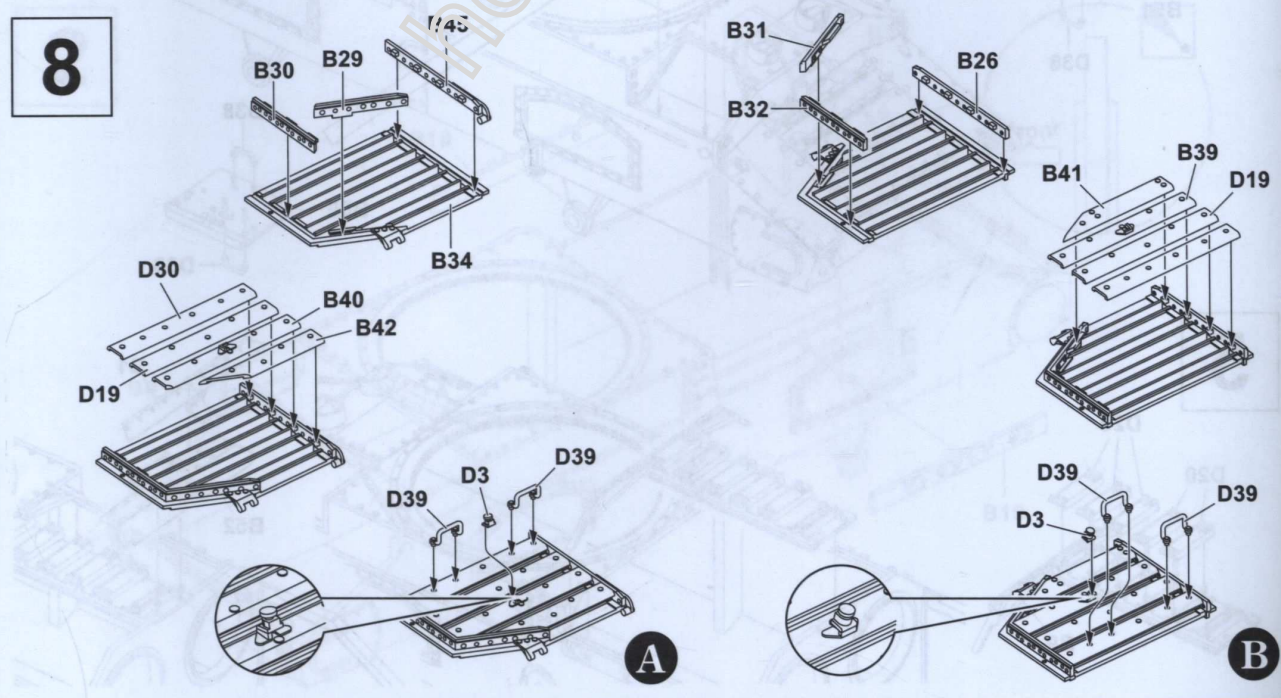

9

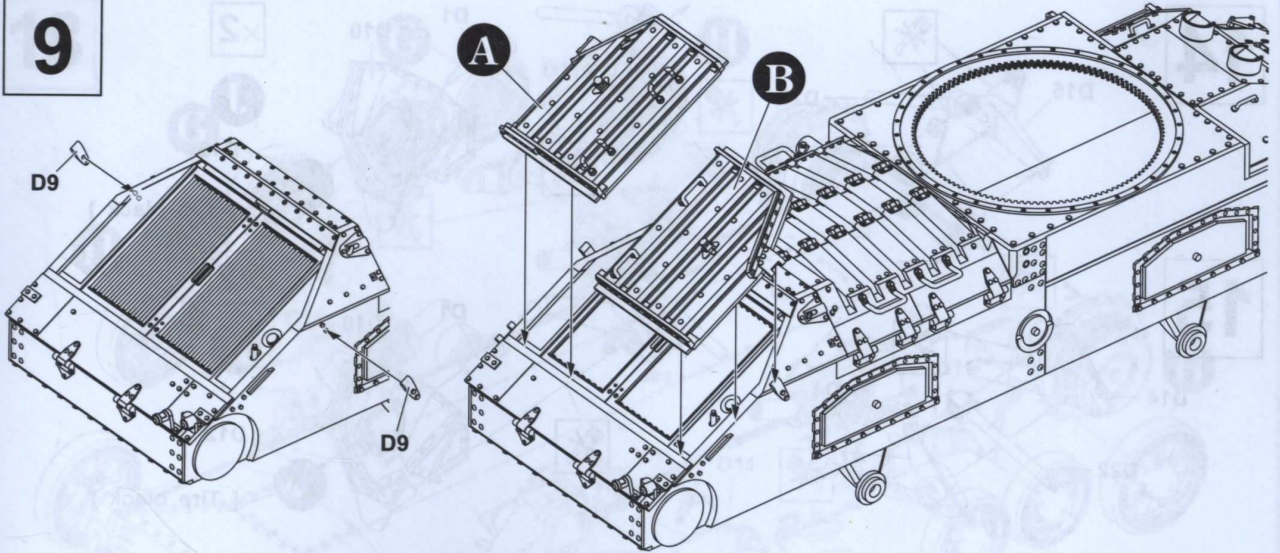

10

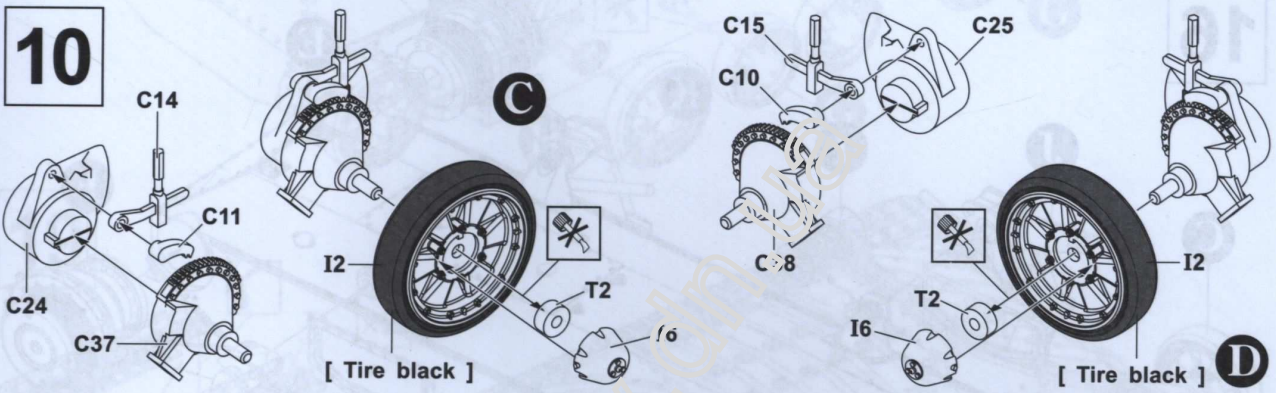

11

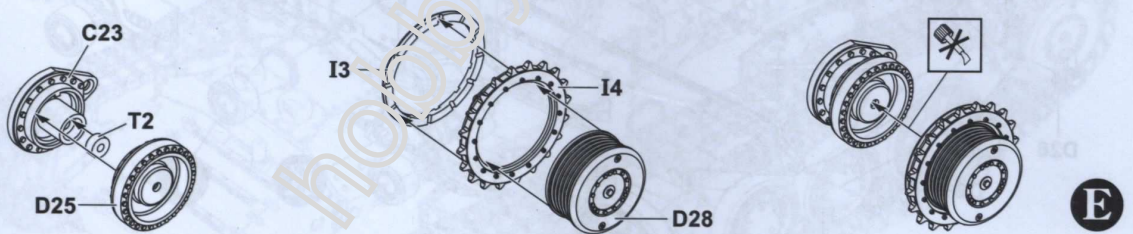

12

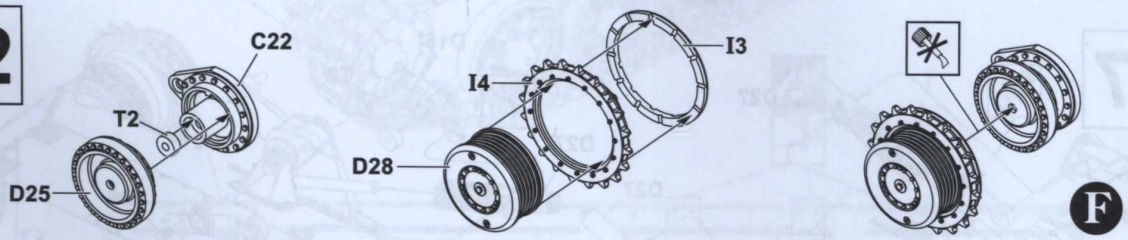

13

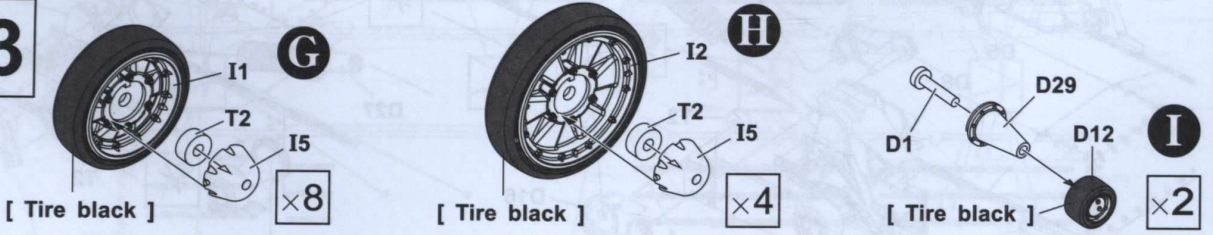

14

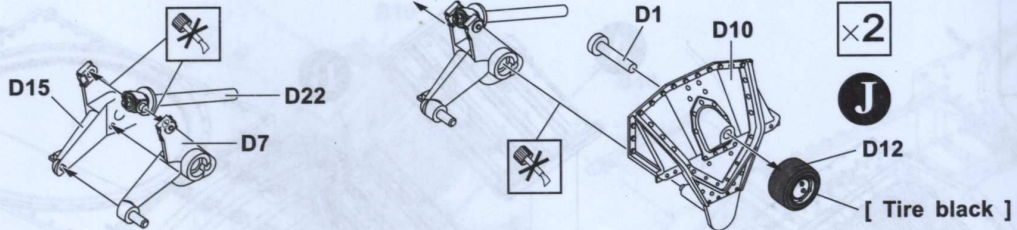

15

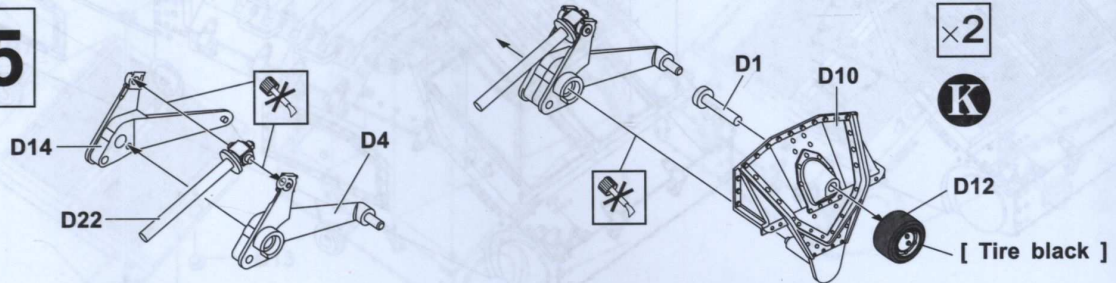

16

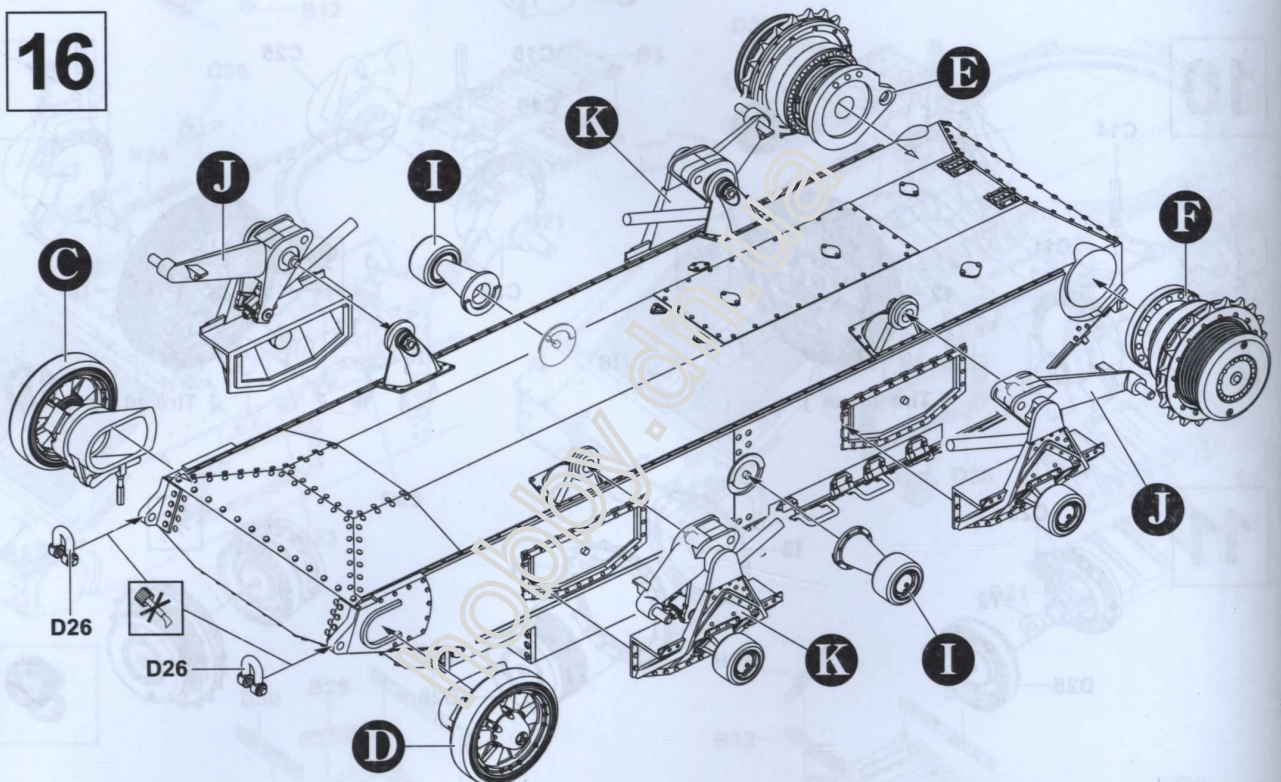

17

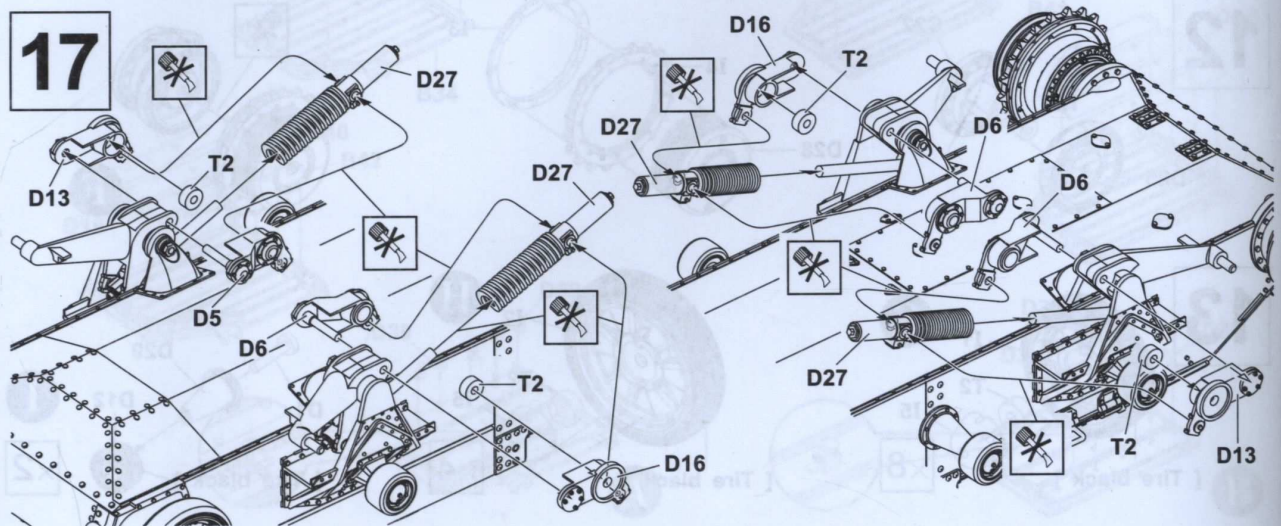



18

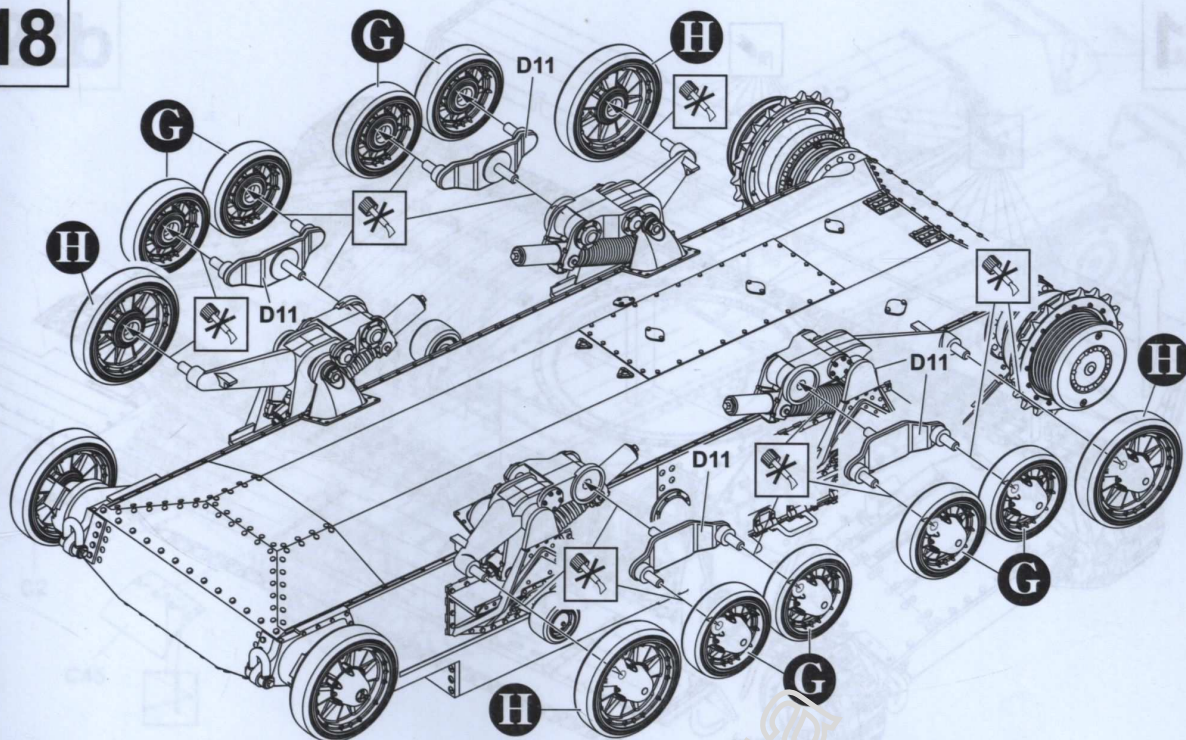

19

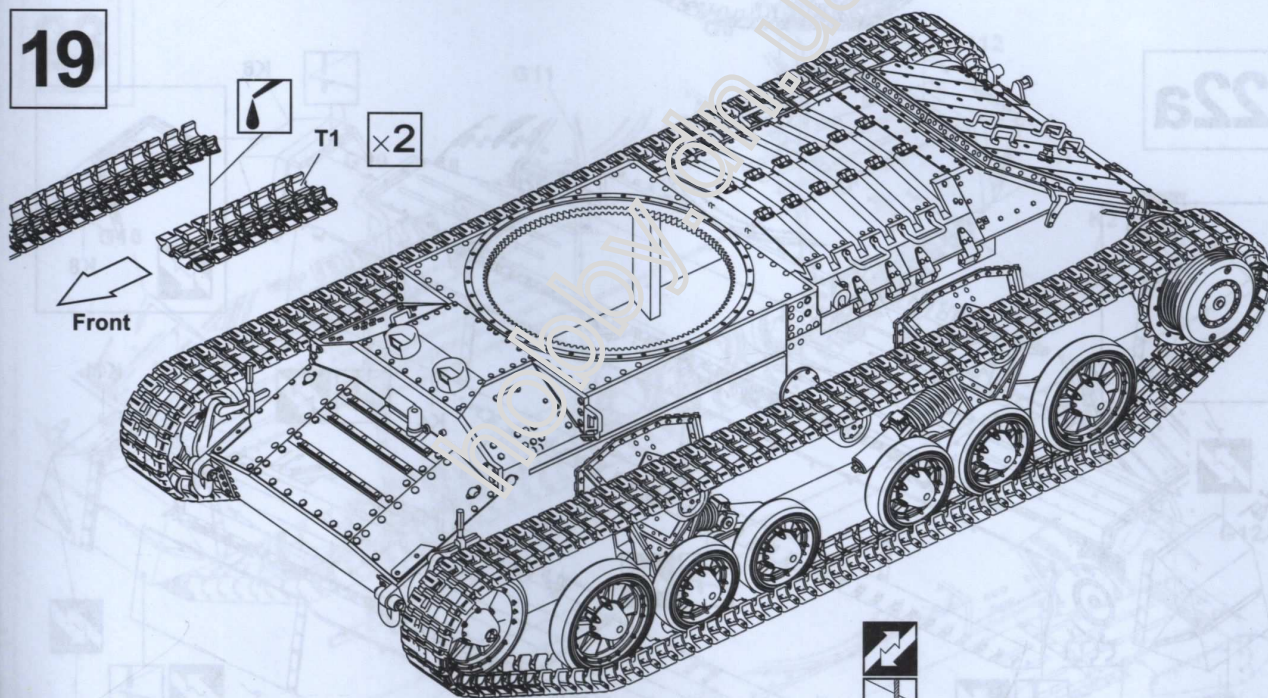

20

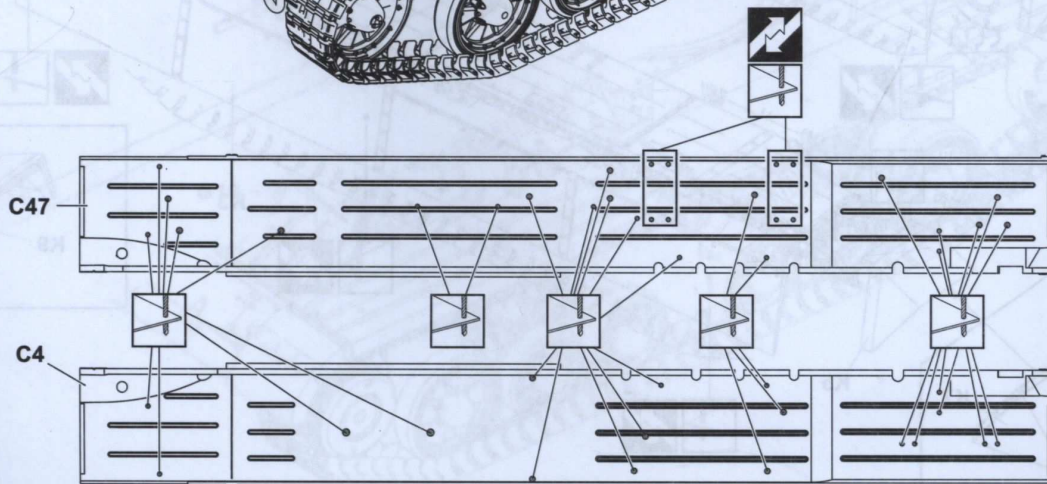

21

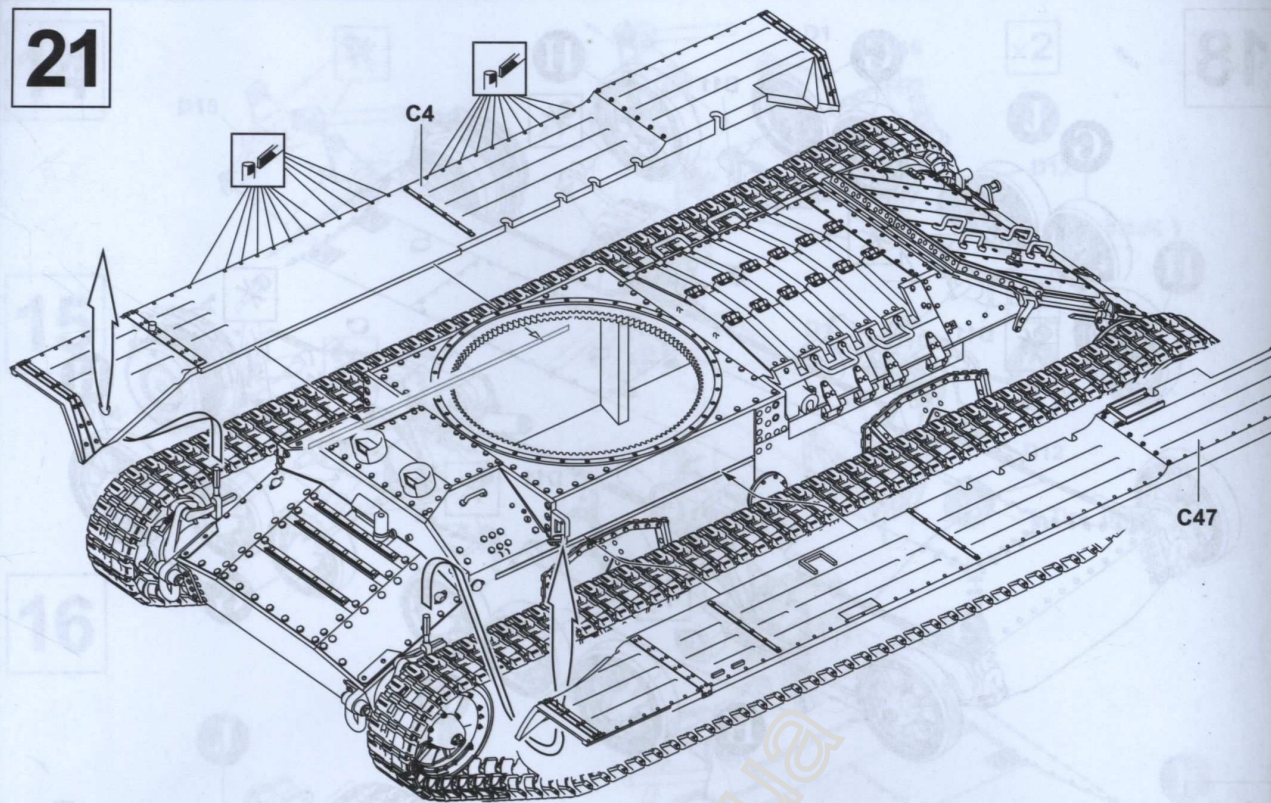

22a

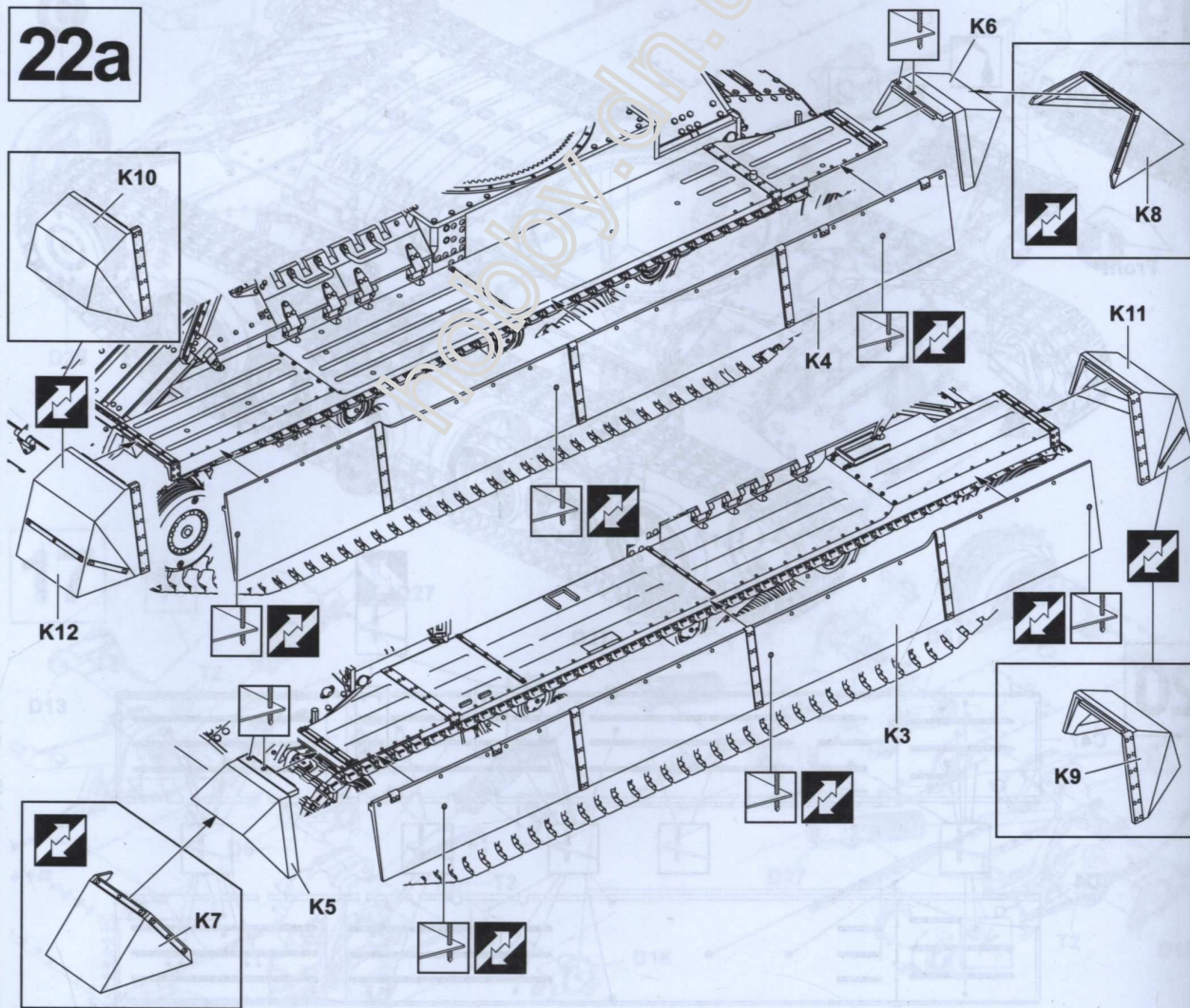

22b

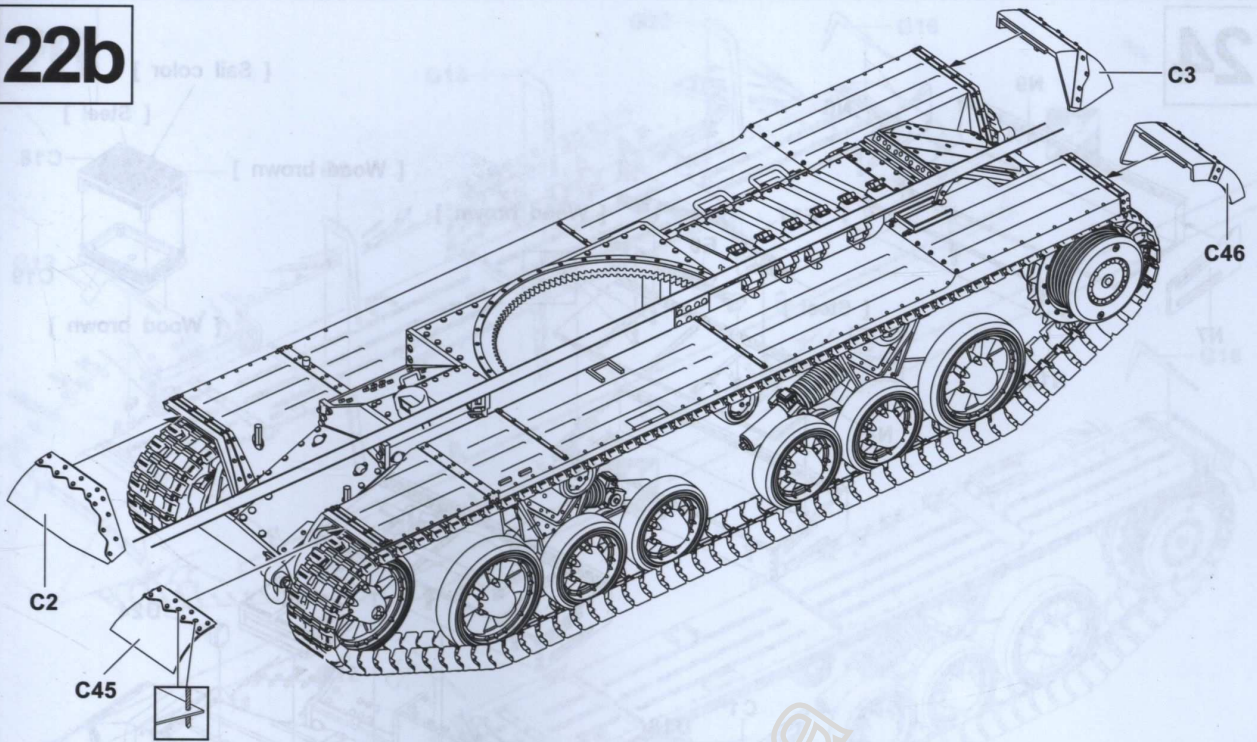

23

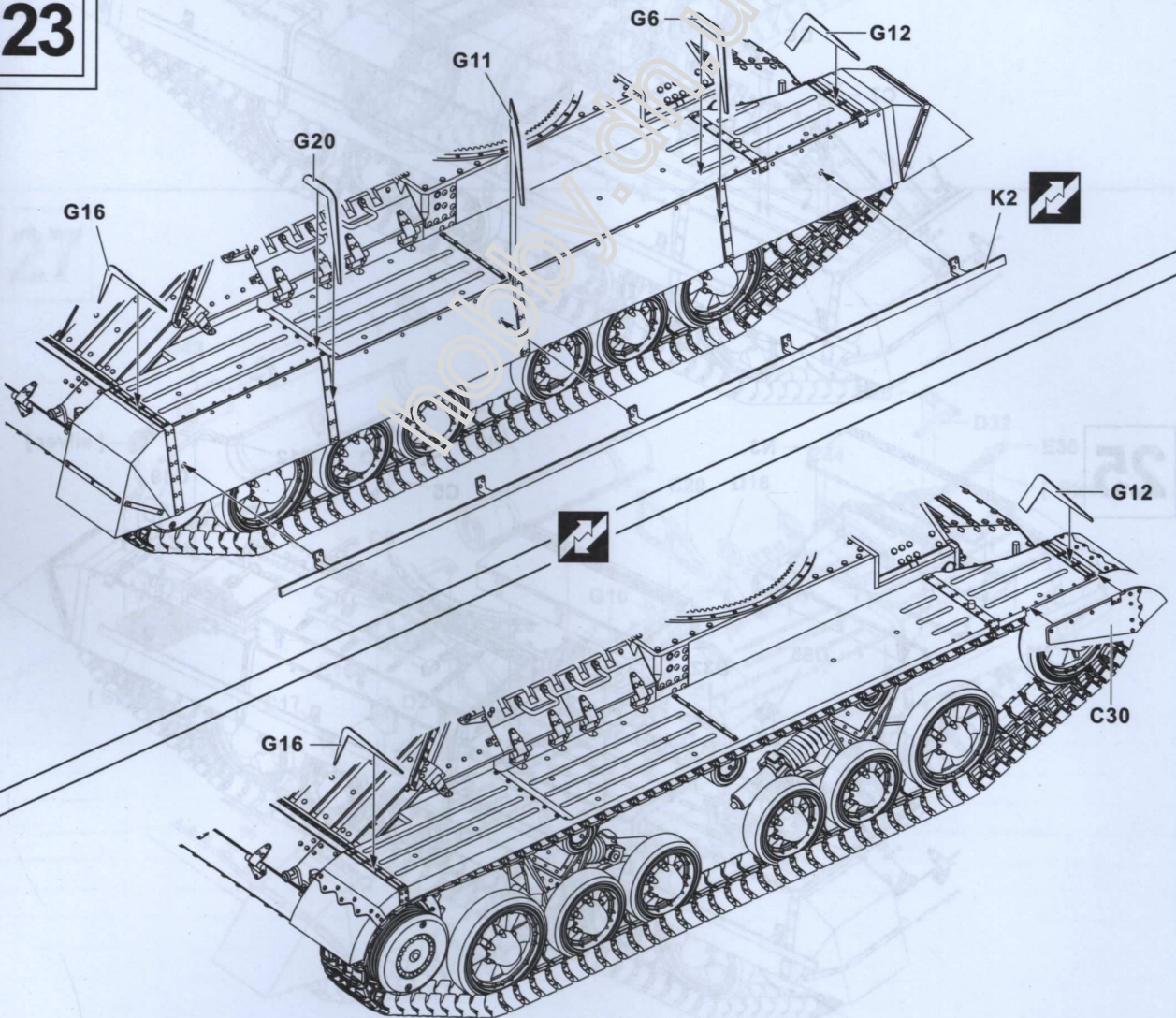

24

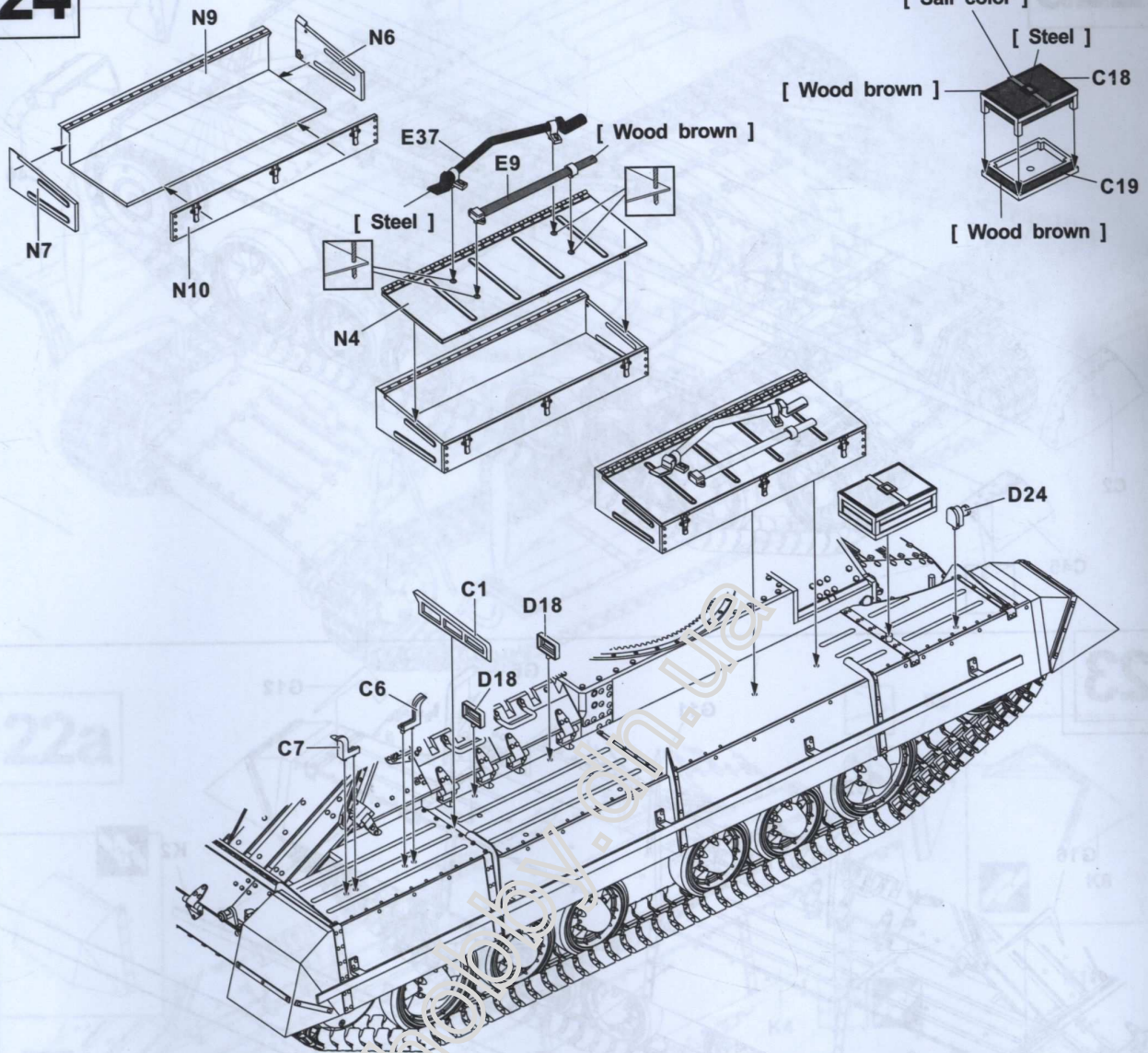

25

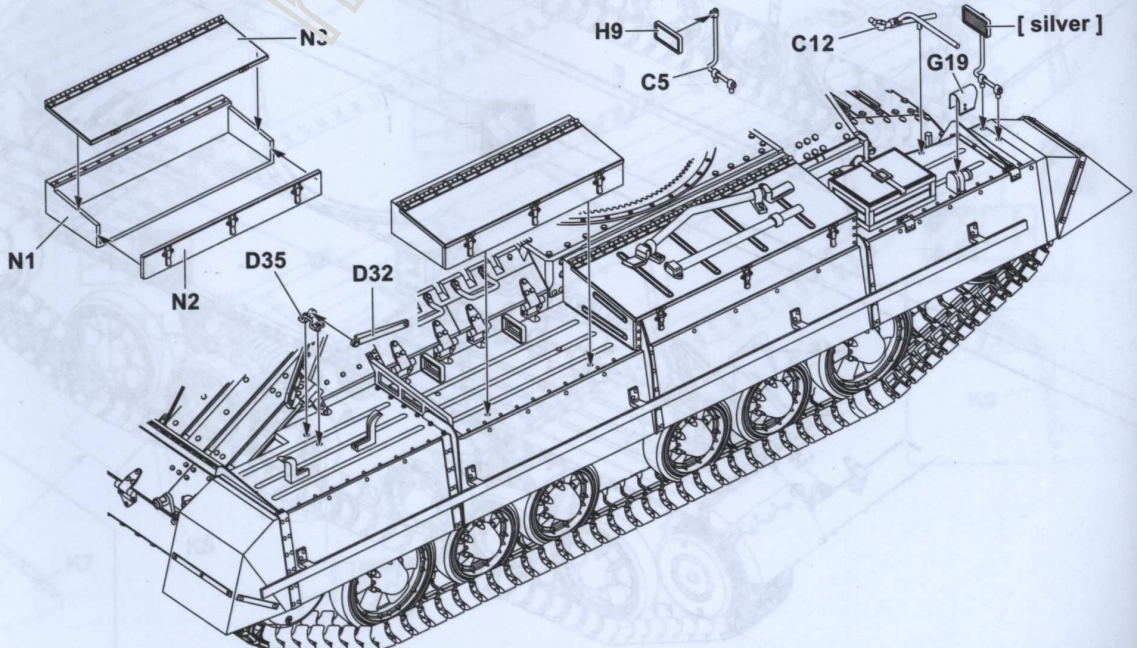

26

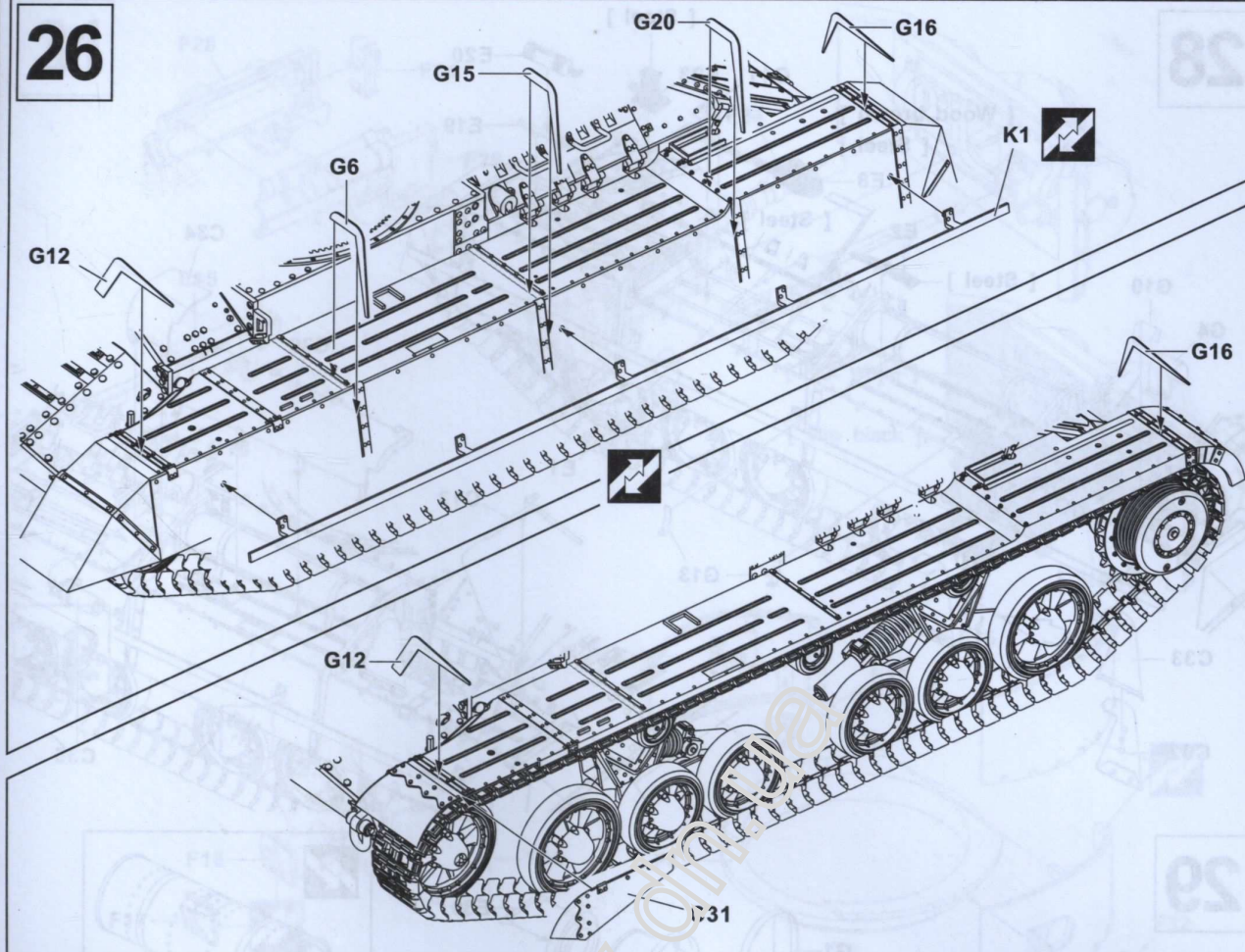

27

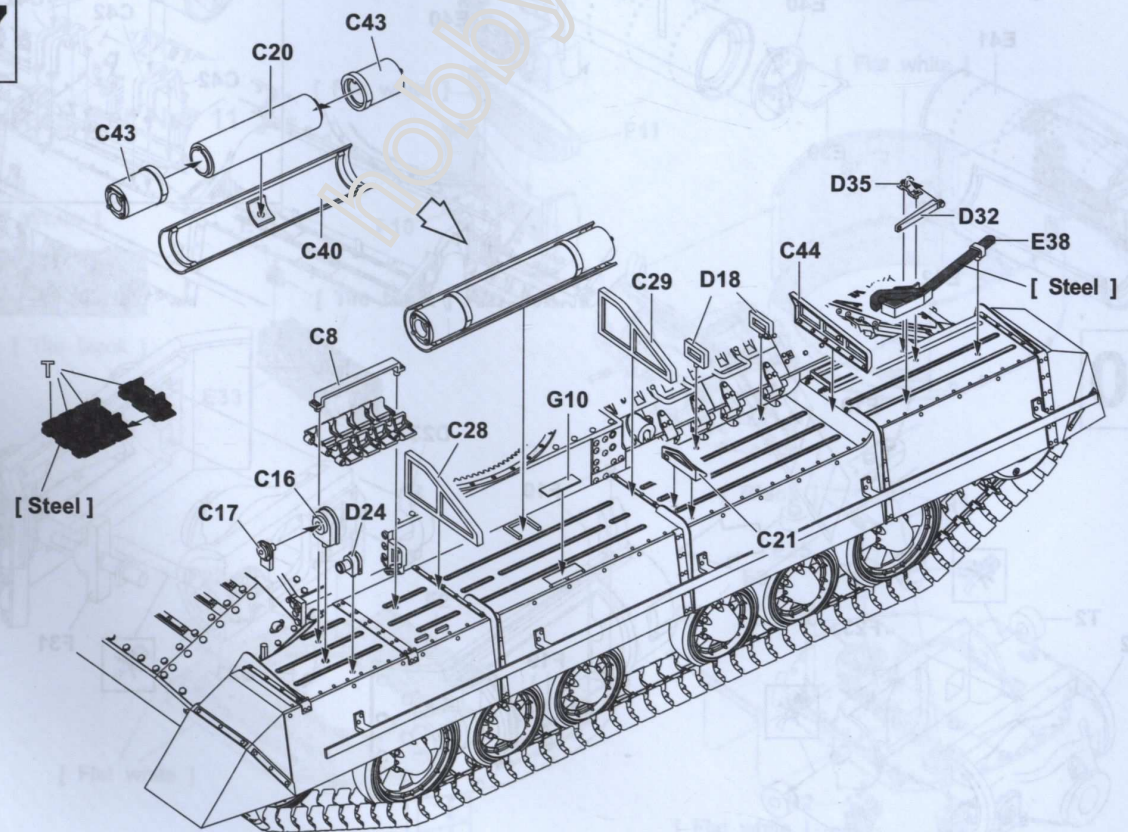

28

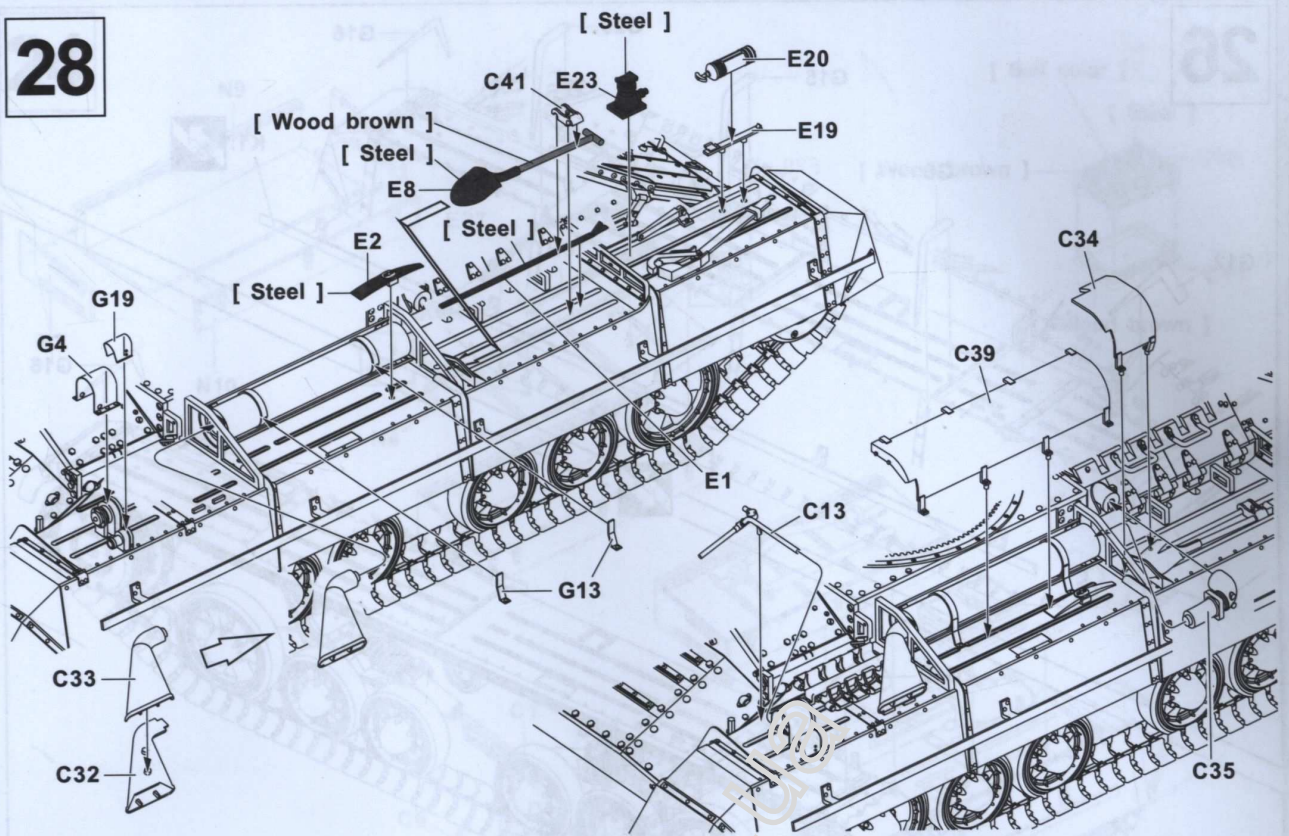

29

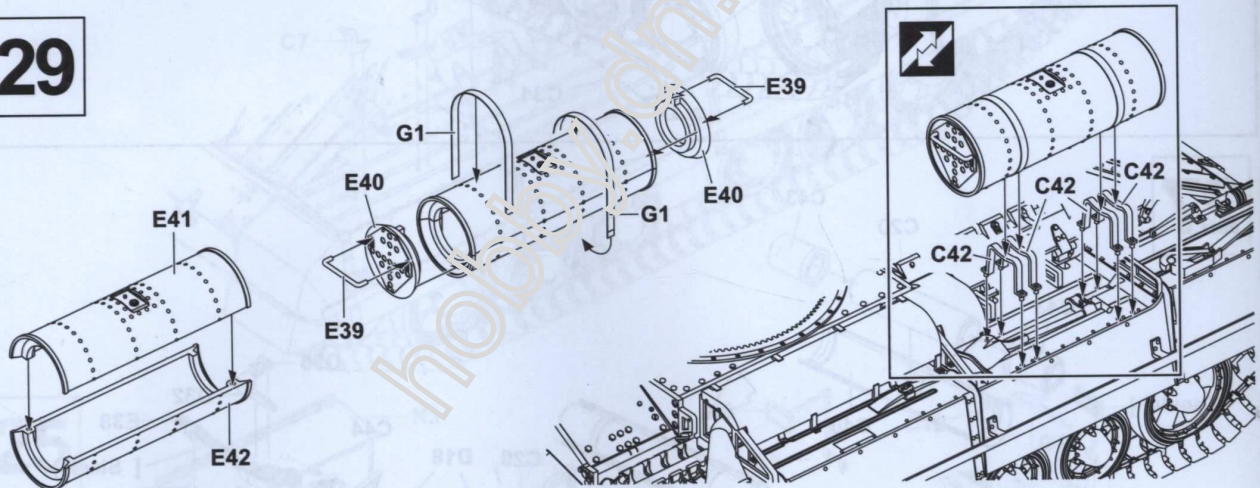

30

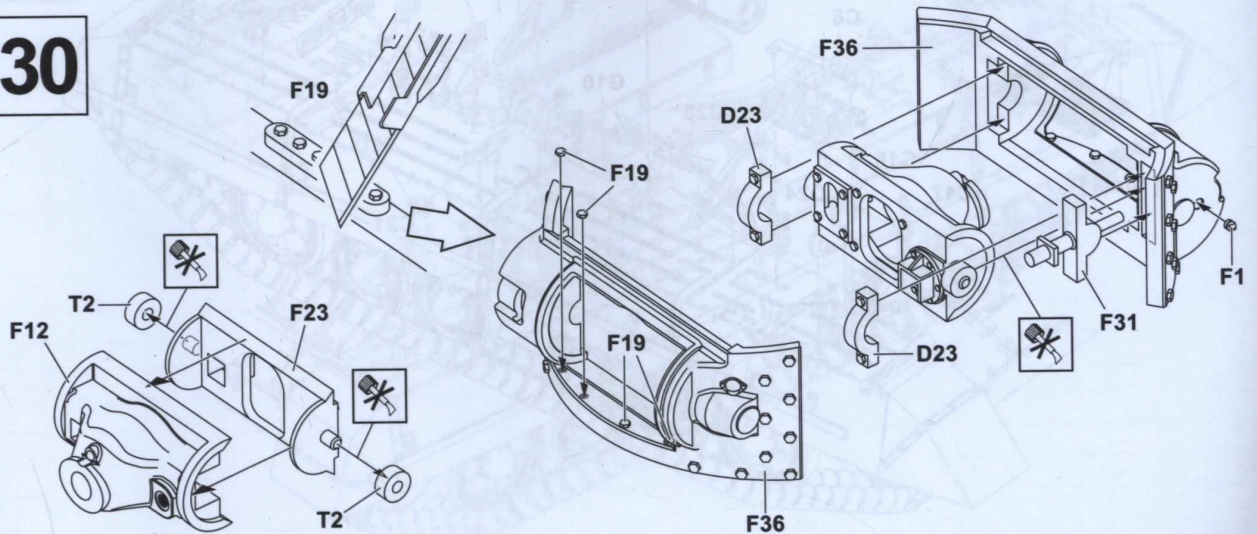

31

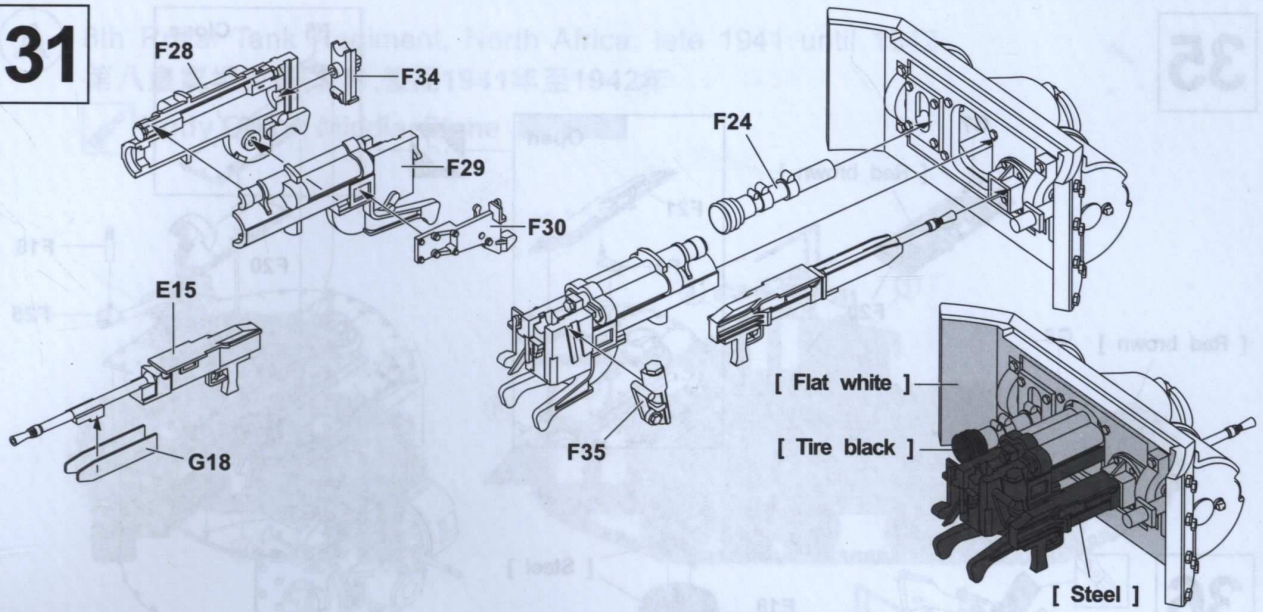

32

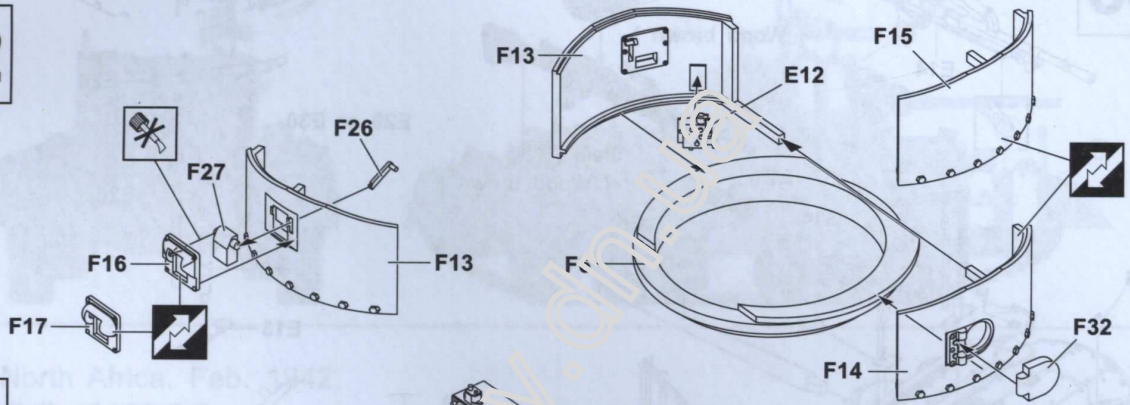

33

《 Wireless Set No. 11 》

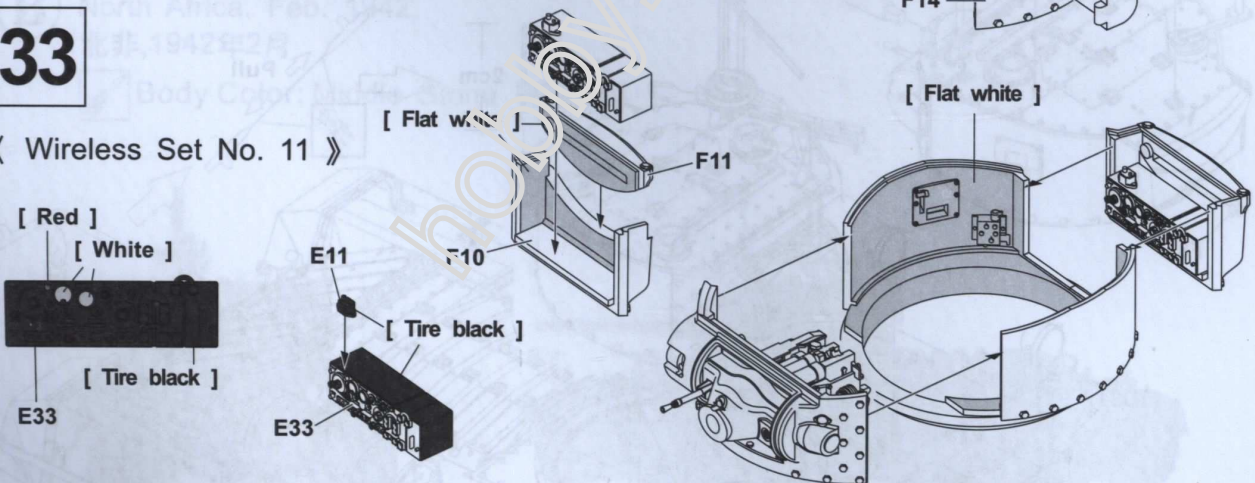

34

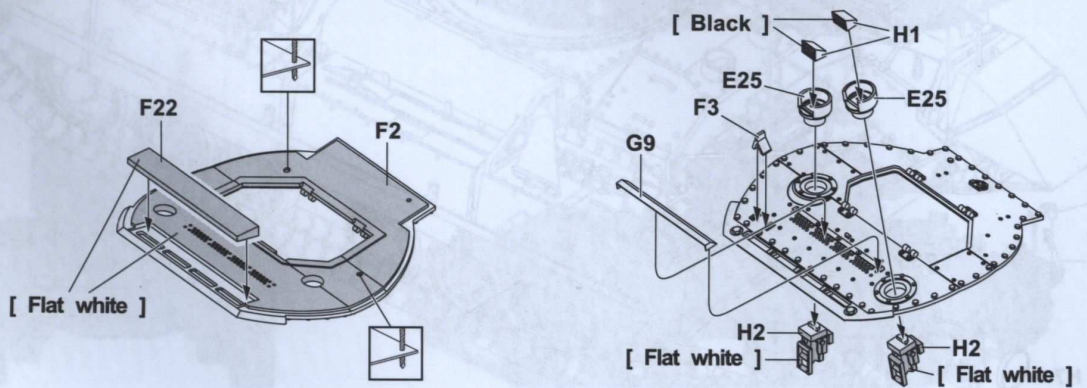

35

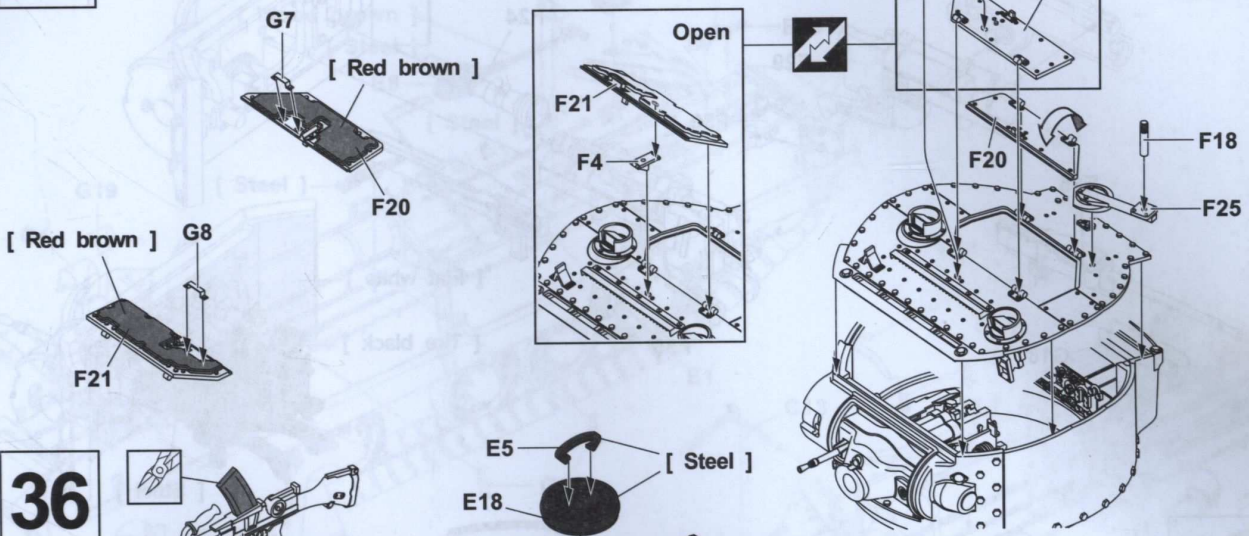

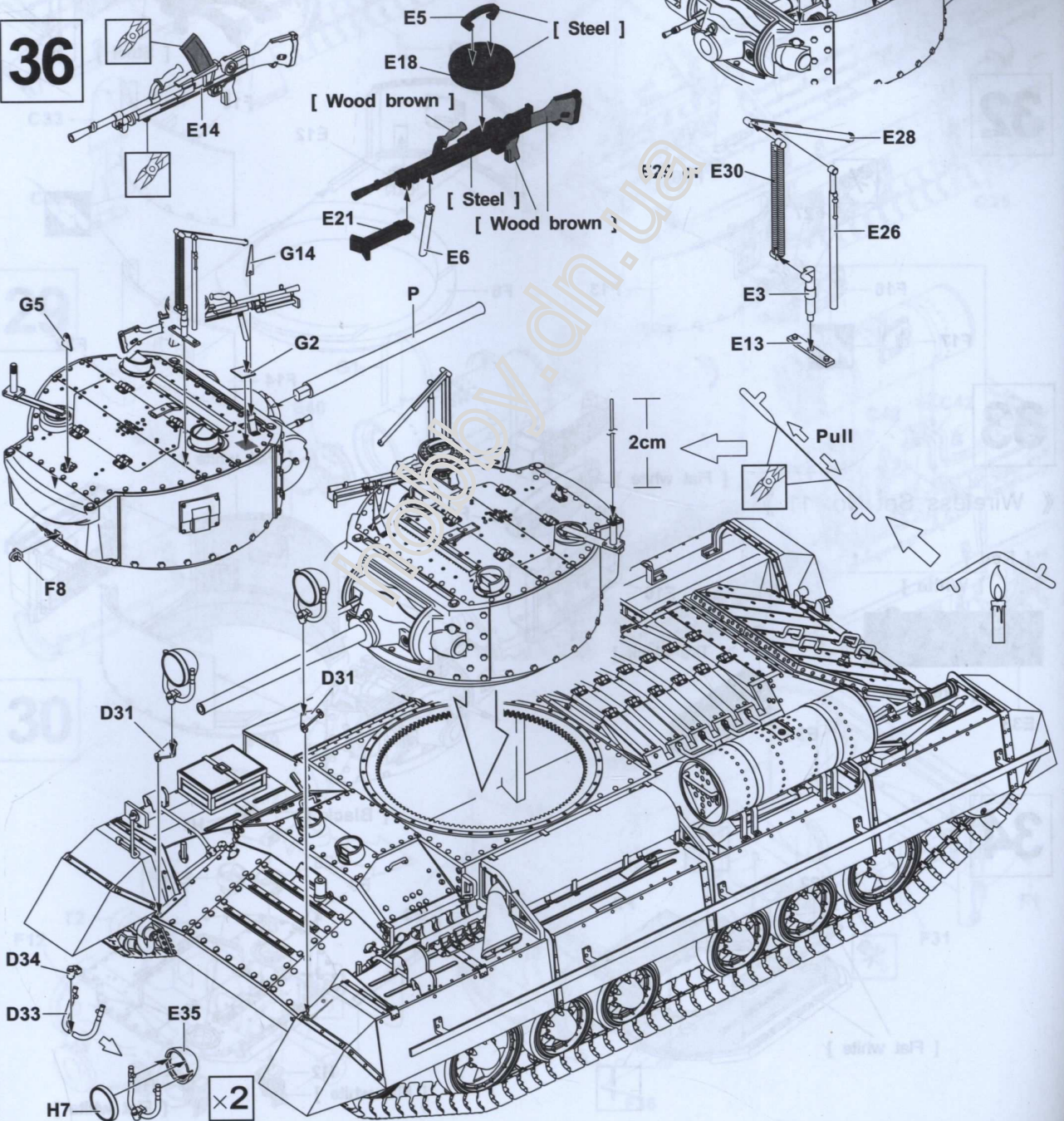

36





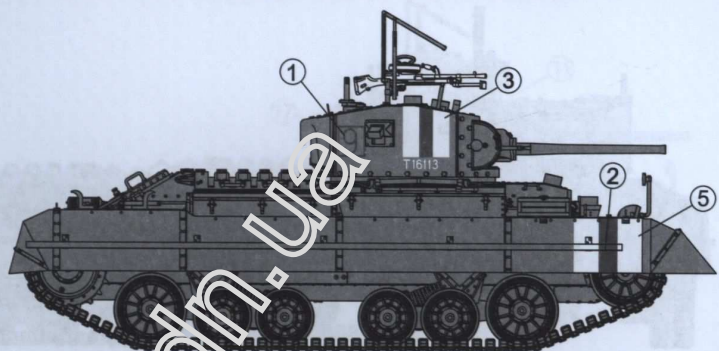
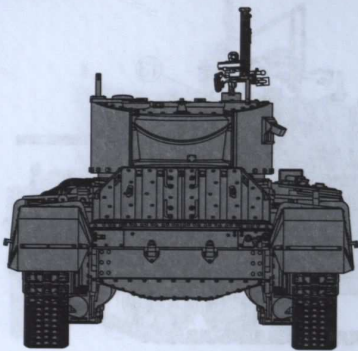
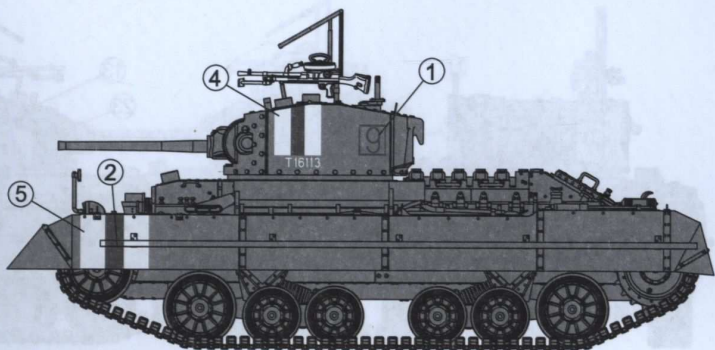
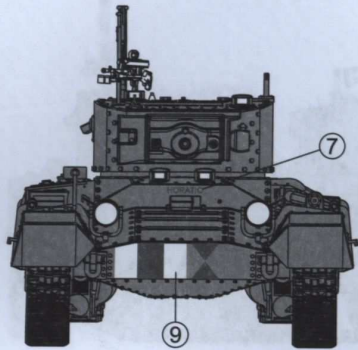

**A** 8th Royal Tank Regiment, North Africa, late 1941 until 1942.  
 第八皇家坦克團,北非,後期1941年至1942年

 Body Color: Middle Stone 



**B** North Africa, Feb. 1942.  
 北非,1942年2月

 Body Color: Middle Stone 

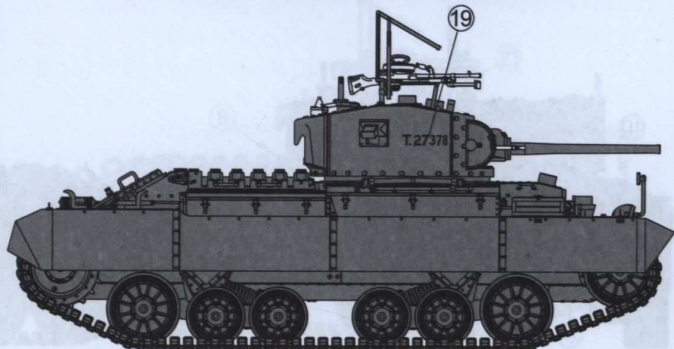
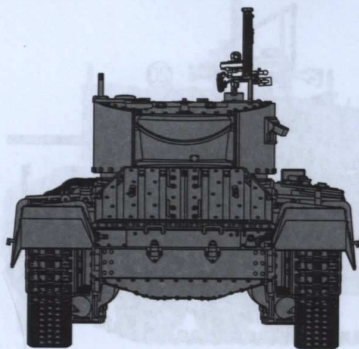
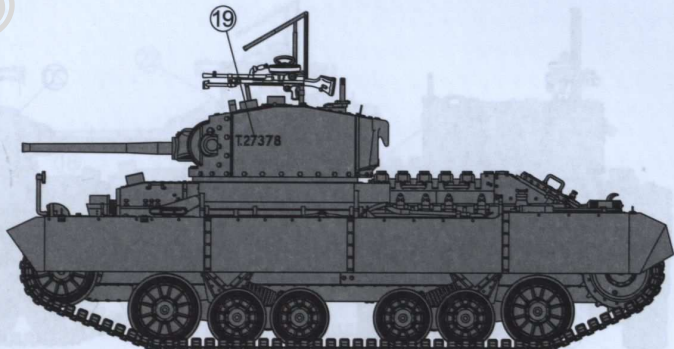
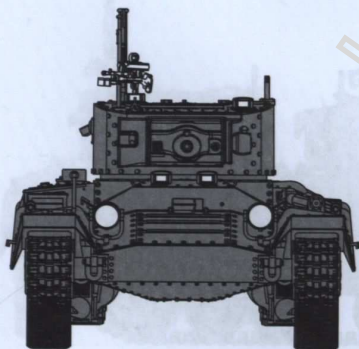

**C** 23rd Armoured Brigade, Tripoli, Jan. 1943.  
第二十三裝甲旅, 的黎波里, 1943年元月

Body Color: Sand   
Khaki green

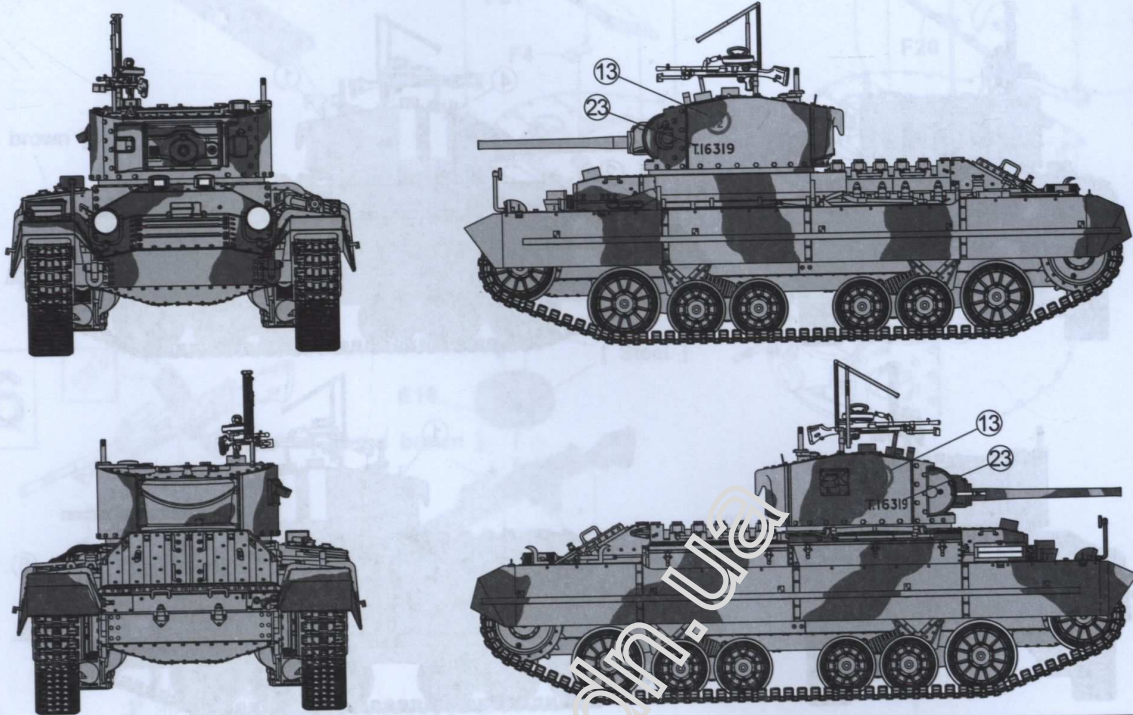

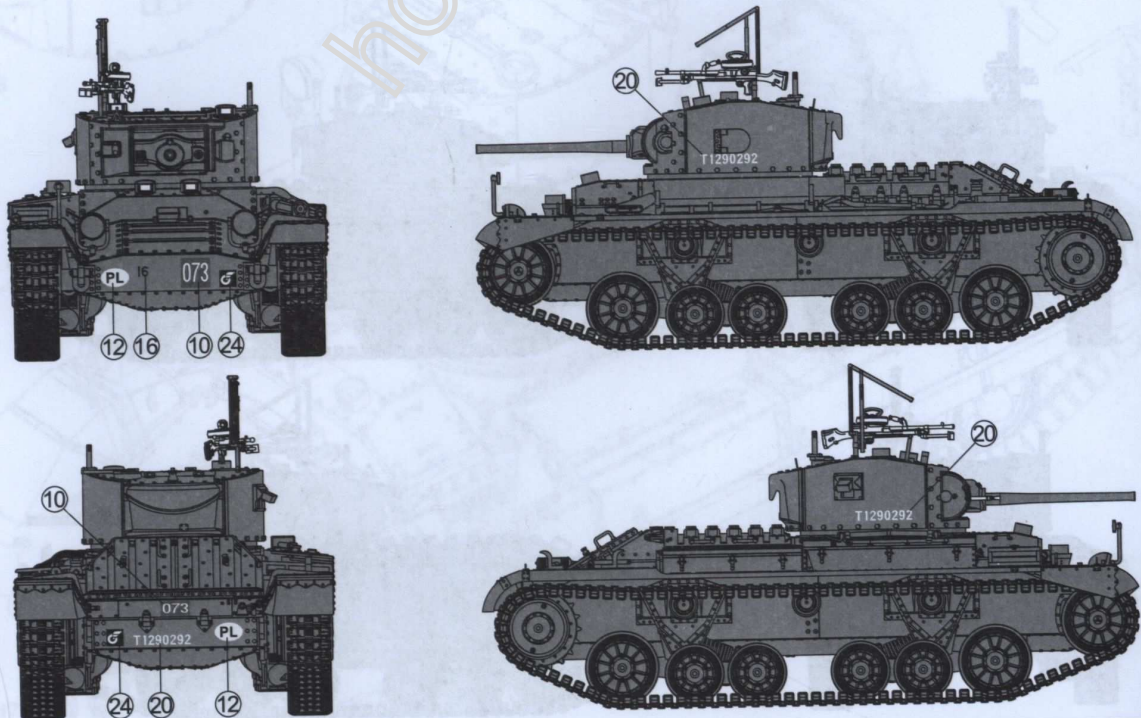

**D** 66th Tank Battalion, 16th Armoured Brigade, Polish 1st Corps, Scotland, 1941.  
自由波蘭第一軍團, 第十六裝甲旅, 第六十六戰車營, 1941年

Body Color: Khaki green



**E**

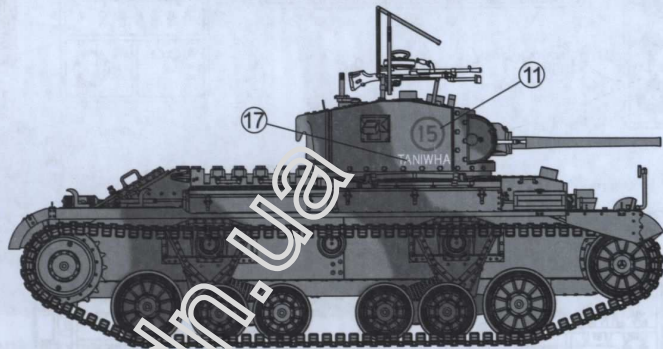
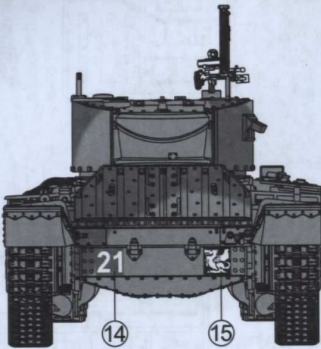
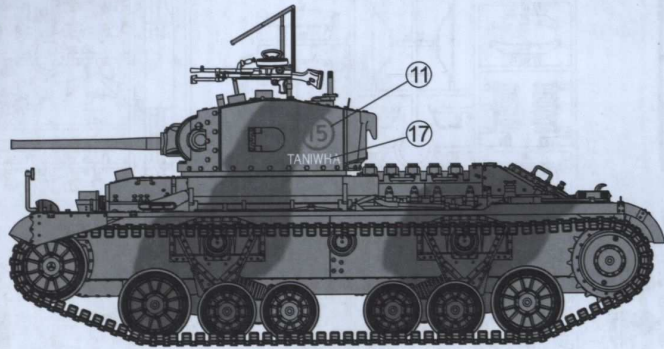
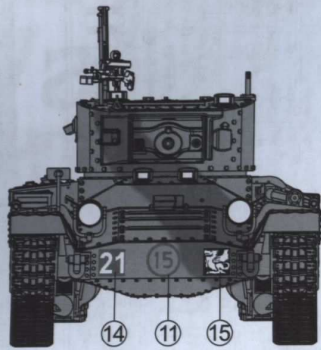

1st Battalion, 1st NZ Army Tank Brigade, Pukekohe, New Zealand, 1943.  
紐西蘭陸軍第一戰車旅第一營, 普基科希, 紐西蘭北島, 1943年

Body Color: Middle Stone   
Khaki green 



**F**

8th Royal Tank Regiment, Libya, Nov. 1941.  
第八皇家坦克團, 利比亞, 1941年11月

Body Color: Middle Stone   
Azure blue   
Sand 

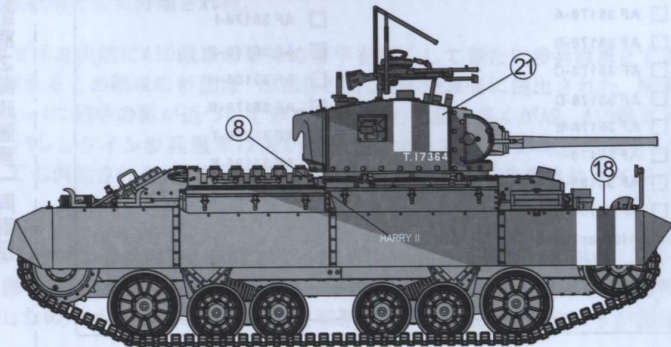
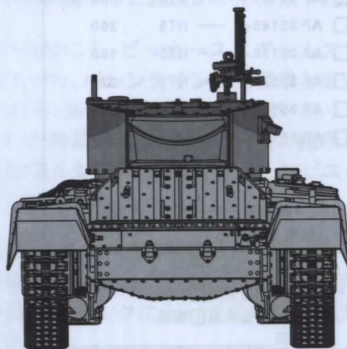
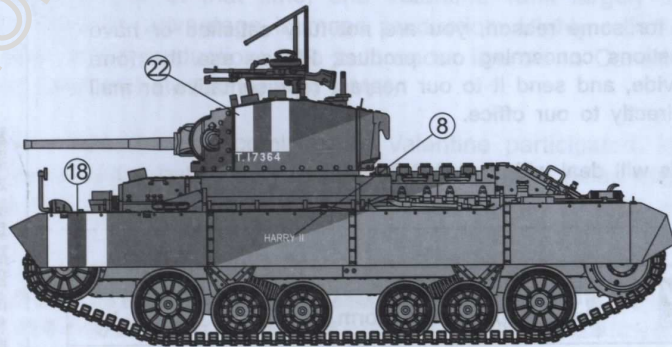
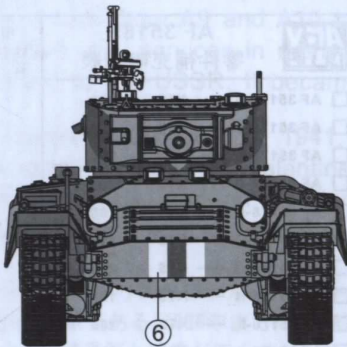

# PARTS LIST 零件表

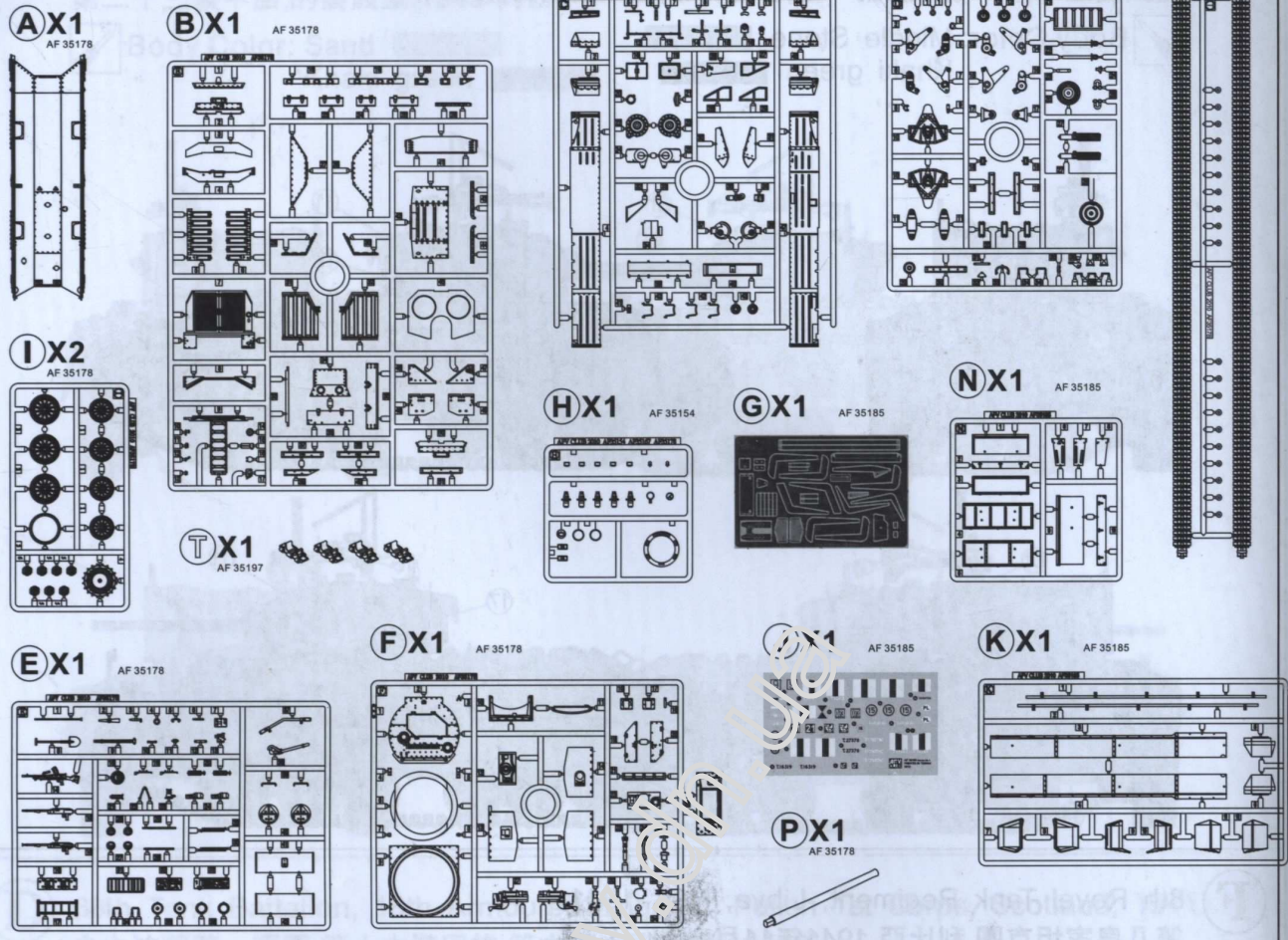

## Instructions:

If for some reason, you are not fully satisfied or have questions concerning our products, please use the form provide, and send it to our nearest representative or mail it directly to our office.

We will deal with that A.S.A.P.

限臺灣地區使用 For Taiwanese use only!

|  <b>AF 35185</b><br>Parts Replacement Form |                                     |
|---|-------------------------------------|
| <input type="checkbox"/> AF 35178-A   | <input type="checkbox"/> AF 35178-I |
| <input type="checkbox"/> AF 35178-B   | <input type="checkbox"/> AF 35185-J |
| <input type="checkbox"/> AF 35178-C   | <input type="checkbox"/> AF 35185-N |
| <input type="checkbox"/> AF 35178-D   | <input type="checkbox"/> AF 35178-P |
| <input type="checkbox"/> AF 35178-E   | <input type="checkbox"/> AF 35178-T |
| <input type="checkbox"/> AF 35178-F   | <input type="checkbox"/> AF 35185-K |
| <input type="checkbox"/> AF 35185-G   | <input type="checkbox"/> AF 35197-T |
| <input type="checkbox"/> AF 35154-H   |                                     |
| Reason for replacement: <input type="checkbox"/> Missing <input type="checkbox"/> Broken                                      |                                     |
| Signature: _____  |                                     |

總代理戰鷹企業 客服部收 本公司將儘速為您處理。  
請將本表與該部品相同金額之郵政匯票一同寄至。

|  <b>AF 35185</b><br>零件補充申請表 |          | 申請人<br>姓名 地址 電話 |
|--|----------|-----------------|
| <input type="checkbox"/> AF 35178-A  | NT\$ 200 |                 |
| <input type="checkbox"/> AF 35178-B  | NT\$ 250 |                 |
| <input type="checkbox"/> AF 35178-C  | NT\$ 200 |                 |
| <input type="checkbox"/> AF 35178-D  | NT\$ 200 |                 |
| <input type="checkbox"/> AF 35178-E  | NT\$ 200 |                 |
| <input type="checkbox"/> AF 35178-F  | NT\$ 250 |                 |
| <input type="checkbox"/> AF 35185-G  | NT\$ 200 |                 |
| <input type="checkbox"/> AF 35154-H  | NT\$ 150 |                 |
| <input type="checkbox"/> AF 35178-I  | NT\$ 200 |                 |
| <input type="checkbox"/> AF 35185-J  | NT\$ 160 |                 |
| <input type="checkbox"/> AF 35185-N  | NT\$ 200 |                 |
| <input type="checkbox"/> AF 35178-P  | NT\$ 160 |                 |
| <input type="checkbox"/> AF 35178-T  | NT\$ 220 |                 |
| <input type="checkbox"/> AF 35185-K  | NT\$ 220 |                 |
| <input type="checkbox"/> AF 35197-T  | NT\$ 50  |                 |
| +郵寄費 NT\$ 80   |          |                 |
| (請填) 總計 NT\$ _____   |          |                 |
| 零件補充原因:(請於 <input type="checkbox"/> 打 <input checked="" type="checkbox"/> )                                      |          |                 |
| 原包裝即 <input type="checkbox"/> 遺失或 <input type="checkbox"/> 毀損,   |          |                 |
| 製作途中 <input type="checkbox"/> 遺失或 <input type="checkbox"/> 毀損,   |          |                 |
| 其他原因 _____   |          |                 |