

# INTERNATIONAL<sup>®</sup> PROSTAR<sup>®</sup>

PART  
NUMBER  
1301



MOEBIUS MODELS

1:25-SCALE PLASTIC MODEL KIT SKILL LEVEL **3** AGES 15 & UP

## IMPORTANT - READ THIS FIRST

Before assembling model, **study pictures carefully**. These instructions include detailed drawings and images of an actual build-up for reference. You can also refer to photos on the packaging. In addition, you will find the following tips helpful:

- This model kit is molded of styrene plastic – **use only styrene-compatible glues or cements**.
- Apply cement to the **inside surfaces only**; avoid getting cement on outer surfaces of model sections.
- **Use cement sparingly** and **avoid getting cement on hands**, so as not to mar or smear plastic surfaces.
- **Do not hurry**; work carefully and patiently.
- Before cementing, **it is advisable to assemble parts dry** (without cement) so that you may familiarize yourself with parts and fit, **noting points where cement is to be applied**.
- For best results assemble model **in the order indicated**.

## PAINTING YOUR KIT

- **Use paint that is made for use on plastic**. If you are unsure, test paint on scrap pieces of sprue before applying it to kit parts.
- This kit is designed to be built in **sub-assemblies**. We would suggest that **it is best to paint each sub-assembly separately** before final assembly of the kit.
- In certain cases **it may be a good idea to paint some parts during assembly**. For example, it will be easiest to

paint and decal the assembled dash and the seats before cementing them in place on the floor, which can also be painted and decaled before assembly.

## DECAL APPLICATION

Decals have been provided to ensure the utmost detail and authenticity. It may also be easiest to **apply decals to sub-assemblies**. Apply decals only after paint is **completely dry**.

1. **Dip the decal in water for 10 seconds**. For best results, mix one drop of common dish washing detergent per cup of lukewarm water.
2. Place the wet decal face up on a paper towel and **wait 30-60 seconds** until the decal is **movable on paper backing**.
3. **Wet the area of the model** to be applied to.
4. Hold the decal face up, in position on model and **slide backing away** from under it.
5. Once positioned correctly, **gently smooth out decal** and **absorb excess water** with a paper towel, cotton swab or clean, soft paintbrush.
6. **Let decals dry completely** before applying any sort of dull coat or gloss coat to decal area, if desired.

## KEY TO PARTS

① Plastic Part    1 Decal

The builder will note that this kit includes additional parts not called for in the instructions; use only part numbers described in these instructions. For a list of parts not needed, see back page.



# 1 CAB SUB-ASSEMBLY

**!** **NOTE:** We suggest that it's wise to paint all the cab and aero fairing parts before assembling the truck.

**A** Cement the **Cab Roof** (#3) to the **Cab Body** (#217).

**B** Paint all the body components — the **Cab Assembly**, the **Front Bumper** (#244), **Cab Back Wall** (#4), **Hood** (#243) and **Aero Skirts** (#246 & #247). The painted components can dry while other assemblies are completed.

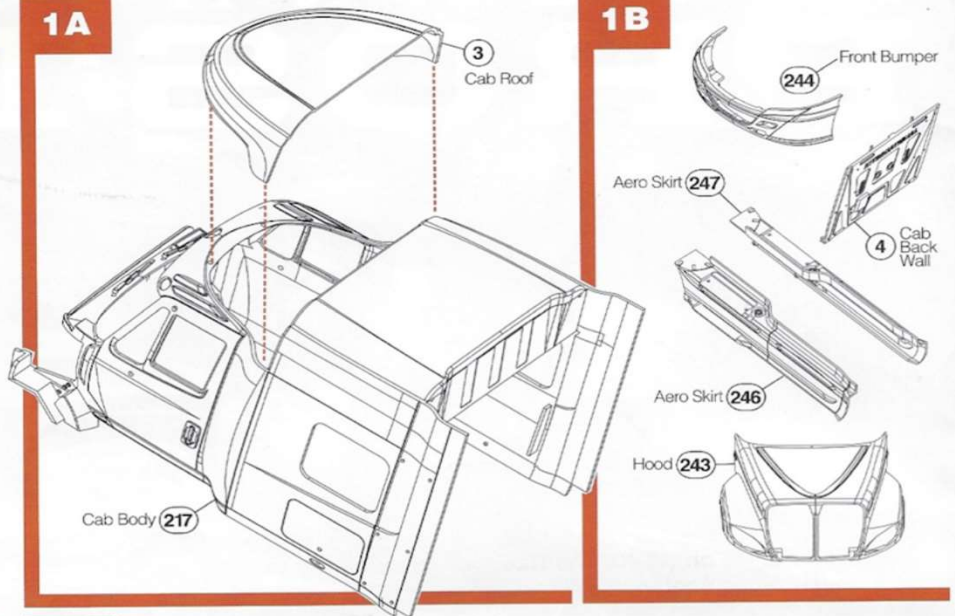

# 2 ENGINE & TRANSMISSION

**!** **NOTE:** We suggest that you paint individual engine parts before assembly

**A** Cement **Engine Halves** (#116 & #117) together, then add the **Oil Pan** (#122), the **Transmission Oil Pan** (#138), **Transmission Rear Cover** (#134), **Engine Front** (#119), **Valve Cover** (#123) **EGR Manifold** (#129) and **Transmission Shift Pack** (#149).

**B** Cement **Exhaust Manifold** (#132), **Oil Filter** (#137) and **Turbo Charger** (#210), **Inter Cooler** (#131) and **Exhaust Pipe** (#276) to right side of **Engine**.

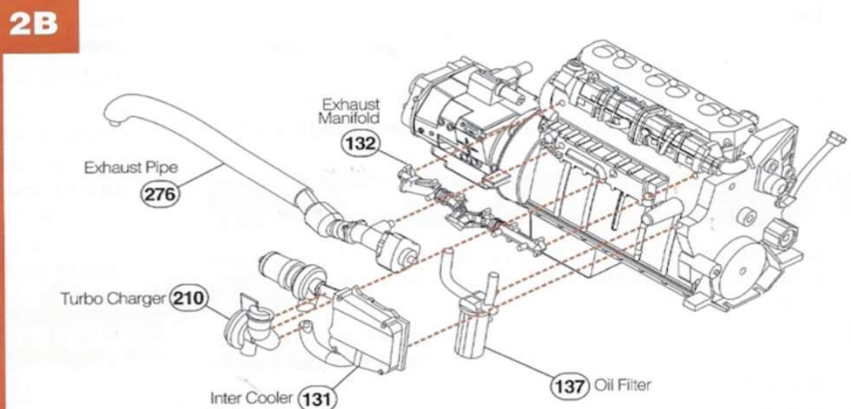
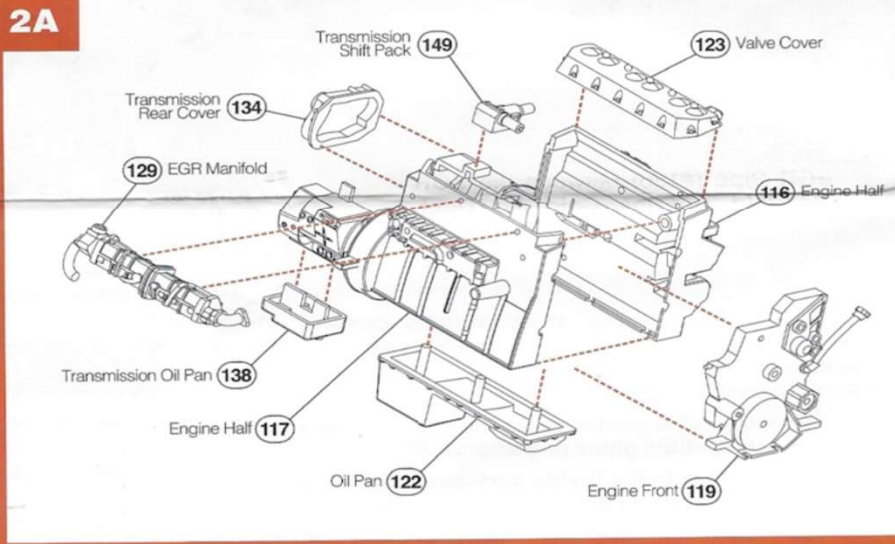

**C** Cement **Engine Front Cross Member** (#133) to **Front Cover of Engine** and add **Air Horn** (#148). Attach **Engine Belts** (#124 & #125), **Pump** (#140), **Alternator** (#147) and **Upper Radiator Hose** (#266) to front of **Engine**.

**D** Cement **Starter** (#144), **Fuel Filter** (#143) and **Canister** (#146) to left side of **Engine**.

**E** Assemble **Air Cleaner** by cementing **Air Pipe** (#279) and **Canister Halves** (#261 & #262) together. Lay the **Air Cleaner Assembly** aside for now.

**F** Assemble the **Radiator** by cementing **Shroud** (#120) to **Radiator Core** (#282) and **Radiator Core** to **Radiator Front** (#245); then add the **Coolant Bottles** (#267 & #145).

**G** Cement the **Fan** (#130) and **Radiator Assembly** to front of **Engine**.

**H** Assemble the **Engine Package** by cementing **Turbocharged Air Duct** (#275) to the right side of the **Engine and Radiator Assembly**; cement the **Cold Air Duct** (#240) between the **Radiator Assembly** and left side of the **Engine**. Finish by cementing the **EGR Pipe** (#136) between the **EGR Manifold** and the **Cold Air Duct**. Complete the **Engine Package** by cementing the **Air Cleaner Assembly** in place. Set the **Engine Assembly** aside for now.

## 2C-D

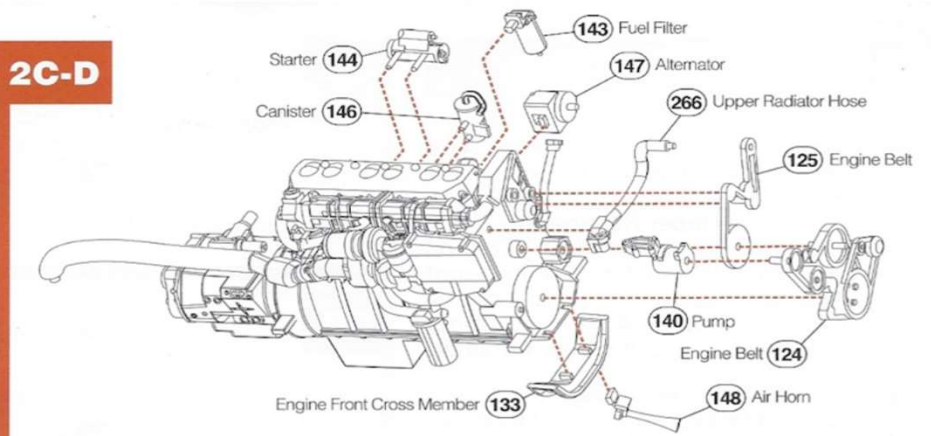

## 2E



## 2F

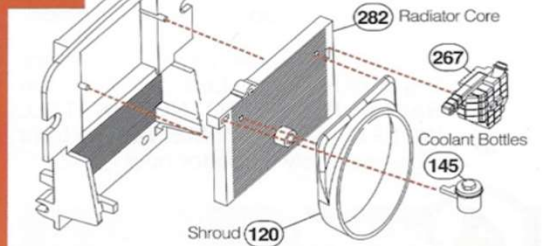

## 2G

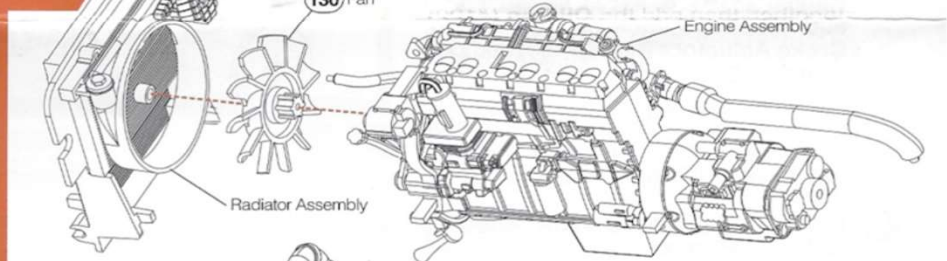

## 2H

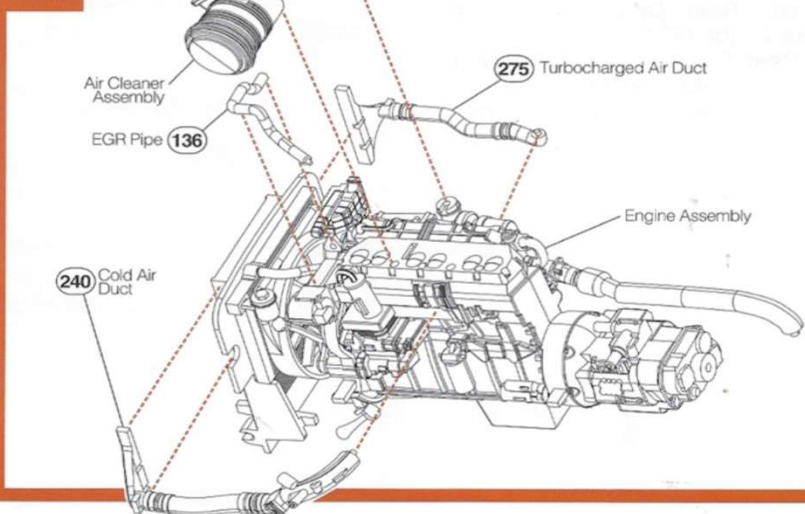



### 3

## FRONT AXLE

- A** **NOTE:** The left side of **Front Axle** (#155) has a small locator hole on the back surface. Assemble **Front Axle** by placing the **Upper Retainer** (#77) and the **Right Lower Retainer** (#180) on the pins at the right end of the **Front Axle** (#155). Repeat the process on the left end of the **Axle** using **Upper Retainer** (#77), **Left Lower Retainer**.
- B** Cement **Steering Linkage** (#178) and **Backer Plates** (#70) in place, taking care not to get glue on **Axle**. To make steering poseable, place **Tie Rod** (#161) on pins of **Lower Hub Retainers** (#179 & #180) and use hot knife blade or screwdriver to melt pins, trapping **Tie Rod** in place.
- C** Cement **Front Air Brake Actuators Right** (#185) and **Left** (#186) to the **Backer Plates**. **DO NOT INSTALL WHEELS AT THIS TIME**. Set the front axle assembly aside for now.

### 3A

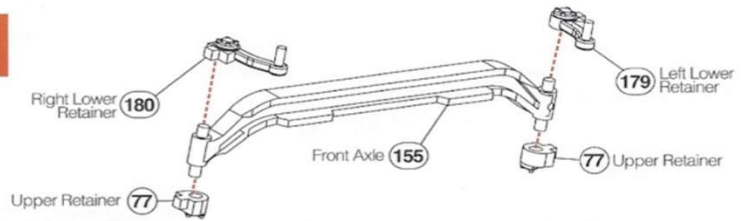

### 3B

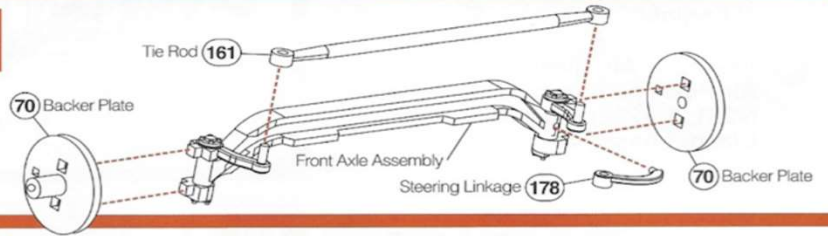

### 3C

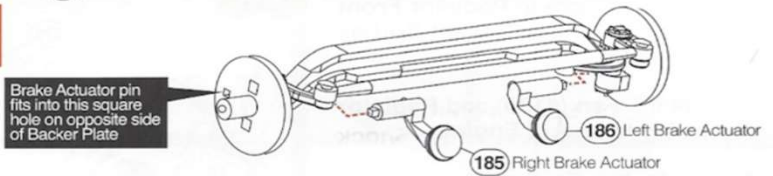

### 4

## REAR AXLES

- A** Cement **Front Drive Axle Housing Halves** (#151 & #152) together and add the **End Plates** (#211). Cement **Brake Actuators Right** (#184) and **Left** (#183) to **End Plates**.
- B** Cement **Front Drive Axle Locator Arms Right** (#207) and **Left** (#206) to the **Front Drive Axle Assembly**.
- C** Cement **Rear Drive Axle Housing Halves** (#153 & #154) together and add **End Plates** (#71). Cement **Brake Actuators Right** (#181) and **Left** (#182) to **End Plates**.
- D** Cement **Rear Drive Axle Locator Arms Right** (#74) and **Left** (#73) to the **Rear Drive Axle Assembly**. **DO NOT INSTALL WHEELS AT THIS TIME**. Set the **Rear Axle Assemblies** aside for now.

### 4A

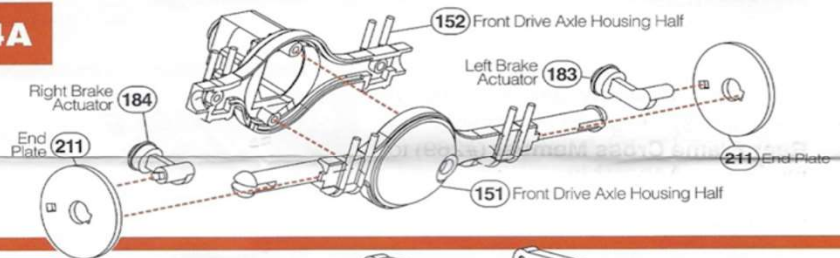

### 4B

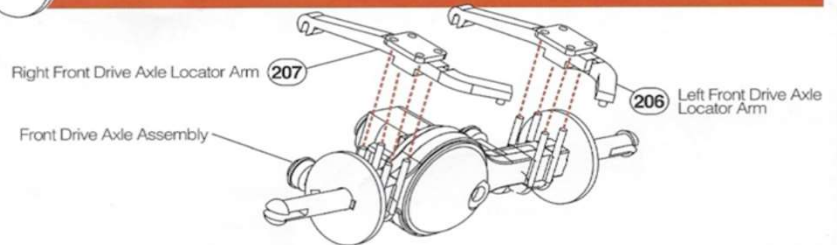

### 4C

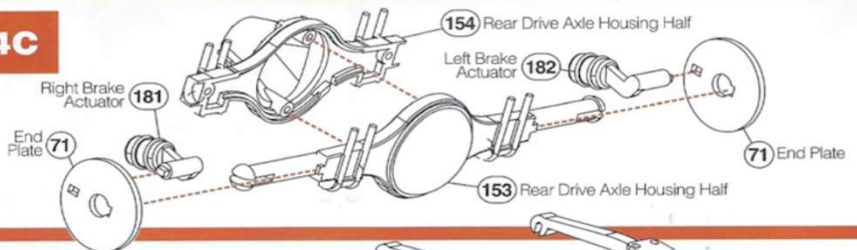

### 4D

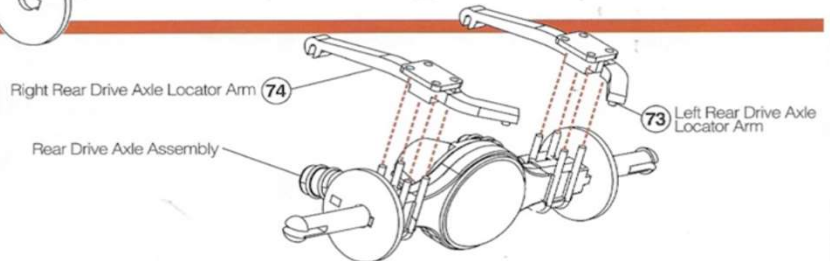

# 5 FRAME

**A** Cement the **Frame Cross Members**, (four #69; #158 & #159) to the **Left Frame Rail** (#251) then cement **Right Frame Rail** (#252) to each of the **Cross Members**. **NOTE:** This is a critical assembly step — make sure that each cross member is properly located and that the entire assembly is square and level when completed.

**B** Cement four **Suspension Hangers** (#72), two **Rear Cab Mounts** (#76) and **Front Cab Mounts Left** (#168) and **Right** (#169) to the **Frame Assembly**. Make sure that cab supports are properly aligned by test fitting (not cementing) the **Frame Assembly** to the **Cab Floor** (#8).

**C** Cement **Front Springs Left** (#264), **Right** (#263) and the **Front Shock Absorbers Left** (#171) and **Right** (#172) along with **Steering Box** (#218) and **Fuel Filter / Water Trap** (#141) to the **Frame Assembly**. Cement the **Rear Drive Axle Shock Absorbers Left** (#175) and **Right** (#176), the **Front Drive Axle Shock Absorbers Left** (#173), **Right** (#174) and the **Rear Frame Cross Member** (#269) to the **Frame Assembly**.

**!** **NOTE:** If you are applying paint with an airbrush or spray cans this is a good time to paint the frame and axle assemblies, as all the components assembled to this point are the same color on the real truck.

**D** Assemble **Battery Box** (#230, #231, #232 & #233). Assemble two **Air Tanks** (#64 and #65). Cement **Air Tanks** to bottom of **Battery Box**.

## 5A

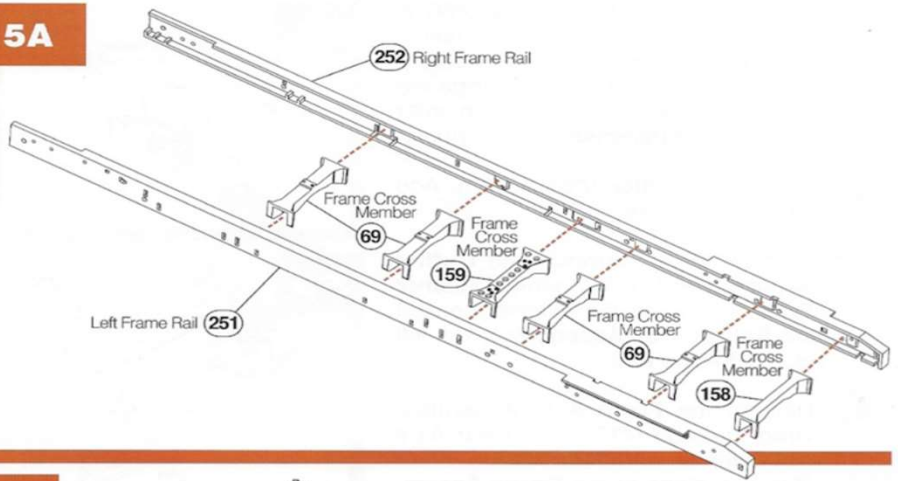

## 5B

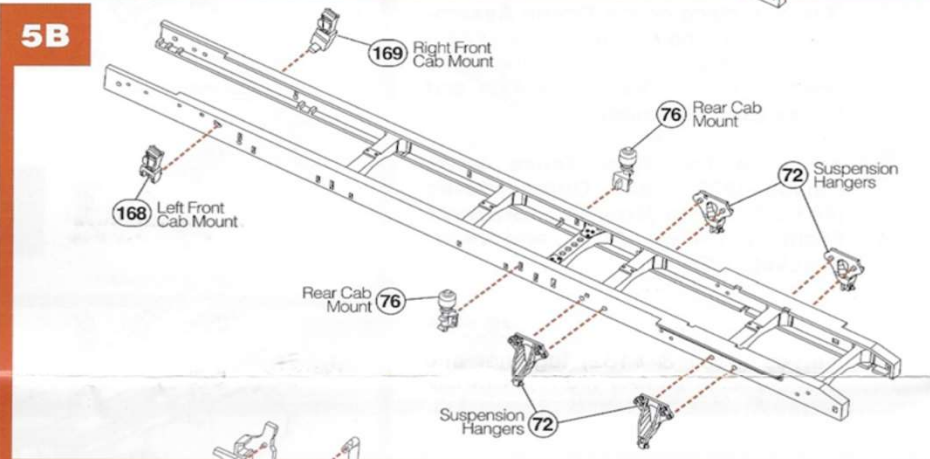

## 5C

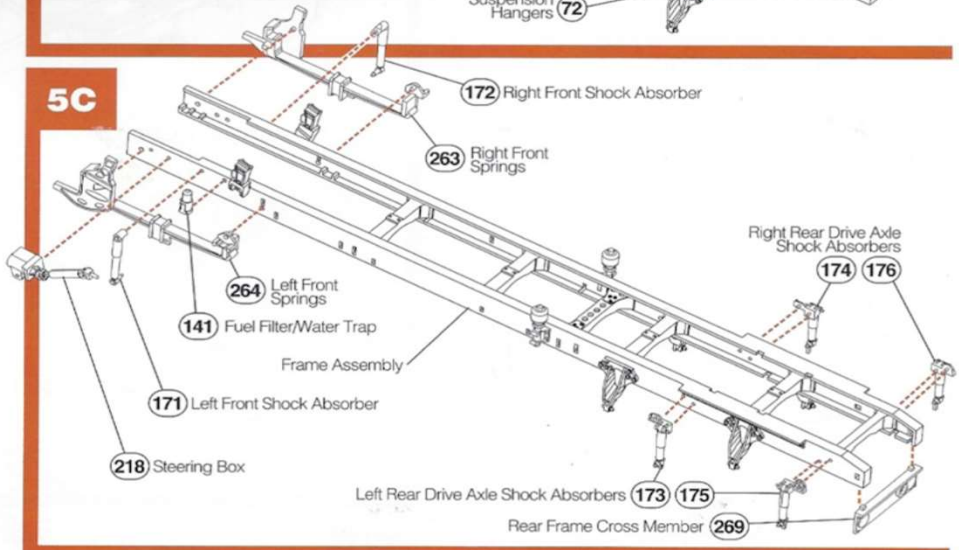

## 5D

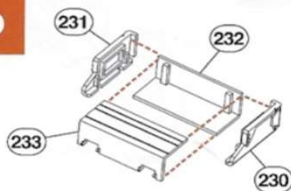

## 2X

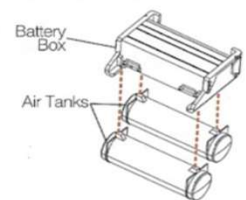



**E** Assemble four **Air Springs** (#66 & #67). **NOTE:** #67 is the **OUTER** half of each **Air Spring** — you will need to **MAKE SURE** that the **Air Springs** are correctly located on the **Frame** in order for the **Rear Suspension** to fit correctly.

**F** Assemble **Muffler** (#88 & #89). Add **Muffler Hangers** (#205).

**G** Cement the **Air Springs**, the **Muffler Assembly** and the **Windshield Washer Bottle** (#274) to the **Frame**. Cement the **Battery Box Assembly** to the left side of **Frame Rail**.

**H** Cement the **Front Axle Assembly**, **Drag Linkage** (#177), the **Rear Axle Assemblies** and **Rear Drive Shaft** (#162) in place on the **Frame Assembly**. Cement the **Exhaust Pipe** (#288) to the **Muffler**, then cement the **Drive Shaft** (#281) to **First Drive Axle** and **Frame Cross Member**.

**I** Assemble two **Fuel Tanks Inner Halves** (#250) and **Outer Halves** (#63), then add **Mounting Brackets Front and Rear** (#79) and **Inner Brackets** (#78).

**5E**

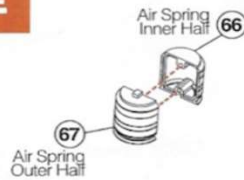

**5F**

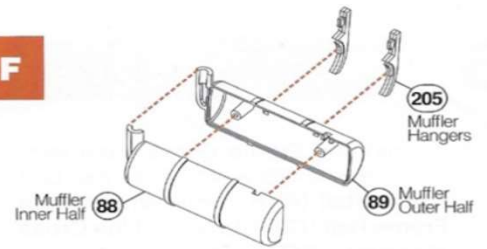

**5G**

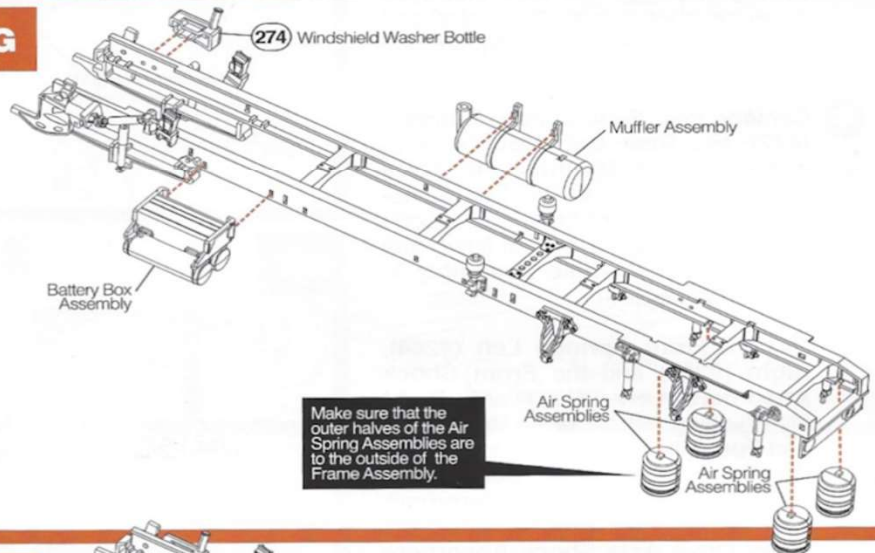

**5H**

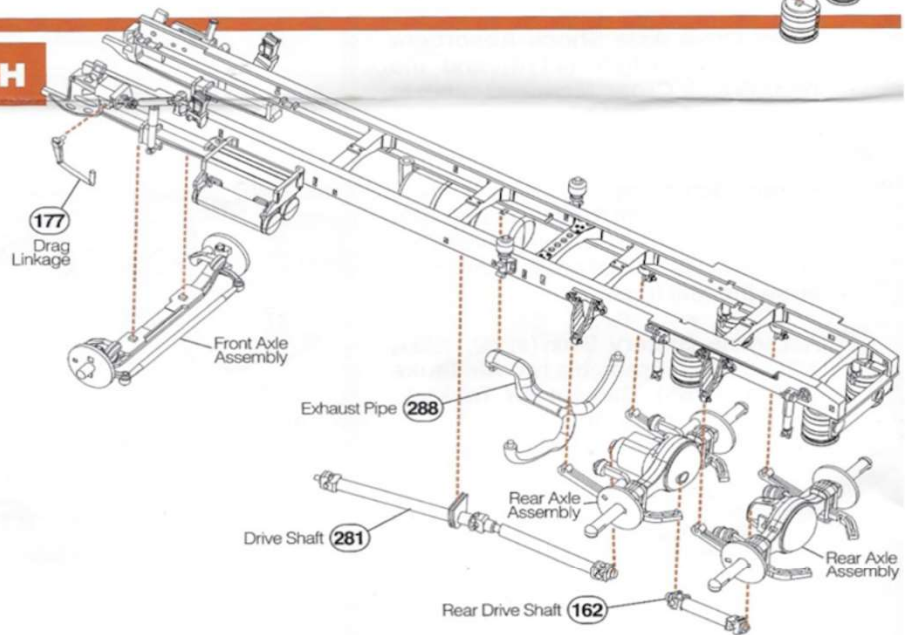

**5I**

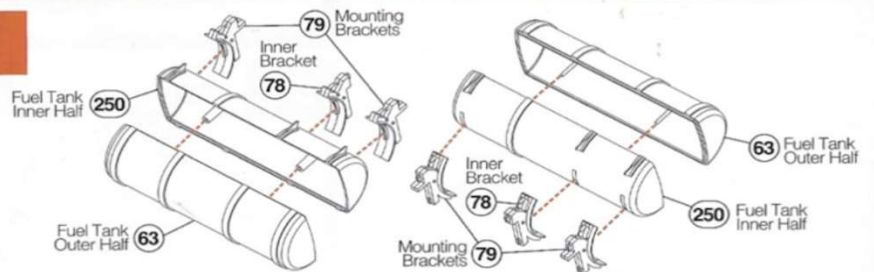

**J** Assemble the **Left Aero Skirt** by cementing the **Inner Structure** (#253), **Front Bracket** (#272), **Middle Bracket** (#75) and **Rear Skirt Bracket** (#241) to the **Left Aero Skirt** (#246). Add the **Chrome Steps** (#237 & #238).

**K** Assemble **Right Aero Skirt** by cementing **Inner Structure** (#254), **Front Bracket** (#273), **Middle Bracket** (#75) and **Rear Skirt Bracket** (#241) to **Right Aero Skirt** (#247). Add the **Chrome Steps** (#236 & #239).

**L** Cement the **Fuel Tank Assemblies** to the **Frame Rails**. Cement the **Fuel Tank Braces** (#163 & #165) in place. Cement the **Left** and **Right Aero Skirt Assemblies** to the **Frame**.

**5J**

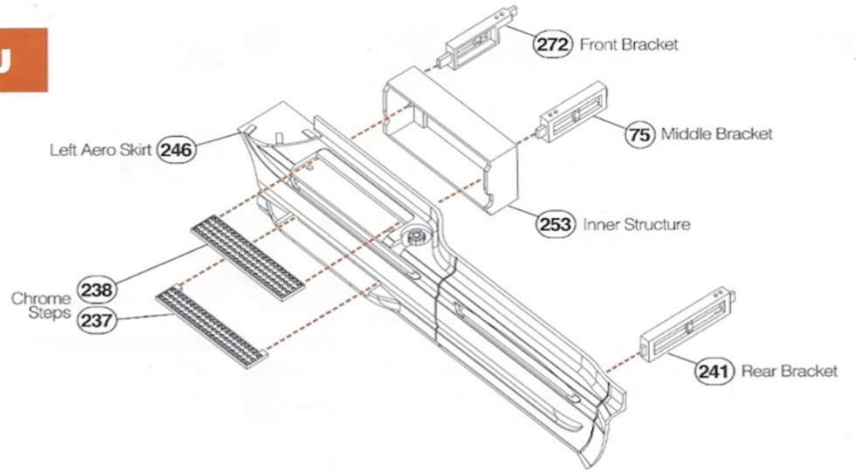

**5K**

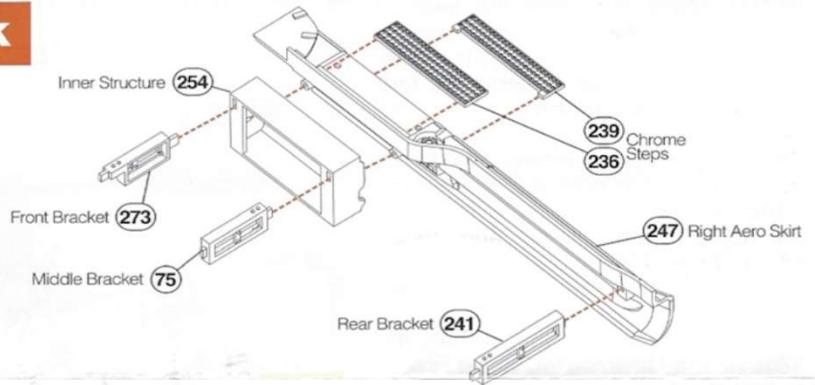

**5L**

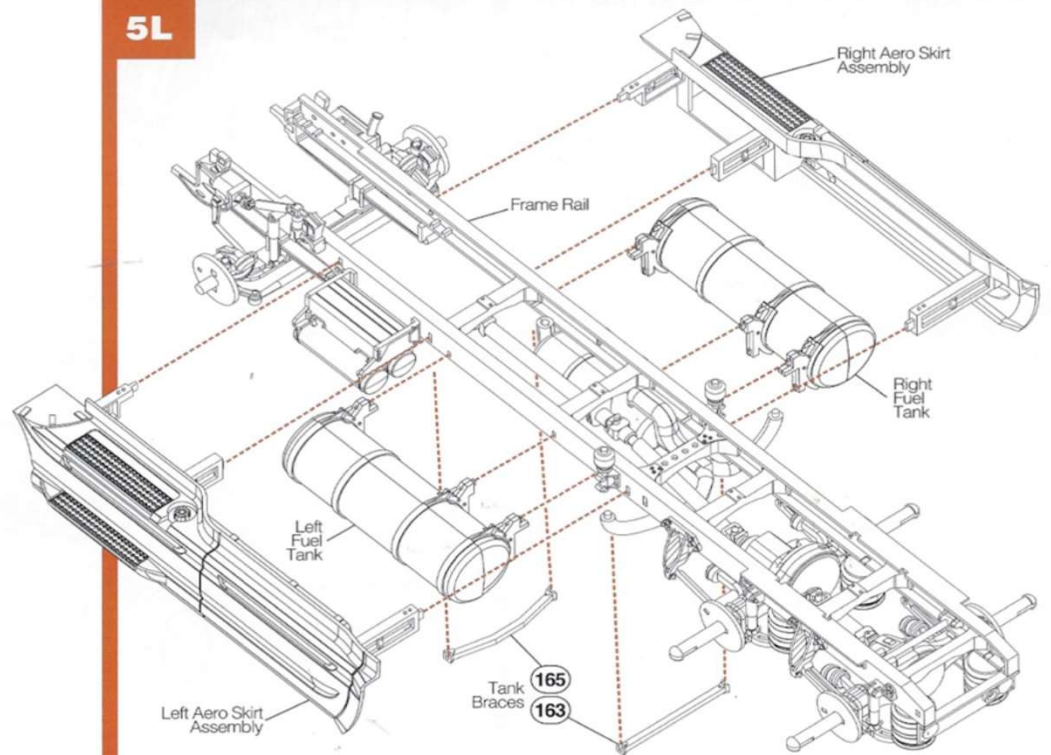



# 6 WHEELS

**A** Insert **Front Wheel** (#57) into **Tire** (#203). Make sure that lettered side of **Tire** is on outside of **Wheel**, then cement **Inner Wheel Ring** (#61) in place. Repeat these steps to complete the second **Front Wheel Assembly**.

**B** Insert **Inner Wheel** (#60) into **Tire** (#203). Make sure that lettered side of **Tire** faces away from **Inner Wheel** (#60) and cement **Inner Wheel Ring** (#61) in place. Repeat these steps to complete four **Inner Wheel Assemblies**.

**C** Insert **Outer Wheel** (#59) into **Tire** (#203). Make sure that the lettered side of the tire faces out, then cement the **Inner Wheel Ring** (#58) in place. Repeat these steps to complete four **Outer Wheel Assemblies**.

**D** Assemble the **Rear Wheel Pair** by inserting the **Inner Wheel** (#60) into the **Outer Wheel** (#59) making sure that the holes in the two wheels line up when done. Repeat these steps to make four sets of **Rear Wheel Pairs**.

**NOTE:** At the builder's discretion, the **Wheels** may be installed to the **Frame** at this point as described in **Step 6E** below; however, some builders may prefer installing wheels **AFTER** the **Engine**, **Exhaust Stacks**, and other details have been cemented in place (**Step 7**).

**E** Install **Rear Wheel Sets** by pushing them onto **Axles**, then install **Front Wheels** by slipping them onto the **Front Axle** and cementing **Retainers** (#80) in place. Take care to keep cement off inner surfaces of **Wheel**. Finish by slipping **Wheel Center Caps** (#62) in place.

## 6A 2X

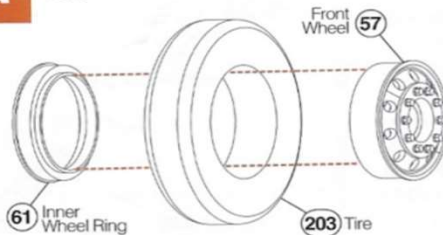

## 6B 4X

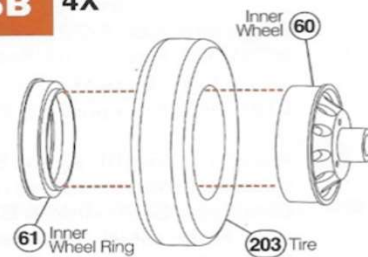

## 6C 4X

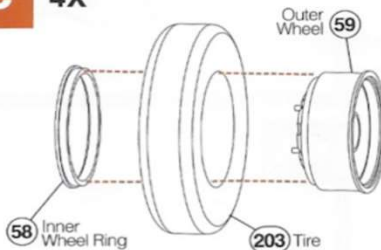

## 6D 4X

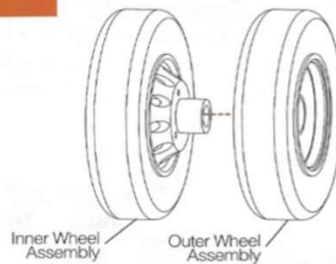

## 6E

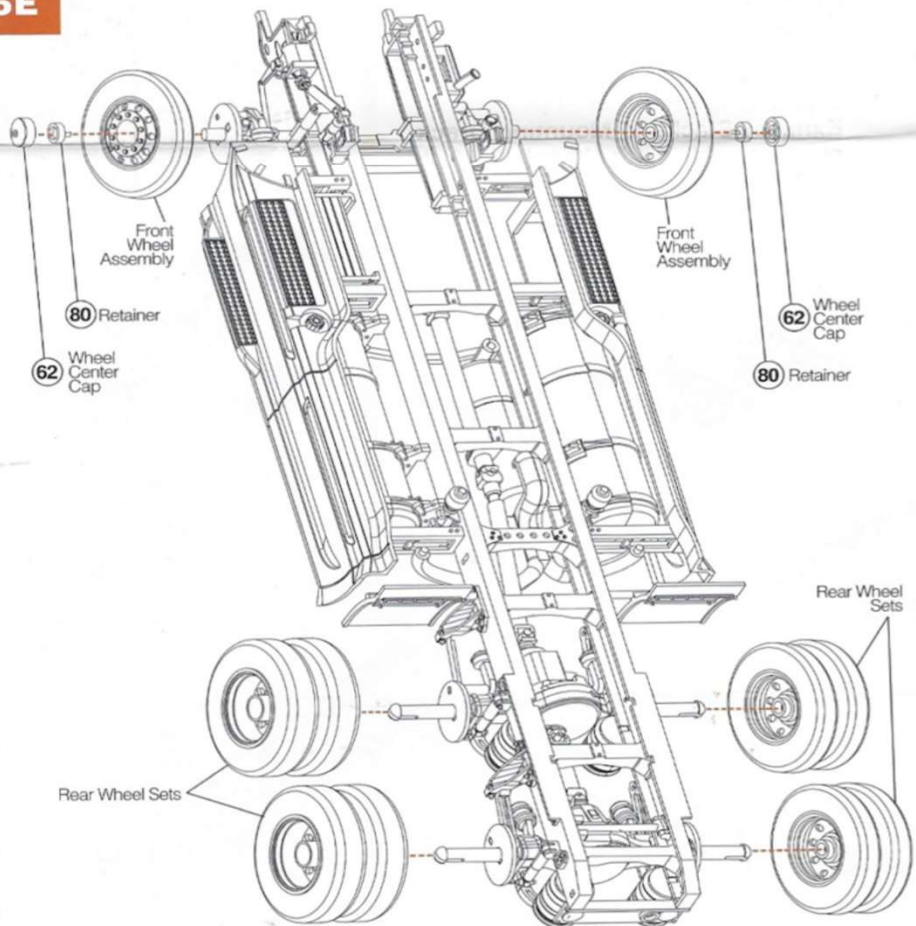



# 7

## ENGINE INSTALL & MORE

**A** Carefully spread the front **Frame Rails** and slide the completed **Engine and Radiator Package** into place, making sure that the **Engine Exhaust Pipe** fits into the **Muffler**, that the **Main Drive Shaft** fits into the **Transmission** and that the **Radiator** fits down into the locator slots in the front of the **Frame**, then cement the **Engine Assembly** in place. Cement the **Front Drive Axle Torque Link** (#167) and **Rear Drive Axle Torque Link** (#166) in place. Cement the **Mud Flaps Left** (#277) and **Right** (#278) and the **Splash Guards Left** (#249) and **Right** (#248) in place.

**B** Assemble **Left Exhaust Stack** (#227, #226 & #235) and **Right Exhaust Stack** (#225, #224 & #234); install the assembled **Exhaust Stacks** to the **Exhaust Stack Mounting Brackets**.

**C** Assemble the **Left Exhaust Stack Mounting Bracket** (#257 & #258) and the **Right Exhaust Stack Mounting Bracket** (#255 & #256).

**D** Install the **Exhaust Stack Mounting Brackets** to the **Frame Rail**; install the **Exhaust Stacks** to **Mounting Brackets**. Assemble **Fifth Wheel** (#109) to **Slider Plate** (#108) and cement the assembly in place on the **Frame**.

**E** Cement the **Front Bumper Bracket** (#270) to front of the **Radiator**. Place the **Front Bumper** (#244) on hinge pins and cement **Retainers** (#271) to **Bumper**. Take care to keep cement off hinge pins so that **Bumper** will move freely. Finish the **Front Bumper** by adding **Driving Lights** (#292).

### 7A

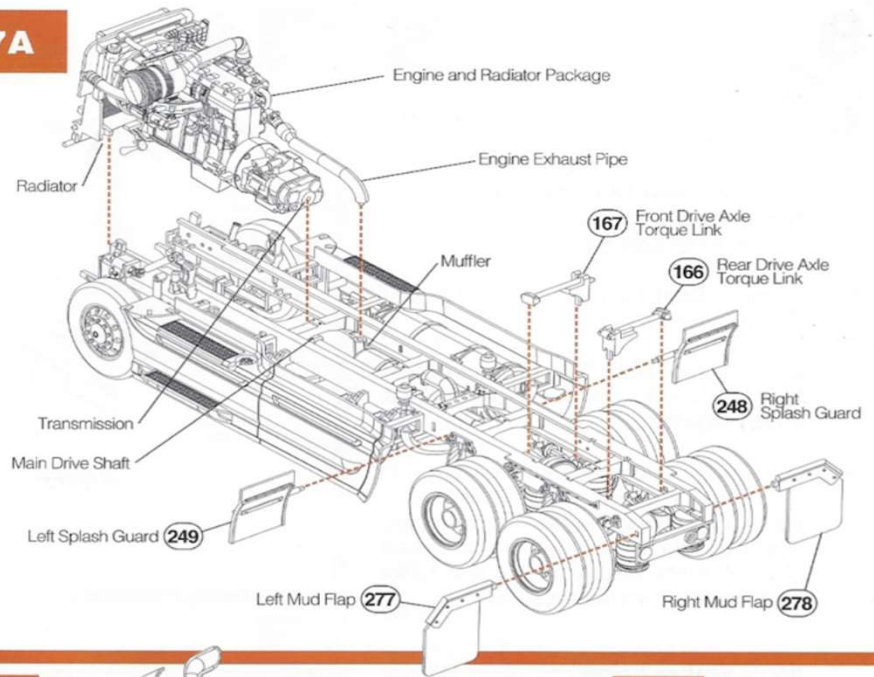

### 7B

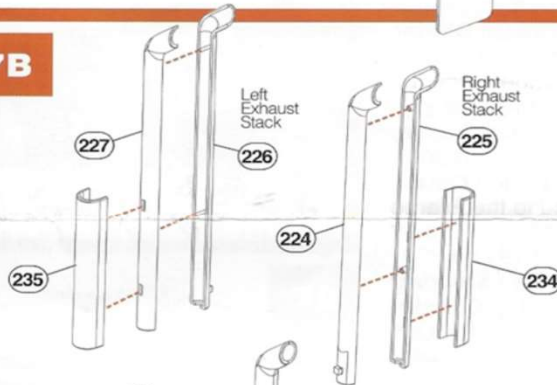

### 7C

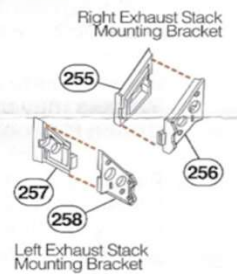

### 7D

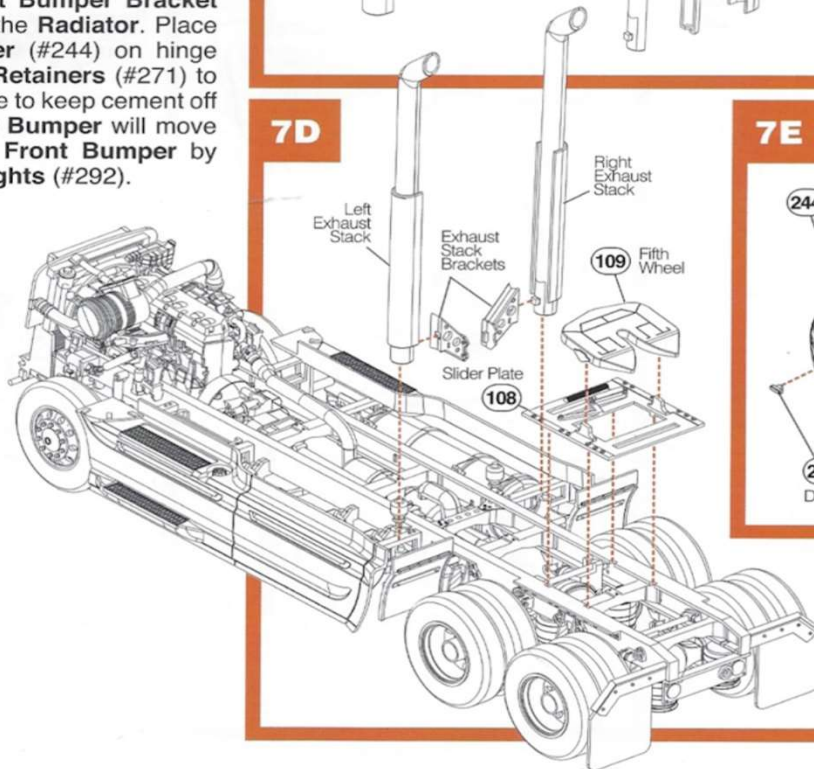

### 7E

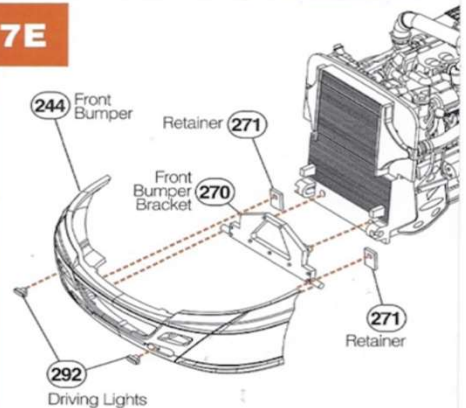

# 8

## CAB INTERIOR

- A** Cement the **Dash Assembly** (#92, #93, & #94) together.
- B** Cement **Right Side Cabinet** (#14) to **Right Wall** (#12) and **Left Side Cabinet** (#15) to **Left Wall** (#13).
- C** Cement **Seat Left** (#101 & #214) and **Right** (#100 & #213) together.
- D** Cement the **Seat Base Assemblies Left** (#102 & #103) and **Right** (#104 & #105) together.
- !** Determine a color scheme for the interior of the ProStar and paint the interior parts and sub-assemblies accordingly. Apply decals to the floor, the dash and cabinet fronts. See pages 14 and 15 for decal placement instructions.
- E** Decide if you want to use the conventional **Shifter Lever**. To install **Shifter Lever** (#268) open the hole for it in the **Floor** (#08). Assemble **Cab Interior** by cementing the **Dash Assembly** in place followed by the **Seat Bases, Seats** and the **Shifter Lever** (#266). Cement the **Couch** (#11) to the **Couch Base** (#16) and cement the completed **Couch** to **Floor** (#08).

- F** Finish by cementing the **Steering Wheel** (#114) and **Steering Column** (#115) in place, followed by the **Left and Right Walls** (#13 & #12). Take your time and make sure that everything fits together tightly.

### 8A

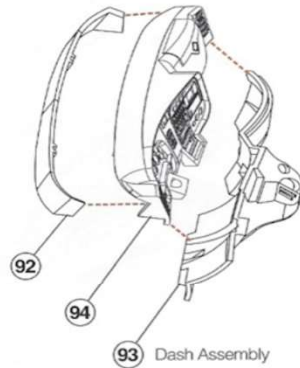

### 8B

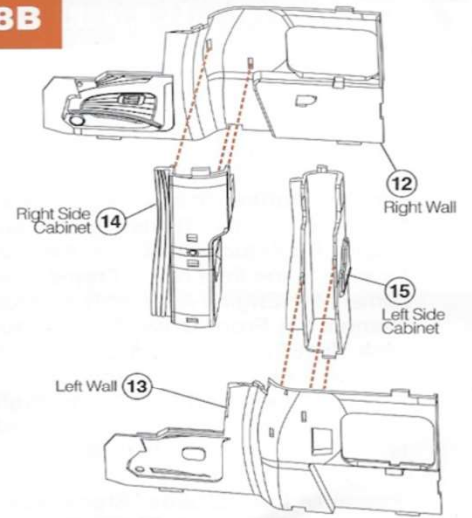

### 8C

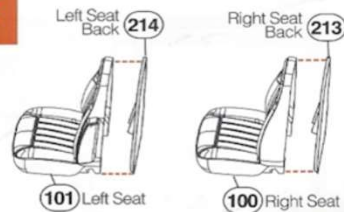

### 8D

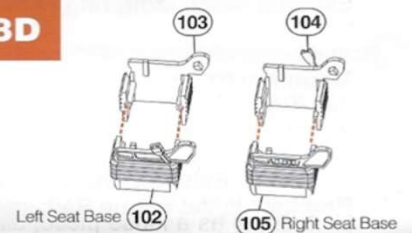

### 8E

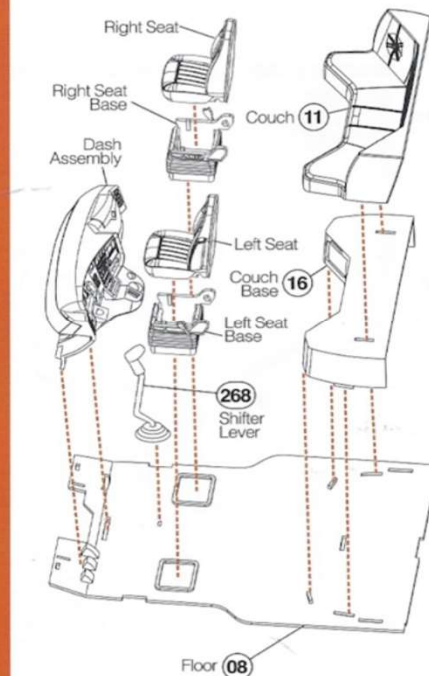

### 8F

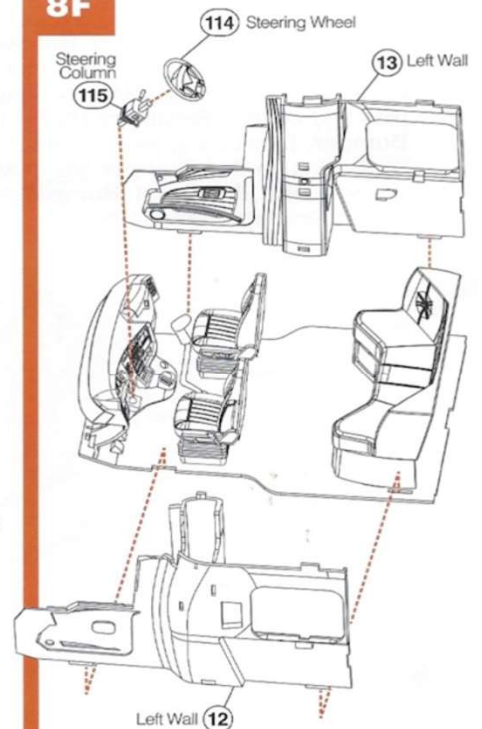



- G** Finish the **Cab Interior Assembly** by cementing the **Interior Ceiling** (#09), **Firewall** (#280) and **Back Wall** (#10) in place. Set the **Cab Interior Assembly** aside for now.

## 9 CAB EXTERIOR

- A** Cement **Cab Fairing Braces** (#83, #84 & #85) to **Cab Rear Wall** (#04); then cement the **Air Hose Slider Rail** (#187) in place. Set the **Rear Wall Assembly** aside for now.
- B** Cement **Sleeper Windows Left** (#189) and **Right** (#190) and **Vent Windows Left** (#191) and **Right** (#192) into the **Cab** (#217), then cement **Windshield** (#188) in place. **NOTE:** The windows cement into the inside of cab. Cement the four **Marker Lights** (#291) and the two upper **Cab Fairing Braces** (#82) in place.
- C** Slide the **Cab Interior Assembly** into **Cab Exterior** and cement it in place, followed by the **Rear Wall Assembly**. You may also add the optional **Roof Air Fairing** (#05) at this time. **NOTE:** Some builders prefer to leave the **Roof Air Fairing** as a loose piece, allowing the option to display with or without.

8G

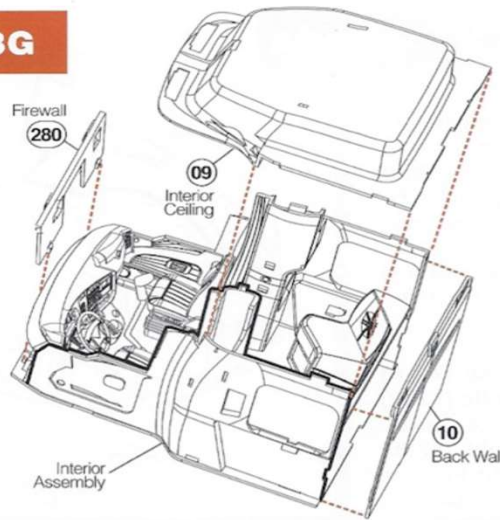

9A

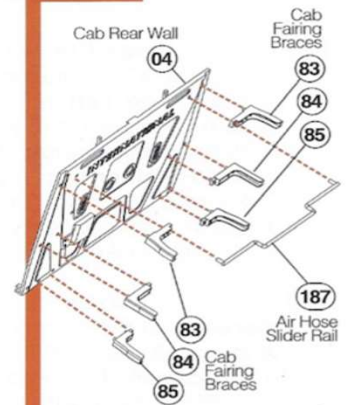

9B

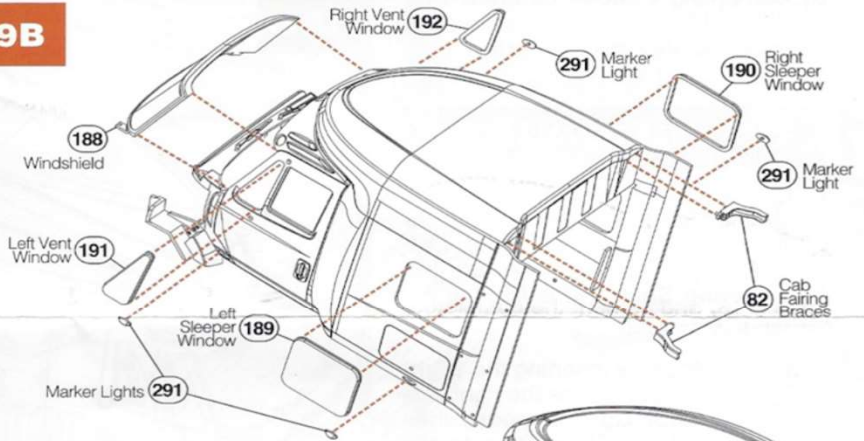

9C

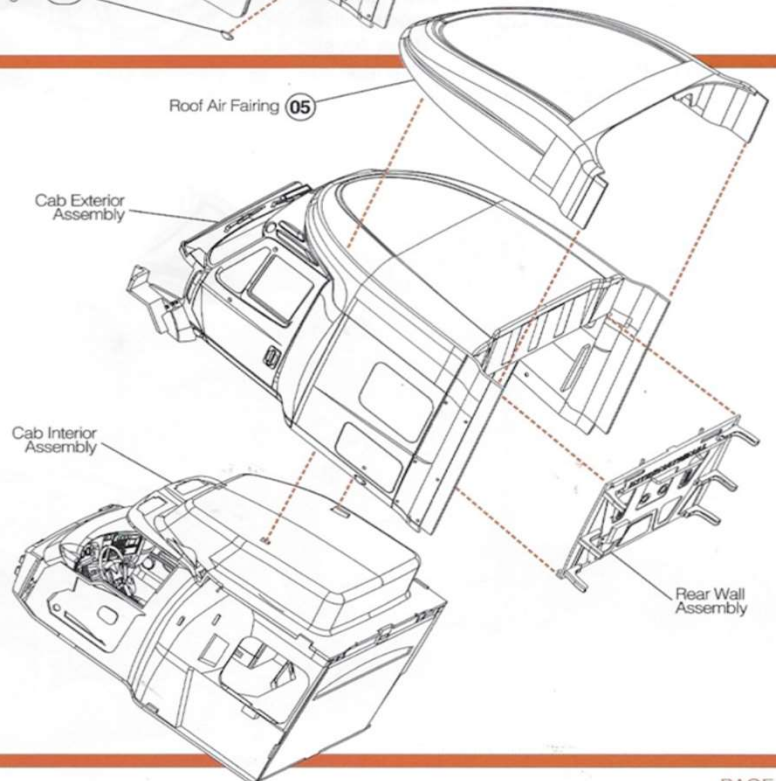

# 10 HOOD ASSEMBLY

**A** Cement **Hinge Brackets Left** (#286) and **Right** (#287) into the **Hood** (#243). Install **Hinge Left** (#259) and **Right** (#260) by slipping the top pin into the corresponding **Hinge Bracket** and gluing **Retainer Cap** (#285) in place. Take care that glue does not get into hinge so that hinges pivot freely in the mounting brackets.

**B** Glue the photo-etched **Stone Guard Screen** into the chrome **Grille** (#242) and install the **Grille** in the **Hood**. Then cement **Left Headlight** (#228) and **Right Headlight** (#229) into the front fenders and add clear **Covers Right** (#289) and **Left** (#290). Finish by cementing **Fender Latches Left** (#283) and **Right** (#284) in place. Set **Hood Assembly** aside for now.

## 10A

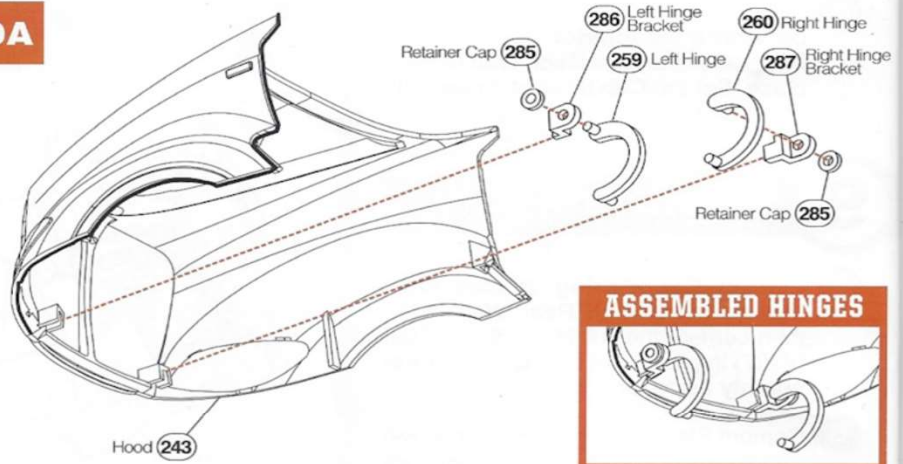

# 11 CAB & HOOD INSTALLATION

**A** Install the **Cab** to the **Chassis** by cementing the **Floor** to the four **Cab Mounts** on the **Frame**; make sure that the **Steering Shaft Pin** is fitted to the hole in the **Firewall**.

**B** Install the **Hood** by inserting the **Right Hinge Pin** into the slot on the right side of the **Radiator Core Support**; then gently spread the **Hinge Pins** to slip the **Left Pin** into the slot on the left side of the **Radiator Core Support**.

## 11A-B

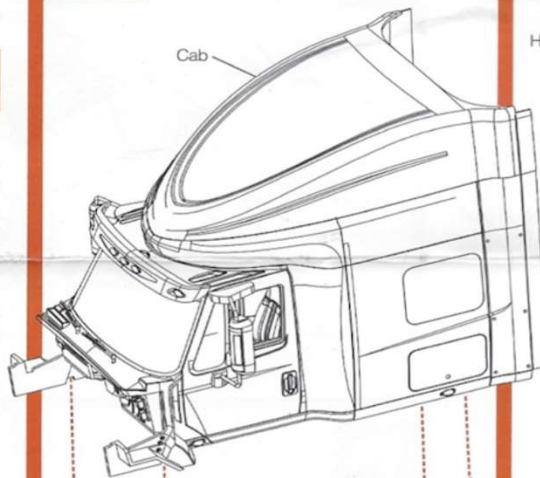

## 10B

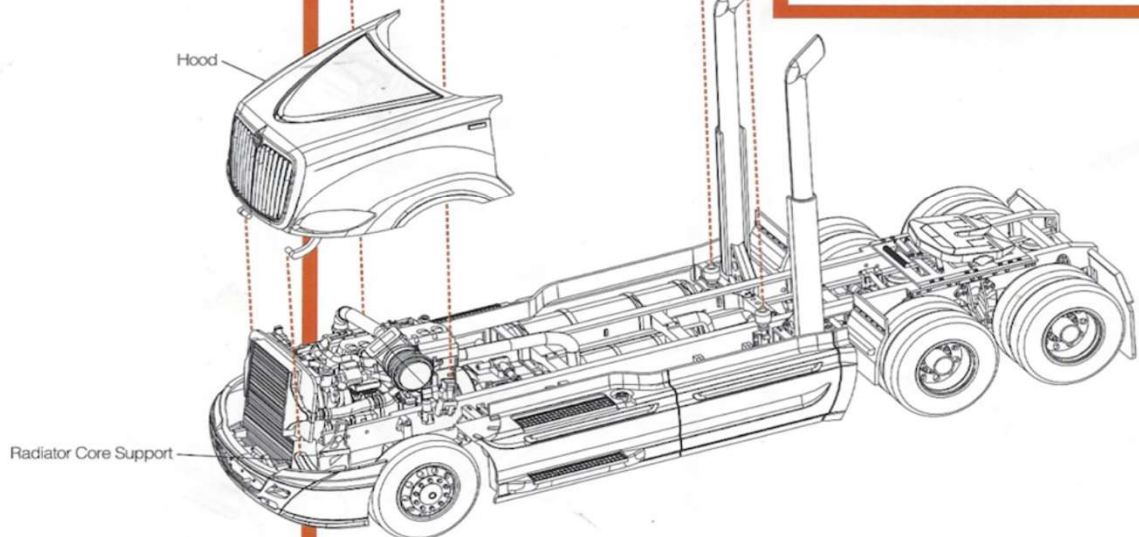
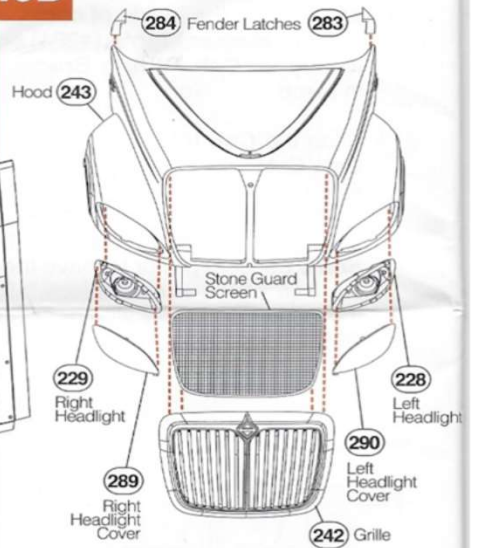



Assemble **Left Mirror** (#220, #223 & #95) and **Right Mirror** (#221, #222 & #96); install assembled **Mirrors** on **Cab**. Add **Small Lenses** (#202) to the **Sun Shade** (#219) and cement in place. Finish by installing **Windshield Wiper Left** (#90) and **Right** (#91).

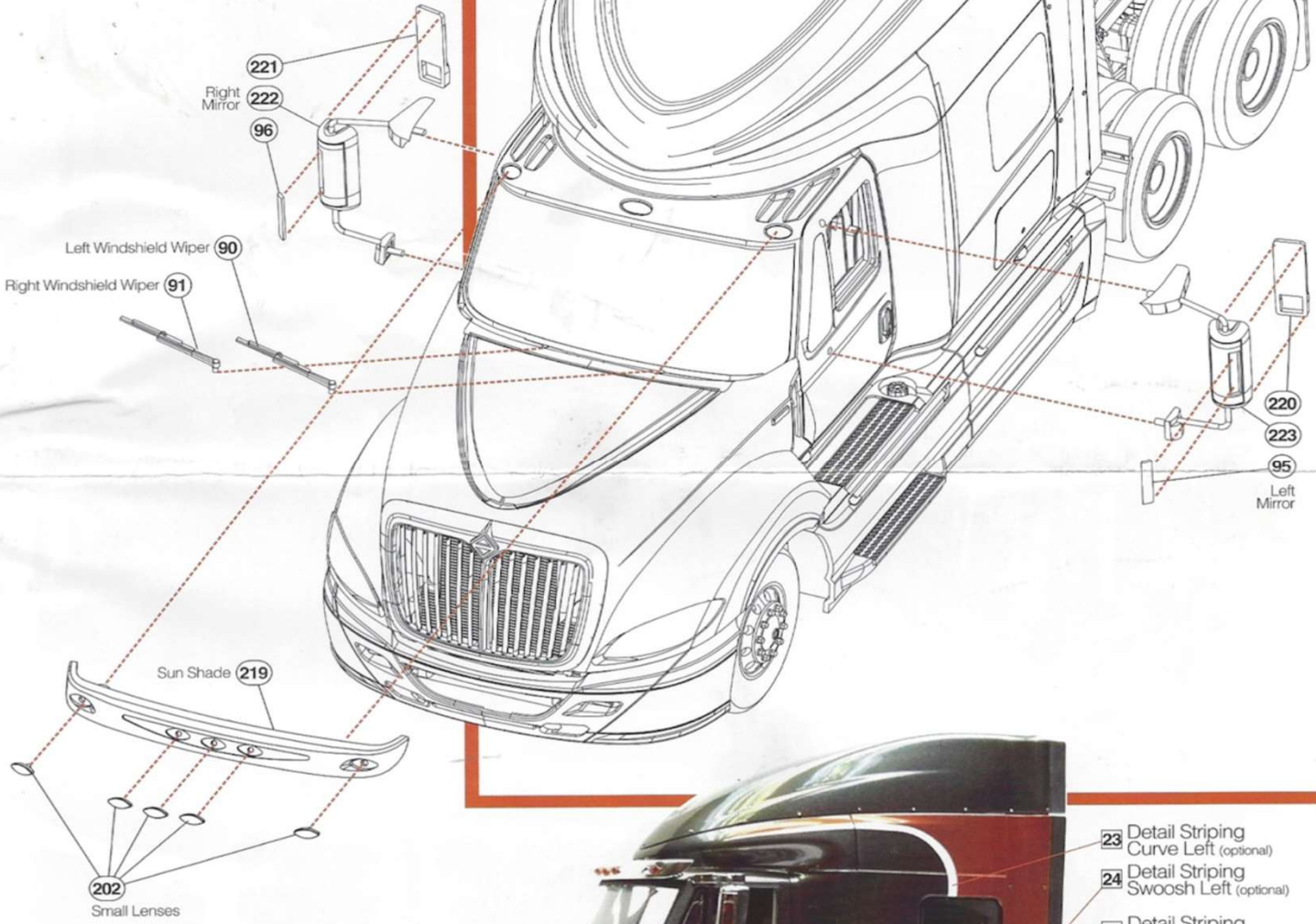

This custom build-up features a copper and charcoal gray paint scheme, highlighted by the included optional curve and swoosh decals.



- 23 Detail Striping Curve Left (optional)
- 24 Detail Striping Swoosh Left (optional)
- 25 Detail Striping Curve Right (optional)
- 26 Detail Striping Swoosh Right (optional)

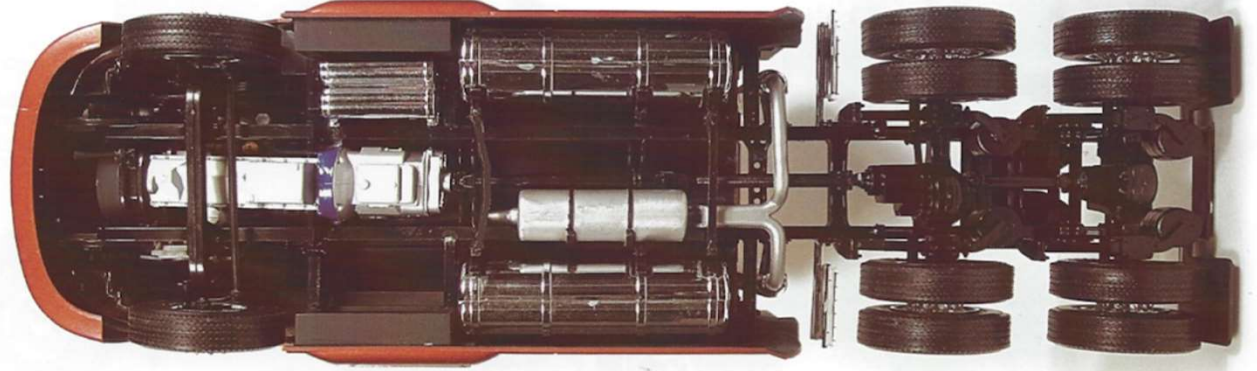
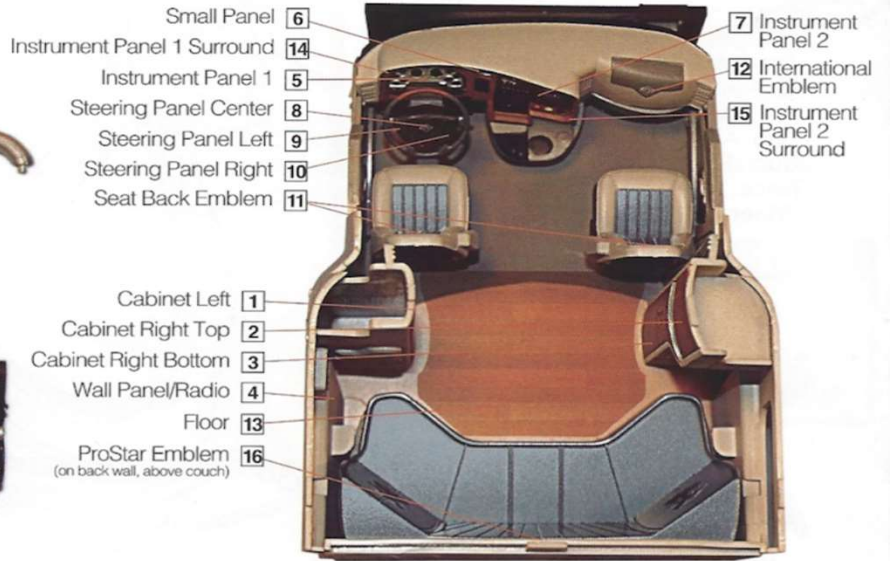
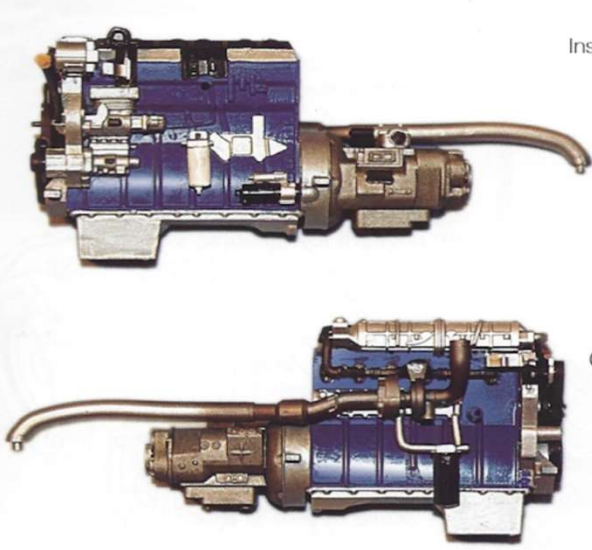





International 17  
(on opposite side)



International Emblem 18

ProStar Emblem 19



ProStar Eagle + 20  
(on both sides)

21 MaxxForce  
(on both sides)

17 International  
(on both sides)



NaviStar 22  
(optional, on both sides)

## ABOUT THOSE EXTRA PARTS

Note that this kit includes extra parts not called for in the instructions. The methodology used in manufacturing our line of truck kits results in the inclusion of extra parts that may not be required to complete a specific kit. Also note there are a few very small parts that we have intentionally supplied duplicates of, in case of breakage or loss.

### PARTS NOT NEEDED FOR THE PROSTAR

2x #68, 2x #75, #81, #98, #99, #110, #113, #135, #139, #142, #156, #157, #160, #164, #193, #197, #197, #198, #199, #200, #201.

### EXTRA PARTS

Extra parts furnished intentionally as spares because they are small and easily lost:

2x #202, 2x #271, 2x #285, 2x #291, 4x #292.



[www.moebiusmodels.com](http://www.moebiusmodels.com)

Moebius Models, 5515 Moreno St., Montclair, CA 91763.  
ProStar, Navistar and International are trademarks licensed by International Truck Intellectual Property Company.  
©2019 Moebius Models. All rights reserved. Made and printed in China.