

Revell F-14A TOM CAT

4712-3800 -A



CEMENT
KLEBSTOFF
COLLE
PLASTIC LIJM
CEMENT
CEMENTO (COLLANTE)
PEGAR



NO CEMENT REQUIRED
NICHT KLEBEN
NE PAS COLLER
NIET PLAKKEN
SKALL INTE KLISTRAS
NON INCOLLARE
NO REQUIERE PEGAMENTO



DO IT THIS MANY TIMES
ANZAHL DER ARBEITZGANGE
LE FAIRE CE NOMBRE DE FOIS
DOE HET ZOVEEL KEER
GJOR DET SA MANGA GANGER
FATELO TUTTE QUESTA VOLTE
HAGALO ESTA CANTIDAD DE VECES



OPTIONAL
WAHLWEISE
FACULTATIF
NAAR KEUZE
VALFRI
FACOLTATIVO
OPCIONAL

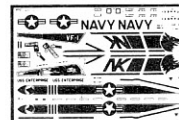

APPLY DECALS
ABZIEHBILDER ANHEFTEN
COLLER LES DECALOMANIES
BRENG PLAKPLAATJES AAN
SATT PA DEKALERNA
APPLICARE LE DECALOMANIE (ADESIVI)
APLICAR CALCAS

18

CLEAR
KLAR
TRANSPARENT
DOORZICHTIG
KLART
VIA LEBERA
TRANSPARENTE



SHOWN IN PLACE
IN DER RICHTIGEN POSITION ABGEBILDET
REPRESENTE EN POSITION
OP DE JUISTE PLAATS AFGEBEELD
VISAD PA PLATS
MOSTRATO IN POSIZIONE
COLOCAR EN LUGAR

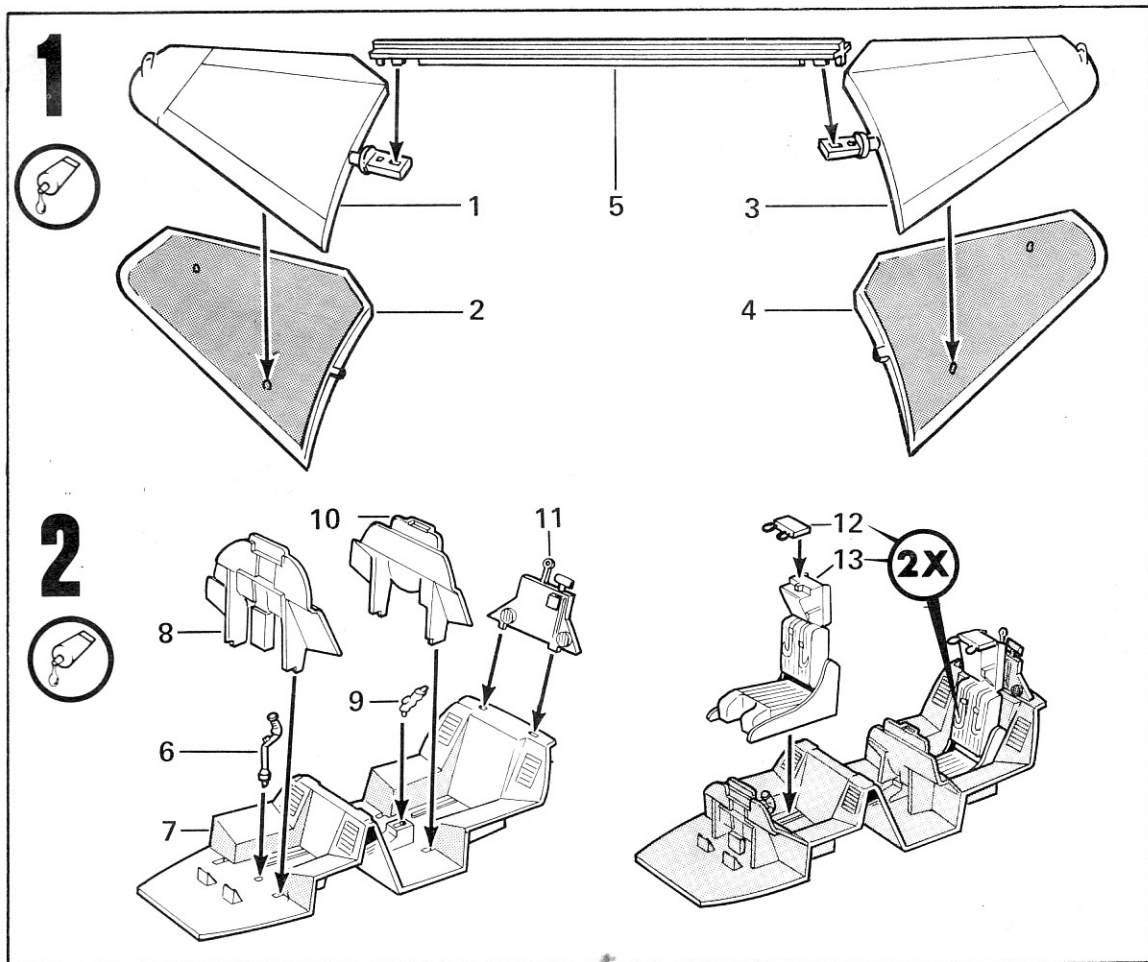

3



A

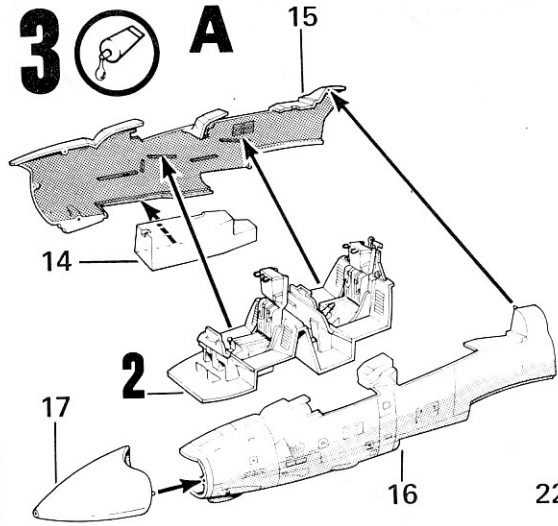

B

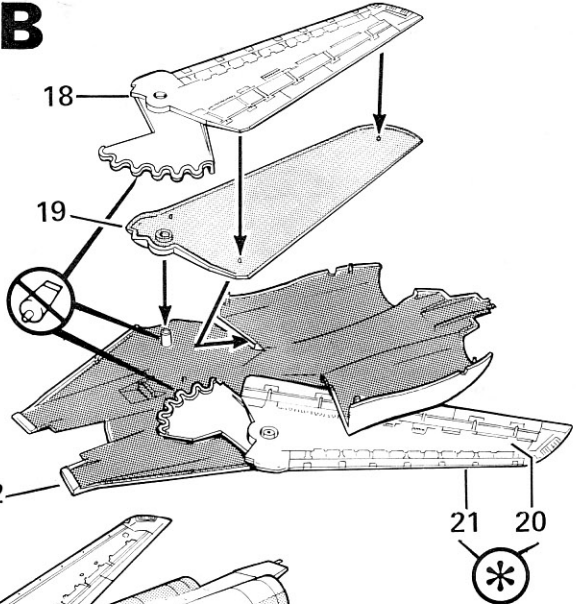

4



3B

3A

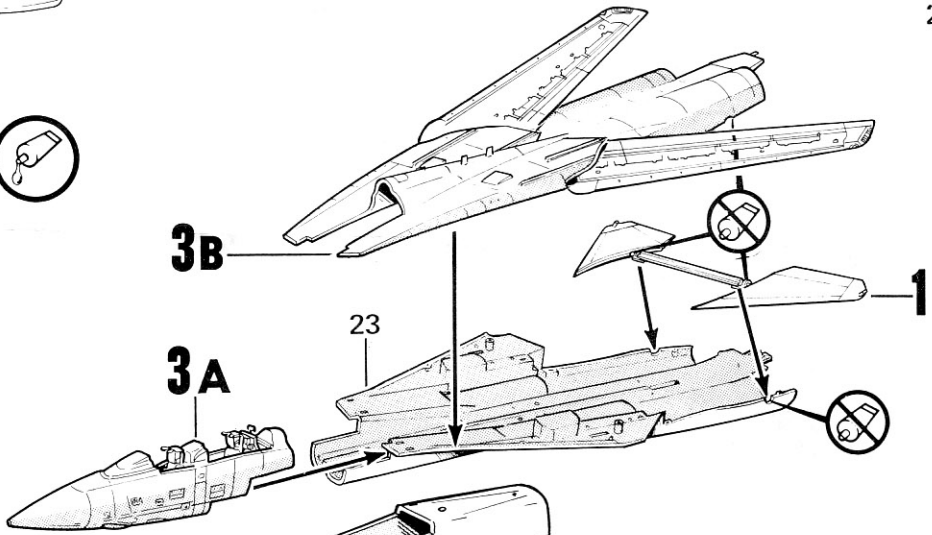

5

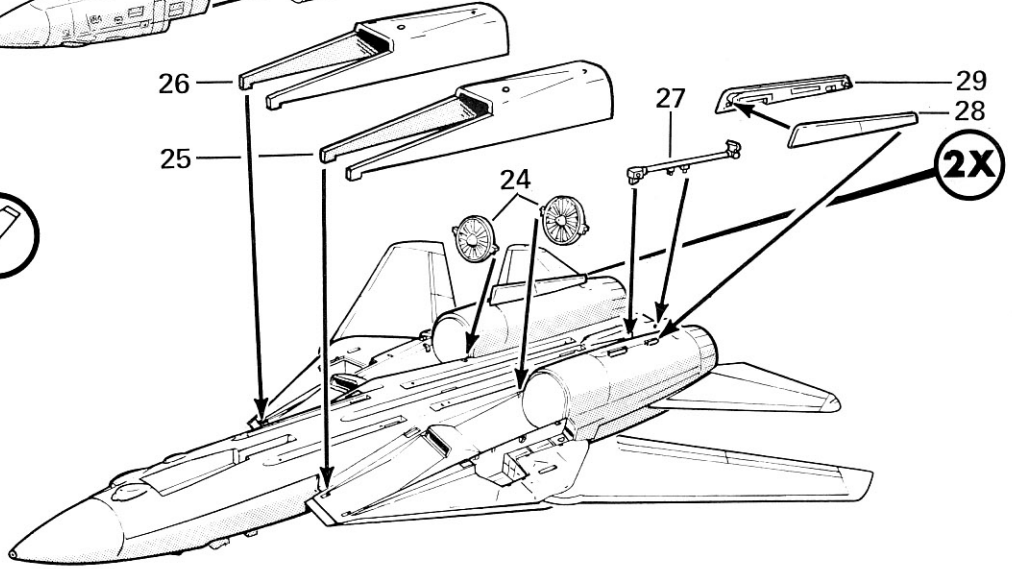



Matt Black
Matt Schwarz
Noir Mat
Mat Zwart
Matt Svart
Negro Mate
Nero Smorto

White
Weiss
Blanc
Wit
Vit
Blanco
Bianco

Matt Eggshell
Matt Eierschale
Couleur Coquille Mat
Mat Eischaal
Matt Aggskal
Cascara de Huevo Mate
Guscio D'Vovo Smorto

Red
Rot
Rouge
Rood
Röd
Rojo
Rosso

Light Grey
Blassgrau
Gris Pâle
Vaalgrijs
Ljusgrå
Gris Palido
Grigio Chiaro

Matt Steel Grey
Matt Stahlgrau
Gris d'Acier Mat
Mat Staalgrijs
Stålgrå
Gris Acero Mate
Grigio Acciaio Smorto

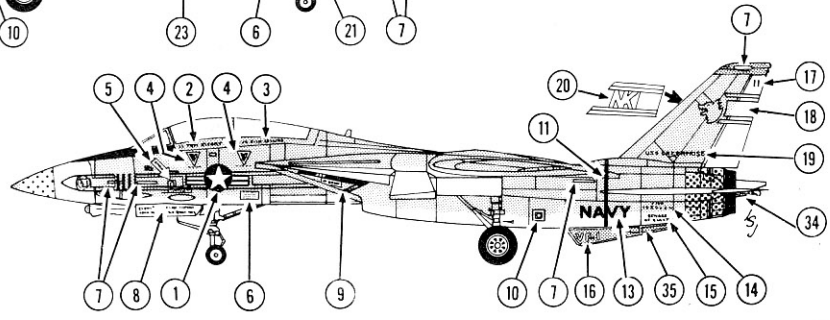
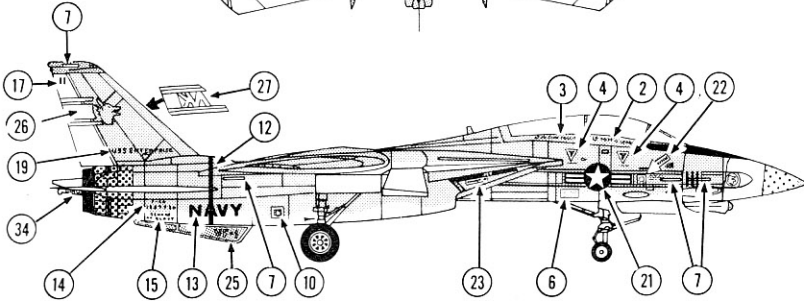
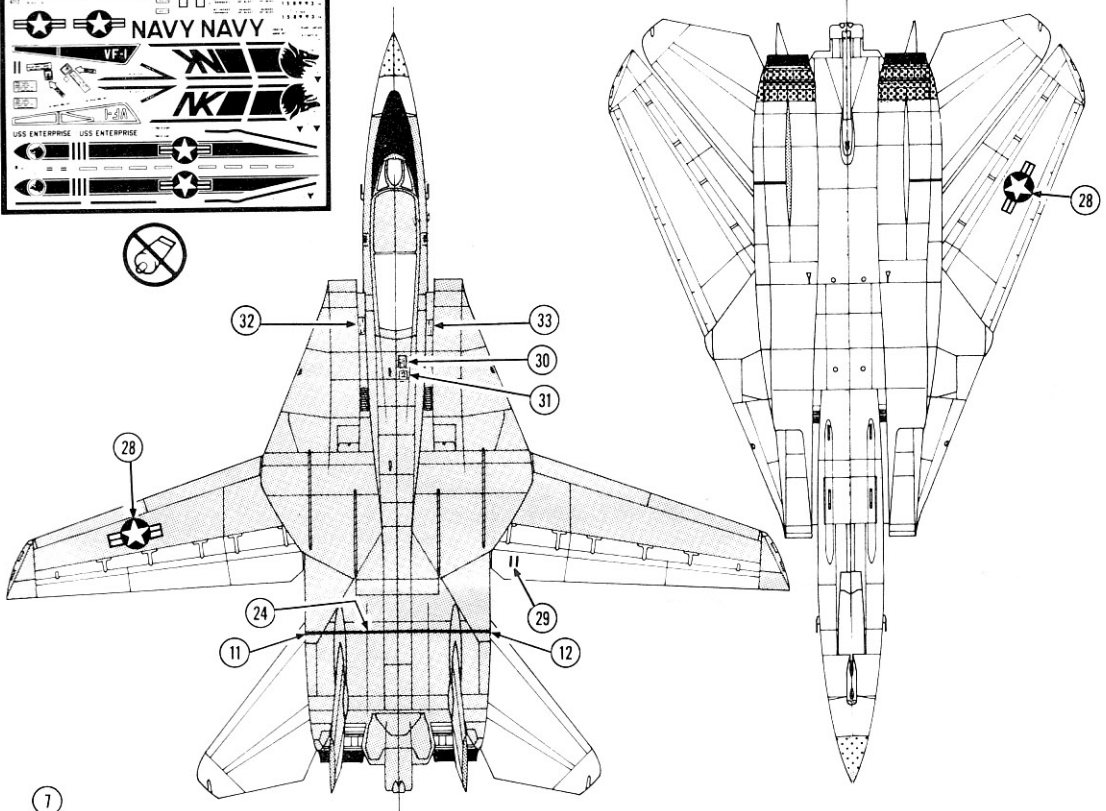
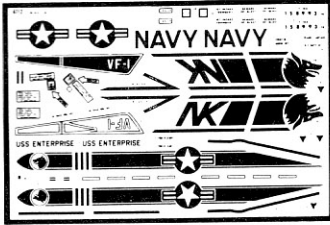

6

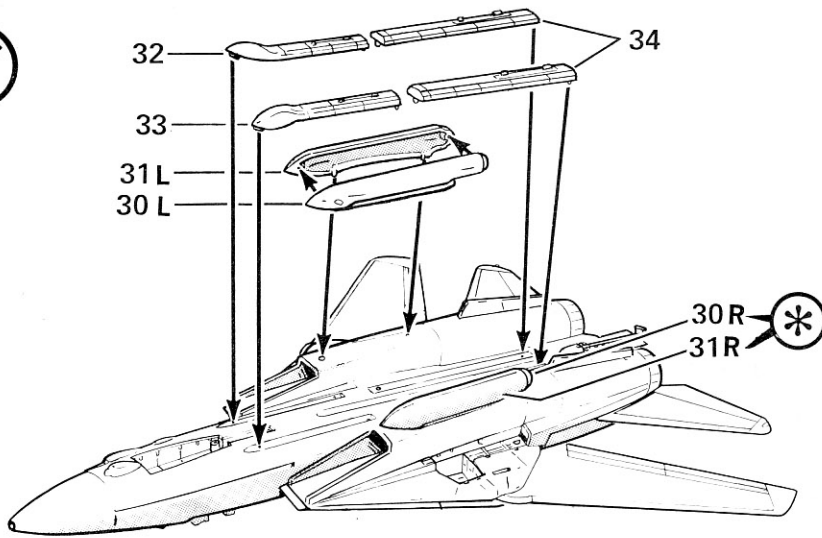
7

8

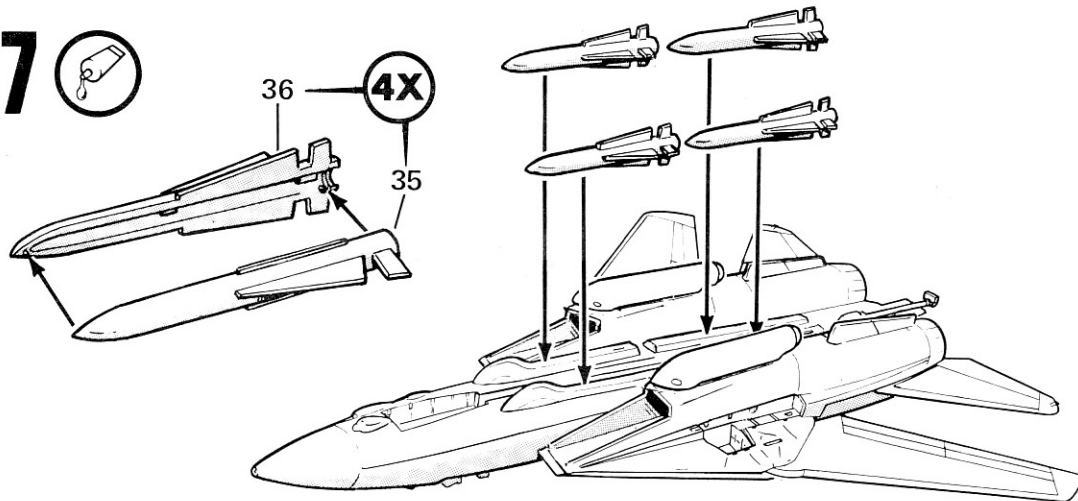
9

10

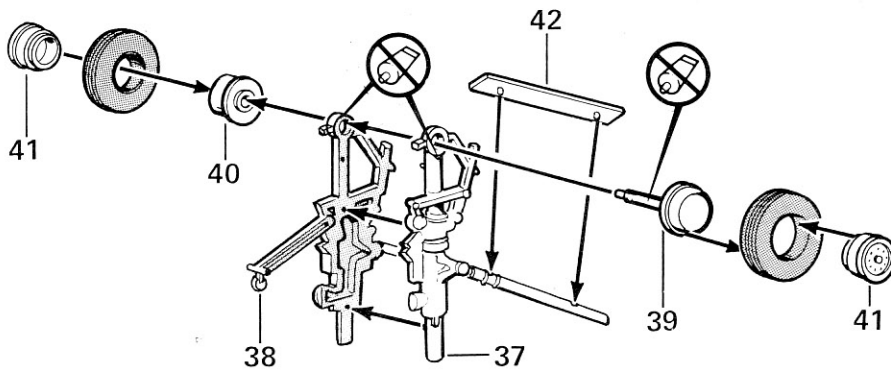
11

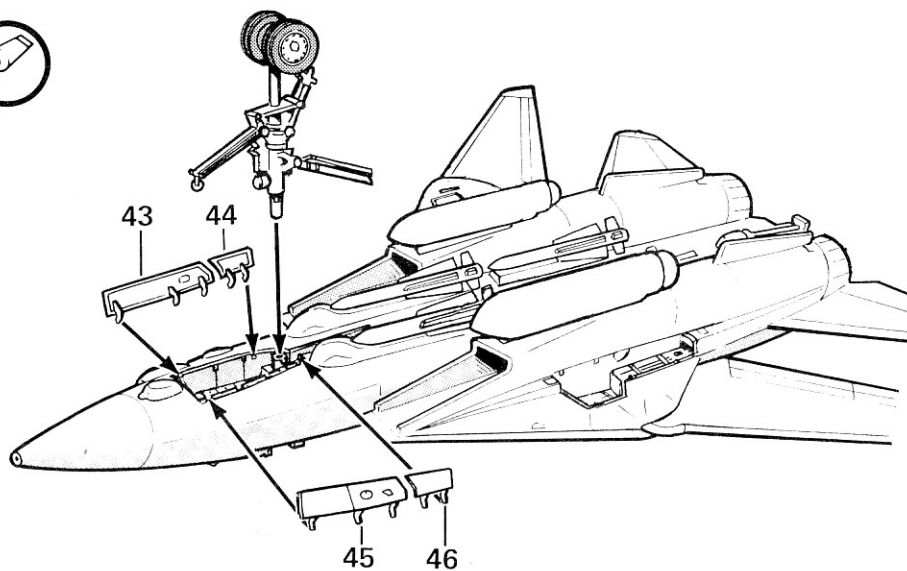
12

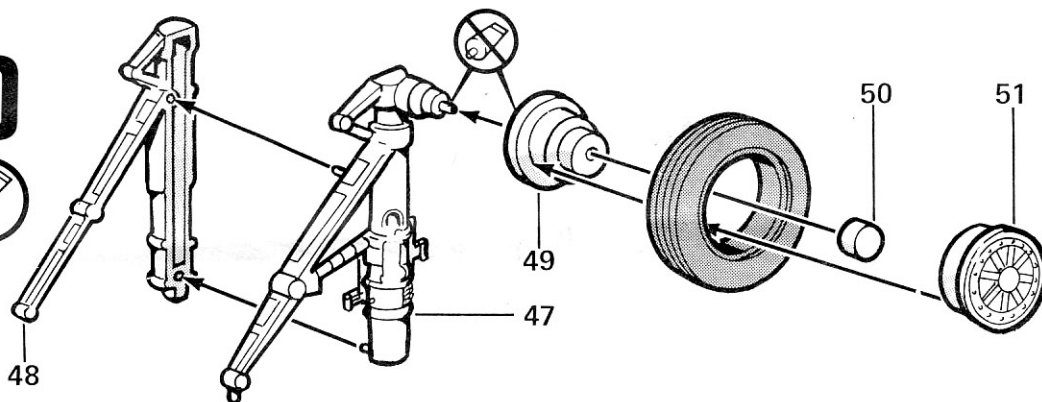

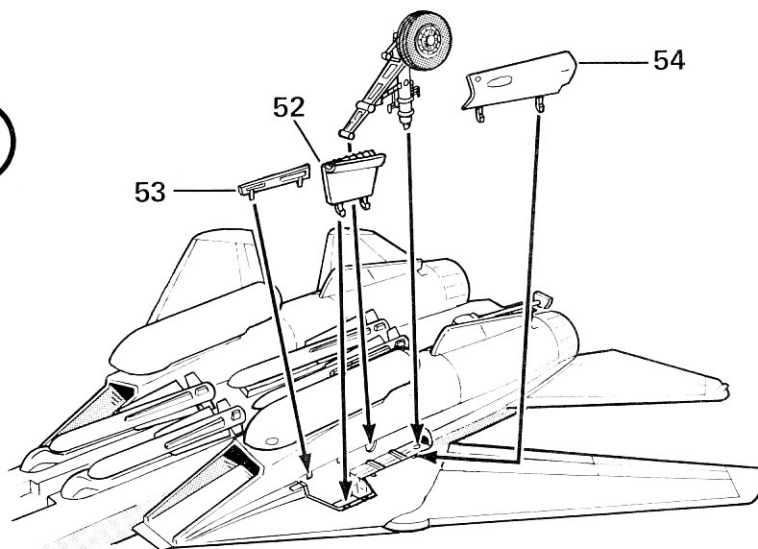
13

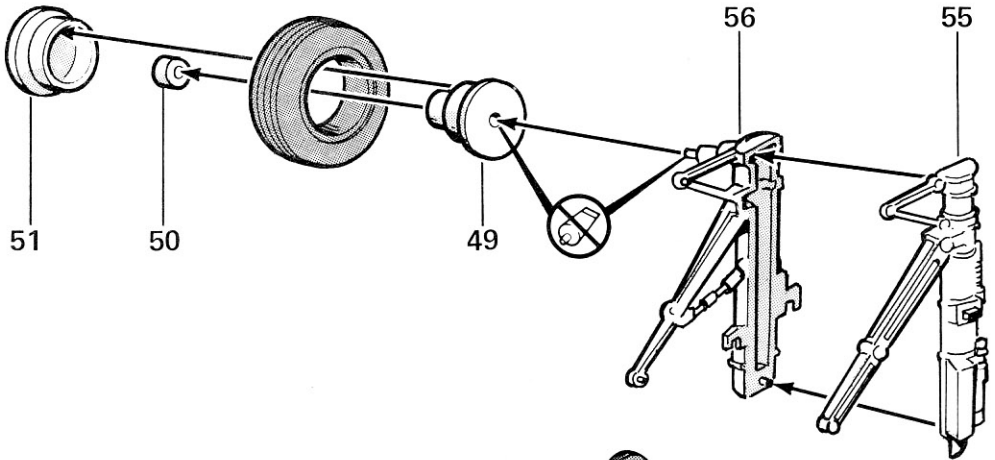

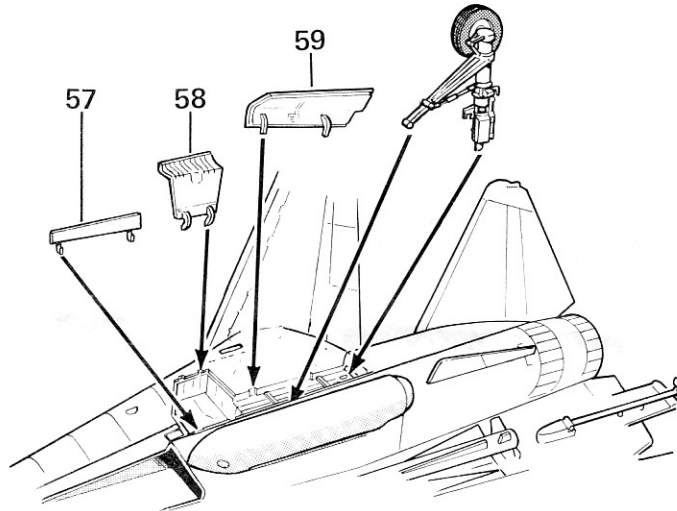
14

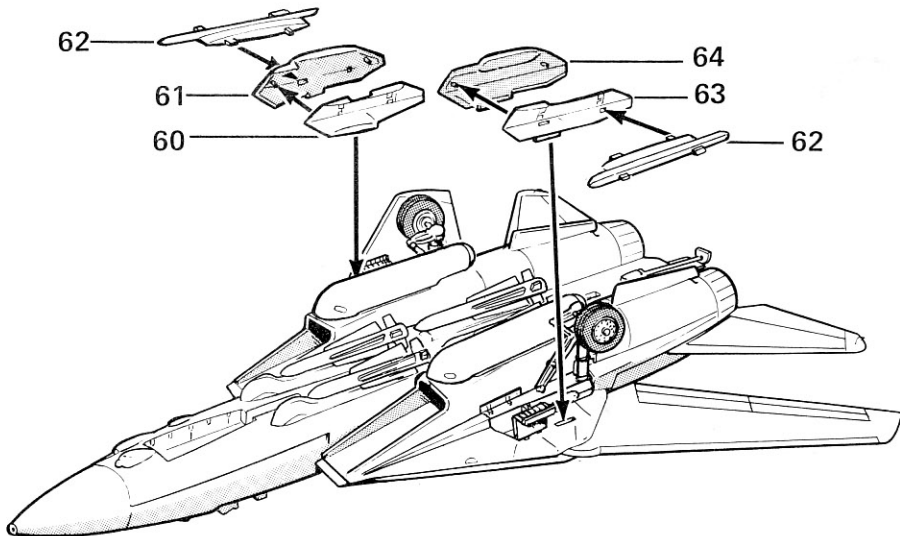

15

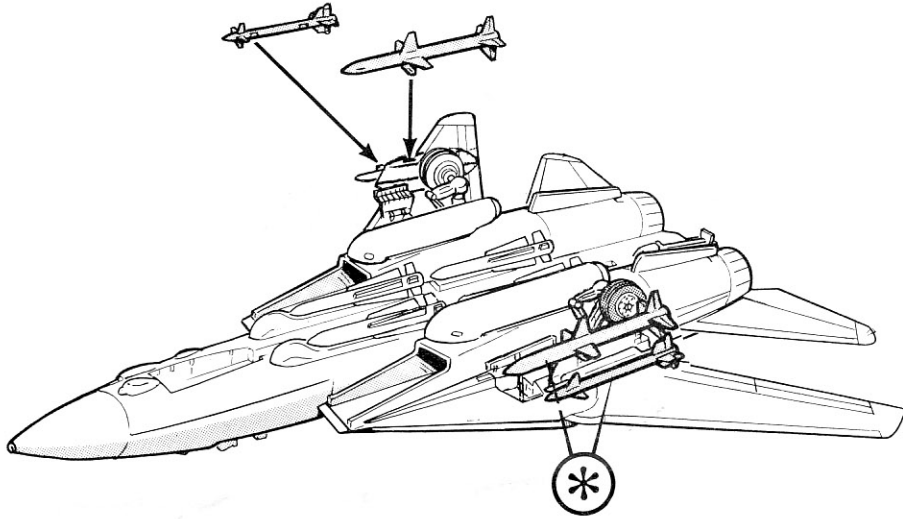
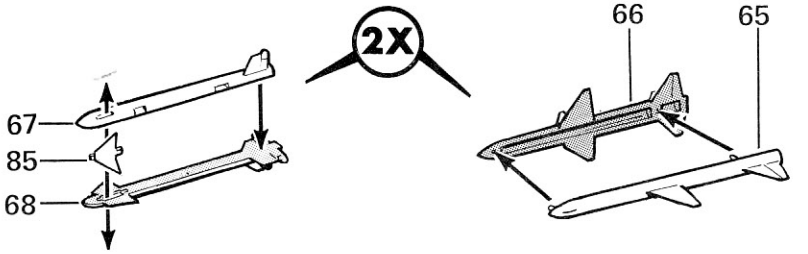

16

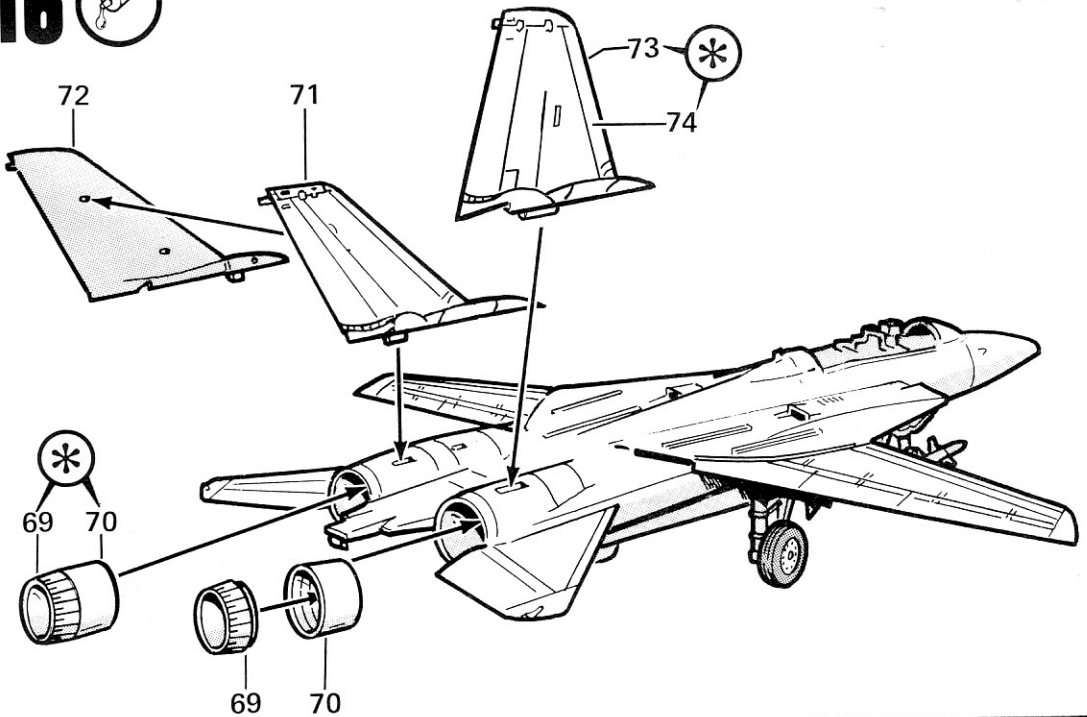

17



(A) (?) (B)

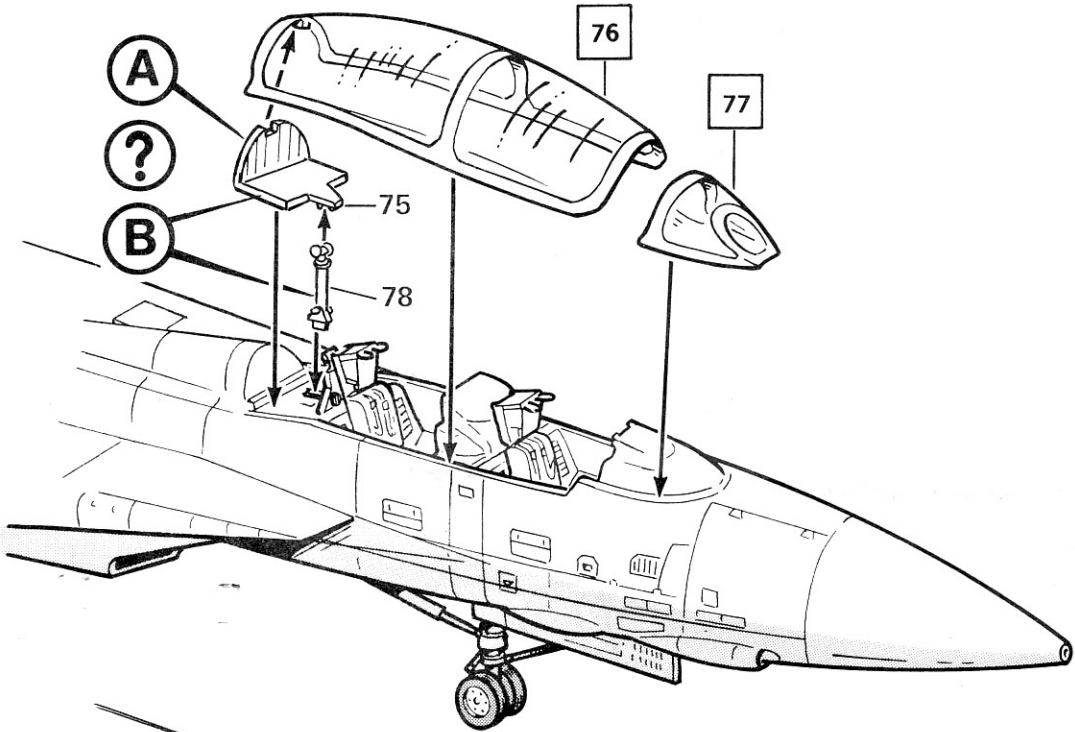
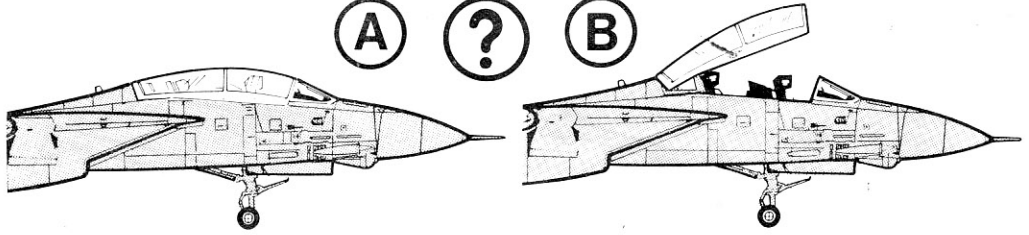

18

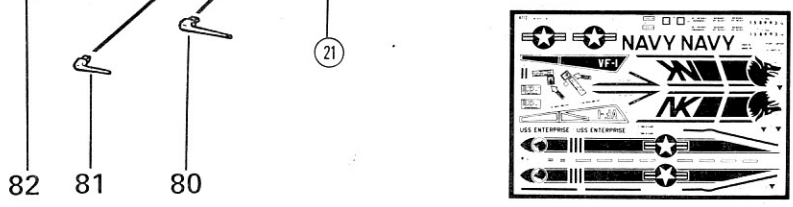
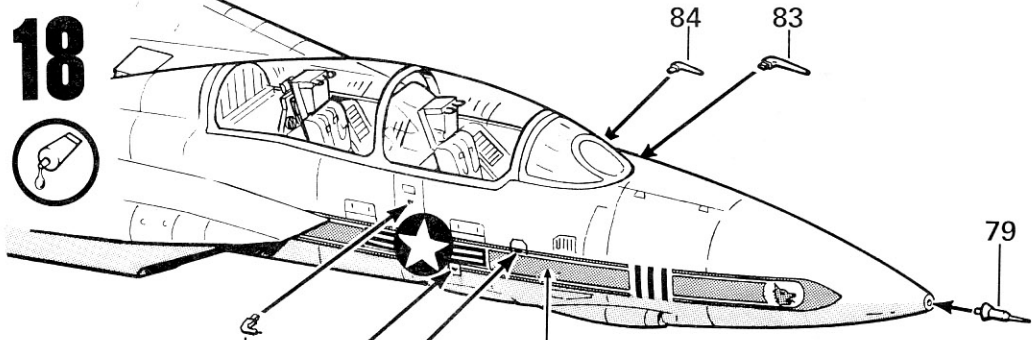

10 DANGER



10



32 JET INTAKE DANGER →

BEWARE OF BLAST

BEWARE OF BLAST

F-14A
15 8993 70

34 DANGER

33 JET INTAKE → DANGER

BEWARE OF BLAST

BEWARE OF BLAST

F-14A
14 15 8993 70



28



NAVY NAVY

13

EVENT #: _____ PLANE CAPTAIN
GROSS WT. _____ H.F. RAYE AE-3
8



25



29

PUSH BUTTON TO OPEN DOOR TO AIRCRAFT CANNOPY TO LOCATE EMERGENCY ESCAPE SYSTEM



5



WARNING: THIS AIRCRAFT CONTAINS A PROTECTIVE ACTUATED EMERGENCY ESCAPE SYSTEM EQUIPPED WITH EXPLOSIVE CHARGES. SEE MANUAL OF INSTRUCTIONS FOR COMPLETE INSTRUCTIONS.

WARNING: THIS AIRCRAFT CONTAINS A PROTECTIVE ACTUATED EMERGENCY ESCAPE SYSTEM EQUIPPED WITH EXPLOSIVE CHARGES. SEE MANUAL OF INSTRUCTIONS FOR COMPLETE INSTRUCTIONS.

LTJG RICH ROLLINS



35



USS ENTERPRISE

19

USS ENTERPRISE

LT TOM O'LEARY

LT TOM O'LEARY

2

1

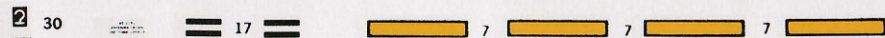

30

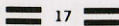

17

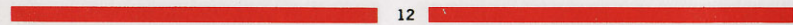

12

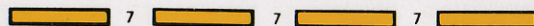

7

7

7

7

7

24

21



20

INTAKE

23

DANGER

JET

JET

DANGER

INTAKE

9

16

27

26

4

EJECTION SEAT

18

4



EJECTION SEAT

4



EJECTION SEAT