

Ventura

1/72nd
Scale

Supermarine Spitfire Mk XI

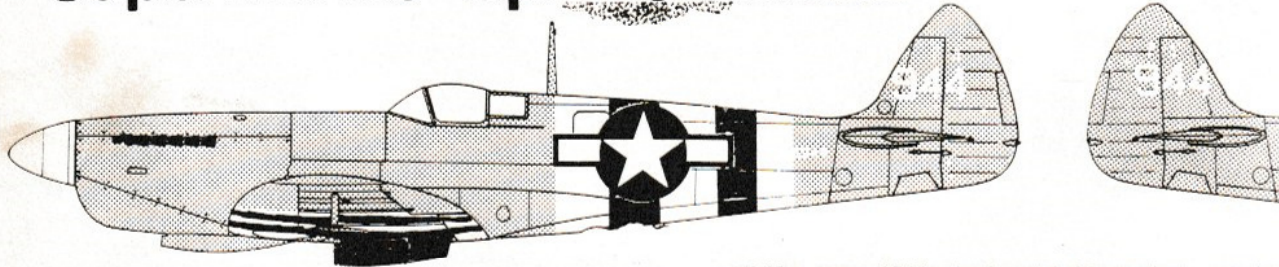

The Spitfire PR Mk XI (Supermarine types 374 and 365) was by far the most produced Merlin engined photographic reconnaissance Spitfire. As soon as the Mk 7 fighter, with 60 series Merlin had been developed the RAF requested a PR version. An initial pre-production batch of Mk XI's were produced by converting Mk IX's at No 1 PRU at Benson.

The first true production aircraft (type 374) were manufactured on the Mk IX production line and had fixed tail wheels and early round style rudders.

The great majority of Mk XI's were built to type 365 standard as depicted in this Ventura Kit with retractable tail wheel and broad cord rudder. Also the Merlin 70 engine was used,

while type 374's had used 60 series, engines. Although the "70" had slightly less power (1475 hp) it was more economical, and had a higher altitude rating, all important for PR missions.

This Ventura Kit includes two sets of markings ; for PL 883 of 4 squadron 35 PR wing, 2 TAF, RAF, in October 1944 and PA 944 of 14 photo squadron 7th Photographic Reconnaissance Wing 8th Airforce June 1944.

REFERENCES

Supermarine Spitfire, Peter Moss, Dicimus Books Ltd
Spitfire at War: 2 , Alfred Price, Ian Allan Ltd
Spitfire; The History, Eric B. Morgan and Edward Shacklady, key Publishing Ltd.

Painting Guide

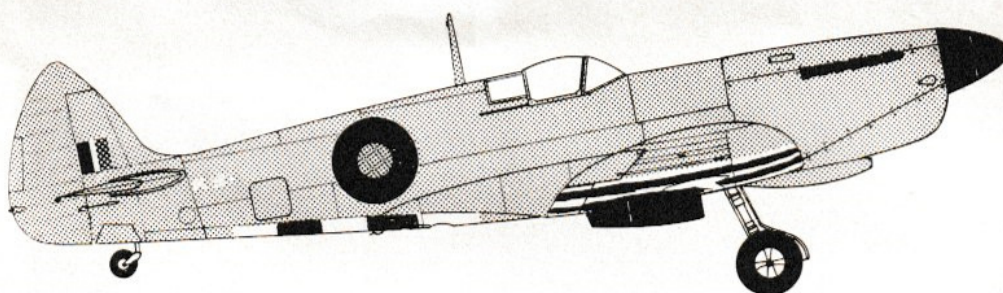

PA944 USAAF.

PA944 is in the standard RAF scheme of over-all PRU Blue. It has a white spinner and is drawn here with roughly painted invasion stripes still in their Complete D-Day form. A good photograph of PA944 appears on page 62 of Spitfire at War:2.

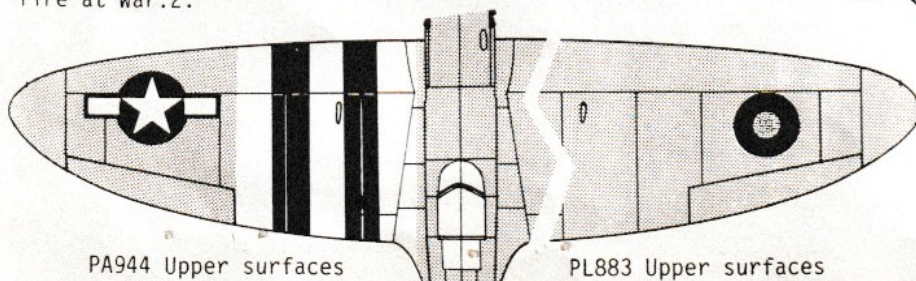

PA944 Upper surfaces

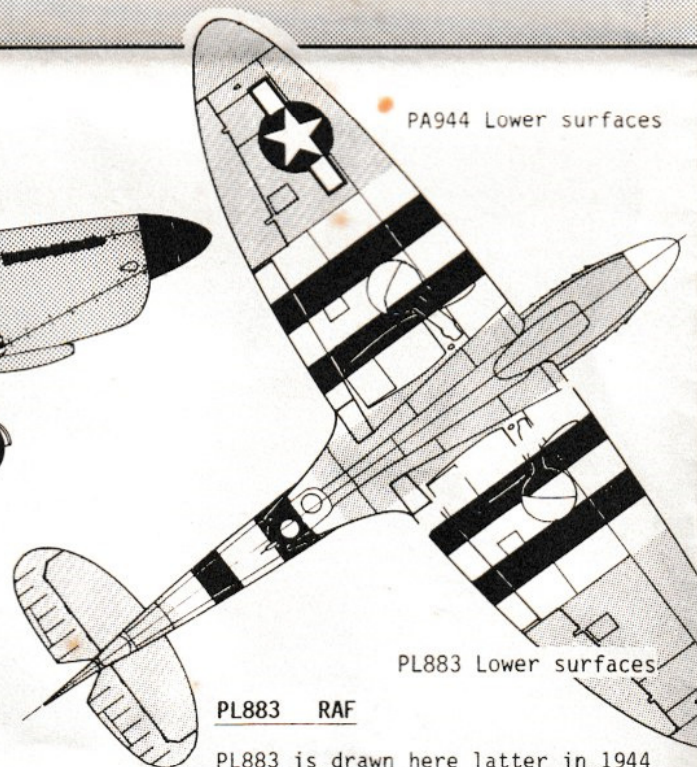

PA944 Lower surfaces

PL883 RAF

PL883 Lower surfaces

PL883 is drawn here latter in 1944 than PA944. It also has the over-all PRU Blue scheme (with a black spinner) but only has invasion stripes on lower wing and fuselage.

Note that while the kit decal sheet includes white serials, both aircraft should, more correctly, have very light grey serials which are available on Ventura decal sheet V7253.

Assembly Guide

- Wash all parts in soapy water to remove mould release agent.
- Saw parts from their sprues and clean up with a modelling knife. **We strongly recommend the modeller use a knife rather than a file to trim away excess sprue endings.**
- Some small parts (eg. radio aerials, tail wheel doors.) must be provided from the spares box.
- Two canopies are provided in case of accidents during assembly.
- Use epoxy glue whenever joining plastic to white metal.
- **The key to success with this and all VENTURA kits is careful parts preparation before cementing, rather than using quantities of filler afterwards!**

Note: This kit contains a minimum of white metal parts due to possible American legislation which will outlaw lead in toys in that country.

Produced by:
Ventura Hobby Products
 P.O. Box 10-213
WELLINGTON
NEW ZEALAND

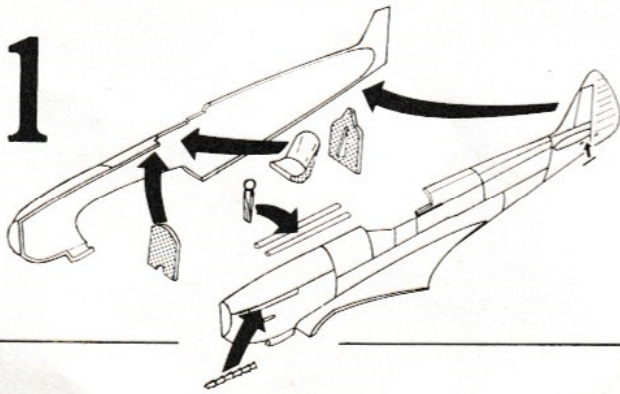

- Add extra detail as required to cockpit. eg. side consuls. Resin parts produced by Cooper Details of the U.S.A. are recommended for superdetail enthusiasts.
- Add cockpit bulkhead from plastic card using the templates below.
- Thin down cockpit walls until the bulkhead and instrument panel fit snugly.
- Add thin plastic rods to simulate rudder actuating bars.



- Detail the interior of the radiators using plastic card and the fine mesh provided.
- Carefully trim away excess plastic and cement the wing underside to the fuselage **then** trim the underside's tips and trailing edges to achieve a perfect fit with the upper surfaces.
- Two sets of wheels are included with the kit, PL883 uses the spoked wheels and PA944 those with plain disk covers.

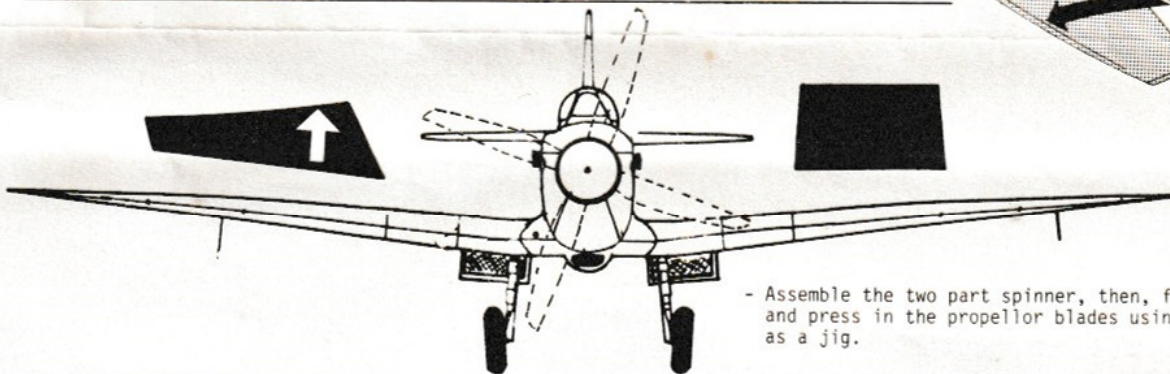
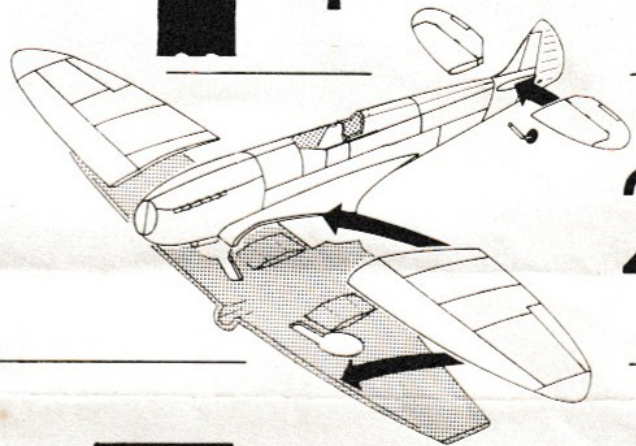

- Assemble the two part spinner, then, fill with modelling epoxy and press in the propeller blades using the front view above as a jig.

Also Available Spitfire HF Mk. VII

1:72 scale

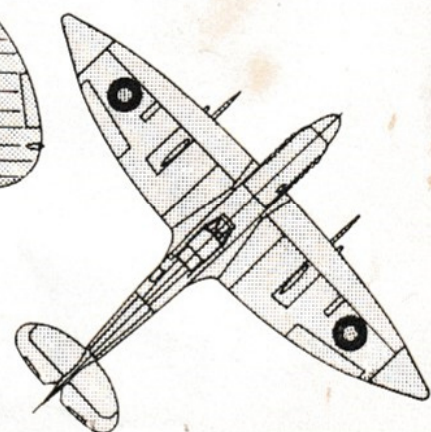
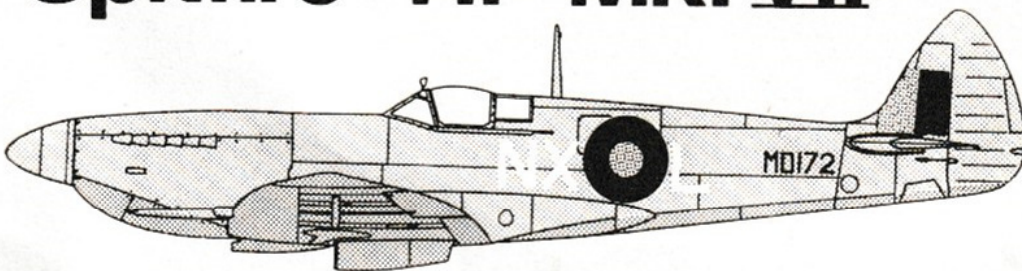

Ventura

Only 1200 of this "short run" injection moulded kit have been produced. It depicts the rare Mk VII Spitfire with its pointed blower intake. The kit includes plastic parts, metal accessories, decals for a 131 Squadron machine, detail drawings of the pressure canopy and intake and two vac-formed canopies.