



THE FORD PICKUP SERIES

1971 RANGER

 1/25 Scale Plastic Model Kit • Skill Level 3 Ages 15 & Up **XLT**

IMPORTANT - READ THIS FIRST

Before assembling model, **study pictures carefully**. These instructions include detailed drawings and images of an actual build-up for reference. You can also refer to photos on the packaging. In addition, you will find the following tips helpful:

- This model kit is molded of styrene plastic – **use only styrene-compatible glues or cements**.
- Apply cement to the **inside surfaces only**; avoid getting cement on outer surfaces of model sections.
- **Use cement sparingly** and **avoid getting cement on hands**, so as not to mar or smear plastic surfaces.
- **Do not hurry**; work carefully and patiently.
- Before cementing, **it is advisable to assemble parts dry** (without cement) so that you may familiarize yourself with parts and fit, **noting points where cement is to be applied**.
- For best results assemble model **in the order indicated**.

PAINTING YOUR KIT

- **Use paint that is made for use on plastic**. If you are unsure, test paint on scrap pieces of sprue before applying it to kit parts.
- This kit is designed to be built in **sub-assemblies**. We would suggest that **it is best to paint each sub-assembly separately** before final assembly of the kit.

- In certain cases it may be a good idea to paint some **parts during assembly**. For example, it will be easiest to paint and decal the assembled dash and the seats before cementing them in place on the floor, which can also be painted before assembly.

DECAL APPLICATION

Decals have been provided to ensure the utmost detail and authenticity. It may also be easiest to **apply decals to sub-assemblies**. Apply decals only after paint is **completely dry**.

1. **Dip the decal in water for 10 seconds**. For best results, mix one drop of common dish washing detergent per cup of lukewarm water.
2. Place the wet decal face up on a paper towel and **wait 30-60 seconds** until the decal is **movable on paper backing**.
3. **Wet the area of the model** where decal will be applied.
4. Hold the decal face up, in position on model and **slide backing away** from under it.
5. Once positioned correctly, **gently smooth out decal** and **absorb excess water** with a paper towel, cotton swab or clean, soft paintbrush.
6. **Let decals dry completely** before applying any sort of dull coat or gloss coat to decal area, if desired.

KEY TO PARTS

① Plastic Part ① Decal

1

CHASSIS

1A

A Cement **Front Cross Member** (#66) into the **Frame**. Install the **Motor Mounts Left** (#64) and **Right** (#65) to the **Front Cross Member** (#66). Cement the **Steering Box** (#42) to left side of **Frame**. Cement the **Left Twin I-Beam Axle** (#70) and **Right Twin I-Beam Axle** (#71) to the **Frame** (#137) and the **Front Cross Member** (#66).

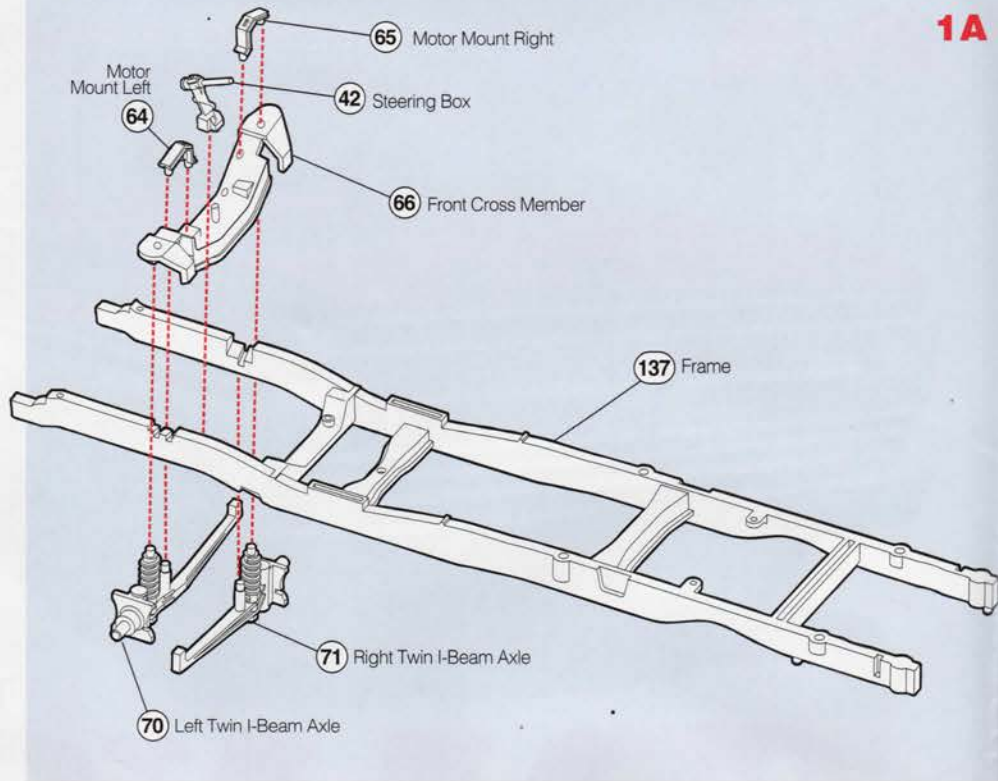

B Cement the **Right Radius Arm** (#34) to the **Frame** and **Right Twin I-Beam Axle** (#71).

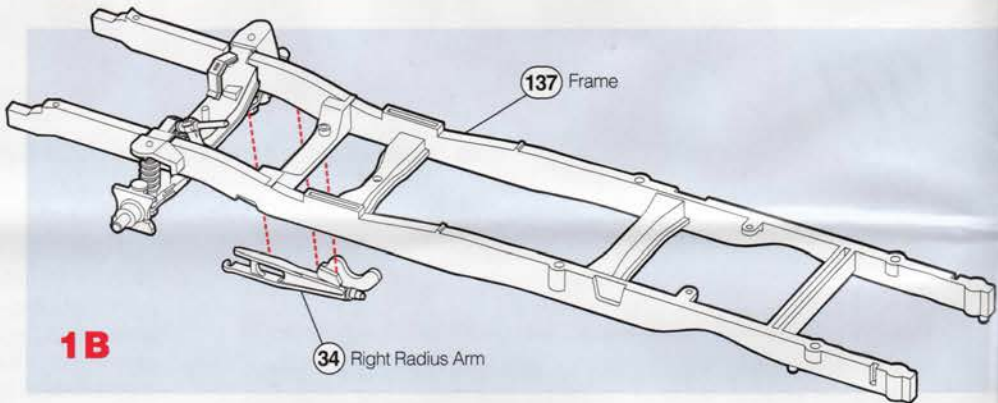

C Thread **Tie Rod** (#63) through hole in the **Right Radius Arm** (#34). Then thread **Left Radius Arm** (#33) over the **Tie Rod** (#63) and cement **Left Radius Arm** (#33) in place on **Frame** (#137). Cement ends of **Tie Rod** (#63) in place on ends of **Twin I-Beam Axles** (#70 & #71).

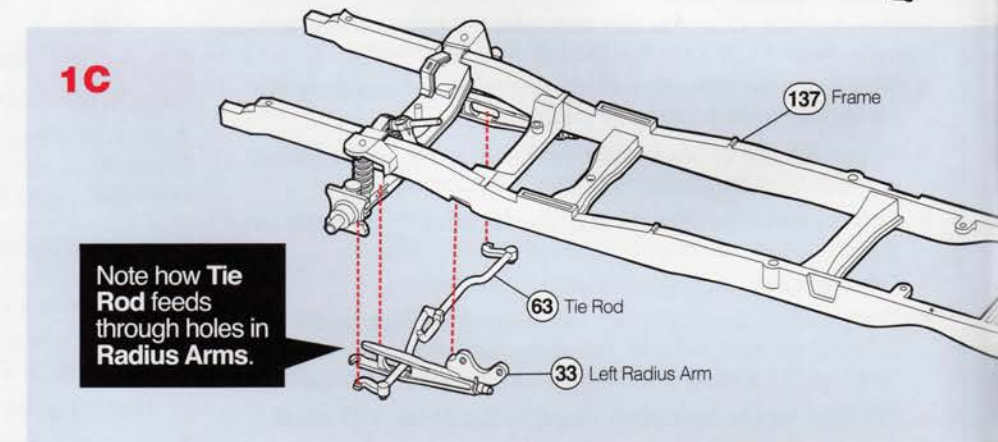

D Add **Sway Bar** (#39) and **Links** (#38) to the **Frame** and **Front Axle Assembly**.

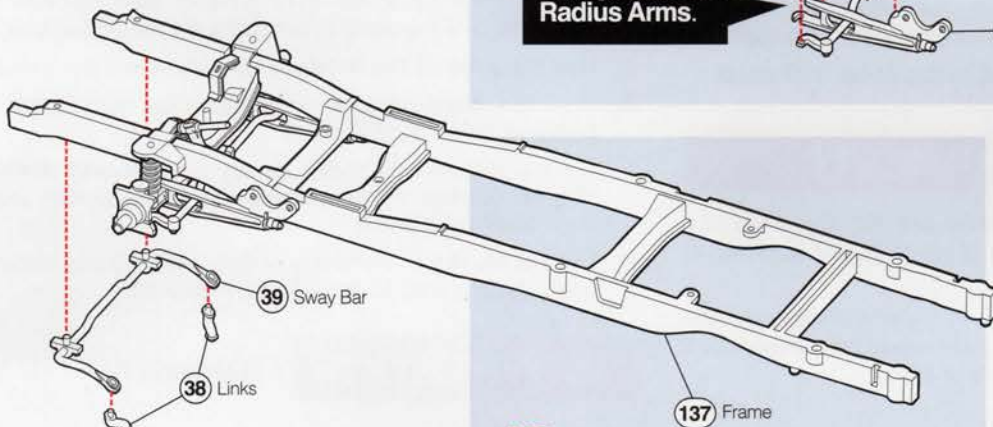

E Cement the **Rear Axle Halves** (#53 & #54) together and add the **Differential Center Section** (#58). Set this assembly aside for now.



1D

F Cement **Left Rear Spring** (#50) and **Right Rear Spring** (#51) to **Frame** (#137).

G Cement **Exhaust Pipe** (#139) to the **Frame** (#137).

H Install the **Rear Axle Assembly** and add the **Rear Shock Absorbers** (#52).

I Push **Spare Wheel** (#56) into **Tire** (#220) and cement them to the **Spare Wheel Carrier** (#55); then cement that assembly to the **Frame** (#137).

Note that **Exhaust Pipe** "weaves" through length of **Frame**: rear of **Exhaust Pipe** fits beneath rear cross-bar and front section fits over middle support bar.

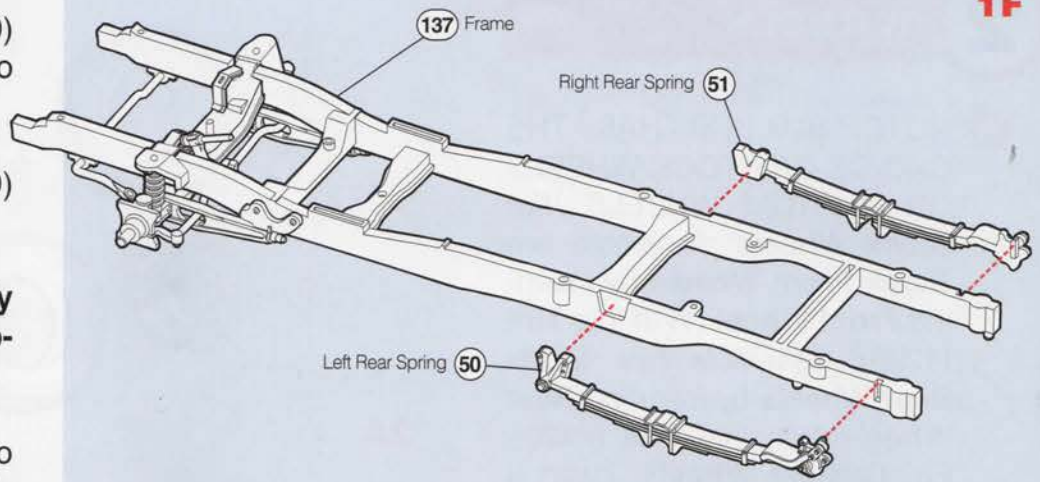

1F

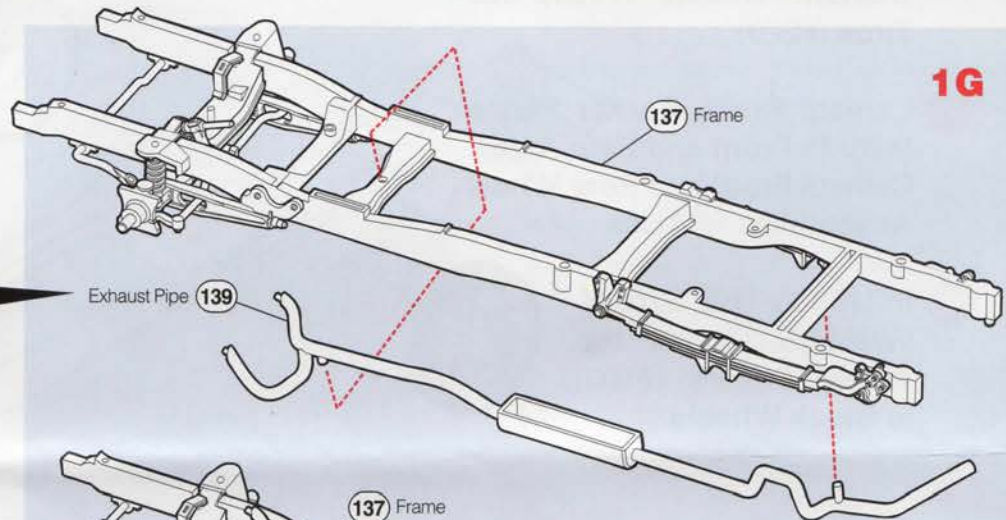

1G

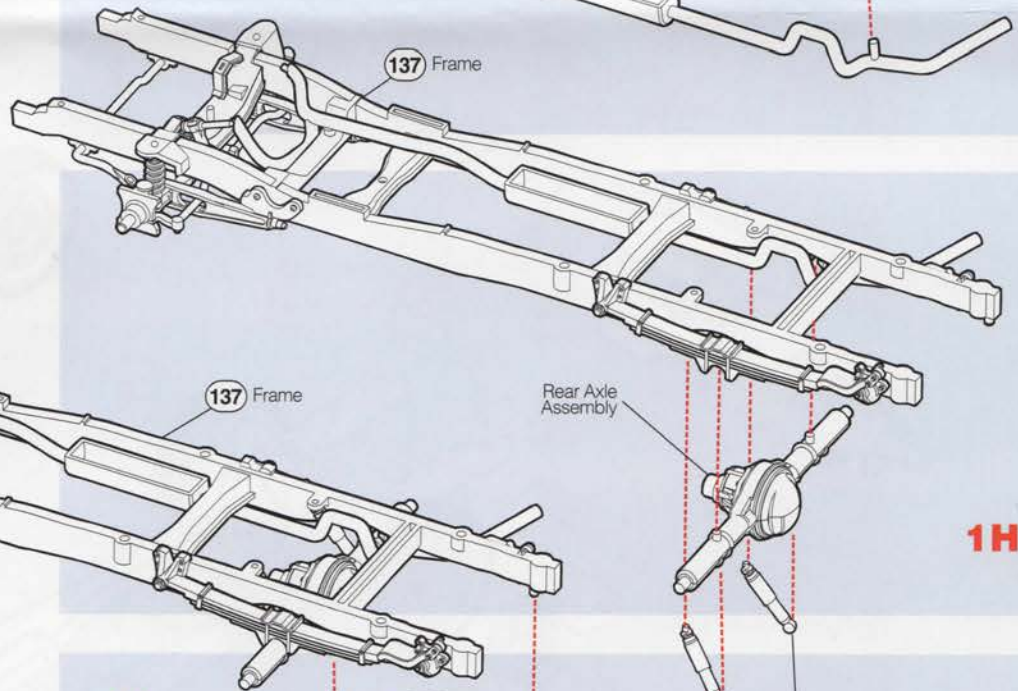

1H

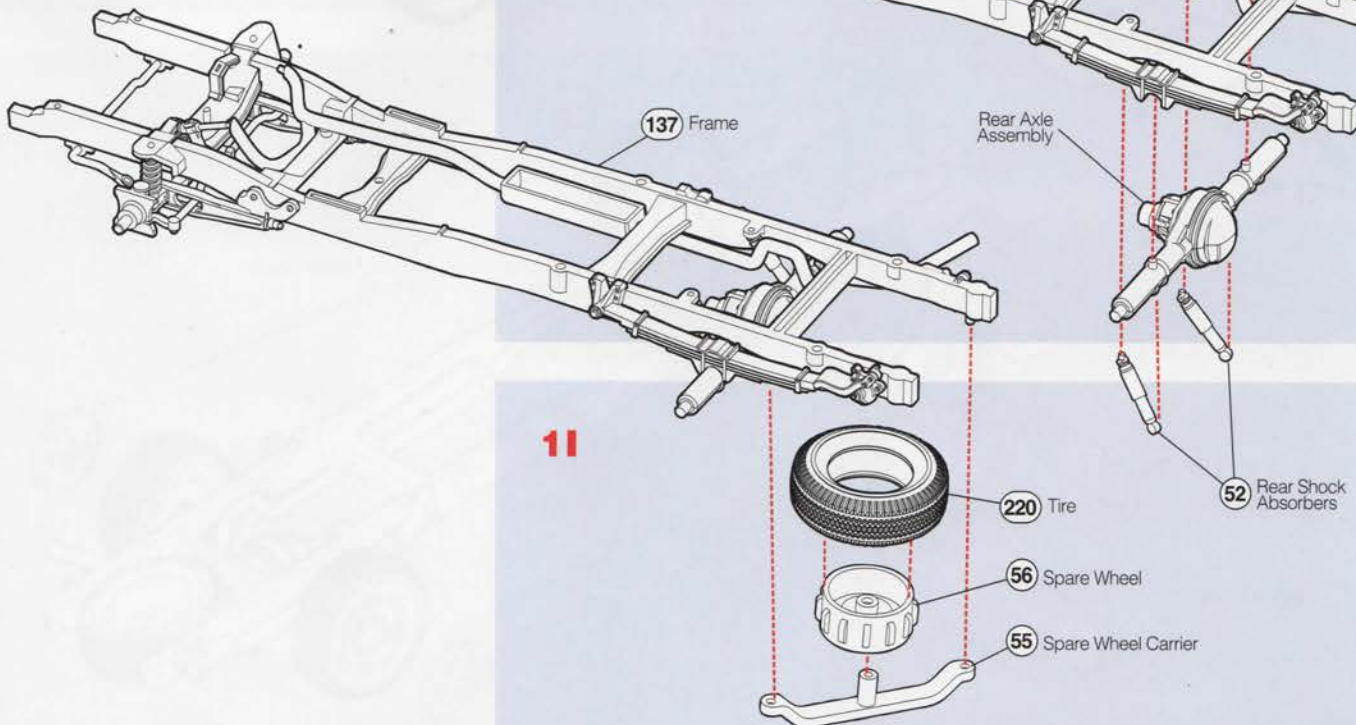

1I

2 WHEELS

A NOTE: BUILDER HAS THE CHOICE OF STOCK WHEELS OR CUSTOM WHEELS. For **Stock Wheels**: Assemble two **Stock Front Wheels** by inserting **Front Wheel** (#73) into **Tire** (#220). Assemble two **Stock Rear Wheels** by inserting **Rear Wheel** (#57) into **Tire** (#220). For **Custom Wheels**, insert 4 **Custom Wheels** (#100) into **Tires** (#220).

B Cement **Brake Backer Plates** (#26) to **Front and Rear Axles**. Cement **Front and Rear Wheel Assemblies** to **Axles**.

C IF USING THE STOCK WHEELS: Attach the **Wheel Covers** (#103) to **Stock Wheels**.

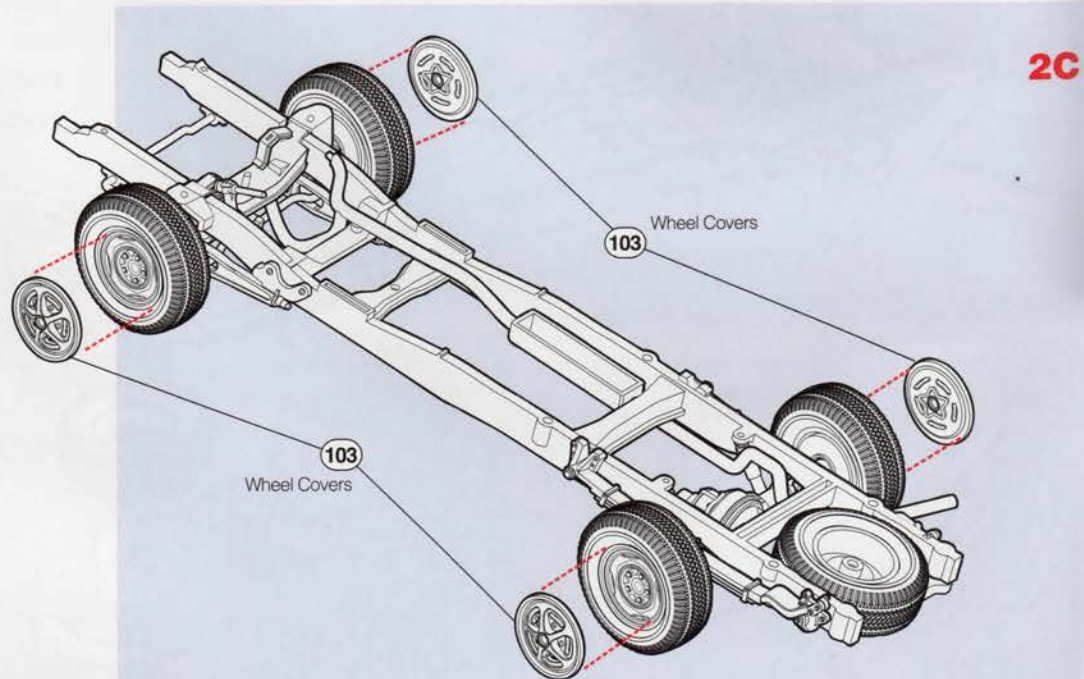
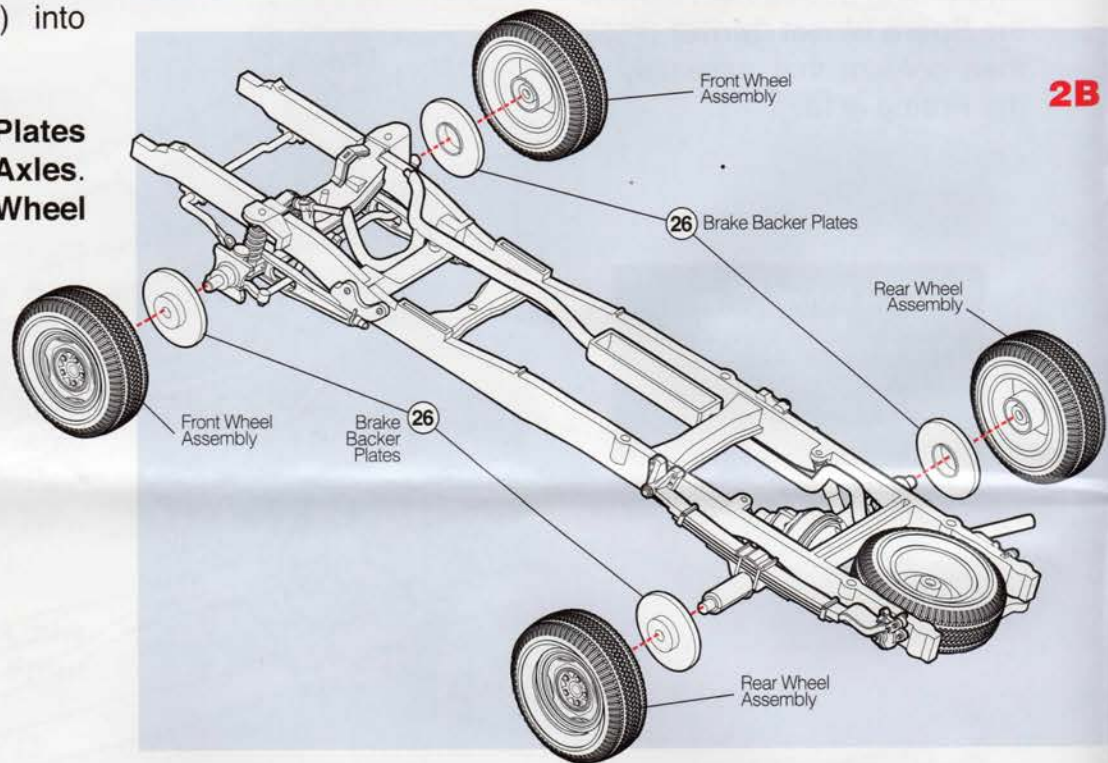
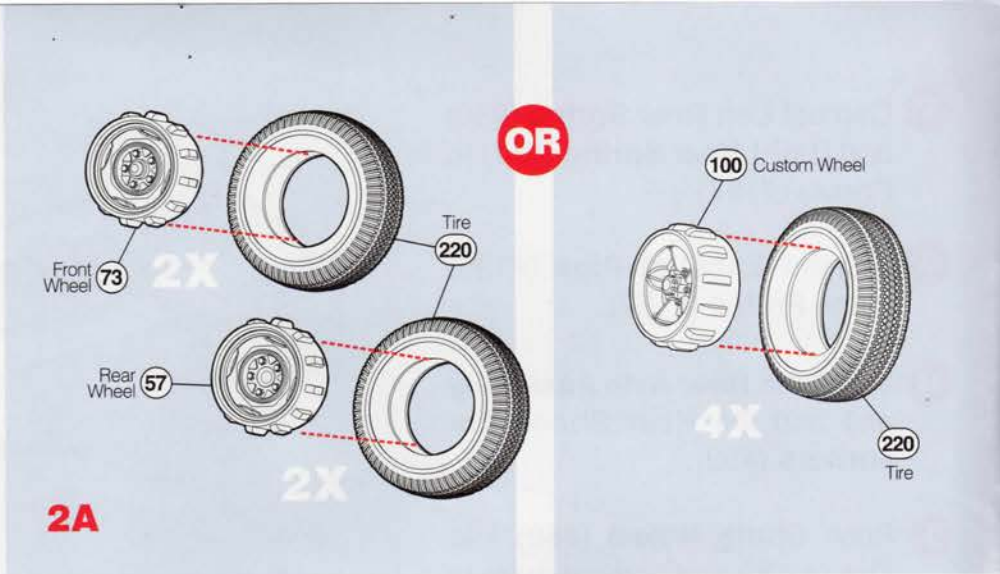

3

ENGINE

- A** Assemble the **Engine Block Halves** (#143 & #144) and add **Oil Pan** (#147).
- B** Assemble **Automatic Transmission Halves** (#145 & #146) and cement the **Transmission** to **Engine Block Assembly**.
- C** Add **Left Cylinder Head** (#141) and **Right Cylinder Head** (#142) to the **Engine Block**.
- D** Cement **Engine Front Cover** (#153) to front of the **Engine Assembly**, followed by **Water Pump** (#167), **Fan Belt** (#165), and **Fan** (#164). Cement **Alternator** (#152) to **Fan Belt**.
- E** Cement **Intake Manifold** (#148) to top of **Engine**. Add **Valve Covers Left** (#125) and **Right** (#126) and **Exhaust Manifolds Left** (#159) and **Right** (#160).

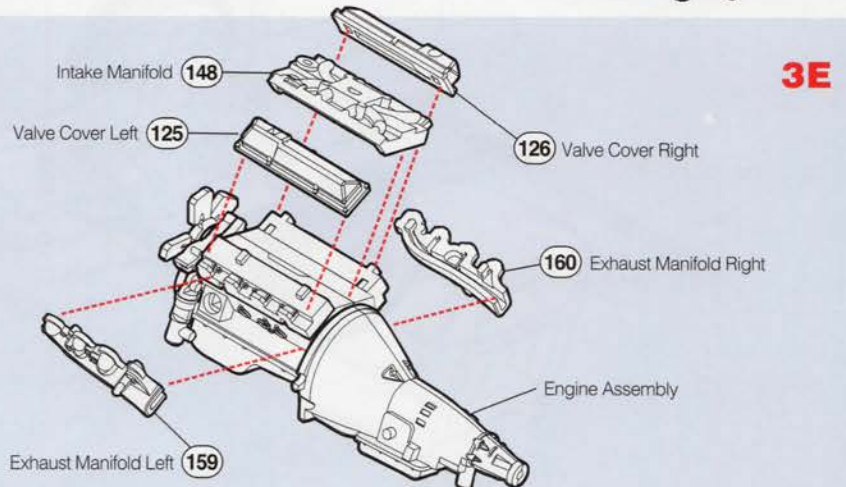
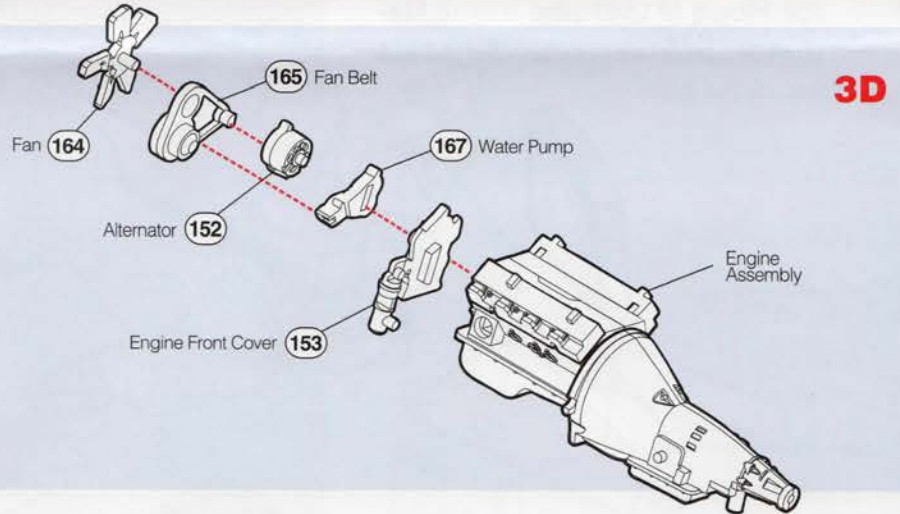
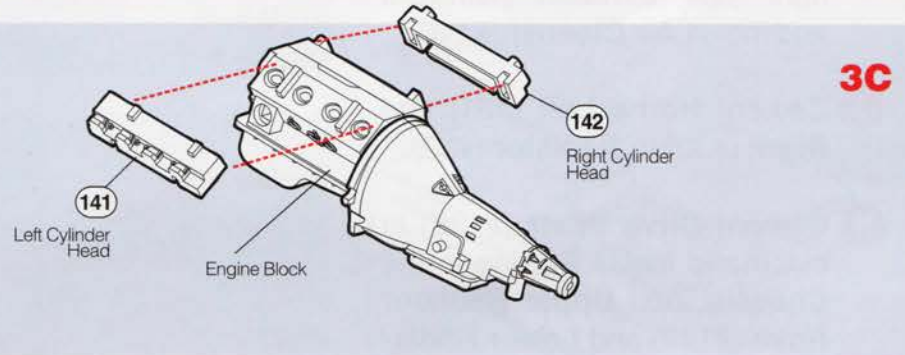
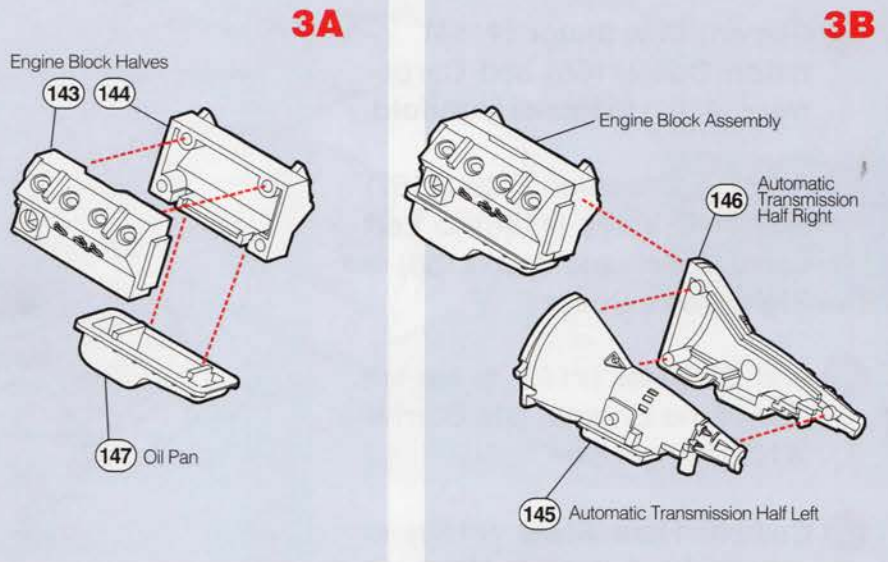

F Cement **Distributor** (#154), **Ignition Coil** (#155) and **Carburetor** (#161) to **Intake Manifold**.

G Add **Oil Breather Cap** (#157) plus **PVC Valve** (#156) to **Left Valve Cover**; add **Cap** (#158) to **Right Valve Cover**.

H Add **Oil Filter** (#163) to the left side of the **Engine**; add **Starter** (#162) to right side.

I Cement **Heat Riser** (#150) to right side **Exhaust Manifold** and install **Air Cleaner** (#140).

J Cement **Horns Left** (#31) and **Right** (#32) to **Radiator** (#62).

K Cement **Drive Shaft** (#138) in place and install **Engine** in the **Chassis**. Add **Upper Radiator Hose** (#149) and **Lower Radiator Hose** (#166) and install **Radiator**. Set completed **Chassis** aside for now.

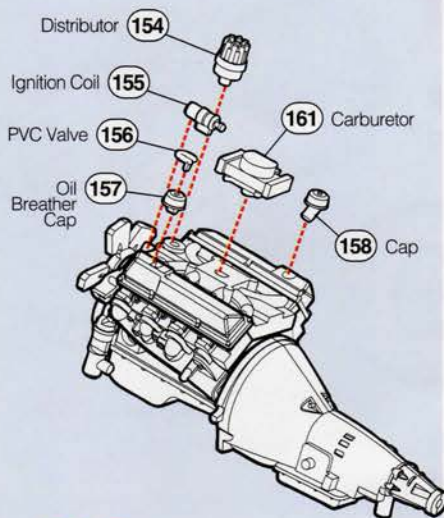

3F-G

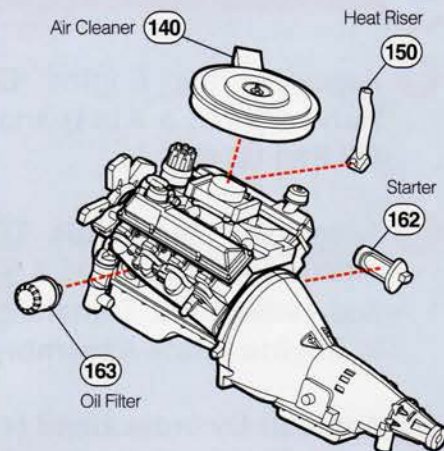

3H-I

3J

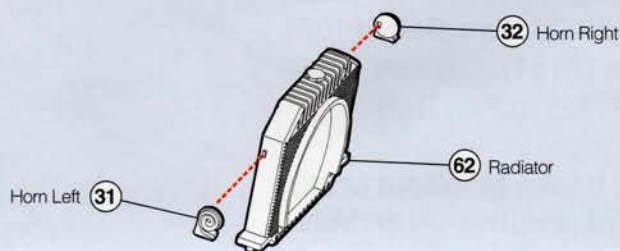

3K

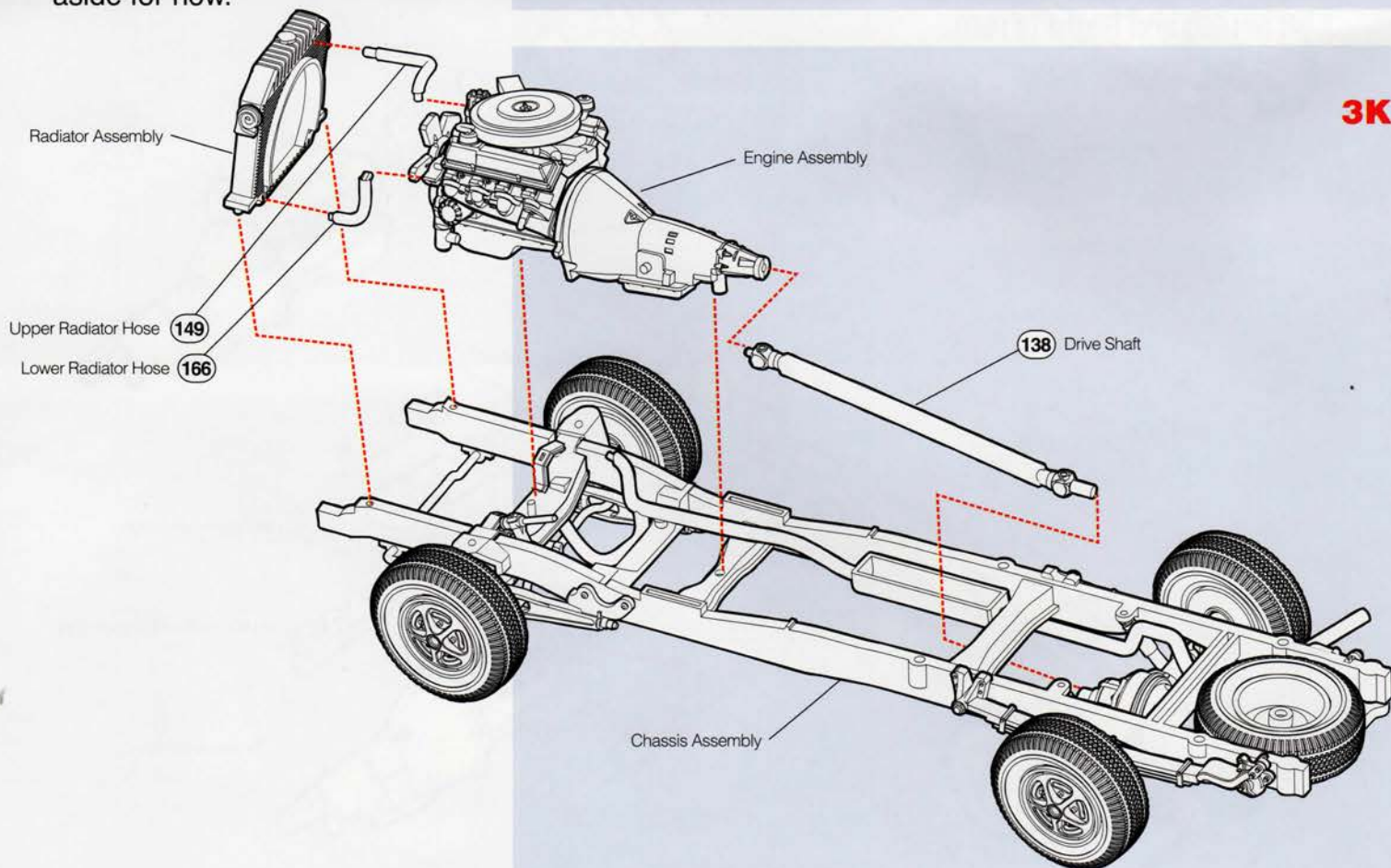

4

CAB

- A** Cement **Sun Visors** (#49) and **Rearview Mirror** (#114) to the ceiling of **Cab** (#1).
- B** Cement **Rear Window** (#209), **Windshield** (#208) and **Vent Windows Left** (#210) and **Right** (#211) in place.
- C** Assemble the **Brake Master Cylinder** (#29 & #30) and install it to the **Firewall** (#44). Cement **Firewall** into **Cab** (#1).
- D** Cement the **Battery** (#27), **Jack** (#40), **Windshield Washer Bottle** (#41) and **Radiator Core Support** (#47) into the **Engine Compartment** of **Cab** (#1).
- E** Cement **F100 Hood Badges Left** (#112) and **Right** (#113) to **Hood** (#2); add **Chrome Trim Bar** (#48) to front of **Hood**.
- F** Cement **Windshield Wipers Left** (#111) and **Right** (#219) in place along with **Mirrors Left** (#118) and **Right** (#117), **Door Handles Left** (#133) and **Right** (#134) and **Gas Cap** (#104). Cement **Grille** (#107) to **Cab** and add **Headlight Lenses** (#212). Add **Ranger Chrome Spears Left** (#131) and **Right** (#132) to **Cab**. Set the **Cab Assembly** aside for now.

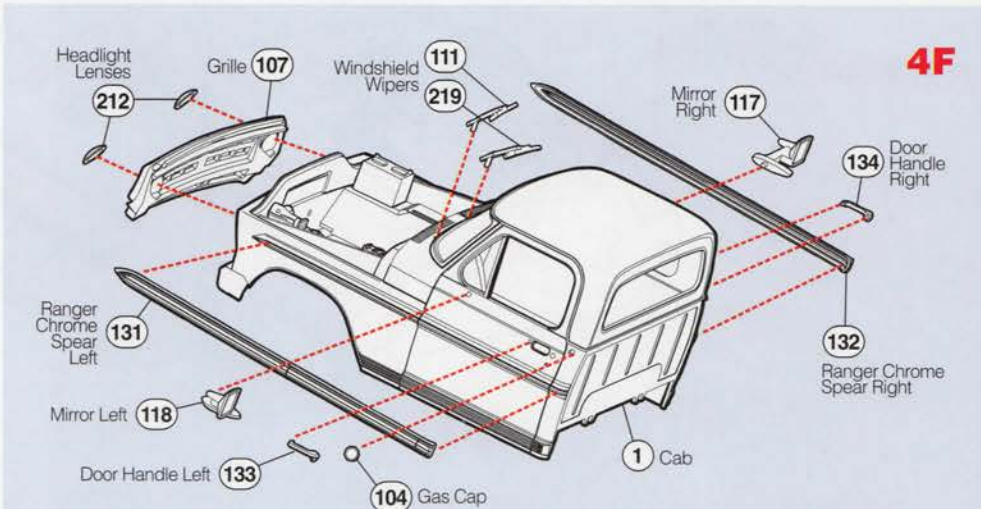
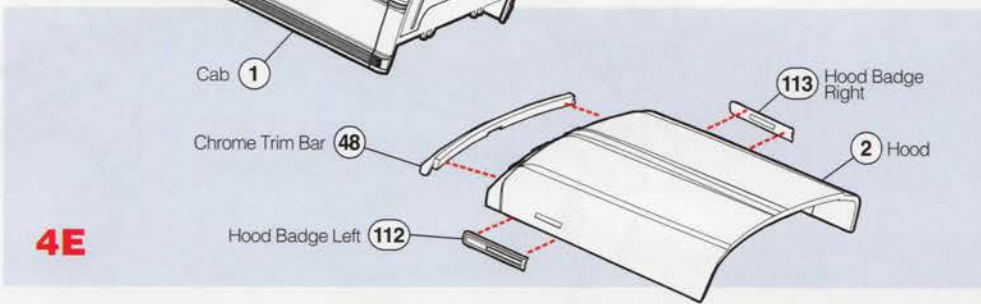
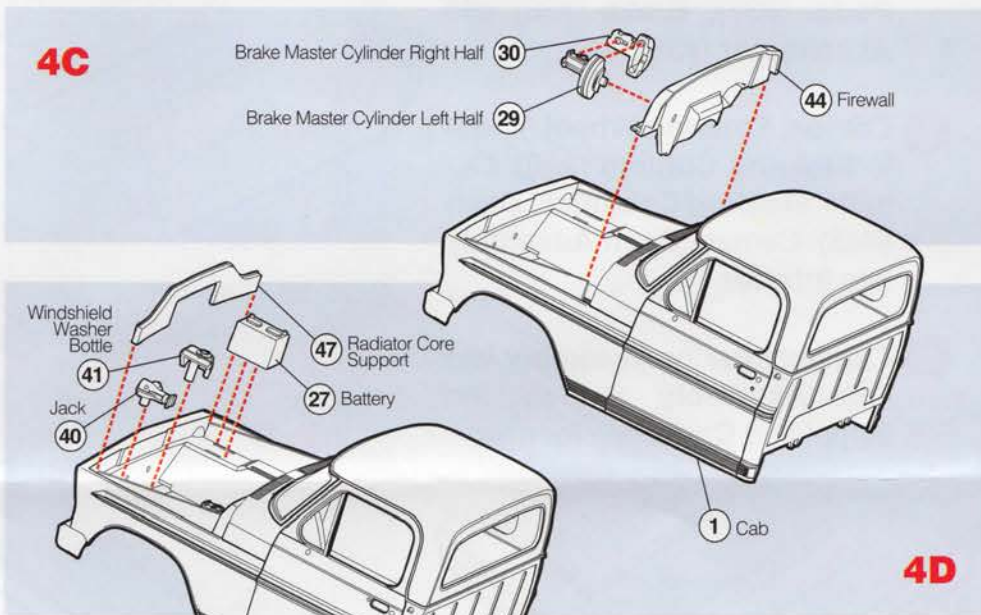
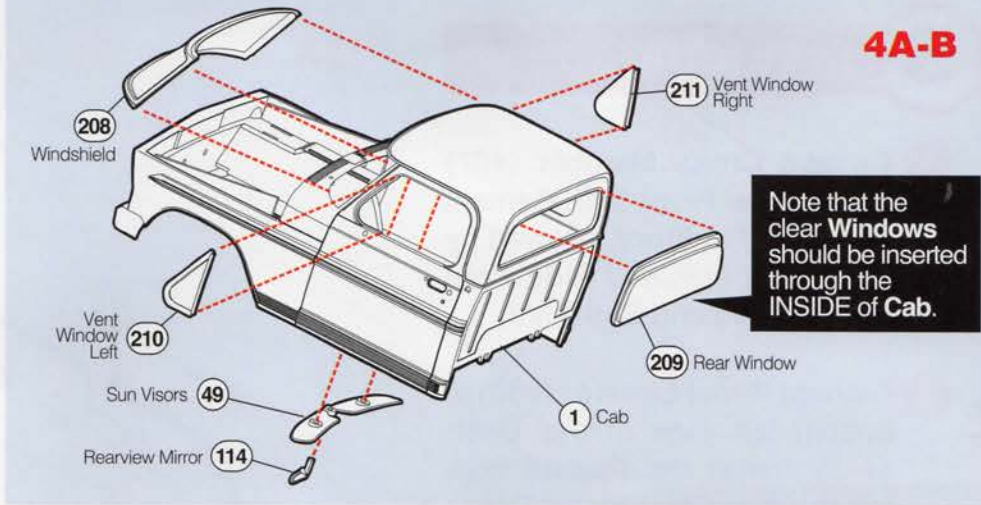

5 INTERIOR

A Cement **Cross Member** (#67) to bottom of **Floor** (#4). Cement **Seat** (#12) to **Floor** followed by **Rear Wall** (#3) and **Side Panels Left** (#7) and **Right** (#8).

B Cement **Pedal Locator** (#68) to bottom left side of the **Dash** (#43). Install the **Pedals** from left to right: **Emergency Brake Pedal** (#37), **Brake** (#36) and **Accelerator** (#35).

C Cement **Steering Wheel** (#136) to **Steering Column** (#28). Cement **Steering Column** to **Dash** (#43). Cement **Dash Assembly** into **Interior**.

D Cement **Interior Assembly** into **Cab Assembly** and set the completed **Cab** aside for now.

5A

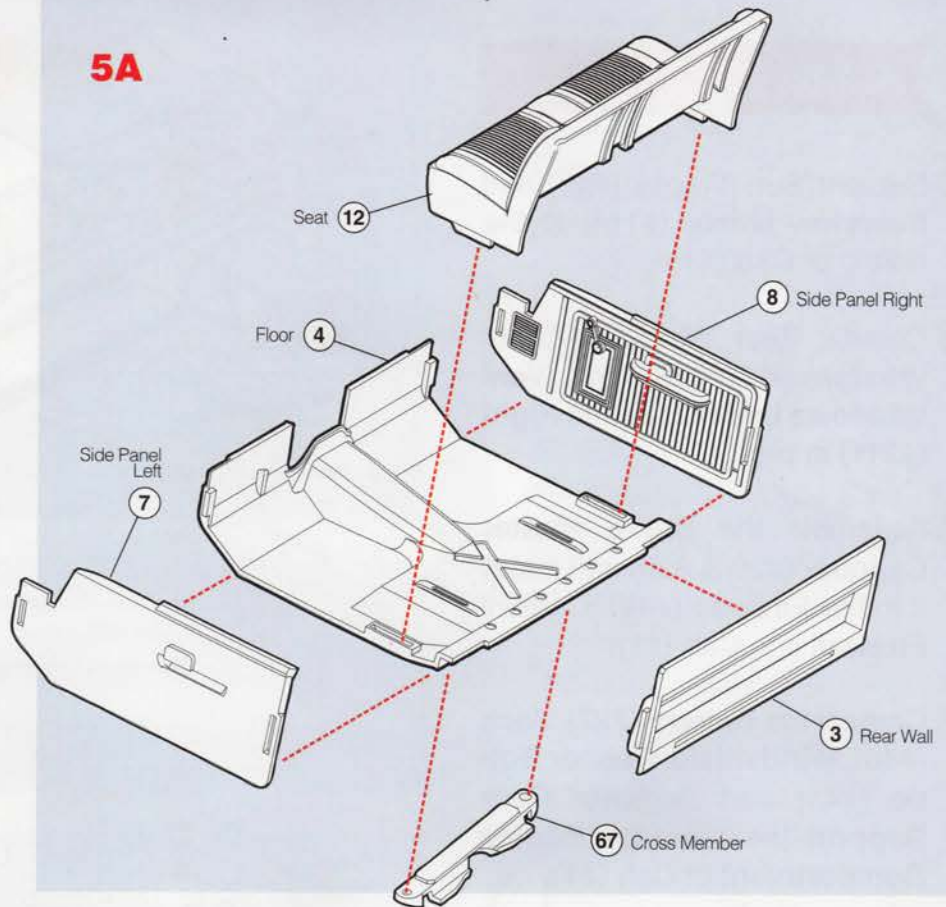

5B-C

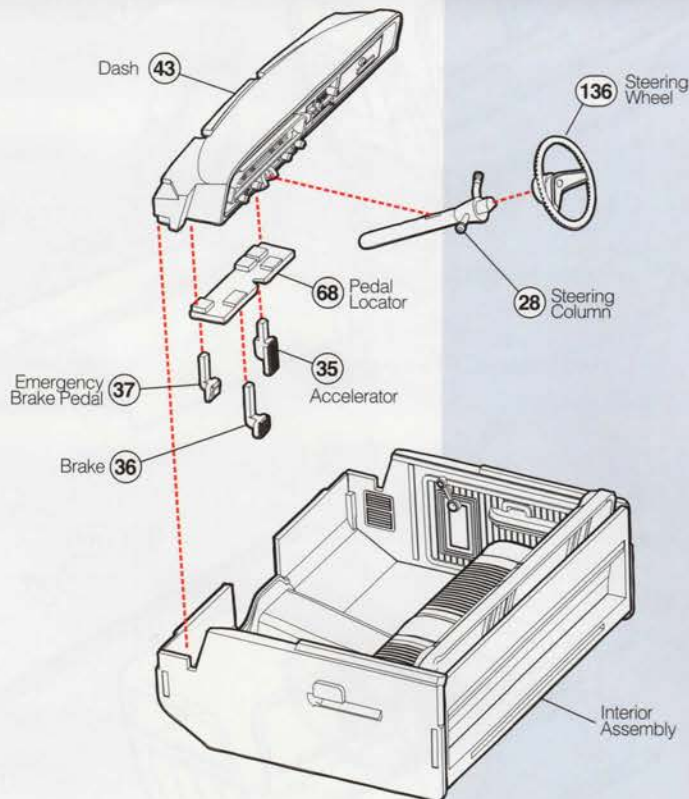

5D

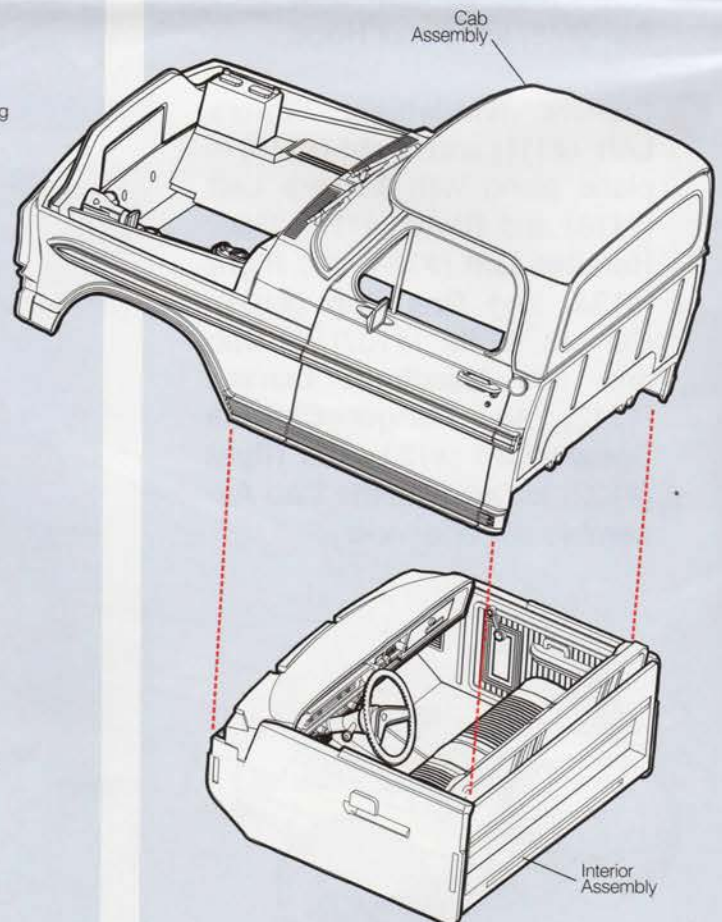

6

BED

A Cement **Left Inner Bed Wall** (#24) to **Left Outer Bed Wall** (#22). Repeat process with the **Right Inner Bed Wall** (#25) and **Right Outer Bed Wall** (#23).

B Cement the **Inner Tailgate** (#46) to the **Outer Tailgate** (#135). Cement the **Bed Side Wall Assemblies** to the **Floor** (#21) along with the **Front Wall** (#45) and **Tailgate Assembly**.

C Add **Taillight Housings Left** (#115) and **Right** (#116) and **Taillight Lens Left** (#213) and **Right** (#214) along with **Ranger Chrome Side Trim Left** (#129) and **Right** (#130).

6A

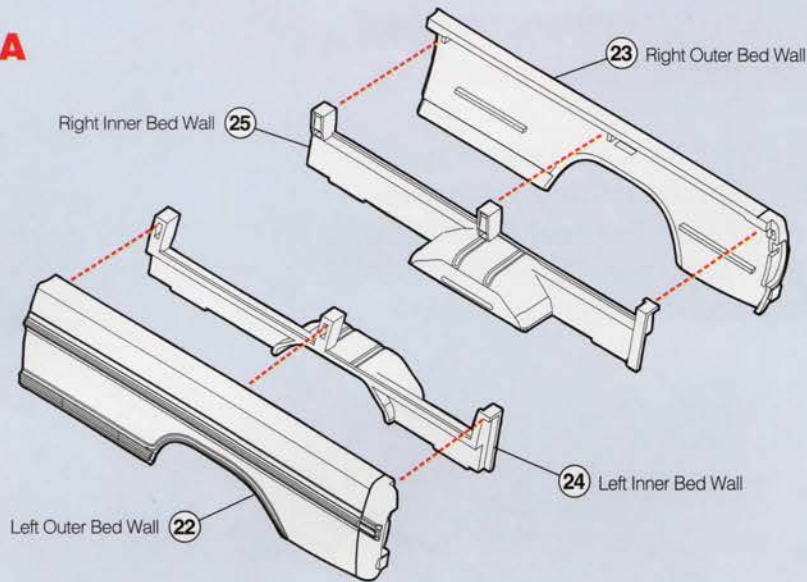

6B

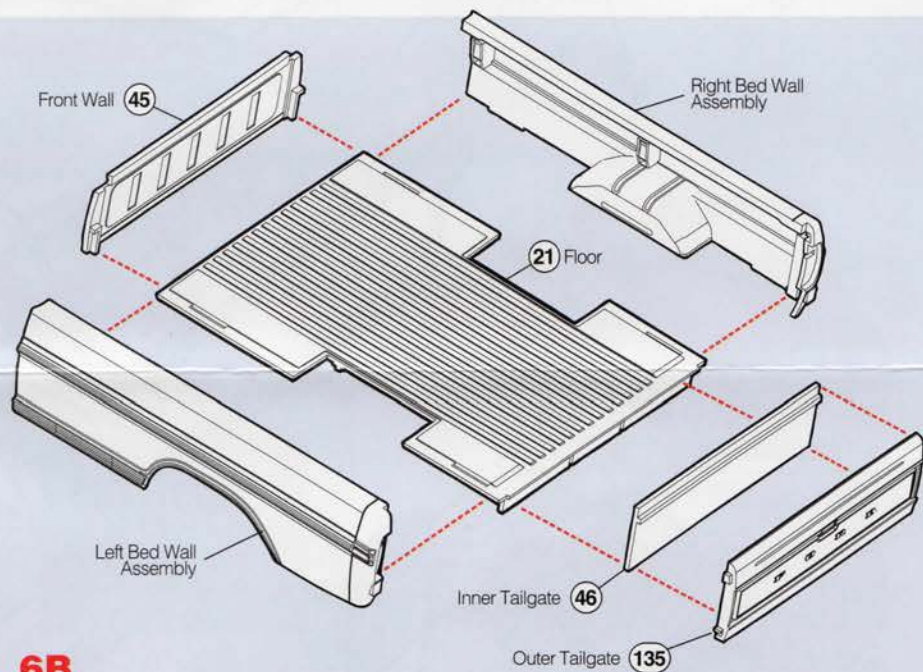

6C

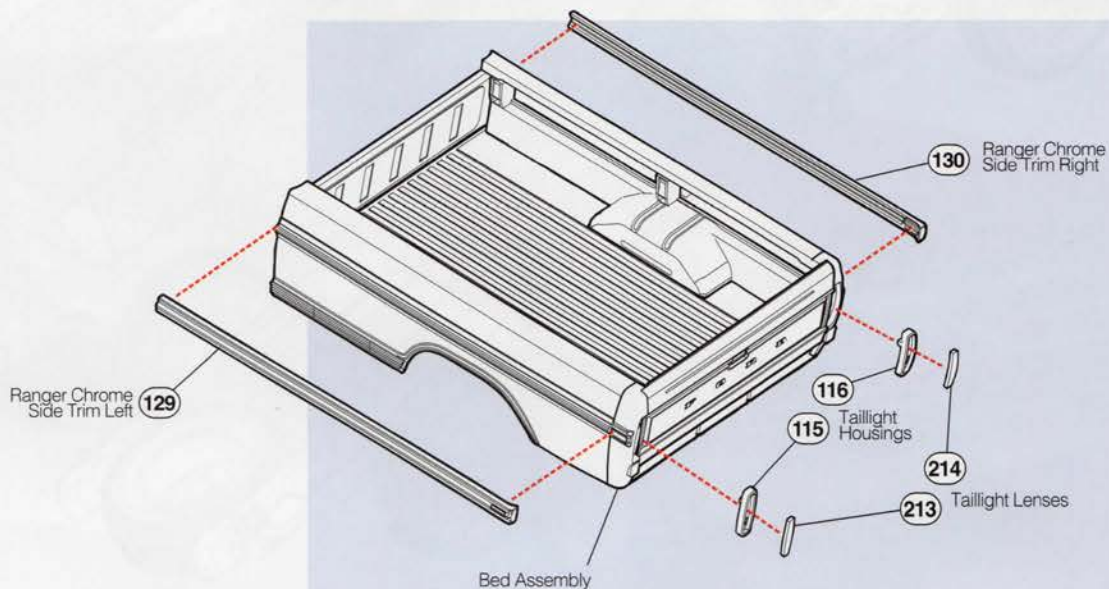

7

FINAL ASSEMBLY

Cement the **Cab Assembly** and the **Bed Assembly** to **Chassis**. Add **Front Bumper (#109)** and **Rear Bumper (#110)**. Set **Hood** in place.

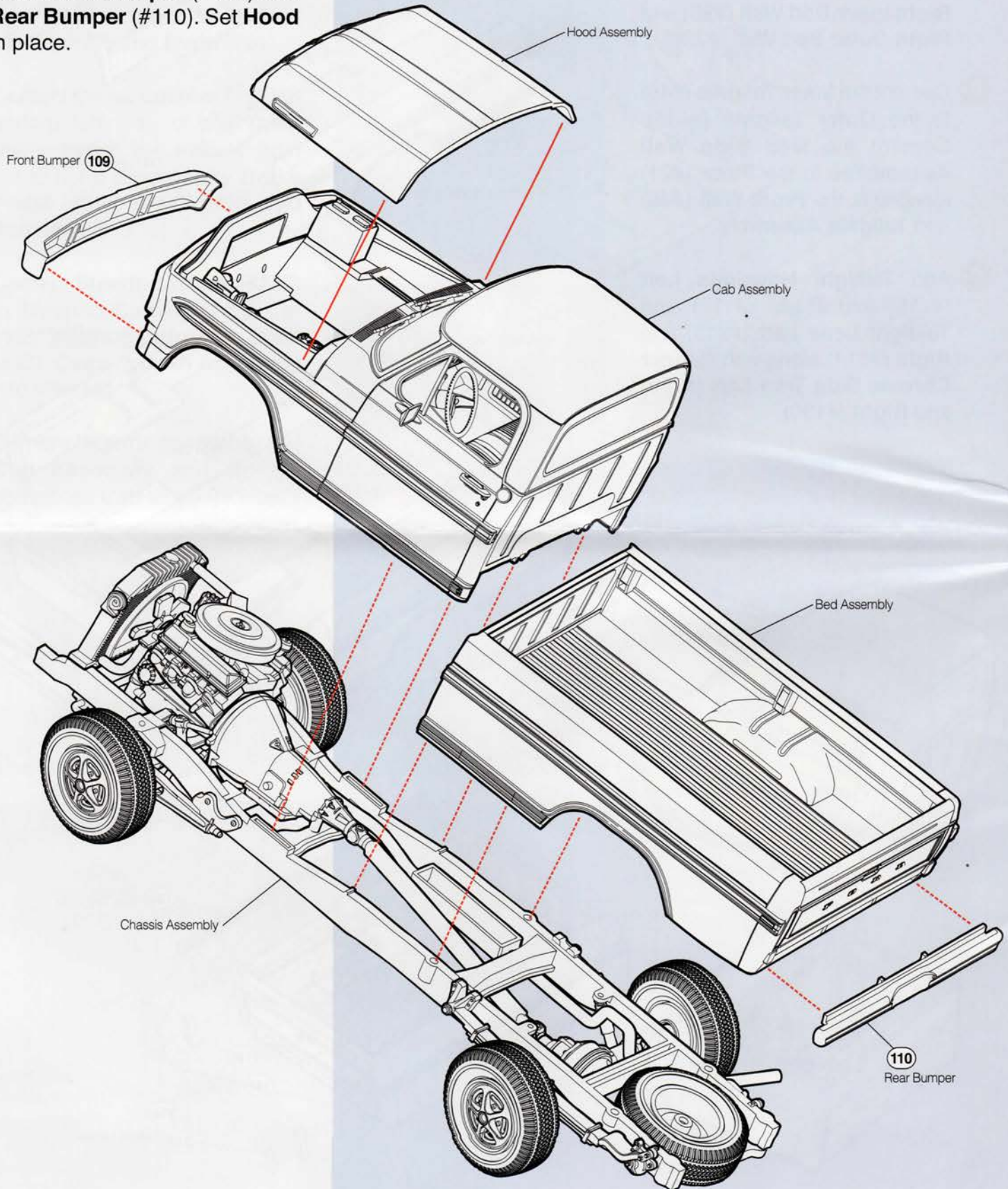



PAINT & DECALS

The **Ford Ranger** was available in a multitude of color schemes, including a variety of “**Tu-Tone**” combinations: “**Standard**” exterior Tu-Tone featured a solid body, bed and cab with a secondary color on the roof section only; “**Deluxe**” featured an upper/lower “split” color scheme (as shown in the buildup on this page); “**Combination**” featured the split color scheme plus the lower color repeated on the roof as well. A general list of factory colors appears on the back page; the builder may wish to do research online, or refer to vintage Ford automotive brochures for more detailed reference and inspiration.

Place decals as indicated. Note that the **Instrument Panels Decal** [6] is one piece, which covers the corresponding area on the dash. The builder who desires to retain raised details may wish to carefully cut the individual panels from the sheet and adhere them to the appropriate cavities on the instrument panel.



If using **Decal 2**, be sure to paint the tailgate panel **stainless steel** before adhering the silver “**FORD**” lettering.



	PAINT COLOR*	CODE
	Raven Black	A
	Pure White	C
	Sky View Blue	E
	Mohave Tan	F
	Chrome Yellow	G
	Boxwood Green	K
	Wimbledon White	M
	Diamond Blue	N
	Seafoam Green	O

	PAINT COLOR*	CODE
	Lime Gold Metallic	S
	Candyapple Red	T
	Mallard Green	V
	Calypso Coral	1
	Prairie Yellow	2
	Swiss Aqua	3
	Regis Red	4
	Bahama Blue	6
	Prime	9

*IMPORTANT: Please note that colors shown are approximations limited by standard printing processes and are for general reference only. For those desiring greater accuracy, you may wish to consult vintage auto paint sources or vintage brochures for more precise color reference.

TU-TONE COLOR COMBINATIONS

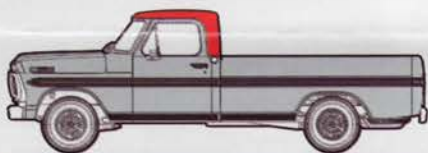

STANDARD TU-TONE

■ First Color Code: **Body**
 ■ Second Color Code: **Roof**

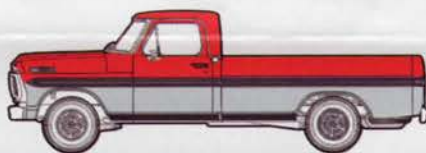

DELUXE TU-TONE

■ First Color Code: **Lower Body**
 ■ Second Color Code: **Upper Body/Roof**

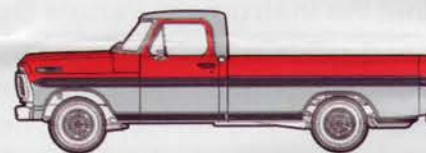

COMBINATION TU-TONE

■ First Color Code: **Lower Body/Roof**
 ■ Second Color Code: **Upper Body**

INTERIOR TRIM

STANDARD TU-TONE

DELUXE & COMBINATION TU-TONE

Blue

M6, 6M, ME, EM, 6E, E6, 6N, N6, EN, NE

6M, M6, EM, ME, E6, 6E, N6, 6N, NE, EN

Parchment or Black

AM, MA, MT, TM, M1, 1M, M4, 4M, AF, FA, M3, 3M, M2, 2M, MF, FM, TF, FT, 1F, F1, 4F, F4, VF, FV, 6E, E6, 6N, N6, EN, NE, VK, KV, VO, OV, KO, OK, TA, 1A, 4A, 6M, EM, 3A, VA, VM, KA, KM, OA, OM, 2A

MA, AM, TM, MT, 1M, M1, 4M, M4, FA, AF, 3M, M3, 2M, M2, FM, MF, FT, TF, F1, 1F, F4, 4F, FV, VF, E6, 6E, N6, 6N, NE, EN, KV, VK, OV, VO, OK, KO, AT, A1, A4, M6, ME, A3, AV, MV, AK, MK, AO, MO, A2

Red

AF, FA, M4, 4M, MF, FM, TF, FT, 4F, F4, AM, M2, TA, TM, 4A

FA, AF, 4M, M4, FM, MF, FT, TF, F4, 4F, MA, 2M, AT, MT, A4

Green

MV, VM, MK, KM, MO, OM, VK, KV, VO, OV, VF, FV, KO, OK, AM, AF, VA, KA, OA

VM, MV, KM, MK, OM, MO, KV, VK, OV, VO, FV, VF, OK, KO, MA, FA, AV, AK, AO



www.moebiusmodels.com

President **Frank Winspur** • Vice President **JoAnn Winspur** • New Product Manager **Dave Metzner** • Art Director **Bob Plant**

Ford Motor Company Trademarks and Trade Dress used under license to Moebius Models. www.FordMotorCompany.com.

©2015 Moebius Models, Glenwood, Florida. All Rights Reserved. Made and Printed in China.

Model shown was built and finished by a professional modeler. Glue and paint required for assembly — sold separately.