

# Choice

Kit Collection  
Limited Edition

# Hawker Tempest Mk. V

CH 72-03

## EJ865

Hawker Tempest Mk. V, EJ865, 80 Squadron, 1947. RAF Dark Green, Ocean Grey, and Medium Sea Grey camouflage with Yellow outer wing leading edges. Dark Blue spinner, and drop tanks.

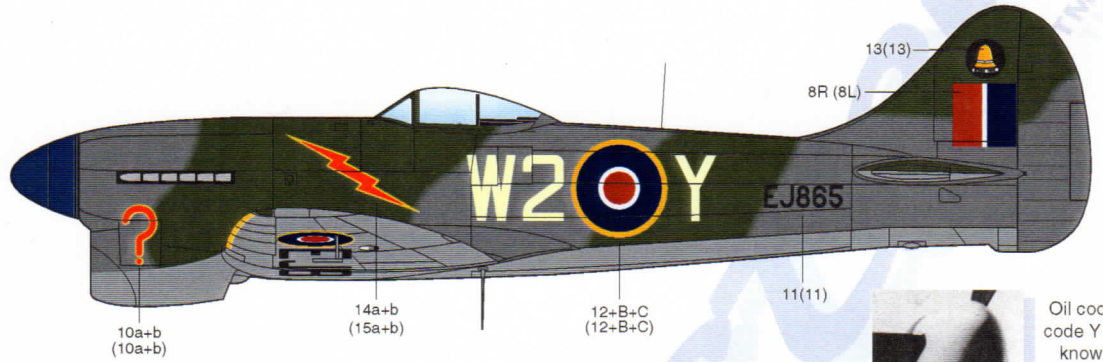

Oil cooler code Y not know if Red or Black. Both supplied!

16 or 17

## NV724

Hawker Tempest Mk. V, NV724, 3 Squadron, July 1945. Flown by Flight Lieutenant P. Clostermann. RAF Dark Green, Ocean Grey, and Medium Sea Grey camouflage with Yellow outer wing leading edges. Red spinner.

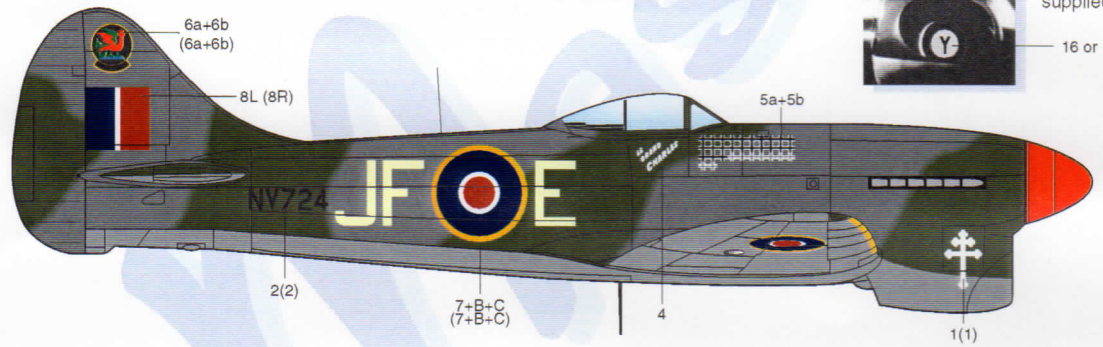

NV724 port side detail

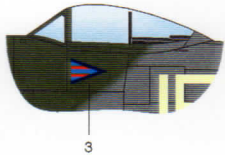

## EJ865

## NV724

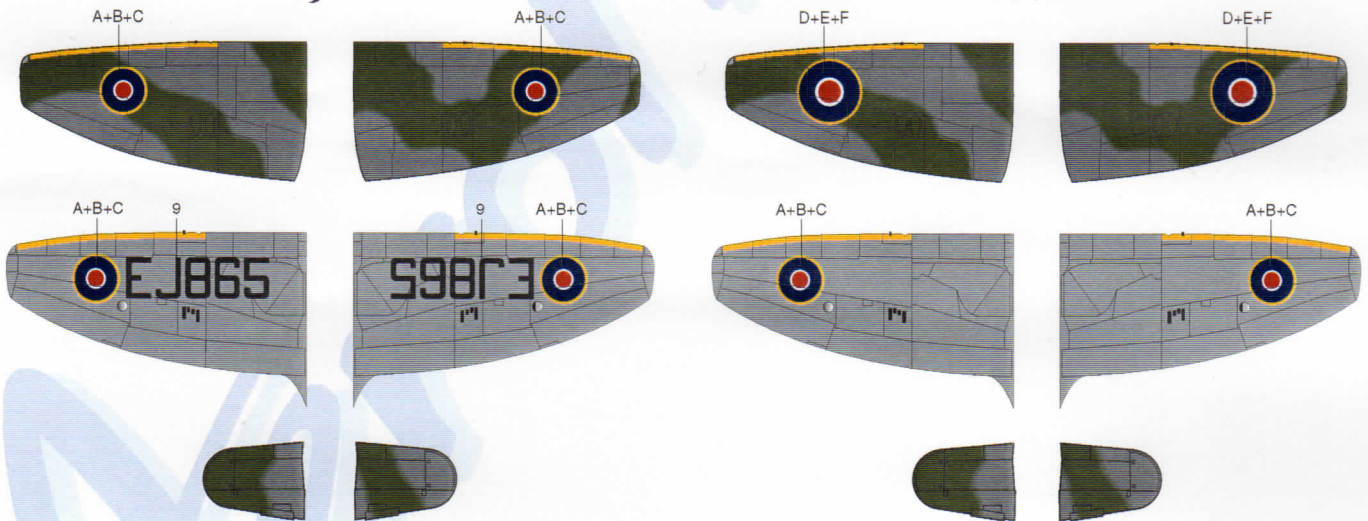

### References:

1. The Typhoon & Tempest Story by Chris Thomas & Christopher Shores, Arms & Armour Press, 1988.

### Recommended AeroMaster Warbird Colors Acrylic

1001 Gloss Clear	1014 Red
1002 Semi-Gls Clr	1015 Blue
1003 Flat Clear	1111 Dk Green
1004 Tire Black	1112 Ocean Gray
1011 Yellow	1113 Med. Sea Gray
1012 White	1120 Interior Green
1013 Black	

### Recommended AeroMaster Warbird Colors Enamels

9001 Black	9111 Dk Green
9002 White	9112 Ocean Gray
9003 Yellow	9113 Med. Sea Gray
9004 Blue	
9005 Red	
9010 Tire Black	

If you have suggestions for future subject matter, AeroMaster would like to hear from you. Our goal is to provide high quality, well researched decals of unusual and interesting subjects. We value our customers' input, so if you have specific suggestions or photographs of unusual subject matter which you would be willing to share, please contact:

**AeroMaster Decals™**  
3615 NW 20th Ave • Miami, Florida 33142 • USA



Dear Customer

Thank you for buying this AeroMaster Product. We hope it will meet all your expectations. This is our fifth experience in producing a complete kit and we hope we have not left anything of major consequence out. We would like to hear your comments about this concept of combining older vintage, sound kits, with state of the art after market accessories, and offering them as one package. And now let us run through the instruction sheet.

The main idea is to replace parts of inadequate quality with latest technology resin, photo-etch or vacu-form parts. The plastic parts are numbered in a square. The photo-etch part numbers are inside an oval, and the resin parts are marked R. We recommended that you cut out all the kit control surfaces, sanding and dry fitting the joints and resin parts before you begin any serious assembly. However, don't attach the control surfaces to your model until it is ready to paint. Do not snap the resin control surfaces off the tree, they will break. Carefully CUT them off with a fine razor saw. In order to get razor sharp trailing edges, these parts are molded with a harder, more brittle resin. Take your time, it will pay off later. Please read and study the drawings until you are familiar with every part.

Markings are provided for 2 Tempests. One is the ever famous "Le Grand Charles", the A/C of Pierre Closterman, and the second one a post war (1947) Tempest.

### RECOMMENDED COLOR APPLICATION

#### Cockpit

BLACK: Floor, Side walls, Instrument panel, Side consoles.  
INT. GREEN: Rear bulkhead, Side wall structure, Seat.  
SILVER: Rudder pedals, Scuff marks on floor, Knobs, etc.  
WHITE or TAN: Seat belts with silver buckles.

#### General Color Note

INTERIOR GREEN: Wheel wells, inside part of Wheel covers.  
METALLIC GRAY or STEEL COLOR: Radiator screen.  
BLACK: Radiator cavity, both, front and back.  
LIGHT GLOSS GRAY: Landing gear struts, Wheel hubs.  
RUST: Exhaust stacks.

Remember that it is easier to paint and finish all the interior parts before matting the fuselage halves. Also, it is easier to attach landing gear struts, wheel doors, fins, antennas, canopies, etc, after they have been assembled and the whole model painted and decaled.

To cut your vacu-form canopy, slightly scribe 1mm larger than where you want to cut with a sharp blade. Continue scribing over this line with increasing pressure every time until it breaks. Remove and smooth out with 600 grit sandpaper. Patience pays!

The assembly is very straight forward. We pointed out the areas where you may encounter problems. Use good grade cyano-acrylate (super) glue to attach resin and photo etch-parts. Of course attach the canopy with white glue or non fogging cyano. Wear protective glasses when cutting photo-etch parts.



### A few tips on working with resin and photo-etch

1. DO NOT SNAP THE PARTS OFF THE TREE. Resist the temptation. Use a razor saw to CAREFULLY remove these parts off the tree. Sometimes you may use the back side of a knife or scribe to scribe the dividing line between the part and the tree. We recommend using the first method and allowing yourself a 1/2 mm leeway. Using 400 grit sandpaper, smooth it out to the correct shape/size.
2. DO NOT breathe the resin dust while cutting or sanding. It is *highly toxic*.
3. Some of the parts on these sets are very, very thin and may be slightly warped. If this occurs, it does not mean they are defective. This is an evil we must live with if we want this perfection. But don't despair, all is not lost. Carefully dip the warped part in hot water for about 30 seconds. Don't burn yourself. Take it out of the water and gently bend it back to proper or original shape and let it cool off in this position.
4. If after following all this instruction a part snaps, use cyano glue to mend it. Sand the joint smooth, and continue.
5. Cutting photo-etch is not difficult, but it is easy to have a little part snap off and hide inside your rug. Of course you've lost that part. To avoid this, attach a piece of masking tape behind the fretch (photo-etch tree) and cut it off as usual. File off the residual burrs.
6. Use fine tweezers to hold your parts while gluing or filing. Use only good grade cyano glue.
7. Use a small flat nose pliers to bend the metal parts.
8. Above all of the already mentioned tips is one that we hope you have acquired during your modeling years. " Planning and patience will make the difference."

We thank you for having purchased this AeroMaster Product and hope you will enjoy building it. Should you encounter any problems with this or any other AMD Product, remember we are only a phone call away. Illustrations by KMC.

Happy Modeling!



#### INSTRUCTIONS FOR STEP 1

1. Detach, clean, fold and assemble seat.
2. Detach, clean, fold and assemble control column.
3. Detach, clean, fold and assemble rudder pedals.
4. Glue together all the small subassemblies and paint.
5. Detach clean fold and paint seat belts White or Tan with Silver buckles. Attach to rear bulkhead. Weather and finish as desired.

#### INSTRUCTIONS FOR STEP 2

1. Glue retainer cap 9 to prop 25. Paint propeller Black with 4" Yellow tips.

#### INSTRUCTIONS FOR STEP 3

1. Detach, clean and glue parts 10 22 23 to 29. Paint as indicated.

#### INSTRUCTIONS FOR STEP 4

1. Detach, clean and fold instrument panel 7. Paint Flat Black.
2. Paint back of film Flat White.
3. Attach the instrument film to the panel.

#### INSTRUCTIONS FOR STEP 5

1. Cut off all the locating pins for the cockpit tub, including the upper fuselage locating pin.
2. Paint side walls and assemble cockpit tub.
3. Assemble radiator area and close the fuselage 28 29 30 and 1 2.
4. When dry, install the instrument panel and gun sight 6.
5. Attach the cockpit tub from the bottom.
6. Attach the tail wheel 13.

#### INSTRUCTIONS FOR STEP 6

1. Carefully cut off ailerons, elevators, rudders and lower flaps\*. Smooth out the inner sections of the upper wing and attach the flap insert 6 5.  
Make sure these 2 parts lay flat inside the wing (shaded area)  
\*Smooth out all the cuts very carefully.

#### INSTRUCTIONS FOR STEP 7

1. Attach upper right and left wing to bottom wing section.
2. Attach this subassembly to fuselage subassembly.  
Smooth the seam as desired.
3. Carefully attach the 4 flap sections with cyano glue at about 30 degrees.

#### INSTRUCTIONS FOR STEP 8

1. Attach horizontal stabilizer to fuselage and wing subassembly.
2. Attach resin control surfaces. For a more realistic model, glue them in deflected positions. See step 9. Remember, ailerons are opposite, (1 up, 1 down) elevators alike (both up or down). Rudder as you wish.
3. Prepare to paint, but do not glue all the landing gear parts, drop tanks, canopy, spinner, wheels etc.

4. At this time attach antenna, F/F antenna, pilot tube, and step. Now is the time to use the new UK Warbird Colors and paint/decal/ weather your model as desired. Attach all the parts mentioned on step 8 (3) when dry. Do not forget all the landing gear, doors, struts, etc. For a more realistic look, cut open your canopy before painting. When assembling the landing gear, make sure you don't forget the wheel caster.

#### INSTRUCTIONS FOR STEP 9

Use blocks #9 only for positioning purposes. Watch trim tab deflected in opposite direction. Also notice wheel caster and strut angle.

Please remember that planning and patience pays. Although over 18 years old, this kit is very good in regards to its shape and dimensions. With the addition of the AMD parts, an outstanding model will result if the above mentioned steps are followed.

You can take this model one step further by completely rescribing the panel lines, replacing the wing tip lights with clear sprue, drilling the exhaust stacks and adding the wing cannons (barely showing in the real A/C). If you carefully complete these steps, you could not buy a better model, no matter the price.

HAPPY MODELING !!!



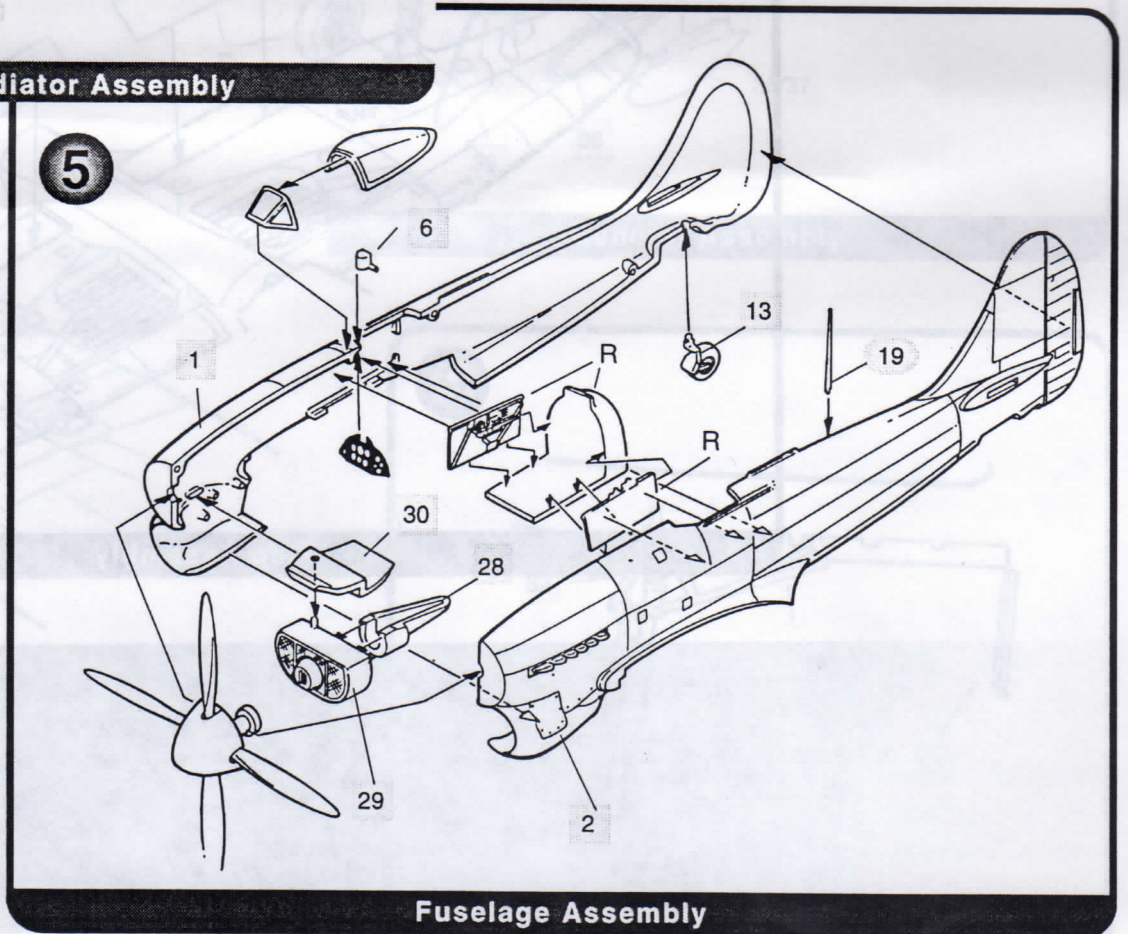
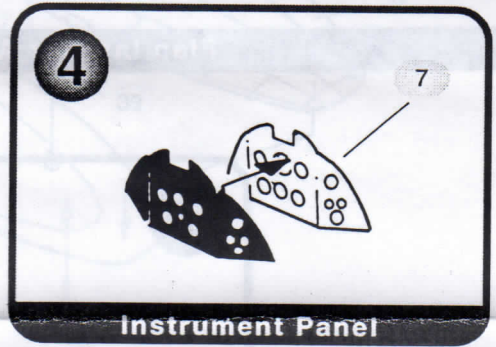
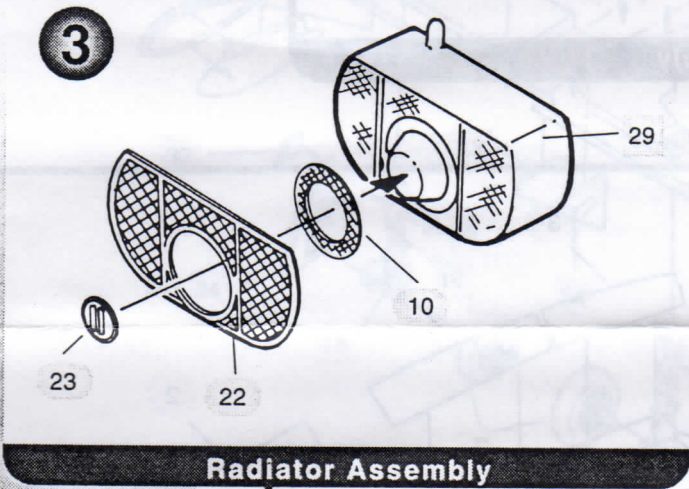
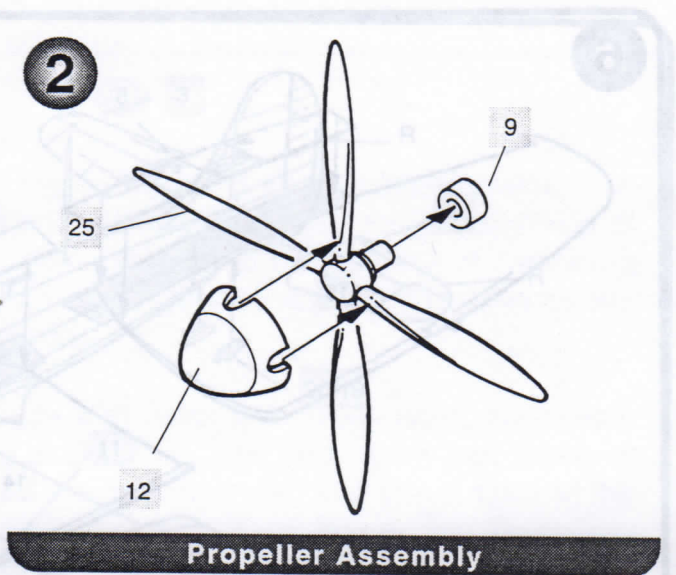
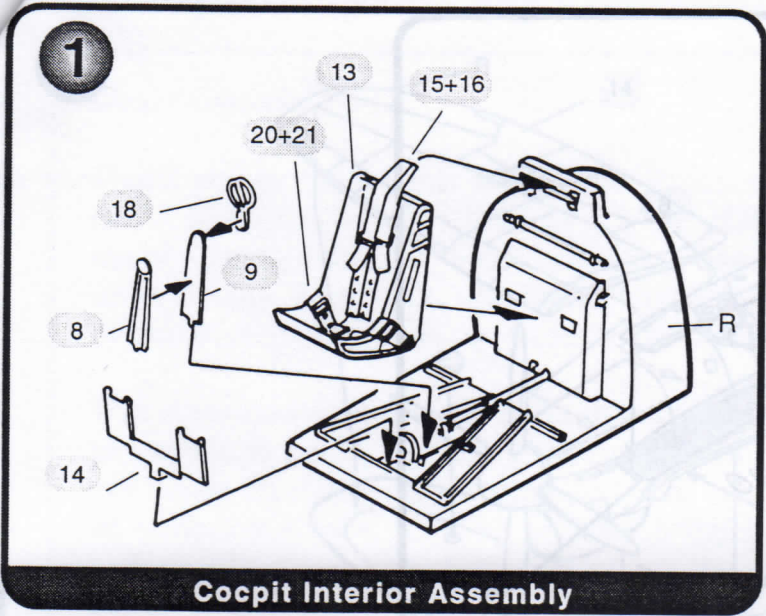



6

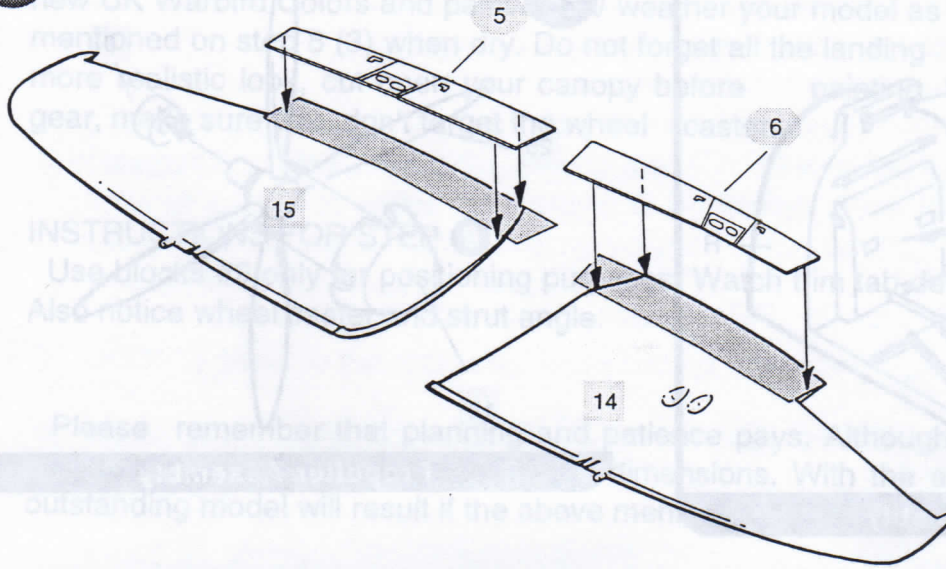

Flap Interior Assembly

7

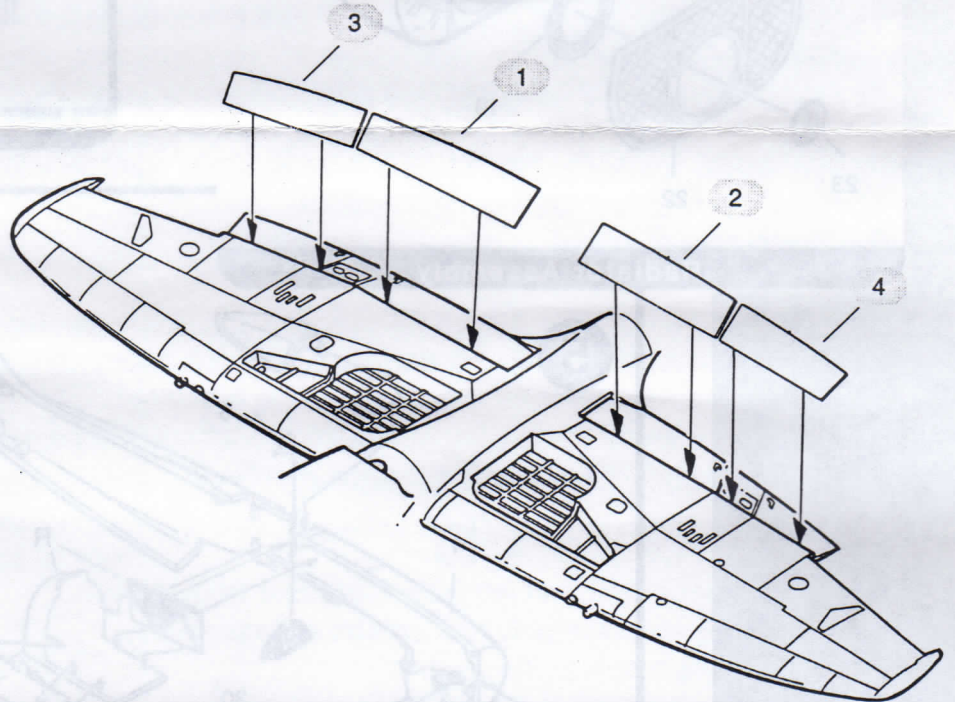

Flap Assembly



8

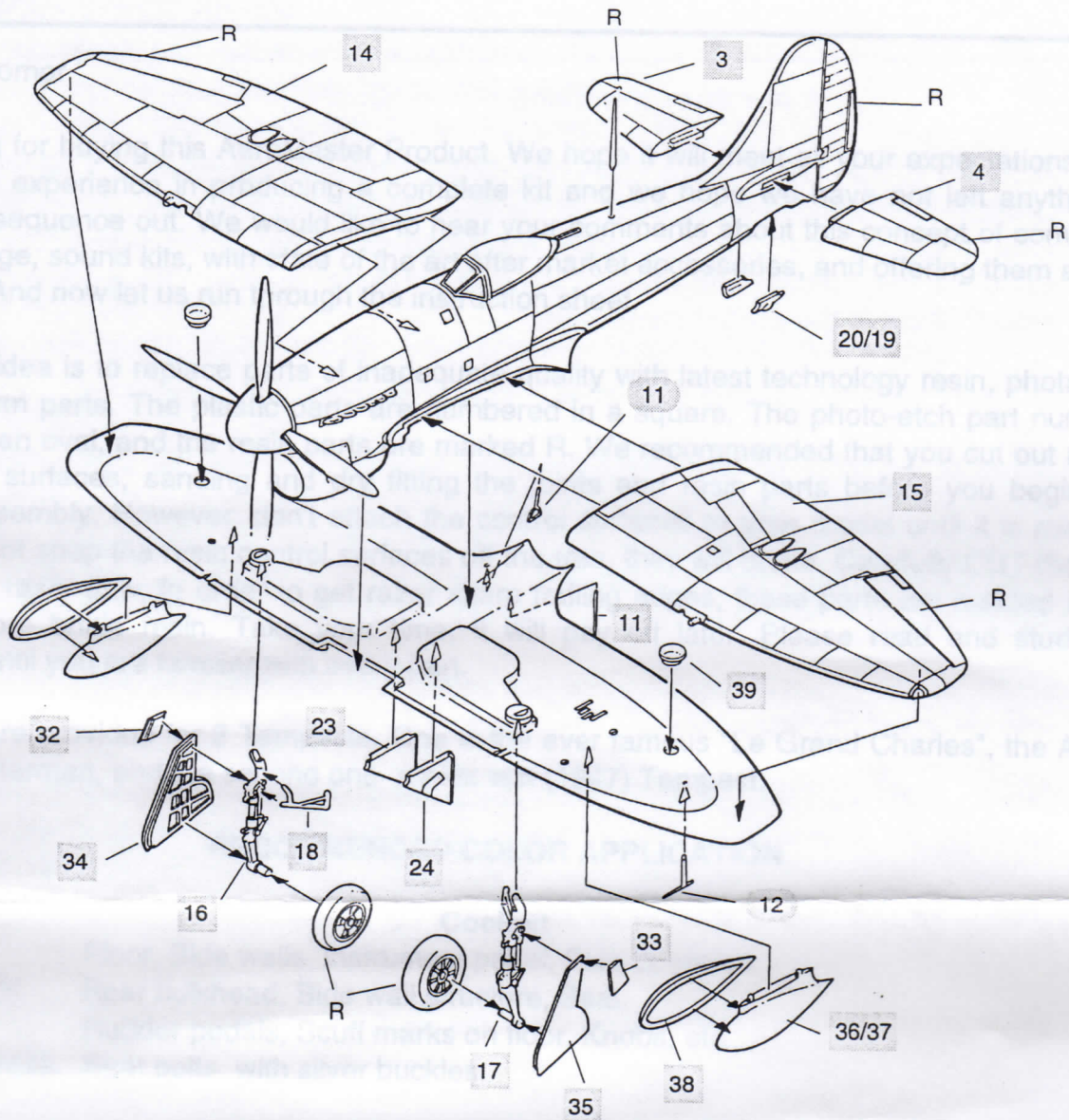

9

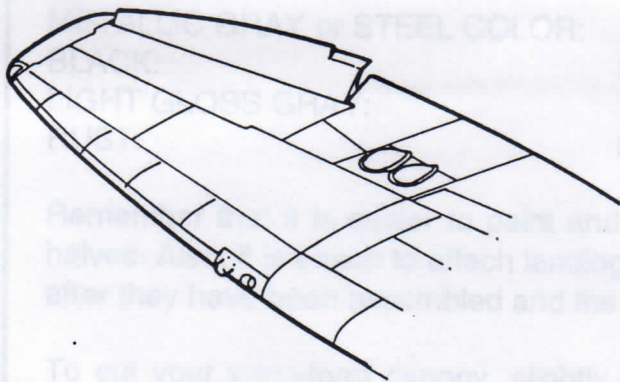

**Aileron Positioning**

**General Assembly**

9

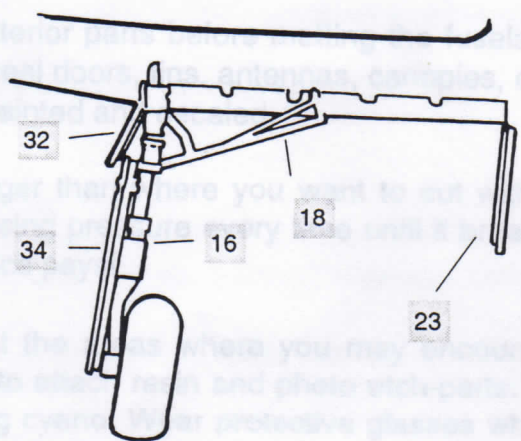

**Landing Gear Positioning**



Dear Customer:

During the final check of this sheet, we realized that we mismatched the upperwing roundels on the two featured A/C. EJ865 should use D+E+F while NV724 should use A+B+C. For further info see photo on page 134 and 140 of *Typhoon & Tempest Story*.

Happy Modeling!

CH72-03