

**RS**  
MODELS

# P-38F Lightning

scale 1/72

92116

The P-38 was originally conceived as an advanced, high-performance twin-engine interceptor. The first major production version was the P-38E, which had a 20mm cannon rather than the earlier 37mm cannon. Production of the E began in September 1941 and 210 were built. The next version, the P-38F, introduced pylon racks that could carry either bombs or droppable fuel tanks, greatly extending its range. Production of the G began in August 1942, followed by the P-38H in May 1943, which had a more powerful version of the Allison V-1710 engine.

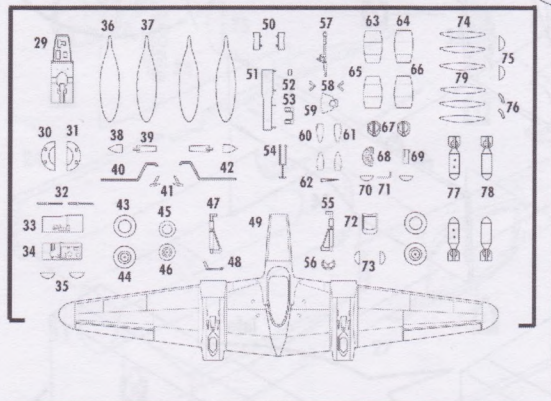
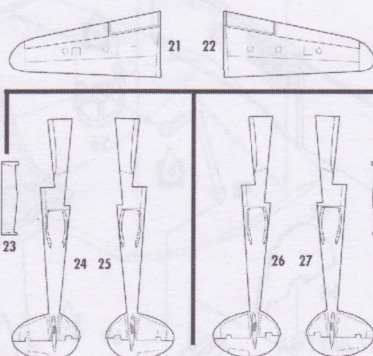
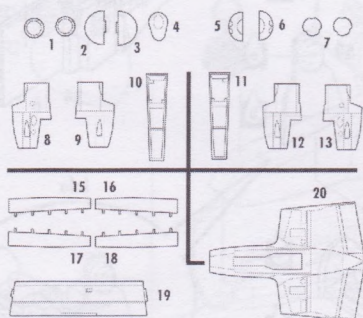

CLEAR PART (C)



RESIN PARTS

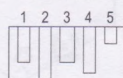

COLORS

- |   |                                    |
|---|------------------------------------|
| <b>a</b> Černá<br>Black                   | <b>h</b> Červená<br>Red            |
| <b>b</b> Interier, Zlatá<br>Zinc Chromate | <b>i</b> Bílá<br>White             |
| <b>c</b> Stříbrná<br>Silver               | <b>j</b> Žlutá<br>Yellow           |
| <b>d</b> Plátno<br>Linen                  | <b>k</b> Pneumatiky<br>Tyres Black |
| <b>e</b> Kůže<br>Leather                  | <b>l</b> Rezavá<br>Rust            |
| <b>f</b> Hliníková<br>Aluminium           | <b>m</b> Tmavá Sedlá<br>Dark Grey  |
| <b>g</b> Chromová<br>Chrome               | <b>n</b> Křemenná<br>Gun metal     |

LEGEND



ohnout bend  
vlečkové lepidlo cyanoacrylate glue  
odstranit remove  
upravit reduce  
vrtat open hole  
vyřebit strach build  
obtlisk decal  
barva color  
film

STEP 1

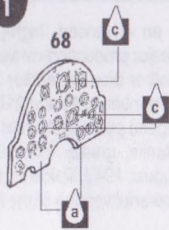

STEP 2

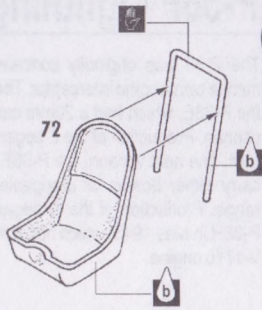

STEP 3

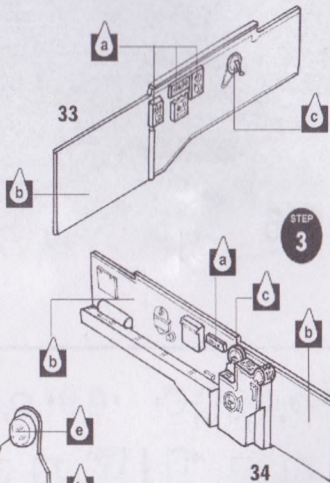

STEP 4

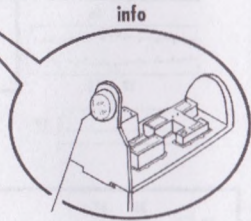
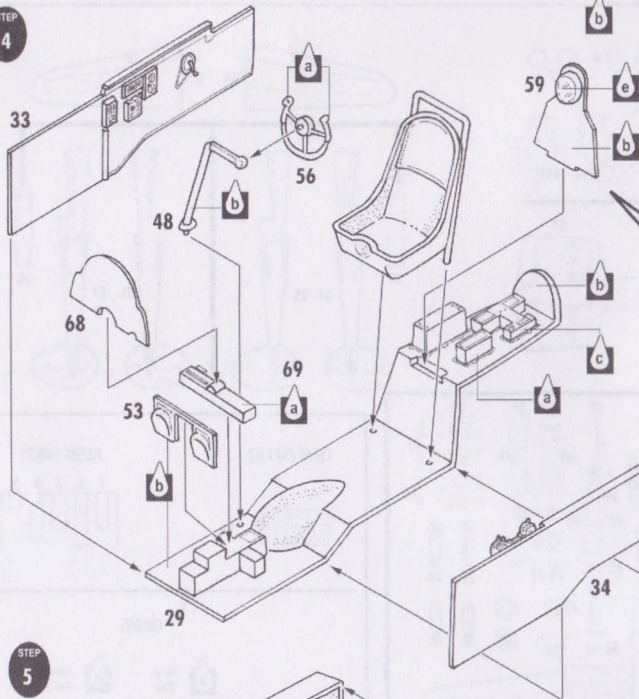

STEP 5

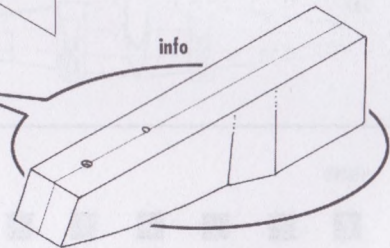
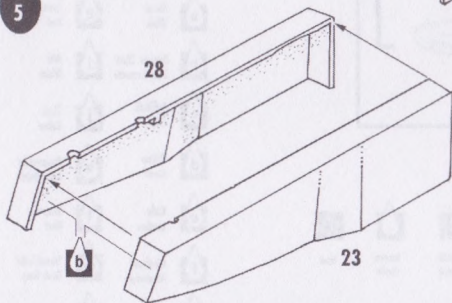



STEP  
9

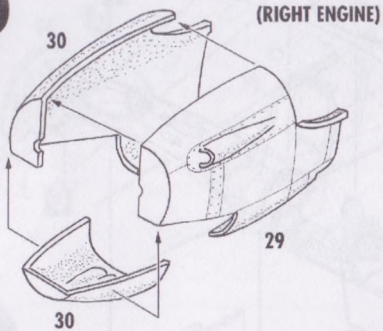

STEP  
10

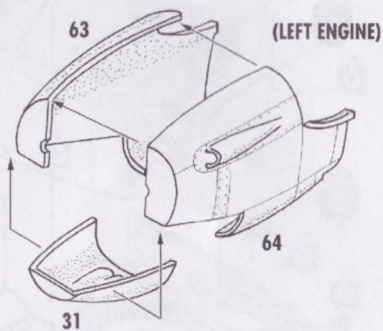

STEP  
11

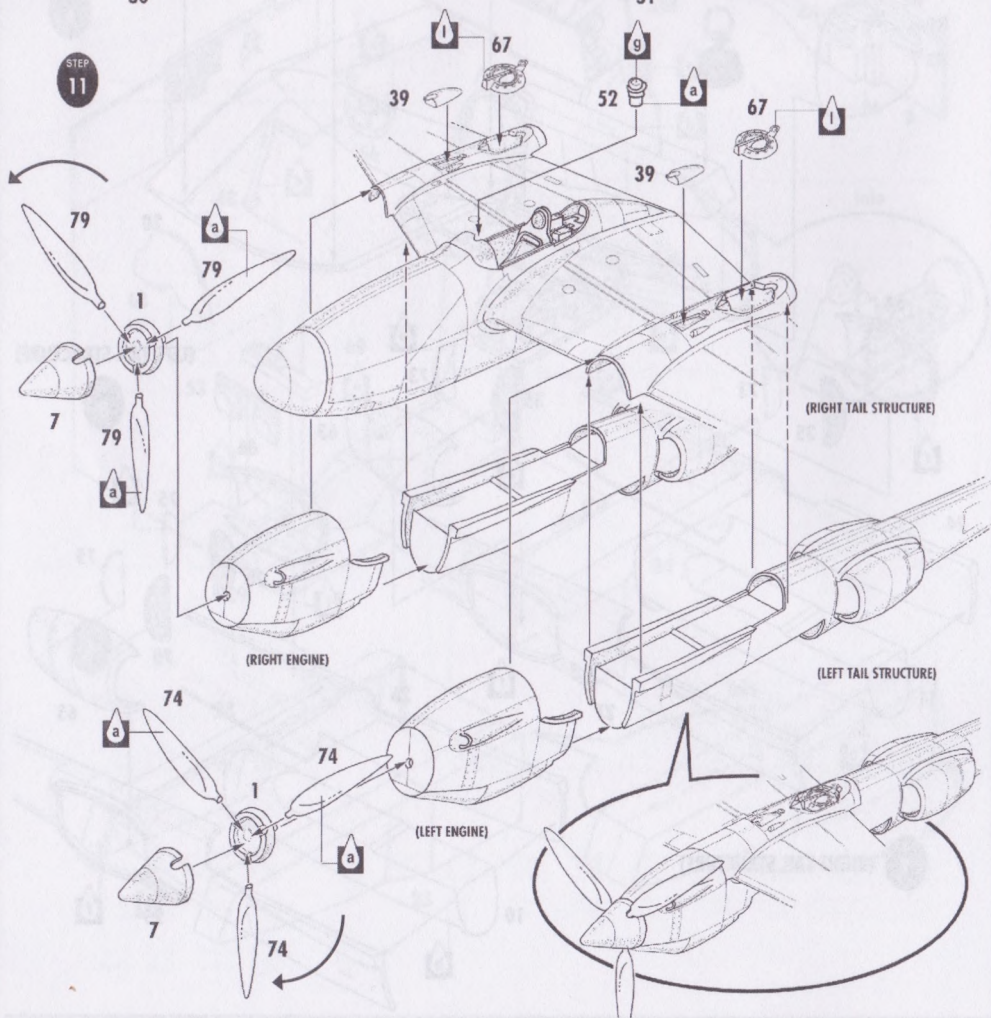

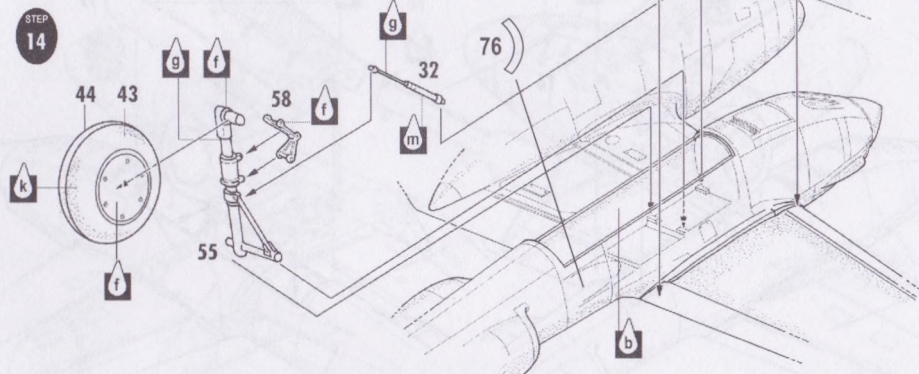
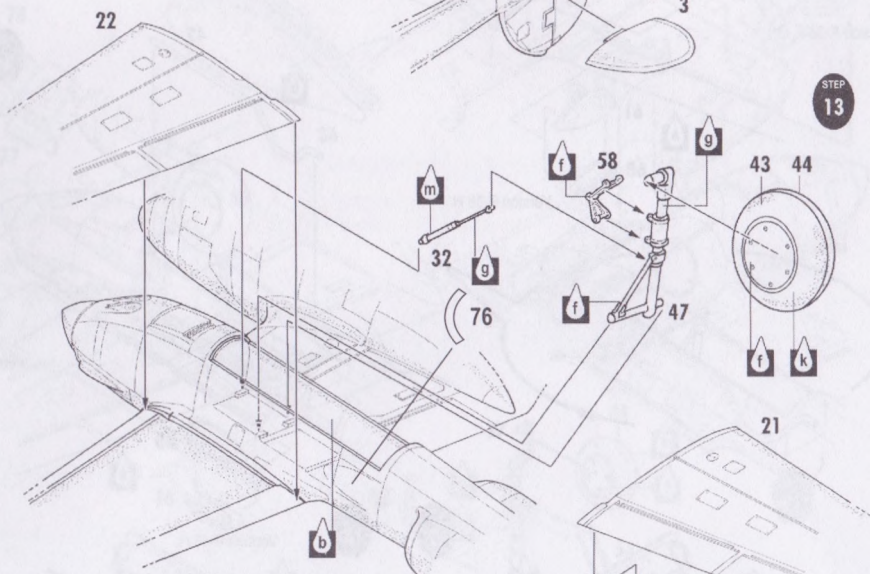
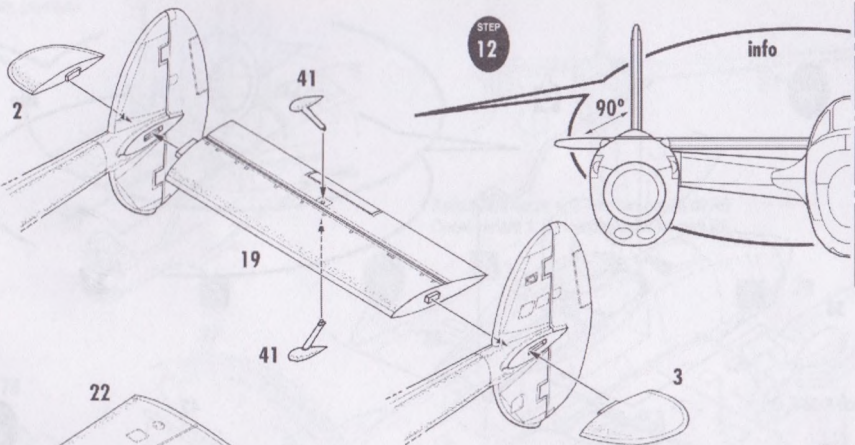

STEP  
15

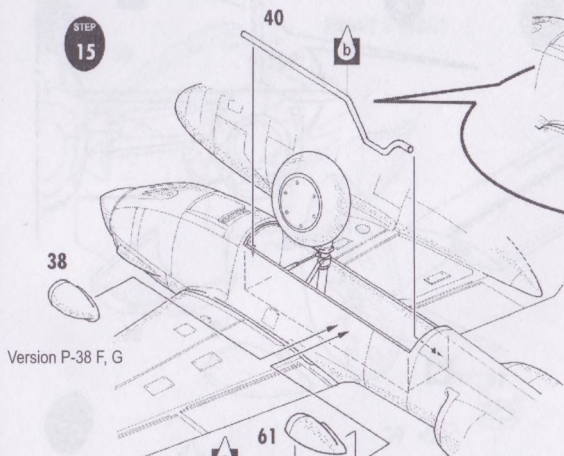

Version P-38 F, G

info

STEP  
16

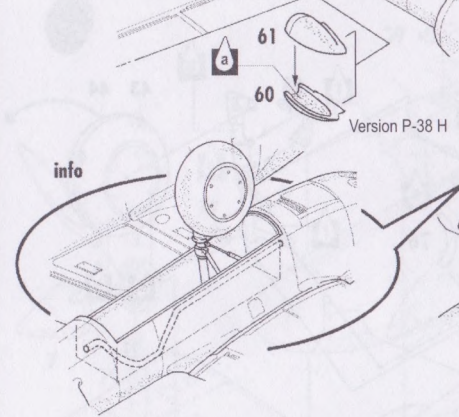

Version P-38 H

info

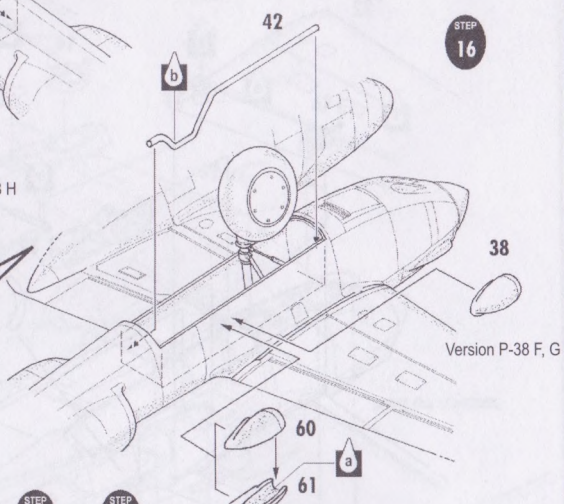

Version P-38 F, G

STEP  
17

STEP  
18

Version P-38 H

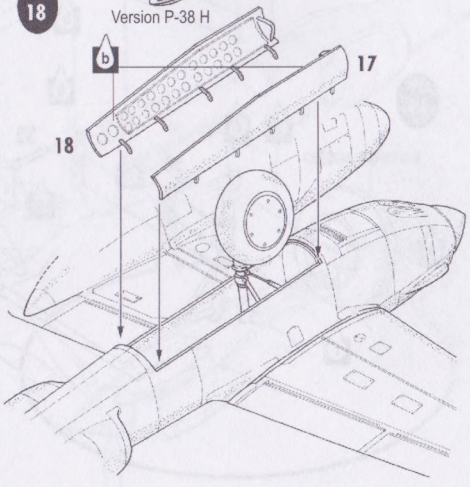
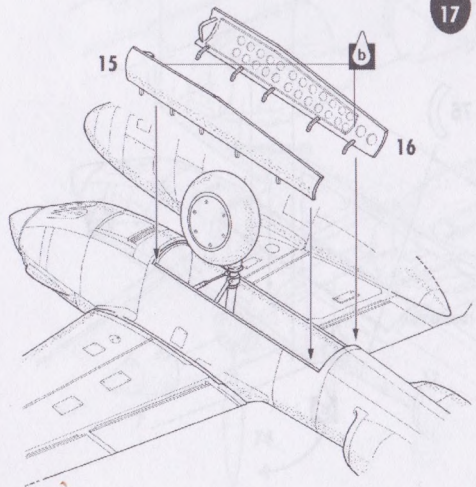

Drop tanks position

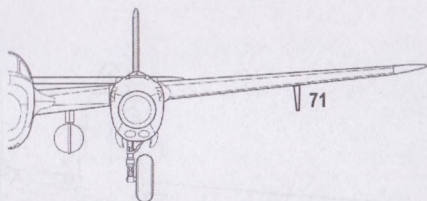
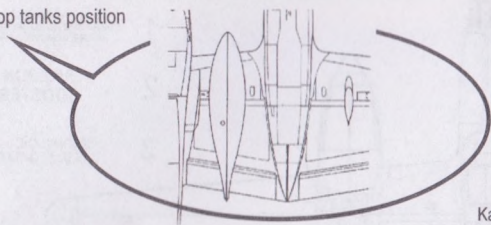

Kamuflážní verze 1, 2 - možno použít díl R6  
Decal variant 1, 2 - may be used for part R6

STEP 19

STEP 20

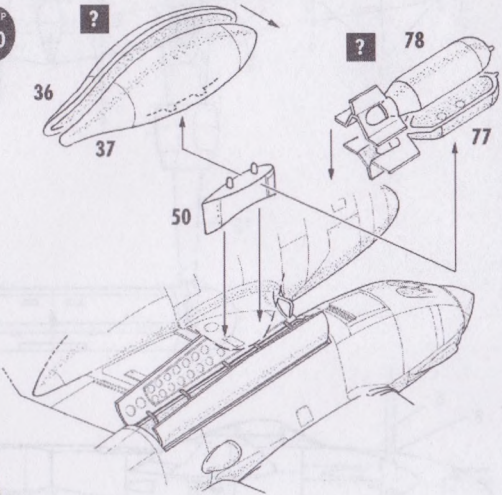
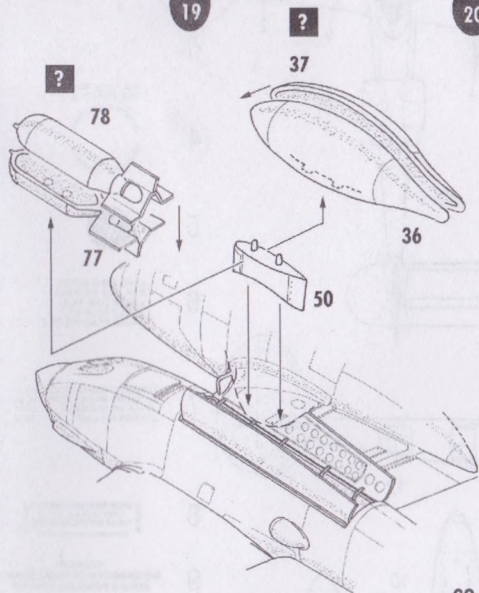

STEP 21

STEP 22

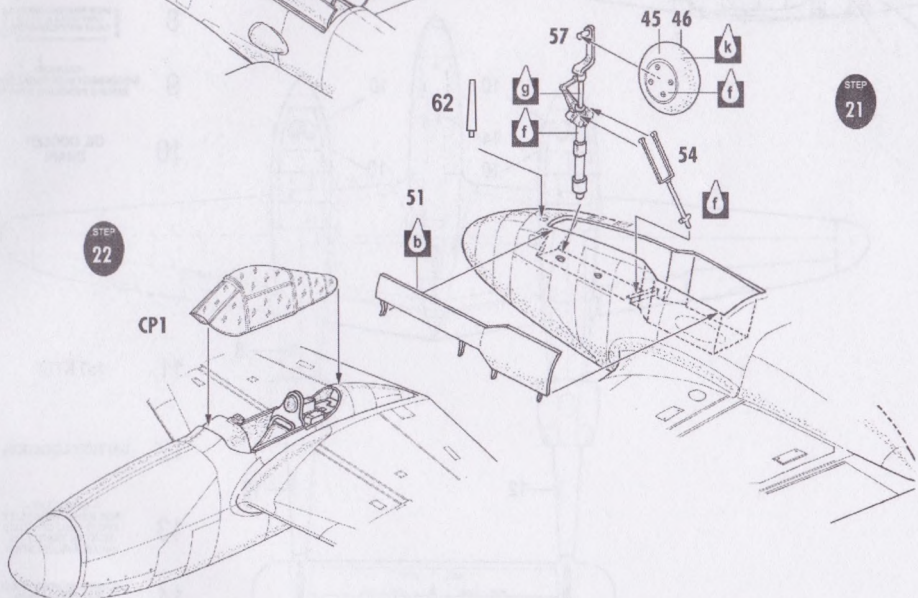

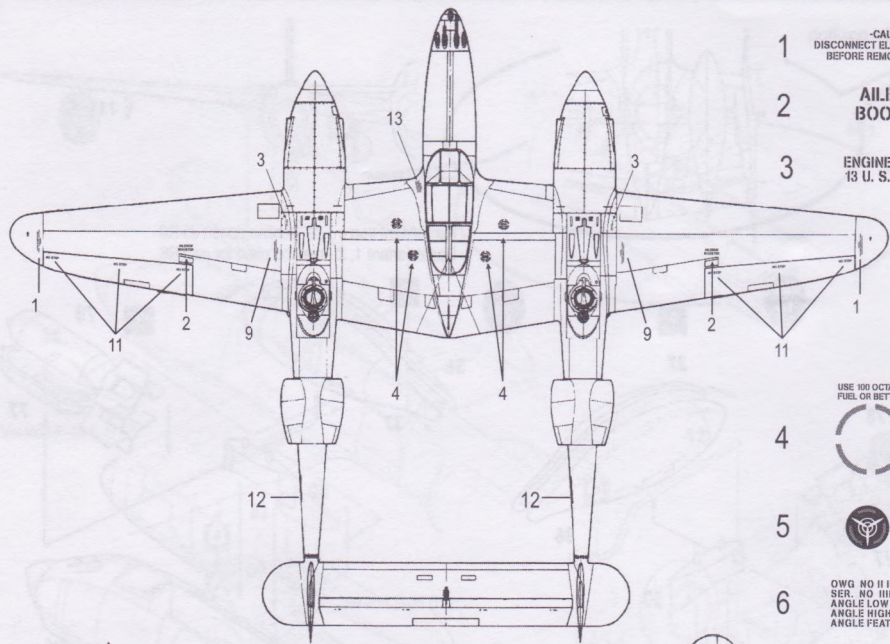

1 -CAUTION-  
DISCONNECT ELECTRICAL WIRING  
BEFORE REMOVING WING TIP

2 **AILERON  
BOOSTER**

3 **ENGINE OIL  
13 U. S. GALLONS**

USE 100 OCTANE  
FUEL OR BETTER



5 **OWG NO II III IIIII  
SER. NO IIII II IIIII  
ANGLE LOW 23.0  
ANGLE HIGH 27.7  
ANGLE FEATHER 87.5**

6 **FURTHEST FORWARD LOAD 148.10  
GROSS WT. WHEELS DOWN 151.88  
GROSS WT. WHEELS UP 154.71  
FURTHER AFT LOAD 56.10**

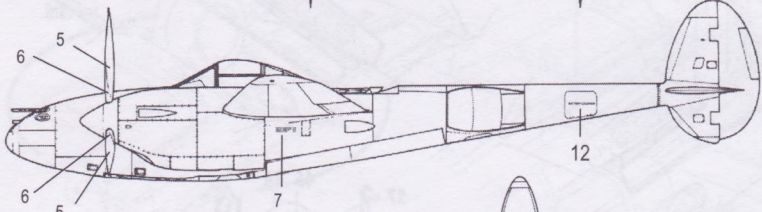

8 **WHEN REMOVING BATTERY  
CARRY CABLE BY HAND  
CABLE MUST CLEAR HERE**

9 -CAUTION-  
DISCONNECT ELECTRICAL WIRING  
BEFORE REMOVING WING TIP

10 **OIL COOLER  
DRAIN**

11 **NO STEP**

12 **BATTERY LOCATION**

13 **-- IMPORTANT --  
FOR MANEUVERABILITY  
FRONT EDGE OF FILLET  
MUST BE TIGHTLY ON  
MICARTA FILLER STRIP**

14 **TO REMOVE NOSE WHEEL  
PULL DOWN LEVER  
UNTIL WHEEL CLEARS GROUND**

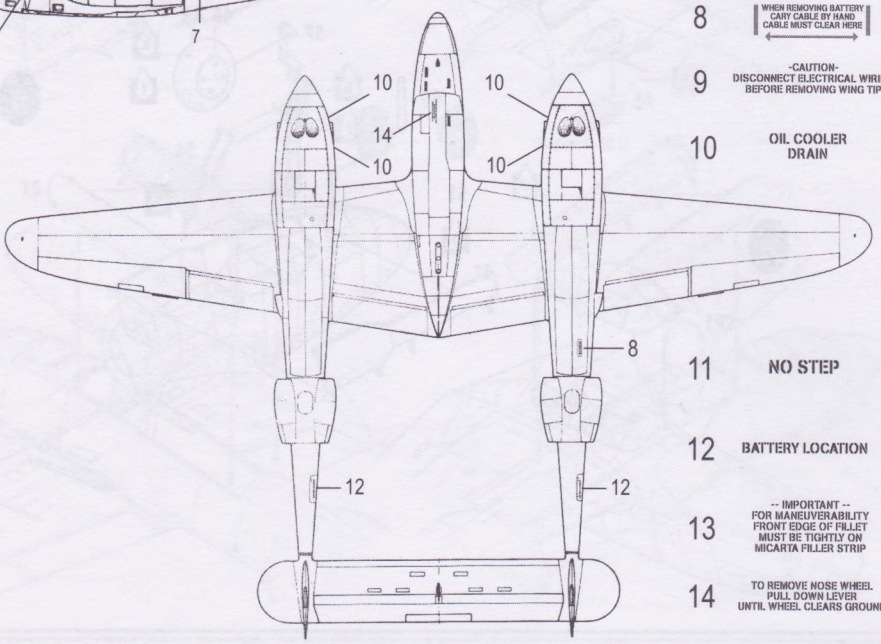



① P-38F-1, Lt Jack M Ilfrey, 94th FS/1st FG, Nouvion, Algeria, March 1943

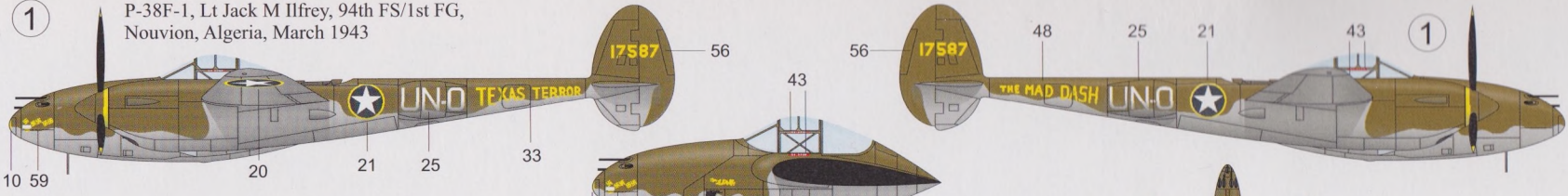

② P-38F-1 of the 27 FS, 1 FG, Lt Edward Newbury, Tunisia, 1943

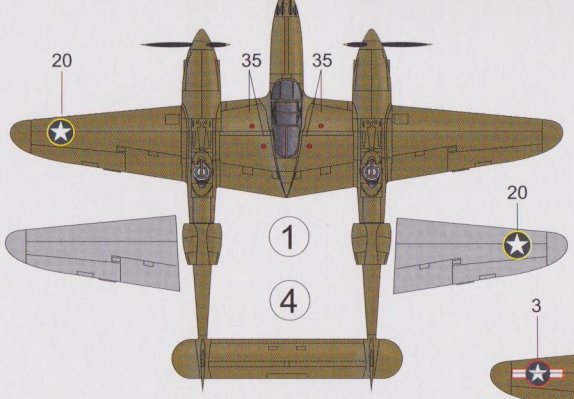
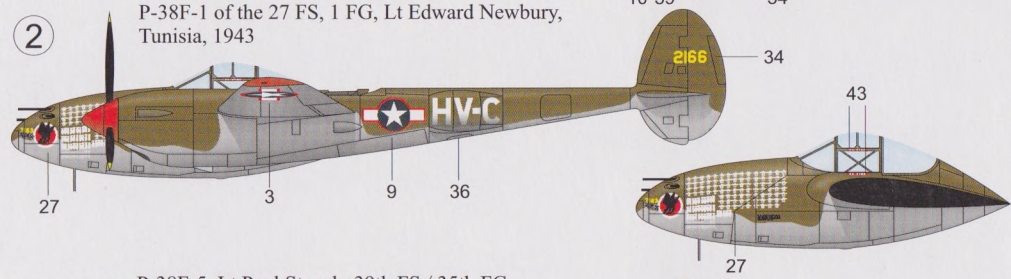

③ P-38F-5, Lt Paul Stanch, 39th FS / 35th FG, Port Moresby, January 1943

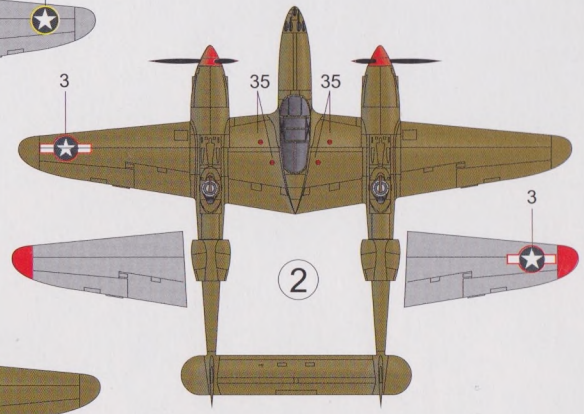
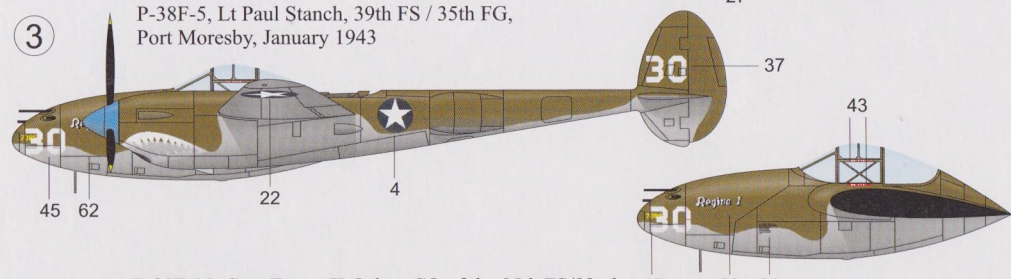

④ P-38F-15, Capt Ernest K Osher, CO of the 95th FS/82nd FG, Bertheaux, Algeria, May 1943

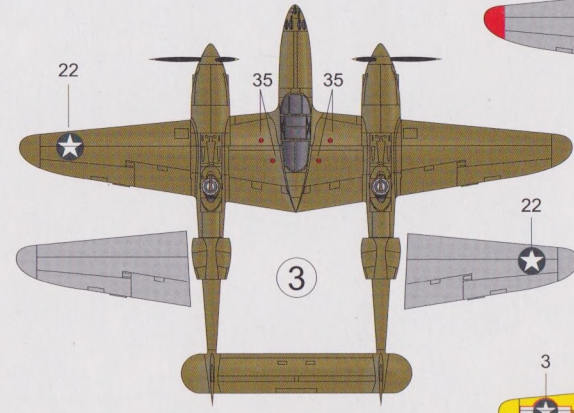
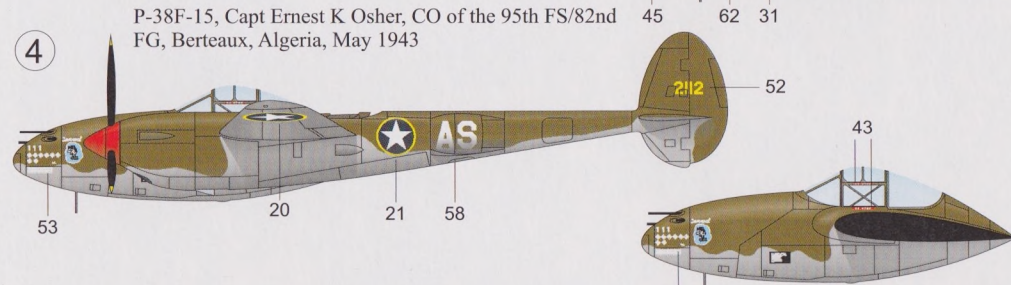

⑤ P-38F-15, Capt James J. Hagenback, 94th FS, 1st FG, 12th AF, Sardinia, 1943

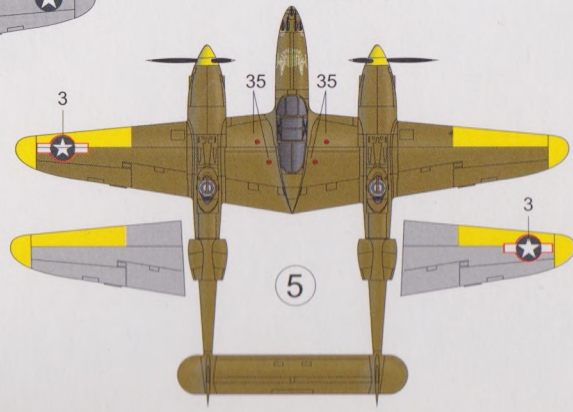
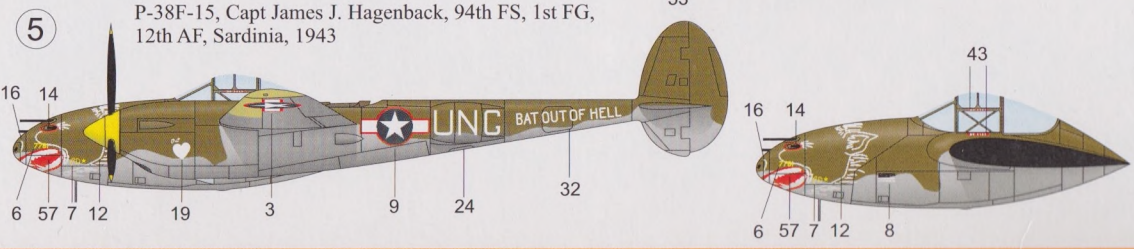

- Olive Drab
- Neutral Grey
- Černá / Black
- Žlutá / Yellow
- Červená / Red
- Modrá / Blue

