

The Opel Maultier was the indirect result of a "marriage of convenience" performed by members of a German SS field recovery and maintenance unit operating in Russia in spring of 1942. It seems that in Russia's rainy season dirt roads become nearly as deep with mud as they are wide and wheeled vehicles bog down quickly. Tracked vehicles are the answer to this problem so with this in mind the soldiers of the maintenance unit mentioned above took the running gear and treads from a captured Soviet Carden-Lloyd light tank and adapted the body and chassis of a Ford truck to them.

The resulting lash-up proved so practical for the conditions in Russia at that time that it was decided to adapt the Opel Blitz truck, then the standard German armed forces transport and cargo carrier, to the same arrangement. Many of the British designed Carden-Lloyd light tanks in use by the Russians had been captured in Germany's initial swift advance.

These were rounded up and sent to Germany where the Opel factory began turning out both tracked and wheeled versions of their famous "Blitz" truck.

The Opel Maultier was highly successful in Russia and formed the inspiration and the basis for the rocket launching Sd. Kfz 4/1 that appeared later.

SPECIFICATIONS

Length: 19' 8-1/4" (6.0 m)

Width: 7' 5-3/4" (2.28 m)

Height: 8' 10-5/8" (2.71 m)

Gross Weight: 8,665 lbs (3,930 kg)

Powerplant: . . Opel six cylinder watercooled, 3,626 cc gasoline engine of 68 hp at 3,120 rpm

Gearbox: Five forward speeds and reverse.

Brakes: Hydraulic type. Servo brakes for track-steering.

GET YOUR TOOLS READY:

BEFORE YOU BEGIN

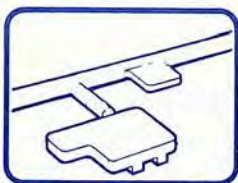

REMOVE PART WHEN CALLED FOR

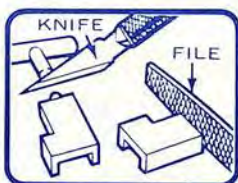

TO REMOVE AND TRIM PARTS

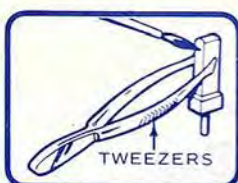

TO HOLD PARTS

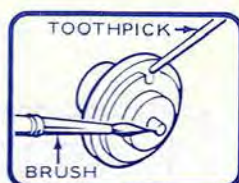

TO APPLY CEMENT



TO HOLD PARTS AFTER CEMENTING

HELPFUL MODELING HINTS.

1. Fit parts together before cementing.
2. Trim away excess plastic.
3. Use cement sparingly, too much will damage your model.

4. Paint small parts **before** detaching from runner.

5. **TO OBTAIN A GOOD BOND, REMOVE PAINT WHERE PARTS ARE TO BE CEMENTED.**

IF YOU WISH TO STOP AT ANY POINT DURING THE CONSTRUCTION OF YOUR MODEL, DO SO ONLY AT THE END OF AN ASSEMBLY STEP.

COLORS REQUIRED FOR OPEL MAULTIER TRUCK

MOLDED COLOR IS SAND.
(USE F.S. 30257 IF PAINTING)

FLAT BLACK	F.S. 37038
FLAT DARK GREEN	F.S. 34079
FLAT DARK GRAY	F.S. 36118
FLAT DARK BROWN	F.S. 30108

For modelers wishing to paint their models in authentic colors we have included the Federal Standard Color Numbers. These numbers refer to color samples printed in FS 595. Copies may be purchased for \$2.75 each from:

THE GENERAL SERVICE ADMINISTRATION
SPECIFICATIONS SECTION
Building 197, STOP 249
WASHINGTON, D.C. 20407

CAUTION

PLASTIC PARTS ARE NOT NUMBERED. USE THESE ILLUSTRATIONS AS A GUIDE IN ASSEMBLING THIS KIT. DO NOT REMOVE PARTS UNTIL YOU ARE READY TO USE THEM.

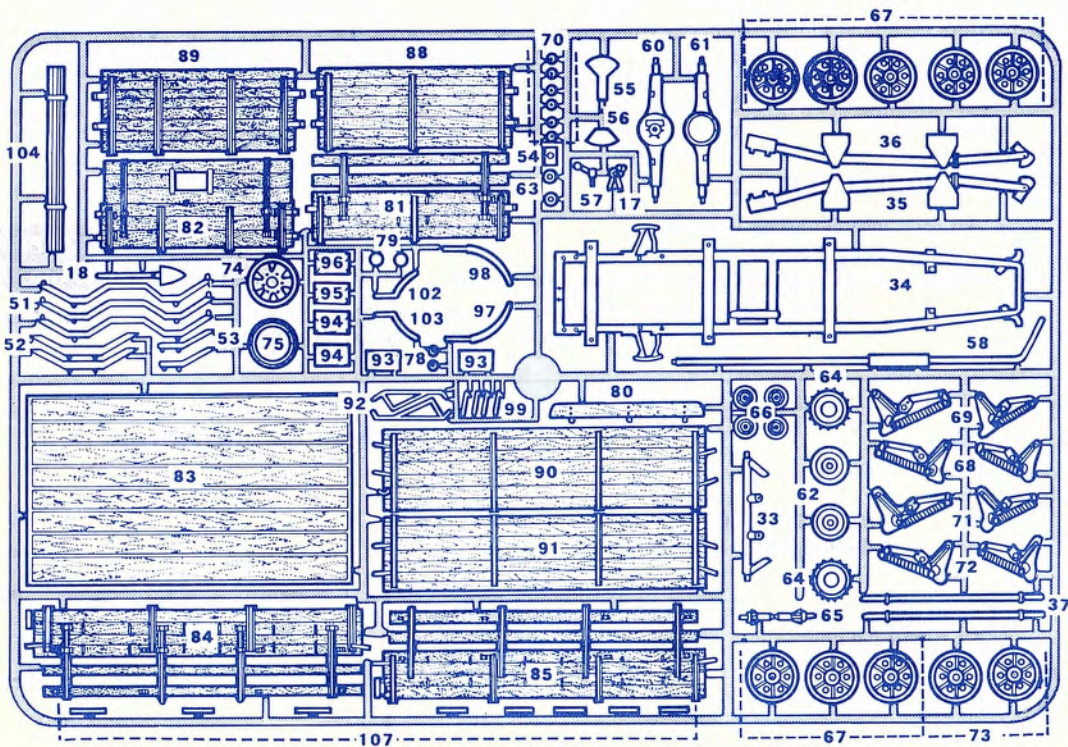
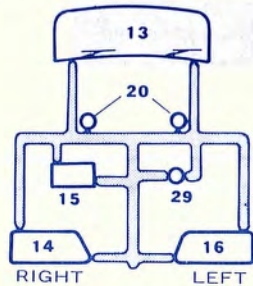
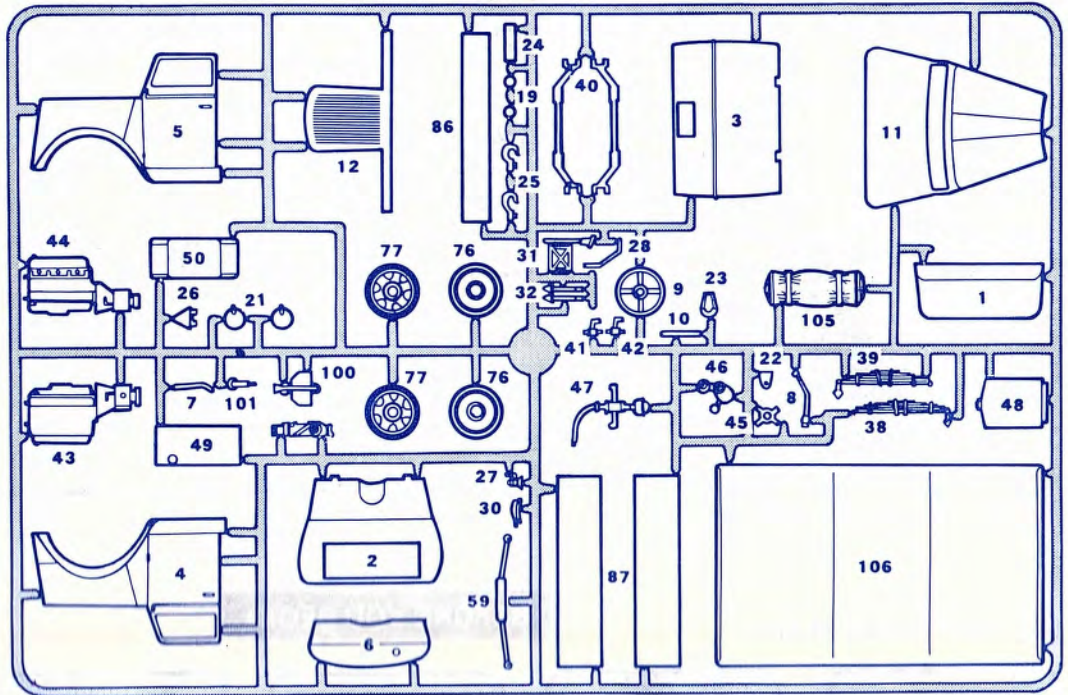
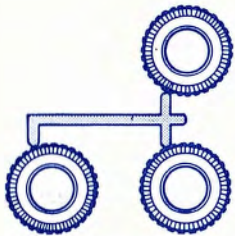
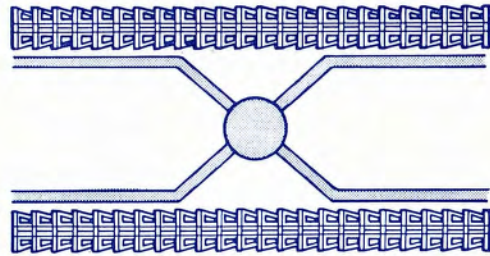

1 CAB INTERIOR DETAILS

- 1 SEAT
- 2 FLOOR
- 3 PANEL, REAR, CAB
- 4 FENDER/DOOR, RIGHT
- 5 FENDER/DOOR, LEFT
- 6 DASHBOARD
- 7 HAND BRAKE
- 8 GEARSHIFT
- 9 WHEEL, STEERING
- 10 COLUMN, STEERING

DETAIL A

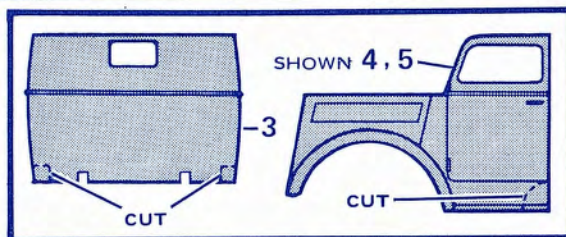

INTERIOR FLAT DARK GRAY

1. Cement (1) to (2). Cut off corners of (3) as shown (see DETAIL A), and cement (3) to (1) and (2).
2. Cut off corner of (4) as shown and cement (4) to (2) and (3). Notice that the DOOR must project out a bit at the rear in order to match the contours of (2) and the edge of (3).
3. Cut off corner of (5) as shown and cement (5) to (2) and (3).
4. Cement (6) to (4) and (5).
5. Cement (7) and (8) to FLOOR; then cement (9) to (10) and cement (10) to (6).

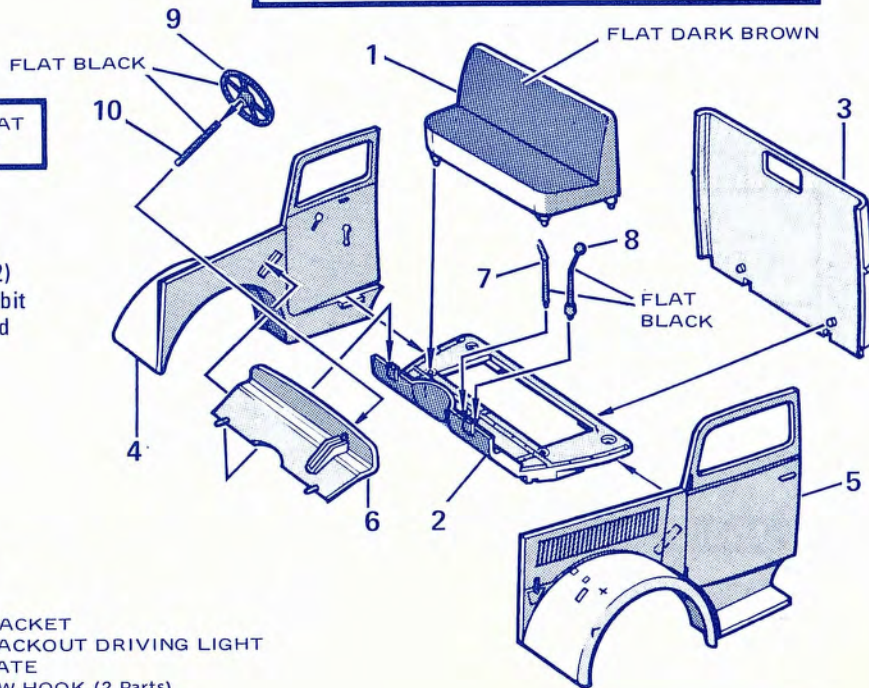

2 CAB EXTERIOR DETAILS

- 11 HOOD/ROOF
- 12 RADIATOR GRILLE/BUMPER
- 13 WINDSHIELD, CLEAR
- 14 WINDOW, RIGHT DOOR, CLEAR
- 15 WINDOW, REAR, CLEAR
- 16 WINDOW, LEFT DOOR, CLEAR
- 17 BRACKET
- 18 SHOVEL
- 19 BLACKOUT MASK
- 20 LENS, CLEAR (2 Parts)
- 21 HEADLIGHT (2 Parts)
- 22 BRACKET
- 23 BLACKOUT DRIVING LIGHT
- 24 PLATE
- 25 TOW HOOK (2 Parts)
- 26 SIGN, FOLDING
- 27 HORN
- 28 BRACKET, MIRROR
- 29 MIRROR, CLEAR
- 30 ORNAMENT, HOOD
- 31 PENNANT FRAME
- 32 WIDTH INDICATOR (2 Parts)

ALL PARTS BASIC VEHICLE COLOR UNLESS OTHERWISE SPECIFIED

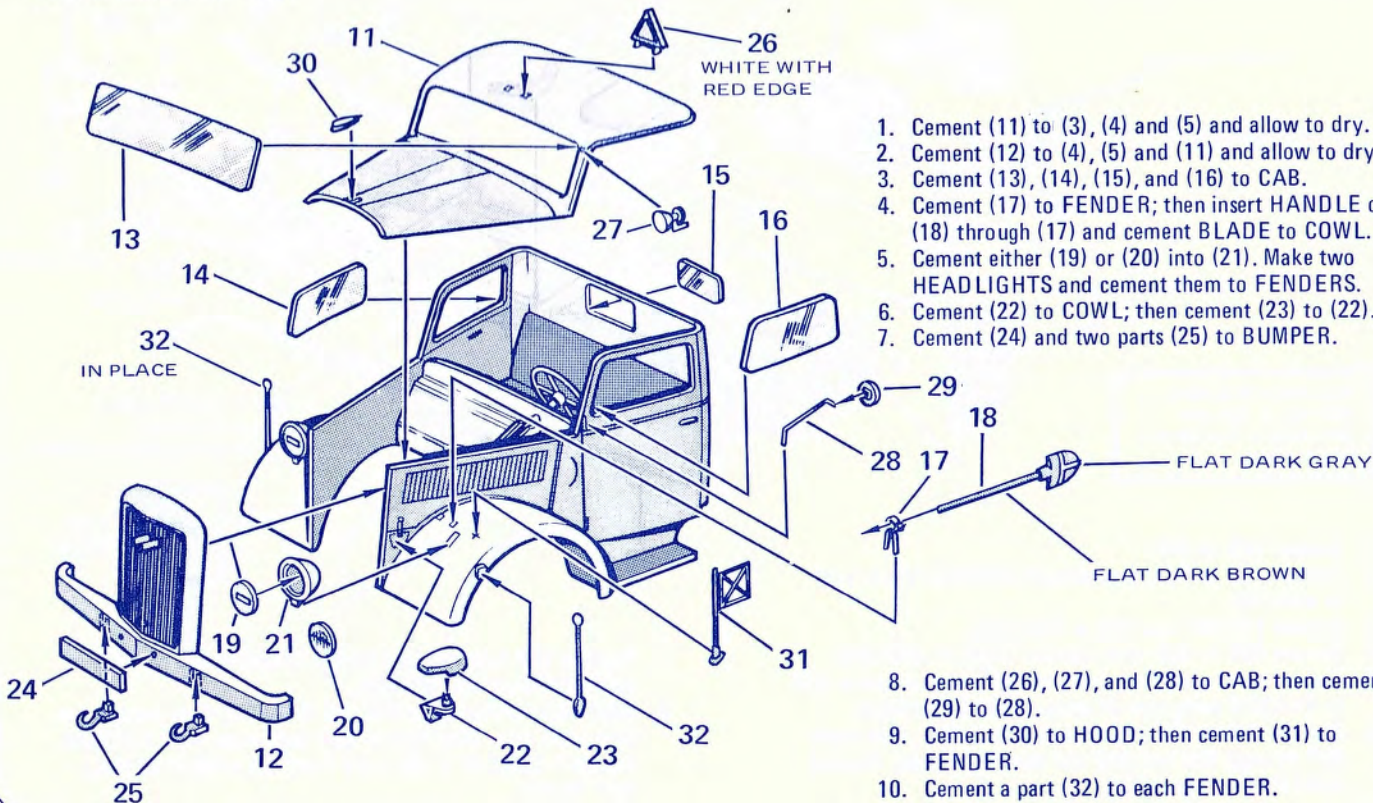

1. Cement (11) to (3), (4) and (5) and allow to dry.
2. Cement (12) to (4), (5) and (11) and allow to dry.
3. Cement (13), (14), (15), and (16) to CAB.
4. Cement (17) to FENDER; then insert HANDLE of (18) through (17) and cement BLADE to COWL.
5. Cement either (19) or (20) into (21). Make two HEADLIGHTS and cement them to FENDERS.
6. Cement (22) to COWL; then cement (23) to (22).
7. Cement (24) and two parts (25) to BUMPER.

8. Cement (26), (27), and (28) to CAB; then cement (29) to (28).
9. Cement (30) to HOOD; then cement (31) to FENDER.
10. Cement a part (32) to each FENDER.

3 CHASSIS DETAILS

- 33 SUB FRAME, AXLE, REAR
- 34 FRAME
- 35 SUB-FRAME/AXLE, LEFT
- 36 SUB-FRAME/AXLE, RIGHT
- 37 AXLE (2 Parts)
- 38 SPRING ASSEMBLY, LEFT
- 39 SPRING ASSEMBLY, RIGHT
- 40 DROP AXLE HALF (2 Parts)
- 41 AXLE/KINGPIN, LEFT
- 42 AXLE/KINGPIN, RIGHT

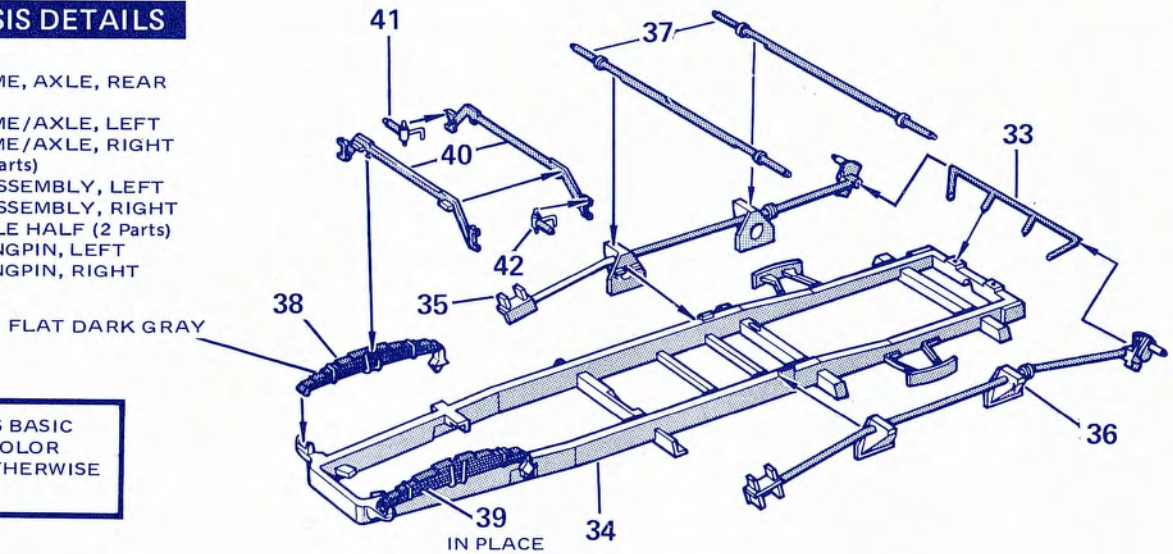

ALL PARTS BASIC VEHICLE COLOR UNLESS OTHERWISE SPECIFIED

1. Cement (33) to (34); then cement (35) and (36) to (33) and (34).
2. Cement two parts (37) to (35) and (36).
3. Cement (38) and (39) to (34).
4. Cement two parts (40) together trapping (41) and (42) in between; then cement ASSEMBLY to (38) and (39). DO NOT ALLOW CEMENT TO TOUCH PARTS (41) AND (42) OR THEY WILL NOT TURN.

4 ENGINE/CHASSIS DETAILS

- | | |
|----------------------------|------------------------------|
| 43 ENGINE HALF, RIGHT | 52 U MEMBER (2 Parts) |
| 44 ENGINE HALF, LEFT | 53 L MEMBER (2 Parts) |
| 45 FAN | 54 PLATE, TOW HITCH MOUNTING |
| 46 WATER PUMP/GENERATOR | 55 TOW HITCH |
| 47 AIR CLEANER/MANIFOLD | 56 SHELL, TOW HITCH |
| 48 RADIATOR | 57 PIN, TOW HITCH |
| 49 TANK, GAS, TOP | 58 EXHAUST PIPE/MUFFLER |
| 50 TANK, GAS, BOTTOM | 59 TIE ROD ASSEMBLY |
| 51 W CROSSMEMBER (3 Parts) | |

FOR A SIMPLE STATIC MODEL, ALL MOVABLE PARTS CAN BE CEMENTED INTO PLACE.

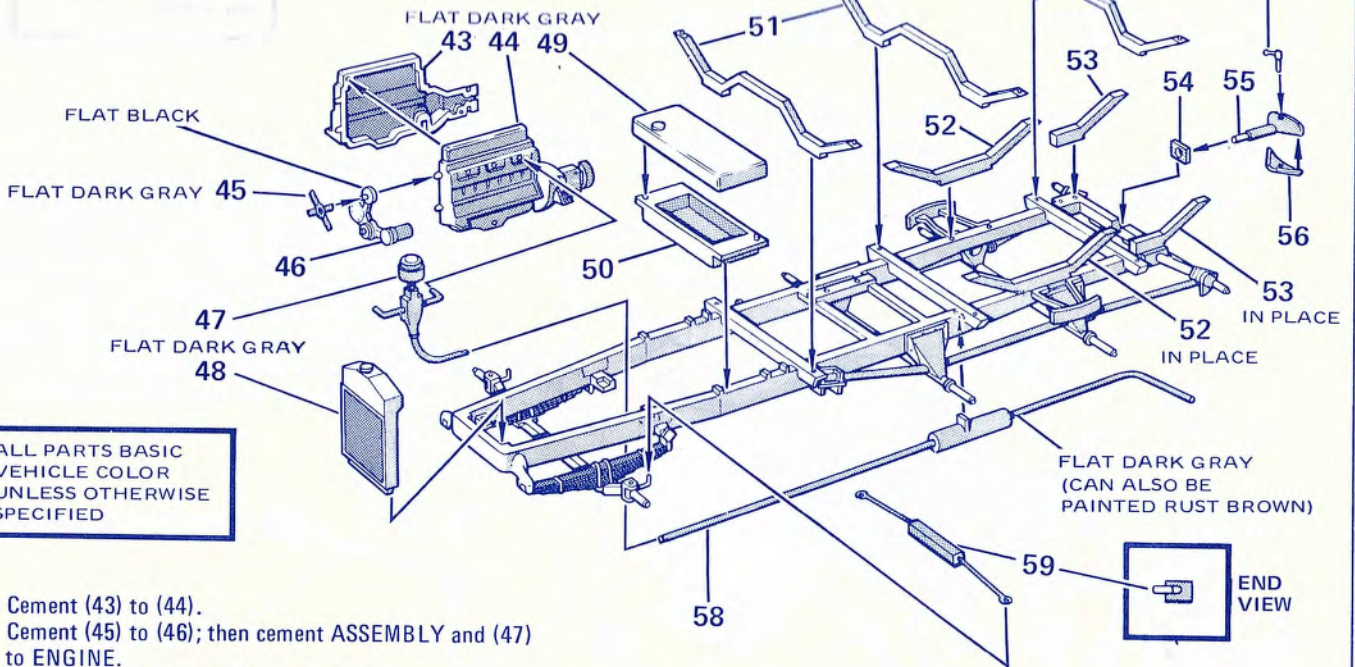

1. Cement (43) to (44).
2. Cement (45) to (46); then cement ASSEMBLY and (47) to ENGINE.
3. Cement ENGINE and (48) to CHASSIS.
4. Cement (49) to (50); then cement TANK to CHASSIS.
5. Cement three parts (51), two parts (52) and two parts (53) to CHASSIS being sure all parts are lined up straight.
6. Cement (54) to (55) and cement (56) to (55); then insert (57) through (55) and (56) and cement in place. Cement ASSEMBLY to CHASSIS.
7. Position (58) between AXLES and CHASSIS and cement to MANIFOLD and CHASSIS.
8. Slide (59) between SPRINGS and CHASSIS; then engage eyes with pivot pins. Note thicker part faces away from CHASSIS. DO NOT CEMENT EYES AND PINS OR KINGPINS WILL NOT PIVOT.

5

BOGIES/WHEELS/TIRES

- 60 DIFFERENTIAL HOUSING HALF, FRONT
- 61 DIFFERENTIAL HOUSING HALF, REAR
- 62 BRAKEDRUM (2 Parts)
- 63 RETAINER (2 Parts)
- 64 SPROCKET, DRIVE (2 Parts)
- 65 SHAFT ASSEMBLY, DRIVE
- 66 RETURN ROLLER (4 Parts)
- 67 WHEEL, BOGIE (8 Parts)
- 68 SUSPENSION HALF, INBOARD (2 Parts)
- 69 SUSPENSION HALF, OUTBOARD (2 Parts)

- 70 RETAINER (4 Parts)
- 71 SUSPENSION HALF, INBOARD (2 Parts)
- 72 SUSPENSION HALF, OUTBOARD (2 Parts)
- 73 WHEEL IDLER (2 Parts)
- 74 WHEEL HALF/MOUNTING STUDS, SPARE
- 75 WHEEL HALF/PLAIN, SPARE
- 76 WHEEL HALF, INBOARD (2 Parts)
- 77 WHEEL HALF, OUTBOARD (2 Parts)
- 78 RETAINER (2 Parts)
- 79 HUB (2 Parts)

DETAIL A

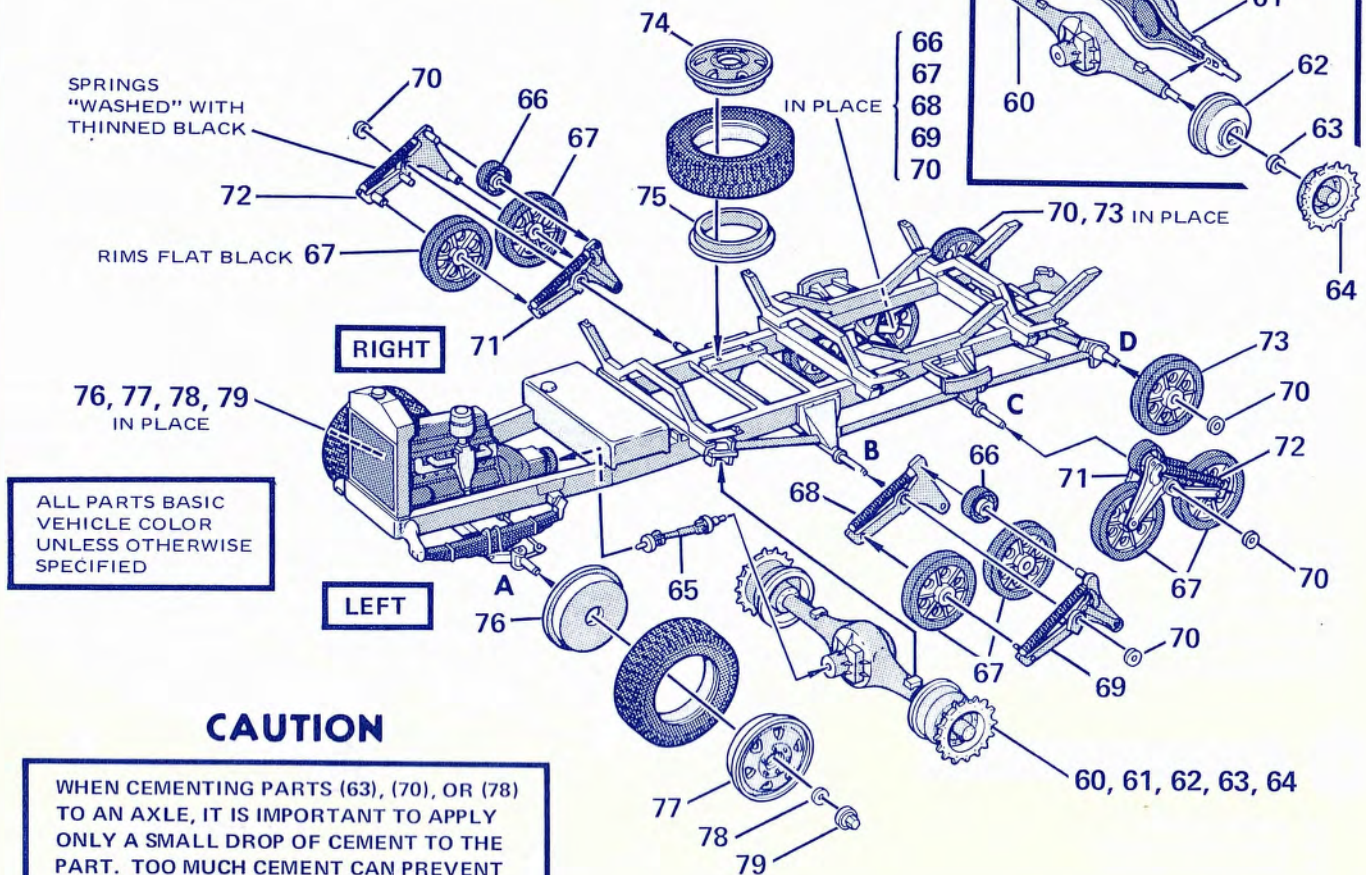
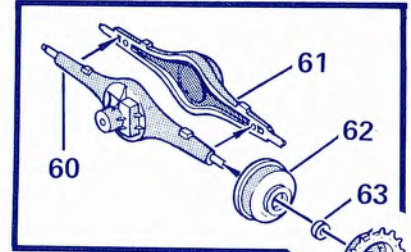

CAUTION

WHEN CEMENTING PARTS (63), (70), OR (78) TO AN AXLE, IT IS IMPORTANT TO APPLY ONLY A SMALL DROP OF CEMENT TO THE PART. TOO MUCH CEMENT CAN PREVENT FREE MOVEMENT OF ADJACENT PARTS.

1. Cement (60) to (61).
2. Slide (62) onto AXLE of DIFFERENTIAL HOUSING; then position (63) on AXLE and hold in place with a drop of cement. DO NOT ALLOW CEMENT TO TOUCH (62) OR WHEEL WILL NOT TURN. Repeat this procedure with remaining parts (62) and (63) (See DETAIL A).
3. Cement a part (64) to each part (62).
4. Lightly cement (65) into DIFFERENTIAL; then position other end of (65) into TRANSMISSION and cement DIFFERENTIAL to CHASSIS.
5. Assemble LEFT FRONT BOGIE by trapping (66) and two parts (67) between (68) and (69). Place a drop of cement on both AXLES of (69) where they protrude through (68). DO NOT ALLOW CEMENT TO TOUCH WHEELS OR THEY WILL NOT TURN. Repeat procedure with an identical set of parts for RIGHT REAR BOGIE.
6. Mount LEFT FRONT BOGIE onto LEFT side of AXLE B; then position (70) on AXLE and hold in place with a drop of cement. DO NOT ALLOW CEMENT TO TOUCH BOGIE OR BOGIE WILL NOT PIVOT. Repeat procedure with RIGHT REAR BOGIE on RIGHT side of AXLE C.
7. Assemble RIGHT FRONT BOGIE by trapping (66) and two parts (67) between (71) and (72). Place a drop of cement on both AXLES where they protrude through (71). DO NOT ALLOW CEMENT TO TOUCH WHEELS OR THEY WILL NOT TURN. Repeat procedure with an identical set of parts for LEFT REAR BOGIE.
8. Mount RIGHT FRONT BOGIE onto RIGHT side of AXLE B; then position (70) on AXLE and hold in place with a drop of cement. DO NOT ALLOW CEMENT TO TOUCH BOGIE OR BOGIE WILL NOT PIVOT. Repeat procedure with LEFT REAR BOGIE on LEFT side of AXLE C.
9. Slide (73) onto AXLE D; then position (70) on AXLE and hold in place with a drop of cement. DO NOT ALLOW CEMENT TO TOUCH AXLE OR WHEEL WILL NOT TURN. Repeat procedure with remaining parts (70) and (73).
10. Trap a TIRE between (74) and (75); then cement (74) to CHASSIS.
11. Trap a TIRE between (76) and (77) and cement (76) and (77) together. Repeat procedure with remaining parts (76) and (77).
12. Mount WHEEL/TIRE on STUB AXLE A; then position (78) on AXLE and hold in place with a drop of cement. Repeat procedure with second WHEEL/TIRE. Cement a (79) to each (78).

6 STAKE-SIDE BOX

- 80 STEP, FOLDING
- 81 TAILGATE
- 82 PANEL, FRONT
- 83 BED
- 84 PANEL, RIGHT SIDE
- 85 PANEL, LEFT SIDE
- 86 BENCH, NARROW
- 87 BENCH, WIDE (2 Parts)

THE STAKE-SIDE BOX IS ONE OF TWO OPTIONS AVAILABLE TO YOU WHEN BUILDING THIS VEHICLE. THE OTHER IS THE SOLID-SIDE BOX (STEP 7). COMPLETE STEP 8 REGARDLESS OF WHICH OPTION YOU CHOOSE.

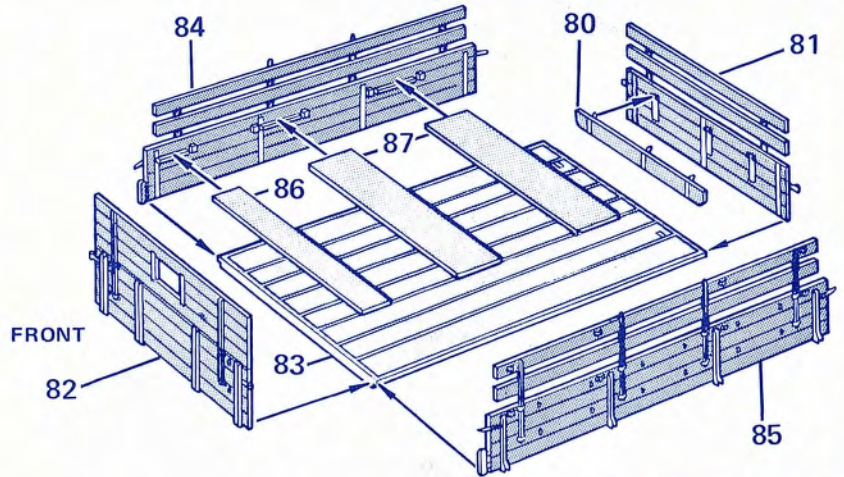

1. Cement (80) to (81) as shown.
2. Cement (81) and (82) to (83). Center and square up both ends.
3. Cement (84) and (85) to (81), (82), and (83).

4. Cement (86) and two parts (87) to (84) and (85).
5. If you built the STAKE-SIDE BOX ignore Step 7 and proceed to Step 8.

ALL PARTS BASIC VEHICLE COLOR UNLESS OTHERWISE SPECIFIED

7 SOLID-SIDE BOX

- 88 TAILGATE
- 89 PANEL, FRONT
- 90 PANEL, RIGHT SIDE
- 91 PANEL, LEFT SIDE
- 92 BRACKET, HANDHOLD (2 Parts)

1. Cement (80) to (88) as shown.
2. Cement (88) and (89) to (83). Center and square up both ends.
3. Cement (90) and (91) to (83), (88), and (89).
4. Cement two parts (92) as shown; then cement (86) and two parts (87) to (90) and (91).

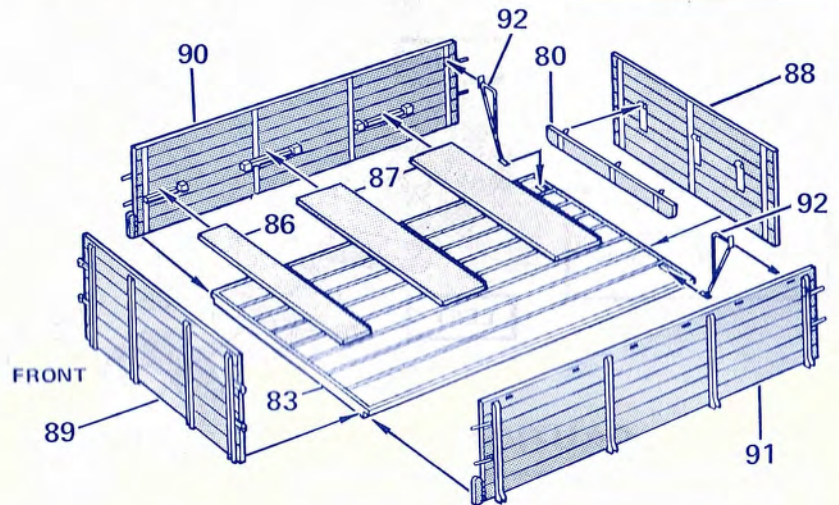

8 BOX BOTTOM DETAILS

- 93 PANEL (3 Parts)
- 94 BOX, LEFT FRONT
- 95 BOX, LEFT REAR
- 96 BOX, RIGHT REAR
- 97 BRACE, FENDER (4 Parts)
- 98 FENDER, LEFT REAR
- 99 FENDER, RIGHT REAR
- 100 PLATE/REFLECTOR ASSEMBLY
- 101 REFLECTOR ASSEMBLY

ALL PARTS BASIC VEHICLE COLOR UNLESS OTHERWISE SPECIFIED

COMPLETE THIS STEP REGARDLESS OF WHICH BOX YOU BUILT.

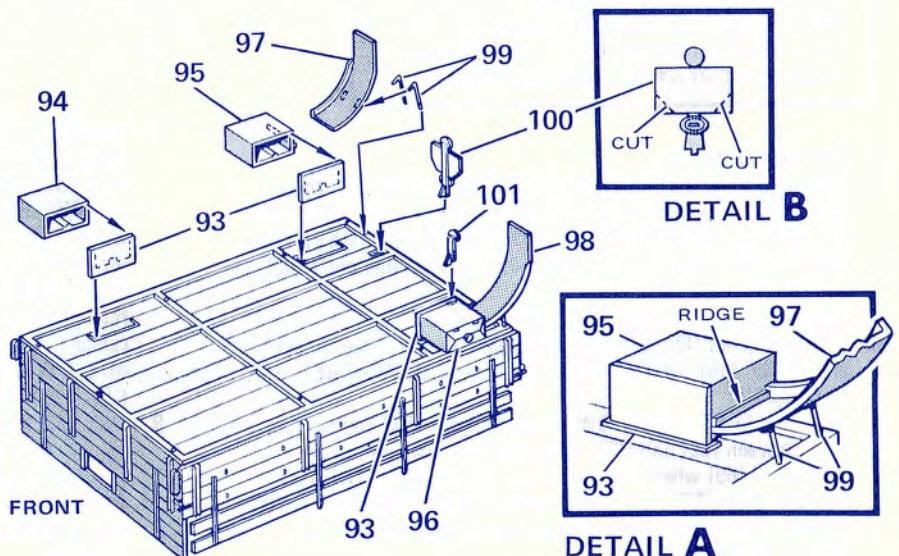

1. Cement a part (93) to each part (94), (95), and (96).
2. Notice that the ridge on one side of (95) and (96) faces aft. Cement (94), (95), and (96) in place.
3. Cement four parts (97) in place (see DETAIL A).

4. Cement four parts (99) in place.
5. Cut corners off (100) (see DETAIL B); then cement (100) and (101) in place.

9

MAJOR COMPONENTS ASSEMBLY

- 102 FENDER, RIGHT FRONT
- 103 FENDER, LEFT FRONT
- 104 BOWS, TARPAULIN
- 105 TARPAULIN, ROLLED

THE STAKE-SIDE AND THE SOLID-SIDE BOXES CAN BE COVERED OR UNCOVERED. THIS STEP CONCERNS THE UNCOVERED VERSION WHILE STEP 10 DETAILS THE COVERED VERSION.

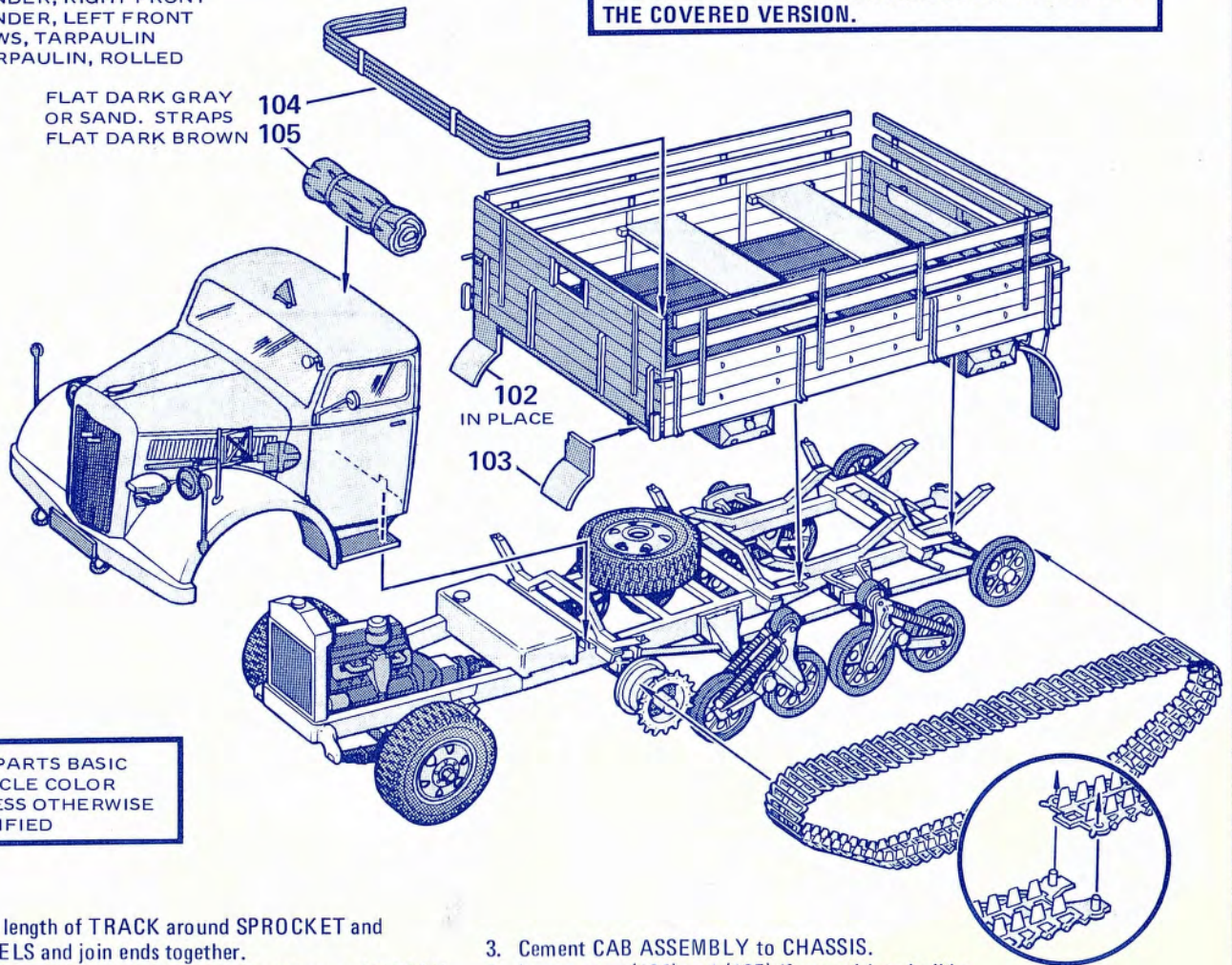

ALL PARTS BASIC VEHICLE COLOR UNLESS OTHERWISE SPECIFIED

1. Wrap length of TRACK around SPROCKET and WHEELS and join ends together. Use tweezers to seat ends. Repeat with second TRACK.
2. Cement (102) and (103) to BOX ASSEMBLY; then cement BOX to CHASSIS (there are fifteen points of contact between the two).
3. Cement CAB ASSEMBLY to CHASSIS.
4. Ignore parts (104) and (105) if you wish to build a covered version and proceed to Step 10. For the uncovered version cement (104) to top of BOX; then cement (105) to (104) and top of CAB.

10

COVERED TOP DETAILS

- 106 TARPAULIN, ERECTED
- 107 BRACE (8 Parts)

ALL PARTS BASIC VEHICLE COLOR UNLESS OTHERWISE SPECIFIED

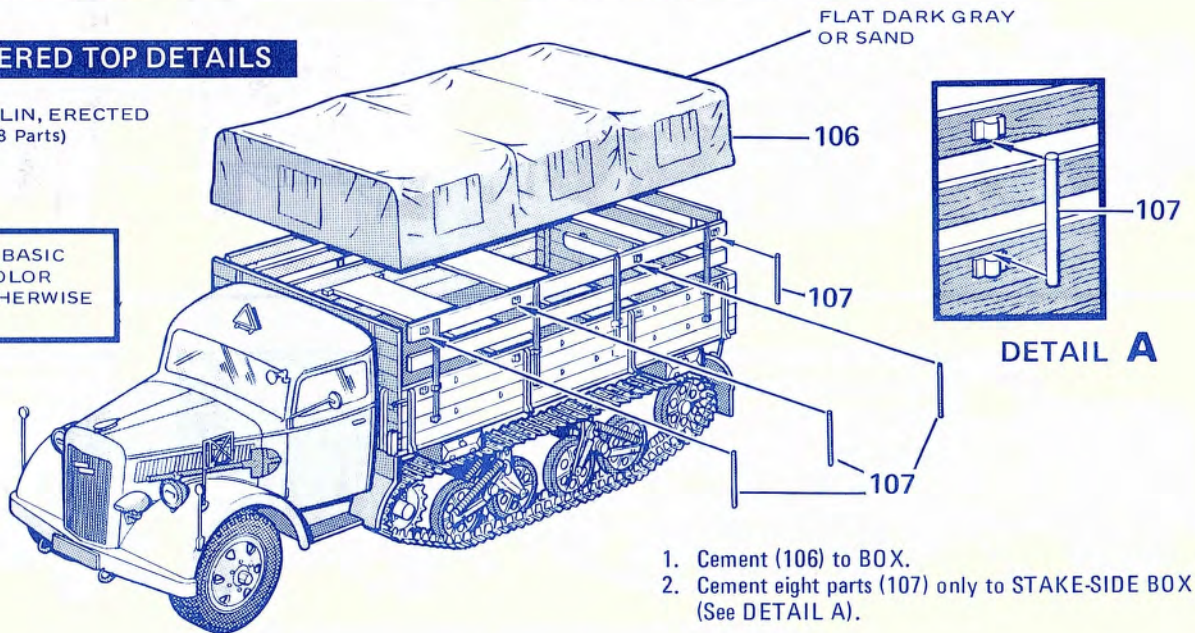

1. Cement (106) to BOX.
2. Cement eight parts (107) only to STAKE-SIDE BOX (See DETAIL A).

11

PAINTING AND DECALS



REFER TO BOX COVER FOR AID IN PAINTING AND DECAL PLACEMENT.

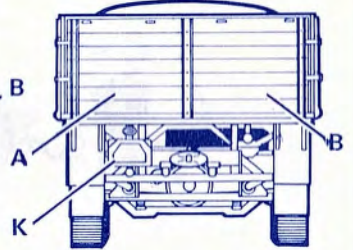
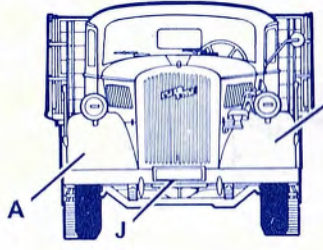
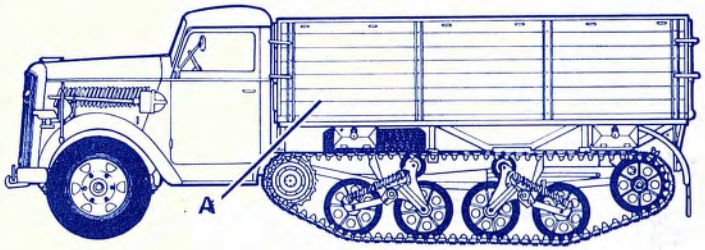
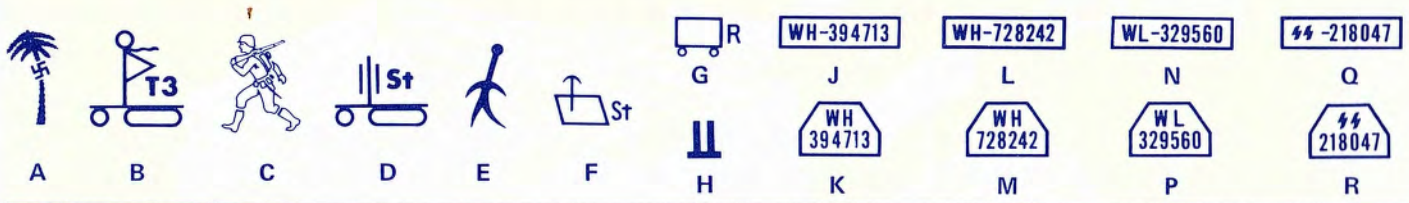

5TH PANZER ARMY, AFRICA, MAY 1943

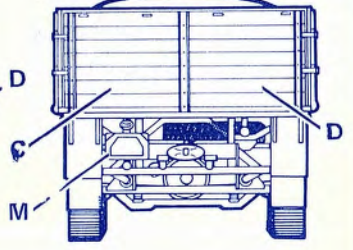
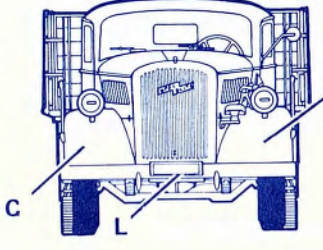
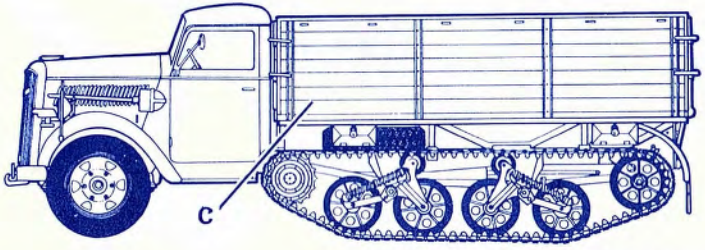

11TH SS ARMY CORPS, UKRAINE, SEPTEMBER 1944

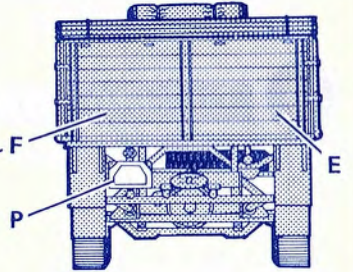
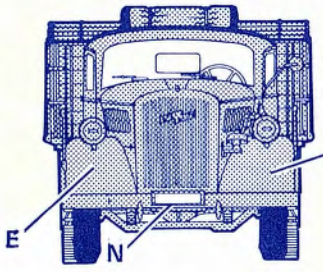
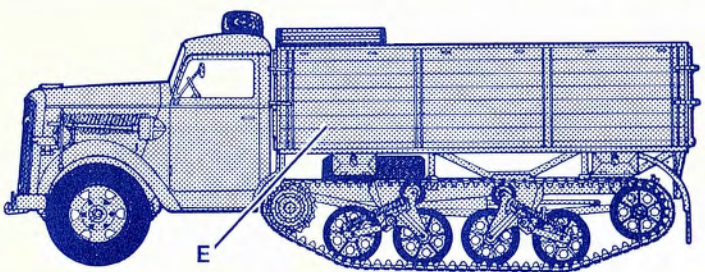

SS DIVISION (DAS REICH), MOSCOW, APRIL 1942

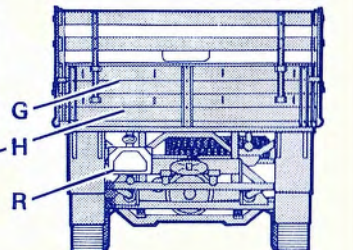
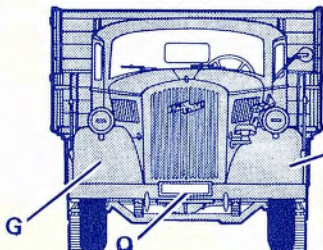
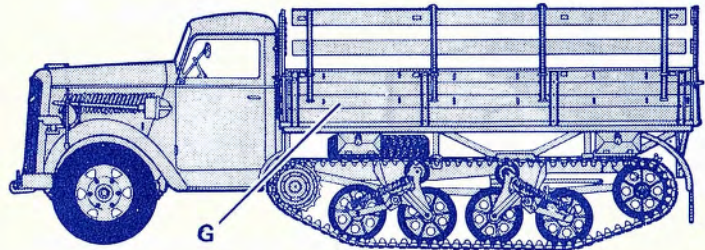

LUFTWAFFE FIELD DIVISION, RUSSIA, OCTOBER 1943

H-2116

⚡ - 218 047



⚡
218 047

WH - 394 713



WH
394 713

WL - 329 560



WL
329 560

WH - 728 242



WH
728 242