

Sturmmörser Tiger

For both parties participated in the Battle of Stalingrad on later part of 1942, it was, beyond all doubts, a turning point of the Second World War. In this brutal battle, both German and Russian had to attack and counter-attack in ruins at Stalingrad, inch by inch. In such cases, commonly used direct cannons were less of use, whereas assault howitzers which were able to fully support infantry offensive, gained popularity again.

Nevertheless, there were only handful StuIG 33Bs, carrying 150mm guns, were saw service at Stalingrad, whereas the Sturmpanzer, using PzKpfw IV chassis, was still under development at that time. In the mean time, another larger howitzer project, using Tiger Tank chassis, was also under development. A 210mm howitzer in original plan was not available due to teething problems, therefore it was decided on August 1943, to adopt a short-barreled 38cm Raketenwerfer 61 L/5.4, breech-loading rocket launcher/mortar, covering range of 4,600 to 6,000 meters. The prototype was named as Sturmtiger, finished on October 1943. The authority permitted to convert battle damaged Tiger Tanks into the Sturmtiger on April 1944; and there were 18 such examples completed from August to December that year.

Early Sturmtigers were sent to Poland to suppress Warsaw Uprising, and there were 7 Sturmtigers participated in offensive operations in Ardennes. According to the battle report from PzStuMrKp 1001 (1001st Assault Howitzer Battalion), in one occasion 3 US Army M4 tanks were destroyed with one single rocket projectile. The rest of Sturmtiger were mainly saw combat in the final defense of the Fatherland in 1945. Despite its massive destructive power, most of the Sturmtiger were abandoned or destroyed by their crews after mechanical breakdown or because of fuel shortage.

1942年末のスターリングラード戦を戦った独ソ両軍にとって、その戦いは間違いなく第二次大戦の転換点であったと言える。この壮絶な戦闘の中で両軍は、市内の廃墟の中で一進一退の攻防を繰り返した。このような状況のなかでは、通常の直接射撃の火砲は役に立たなかった一方で、歩兵の攻撃を援護する突撃榴弾砲は高い信頼を得たのだった。

それにもかかわらず、この種の車輛は、150mm砲を装備したStuIG33Bsがごく少数スターリングラードに配備されていたのみで、IV号戦車の車体を利用した新型突撃戦車は開発中の段階であった。その間に全く別の大型榴弾砲をタイガー戦車の車体に搭載する計画が進行していた。A 210mm榴弾砲は種々の問題により計画が頓挫していた。そのため、射程4600~6000mの短砲身38cm61式臼砲 L/5.4を搭載することが、1943年8月に決定した。試作車は1943年10月に完成し、シュツルムタイガーと名付けられた。1944年4月にタイガー戦車の損傷車輛からの改修が許可され、同年8月から12月の間に18輛が改修された。

初期のシュツルムタイガーは、ワルシャワ蜂起鎮圧のためにポーランドへ送られ、また、7輛がアルデンヌ攻勢に参加している。第1001突撃臼砲中隊の戦闘記録によると、1発の発射により3輛のM4 シャーマンを撃破した例が報告されている。残りのシュツルムタイガーは、1945年のドイツ国内の防衛戦に投入されたが、その恐るべき破壊力を存分に発揮することなく、多くは機械故障や燃料切れのために乗員たちによって放棄・破壊されてしまったのである。

1942年下半展開的史達林格勒戰役,是二次大戰德蘇諸多會戰的重要轉捩點之一,戰役中德蘇兩軍在已經成為廢墟的市街中逐街逐巷的反復爭奪,一般的直射火砲在這種斷垣殘壁中能夠發揮的效果有限,因此能夠充分支援步兵戰鬥的突擊榴彈砲其價值在這場戰役中重新得到重視。

然而史達林格勒戰役期間德軍僅有少量搭載150mm重步兵砲的StuIG 33B投入戰場,而採用IV號戰車底盤的Sturmpanzer則尚在開發之中,另外以虎式戰車底盤搭載更大口徑火砲的突擊砲的計畫也正在進行中,原本構想裝備的一種210mm口徑的榴彈砲因為發展並不成功,1943年8月時遂決定搭載改良自海軍所使用的RW 61 380mm口徑L/5.4臼砲,所發射的火箭彈射程能夠達到4600m遠,1943年10月份原型車完成,並被賦與了突擊虎(Sturmtiger)的命名,經過測試後1944年4月批准將戰場上因戰損而汰換下來的虎式戰車改裝為突擊虎,由1944年8月至12月的期間內共完成改裝了十八輛。

早期生產的兩輛突擊虎很快的被派往華沙,鎮壓當地居民的起義抗暴行動,另外有七輛突擊虎參與了亞爾丁森林的反擊作戰,據報導第1001突擊臼砲營的突擊虎即曾以一枚火箭彈摧毀三輛美軍的M4中戰車,其餘的突擊虎分別投入德國本土的防衛戰中,儘管突擊虎擁有強大的破壞力,但因大戰末期燃料與彈藥的缺乏,加上機械的故障,大多數的突擊虎在戰場上都因而遭致了乘員遺棄與破壞的命運。

Illustration:圖示說明



Agglutinate
用膠黏合



No Agglutinate
不用黏合



Make 2 Sets
二組製作



Remove
將其磨去



Optional
選擇使用



Instnt Glue
使用瞬間膠



File Hole
把孔填平



Zimmerit coating
塗佈防磁紋

Method For Applying Decals:

1. Clean Model Surface With Wet Cloth.
2. Cut Out Of Decal Sheet And Dip Them In Water For 15 Seconds.
3. Place it on proper position on model.
4. Slide off base paper leaving decals On Model With Wet Finger Tip.
5. Move Decals To Exact Position, Push Out Excess Water Under Decal With Soft Cotton Cloth.
6. When Decals Get Dry Then Complete.

水貼紙使用說明:

- 1.將模型表面擦乾淨
- 2.將貼紙剪下泡入清水中約15秒
- 3.將泡濕之貼紙取出置於欲貼處旁
- 4.用指尖輕推貼紙表面使其滑出底紙
- 5.將貼紙調整至適當位置並輕擦拭水份
- 6.待其自然乾燥後即完成

Color list: 塗料表

Color	Brand	GSI Creos (Gunze Sangyo)			Humbrol	Revell	Life Color
		Hobby Color	Mr. Color	Mr. Color Spray			
Wood brown	木棕	H-37	C-43	J-43	34	05	UA085/ UA125
Dark green	深綠	H-36/H-405	C-70	J-70	149	363	UA083
Dark yellow	深黃	H-79	C-39	J-39	83	16	UA081
Steel	黑鐵	H-18	C-28	J-28	53	91	LC76
Tire black	輪胎黑	H-77	C-137		85	302	LC02
Red brown	紅褐	H-47	C-41	J-44	160	383	UA082
Metallic green	亮綠	H-89	C-77	J-77	131	364	
Flat white	消光白	H-11	C-62	J-62	34	05	LC01

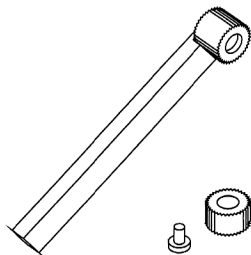

AC 35003 Zimmerit coating applicator doe

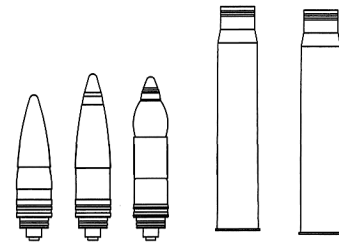

AF 35087 Brass 8.8cm Ammo set(for Flak 18/36/37、Tiger I)

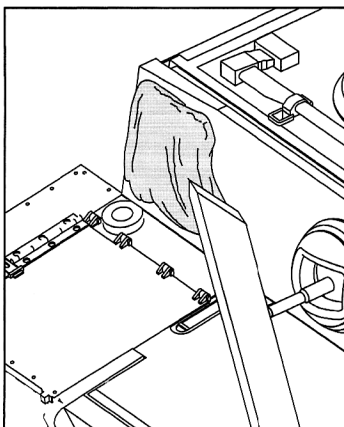

Spread putty in areas to have zimmerit coating.
將補土塗布在要表現防磁紋區域

Use the AFV Club 1/35 scale zimmerit roller over the area with putty. (Please note the 2 different width for the best result.)
使用本產品滾出所要表現的紋路 (滾輪有2種寬度可供選擇)

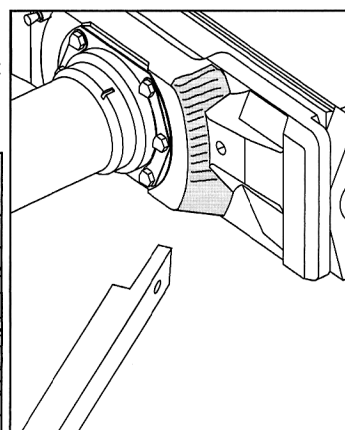
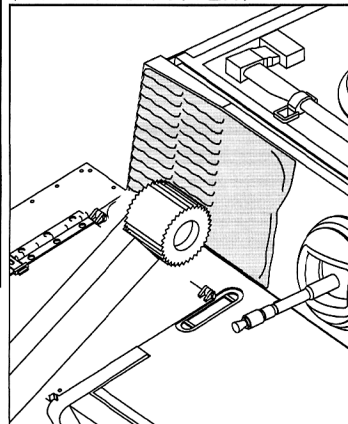

At areas not reached by the roller, please switch to use the 1/35 scale zimmerit stamp at either end of the handle instead.
在轉角和滾輪滾不到的死角,請使用滾輪桿兩端的刻紋,壓印出紋路

Please constantly check to make sure the roller is free from any left over putty for best results.
請注意隨時清除沾黏在滾輪上的補土,使工具保持在最佳狀態

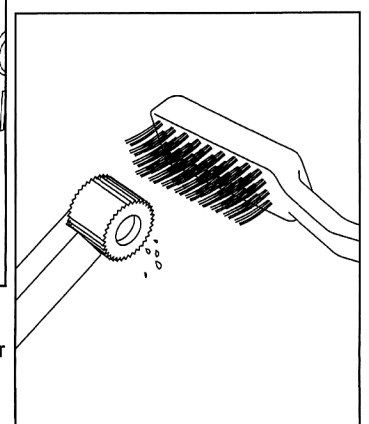

1

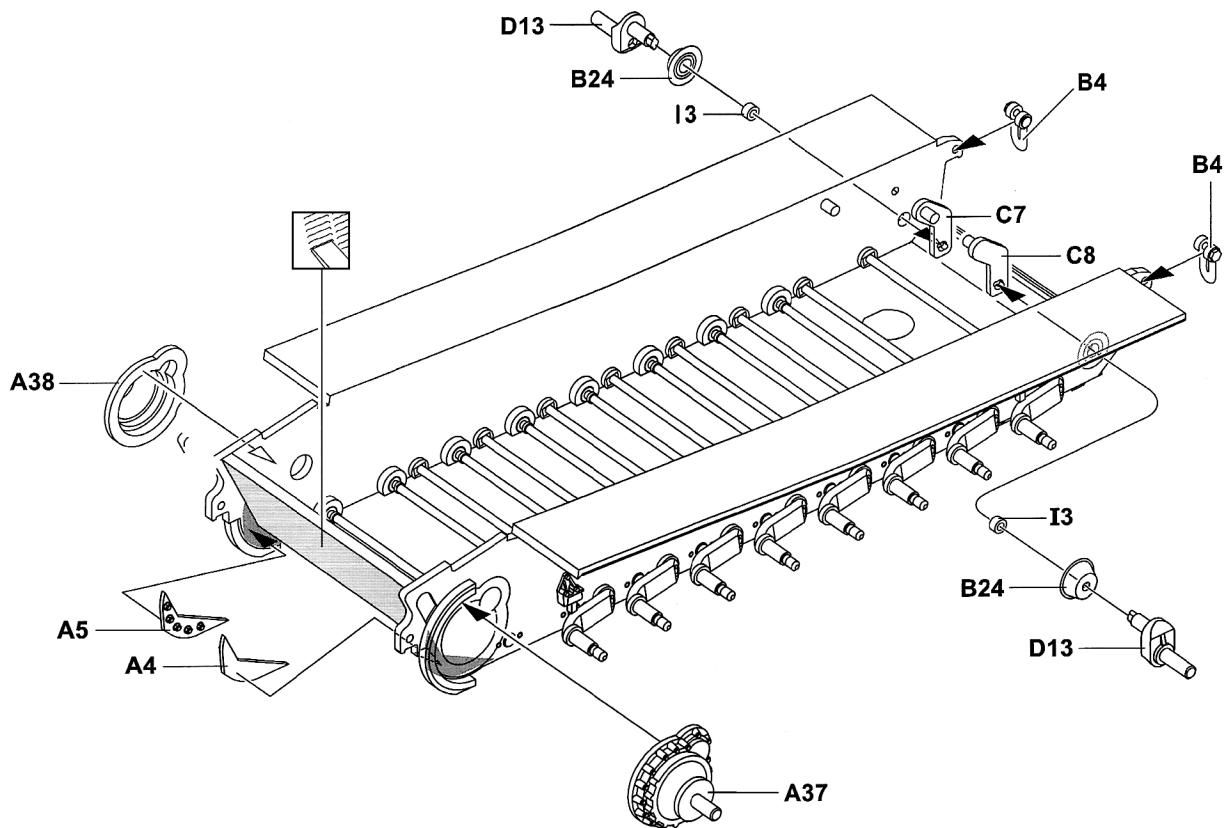
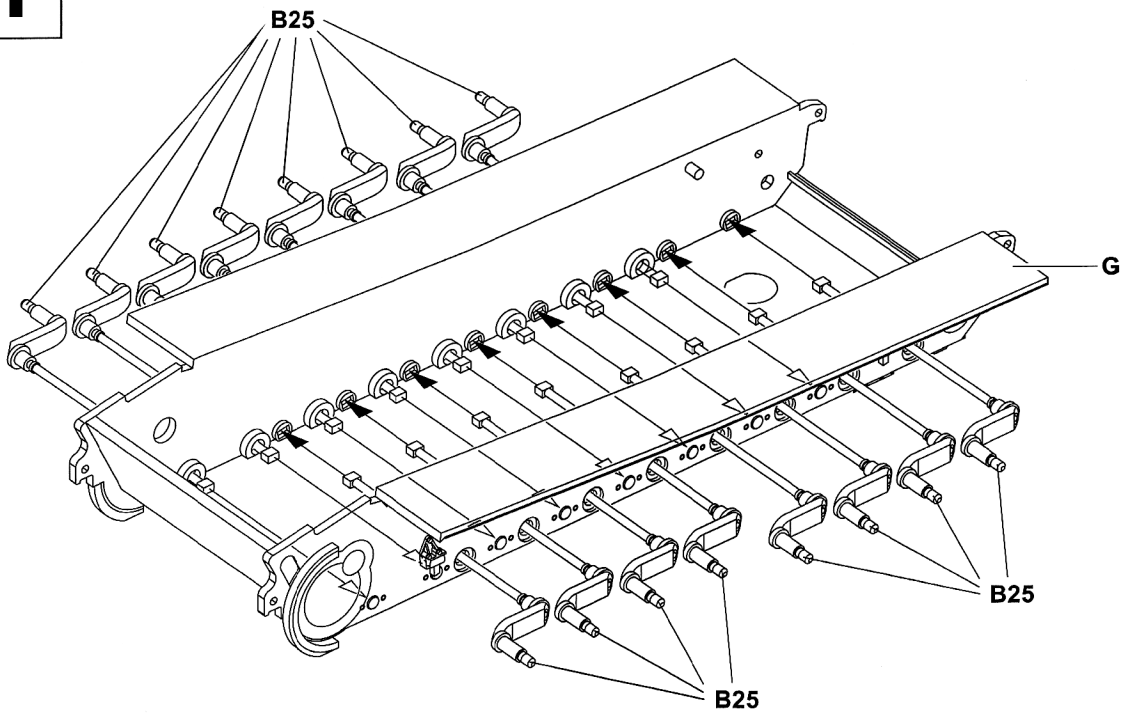

2

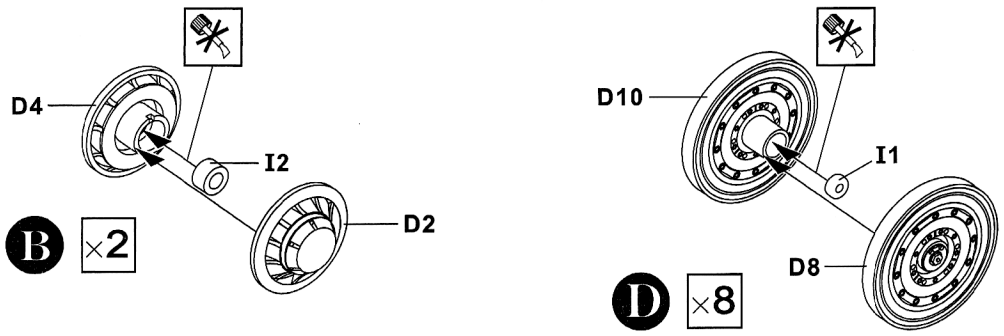
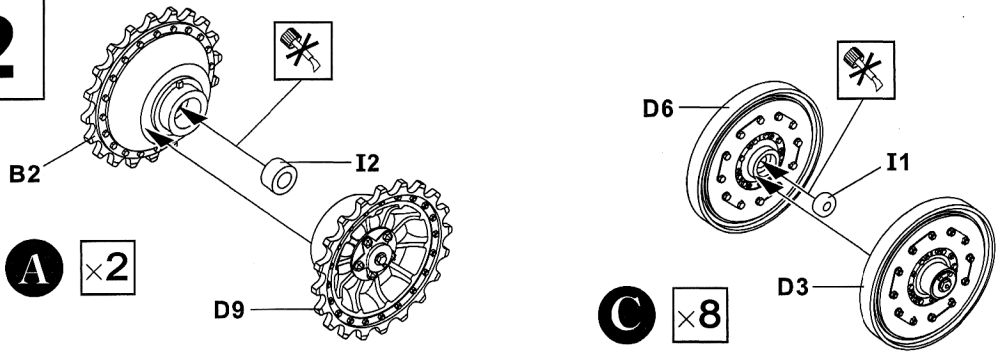

3

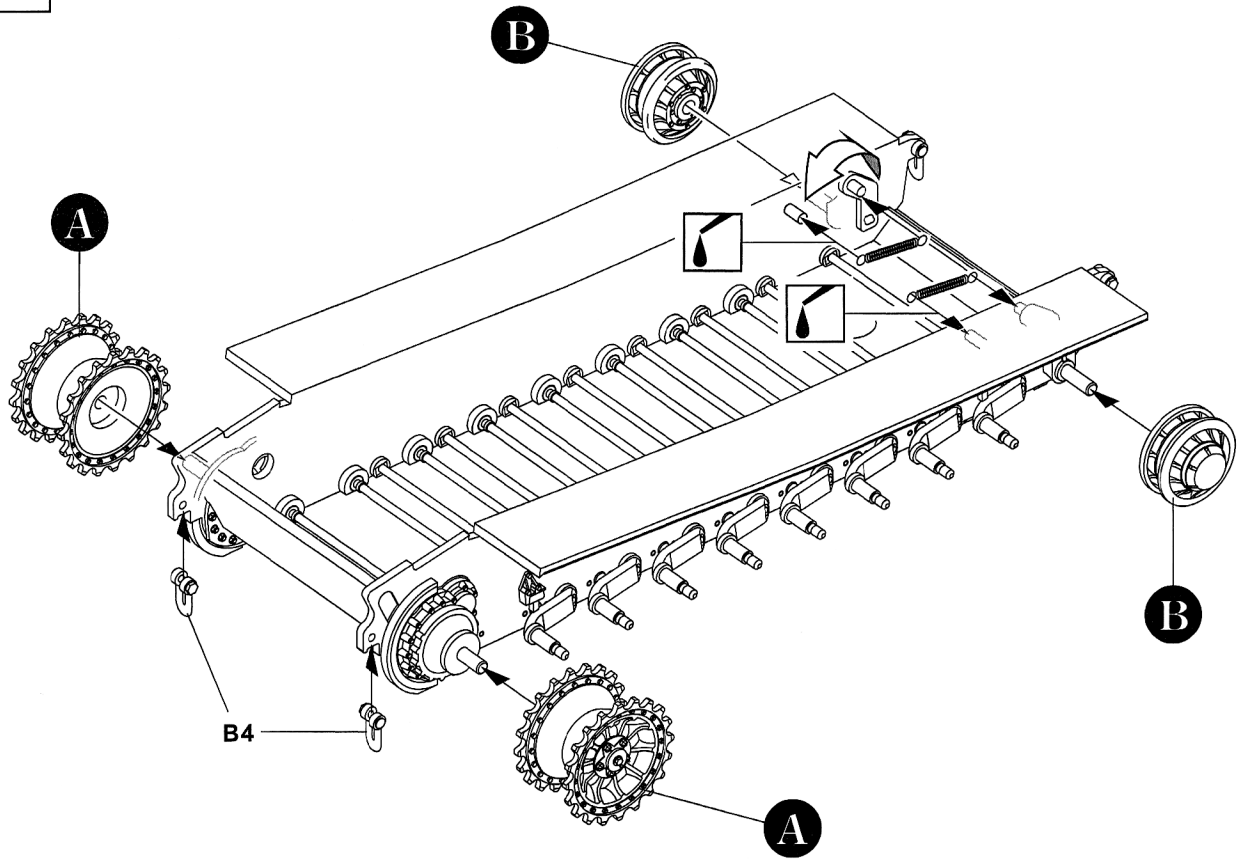

4

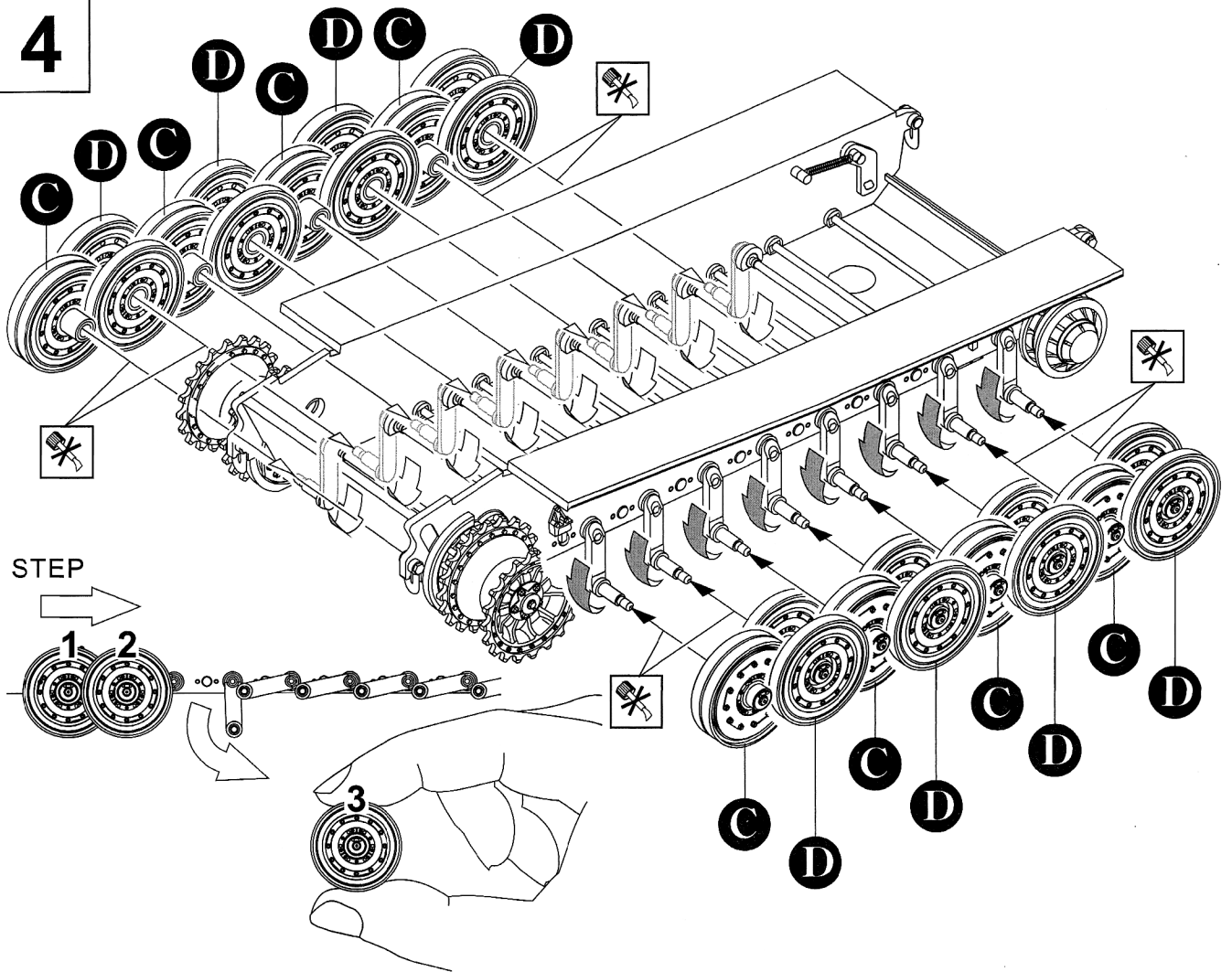

5

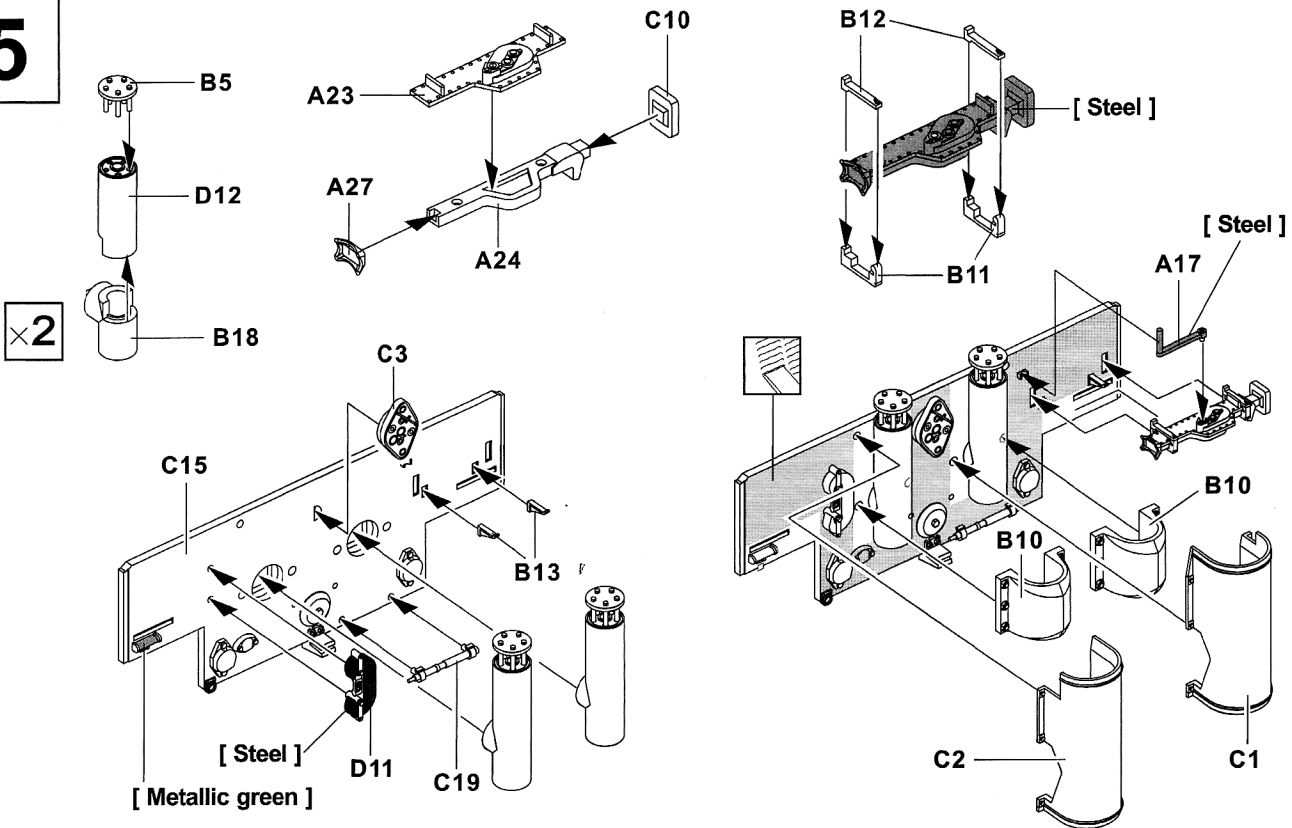

6

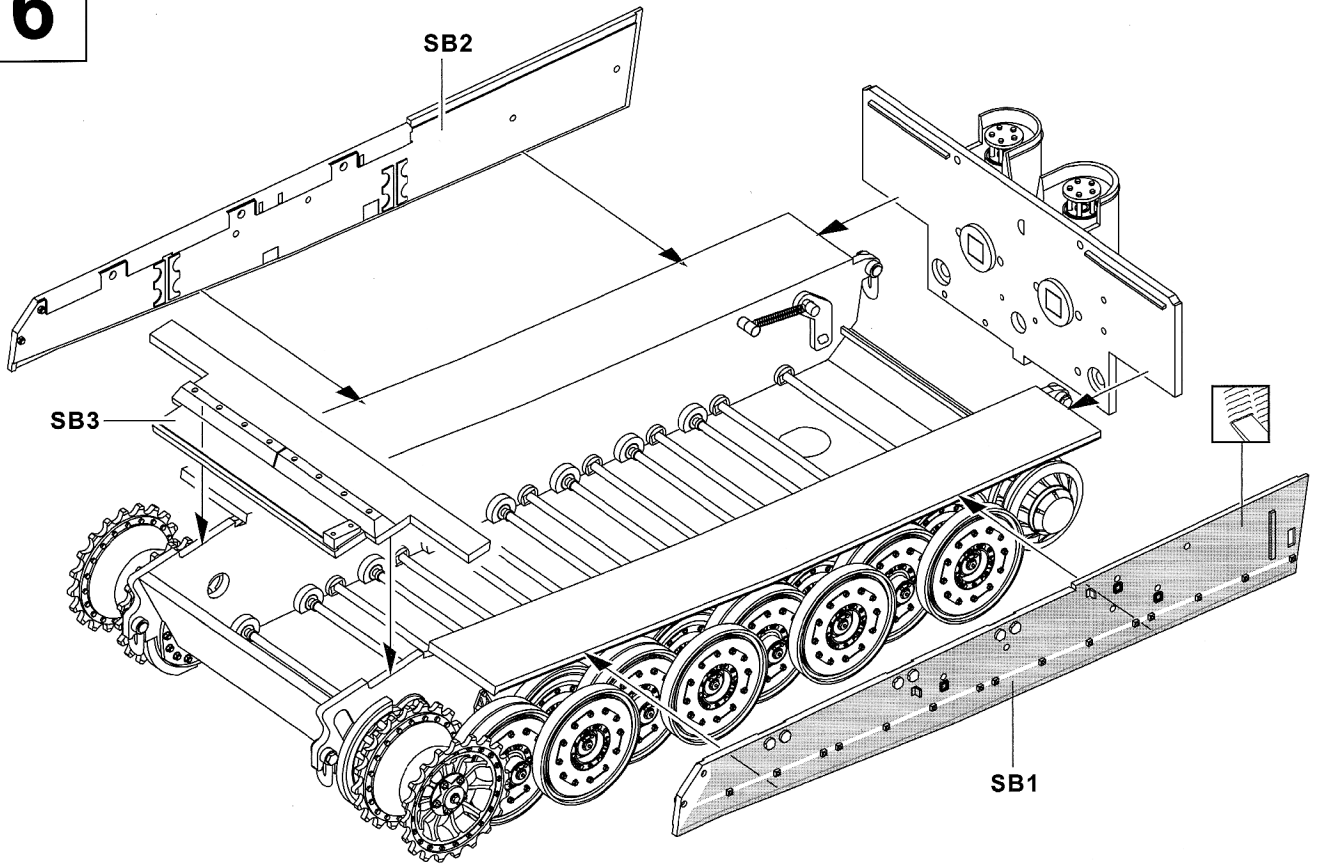

7

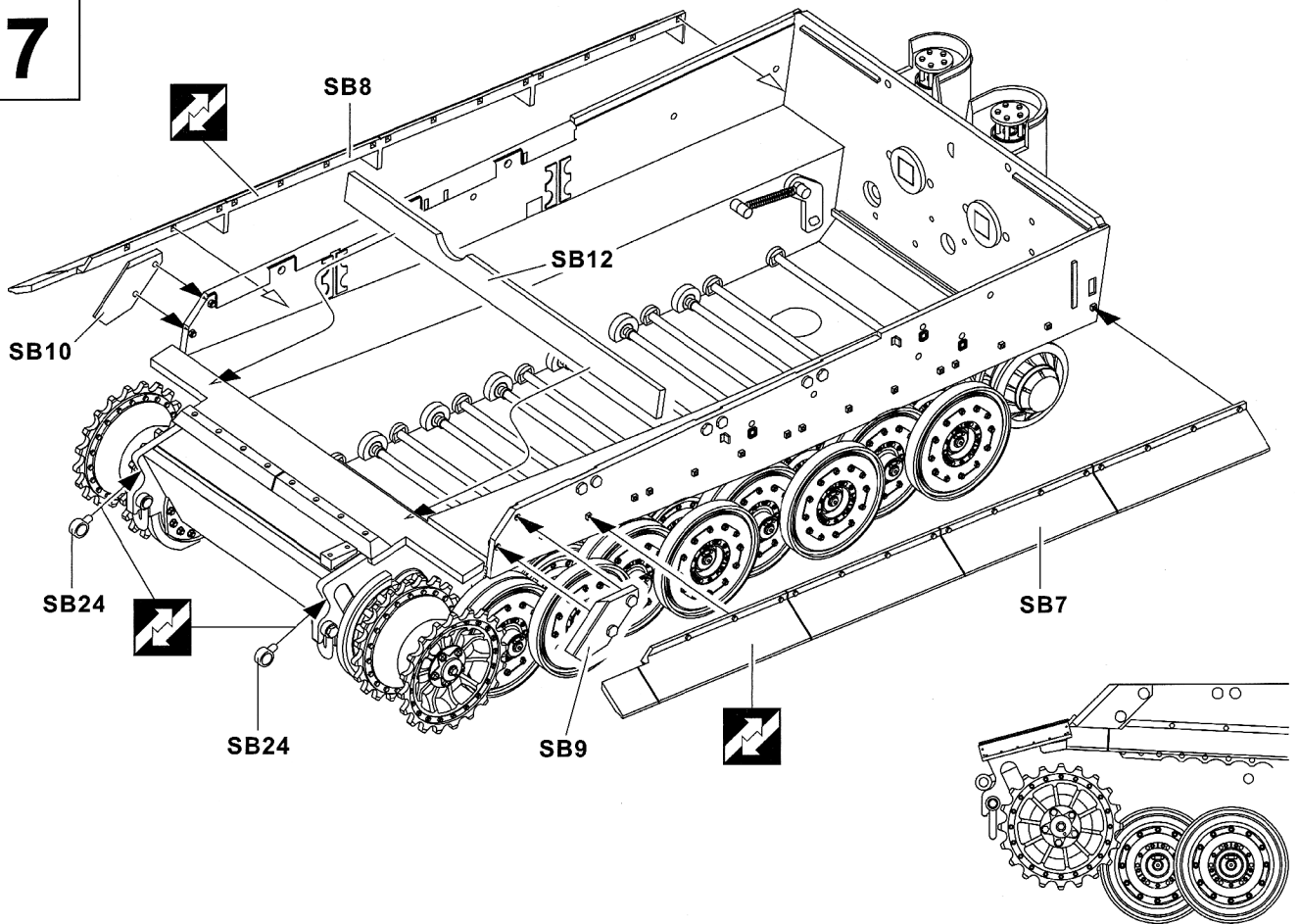

8

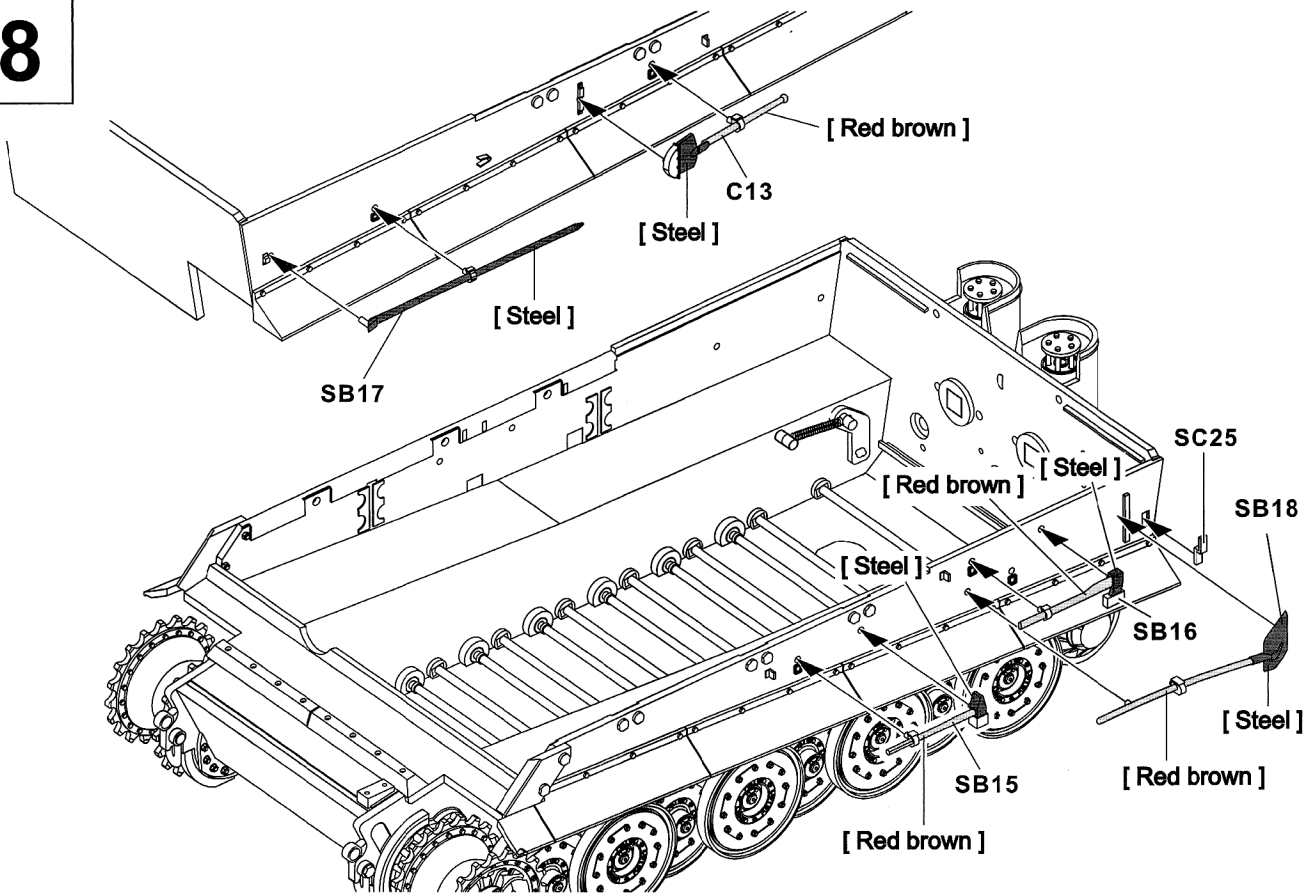

9

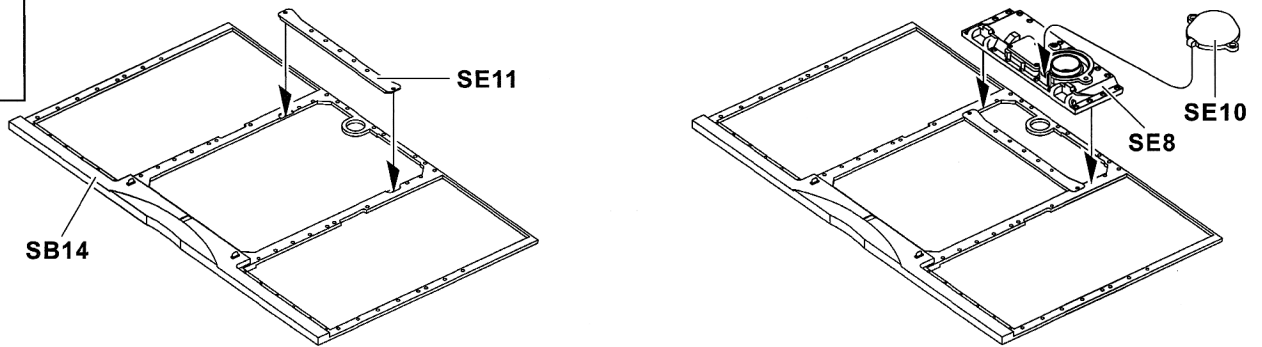

10

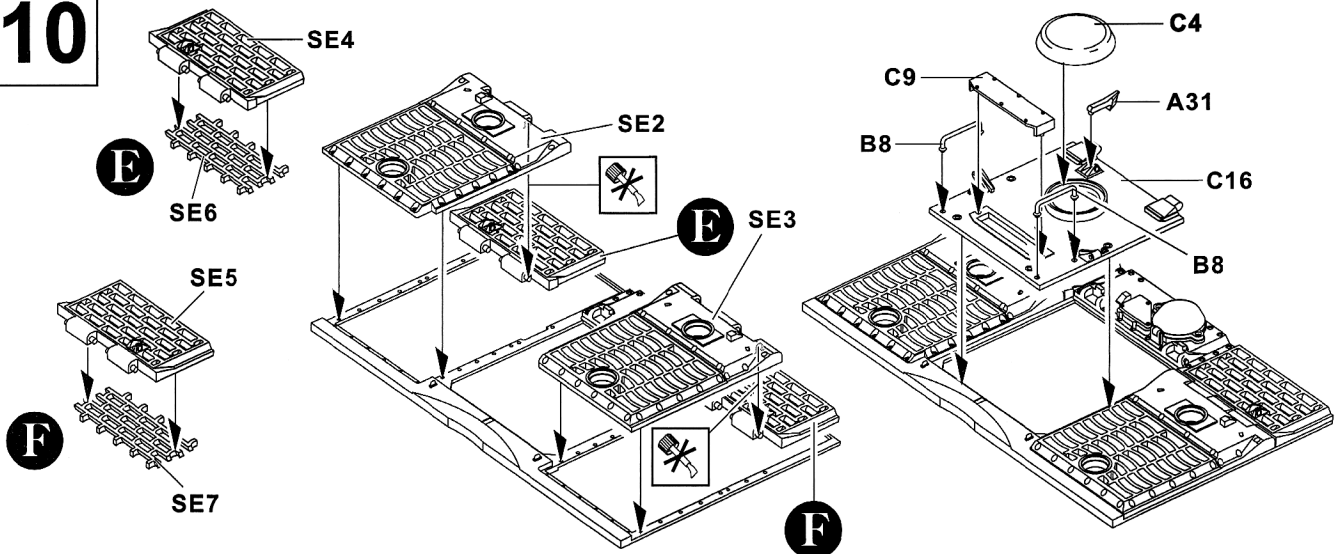

11

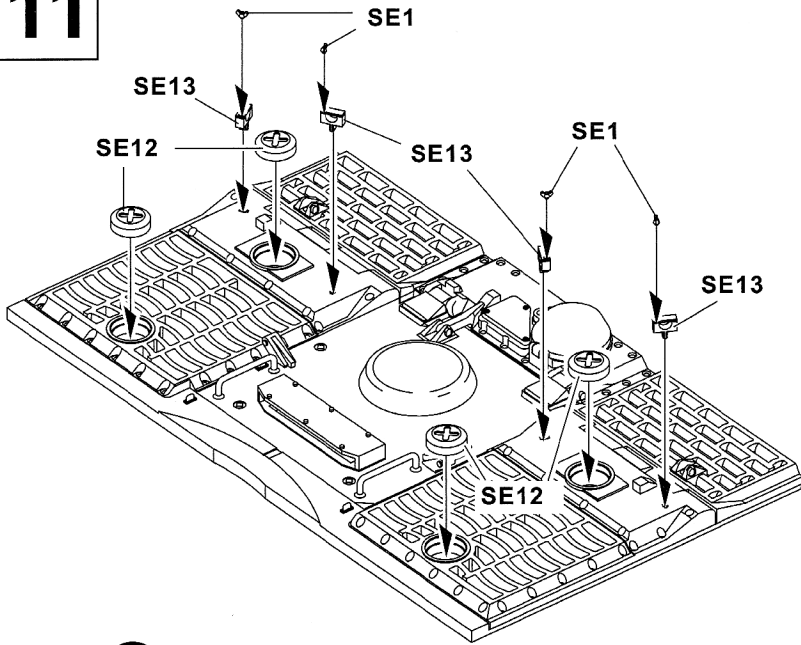

G

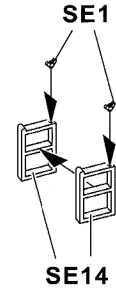

H

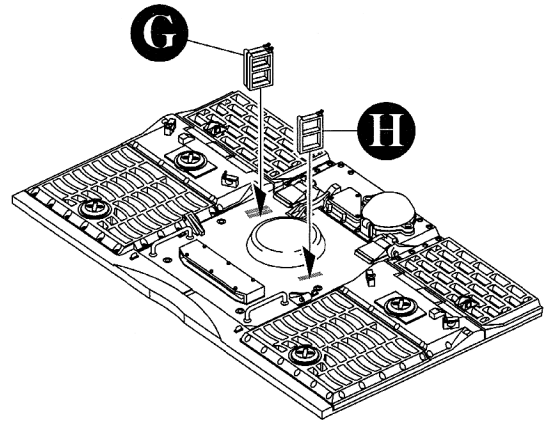
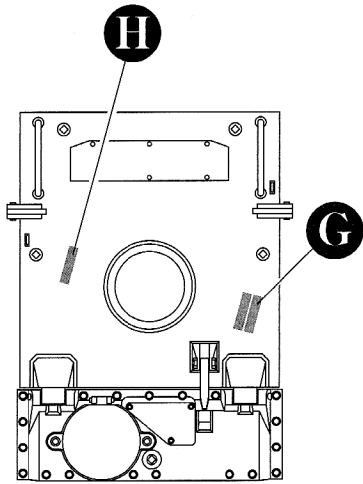
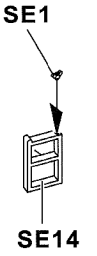

12

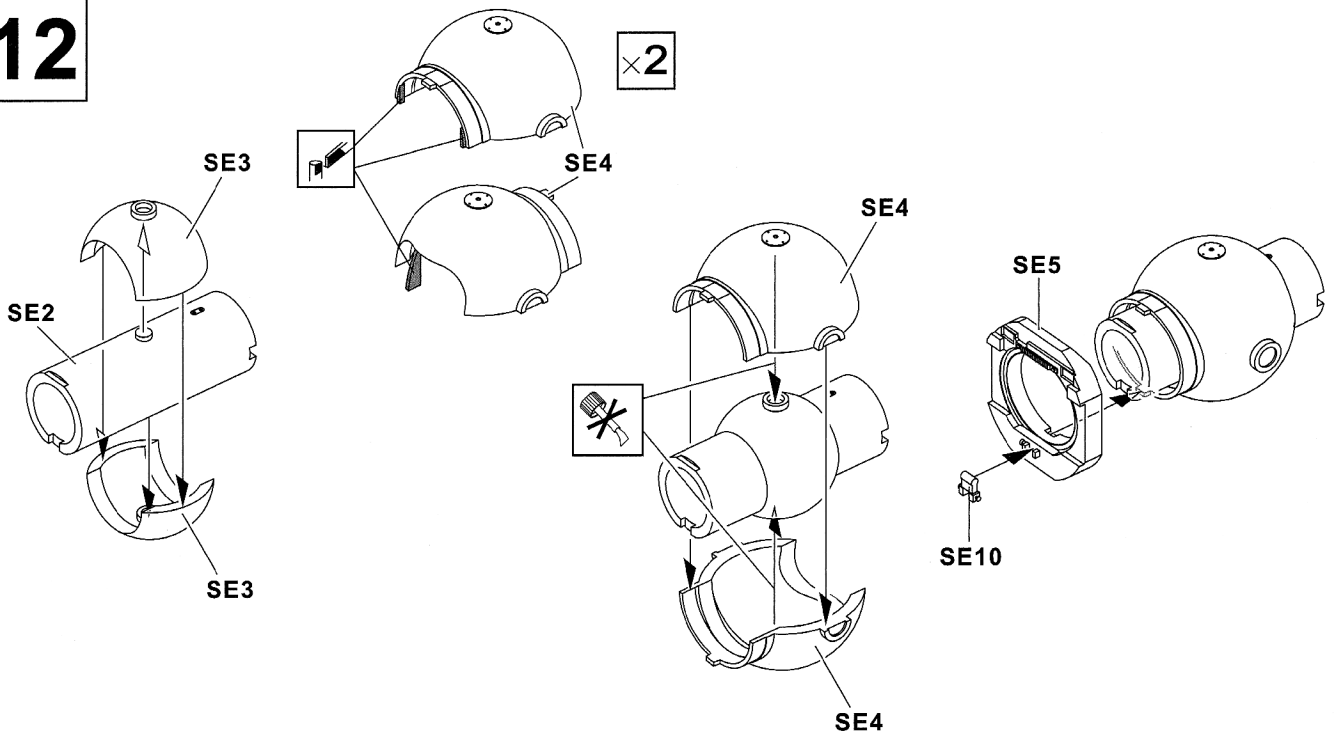

13

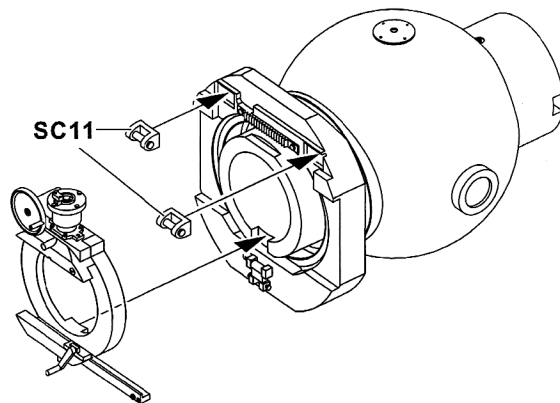
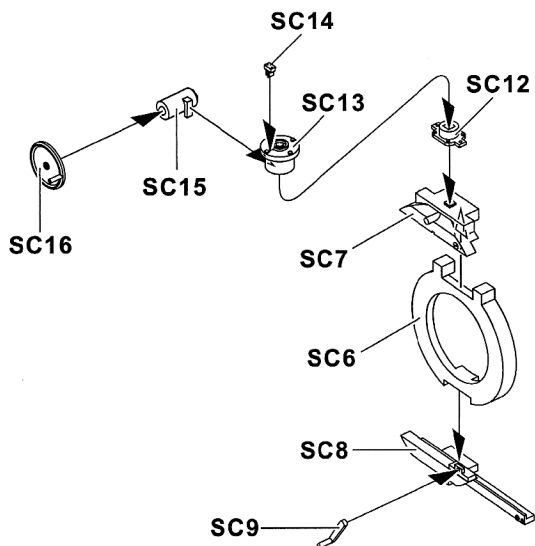

14

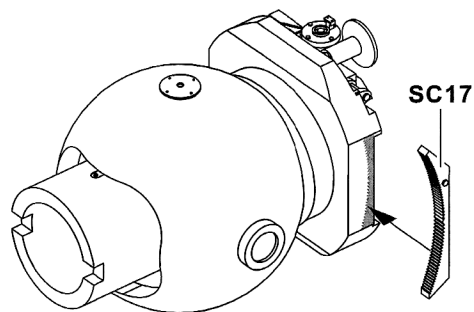
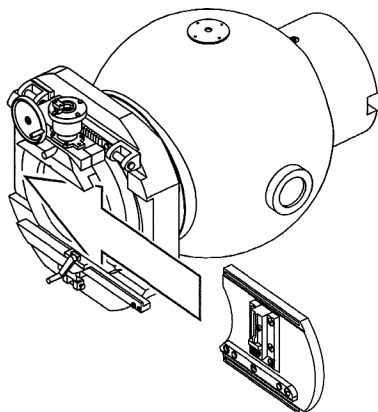
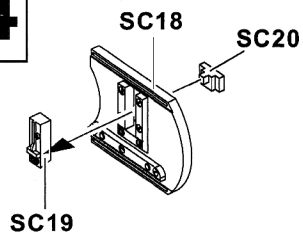

15

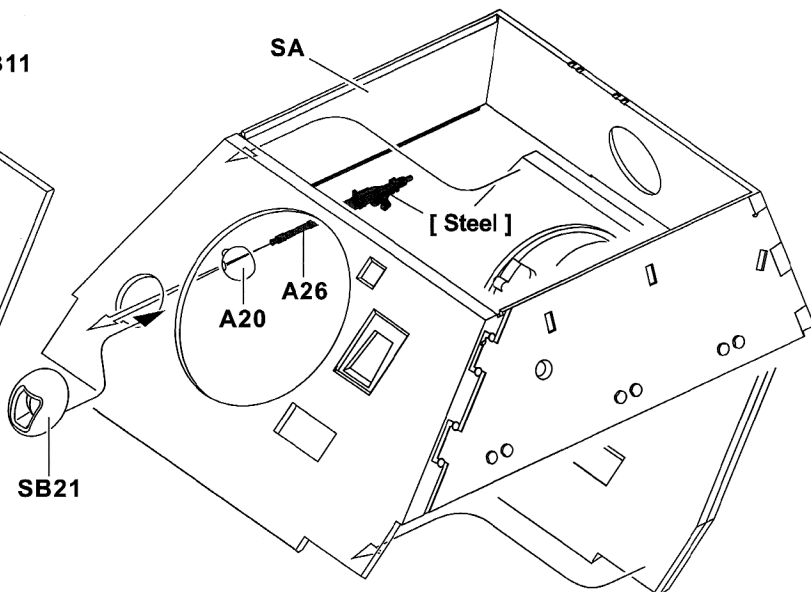
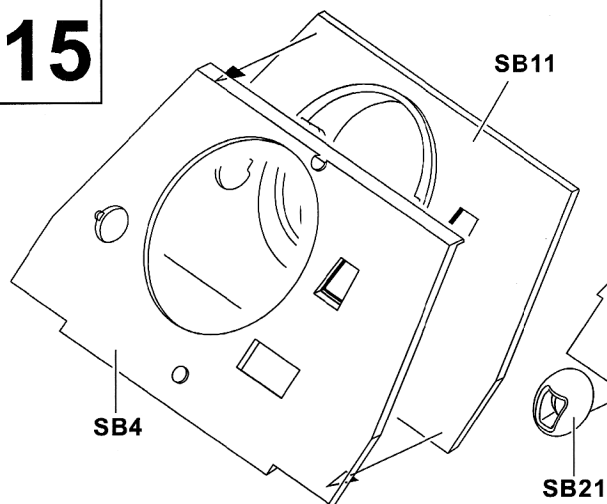

16

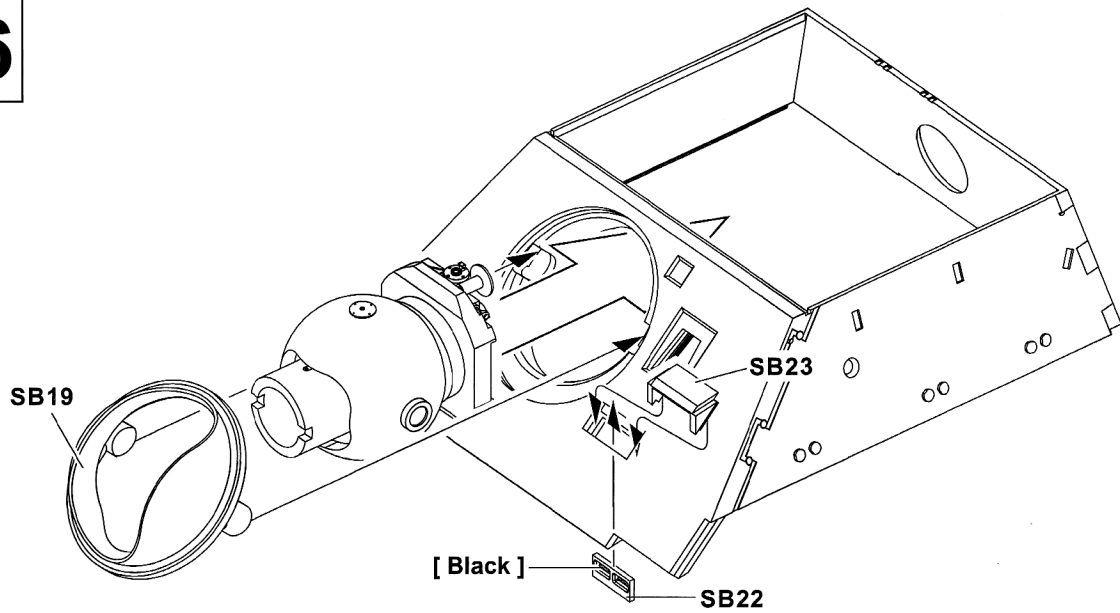

17

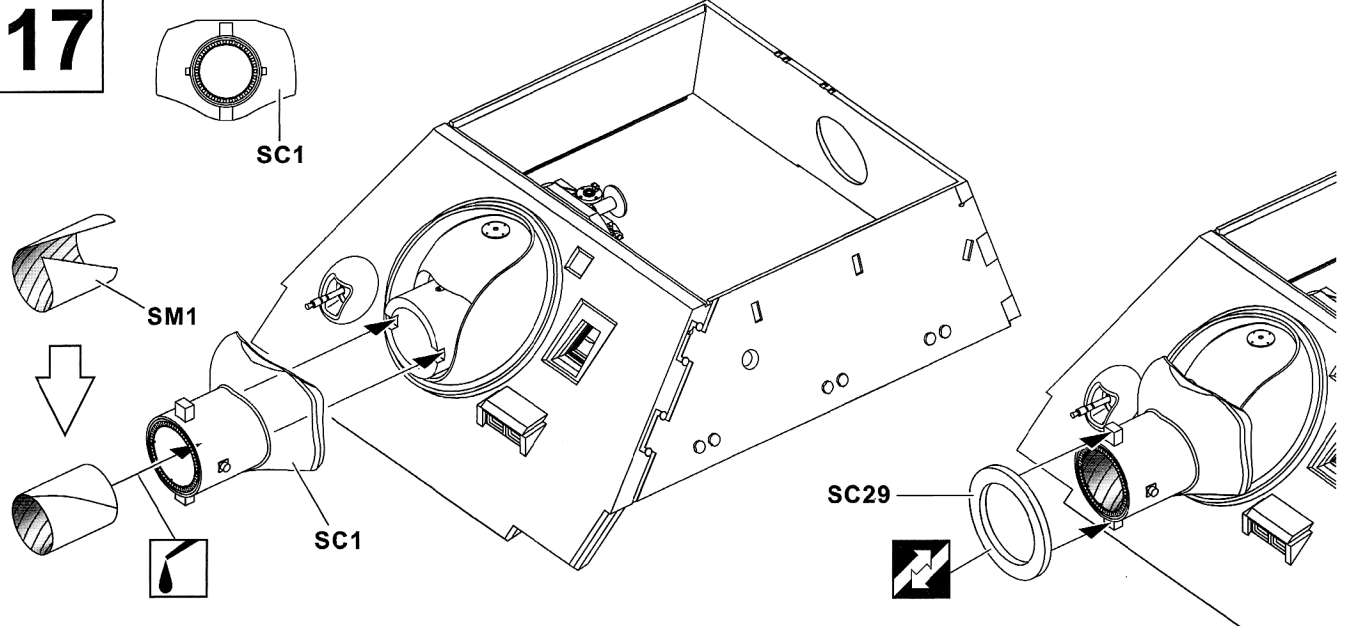

18

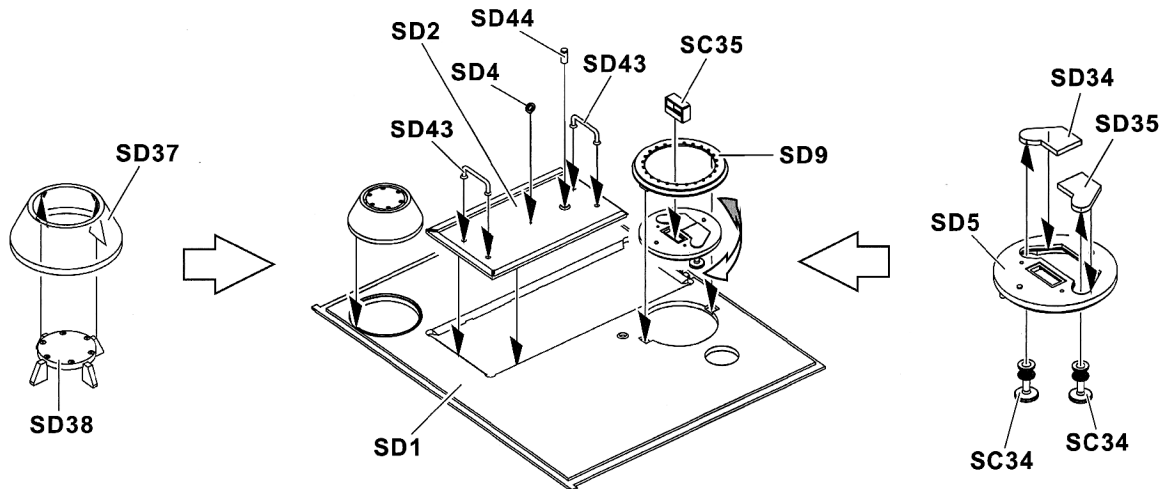

19

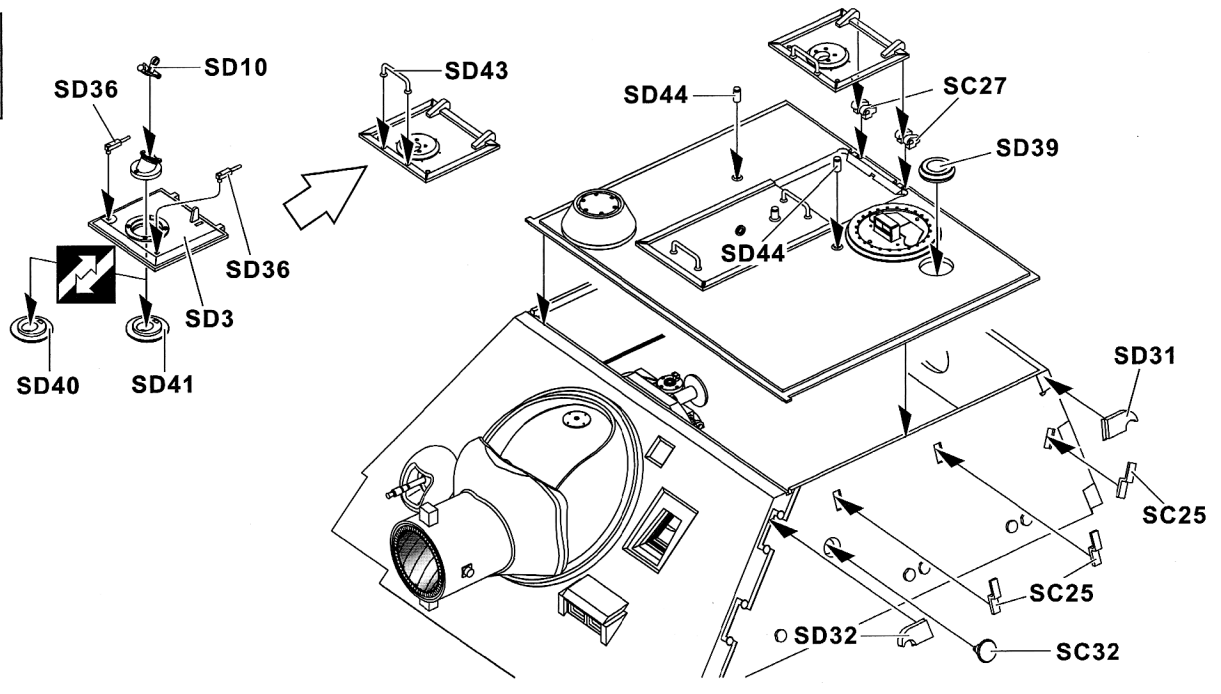

20

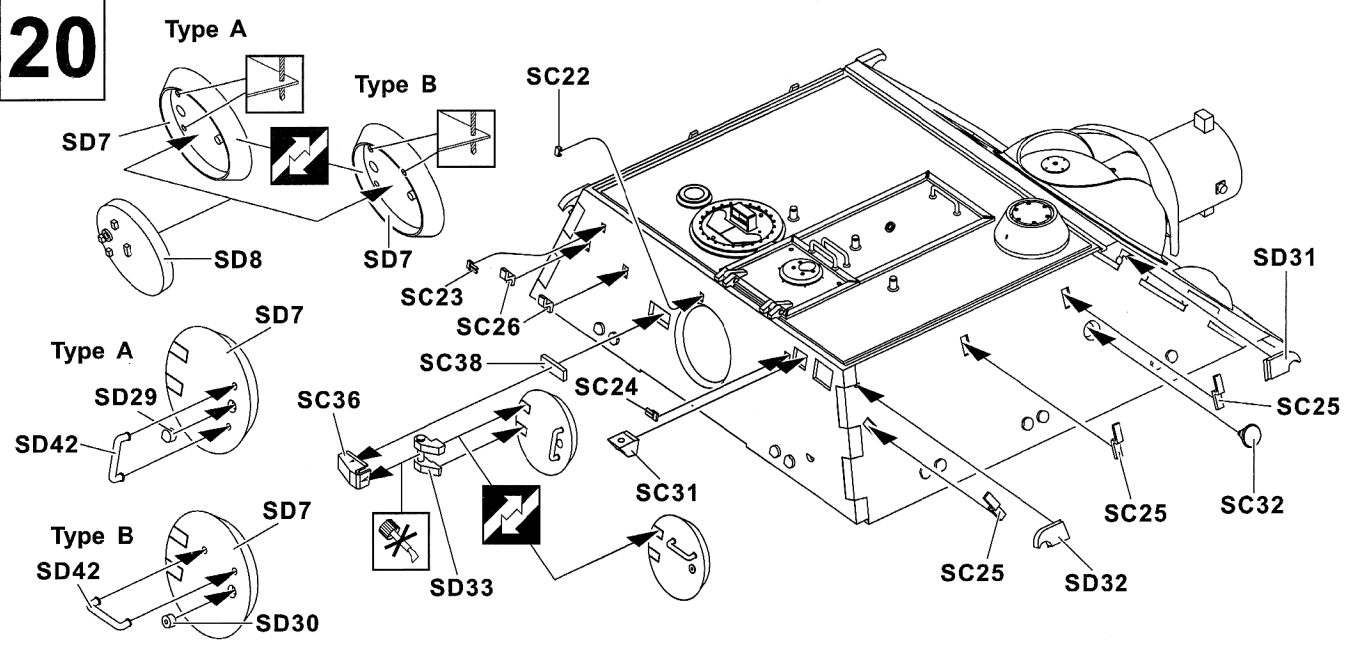

21

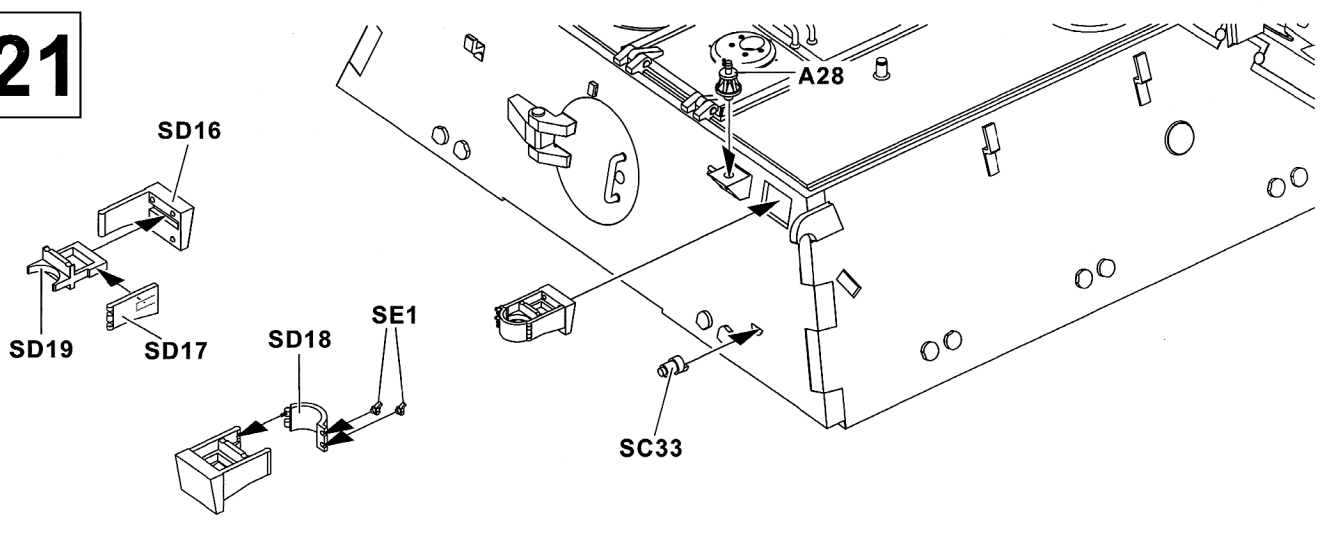

22

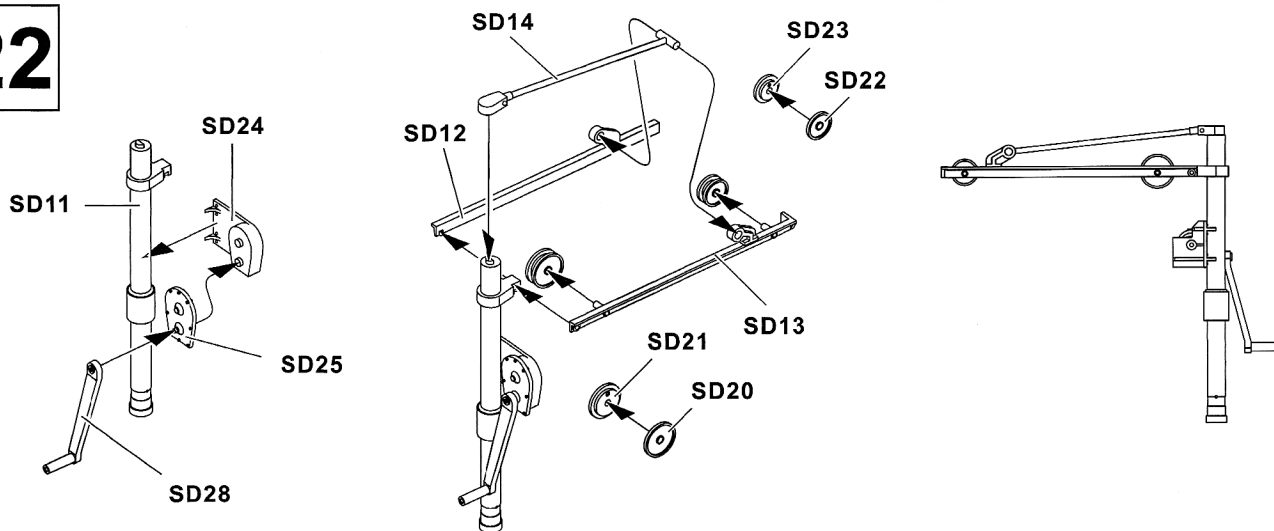

23

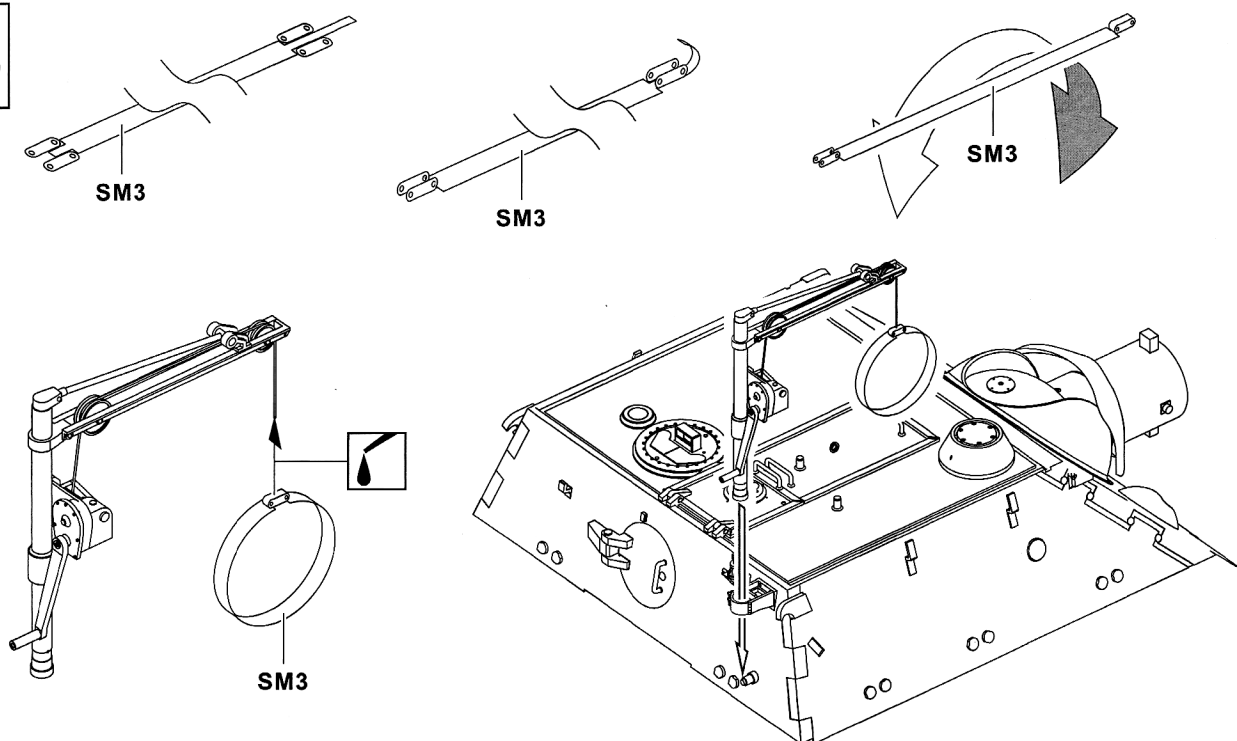

24

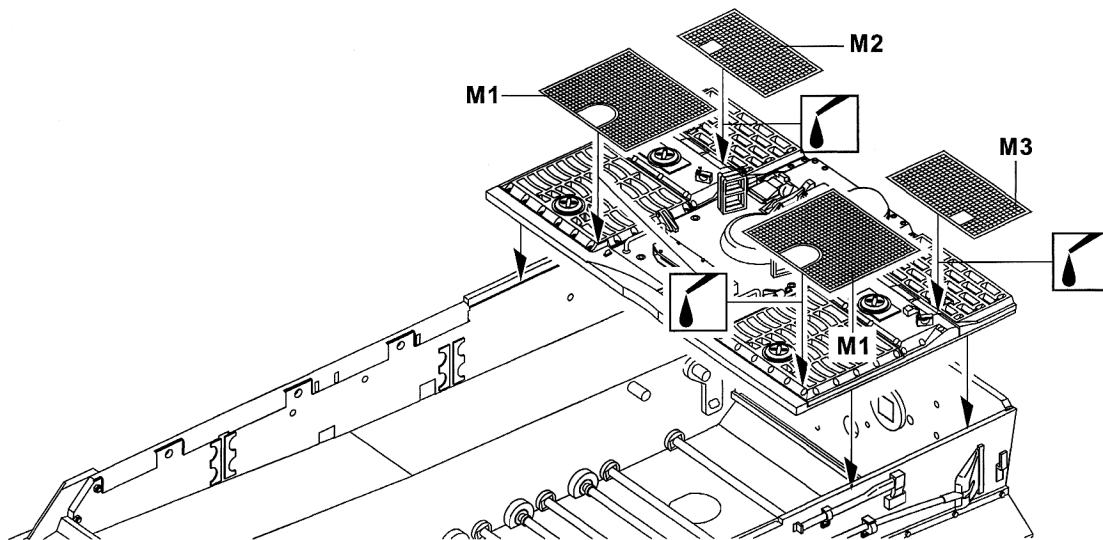

25

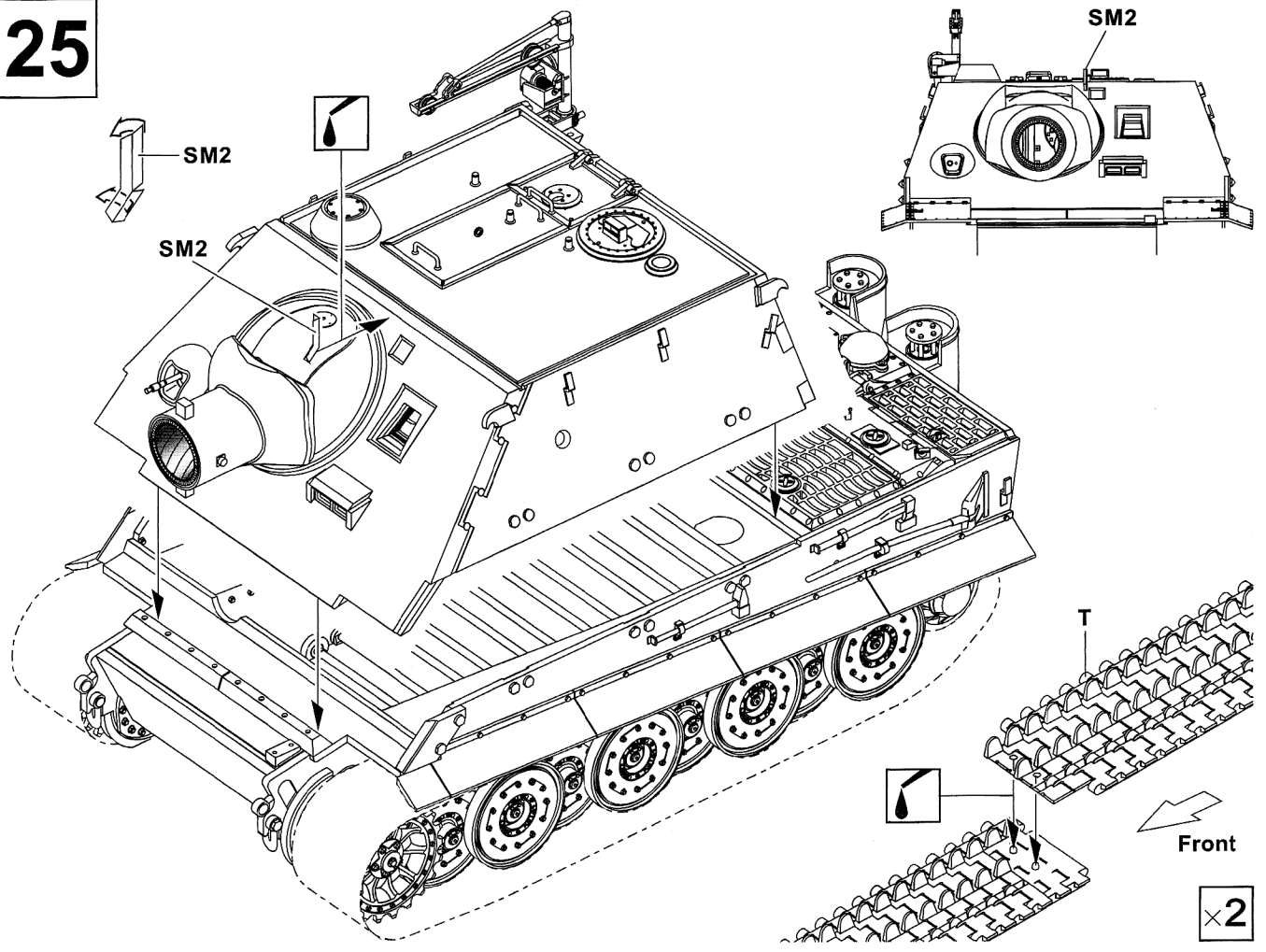

26

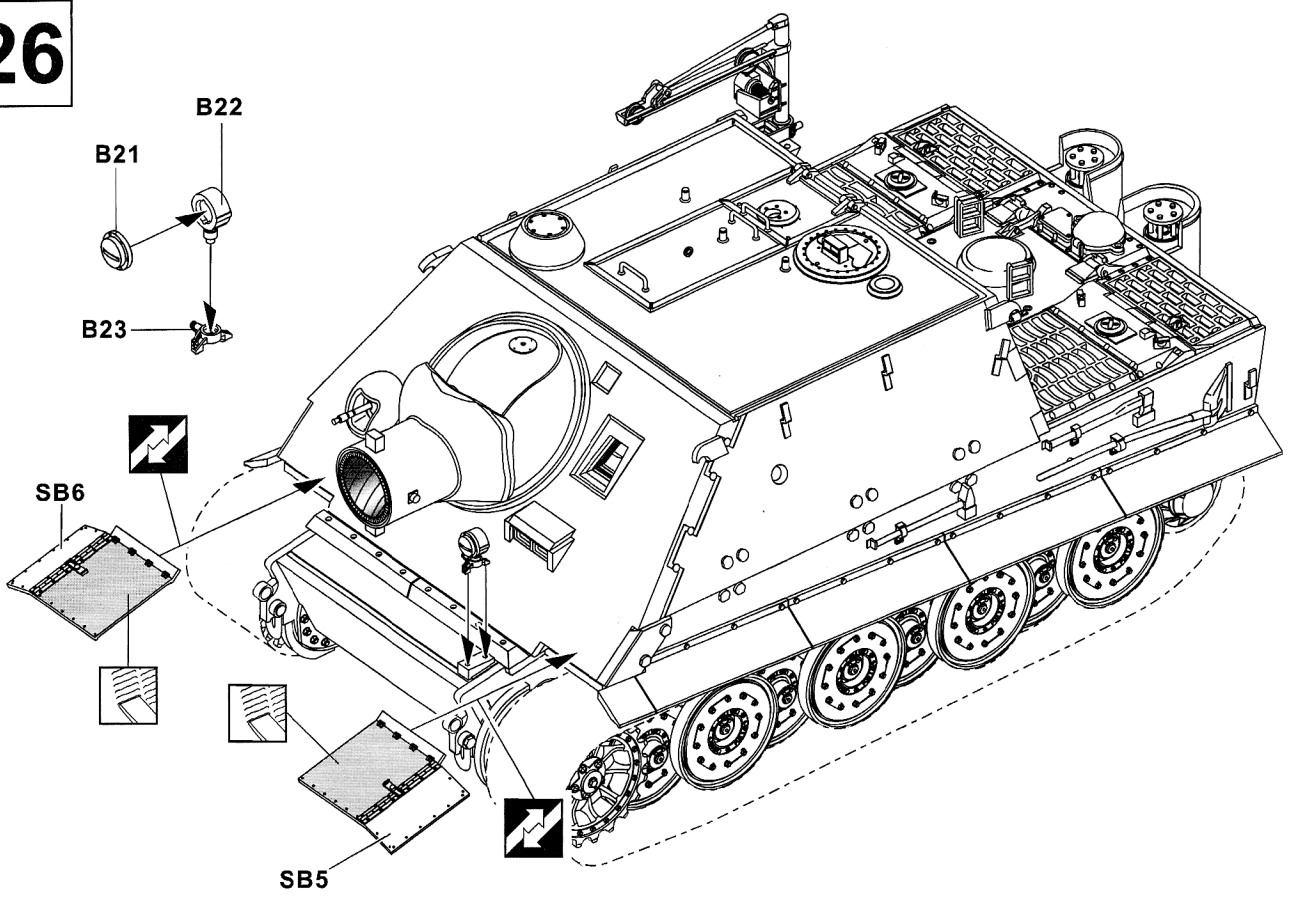

A

PzStuMrKp 1001, Western Front, 1945

1945年西線,第1001突擊臼砲連



Body Color:  Red Brown

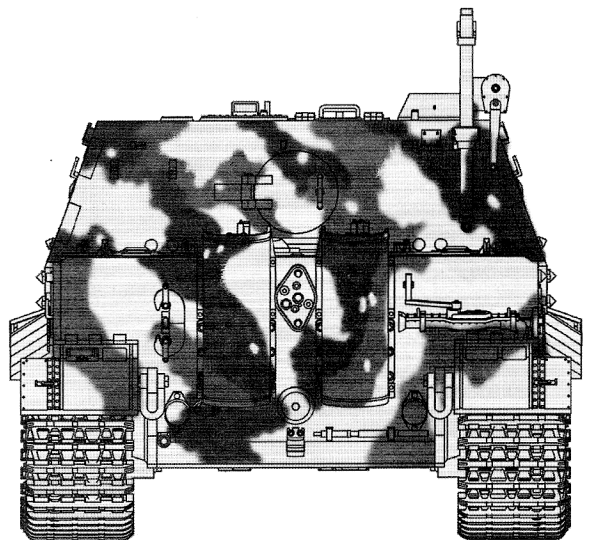
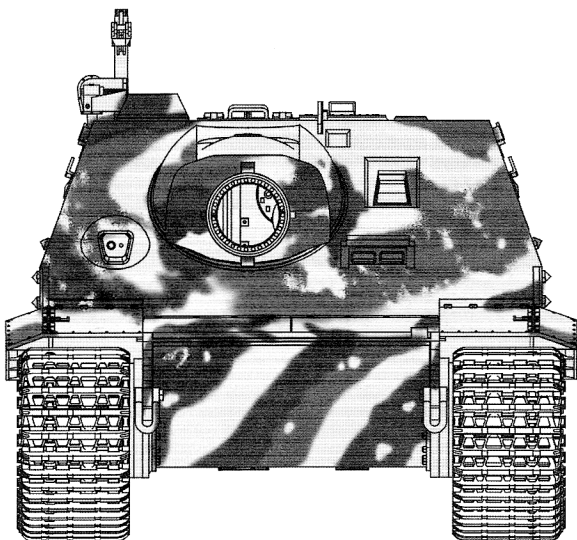
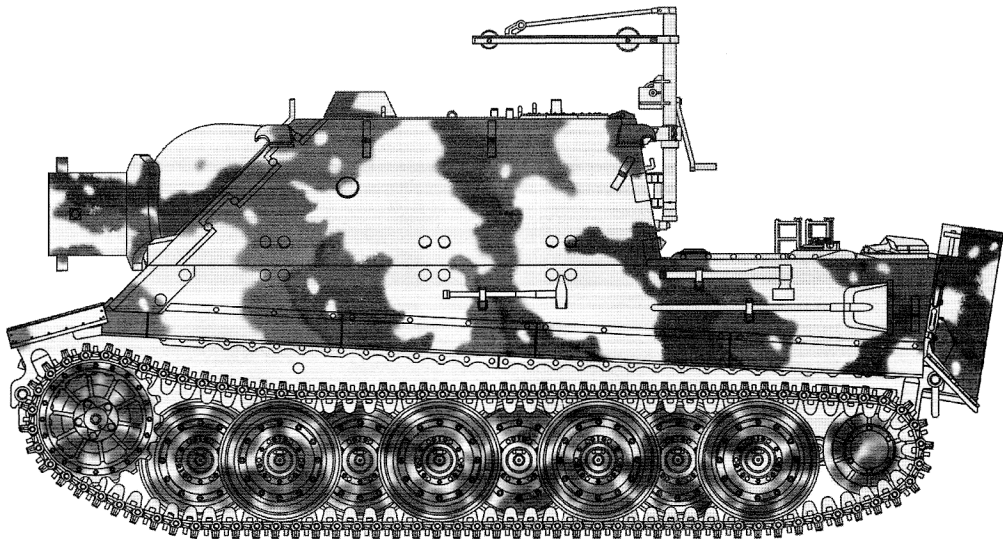
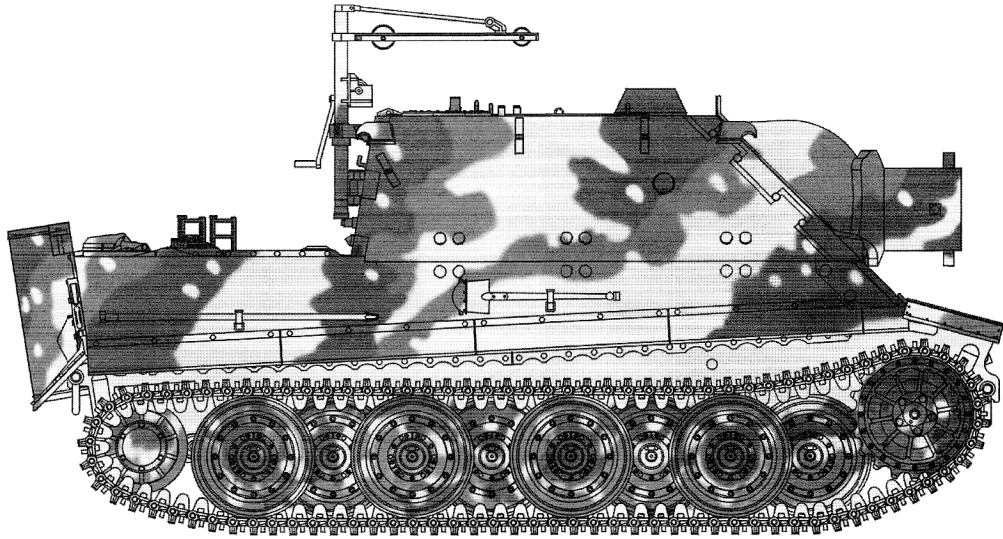

 Dark Green

 Dark Yellow



B



Body Color:  Red Brown
 Dark Yellow

 Dark Green

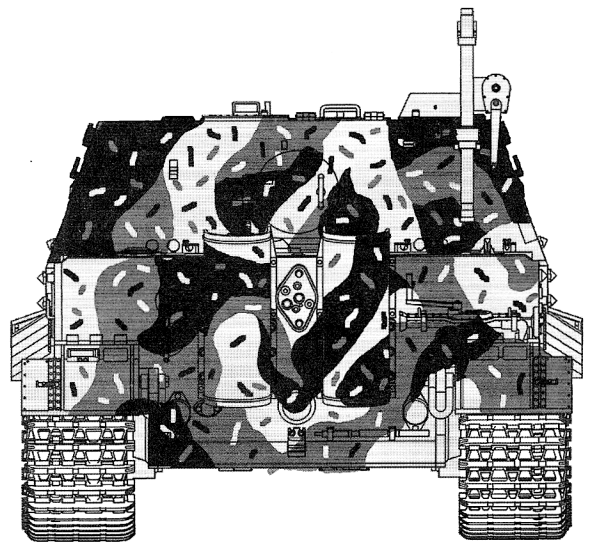
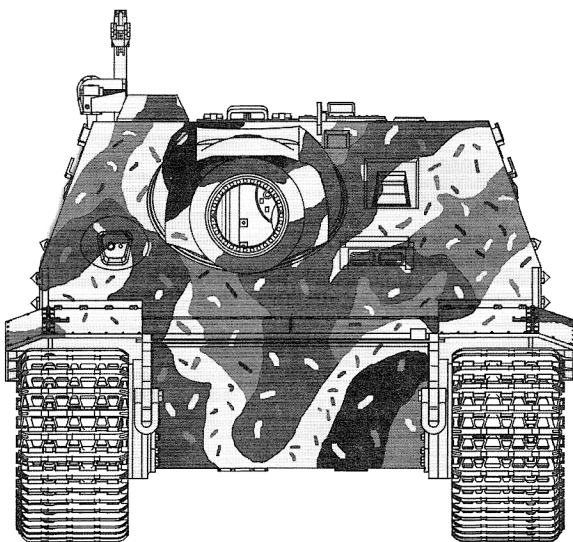
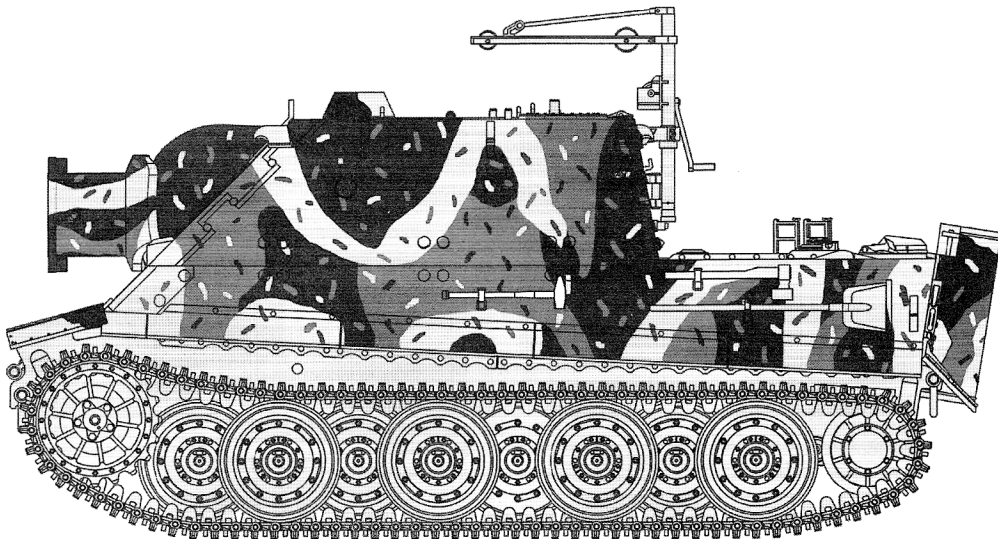
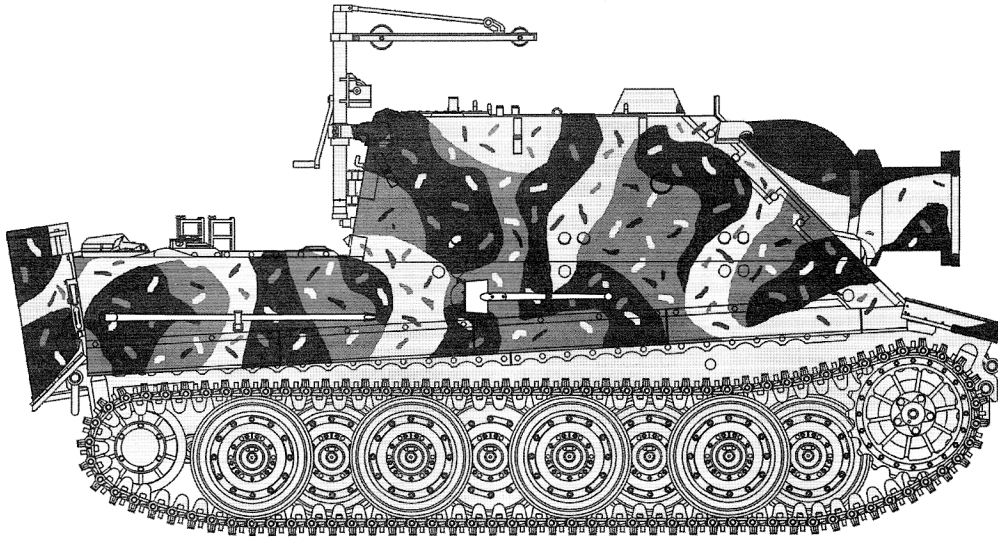

PARTS LIST 零件表

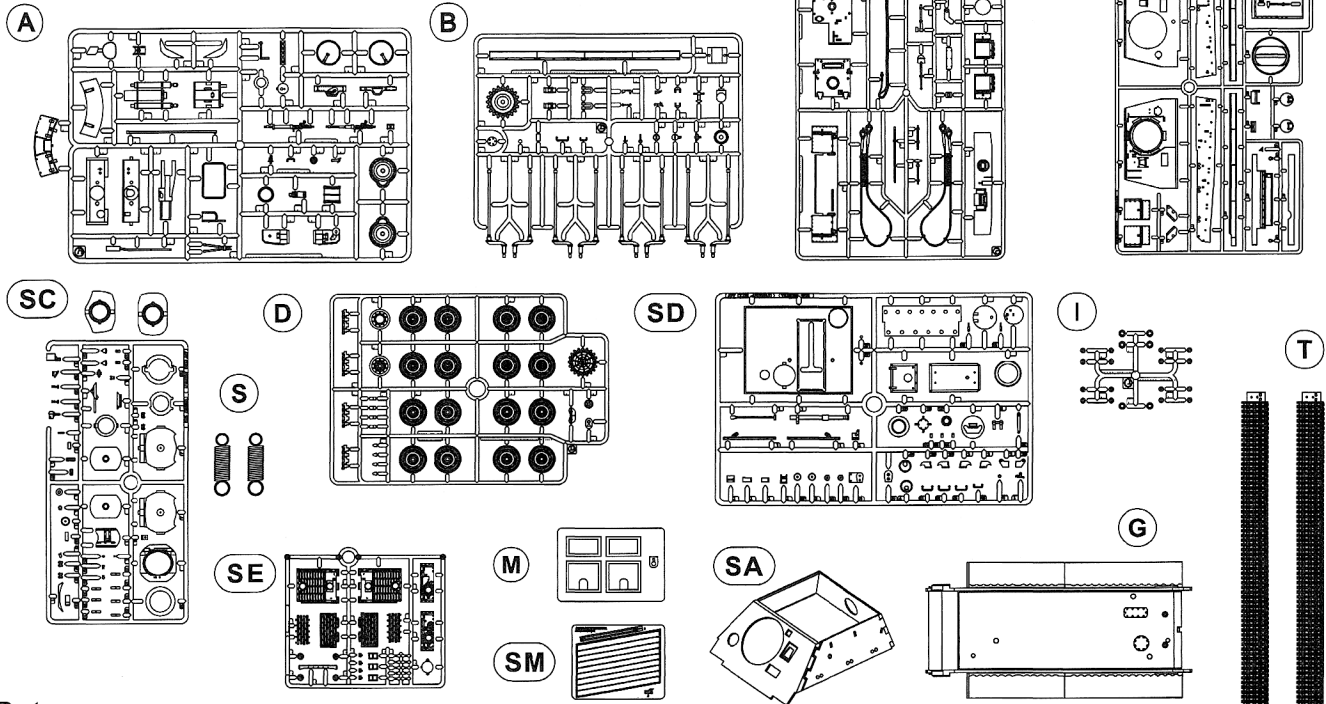

Parts :

(A) ——— 1	(D) ——— 2	(I) ——— 1	(SA) ——— 1	(SD) ——— 1
(B) ——— 2	(SE) ——— 1	(M) ——— 1	(SB) ——— 1	(SM) ——— 1
(C) ——— 1	(G) ——— 1	(T) ——— 1	(SC) ——— 1	(S) ——— 1

Parts not used. A : 1、2、3、6、7、8、9、10、11、12、13、14、15、16
 不需使用的零件 18、19、21、22、25、29、30、31、32、35、36
 B : 7、9、11、12、15、16、17、19、20
 C : 12、14、18、20、21、22、23
 D : 1、5、7
 SB : 20 SE : 9



Instructions:

If for some reason, you are not fully satisfied or have questions concerning our product; Please use the form provide, and send it to our nearest representative or mail it directly to our office.

We will deal with that A.S.A.P.



**AF 35103
Parts Replacement Form**

- | | |
|----------------------------------|-----------------------------------|
| <input type="checkbox"/> A parts | <input type="checkbox"/> S parts |
| <input type="checkbox"/> B parts | <input type="checkbox"/> T parts |
| <input type="checkbox"/> C parts | <input type="checkbox"/> SA parts |
| <input type="checkbox"/> D parts | <input type="checkbox"/> SB parts |
| <input type="checkbox"/> E parts | <input type="checkbox"/> SC parts |
| <input type="checkbox"/> G parts | <input type="checkbox"/> SD parts |
| <input type="checkbox"/> I parts | <input type="checkbox"/> SE parts |
| <input type="checkbox"/> M parts | <input type="checkbox"/> SM parts |

Reason for replacement: Missing Broken

Signature: _____

限臺灣地區使用 For Taiwanese use only!



AF 35103

零件補充申請表

- | | | |
|----------------------------------|----|----------|
| <input type="checkbox"/> A 部品零件 | —— | NT\$ 280 |
| <input type="checkbox"/> B 部品零件 | —— | NT\$ 180 |
| <input type="checkbox"/> C 部品零件 | —— | NT\$ 180 |
| <input type="checkbox"/> D 部品零件 | —— | NT\$ 160 |
| <input type="checkbox"/> G 部品零件 | —— | NT\$ 160 |
| <input type="checkbox"/> I 部品零件 | —— | NT\$ 60 |
| <input type="checkbox"/> M 部品零件 | —— | NT\$ 150 |
| <input type="checkbox"/> S 部品零件 | —— | NT\$ 20 |
| <input type="checkbox"/> T 部品零件 | —— | NT\$ 280 |
| <input type="checkbox"/> SA 部品零件 | —— | NT\$ 140 |
| <input type="checkbox"/> SB 部品零件 | —— | NT\$ 220 |
| <input type="checkbox"/> SC 部品零件 | —— | NT\$ 260 |
| <input type="checkbox"/> SD 部品零件 | —— | NT\$ 200 |
| <input type="checkbox"/> SE 部品零件 | —— | NT\$ 160 |
| <input type="checkbox"/> SM 部品零件 | —— | NT\$ 150 |
| + 郵寄費 | | NT\$ 80 |

(請填) 總計 NT\$ _____

零件補充原因:(請於打)

- 原包裝即 遺失或 毀損
 製作途中 遺失或 毀損
 補充多餘零件
 其他原因 _____

申請人
 姓名 地址 電話

 名址話

★請將本表與該部品相同金額之郵政匯票一同寄至
 總代理: 戰鷹企業 客服部 收 本公司將盡速為您處理