

1/35 MILITARY MINIATURE VEHICLE UPGRADE SERIES PE35375

WWII U.S. M7 Priest Mid Production

二战美军M7牧师自行榴弹炮中期型基本改造件

[For DRAGON 6637]

推荐使用工具 RECOMMENDED TOOLS

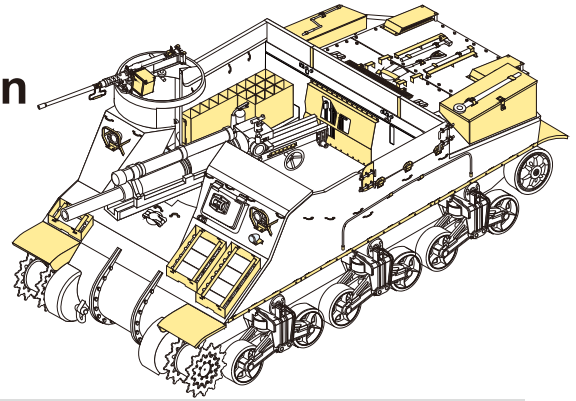
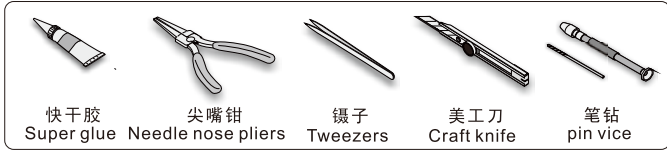

Technical assistance provided by Zhong Mingzhou

| | | | | | | |
|---------------|-----------------|--|---|---|------------------------------------|--|
| 安装 install | 折叠 bend | A1 改造件零件编号 PE/resin part number | B12 原零件编号 kit part number | C22 被替换的原零件编号 replaced kit part number | 另一侧相同制作 repeat on opposite side | 用尖端在凹槽处冲压 use penpoint to press on the dent 蚀刻片零件内面向上 Put the part upside down 用笔尖在凹槽处刻 Use penpoint to press on the dent |
| 切除 remove | 打磨 grind off | 弧度卷曲 radial bending | x2 制作若干组 multiple assembly | 选择安装 alternative | 填补 fill | |

自制 Scratch build

右边内侧 Right inner side

左边内侧 Left inner side

推荐 VBS0301 VOYAGERMODEL VBS0301 Recommended

菲林 Film

Ø.0.5

1/35 MILITARY MINIATURE VEHICLE UPGRADE SERIES PE35375

C13, **A28**, **C7**, **B16**, **A15**, **B40**, **B31**, **A28**, **B11**, **B12**

根据喜好使用
Select the parts as preferred

树脂件
Resin part

自制
Scratch build

根据喜好使用
Select the parts as preferred

m, **m**, **aa**, **x2n**

A40, **A32**, **D2**, **A35**, **A24**, **A29**, **A25**, **B10**, **D2**, **B10**, **A20**, **D12**, **D11**, **D16**, **D1**, **D17**, **D5**, **D10**, **D15**, **D17**, **D15**

自制
Scratch build

树脂件
Resin part

自制
Scratch build

根据喜好使用
Select the parts as preferred

0

D16, **D1**, **D17**, **D5**, **D10**, **D15**, **D17**, **D15**, **D12**, **D11**, **D16**, **D1**, **D17**, **D15**, **D17**, **D15**

105mm Howitzer Ammo & Accessories

推荐 AFV 35184
AFV 35184 Recommended

自制
Scratch build

推荐 AFV 35184
AFV 35184 Recommended

p, **q**

1/35 MILITARY MINIATURE VEHICLE UPGRADE SERIES PE35375

推荐 PEA107
VOYAGERMODEL PEA107
Recommended

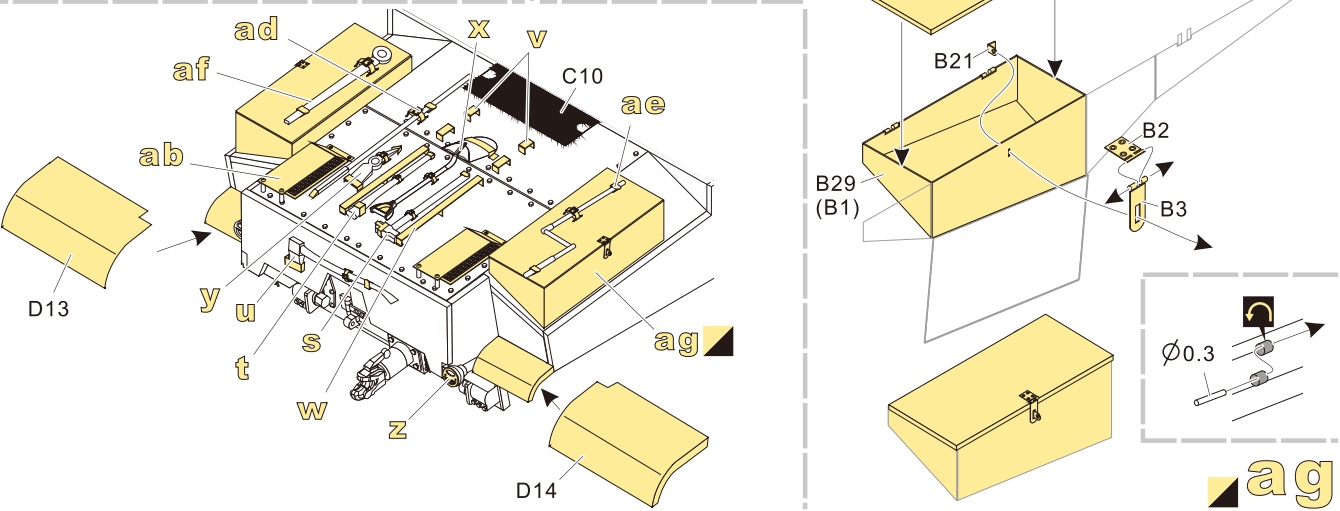
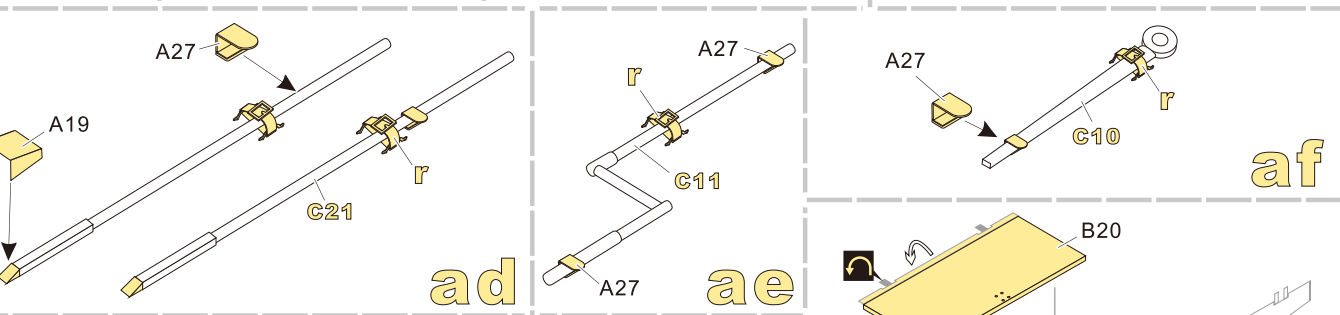
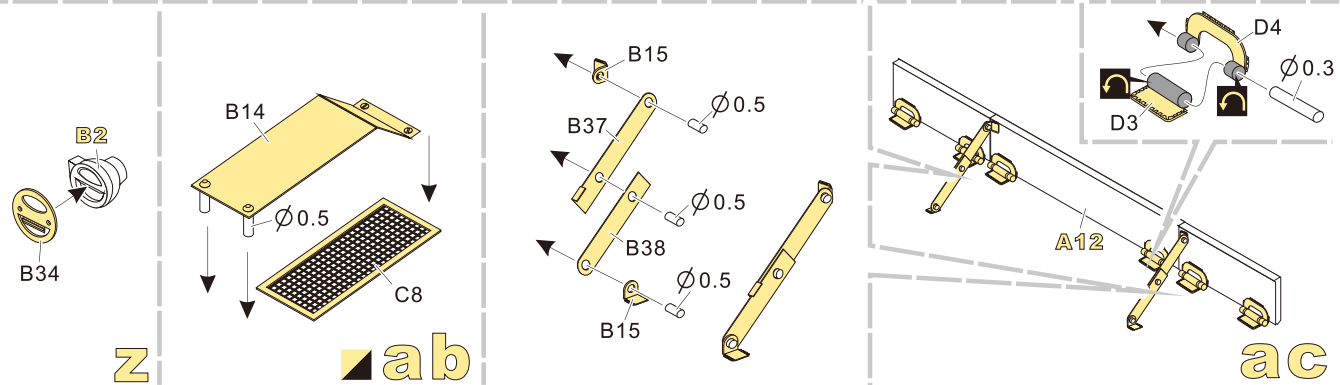
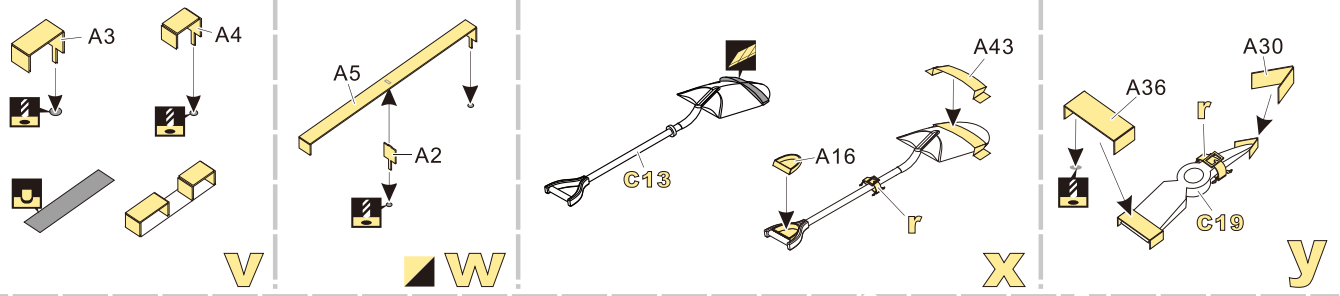
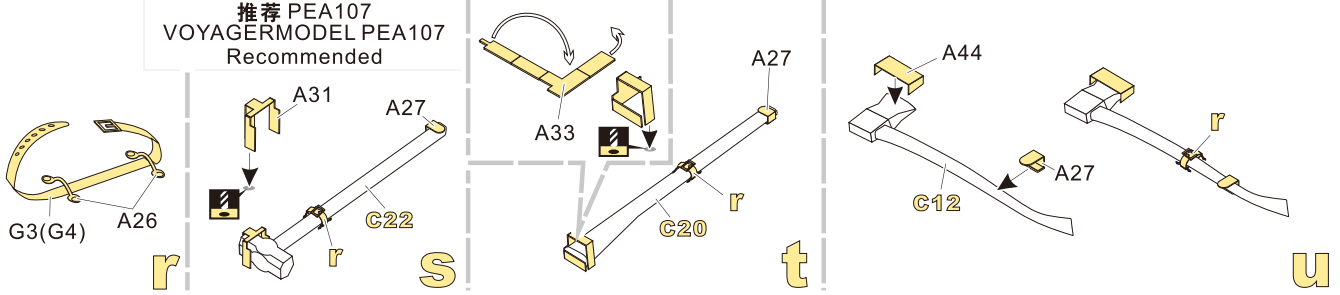

1/35 MILITARY MINIATURE VEHICLE UPGRADE SERIES PE35375

推荐 PEA204
PEA204
Recommended

树脂件
Resin part

使用制具
Use jig provided

右
Right

左
Left

推荐 VBS0201
VBS0201
Recommended

剖面
Cross section

Ø0.5

Ø0.3

aa
al
ak
am

aj
an
ap

B30
B31

B44
B45
B46

A26

A17
A18
C6
C9
C11

A11
A10
A12
A34
A23

B25(B26)
B23,24
C1

D6
D7
D6

E1
E4
E2
E4
E5
E3

D19
D20
D18

B36
B51
B45
B8
B9
B24
D8
D9
D8
D17
D22
D8

B4(B5)
D4
D3

ap