

P
EGASUS
HOBBIES

E-Z SNAPZ
SNAP TOGETHER MODEL

P-51B Mustang - Tuskegee



NO. 8404

THE MILITARY MUSEUM COLLECTION

The P-51 Mustang is the best fighter aircraft of World War Two. Starting in 1943 it flew farther, and faster, than most other planes in the sky. Serving mostly as a long range fighter escort, it was very important to the success of the Allied bombing campaign. Its pilots loved it's maneuverability in a dog fight, as well as its ease to fly on the long escort missions. It smashed the German Luftwaffe in both the air, as well as on the ground.

Lee Archer is the famous Tuskegee airman's only "Ace" pilot with 5 kills. This airplane is his North American P-51 in which he scored three kills in one day on October 13th 1944. While usually referred to as a P-51B, Archer actually flew a P-51C model, which only differed from the B in where it was manufactured. Archer went on to serve in the Korean War as well, and retired from the Air Force in 1970 with the rank of Lieutenant Colonel. Truly one of America's great heroes

This kit is one of the exciting new range of E-Z Snapz from Pegasus Hobbies. It is designed to be put together by the first time modeler of almost any age, and still have excellent detail to the level that even professional modelers will be impressed with. Truly, a kit for all ages, regardless of what your skill is. Both decals and stickers are included for markings, so no one will be left out! Look for more exciting kits coming in this range. Build an entire fleet of planes the E-Z Snapz way from Pegasus Hobbies!

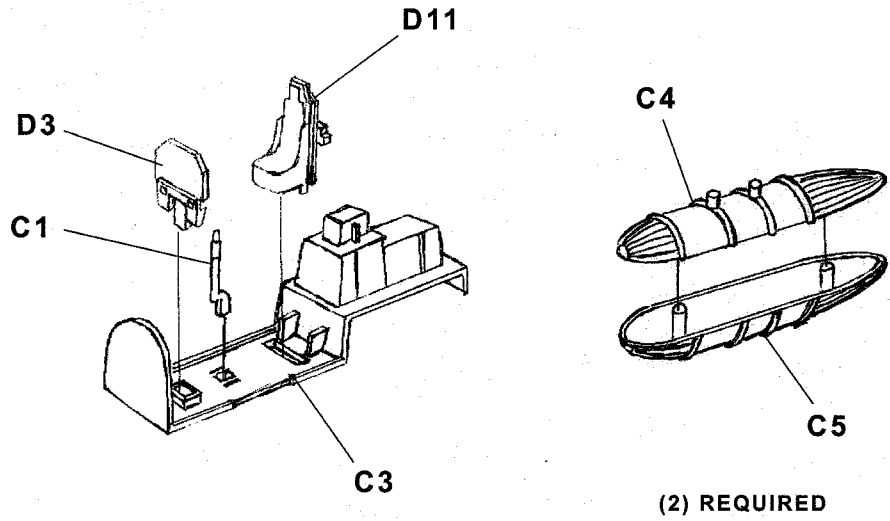
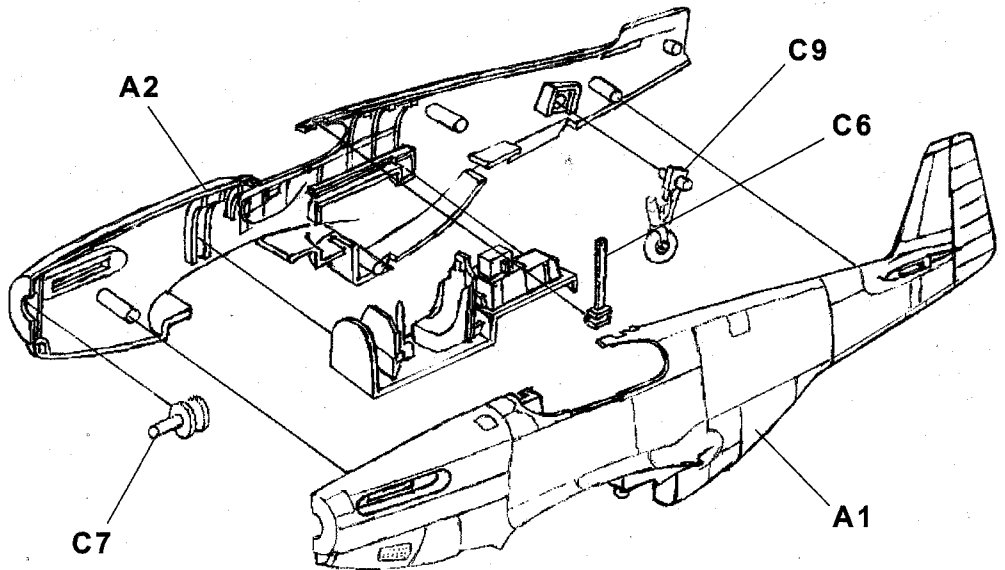
1**Cockpit and fuel tank assembly****2****Fuselage assembly**

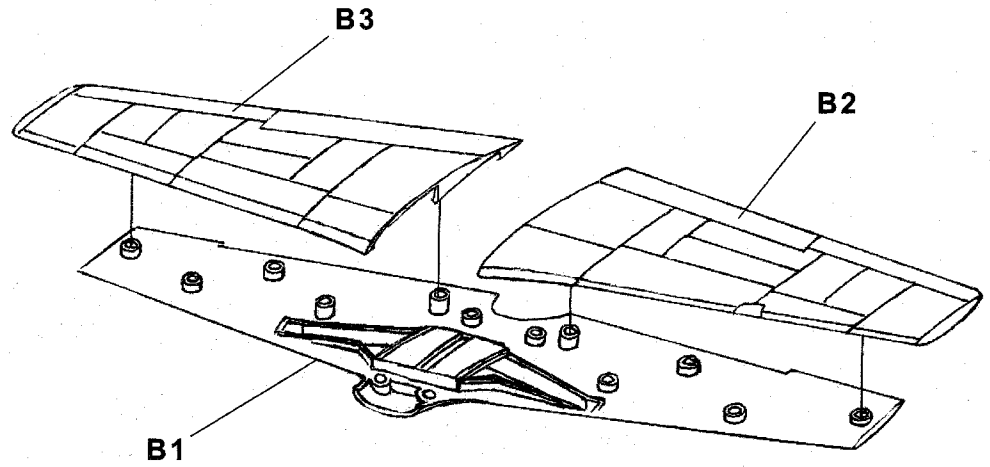
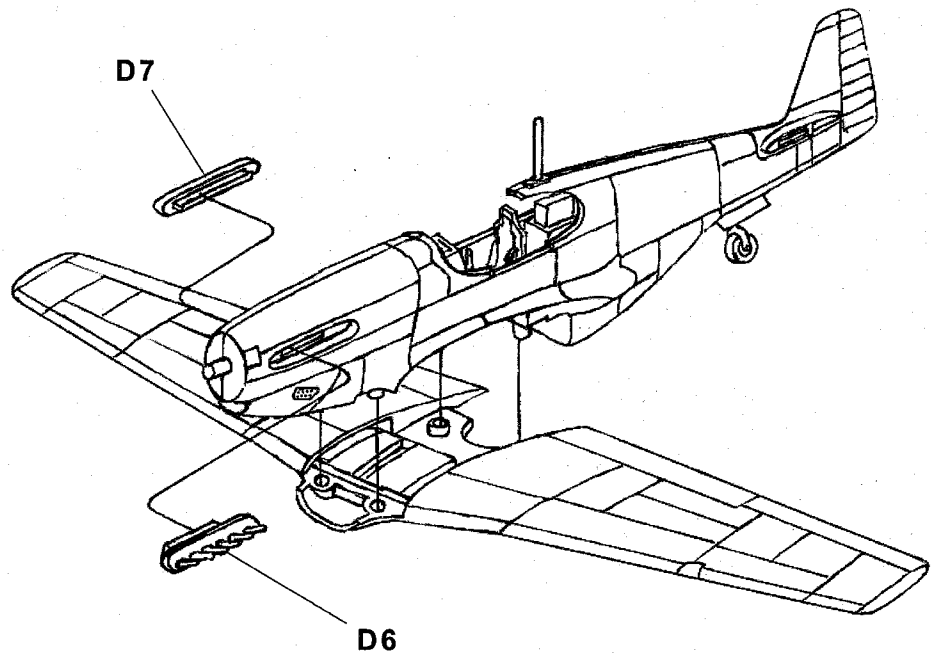
3**Wing assembly****4****Attaching wing assembly**

5 Landing gear assembly

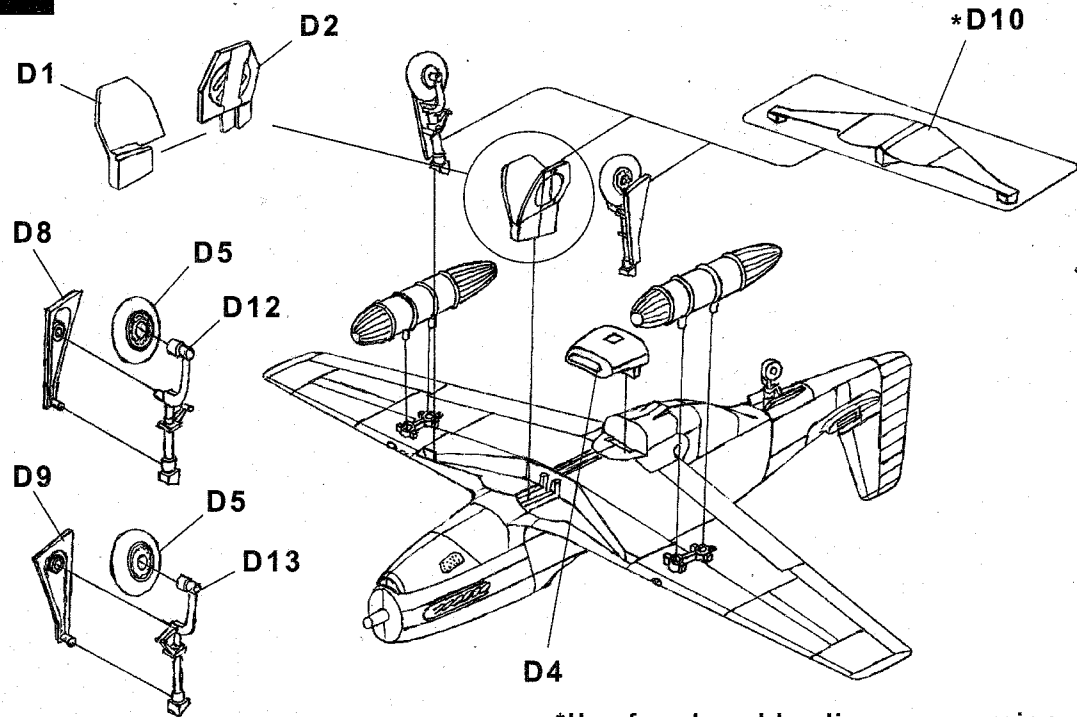

*Use for closed landing gear version

6 Attaching canopy and propeller

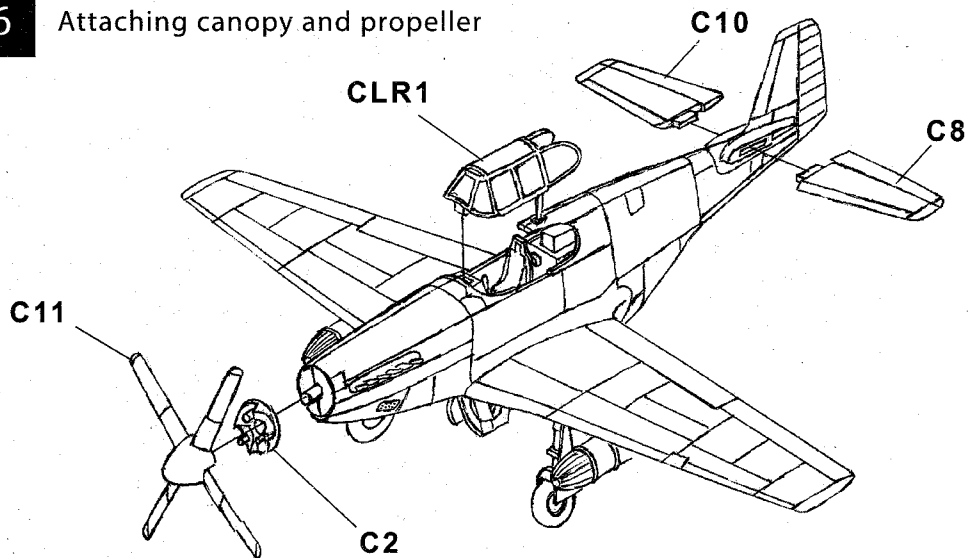

DECAL & PAINTING GUIDE

- To get a really nice finish, make sure you use quality hobby paints and brushes. Take good care of your brushes and clean them well after every time you use them and they will last long time. Before you paint, be sure to lay down some newspaper in the area you plan on working. Paint the interior first, before the fuselage halves are put together. Then paint the fuselage after assembly is completed. Paint the landing gear separately from the fuselage, and leave them off when painting the fuselage. After the paint has dried completely, put on the decals or stickers.

1. Cut each design out separately, only when you are ready for that one.
2. Take a paper towel and fold in half twice.
3. Dip the decal in a dish of water for only 10 seconds, and then put it on the paper towel, design side up.
4. Wait until the design moves freely around on the paper. Only touch it with a wet finger tip!
5. Slide the design from the paper onto the model and blot the excess water away with a paper towel and let dry.

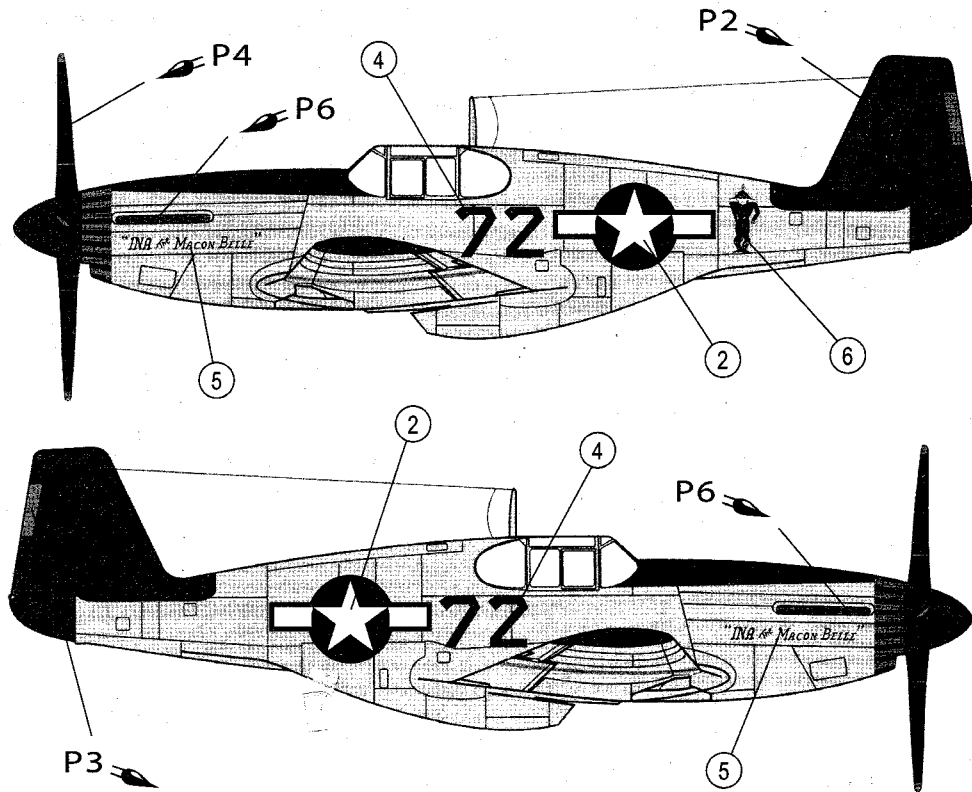

Paint Color Chart

P1	Aluminum
P2	Guards Red
P3	Insignia Yellow
P4	Flat Black
P5	Olive Drab
P6	Gunmetal
P7	Zinc Chromate Green

