

P72015 Typhoon Mk.I 1/72 Gun Bays

Special Hobby 2024

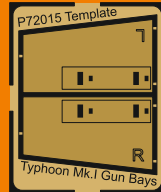

PE - Photo-etched parts

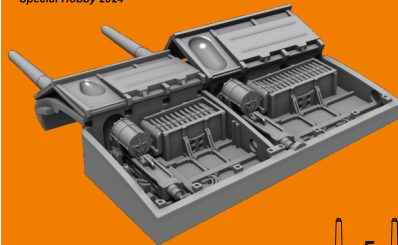

3D-Printed Parts

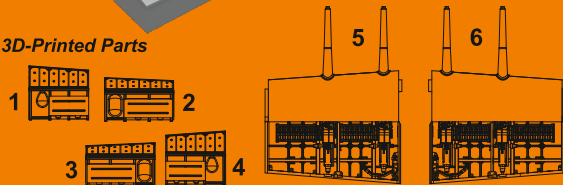

díly stavebnice
kit parts

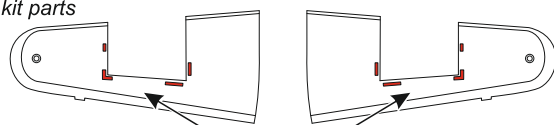

díl stavebnice
kit part

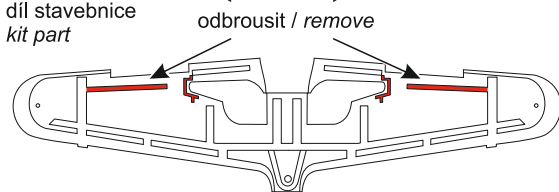

díl stavebnice
kit part

odbrousit / remove

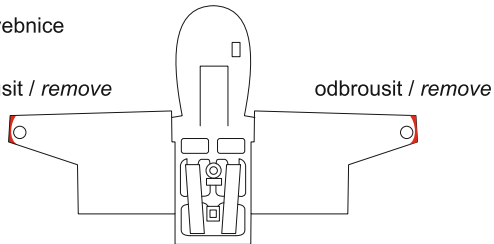

Ohnuté 3D tisky narovnejte ponořením do horké vody, srovnejte je a zchladte studenou vodou. K lepení použít kyanoakrylátové lepidlo! Kontaktní plochy doporučujeme před lepením odmastit. Různé drátky a tyčinky nejsou přiloženy.

Bent 3D printed parts: put them into hot water, straighten them and cool them in cold water. For best result use cyanoacrylate glue! Ungreasing contact areas is recommended before gluing. Wires and rods not included.

www.cmkkits.com
www.specialhobby.eu
www.facebook.com/specialhobby/

Special Hobby also offers 1/72 3D printed sets
P72001 Focke Wulf Fw 190A/D Seat
and P72002 Ju 87D/G Gunner's Seat and MG 81Z
machine gun



Special Hobby, meziklesí 718, CZ - Praha 9, 193 00, e-mail: office@specialhobby.eu

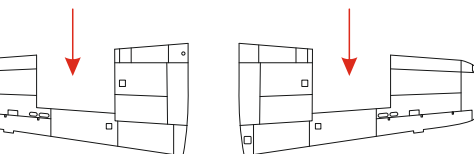
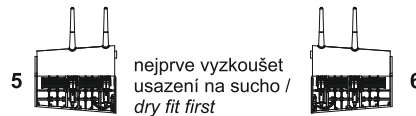

díly stavebnice
kit parts

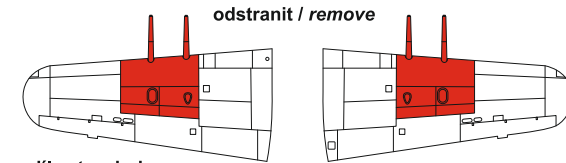
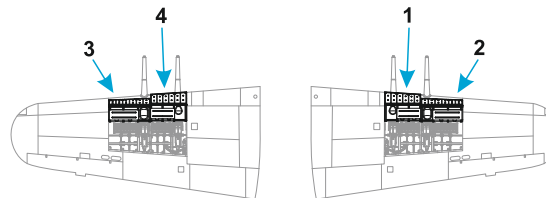

díly stavebnice
kit parts

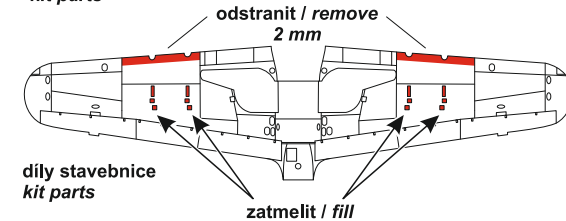

díly stavebnice
kit parts

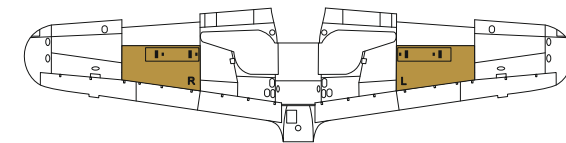

narýt podle šablony
scribe using etched-template

P72013



Typhoon Mk.I
Gun Sight and Seat
Correction Set

Q72413



Tempest/Typhoon
Early type
Wheels

P72014



Typhoon Mk.I Three-blade Propeller

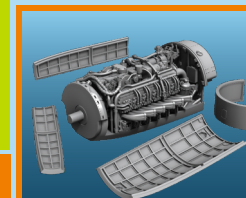

P72012

Typhoon Engine
and Fuselage Tank

Contains the top of the Sirocco engine, open oil tank
and cover panels. For Airfix kits.

1/72

Our range of sets for the 1/72 Typhoon Mk.I (Airfix kits) is extensive. We offer not only P72013 Typhoon Mk.I Gun Sight and Seat Correction, but also other sets:
129-P72012Typhoon Mk.I Engine 1/72 / for Airfix kit
129-P72014Typhoon Mk.I Three-blade Propeller 1/72 / for Airfix kit
129-P72015Typhoon Mk.I Gun Bays 1/72 / for Airfix kit
129-P72016Typhoon Mk.I Standard Exhausts 1/72 / for Airfix kit
129-P72017Typhoon Mk.I Late Type Shrouded Exhausts 1/72 / for Airfix kit
129-Q72413 Tempest/Typhoon Early type Wheels 1/72

Note:
P72XXX - 3D printed sets
Q72XXX - resin cast set
(printed master)