

ADECO

1:48 scale
Messerschmitt BF109 G2 - G14
Cockpit set (For Hasegawa kits)

Assembly instructions

1 Sidewalls

Make sure to leave enough space for the floor assembly

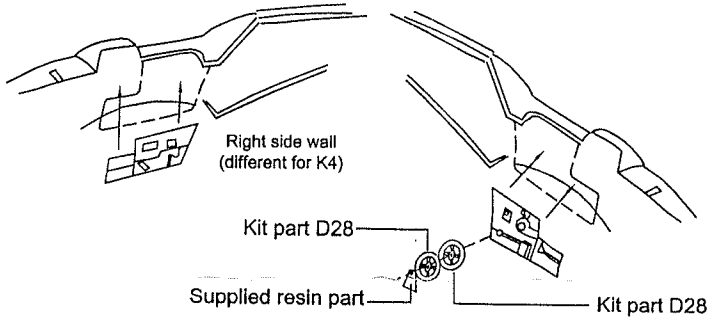

The resin part will require a little sanding to achieve a perfect fit with the floor

Once you have made these assemblies, fuselage halves can be glued together

2 Instrument panel / Gunsight

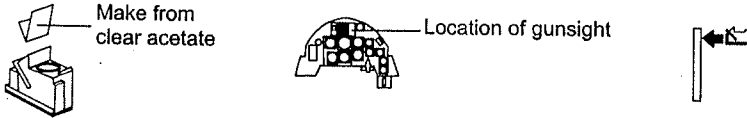

You can then glue the instrument panel assembly from below the joined fuselage

3 Floor / Canon cover / Control column

Glue the 3 parts as pictured. The floor has a locating tab for the Canon cover

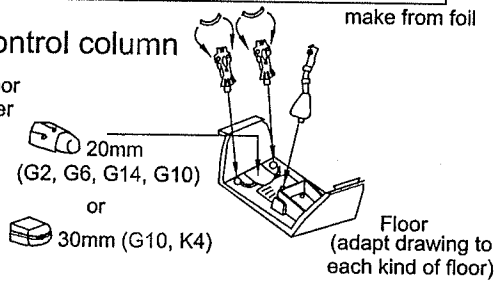

4 Positioning of Seatbelts

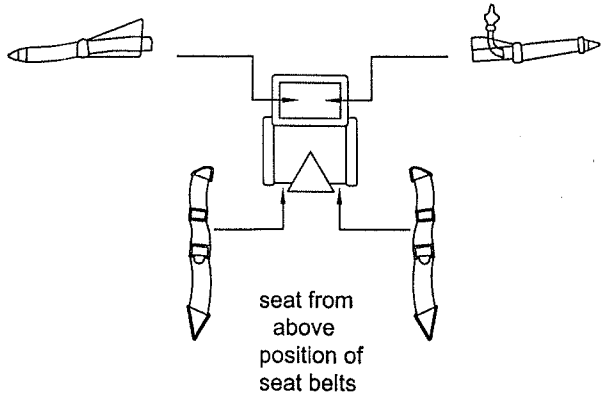

Once you have made these assemblies, floor can be glued in the fuselage.

Painting instructions

① Sidewalls

Base colour: 1

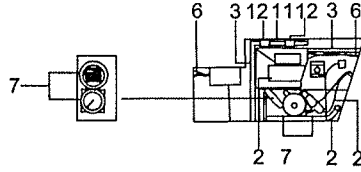
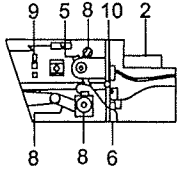

② Floor

Base colour: 1

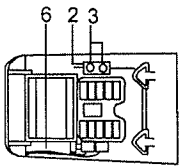

③ Firewall

Base colour: 1

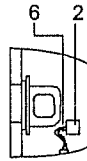

④ Instrument panel

Base colour: 1

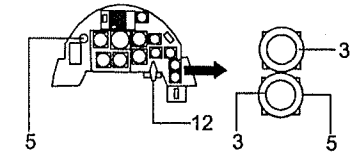

All instruments black with white dials unless indicated

⑤ Control column

Base colour: 1

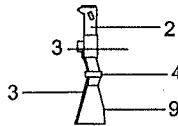

⑥ Gunsight REVI 16B

This part of the glass was tinted like sunglasses

Lens (glass colour)

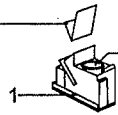

Base colour: 12

7 Additional infos

Seat belts and buckles

German seat buckles were dull aluminium in colour. The anchoring buckles (seat and shoulders) were painted RLM66. Fabric belts were light tan, often almost white.

Late Me109G6/G14

Because of shortage of raw material and paint, some late cockpits might have looked a bit different from the normal production models. For instance, the leather control column boot was later replaced by fabric. As well, the oxygen equipment was later only partially painted blue. The balance/trim wheels were also different between early and late G6/14. The normal model was punched metal with round brown bakelite edges. This is rather well replicated by the original kit plastic parts. Later, the wheels were only punched with rounded edges. This can be more authentically reproduced by photo etched accessories.

8 References

Airframes

2 surviving aircrafts were used to produce this set:

Me 109/G6, Wr.Nr 163824 built in Autumn 1943 by Messerschmitt at Regensburg
Me 109/G14, Wr.Nr 167271 built in Spring 1944 by Messerschmitt at Aubsburg

Manuals

We also used some war time instruction and maintenance manuals. Among them:

Spare part catalogue (1944)
Pilot's Handbook (1944)
Field Reparation manuals (1943 revised edition)

9 Paint codes

1: Dark grey (RLM66)	5: Red (RLM23)	9: Red/Brown leather
2: Black	6: Light yellow	10: Brown Bakelite
3: Yellow (RLM27)	7: Blue (RLM24)	11: Metal (Silver)
4: White (RLM21)	8: Gun metal	12: Dull aluminium

These ADECO masters and research work were made in Finland by Vincent Kermorgant.

Casting, conditioning and distribution are made by:

Model Design Construction
Corner Unit, North Mill, Bridgefoot
Belper, Derbyshire, DE56 1YD
UK