

Churchill Mk VI

Ordnance QF 75mm gun

British Infantry Tank

In the late thirties British tank doctrine identified three distinct roles for tanks these being classified as light tanks, intended for reconnaissance, cruisers for rapid exploitation of breakthroughs and Infantry tanks. The British tank design concept established in 1930s resulting tanks in three very different aspects: light tanks for reconnaissance, cruiser tanks which were fast and mobile and infantry tanks to accompany infantry to help them break through heavily defended areas in the enemy lines. Although the Matilda's performance was proven in the Battle of France in 1940, yet its small turret made a heavier gun impossible. Furthermore, its limited off-road speed was never considered satisfied.

Designed as the successor of Matilda, a new tank infantry prototype was introduced in November 1940, and the first batch of mass production tanks saw service in June the following year. This series of tanks was named after Winston Churchill, who was appointed First Lord of the Admiralty at that time, due to his contribution to the development of the tank as a weapon. As an infantry tank, the Churchill features with heavy armours and reliable suspension systems, equipped with 11 bogies each side.

Churchill Tank's defence capabilities and firepower were gradually improved as the war moved on. By 1943, the production of all versions of Churchill Tank reached 3500. Yet, malfunction issues had been haunting Churchill Tank so that the British Army even planned to switch the production to Cromwell cruiser tank. Churchill Tank was retained eventually due to its thick armour, which gave the Churchill better defence capabilities in combat. This advantage gave the Churchill opportunities for further improvement and upgrades. At the time, the 6-pounder gun on Churchill IIIs and IVs showed merits in anti-tank tasks, yet insufficient for soft targets with high explosive projectiles.

Churchill IV commenced to produce on late 1943. It was equipped with an Ordnance QF 75 mm gun to replace the 6-pounder gun. In addition to improvement in anti-personnel tasks, the other major advantage was it could share the same ammunition with US Army's M3 and M4 tanks. A total of 200 Churchill IVs was produced, which saw actions on D-Day and combats that followed.

イギリス陸軍の戦車設計の方針は1930年代に、まったく異なる用途の3種類の戦車によって確立された。すなわち、偵察用の軽戦車、機動性と速度を重視した巡航戦車、そして歩兵に同行し、彼らの敵陣突破を助ける歩兵戦車の3種であった。

1940年のフランス戦において、マチルダ歩兵戦車の問題点が浮き彫りになった。小さな砲塔は大口徑の火砲の搭載ができず、さらに路外速度の低さは到底納得できるものではなかったのである。

マチルダ戦車の後継となる新型歩兵戦車の試作型は、1940年11月に完成し、最初の量産型は、翌年の6月に配備がはじまった。この新型歩兵戦車シリーズは、海軍大臣時代に戦車を兵器として開発することに貢献したウィンストン・チャーチルにちなんで、チャーチル歩兵戦車と名づけられた。

歩兵戦車としてのチャーチル戦車の特徴は、重装甲と信頼性の高いサスペンション(両側面の11個のボギーで接地圧を分散させる)であった。歩兵戦車チャーチルの防御力・火力は、戦争の進展に伴い次第に改良されていった。1943年までに、チャーチル戦車各型あわせた生産数は、3500輻に達していた。チャーチル戦車には、機械故障の問題が終始付きまとい、そのため英陸軍としては、クロムウエル巡航戦車への生産切替を計画していた。しかし、厚い装甲を誇るチャーチル戦車は戦闘において高い防御力を発揮し、引き続き生産され、前線で使用されたのだった。この利点により、チャーチル戦車には更なる改良・性能向上が加えられていくこととなった。かつてMk. IIIとMk. IVに6ポンド砲を搭載したことで対戦車戦闘力が大きく向上したが、軟目標に対するHE弾は依然として威力が不足していた。

チャーチルMk. VIは、1943年末に生産が開始された。これまでの6ポンド砲に換えて、オードナンスQF75mm砲を搭載したことで、軟目標への攻撃力が向上した。さらに、米陸軍のM3、M4中戦車の75mm砲と共通の弾薬を使用することができるようになった事は、大きなメリットだった。総計200輻のMk. VIが生産され、ノルマンディ上陸戦以降の戦闘に投入されたのだった。

在1930年代,英國的戰車運用理論中確立了戰車的三種截然不同角色,包括了執行偵查任務的輕戰車、能夠快速突破擴大戰果的巡航戰車,與伴隨步兵能提供步兵火力支援,並清除障礙與工事的步兵戰車。

經過了1940年的法國戰役後,儘管參與戰役的英國Matilda步兵戰車面對德國戰車有著傑出的表現,但過小的砲塔環限制了將來提升火砲口徑可能,另外它過於緩慢的越野性能也未能讓人滿意。因此英國政府委託設計一種新的步兵戰車用來取代Matilda步兵戰車。1940年的11月新型步兵戰車的試作車完成,1941年6月第一批量產車進入陸軍服役,由於當時的英國首相邱吉爾在擔任海軍大臣期間對戰車這種新武器開發的大力支持,為表章他的貢獻,因此新的步兵戰車遂命以邱吉爾之名。邱吉爾步兵戰車延續著步兵戰車既有的特點,有著厚重的裝甲與可靠的懸吊系統,車身兩側每側均有11組承載輪以分散接地壓。

1942年8月邱吉爾戰車首次投入實戰,隨著戰事的發展,邱吉爾戰車在防禦力與火力上逐次地進行提升。時序進入1943年,此時各型邱吉爾戰車生產的生產數量已經接近3500輛的龐大數量。由於機械故障的問題始終困擾著邱吉爾戰車,軍方曾一度計畫將生產主力轉移到克倫威爾巡航戰車之上。所幸邱吉爾戰車厚實的裝甲,在抵禦敵軍的砲火上較克倫威爾更為有效,由於保有此優勢,使得邱吉爾戰車仍然具有升級改良的機會。此時邱吉爾Mk.III與Mk.IV型六磅主砲的威力在做為反裝甲武器時尚稱優異,但在對軟性目標攻擊的高爆彈藥上就顯得能力不足。

邱吉爾Mk.VI型在1943年末開始生產,由Ordnance QF 75mm Mk. V主砲取代原本的六磅砲,除了在對於人員的殺傷效果有所提升之外,最大的優勢在於能夠使用與美軍M3、M4中戰車相同的彈藥。邱吉爾Mk.VI型共生產200輛,投入了諾曼地登陸登陸後在西歐的戰鬥。

Illustration:圖示說明



Method For Applying Decals:

1. Clean Model Surface With Wet Cloth.
2. Cut Out Of Decal Sheet And Dip Them In Warm Water For 15 Seconds.
3. Place it on proper position on model.
4. Slide off base paper leaving decals On Model With Wet Finger Tip.
5. Move Decals To Exact Position, Push Out Excess Water Under Decal With Soft Cotton Cloth.
6. When Decals Get Dry Then Complete.

水貼紙使用說明:

1. 將模型表面擦乾淨
2. 將貼紙剪下泡入溫水中浸泡約15秒
3. 將泡濕之貼紙取出置於欲貼處旁
4. 用指尖輕推貼紙表面使其滑出底紙
5. 將貼紙調整至適當位置並輕擦拭水份
6. 待其自然乾燥後即完成

Color list: 塗料表

Color	Brand	Gunze Sangyo			Humbrol	Revell	Lifecolor
		Hobby Color	Mr.Color	Mr.Color Spray			
Brass	黃銅	H9	C9	J9	54	92	LC75
Flat white	消光白	H11	C62	J62	34	05	LC01
Khaki green	卡其綠	H80	C54				
Olive drab(2)	橄欖綠	H78	C38	J38	66	46	UA106
Red	紅	H3	C3	J3	19	31	LC56
Red brown	紅褐	H47	C41	J41	160	383	
Sandy Yellow	沙黃	H66	C119		168		UA020
Steel	黑鐵	H18	C28	J28	53	91	LC76
Tire black	輪胎黑	H77	C33+C62		85	302	LC02
Wood brown	木棕	H37	C43		169		FS12

1

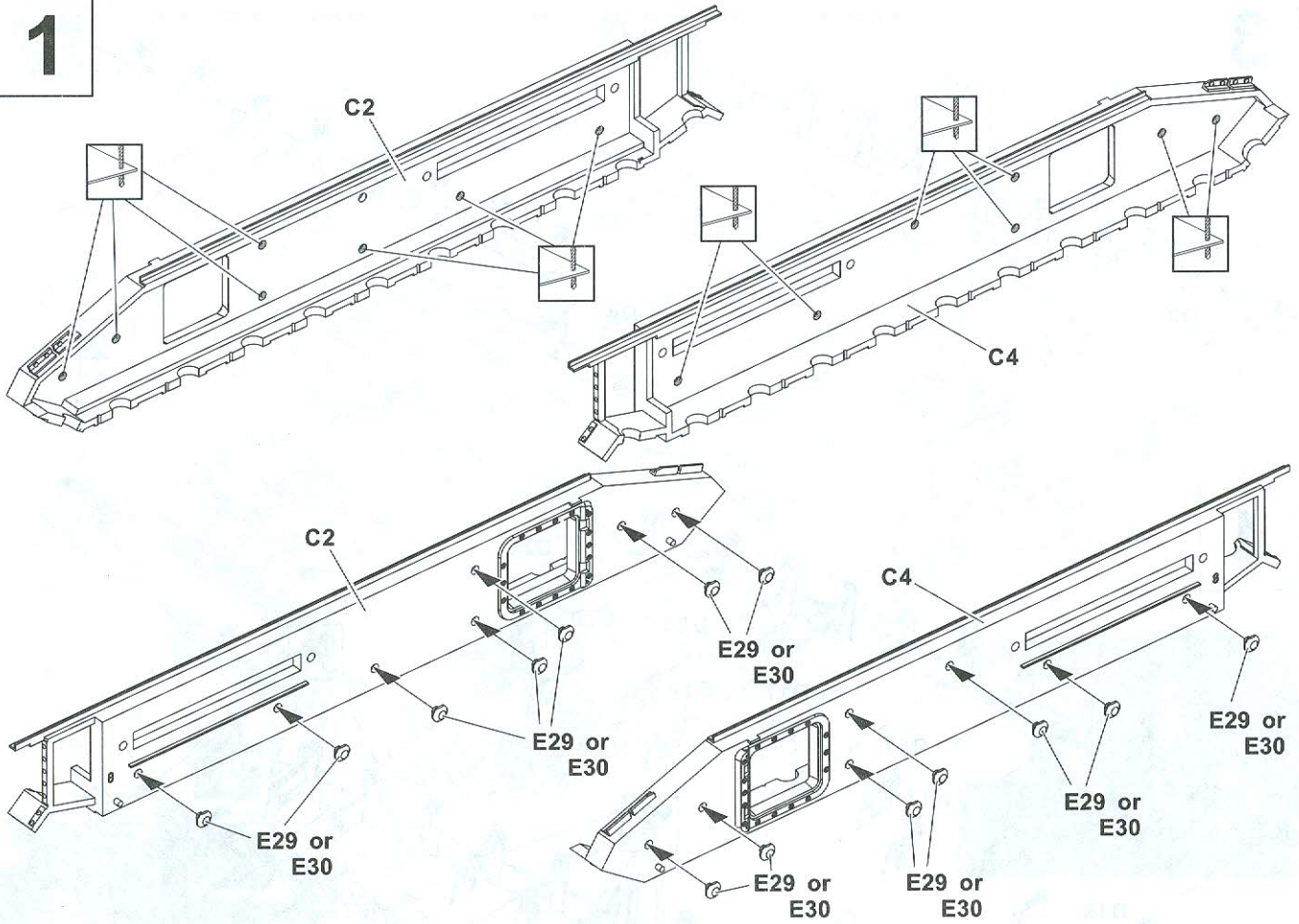

2

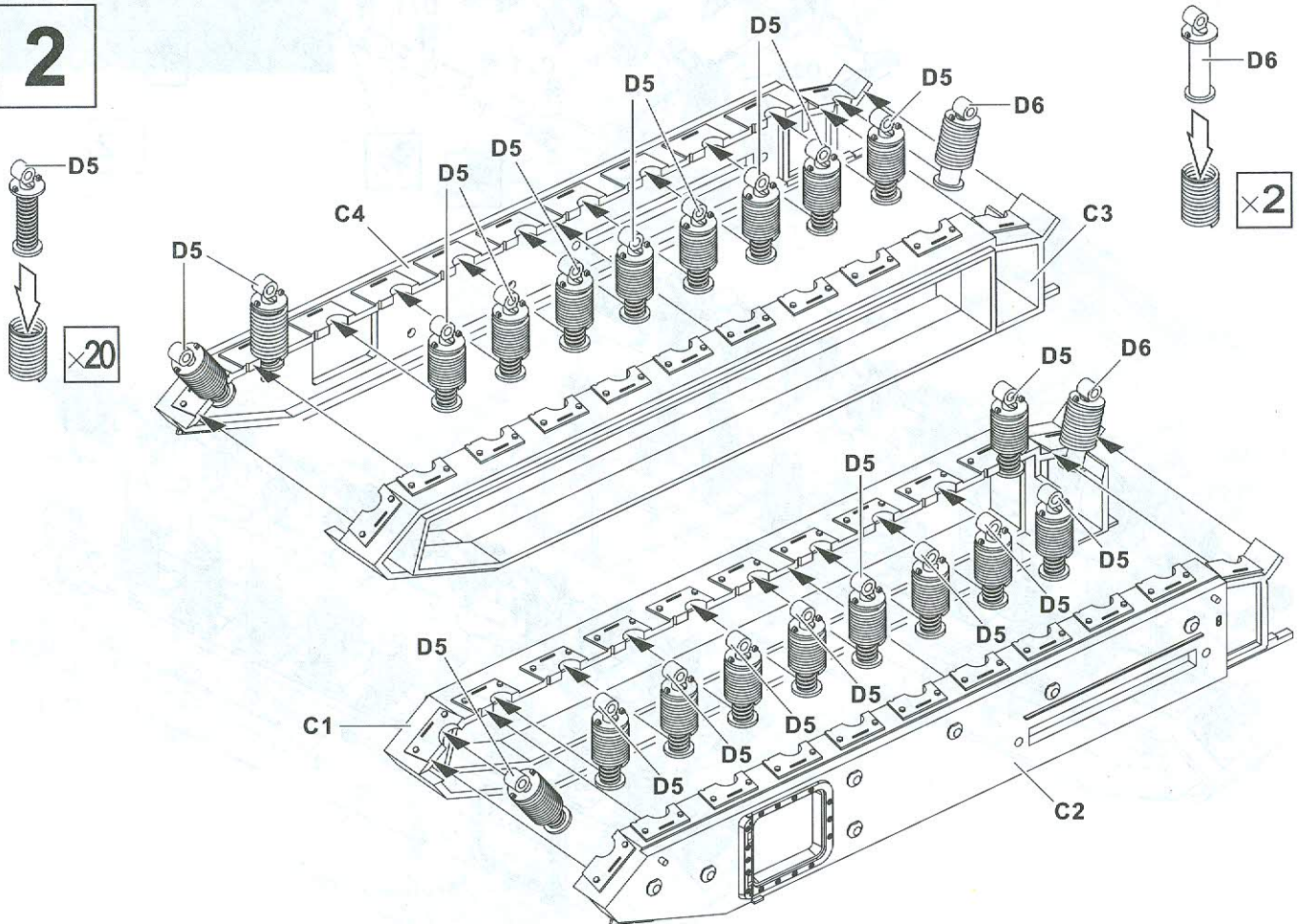

3

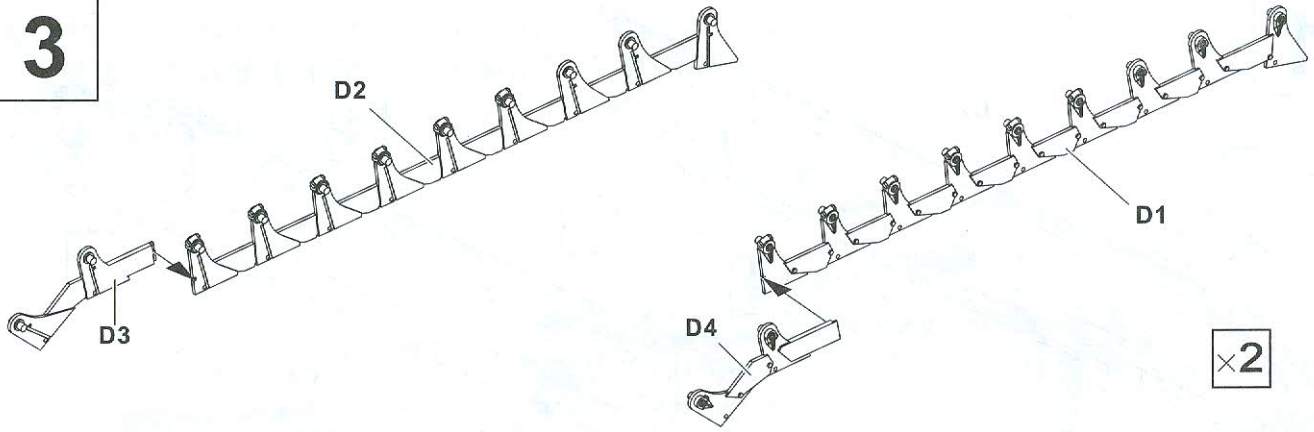

4

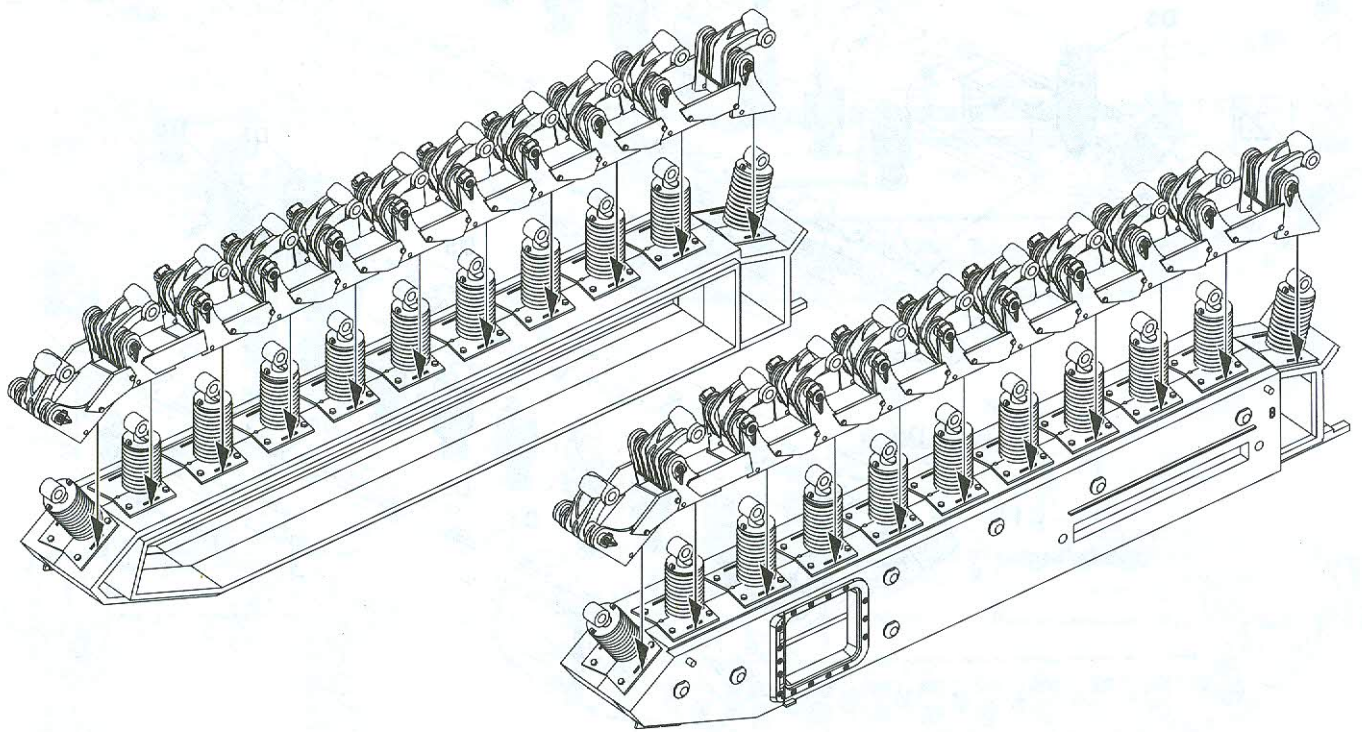
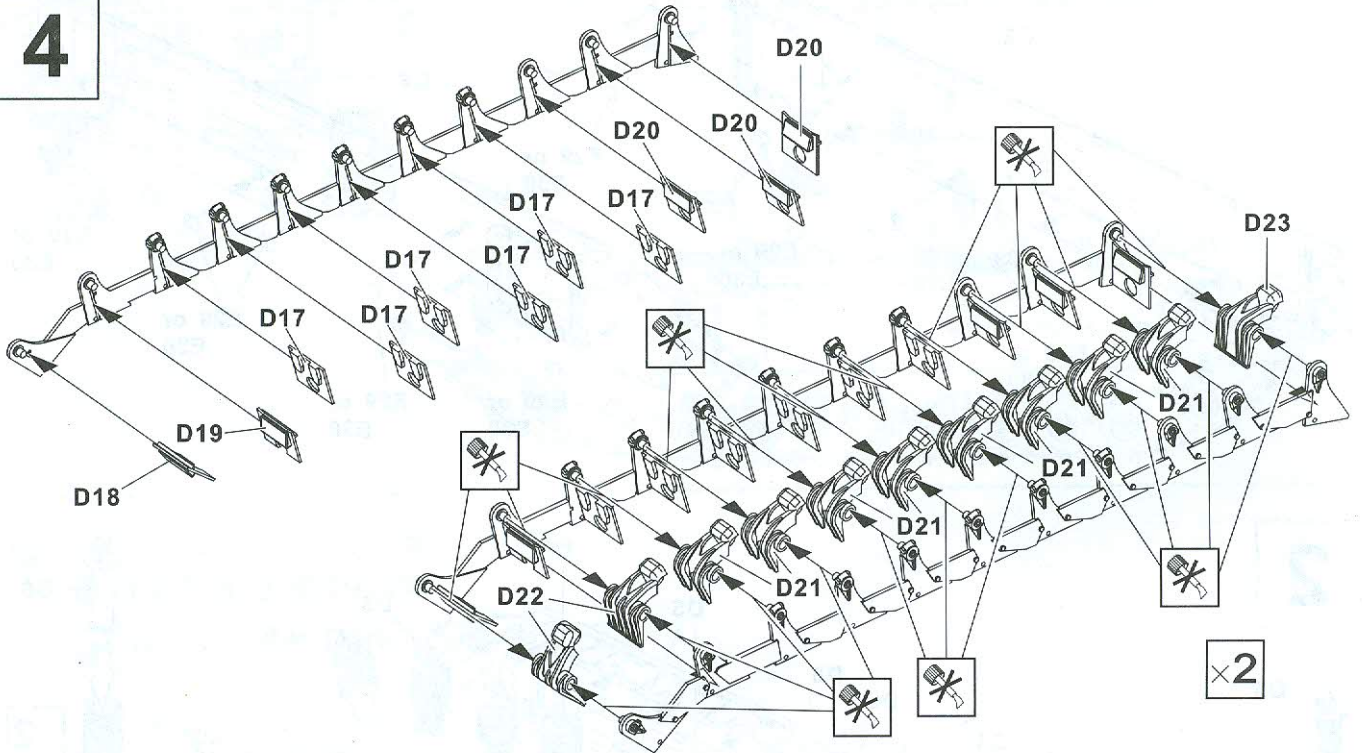

5

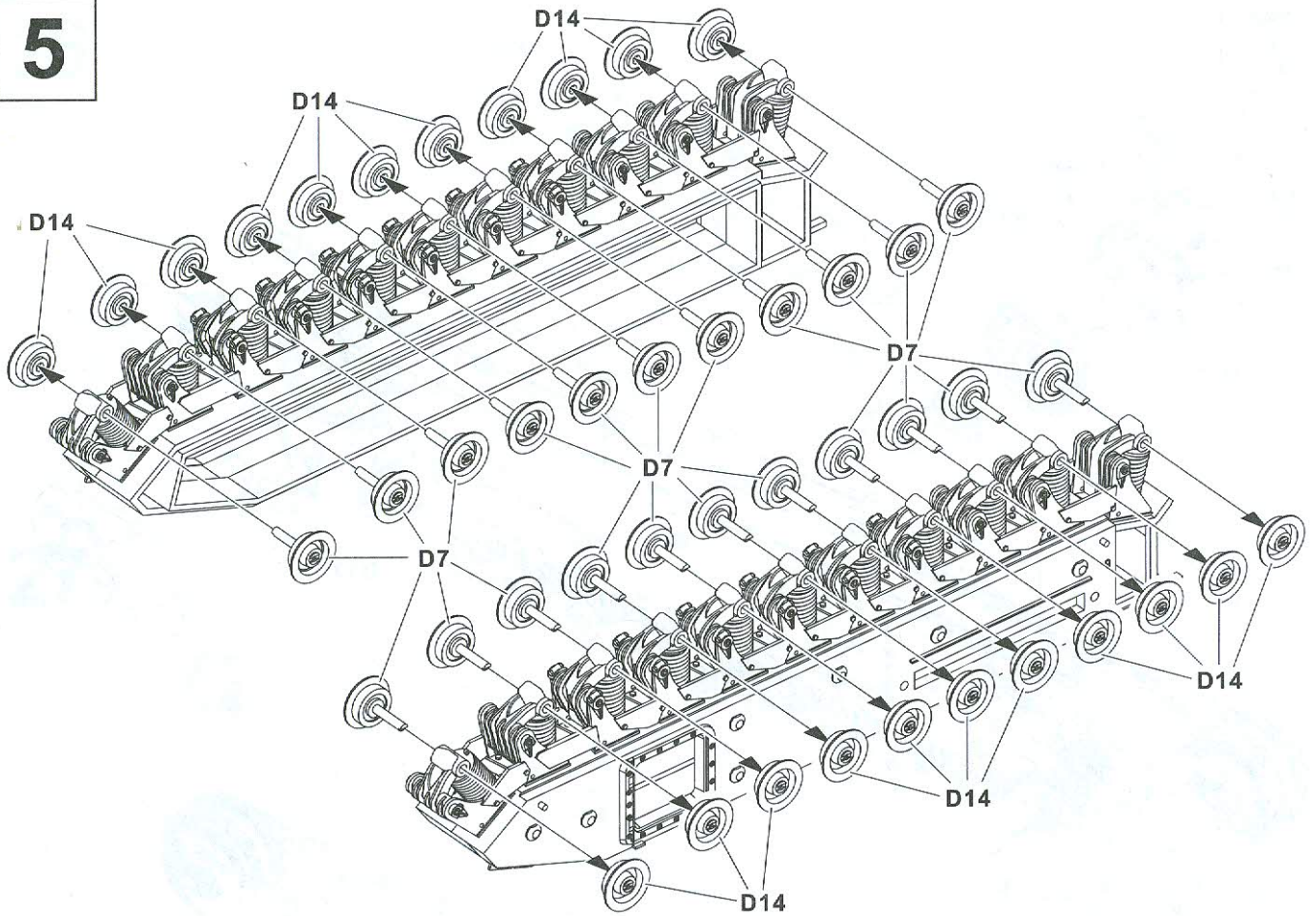

6

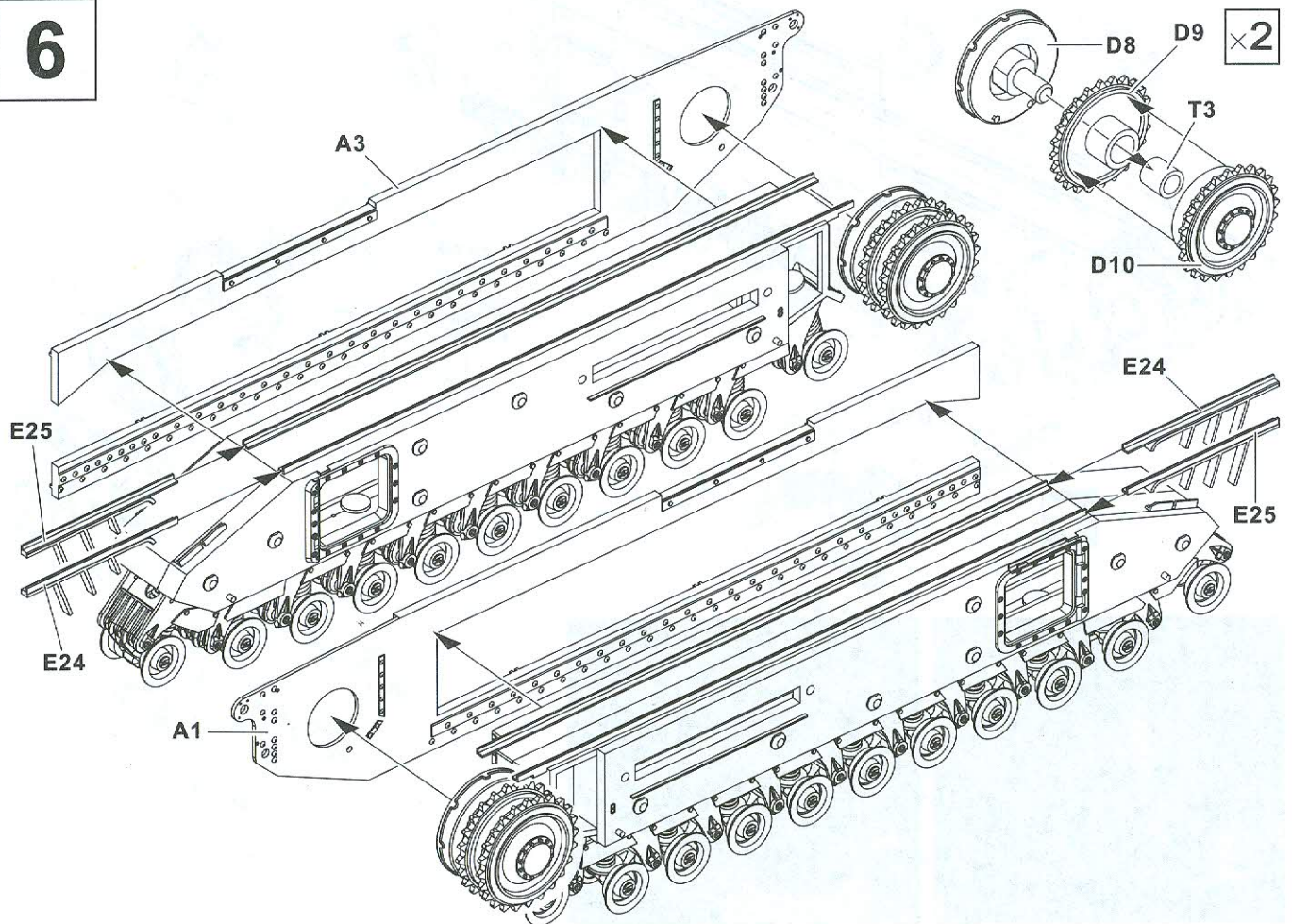

7

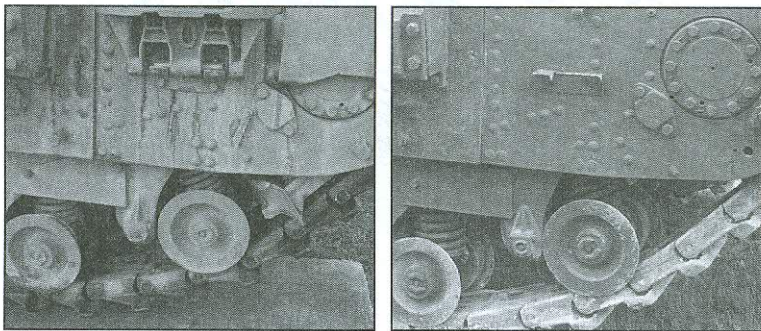
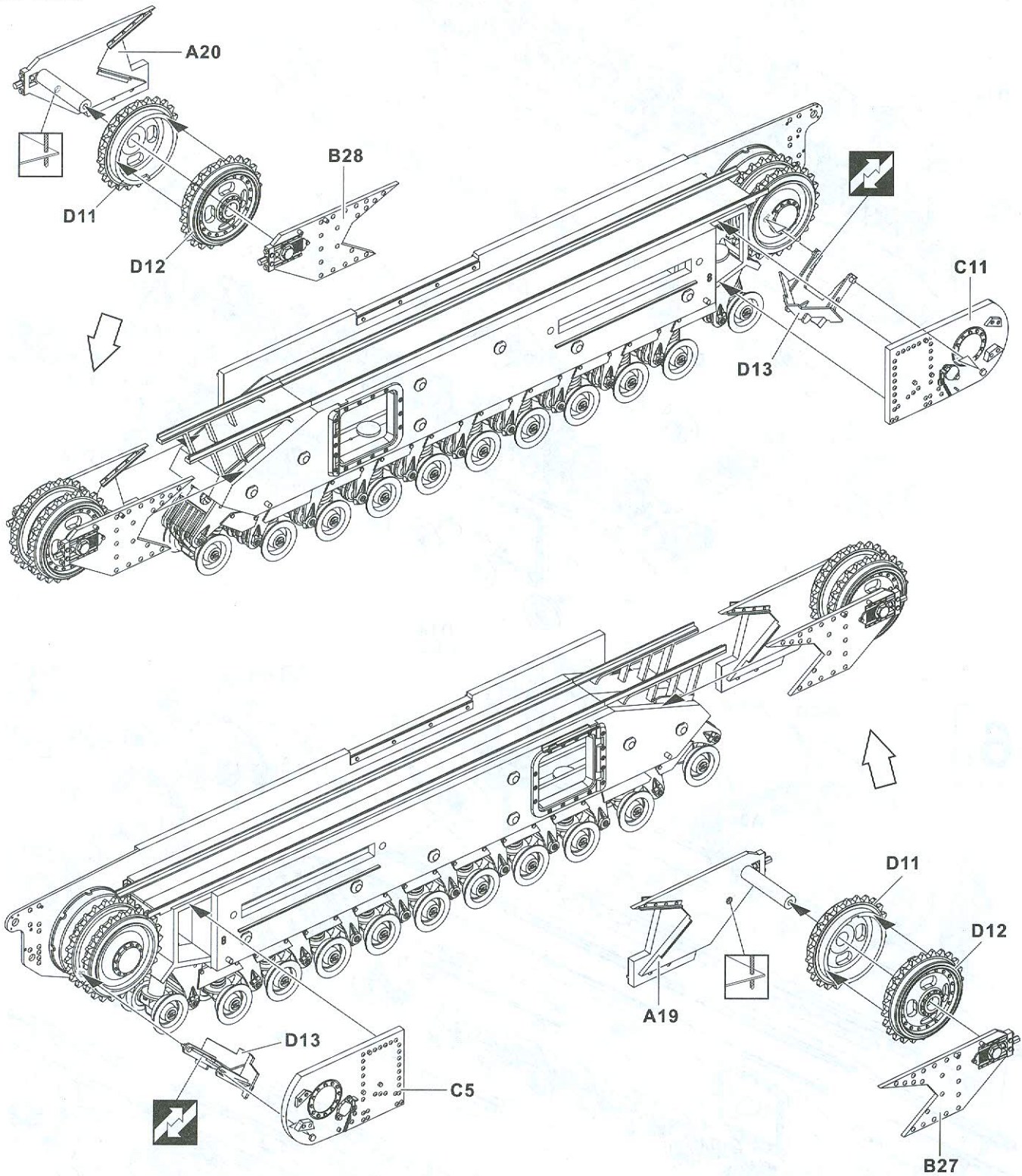

8

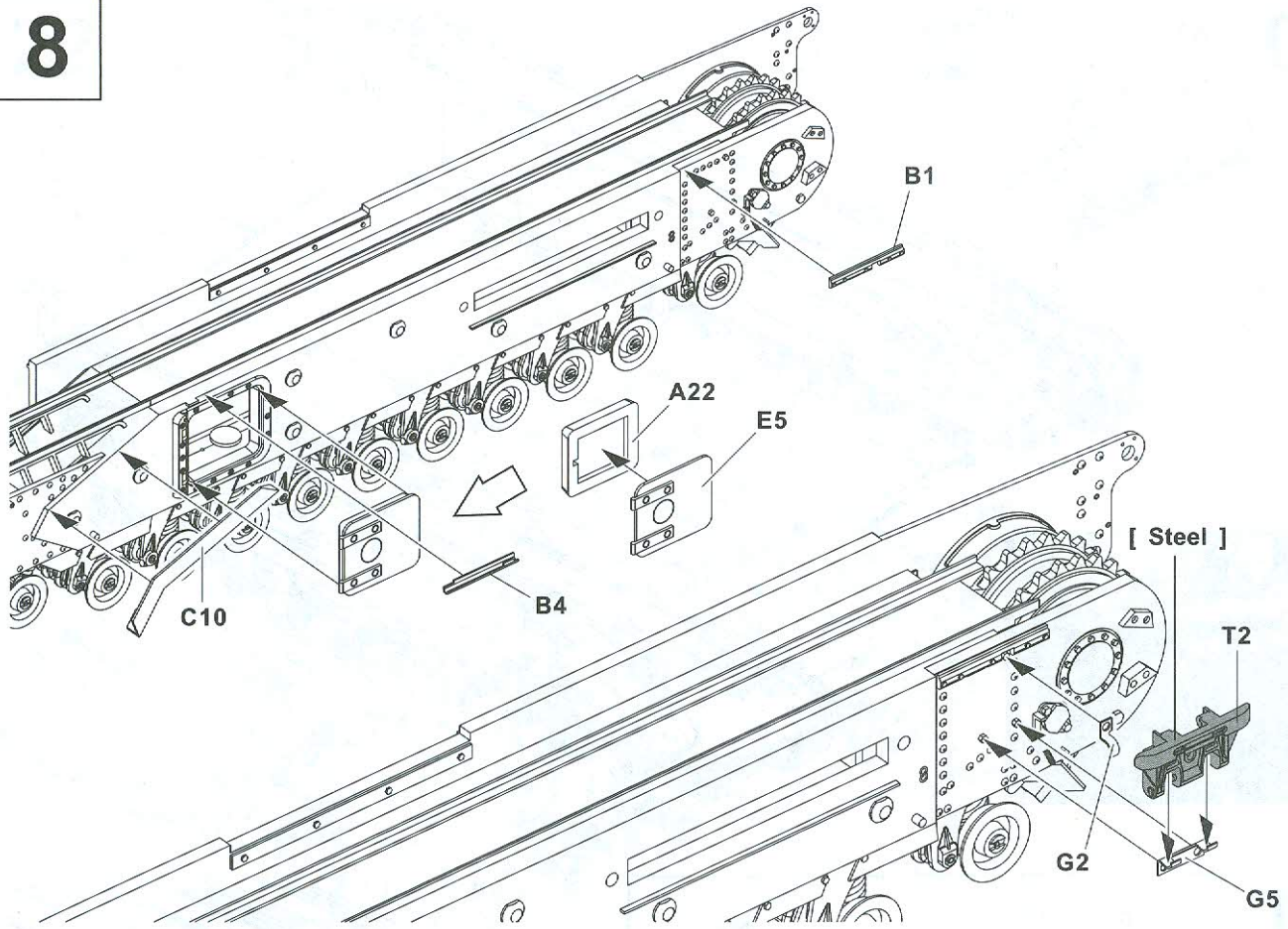

9

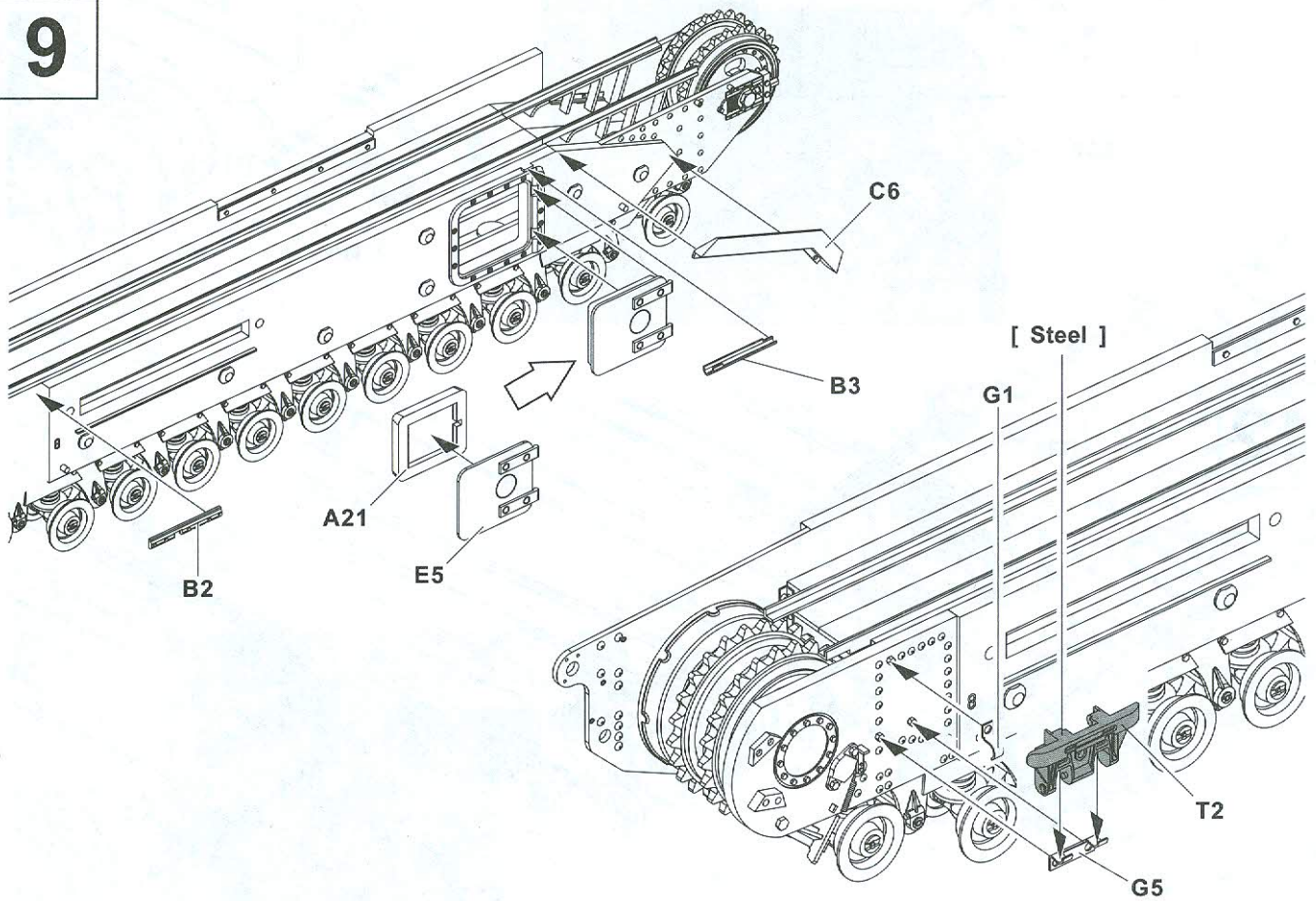

10

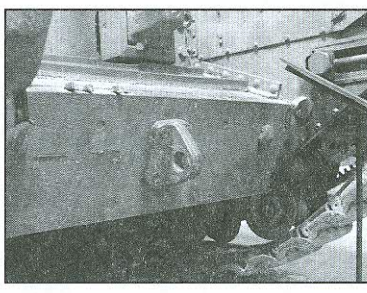
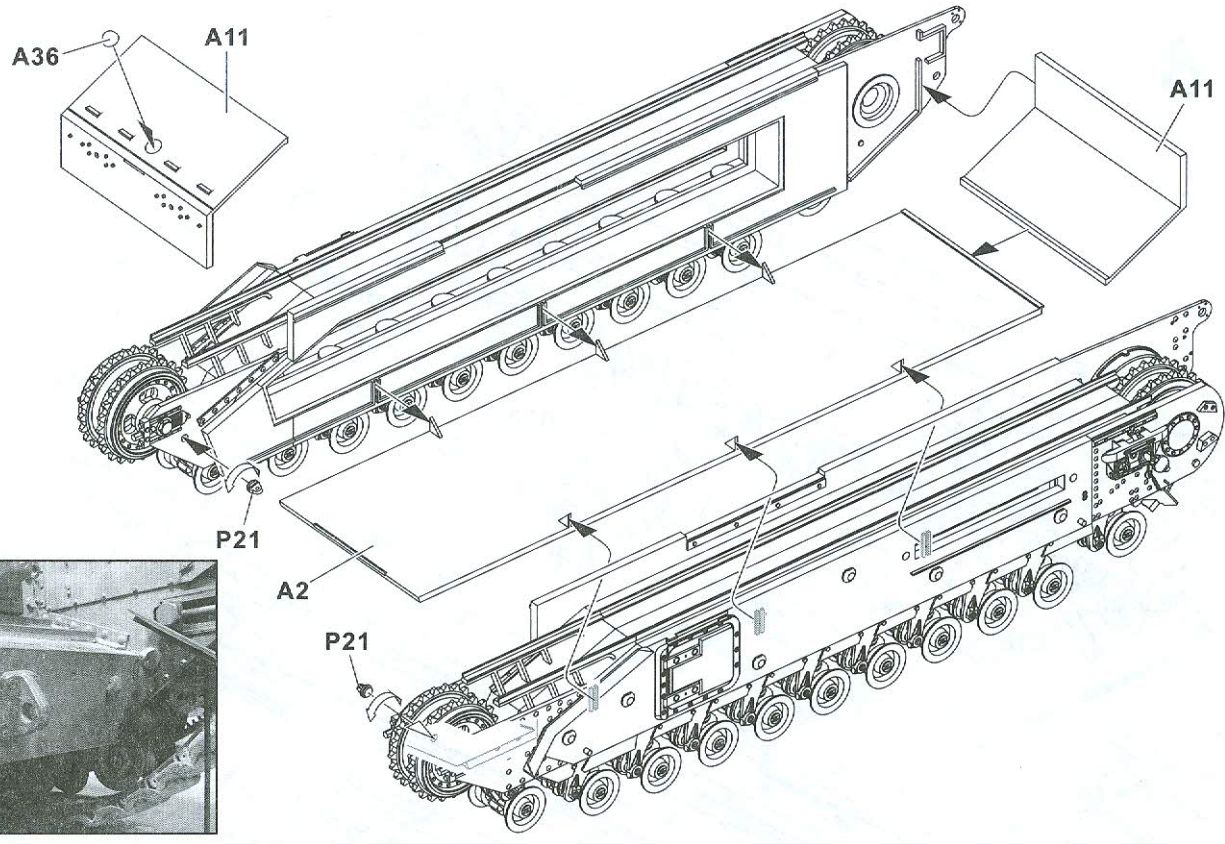

11

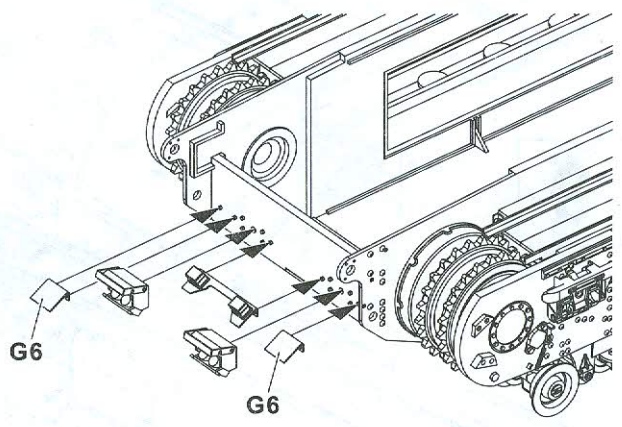
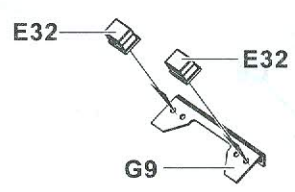
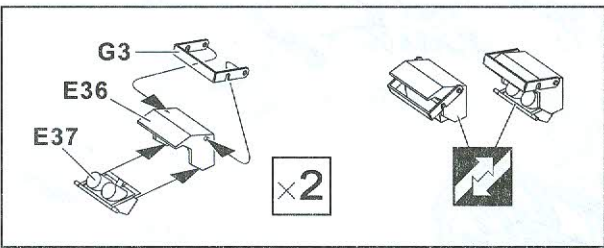

12

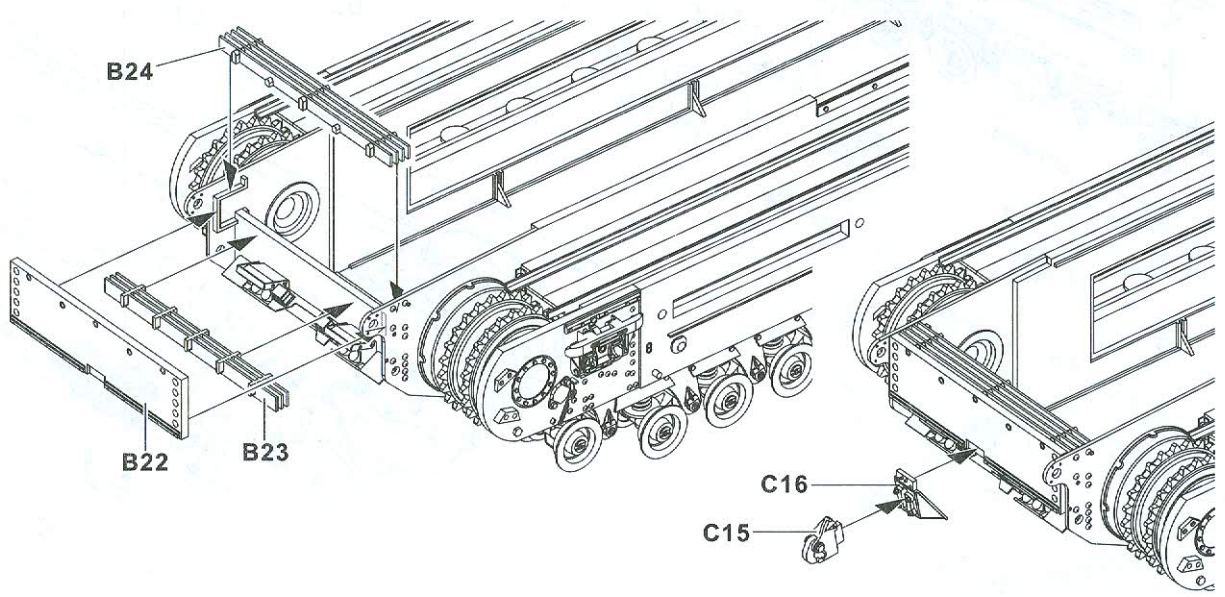

13

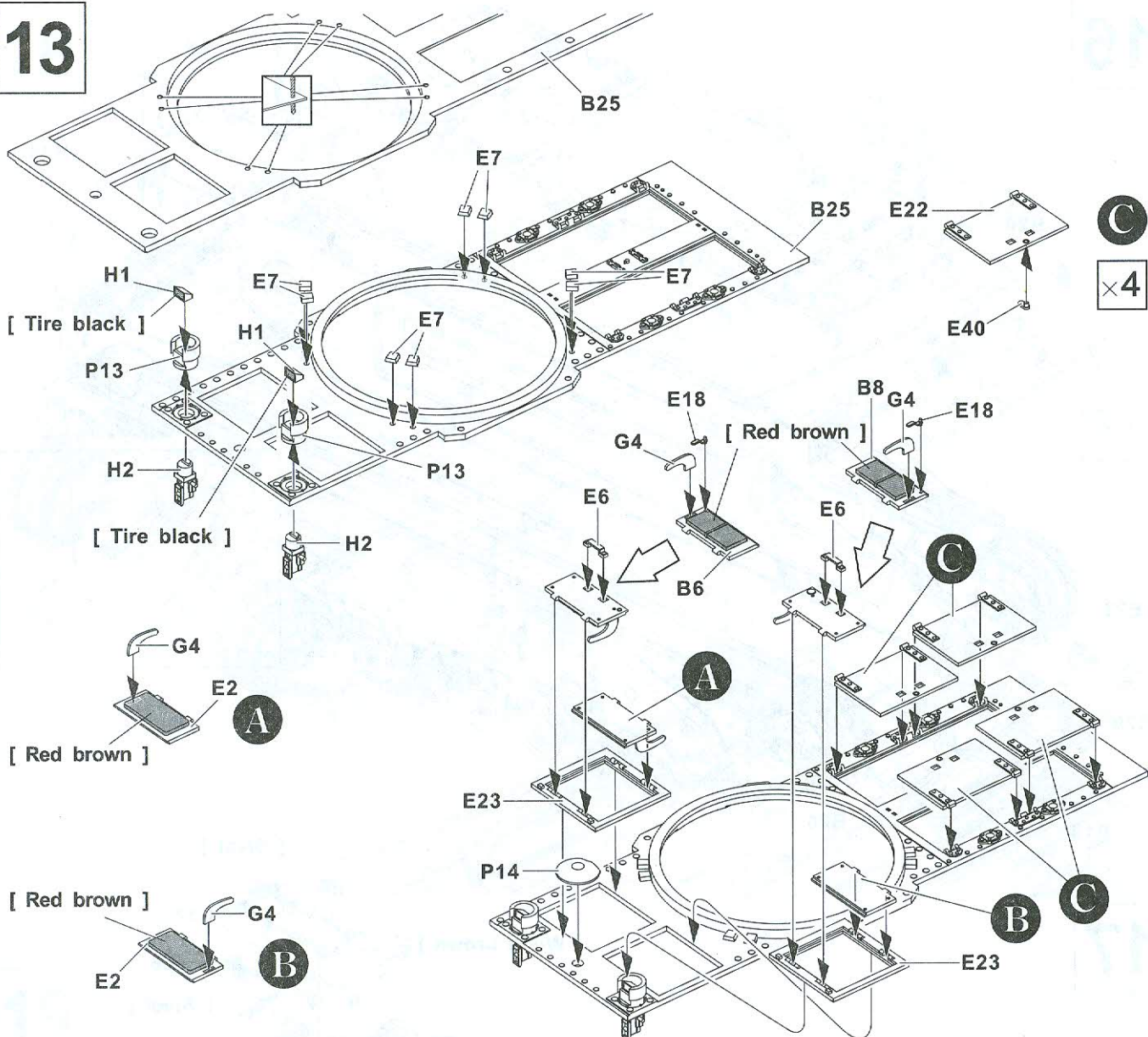

14

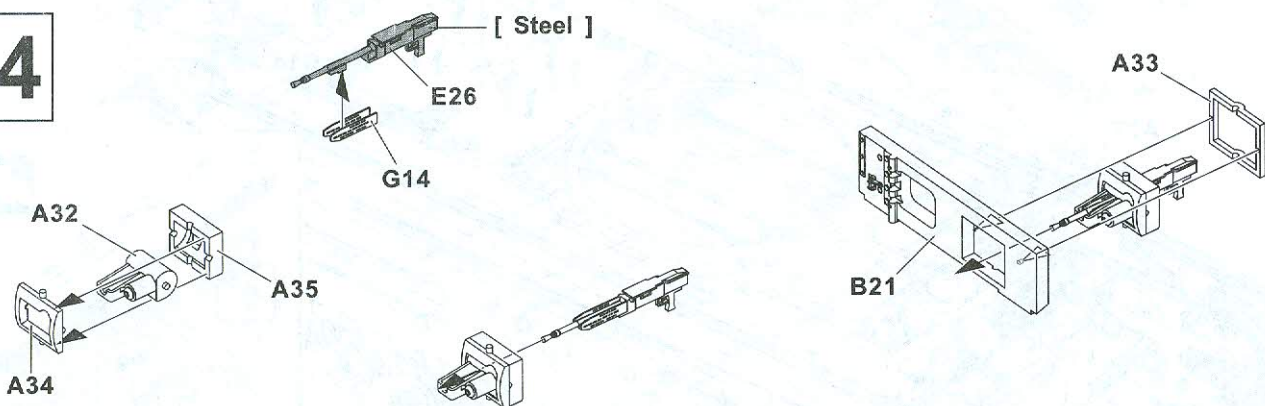

15

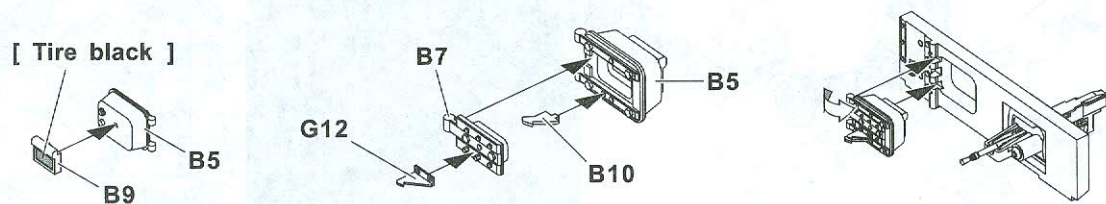

16

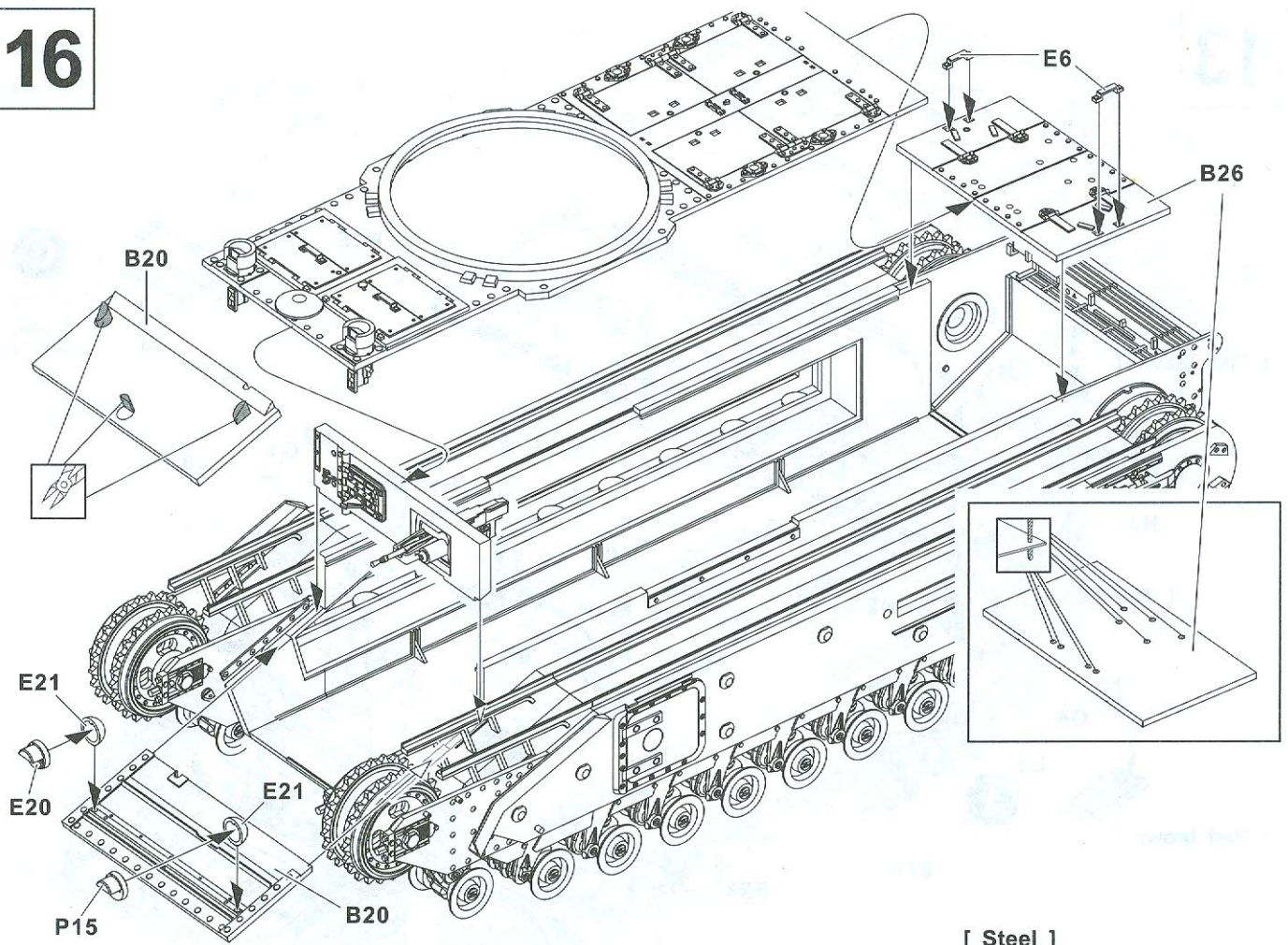

17

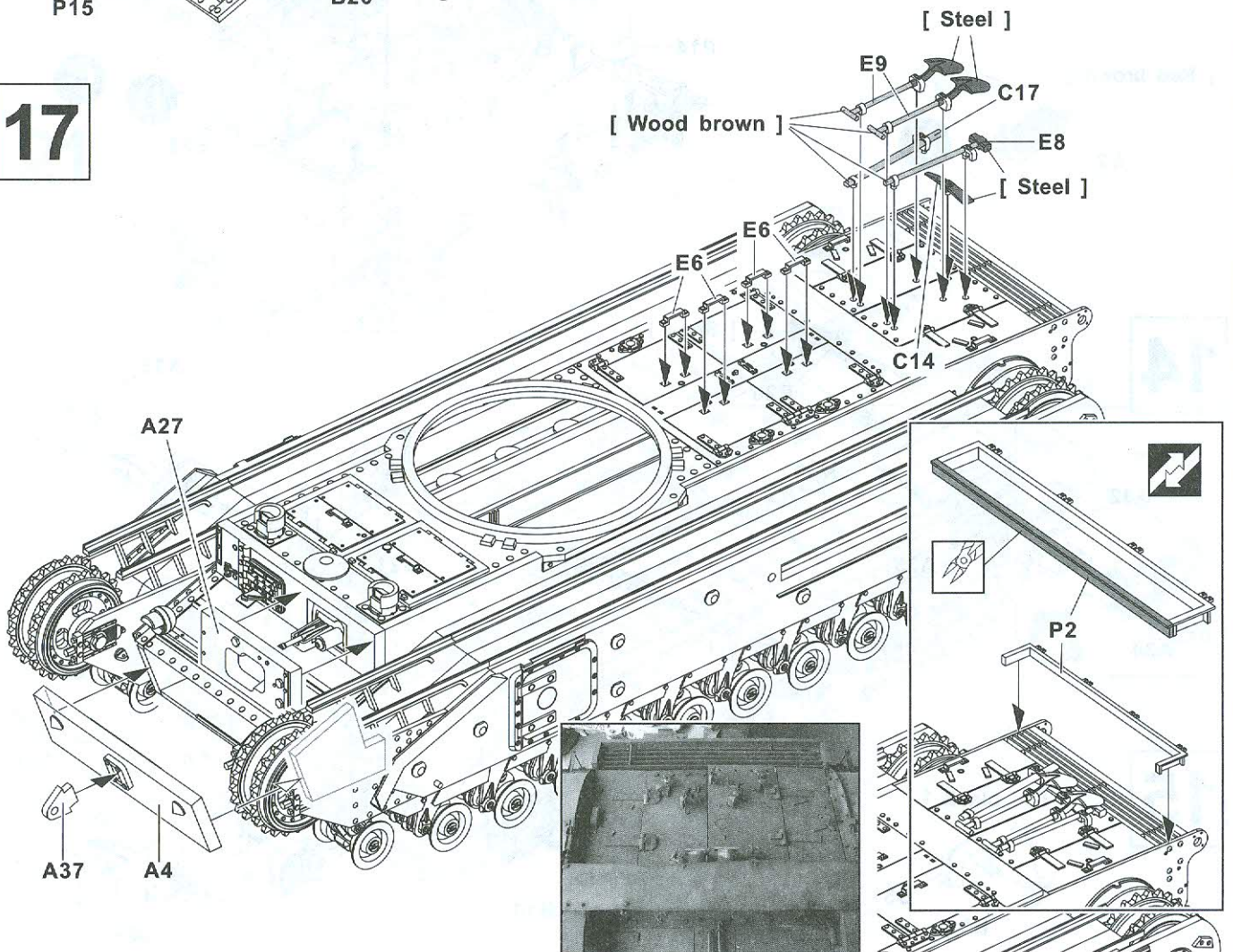

18

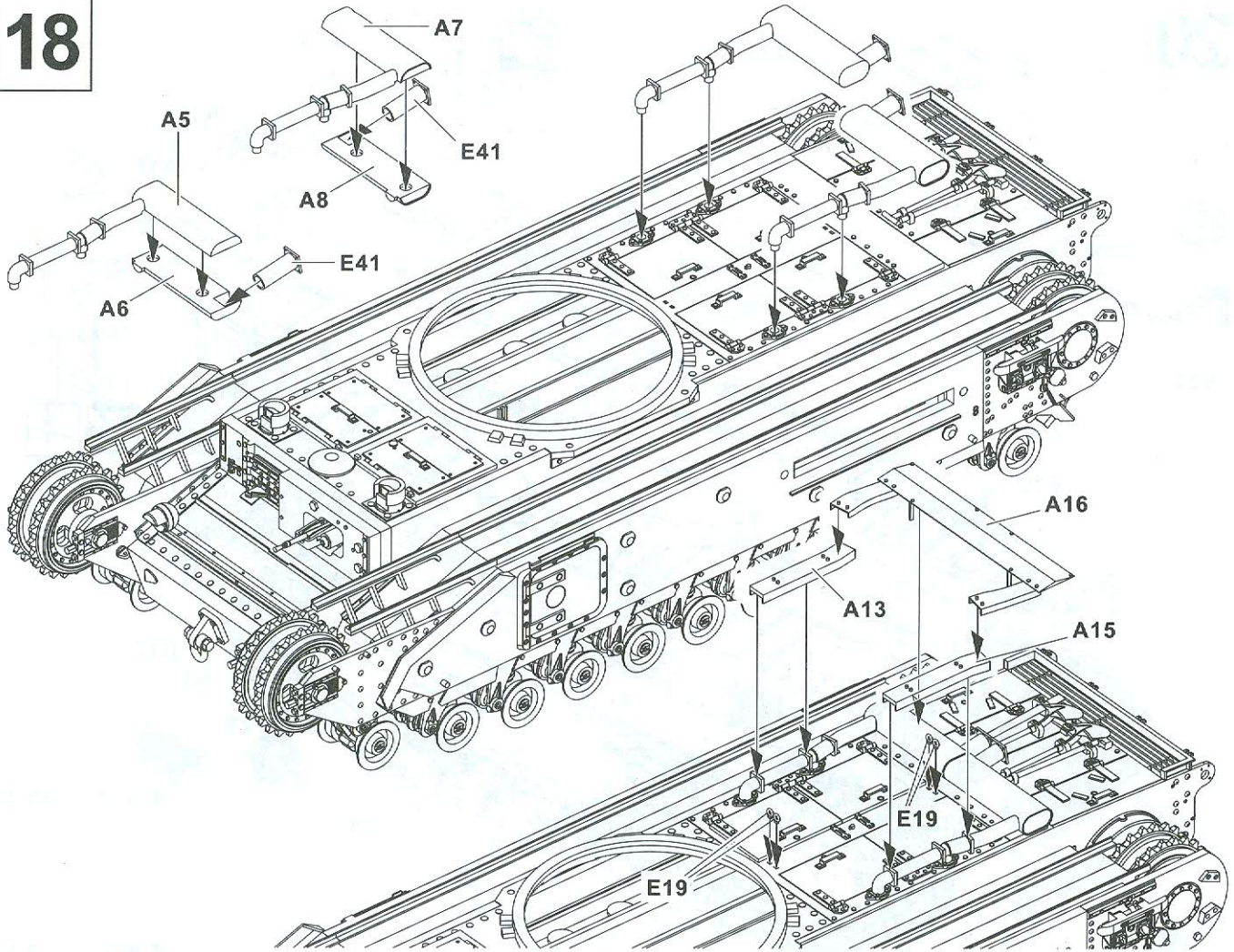

19

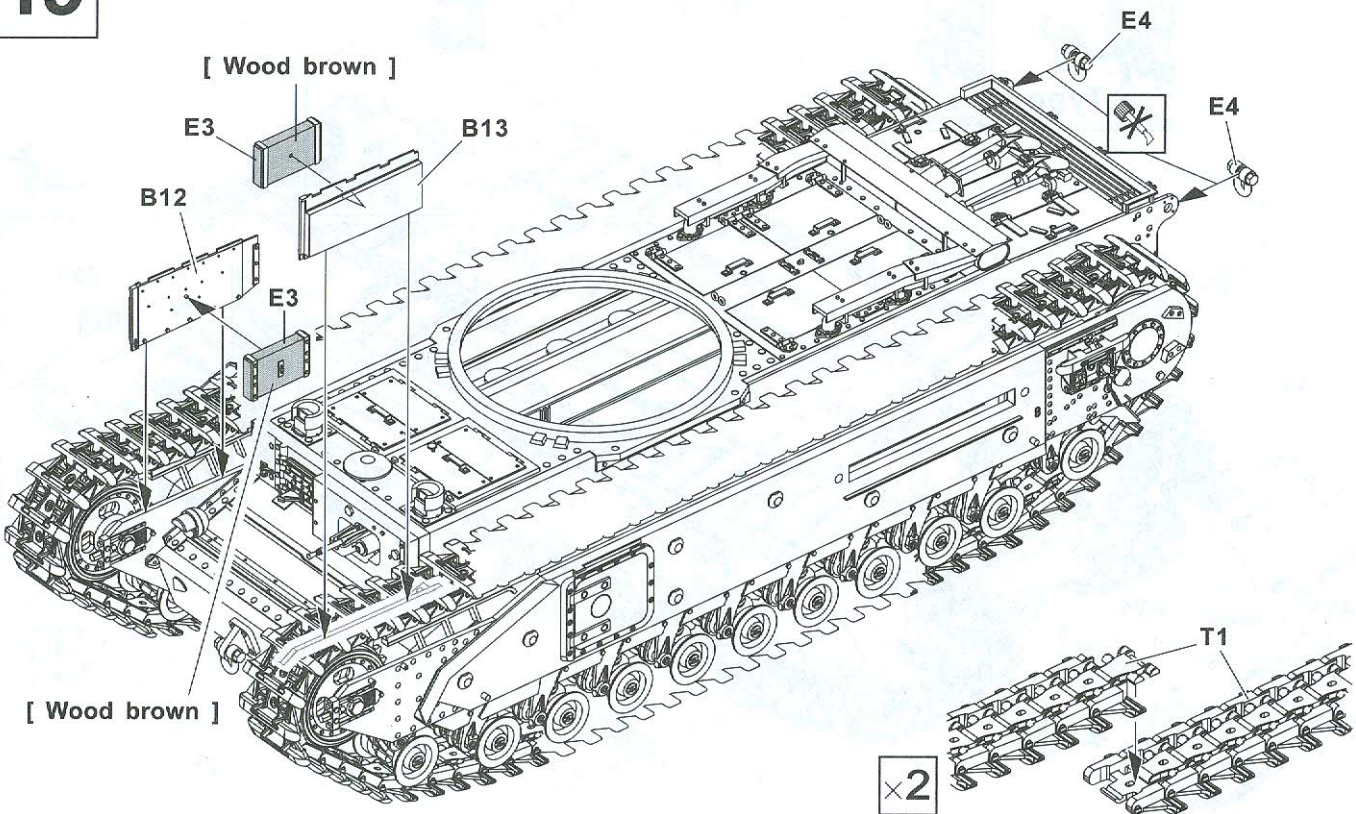

20

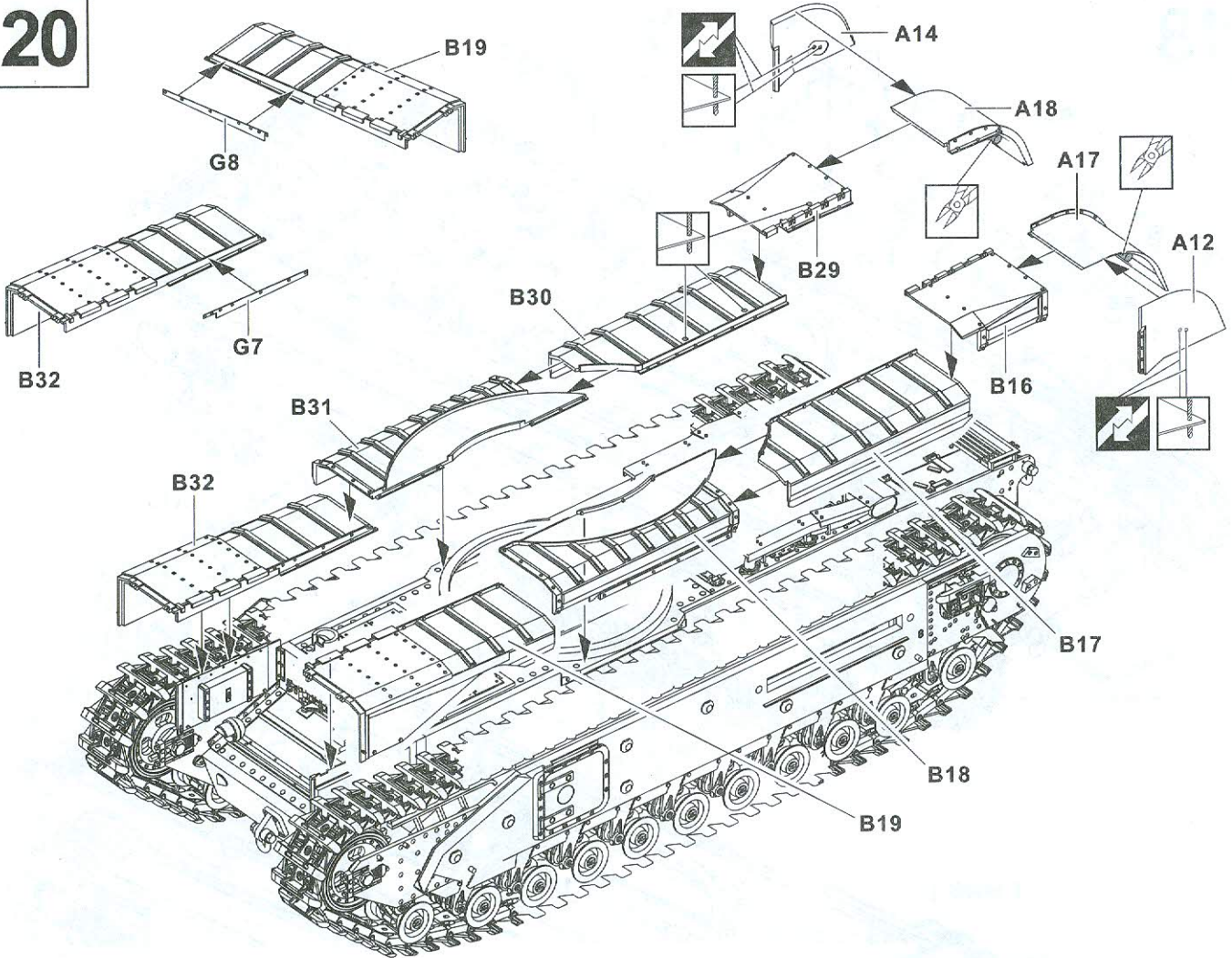

21

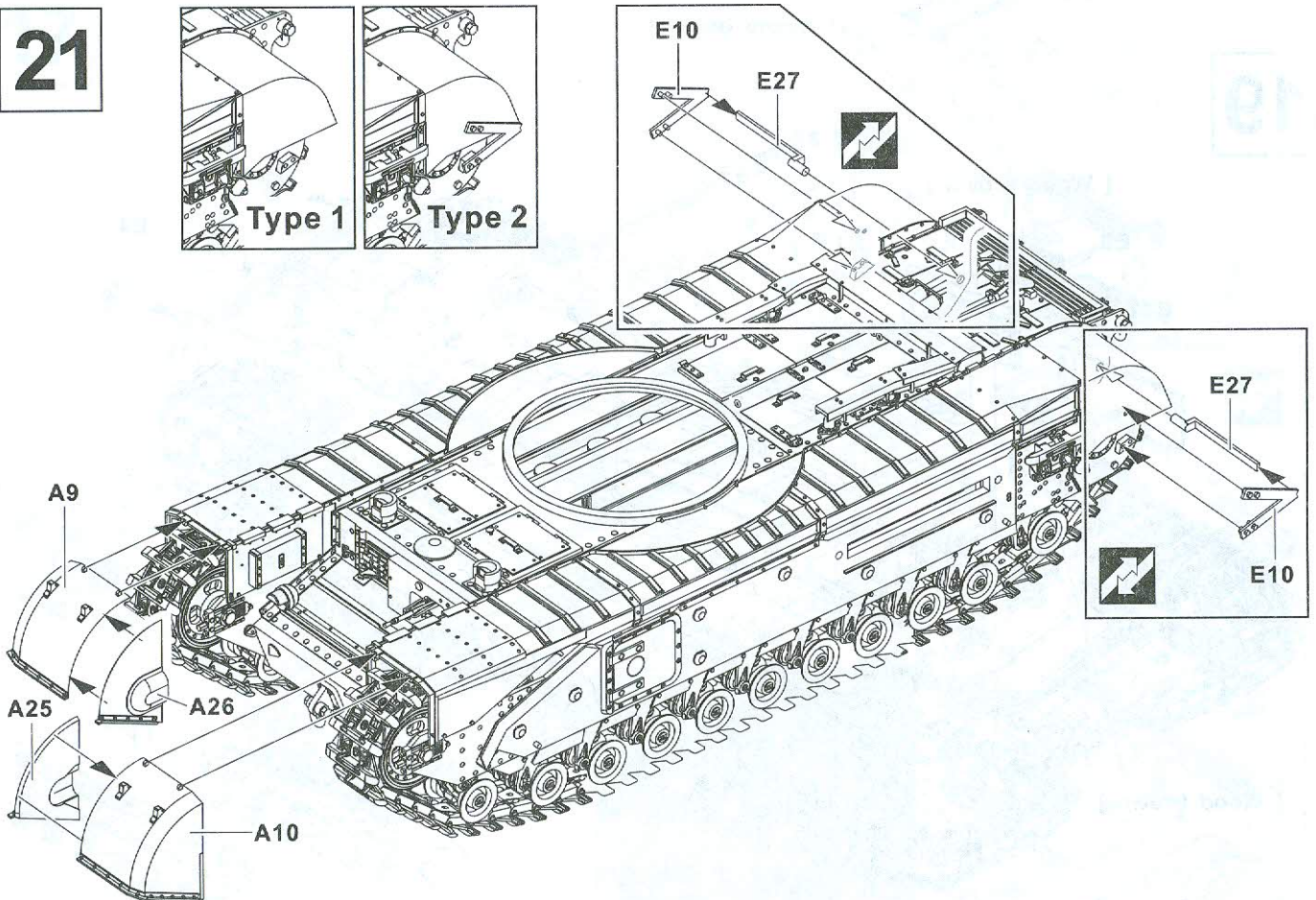

22

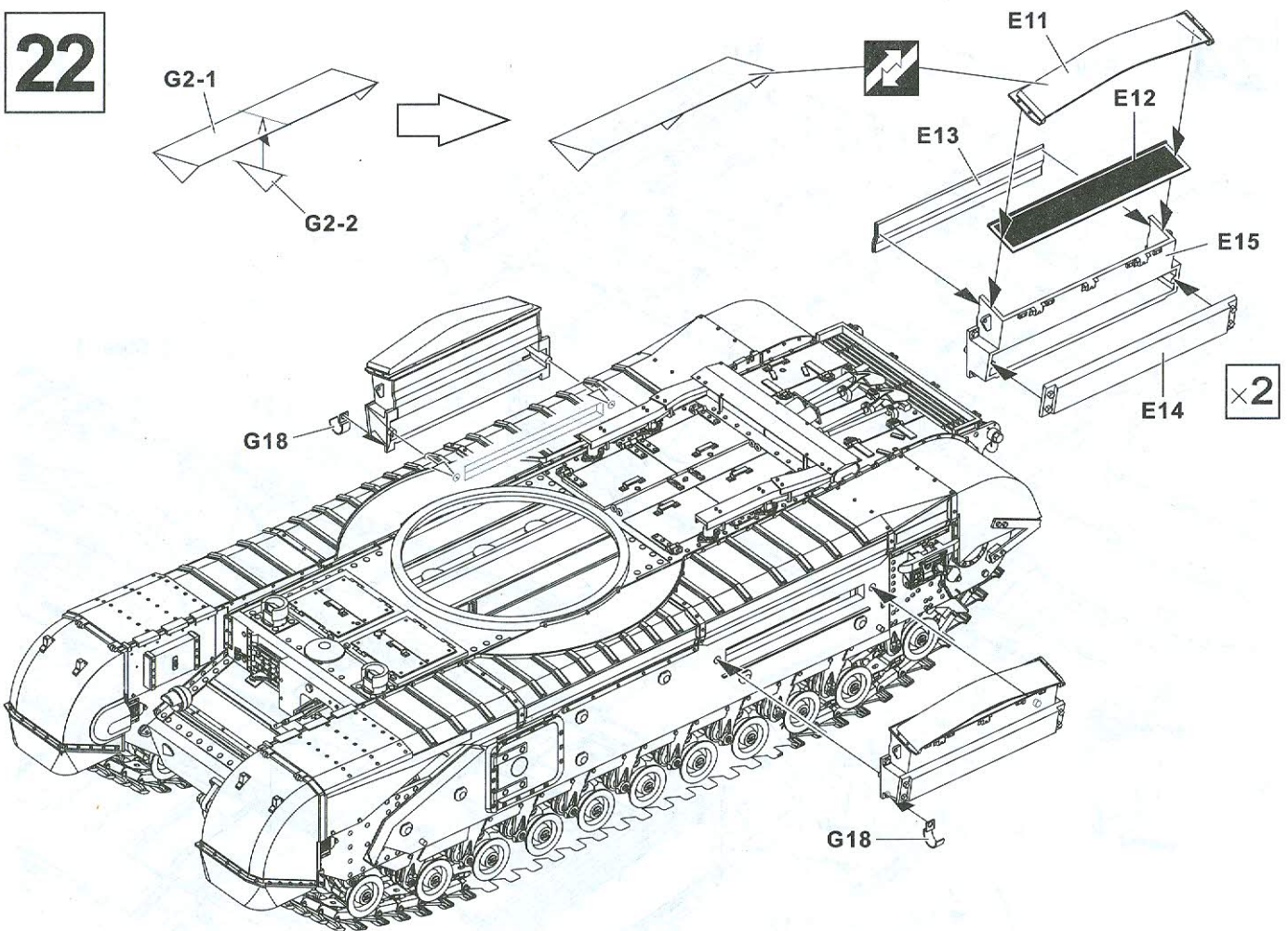

23

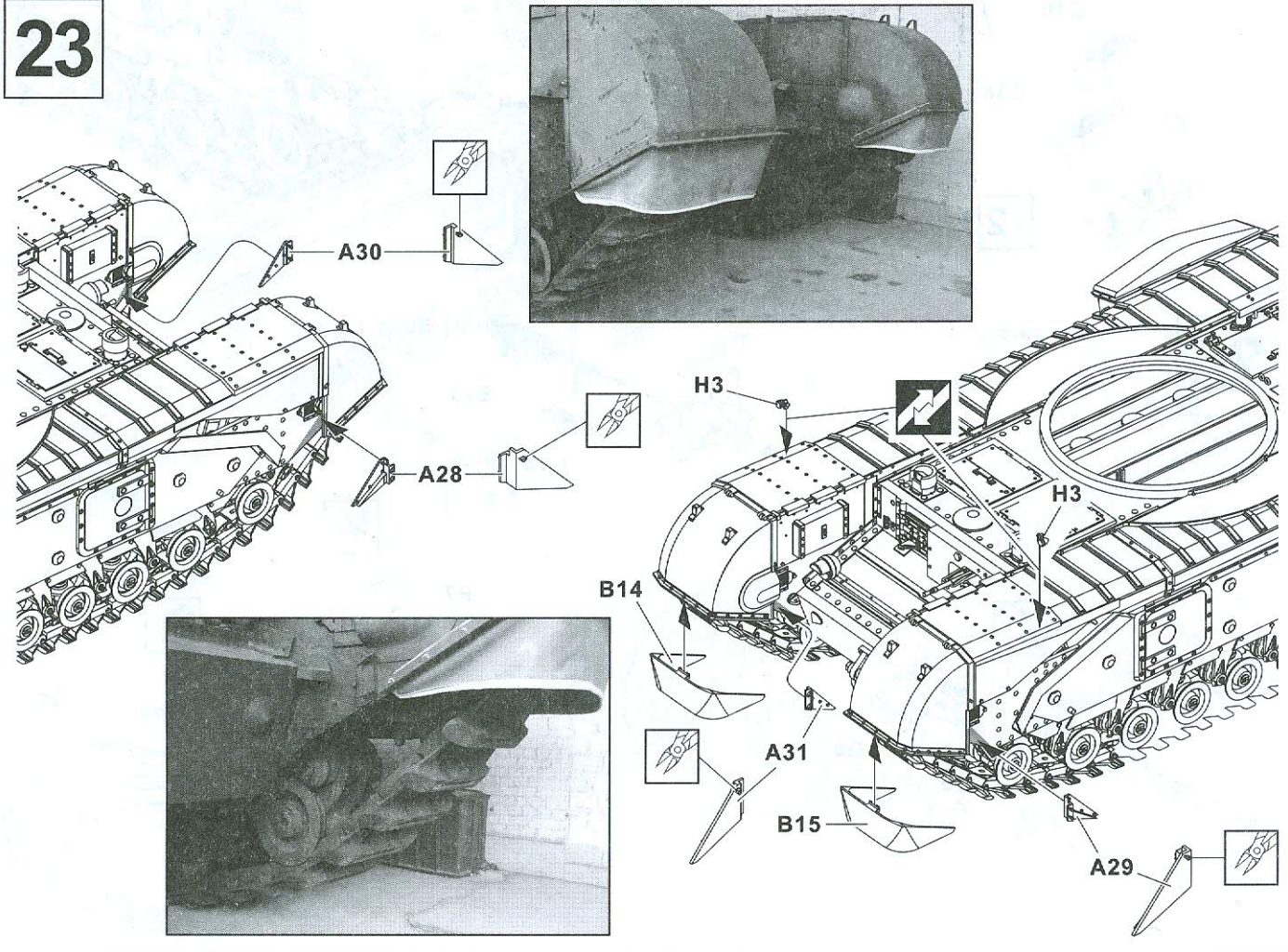

24

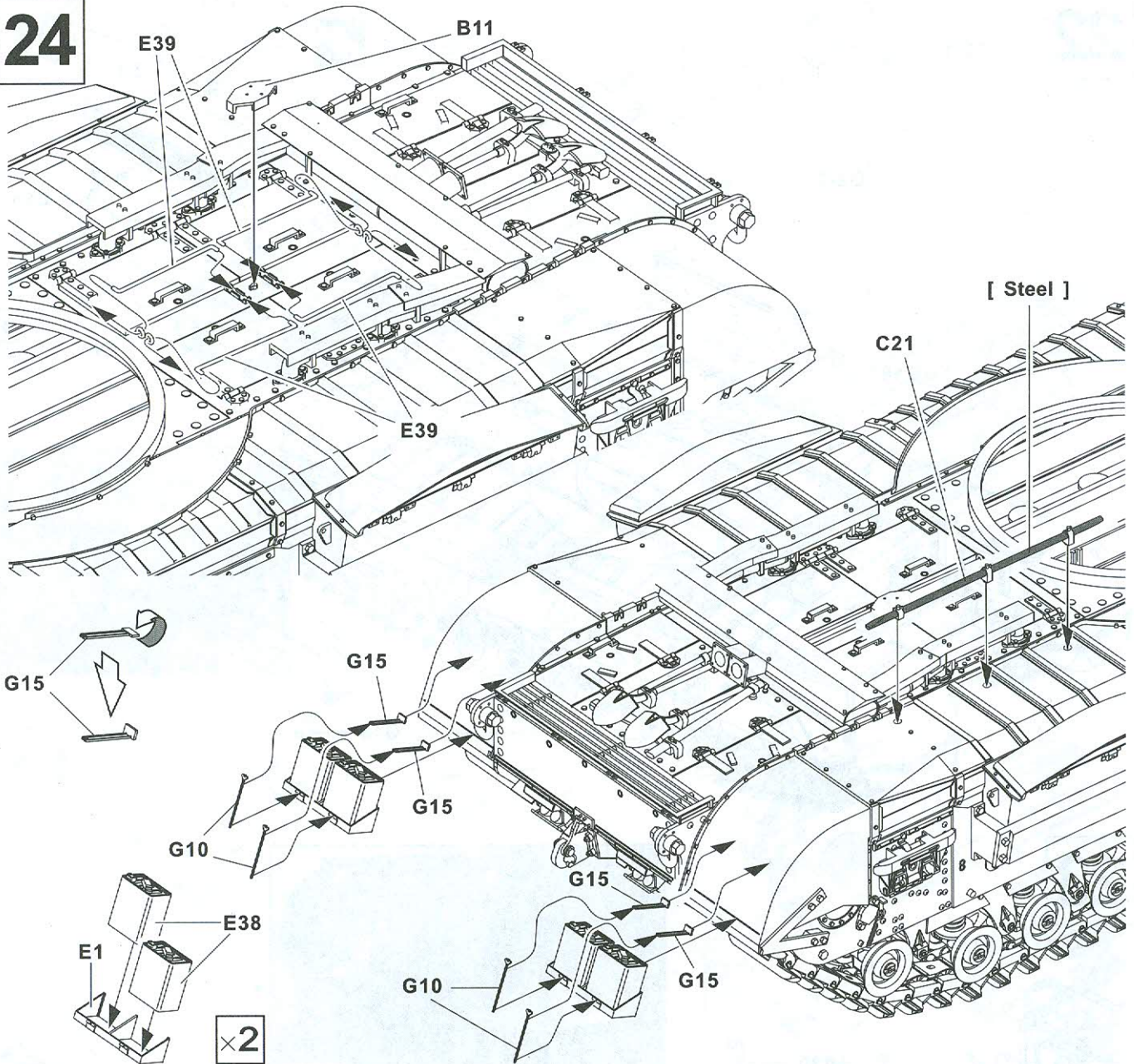

25

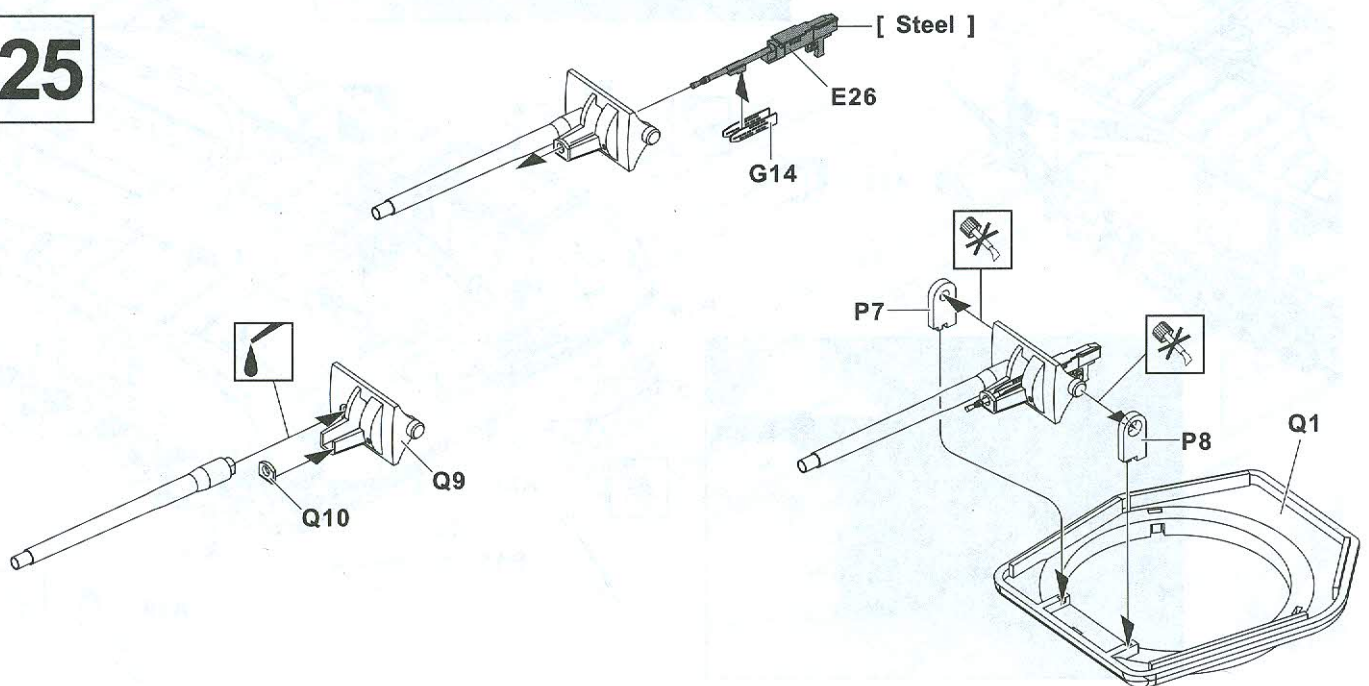

26

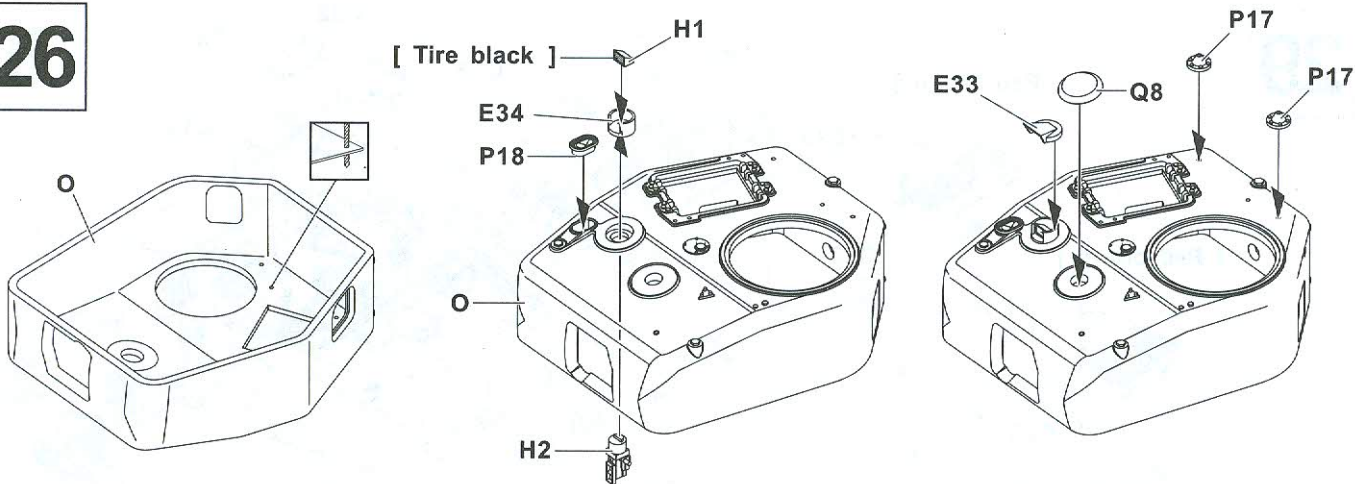

27

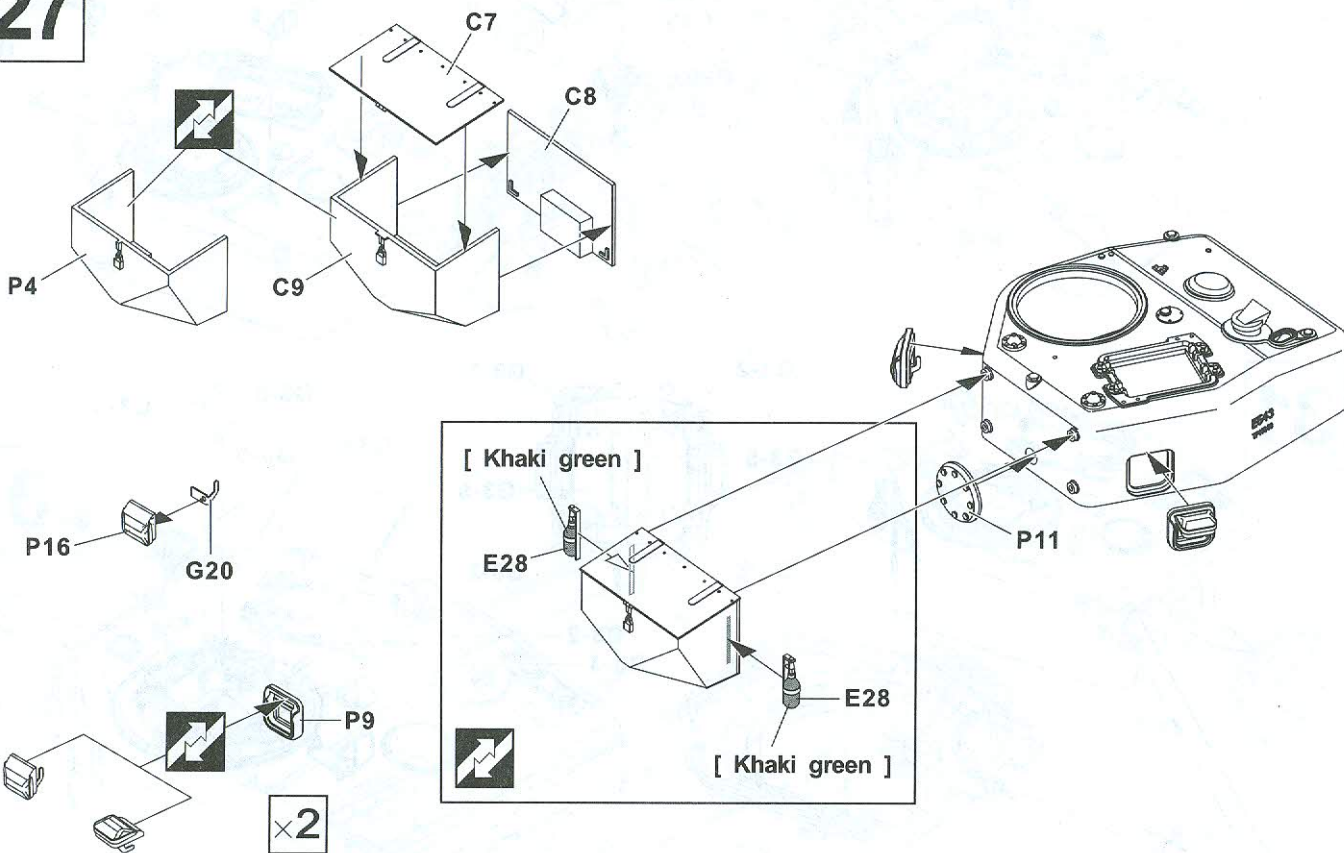

28

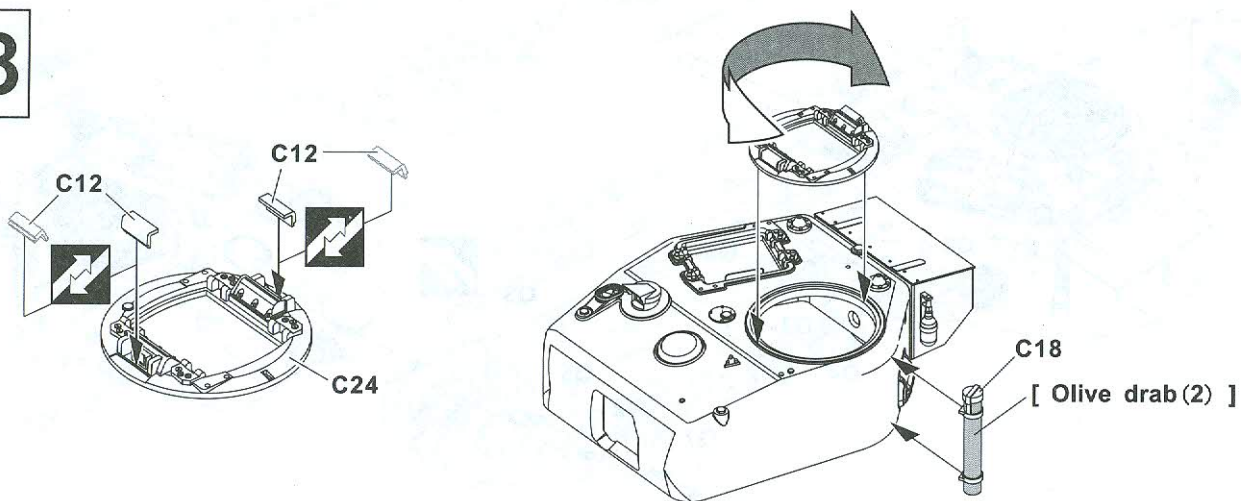

29

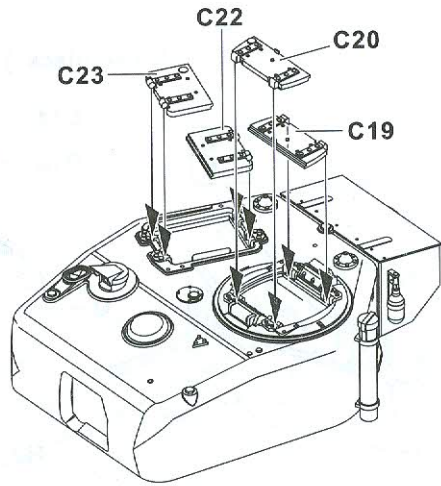
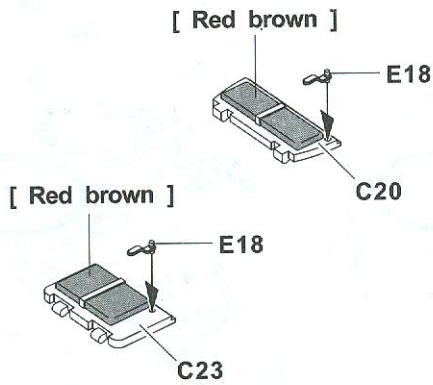

30

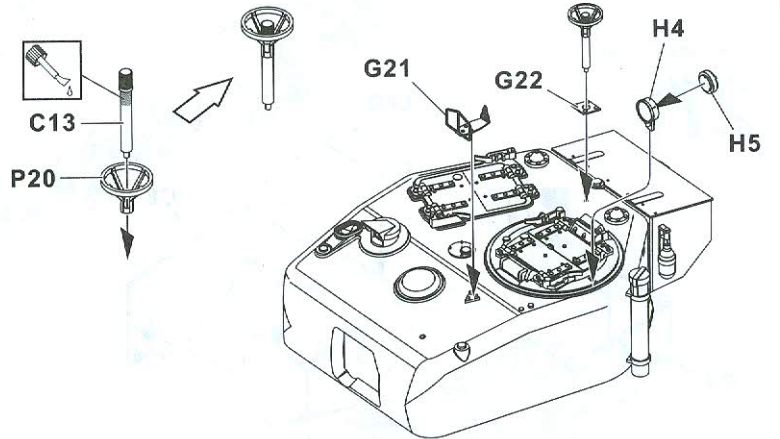
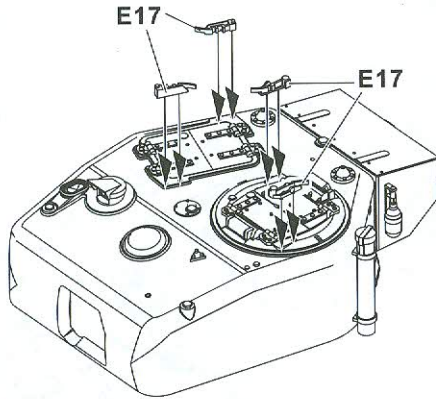

31

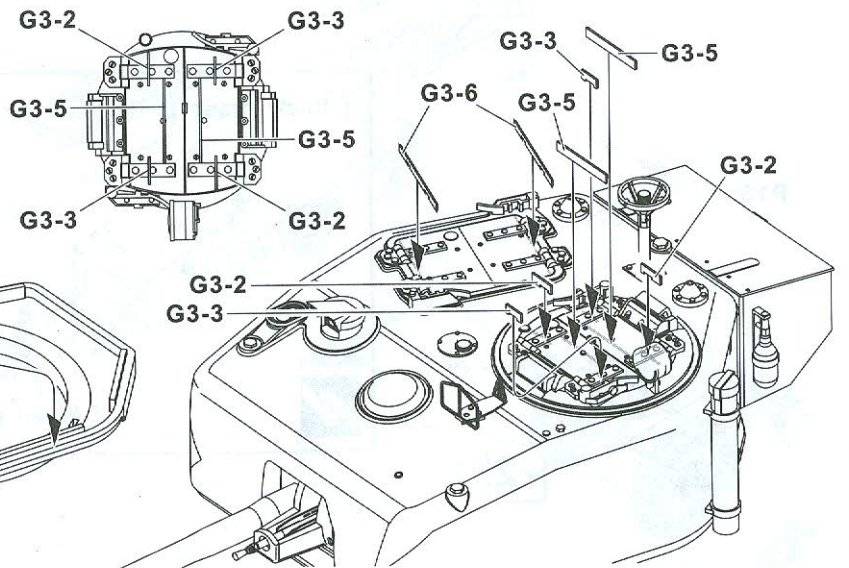
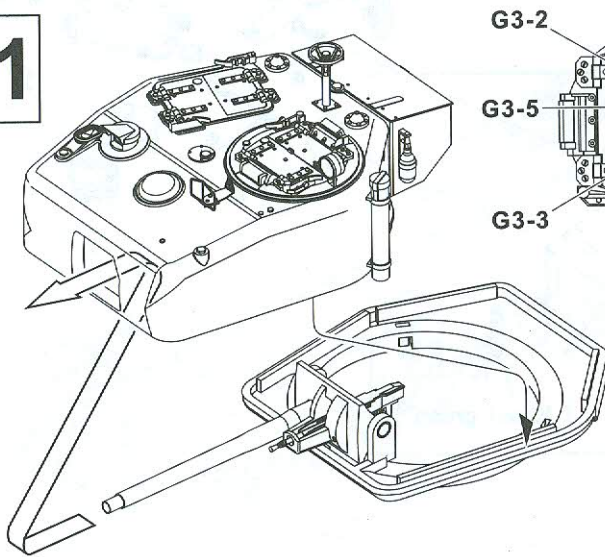

32

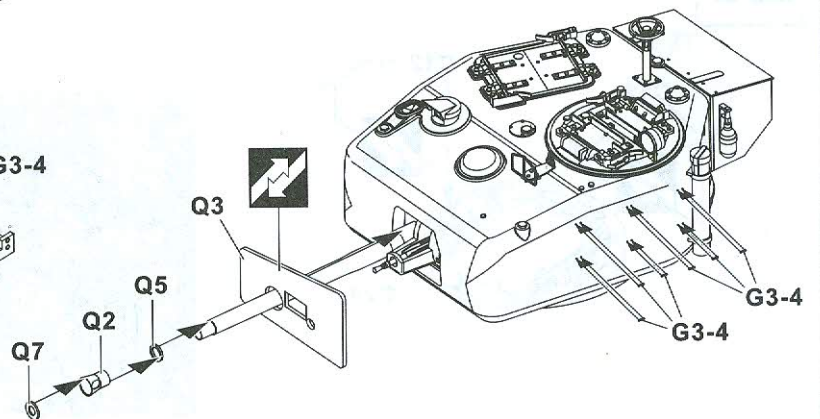
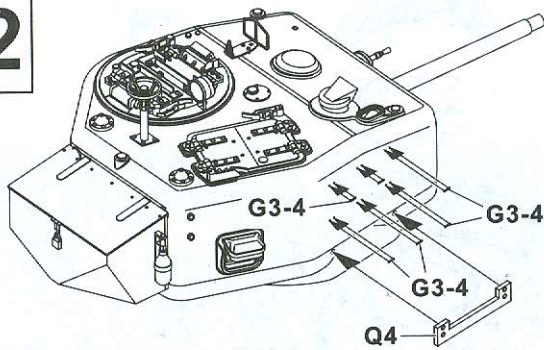

33

0mm

110mm

[Steel]

×2

E42

P6

P5

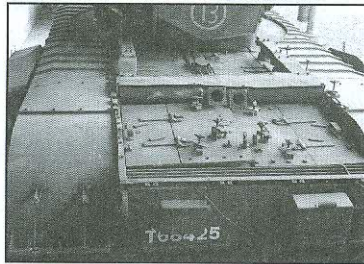
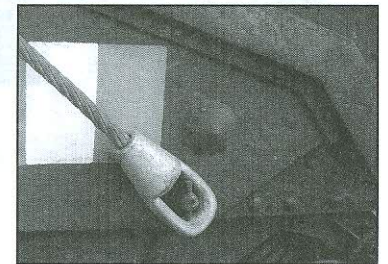

5cm

2cm

5cm

Pull

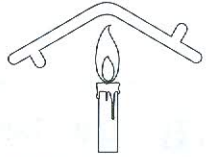

A Royal Armoured Corps Gunnery School, Dorset UK, 1943
 皇家裝甲兵團重砲學院, 英國多塞特郡, 1943年

 Body Color: Dark Green 

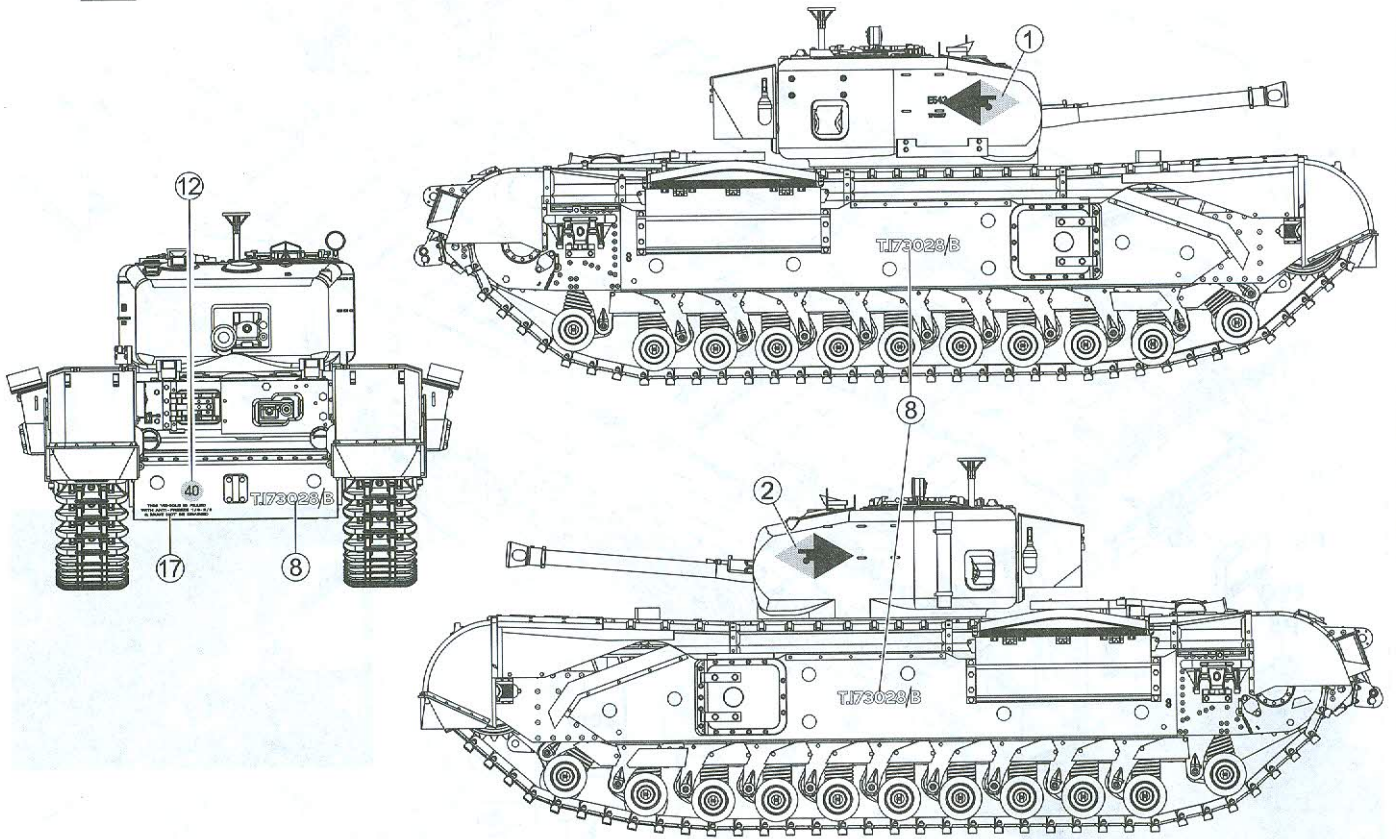

B 34th Tank Brigade, France, 1944
 第34裝甲旅, 法國, 1944年

 Body Color: Dark Green 

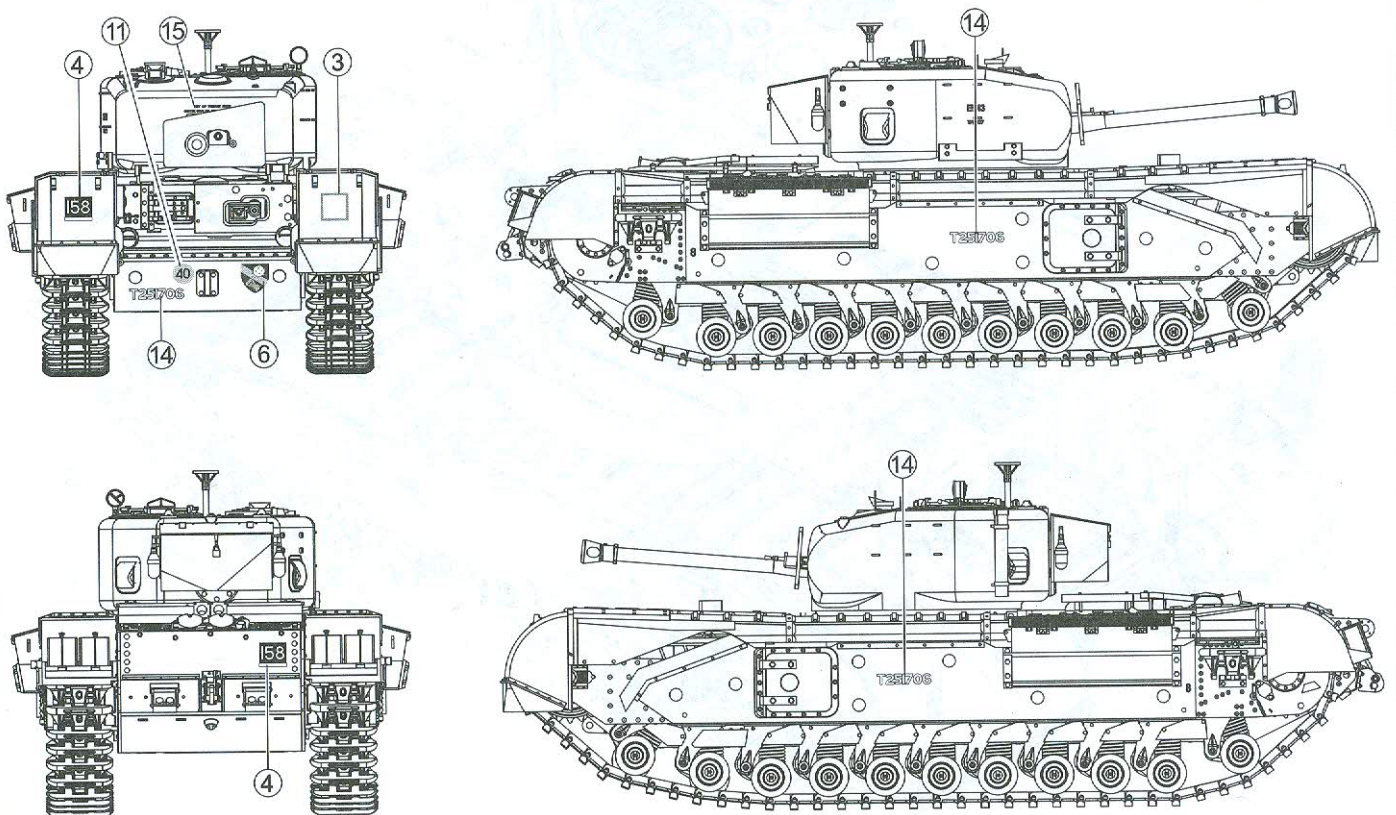

C 3rd Battalion, Scots Guards, 6th Guards Armoured Brigade, Holland, Nov. 1944
 第六禁衛裝甲旅,蘇格蘭衛隊第三營,荷蘭,1944年11月

 Body Color: Dark Green 

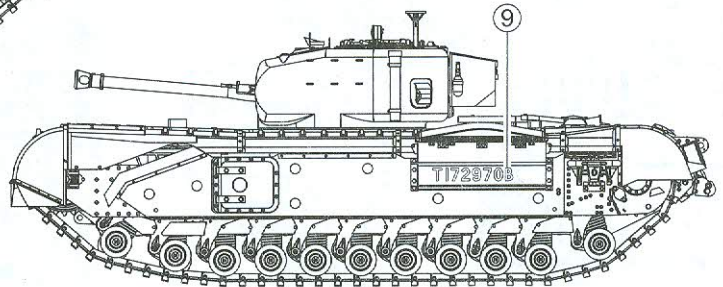
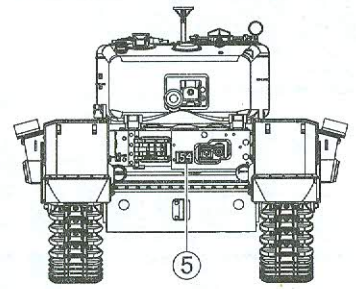
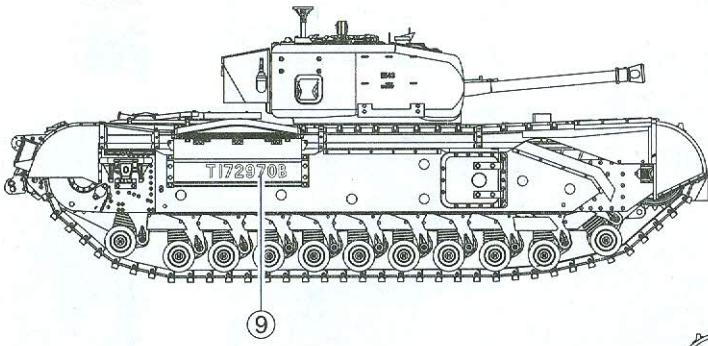

D 25th Armoured Brigade, Italy, May. 1944
 第二十五裝甲旅,義大利戰線,1944年5月

 Body Color: Dark Green 

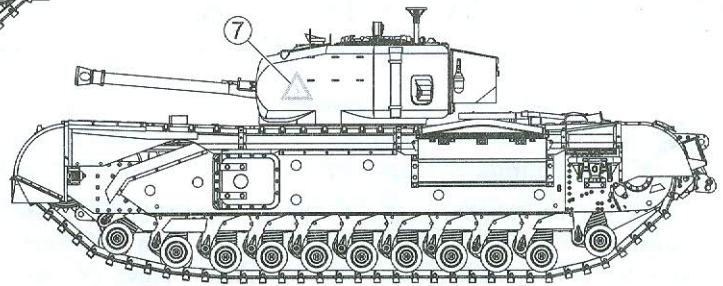
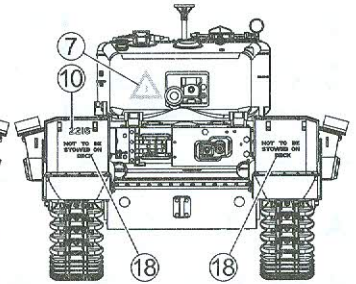
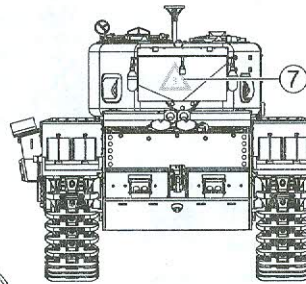
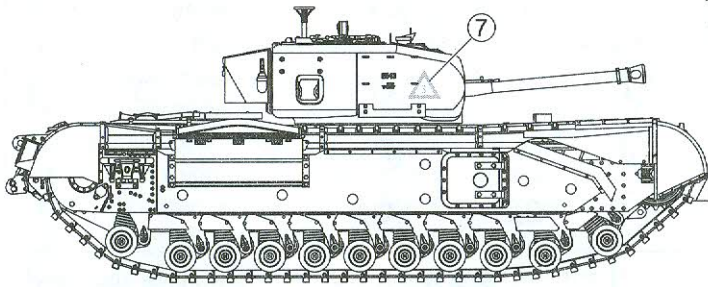





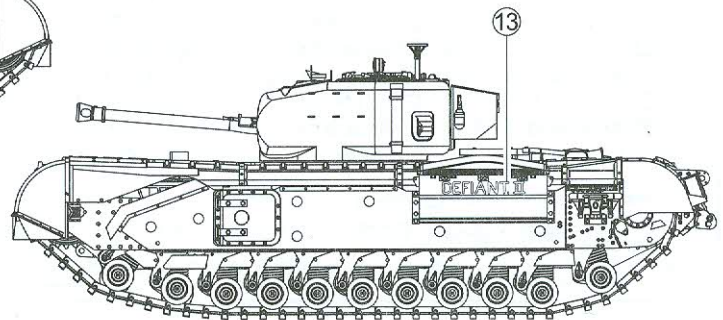
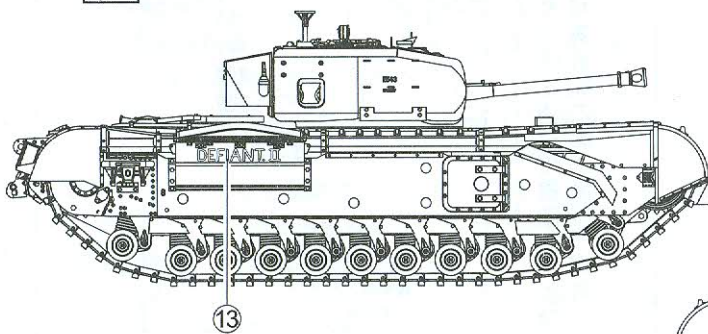



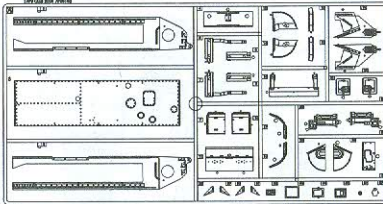
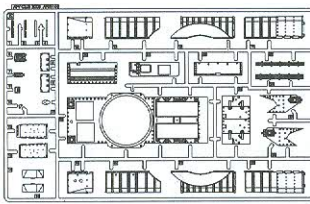
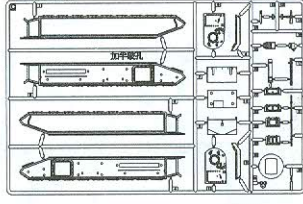

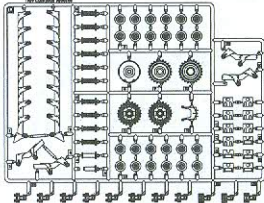
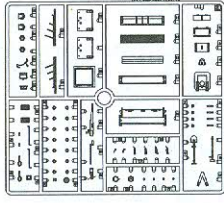
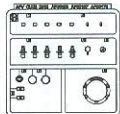
E 6th Guards Armoured Brigade, Germany, March 1945
 第六禁衛裝甲旅,德國境內,1945年3月

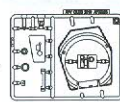
 Body Color: Dark Green 

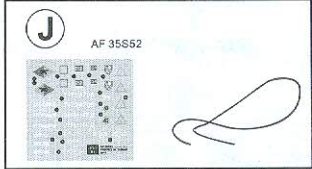

PARTS LIST 零件表

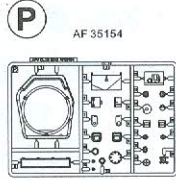
<p>(A) AF 35153</p> 	<p>(B) AF 35153</p> 	<p>(C) AF 35153</p> 	<p>(G) AF 35167</p> 		
<p>(D) AF 35153</p> 	<p>(E) AF 35153</p> 	<p>(H) AF 35153</p> 	<p>(I) AF 35S52</p> 	<p>(Q) AF 35S52</p> 	<p>(G2) AF 35169</p> 
		<p>(T) AF 35153</p> 	<p>(G3) AF 35S52</p> 		
<p>(J) AF 35S52</p> 	<p>(K) AF 35153</p> 	<p>(O) AF 35S52</p> 	<p>(P) AF 35154</p> 		

(A) — 1	(D) — 2	(G2) — 1	(I) — 1	(O) — 1	(T) — 1
(B) — 1	(E) — 2	(G3) — 1	(J) — 1	(P) — 1	
(C) — 1	(G) — 1	(H) — 1	(K) — 22	(Q) — 1	



Instructions:

If for some reason, you are not fully satisfied or have questions concerning our product; Please use the form provide, and send it to our nearest representative or mail it directly to our office.

We will deal with that A.S.A.P.



AF 35S52 Parts Replacement Form

- | | | |
|-------------------------------------|--------------------------------------|-------------------------------------|
| <input type="checkbox"/> AF 35153-A | <input type="checkbox"/> AF 35169-G2 | <input type="checkbox"/> AF 35S52-O |
| <input type="checkbox"/> AF 35153-B | <input type="checkbox"/> AF 35S52-G3 | <input type="checkbox"/> AF 35154-P |
| <input type="checkbox"/> AF 35153-C | <input type="checkbox"/> AF 35167-H | <input type="checkbox"/> AF 35S52-Q |
| <input type="checkbox"/> AF 35153-D | <input type="checkbox"/> AF 35S52-I | <input type="checkbox"/> AF 35153-T |
| <input type="checkbox"/> AF 35153-E | <input type="checkbox"/> AF 35S52-J | |
| <input type="checkbox"/> AF 35167-G | <input type="checkbox"/> AF 35153-K | |

Reason for replacement: Missing Broken

Signature: _____

限臺灣地區使用 For Taiwanese use only!



AF 35S52 零件補充申請表

申請人姓名 地址 電話

- | | |
|--------------------------------------|----------|
| <input type="checkbox"/> AF 35153-A | NT\$ 280 |
| <input type="checkbox"/> AF 35153-B | NT\$ 280 |
| <input type="checkbox"/> AF 35153-C | NT\$ 240 |
| <input type="checkbox"/> AF 35153-D | NT\$ 320 |
| <input type="checkbox"/> AF 35153-E | NT\$ 210 |
| <input type="checkbox"/> AF 35167-G | NT\$ 220 |
| <input type="checkbox"/> AF 35169-G2 | NT\$ 150 |
| <input type="checkbox"/> AF 35S52-G3 | NT\$ 150 |
| <input type="checkbox"/> AF 35167-H | NT\$ 120 |
| <input type="checkbox"/> AF 35S52-I | NT\$ 200 |
| <input type="checkbox"/> AF 35S52-J | NT\$ 160 |
| <input type="checkbox"/> AF 35153-K | NT\$ 100 |
| <input type="checkbox"/> AF 35S52-O | NT\$ 160 |
| <input type="checkbox"/> AF 35154-P | NT\$ 200 |
| <input type="checkbox"/> AF 35S52-Q | NT\$ 150 |
| <input type="checkbox"/> AF 35153-T | NT\$ 280 |

+郵寄費 — NT\$ 80
(請填)總計NT\$ _____

零件補充原因:(請於 打)

原包裝即 遺失或 毀損,

製作途中 遺失或 毀損,

其他原因 _____

總代理戰鷹企業有限公司收本公司將儘速為您處理。
請將本表與該部品相同金額之郵政匯票一同寄至。

