

## Sd.Kfz. 251/9 Ausf. C

### "Stummel"



**\*\*Special thanks to:  
Mr. Holger Erdmann and Mr. Thomas Hartwing.**



7.5cm KwK37 was a L/24 low-velocity tank gun, originally designed to fire high-explosive shell for close support. It was also found effective against light-armored vehicles and used as main armament of early Panzer IV and StuG III.

To be more effective against furious rivals on the eastern front during WWII, since March 1942, new produced Panzer IV and StuG III were upgraded with more powerful L/43 7.5 cm KwK 40 tank gun. The rest of 7.5 cm KwK 37 was then turned to used on other infantry support vehicles.

In June 1942, Bussing-NAG company completed 2 prototypes mounting KwK37 tank gun on Sd.Kfz.251 Ausf. C half-track personnel carrier and put them in combat test on eastern front. In July 1942, 150 vehicles purchase order was awarded to Bussing-NAG company. By the end of 1942, it was put in production and designated "Sd.Kfz.251/9".

To accommodate KwK37, it was installed on the gun mount in the fighting compartment. The tank gun was positioned on the right side of the hull. The seat on right side of the driver was canceled. The front armor plate was cut to lower vehicle height, this also gave the tank gun limited angle of traverse. gun shield was installed to reinforce defense on the front. Fighting compartment can accommodate 52 shells and 3 crew members including driver. Since July 1943, new produced Sd.Kfz.251/9 were changed to D model hull. Because of its distinctive feature that L/24 short barrel sticking out in the front, it was nicknamed "Stummel" among German soldiers. On European battlefields, Sd.Kfz.251/9 mainly played the role providing infantry fire support.

ドイツ軍の戦車搭載砲24口径7.5cmKwK37は低初速砲で、もともとは榴弾を発射しての近接支援を主な目的として開発された。また、軽装甲の車輛攻撃にも効果があり、初期型のIV号戦車やIII号突撃砲に搭載されていた。しかし、東部戦線において遭遇した敵の強力な装甲車輛に対抗するため、1942年3月から、IV号戦車とIII号突撃砲には、より強力な長砲身43口径7.5cmKwK40砲が搭載されるようになる。このため、余剰となった短砲身7.5cmKwK37砲は、歩兵支援車輛へと転用されていくこととなる。

1942年6月、ビュッシング-NAG社はSd.Kfz.251ハーフトラックのC型車体にKwK37砲を搭載した2種類の試作車を完成させ、すぐに東部戦線において実戦テストが実施された。その結果、7月にビュッシング-NAG社に対し150輛を発注、同年末までに生産され、この車輛には、Sd.Kfz.251/9の形式名があたえられた。

KwK37砲は、戦闘室に設置した砲座に据えて搭載された。砲は車体の右寄りに位置し、そのため運転室の右側シートは取り外された。車高を低く抑えるため、車体装甲板の前面の一部を切欠き、そこに砲を搭載したが、このために砲の射界が制限される結果を生んでしまった。前面の防御力強化のため、砲には防盾を装備、車内には52発の砲弾が搭載され、ドライバーを含めて3名が乗車した。1943年7月から、新規に生産されるSd.Kfz.251/9にはD型車体がいられるようになる。Sd.Kfz.251/9は、短い砲身の24口径砲が前方に突き出た特徴的なスタイルから、前線の兵士たちから「シュトゥンメル(切り株)」の愛称で呼ばれ、激しい戦闘の場で、歩兵への火力支援の役割を果たしたのだった。

7.5釐米KwK37是德軍一種車輛搭載的24倍徑低初速火炮。原本設計做為射擊榴彈提供近距離支援之用，對裝甲不夠厚重的敵方車輛也具有相當威力，是早期四號戰車與三號突擊砲所配置的主要武裝。為了對抗東線戰場上更為強勁的對手，1942年3月後新出廠的四號戰車與三號突擊砲搭載上更強力的43倍徑7.5釐米砲，此時屬於剩餘料件的7.5釐米KwK37砲被轉而運用在其它步兵支援車輛上。

1942年6月由Bussing-NAG公司完成了以Sd.Kfz.251半履帶運兵車C型車體為載臺，搭載KwK37戰車砲的兩輛試作車，隨即投入東線戰場進行實戰驗證。7月份得到了150輛的訂單，並在該年底前進入了量產，成為了Sd.Kfz.251/9。

為了容納KwK37，砲身安裝於戰鬥室內的砲臺之上。偏向車體右側的火砲，駕駛右側座席因此被取消。又為了降低車身高度，前方裝甲板切斷讓火炮獲得有限的射界，並增設了火炮防盾來補強前方的防禦。車內可攜行52發砲彈，含駕駛共三名乘員，自1943年七月起生產的Sd.Kfz.251/9改為D型車體。由於24倍徑短砲管突出於前方的特徵，Sd.Kfz.251/9被士兵暱稱為”菸屁股”(Stummel)，在歐洲戰場上提供步兵火力支援為主的任務。

### Illustration:圖示說明



### Method For Applying Decals:

1. Clean Model Surface With Wet Cloth.
2. Cut Out Of Decal Sheet And Dip Them In Warm Water For 15 Seconds.
3. Place it on proper position on model.
4. Slide off base paper leaving decals On Model With Wet Finger Tip.
5. Move Decals To Exact Position, Push Out Excess Water Under Decal With Soft Cotton Cloth.
6. When Decals Get Dry Then Complete.

### 水貼紙使用說明:

1. 將模型表面擦乾淨
2. 將貼紙剪下泡入溫水中浸泡約15秒
3. 將泡濕之貼紙取出置於欲貼處旁
4. 用指尖輕推貼紙表面使其滑出底紙
5. 將貼紙調整至適當位置並輕擦拭水份
6. 待其自然乾燥後即完成

### Color list: 塗料表

Color	Brand	GSI Creos			Humbrol	Revell	Lifecolor
		Hobby Color	Mr.Color	Mr.Color Spray			
Brass	黃銅	H9	C9	J9	54	92	LC75
Field gray(2)	原野灰	H48	C52		91	67	UA051
Flat white	消光白	H11	C62	J62	34	05	LC01
German gray	德國灰	H32	C40	J40	92	79	UA073
Metallic green	亮綠	H89	C77	J77	131	364	
Olive green	橄欖綠	H405	C70	J70	149	363	UA08
Red	紅	H3	C3	J3	19	31	LC56
Red brown	紅褐	H47/H406	C41	J41	160	383	UA085
RLM02 Gray	灰	H70	C60				UA71
Sail color	帆布	H85	C45		28		UA099
Sandy yellow	砂黃	H79/H403	C39	J39	83	16	UA081
Steel	黑鐵	H18	C28	J28	53	91	LC76
Tire black	輪胎黑	H77	C137		85	302	LC02
Wood brown	木棕	H37	C43		169		FS12
Yellow	黃	H4	C4	J4	69	12	LC53

# 7.5 cm Kampfswagenkanone 37 L/24

KwK 37 was a tank cannon which was developed as close-support tank gun. It was effective performing close-support for infantry; however, it was not effective against tanks and heavily-armored vehicles.

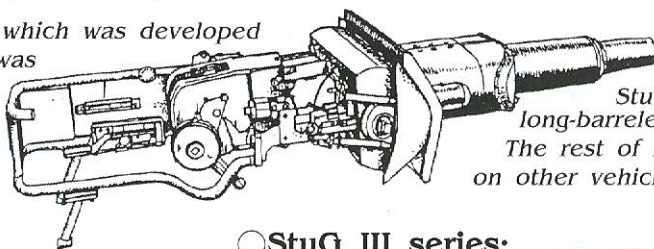

Later, Pz.Kpfw. IV and StuG III were mounted with long-barreled 7.5cm KwK 40 tank gun. The rest of KwK 37 were use to mount on other vehicles as infantry close-support artillery gun.

## ○Pz.Kpfw. IV series:

Ausf. A  
(1937)

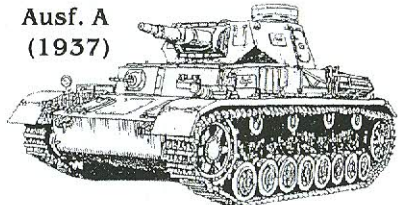

Ausf. B  
(1938)



Ausf. C  
(1938)

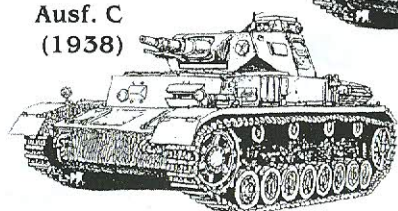

Ausf. D  
(1939)

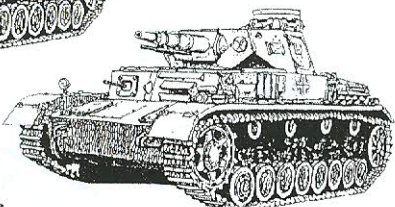

Ausf. E  
(1940)

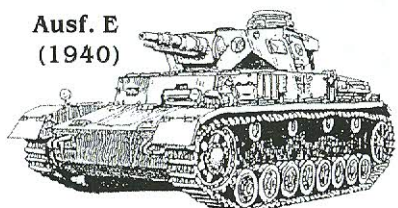

Ausf. F  
(1941)

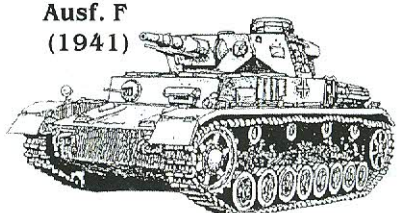

## ○8 Wheeled Armoured Car

Sd.Kfz.233  
(1942)

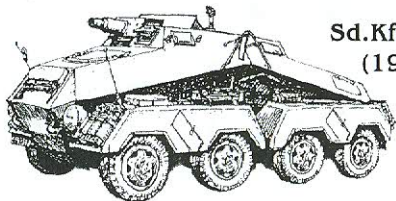

Sd.Kfz.234/4  
(1944)

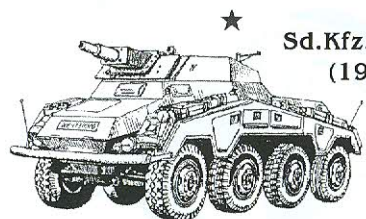

## ○StuG III series:

Ausf. A  
(1940)



Ausf. B  
(1940)

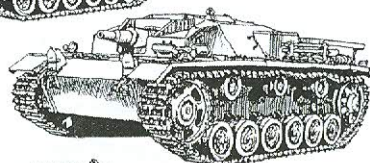

Ausf. C/D  
(1941)

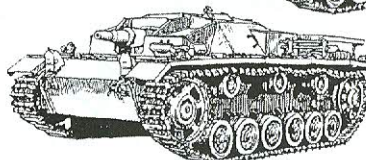

Ausf. E  
(1941)

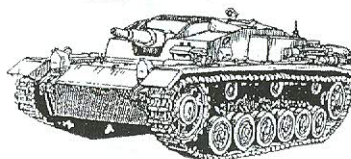

## ○Pz.Kpfw. III

Ausf. N  
(1942)



## ○Jagdpanzer 38 (t) mit 7.5 cm KwK L/24

Prototype built in 1944



Hetzer chassis

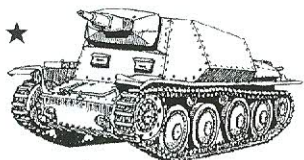

38(t) chassis  
2 types

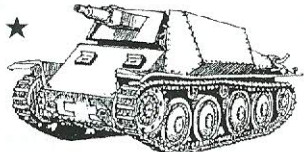

## ○Half-track Armored Personnel Carrier

Sd.kfz.251/9 "Stummel"



(1942) C model early type



(1943) D model late type



(1944) revised late type

Sd.Kfz.250/8  
(1944)



★ mark indicates that 7.5 cm KwK 37 was mounted with revised and simplified K51 mount (It was able to be mounted without modifying vehicle body)

Shin.ueda  
上田 信

1

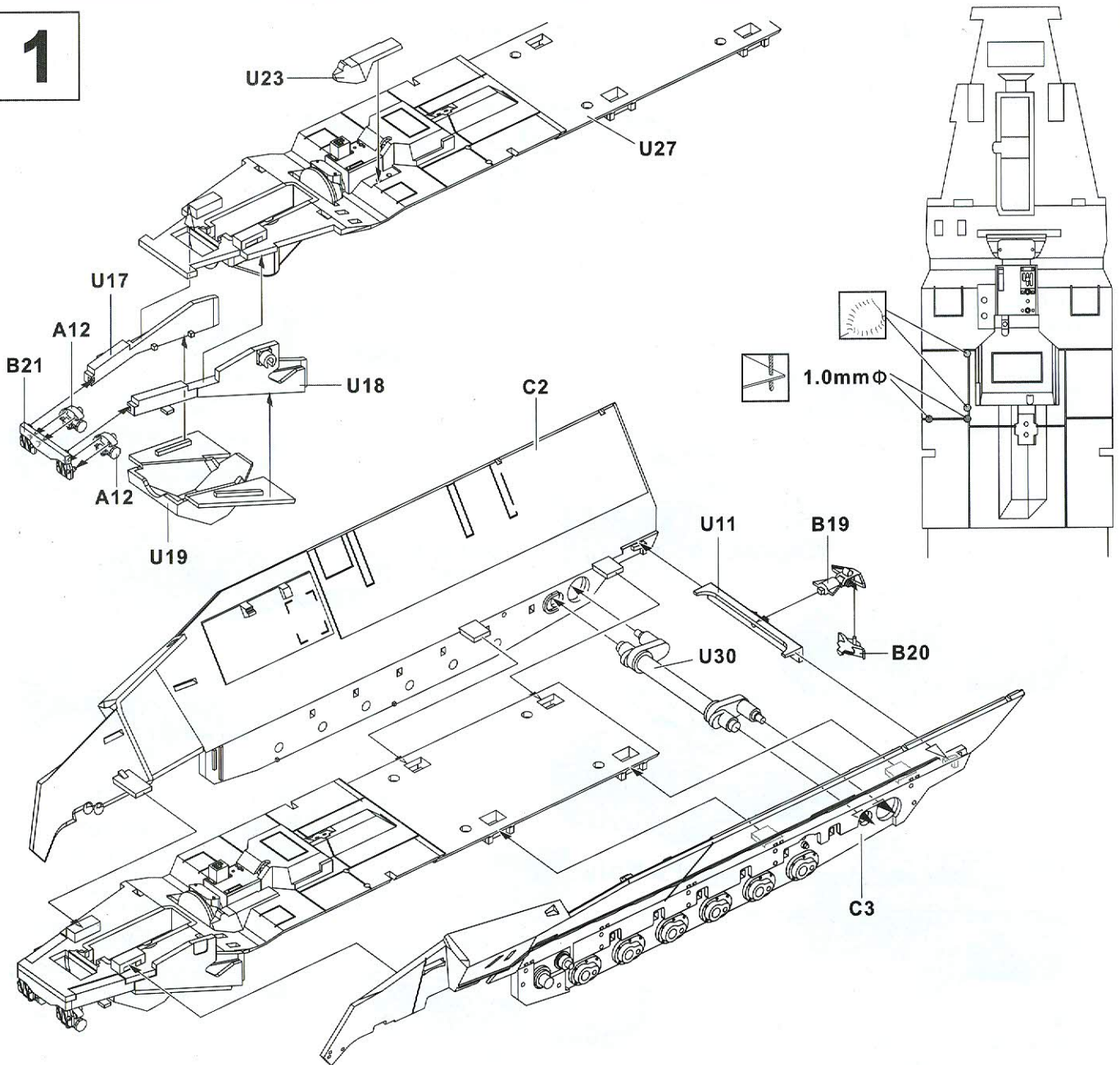

2

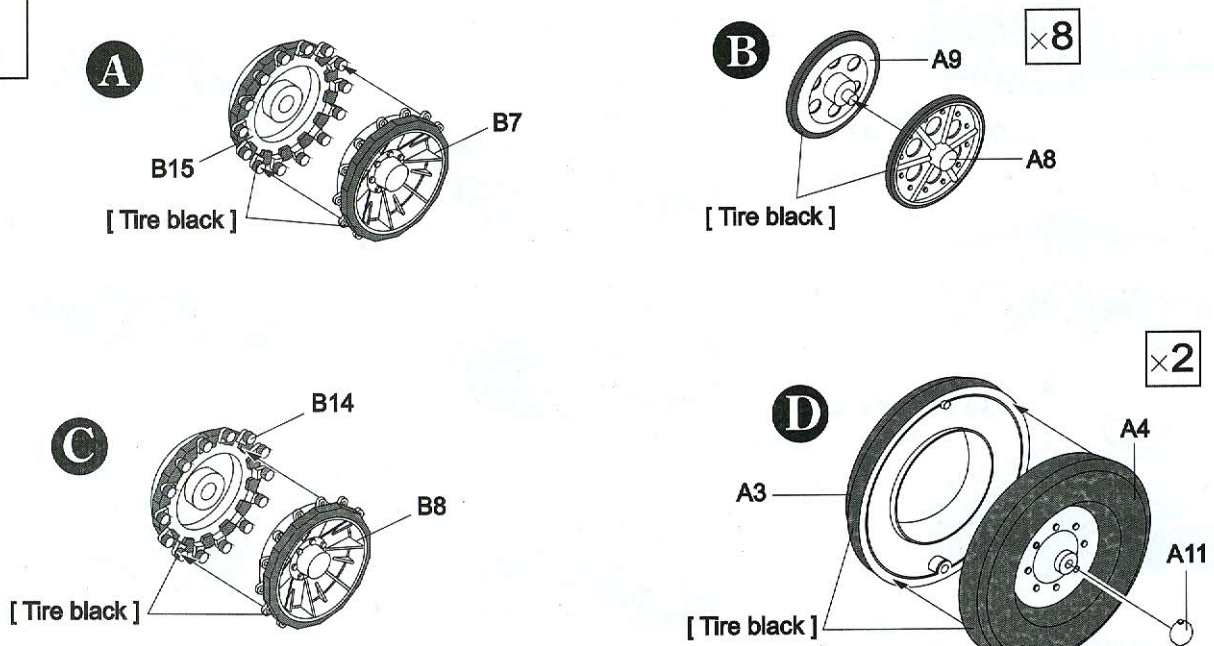

3

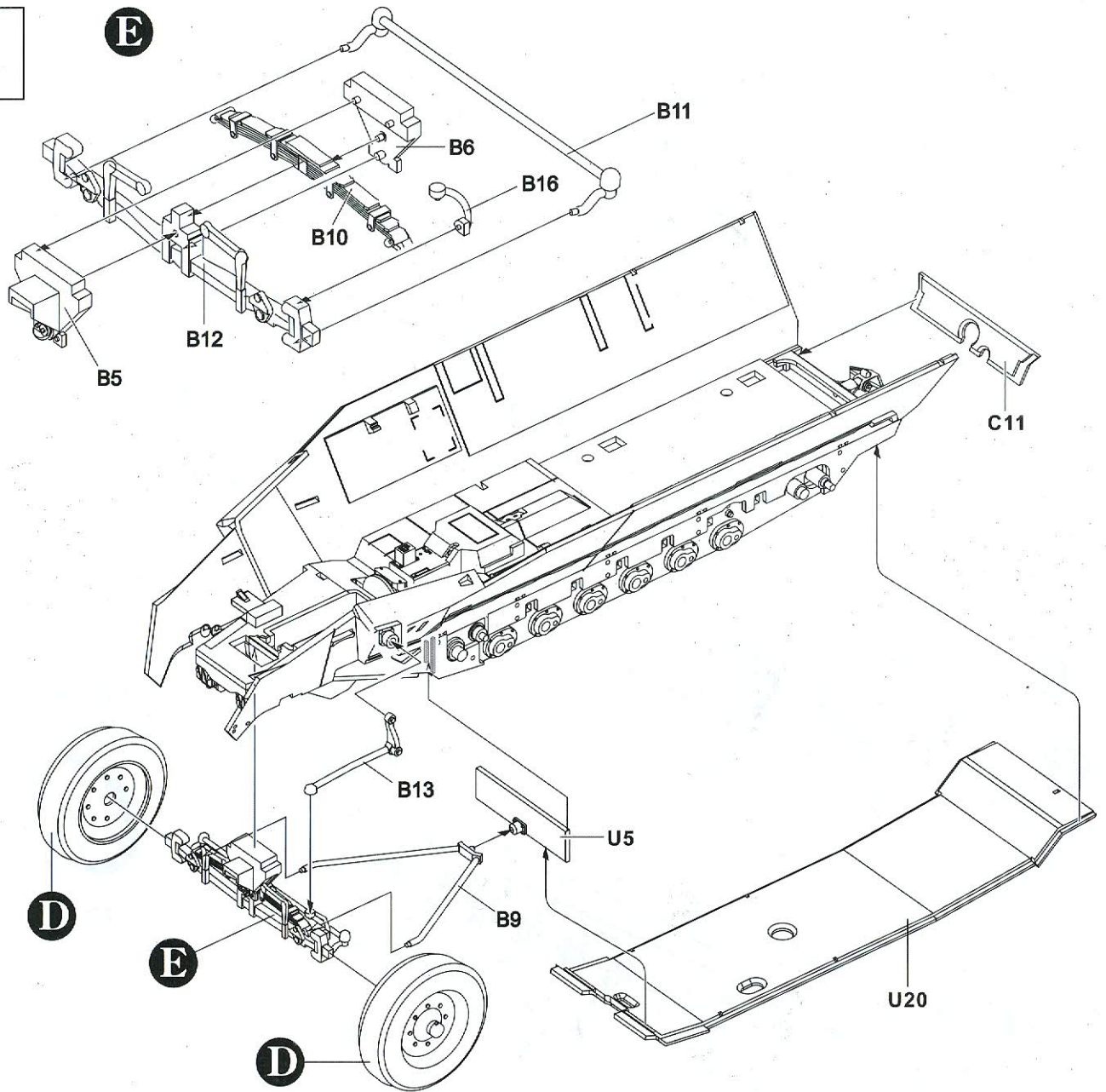

4

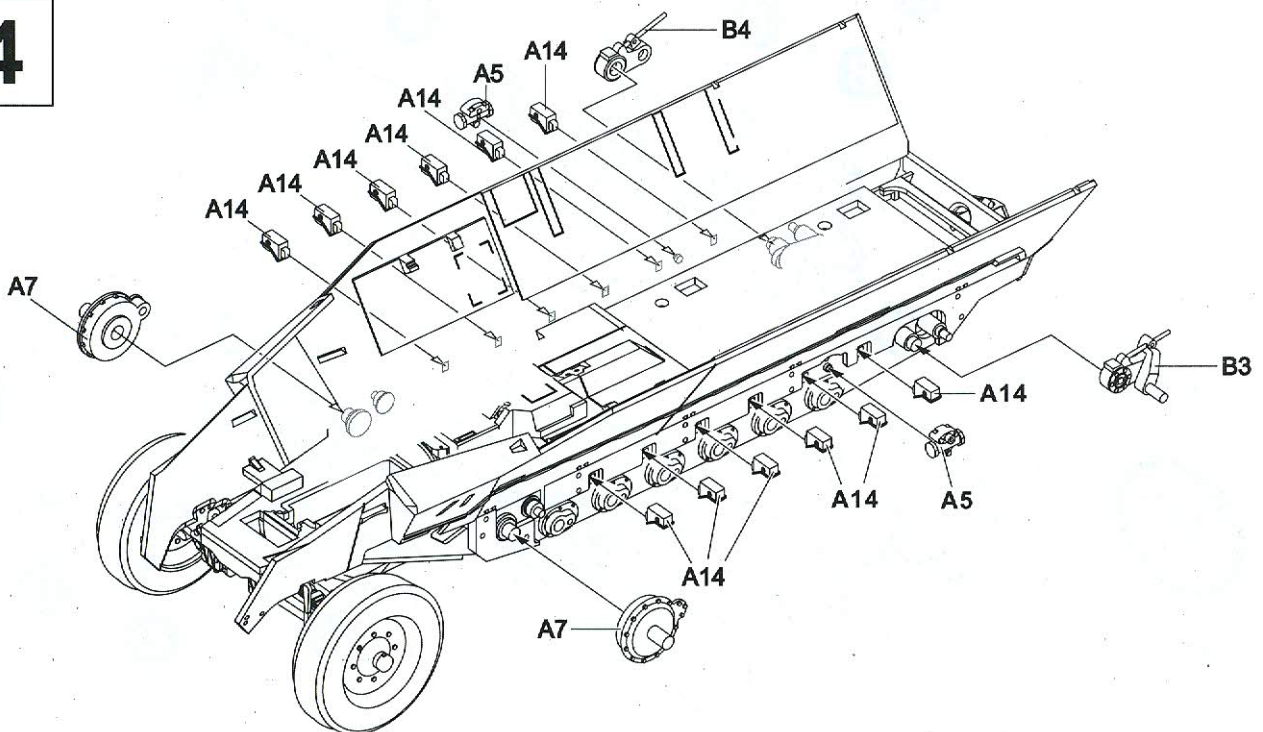

5

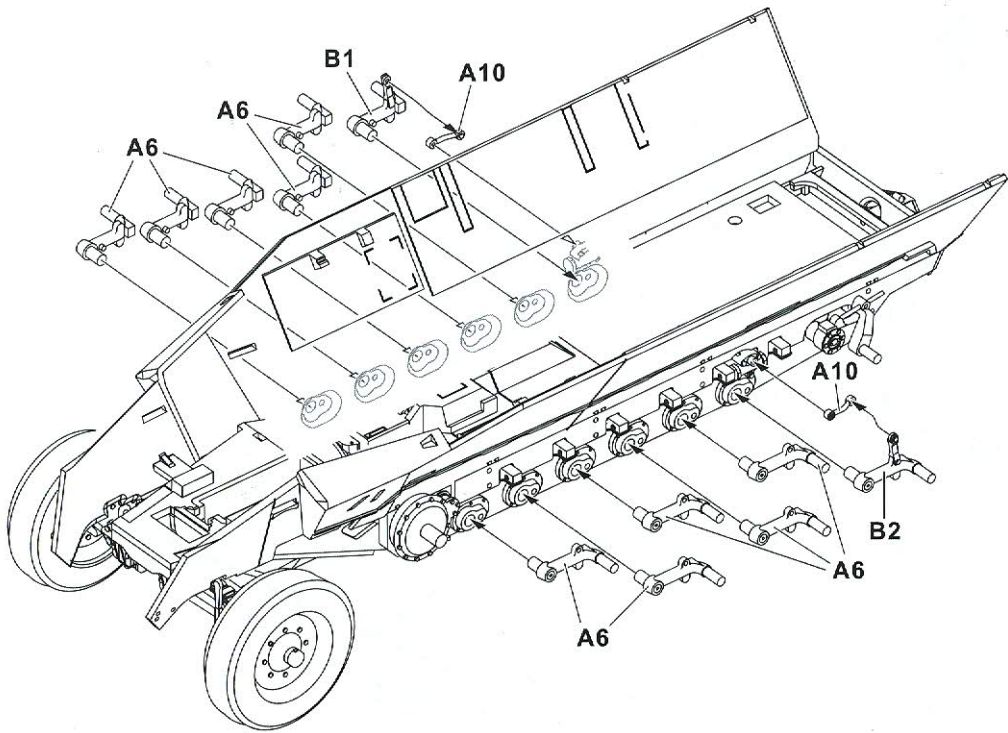

6

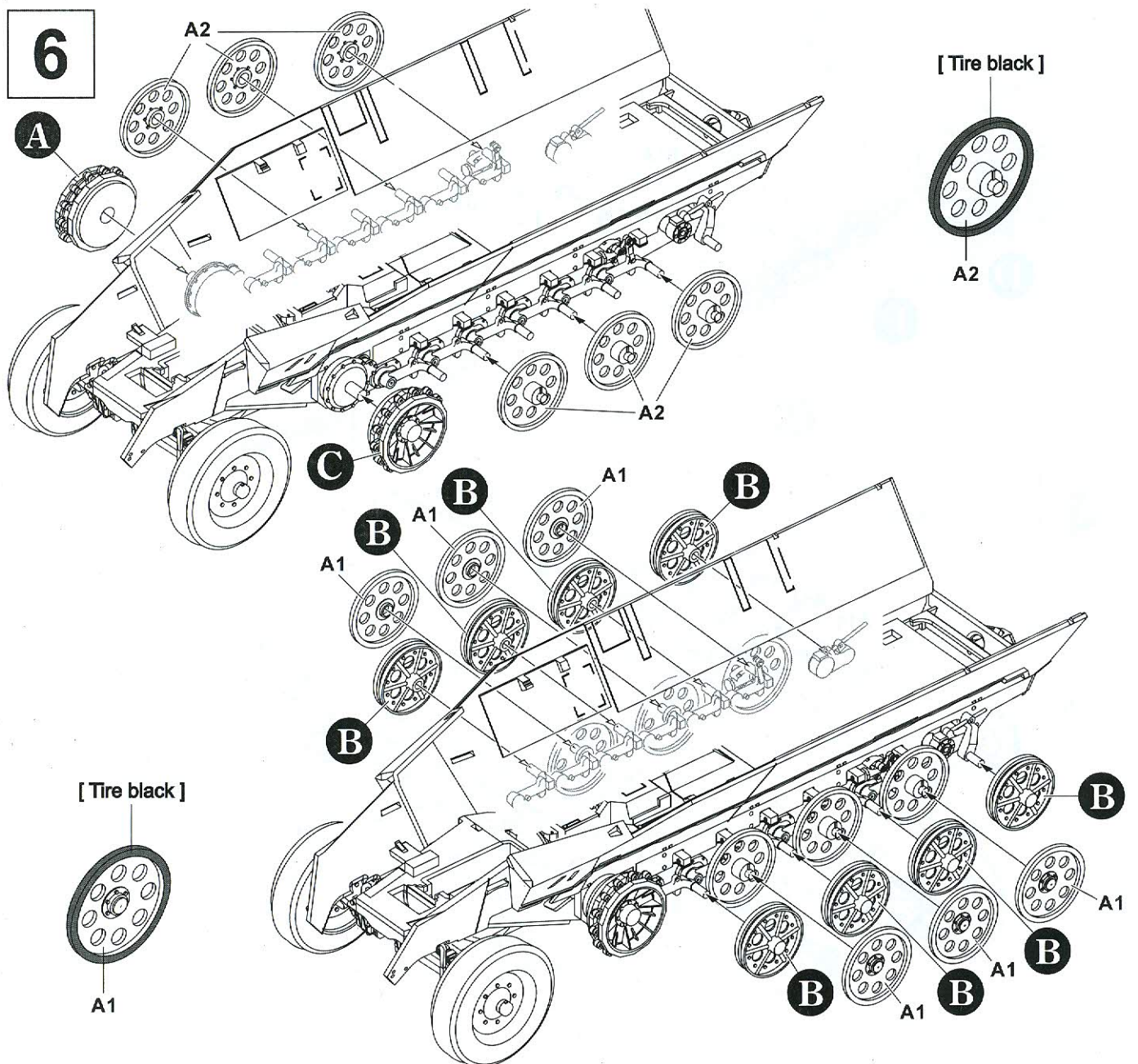

7

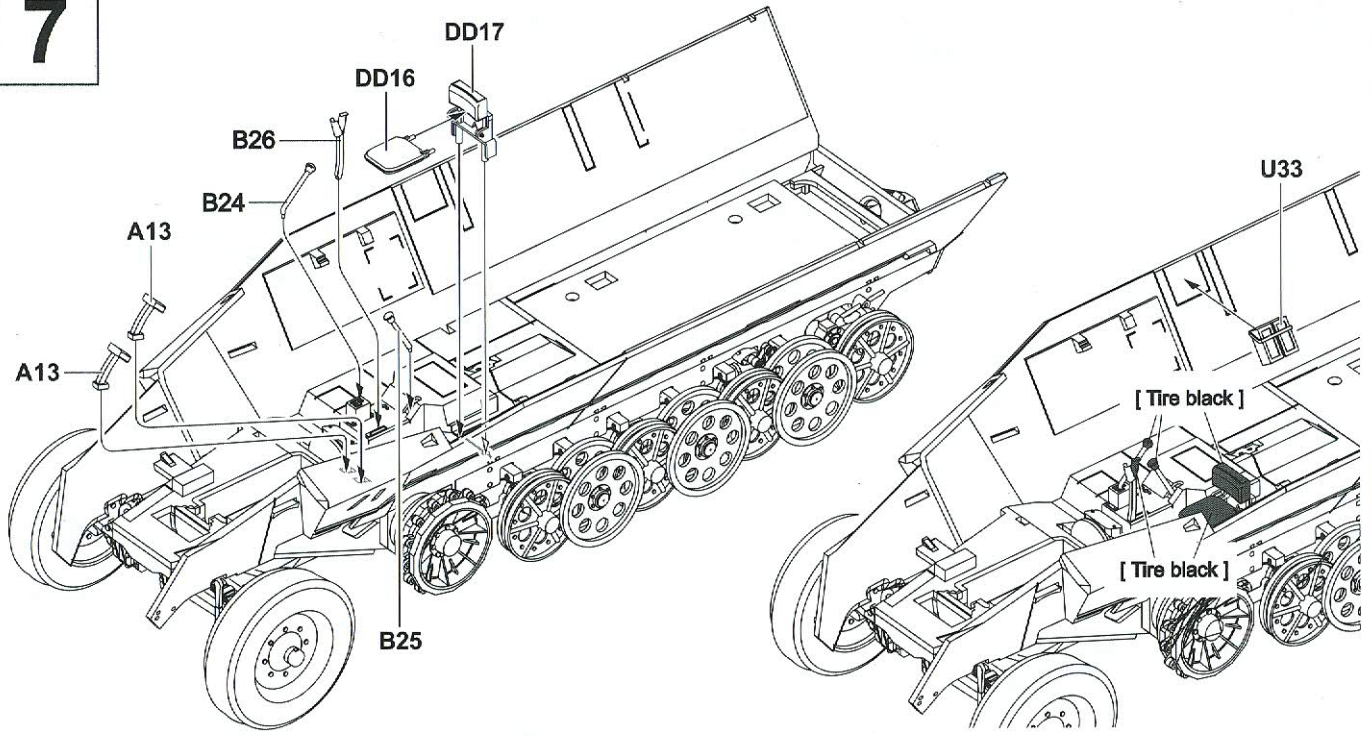

8

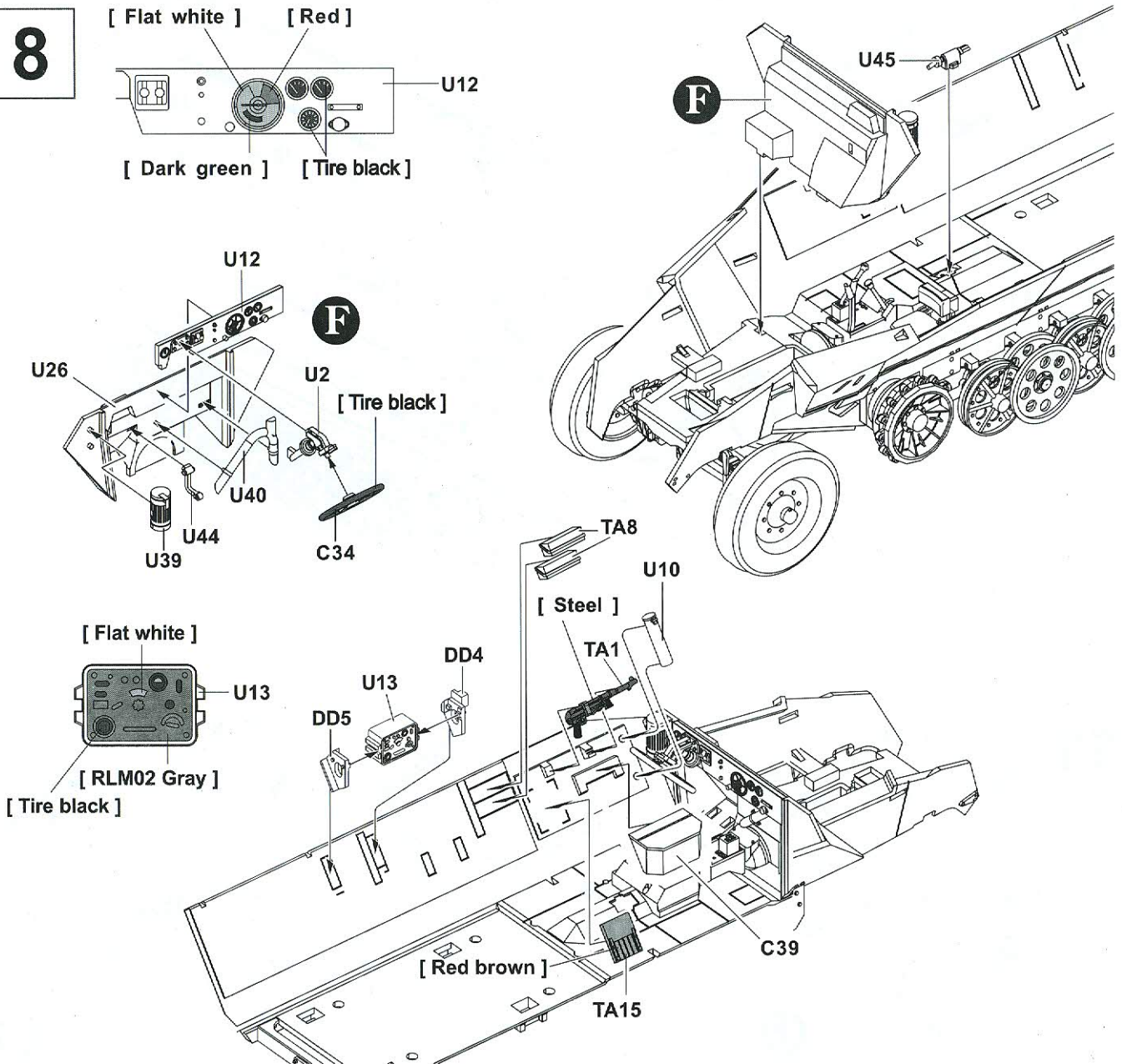

9

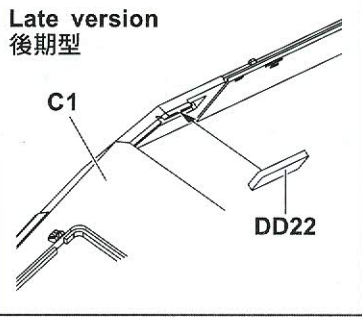

Early version  
初期型

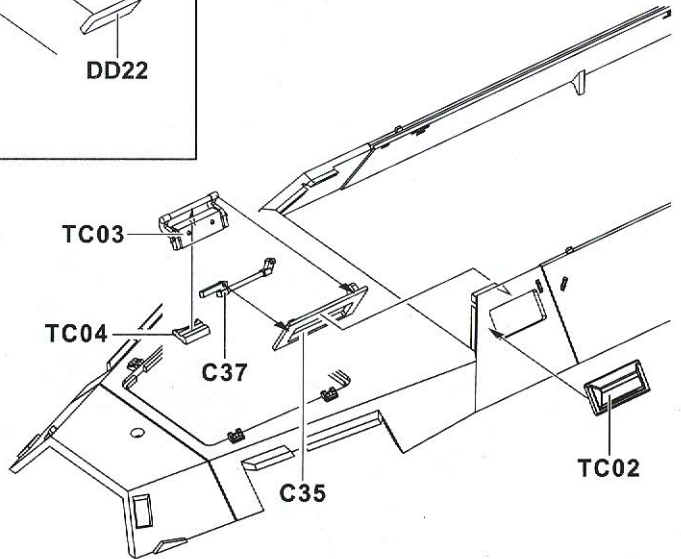
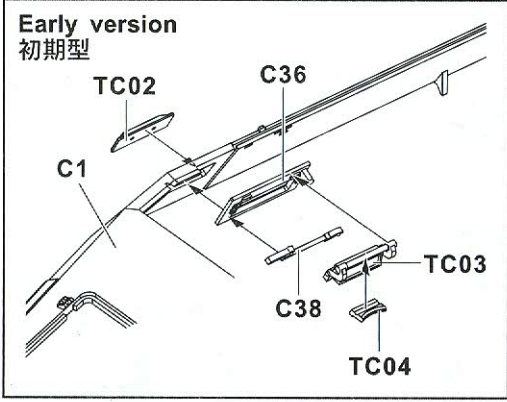

10

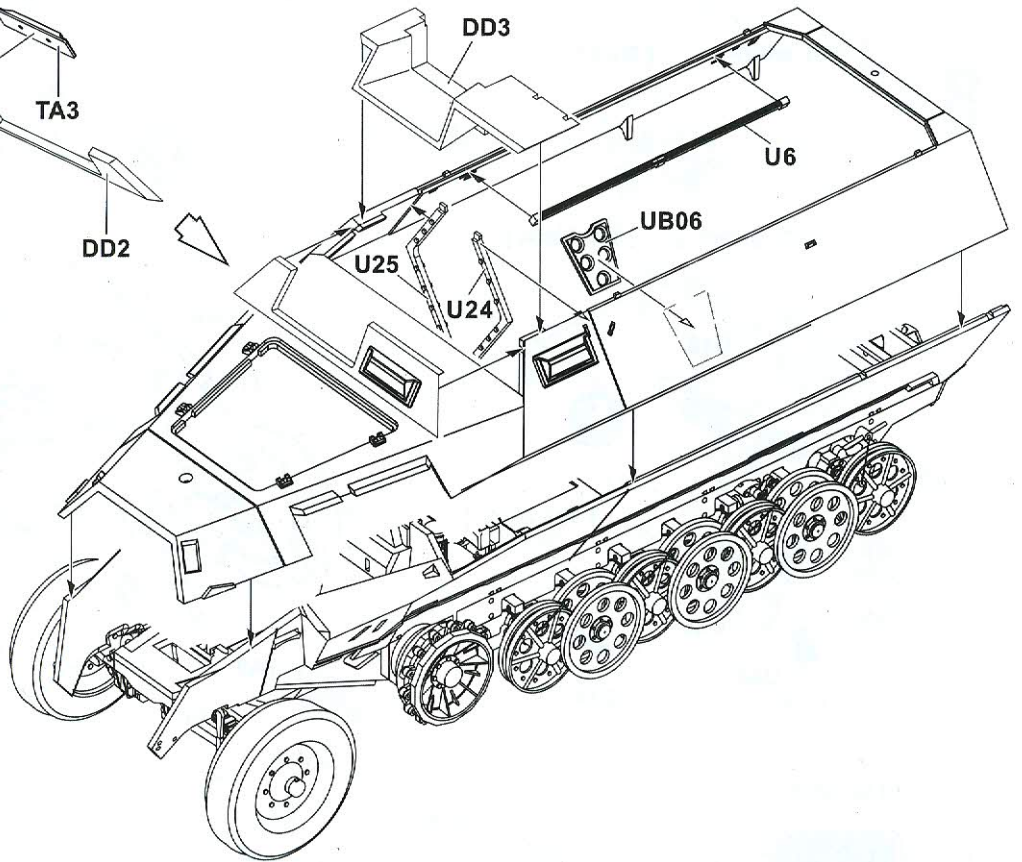
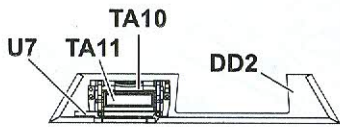
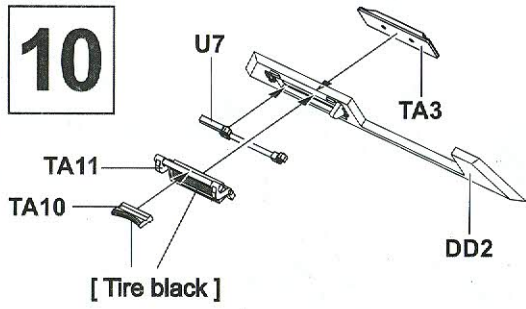

11

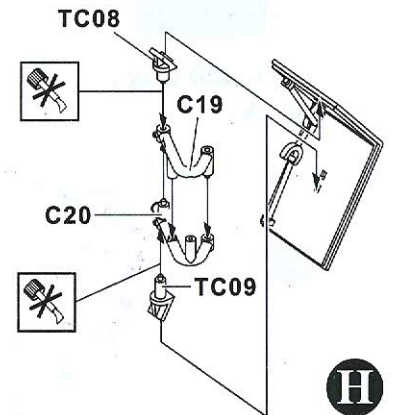
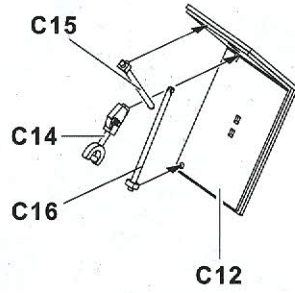
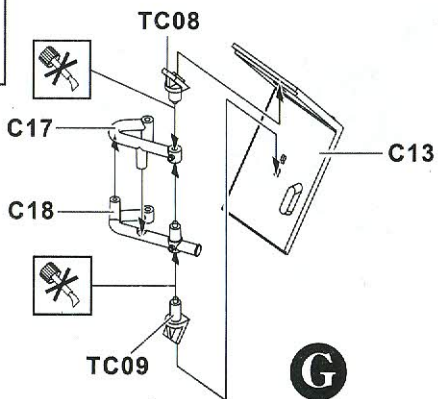



# 12

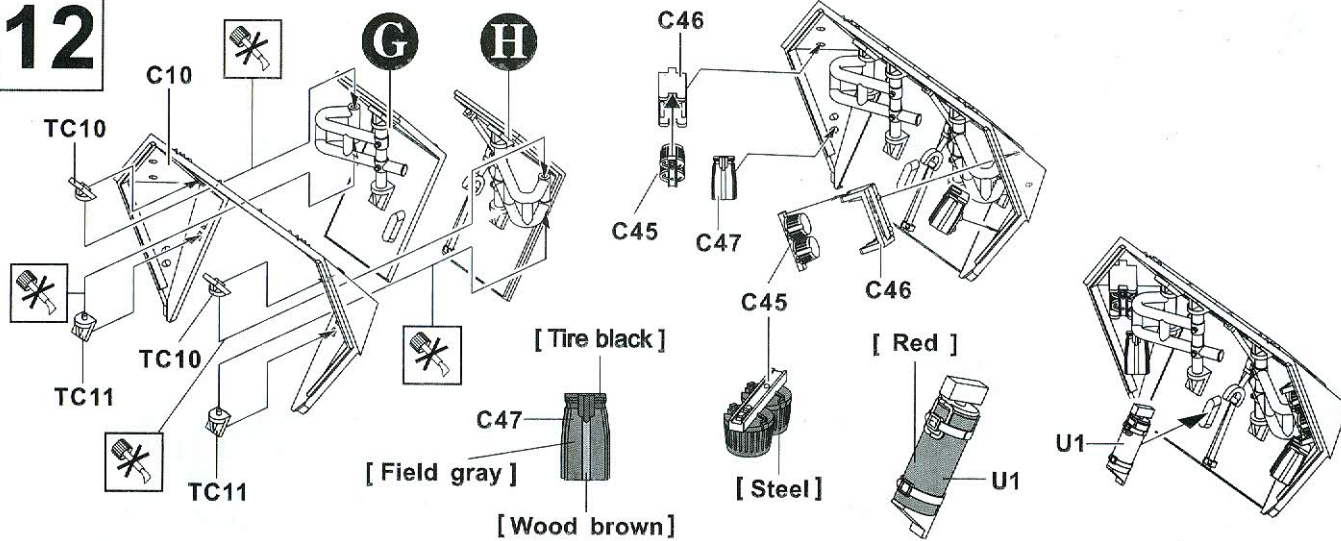

# 13

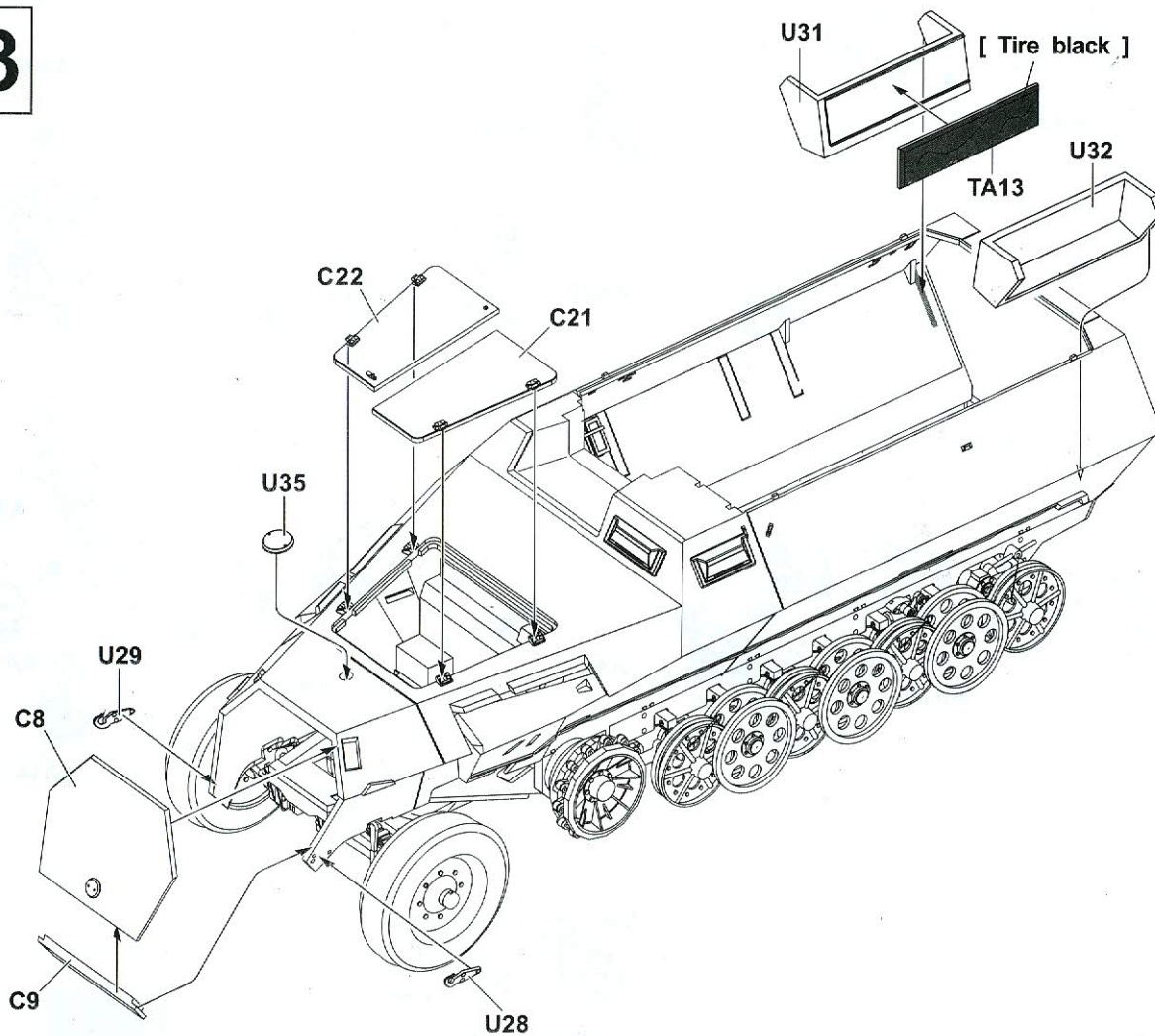

# 14

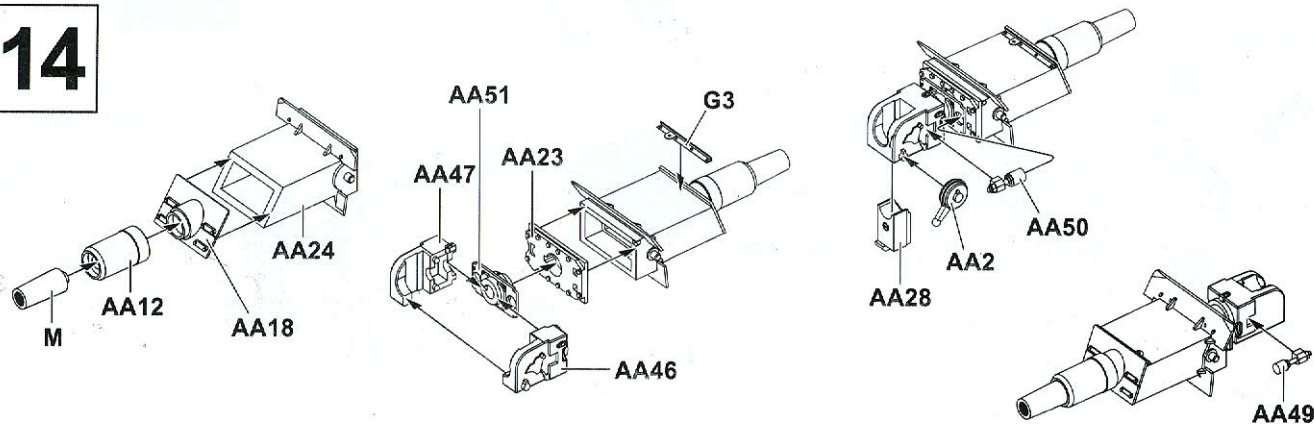

15

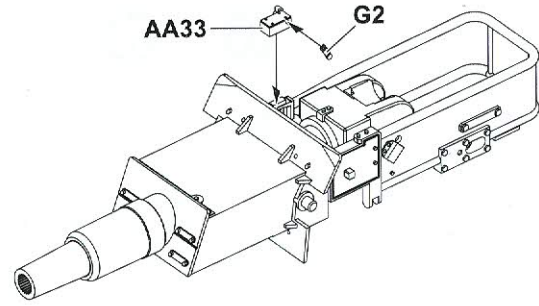
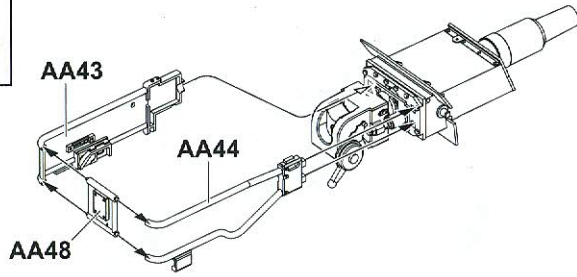

16

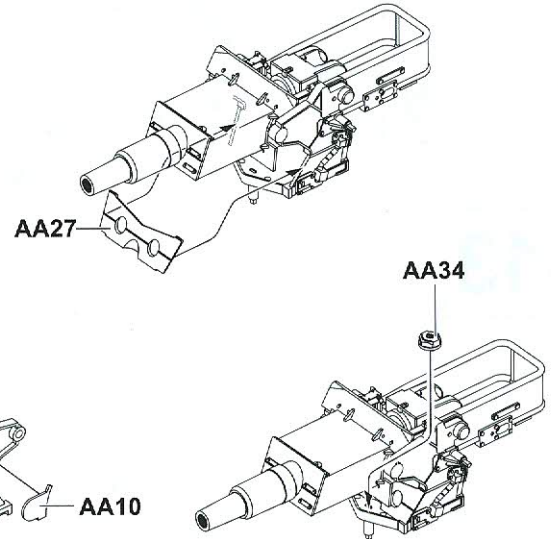
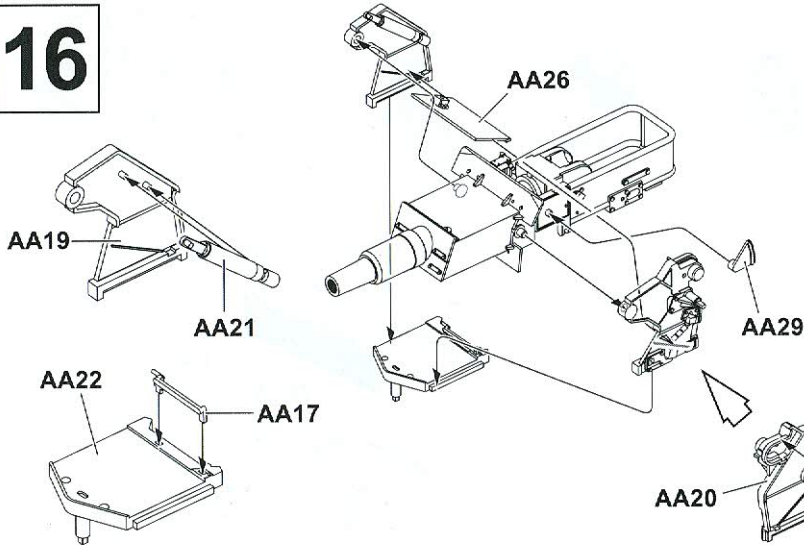

17

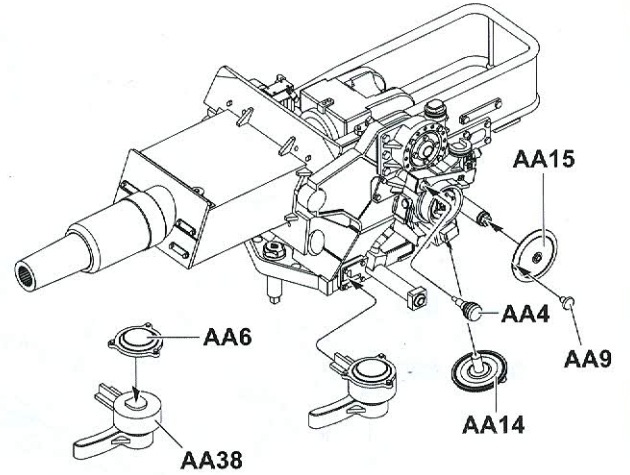
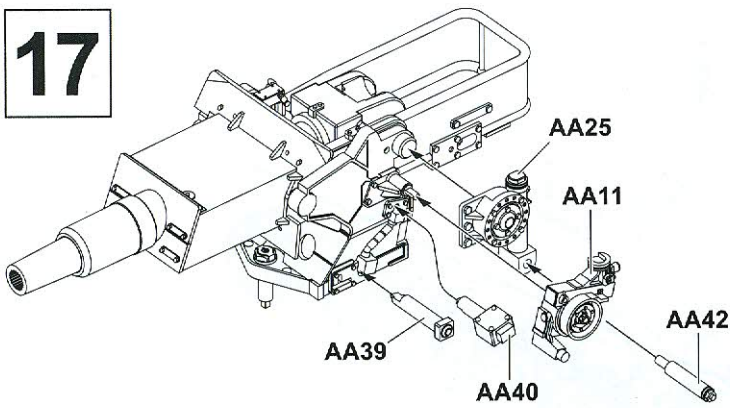

18

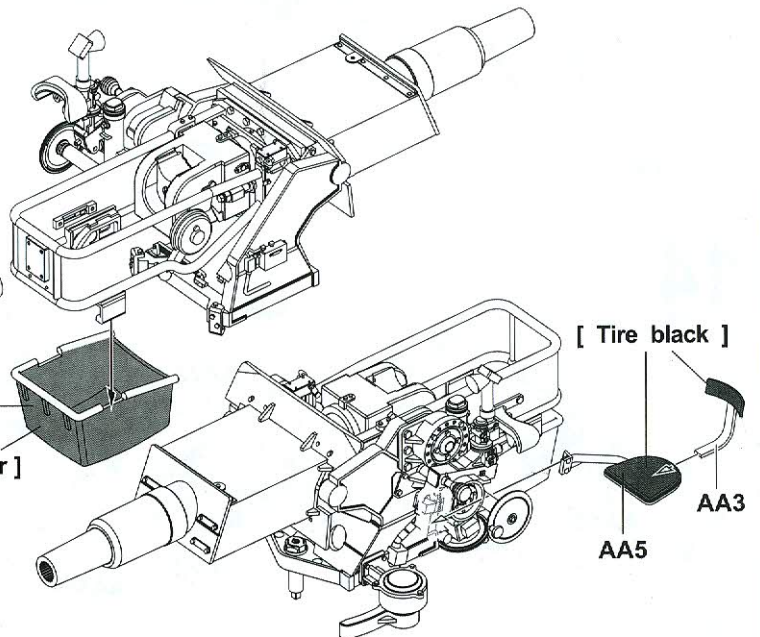
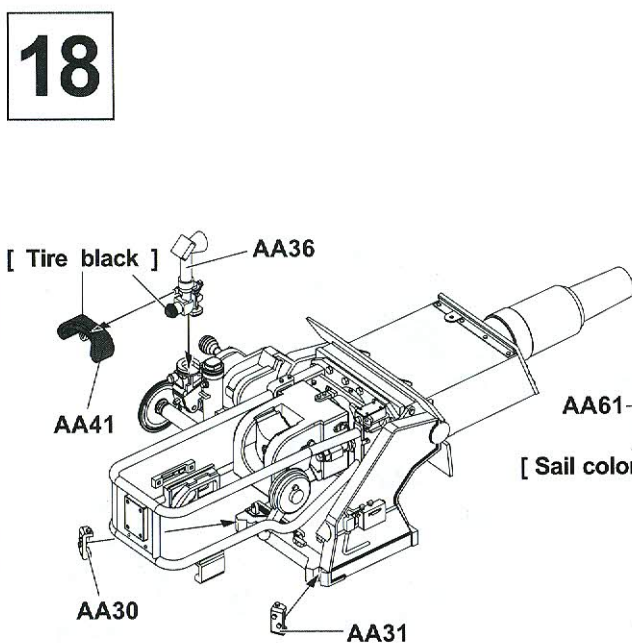

# 19

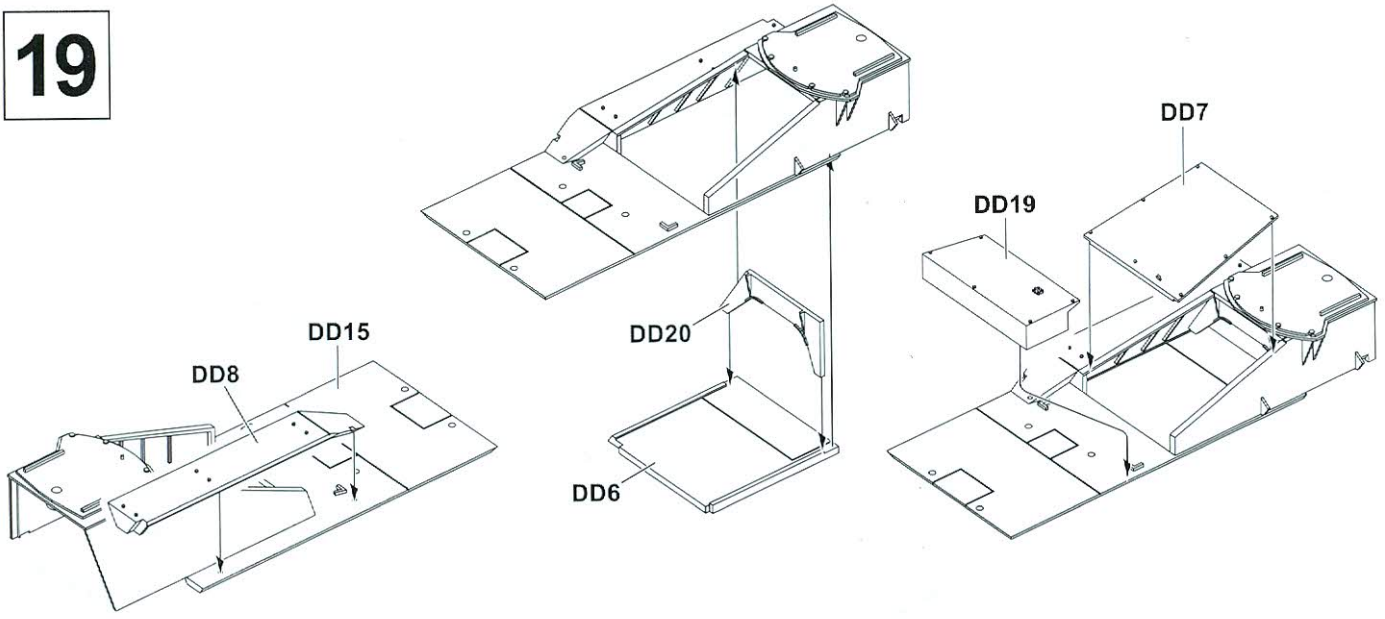

# 20

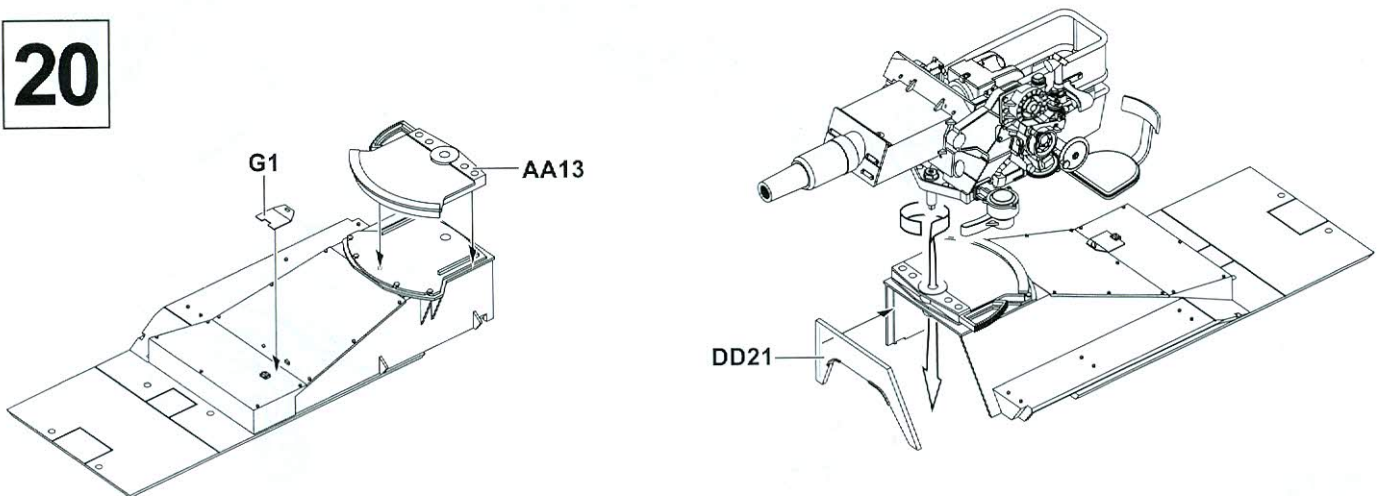

# 21

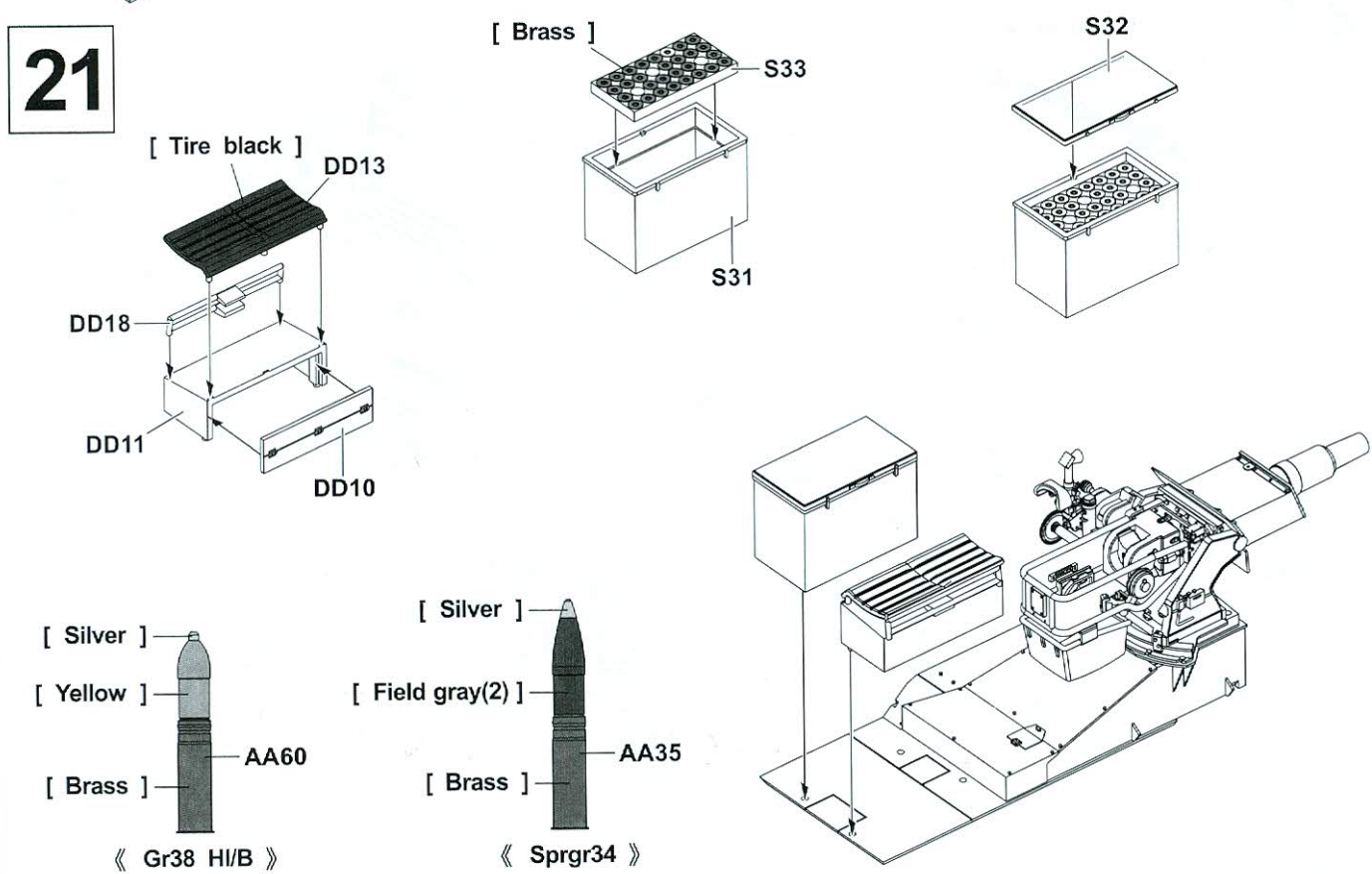

22

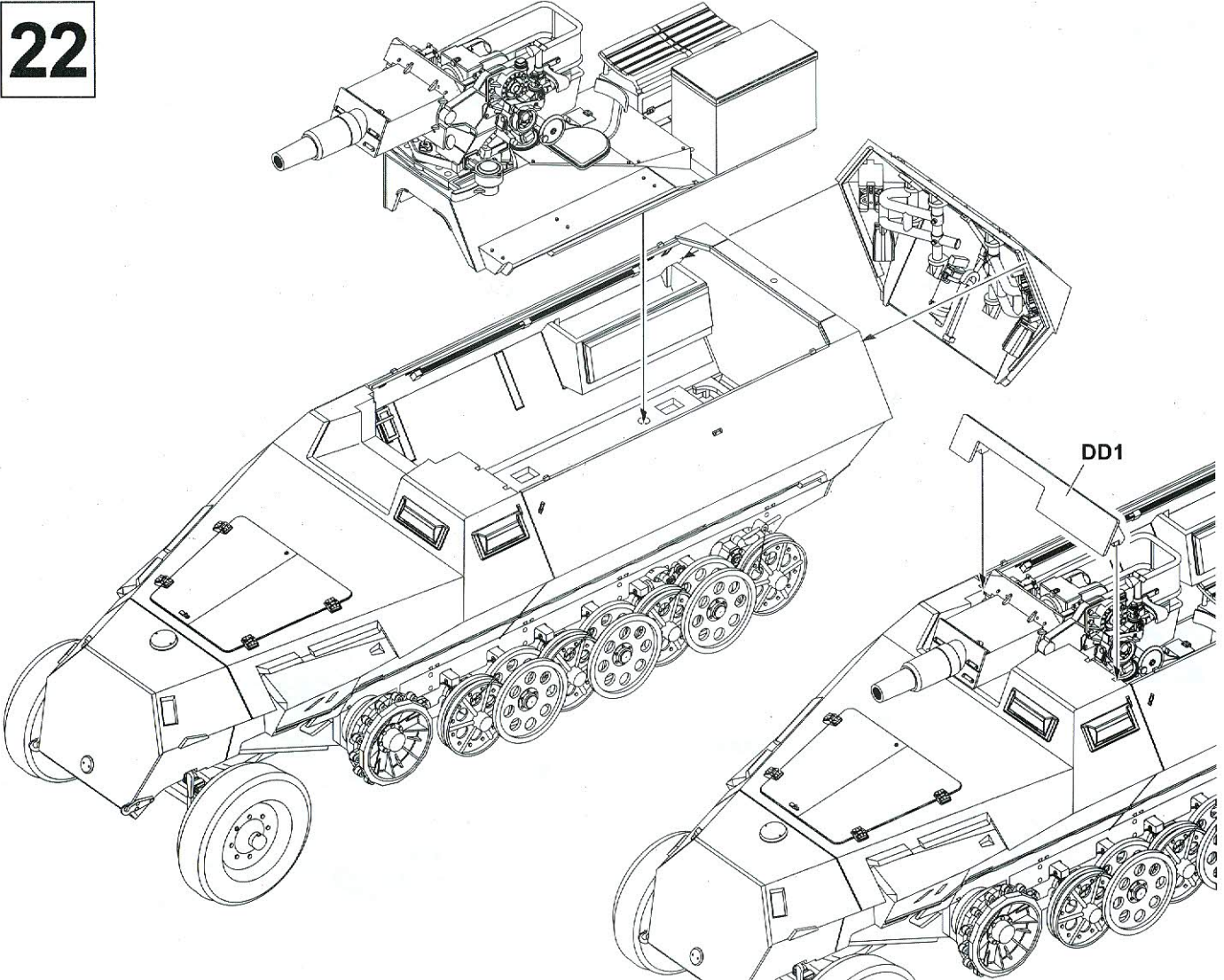

23

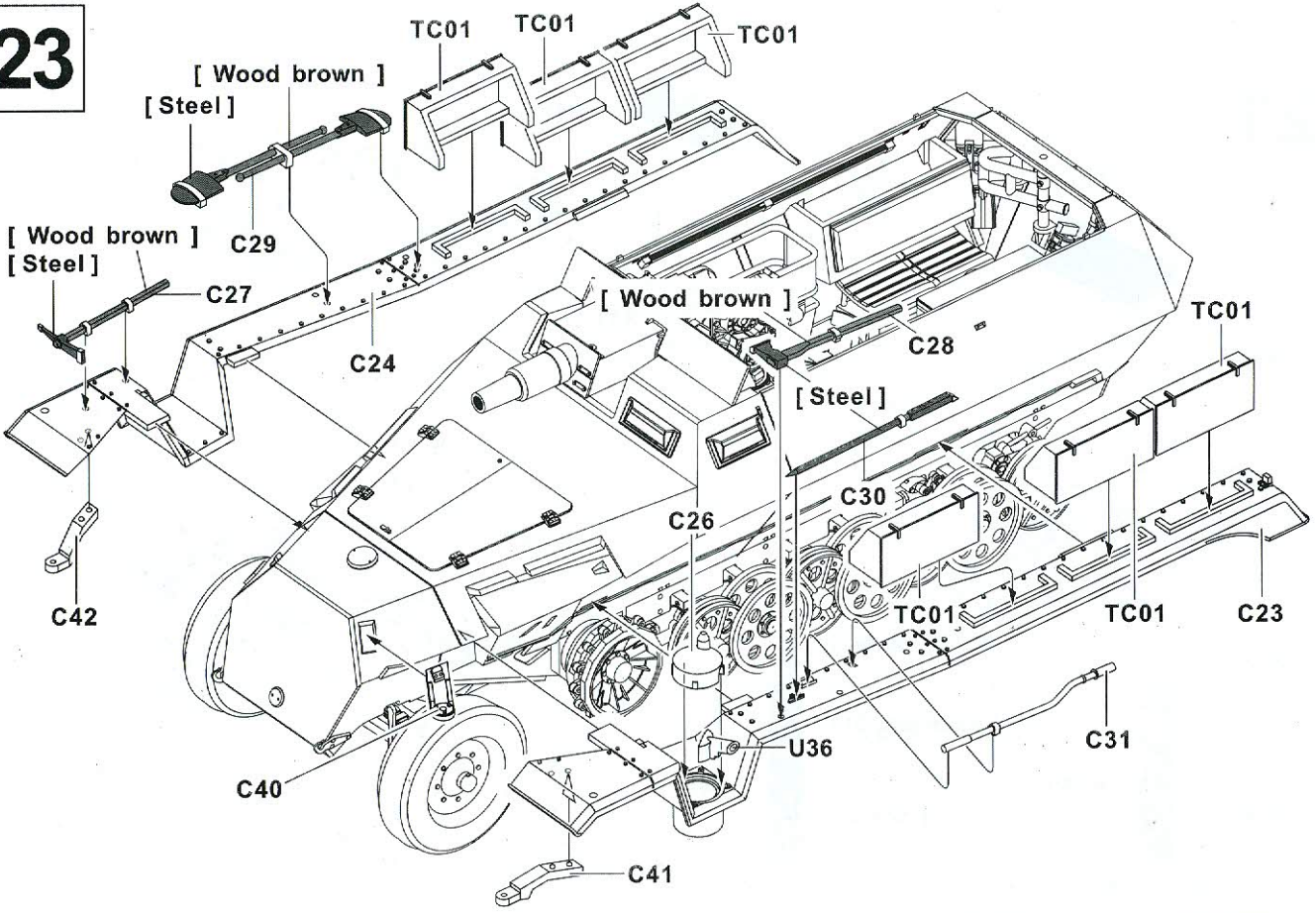

24

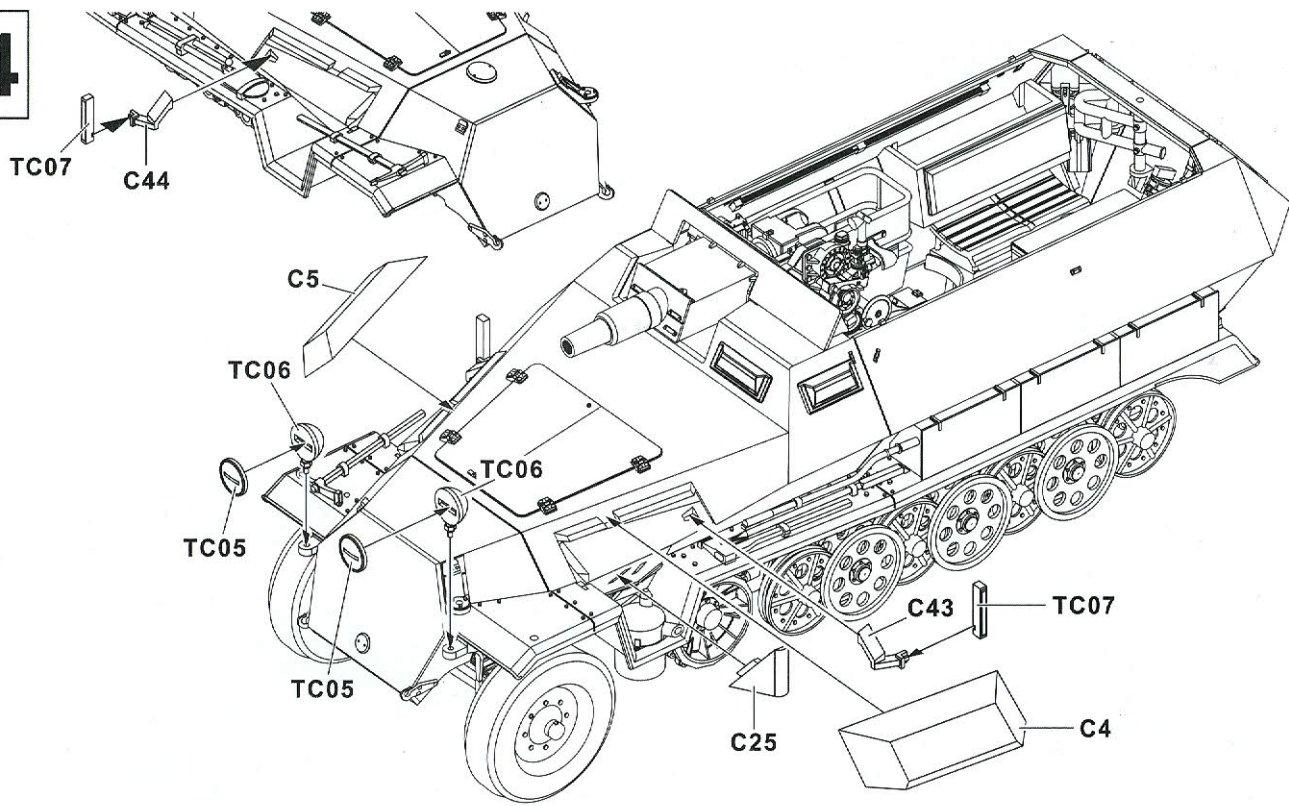

25

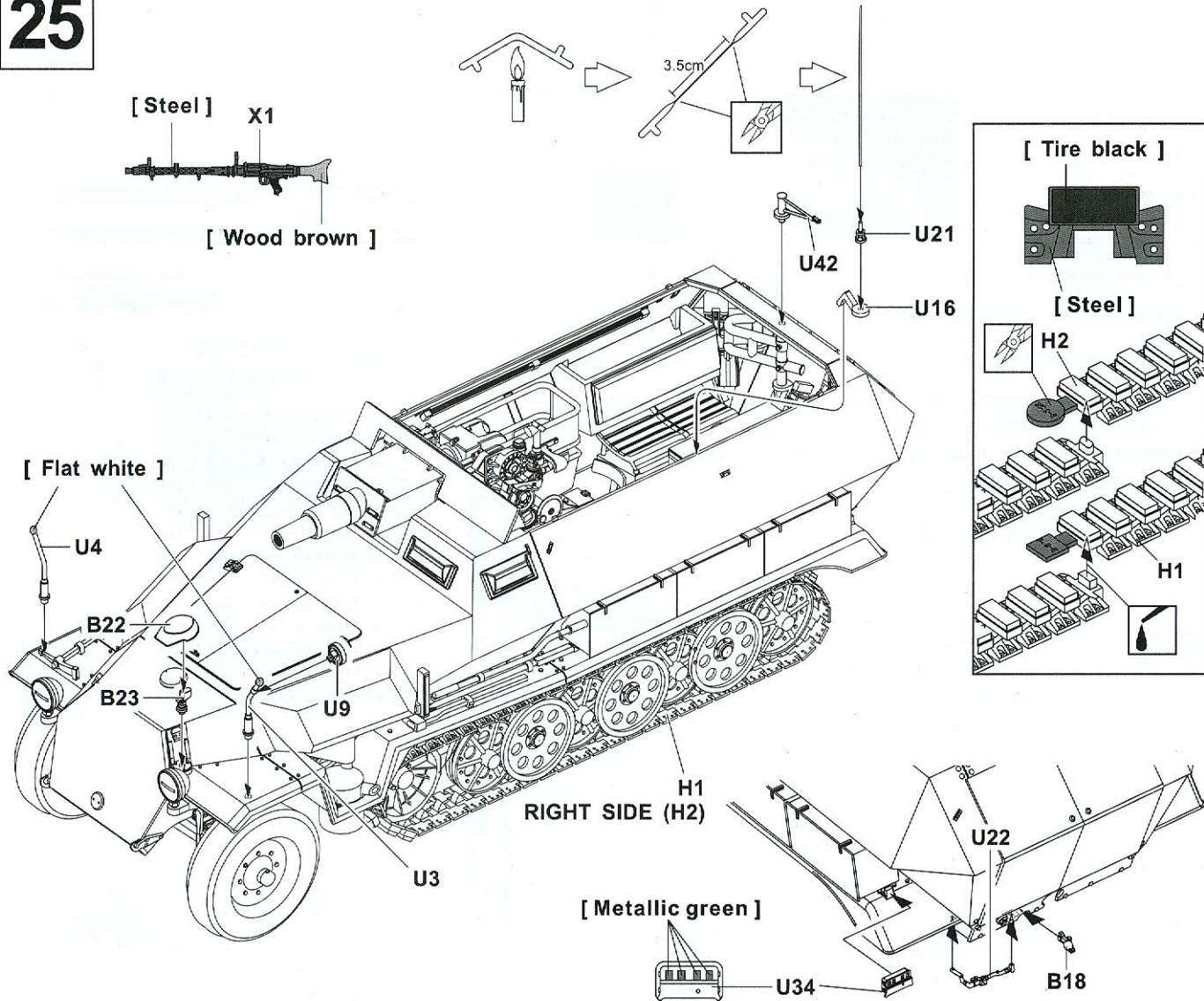

 Note the different length of track(H1,H2)  
注意兩條履帶的長度不同

# PARTS LIST 零件表

C AF 35078x1

A AF 35040x2

B AF 35040x1

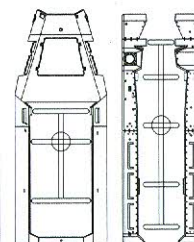
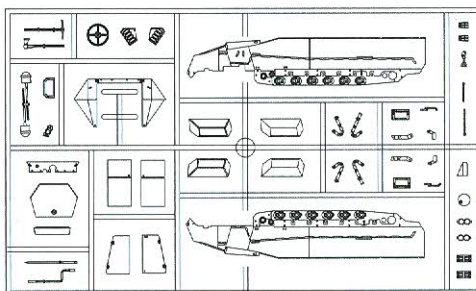
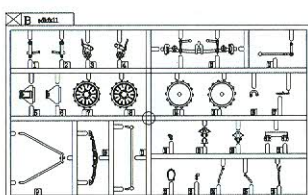
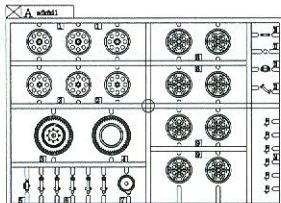

AA AF 35233x1

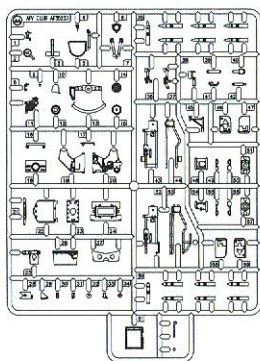

DD AF 35251x1

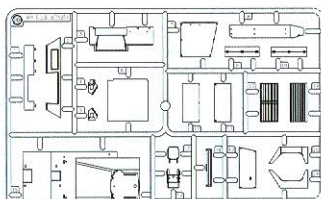

U AF 35063x1

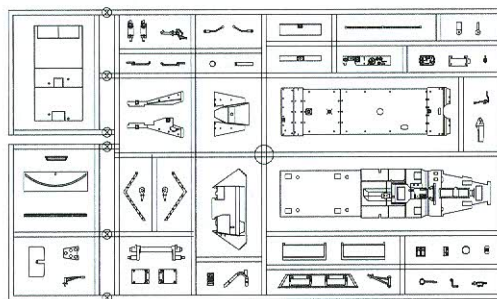

M AF 35251x1



X AF 35054x1

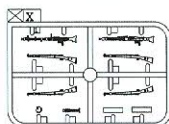

TC AF 35063x2

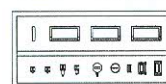

TA AF 35063x1

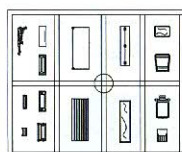

J AF 35251x1

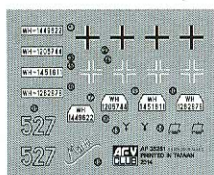

G AF 35251x1



H AF 35040x1



## Instructions:

If for some reason, you are not fully satisfied or have questions concerning our product; Please use the form provide, and send it to our nearest representative or mail it directly to our office.

We will deal with that A.S.A.P.

限臺灣地區使用 For Taiwanese use only!



## AF 35251 零件補充申請表

申請人  
姓名 地址 電話

- AF 35040-A ——— NTS 280
- AF 35233-AA ——— NTS 260
- AF 35040-B ——— NTS 120
- AF 35078-C ——— NTS 260
- AF 35251-DD ——— NTS 180
- AF 35251-G ——— NTS 160
- AF 35040-H ——— NTS 160
- AF 35251-J ——— NTS 160
- AF 35251-M ——— NTS 100
- AF 35063-TA ——— NTS 60
- AF 35063-TC ——— NTS 80
- AF 35063-U ——— NTS 160
- AF 35054-X ——— NTS 60

+郵寄費 ——— NTS 80  
(請填)總計NTS \_\_\_\_\_

零件補充原因:(請於  打 )  
原包裝即  遺失或  毀損,  
製作途中  遺失或  毀損,  
其他原因 \_\_\_\_\_

總代理戰鷹企業有限公司收本公司將儘速為您處理。  
請將本表與該部品相同金額之郵政匯票一同寄至。



## AF 35251 Parts Replacement Form

- AF 35040-A
- AF 35233-AA
- AF 35040-B
- AF 35078-C
- AF 35251-DD
- AF 35251-G
- AF 35040-H
- AF 35251-J
- AF 35251-M
- AF 35063-TA
- AF 35063-TC
- AF 35063-U
- AF 35054-X

Reason for replacement:  Missing  
 Broken

Signature: \_\_\_\_\_

**A** 16th Pz.Div., Poland, Jan. 1945  
 第十六装甲师, 波兰, 1945年元月

 Body Color: Flat white 

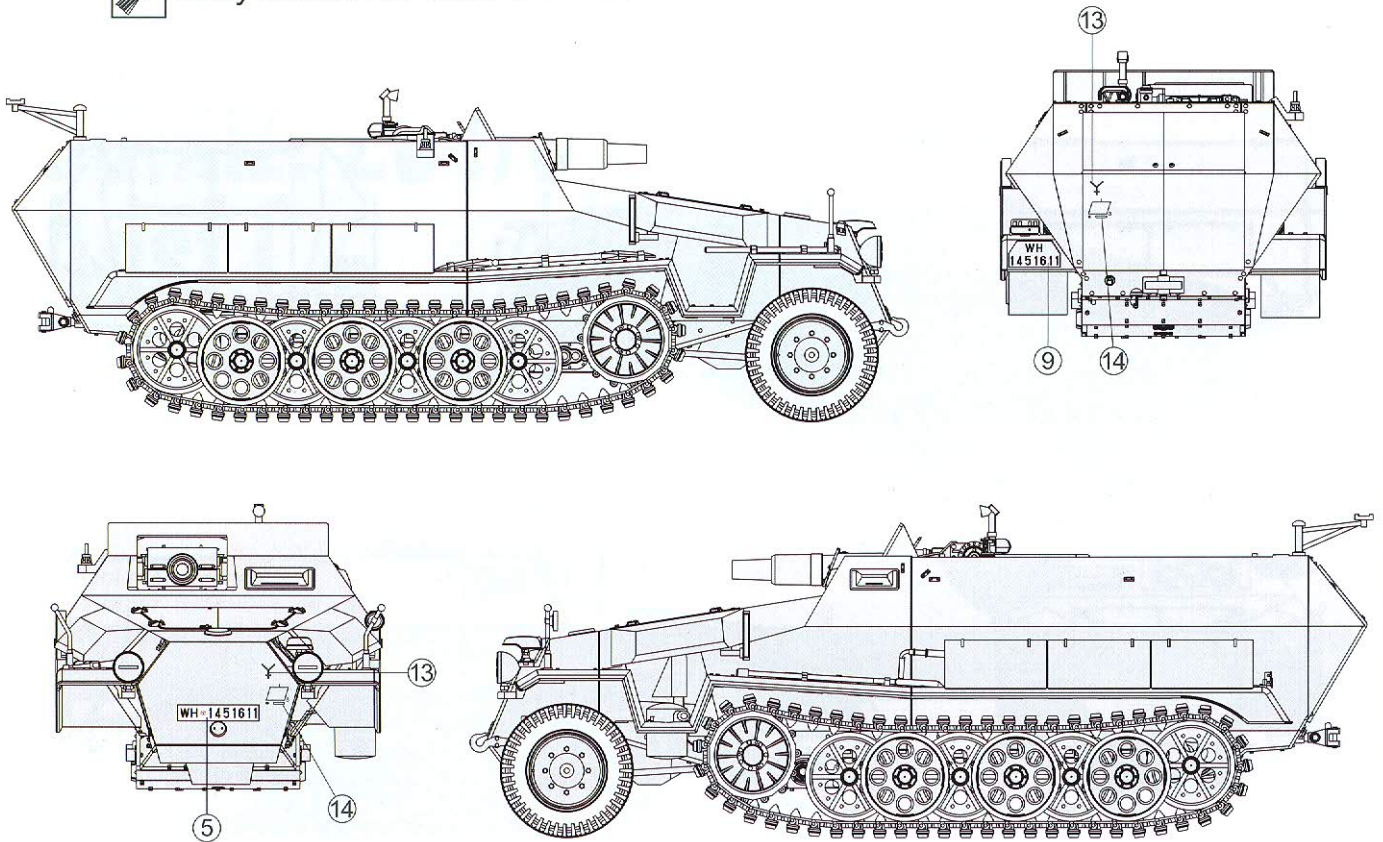

**B** Eastern Front, 1942  
 東線, 1942年

 Body Color: German gray 

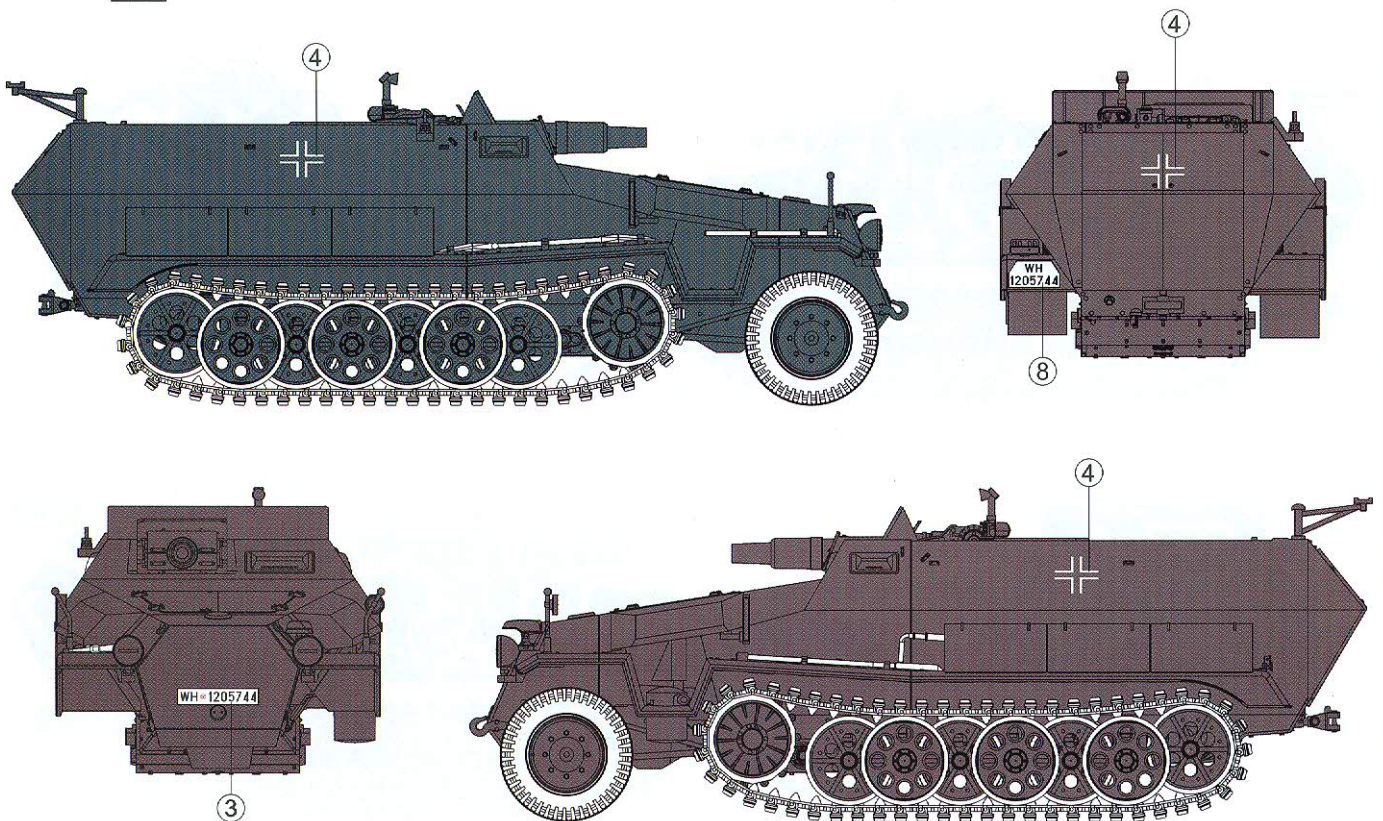

**C** 19th Pz.Div., Charkow, Winter 1942/43  
 第十九裝甲師, 卡爾可夫, 1942/43年冬

Body Color: German gray   
 Flat white 

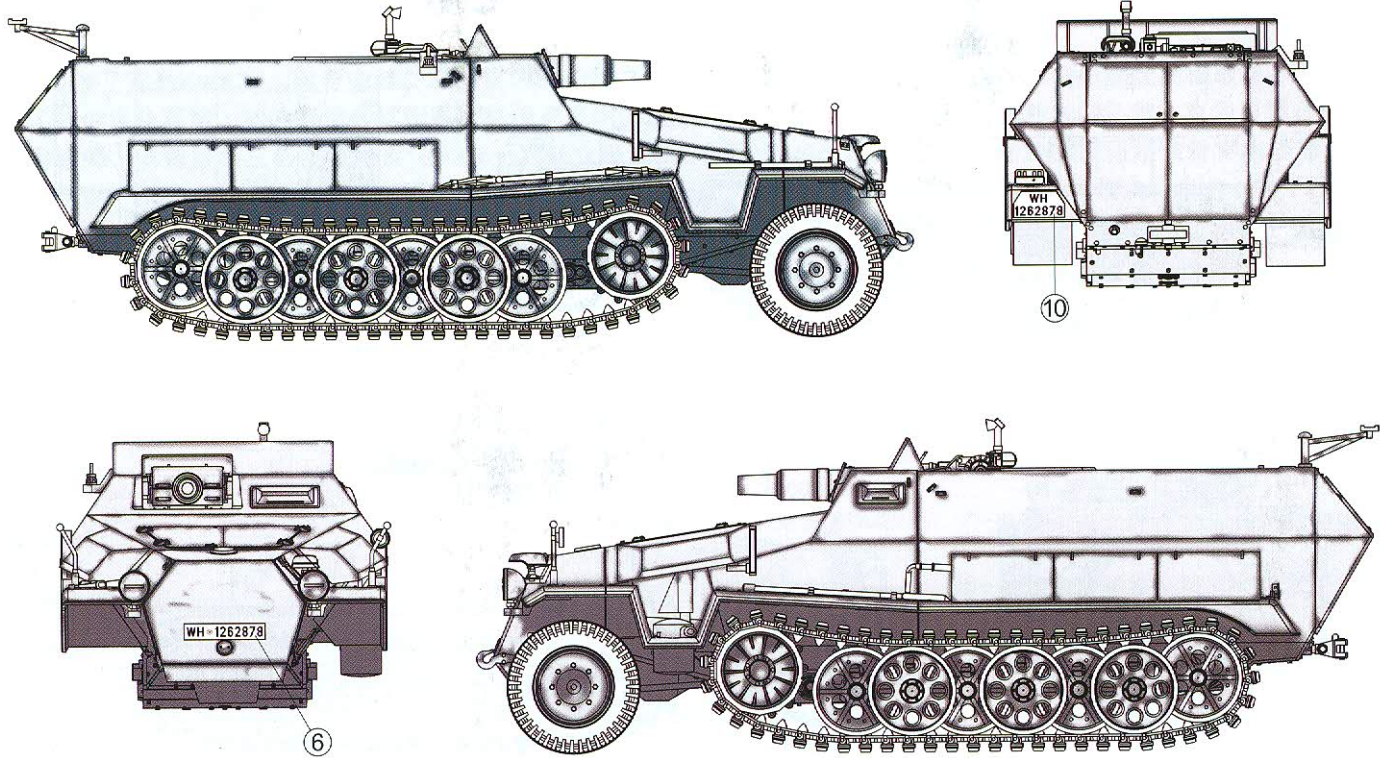

**D** Eastern Front, Summer 1943  
 東線, 1943年夏

Body Color: Olive green   
 Sandy yellow 

