

**a
m
t**

T515 603

FORD LOUISVILLE LINE TRUCK "SHORT HAULER"

WITH BODY BY

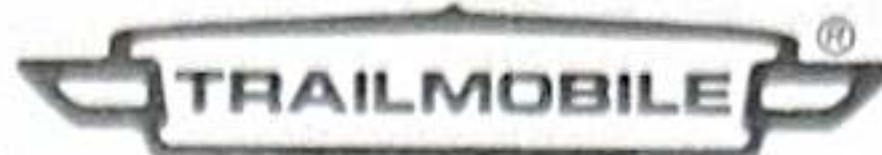

IMPORTANT!

READ THESE POINTS BEFORE YOU BEGIN

- 1 "TEST FIT" all parts before cementing. Trim excess plastic from parts before joining.
- 2 Cement all parts unless otherwise indicated by the instructions.
- 3 Use paint and cement made for styrene plastic only.
- 4 Paint all sub-assemblies before attaching parts.
- 5 Scrape paint away from surfaces to be cemented together.
- 6 Follow all of the numbers on the instruction sheet beginning with number one.

1. ENGINE 1-27

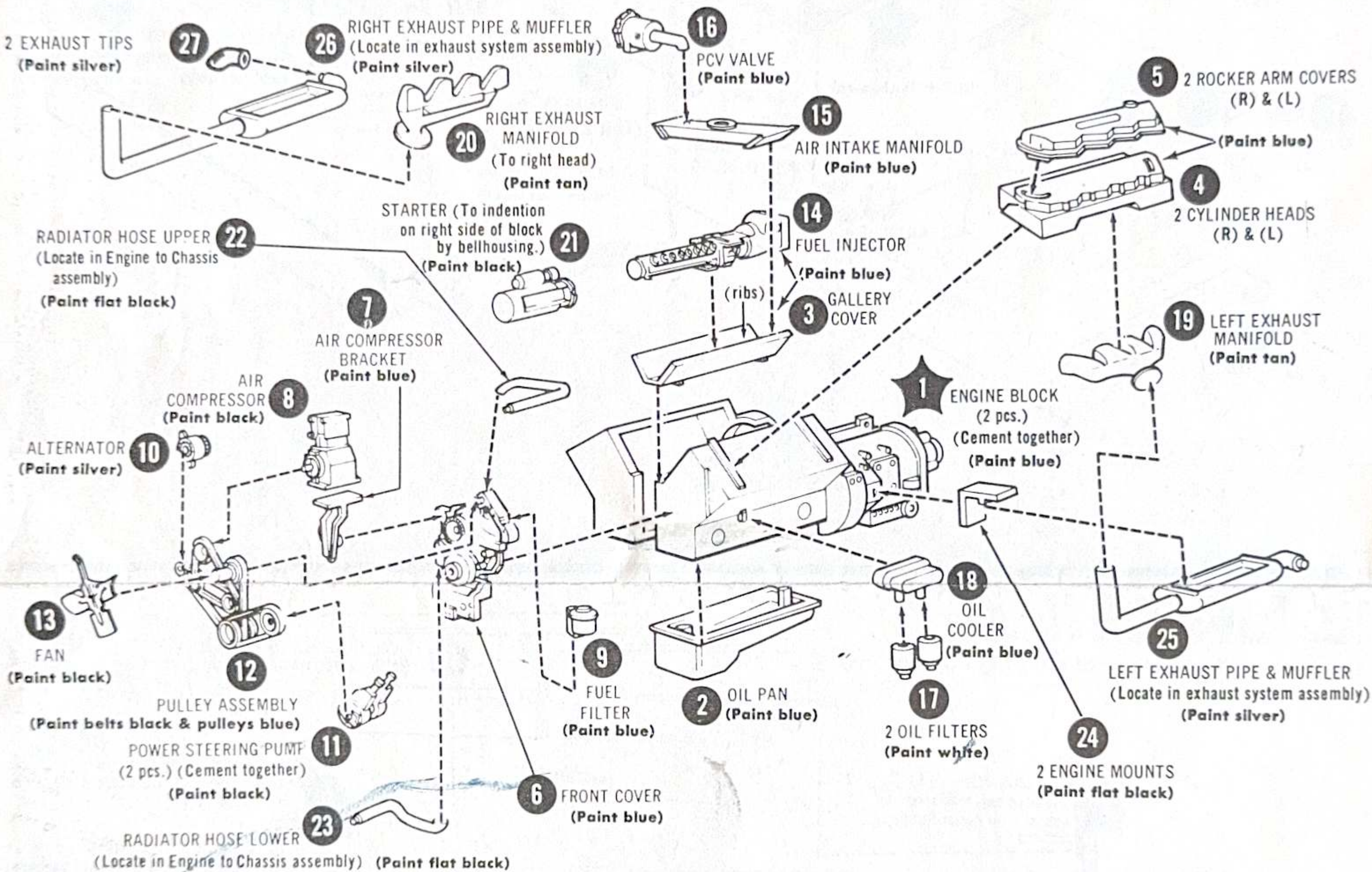

2. WHEELS 1-3 (Remove centers from tires)

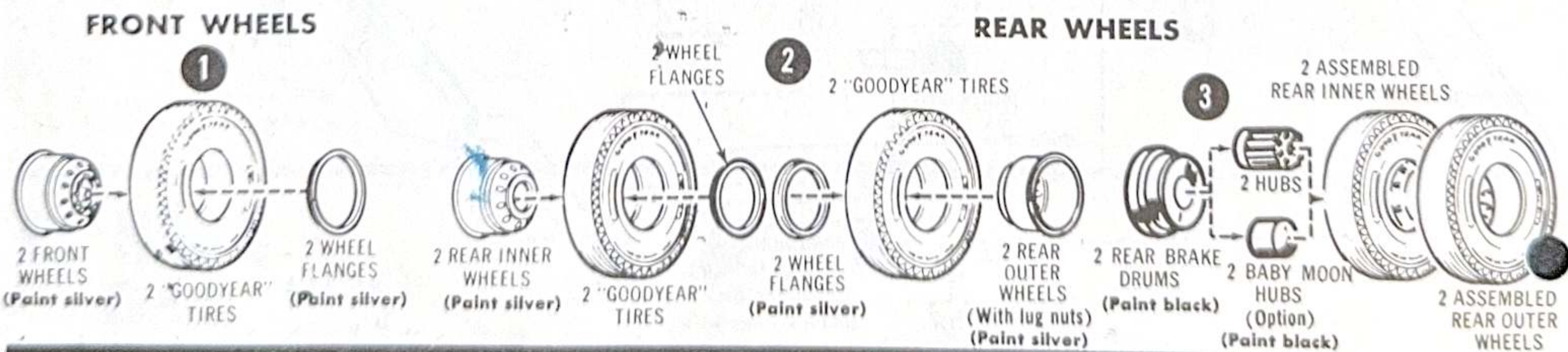

3. BASIC FRAME 1-7

(Paint basic frame flat black)

CEMENT ALL CROSSMEMBERS TO RIGHT FRAME RAIL THEN CEMENT LEFT FRAME RAIL TO ASSEMBLED CROSSMEMBERS.

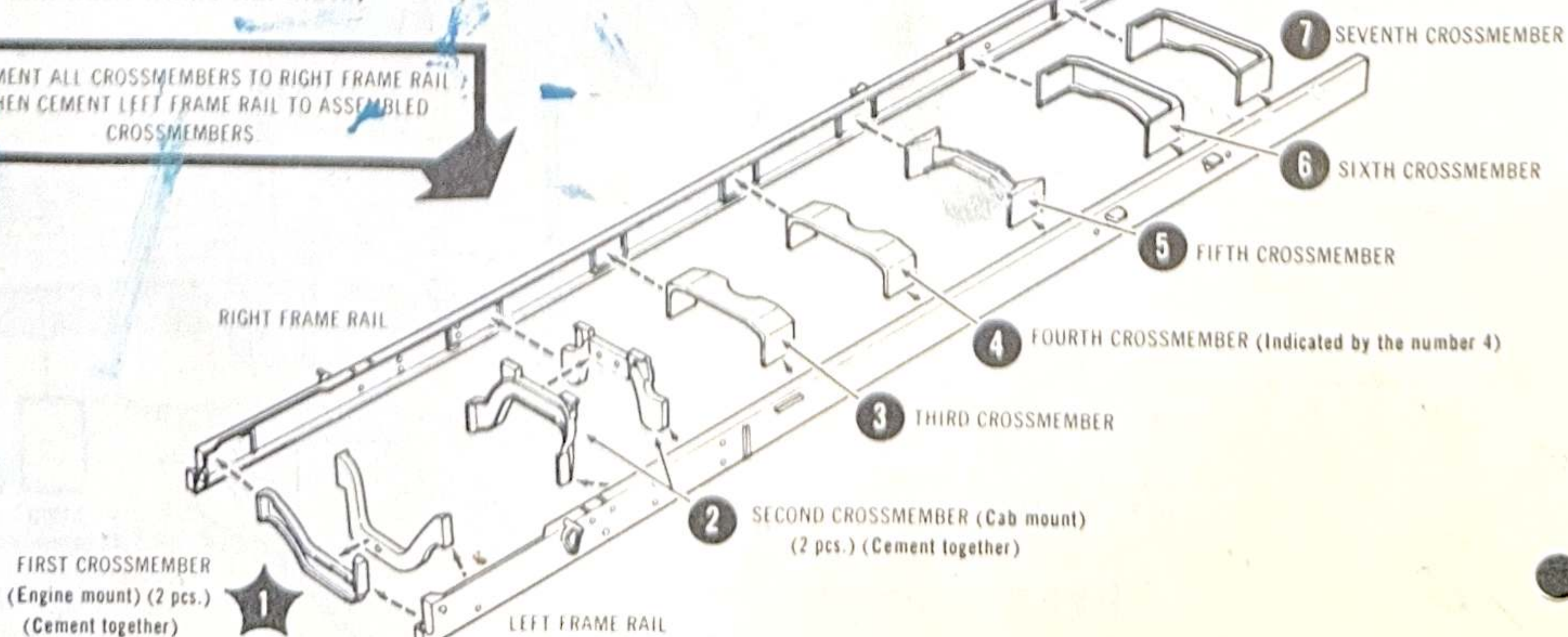

4. FRONT AXLE 1-10

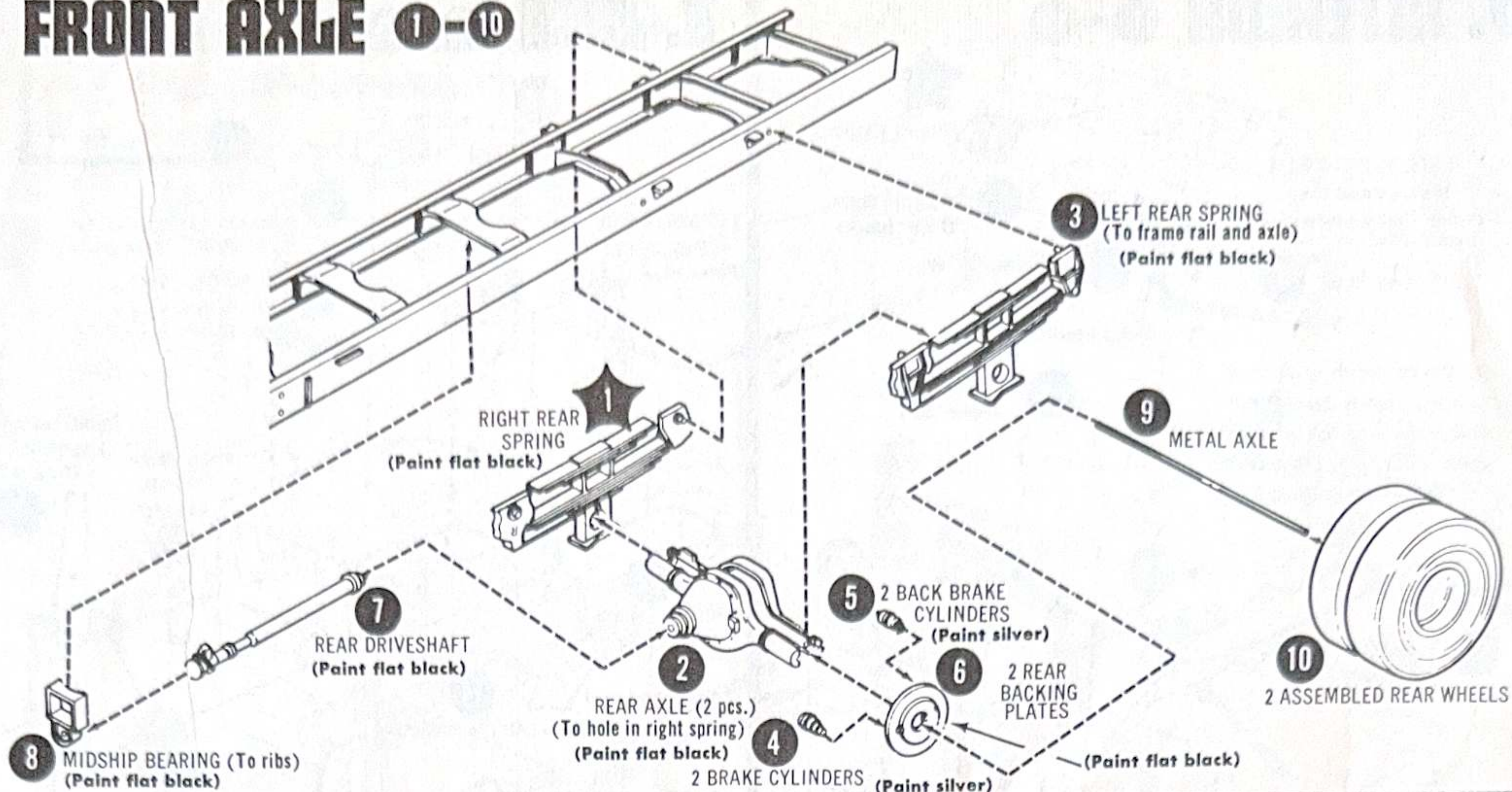

5. REAR AXLE 1-11

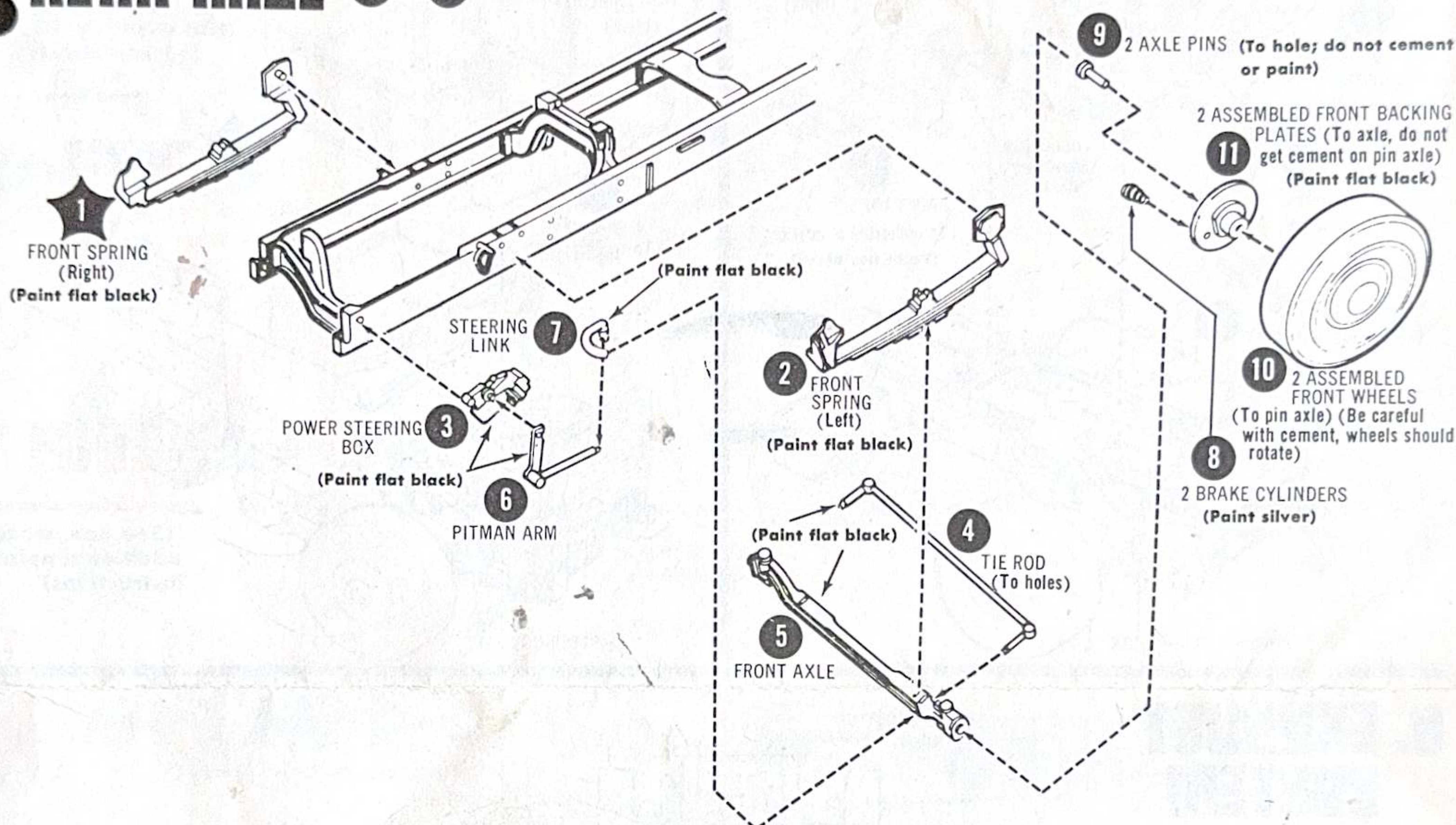

6. ENGINE TO CHASSIS 1-17

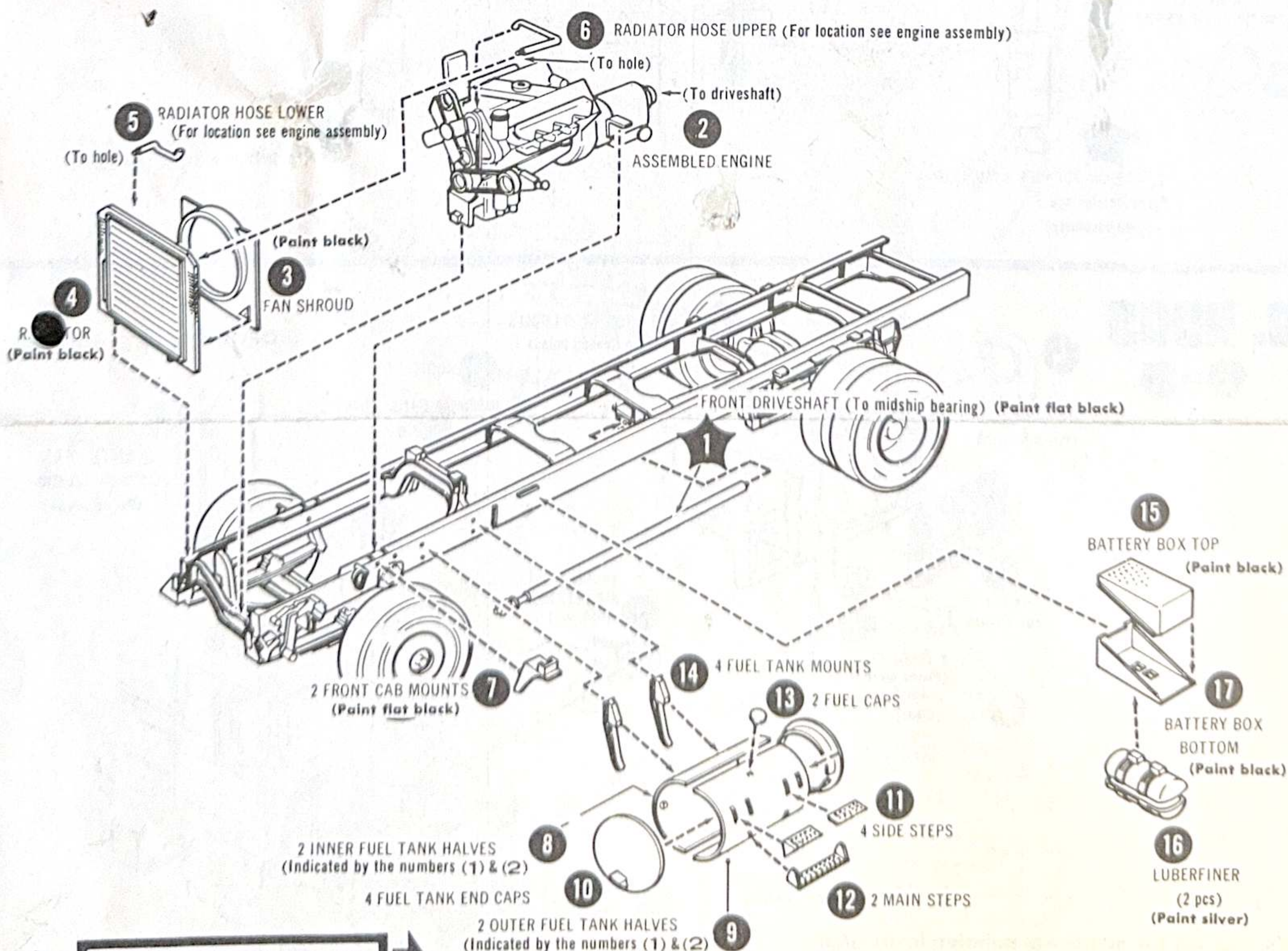

ASSEMBLE BOTH TANKS. LOCATE ONE TO RIGHT SIDE (1) (1) AND ONE TO LEFT SIDE (2) (2) (Paint silver)

7. INTERIOR 1-13

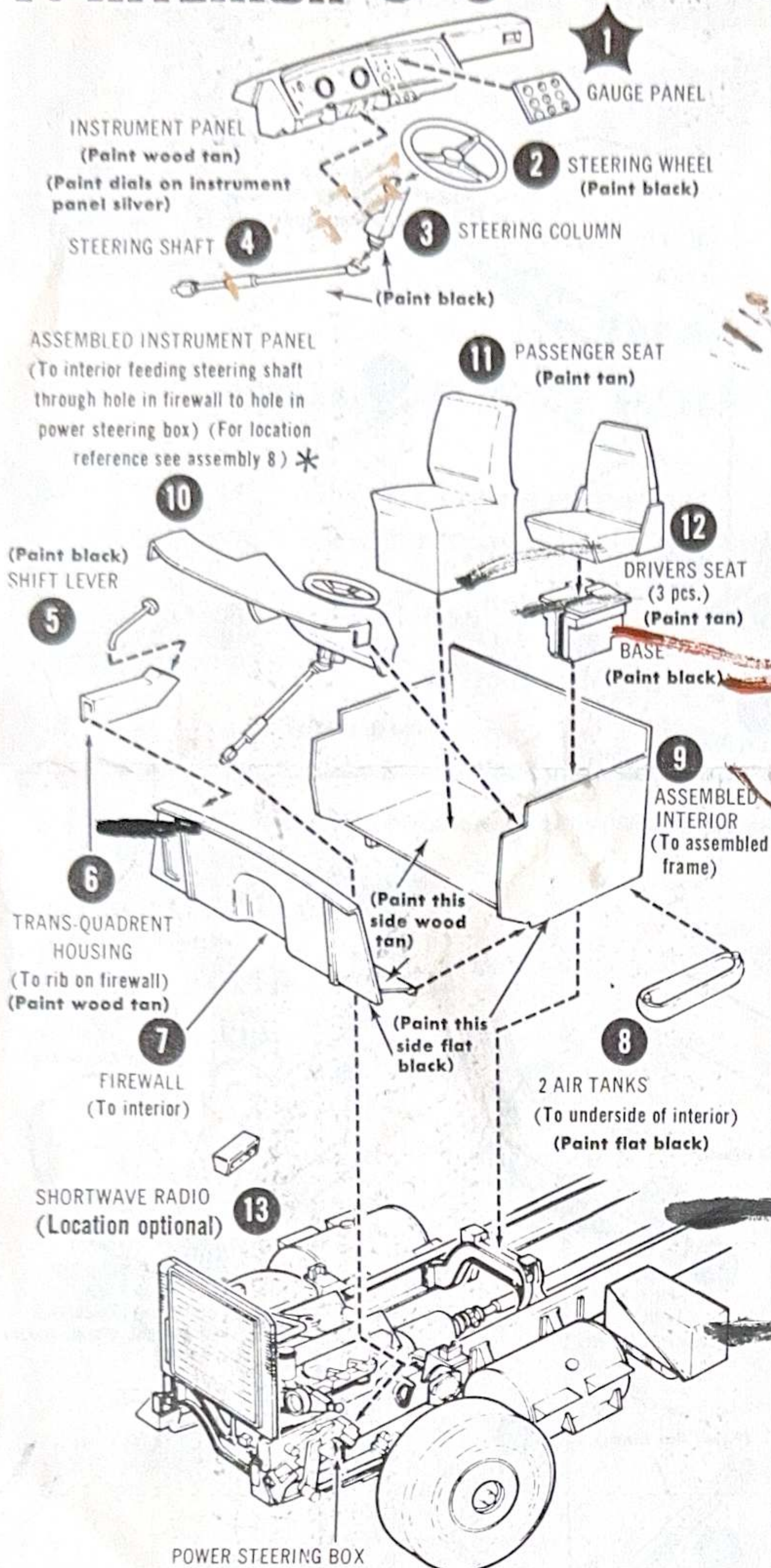

8. CAB 1-14

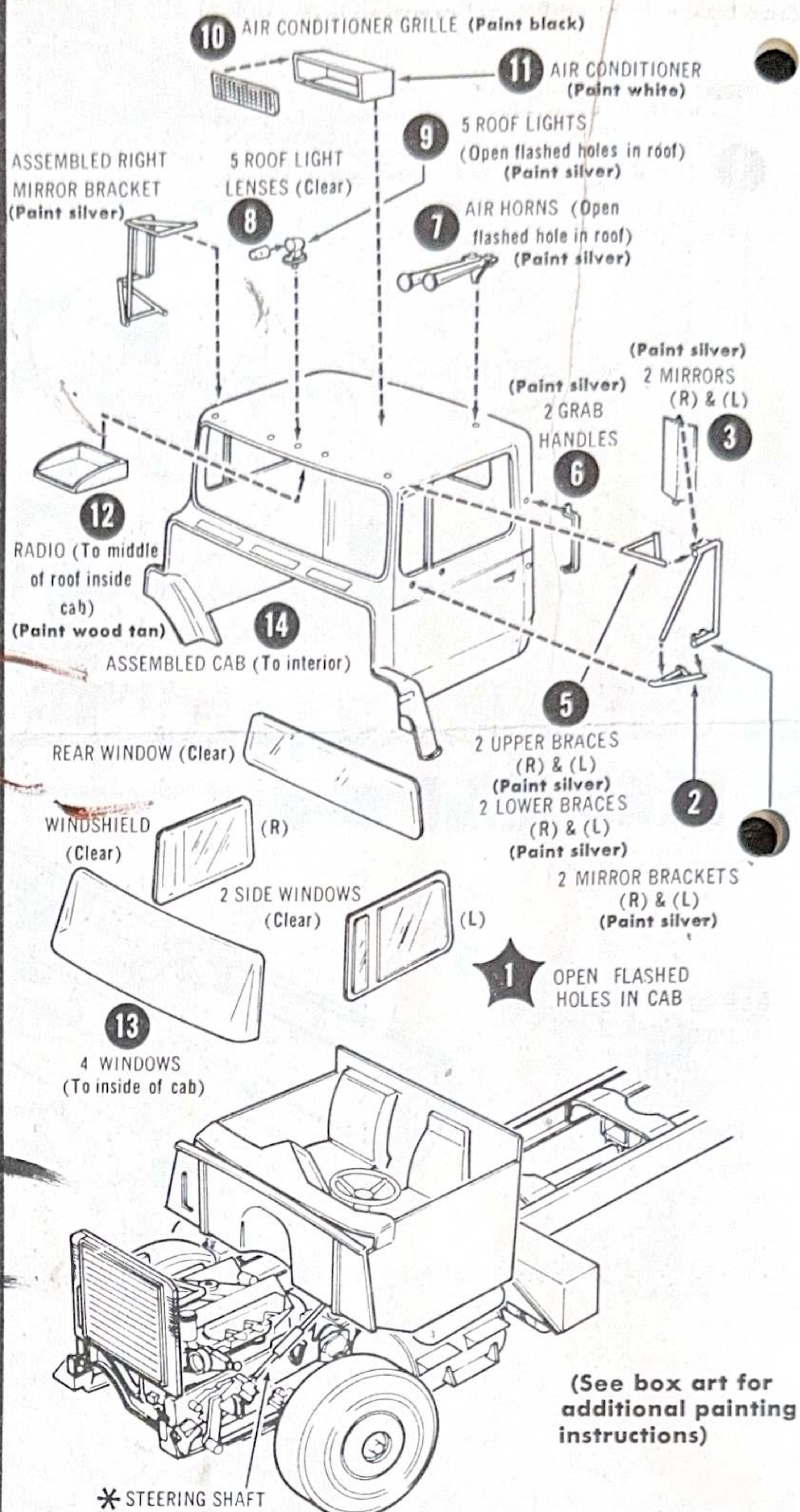

9. EXHAUST SYSTEM 1-2

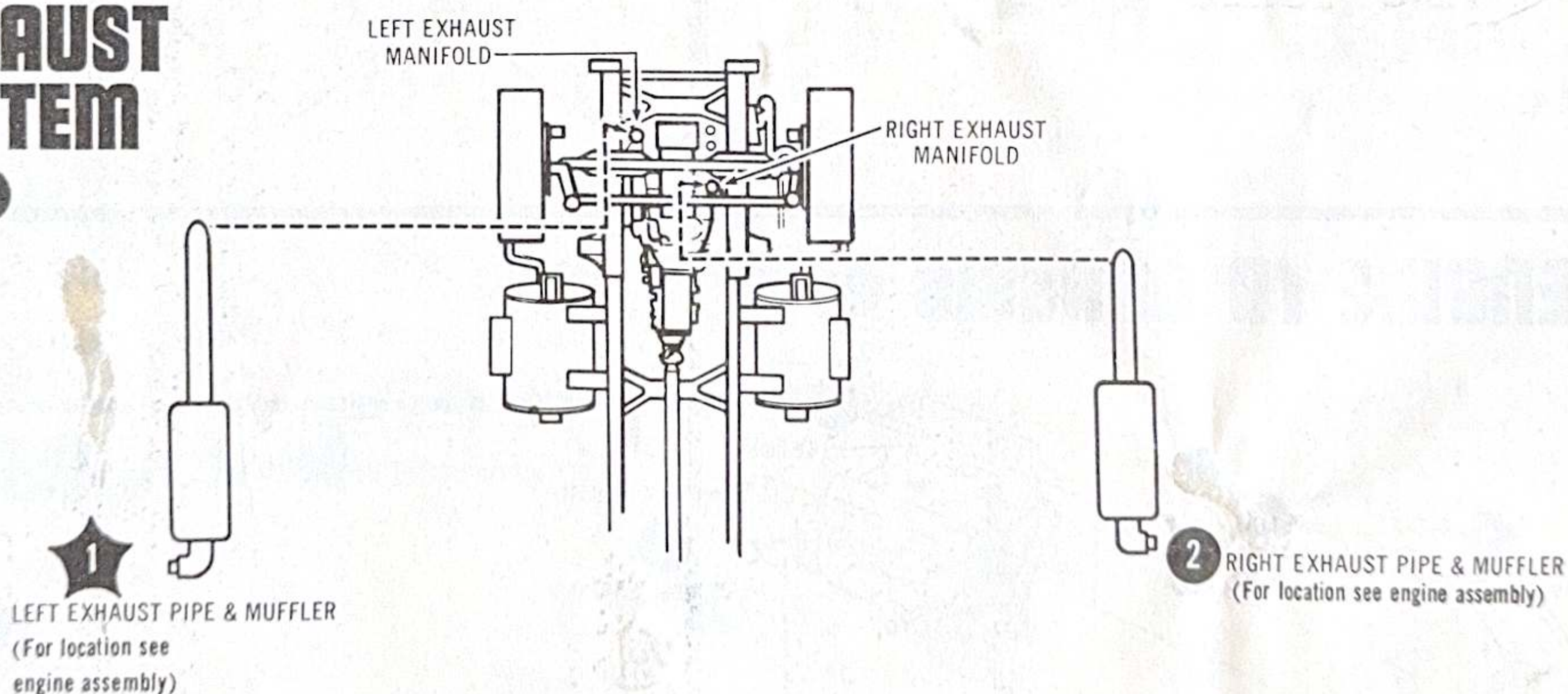

10. HOOD 1-12

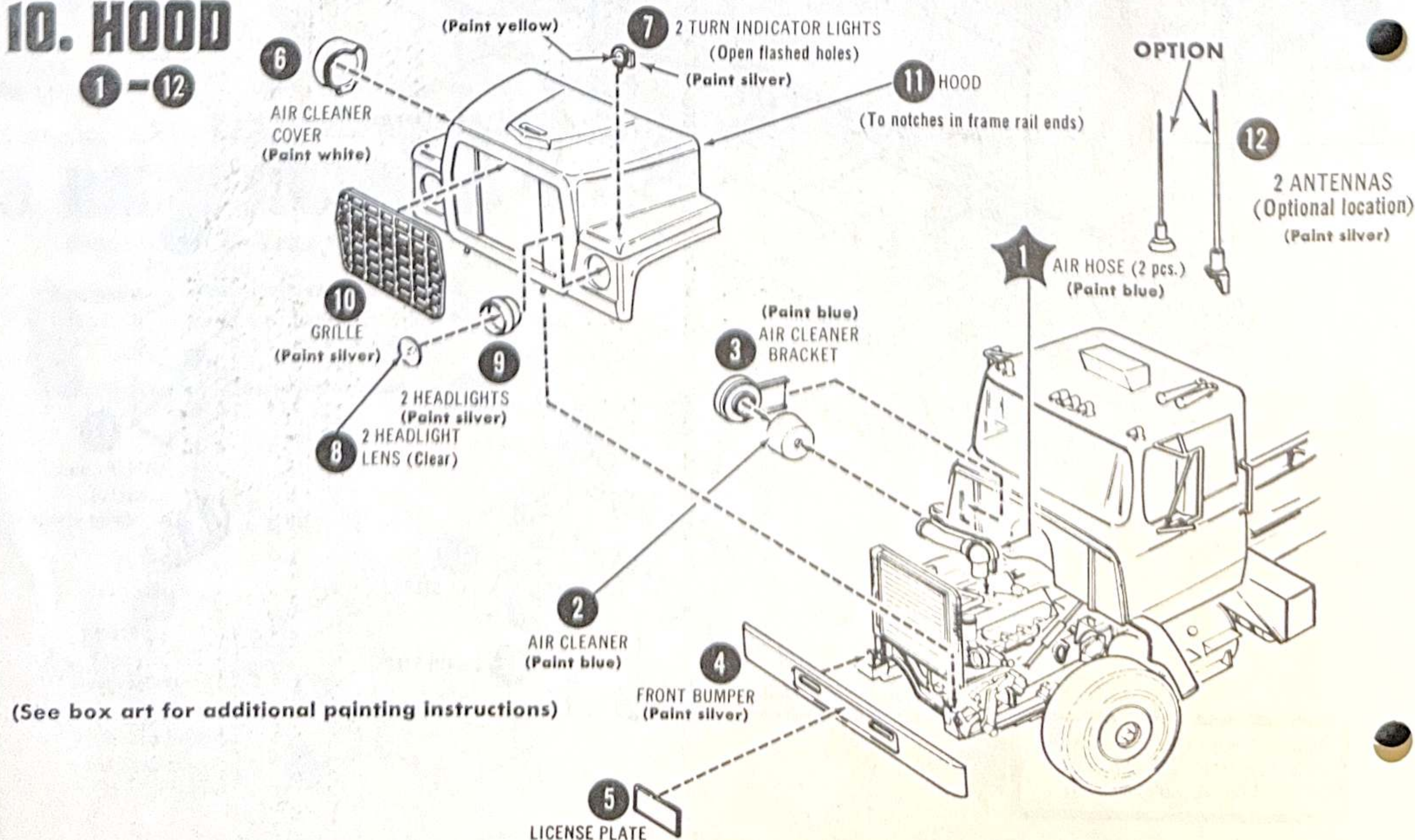

11. VAN ASSEMBLY 1-21

(See box art for additional painting instructions)

"TODCO" REAR ROLLUP DOOR

NOTE: Cut sections along scored lines and sand edges smooth. Install one at a time in rollup door guides. Apply tape to back of door when installation is completed. Tape and sandpaper are not included in this kit.

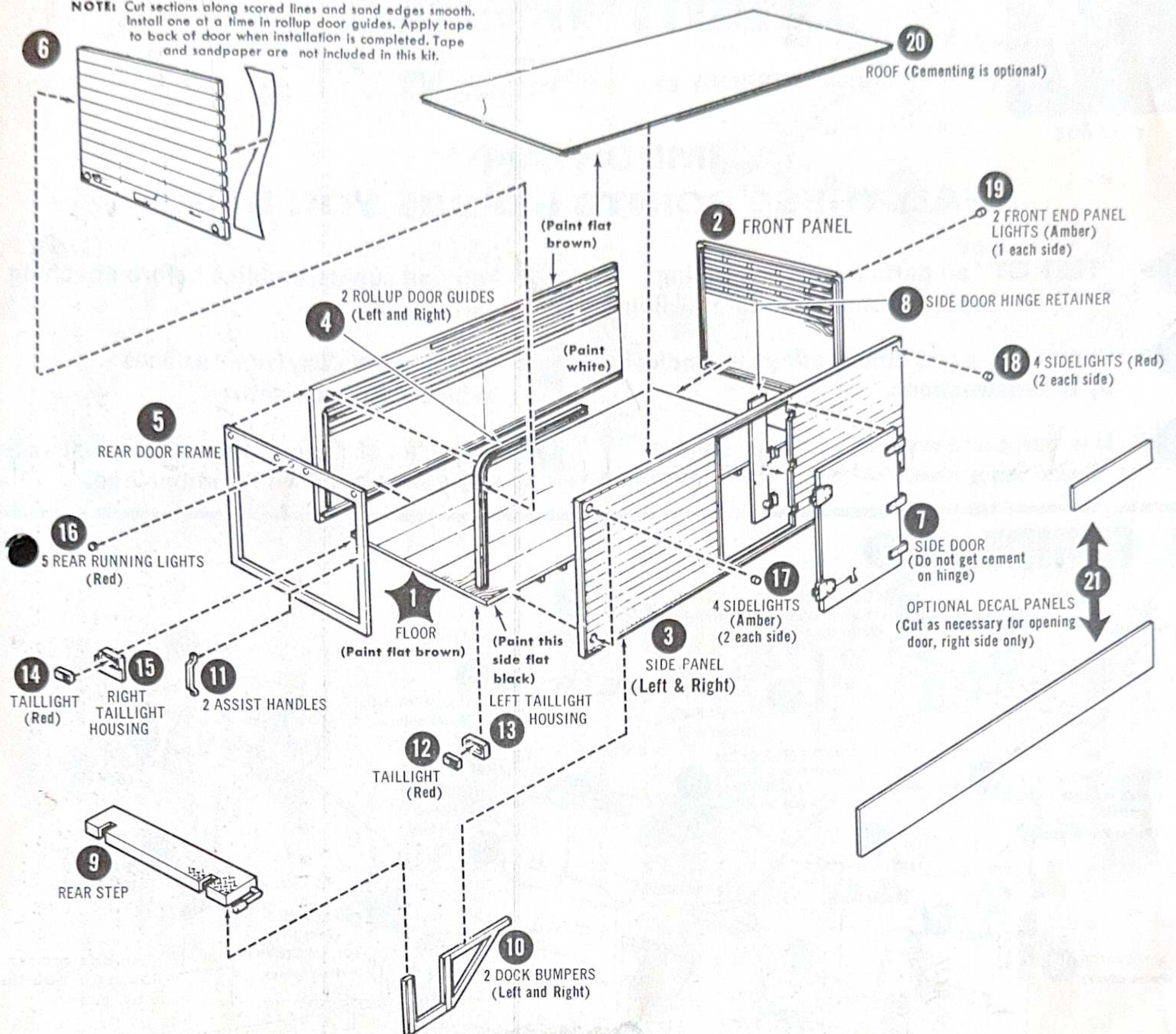

12. LIFT GATE 1-18

(See box art for additional painting instructions)

