

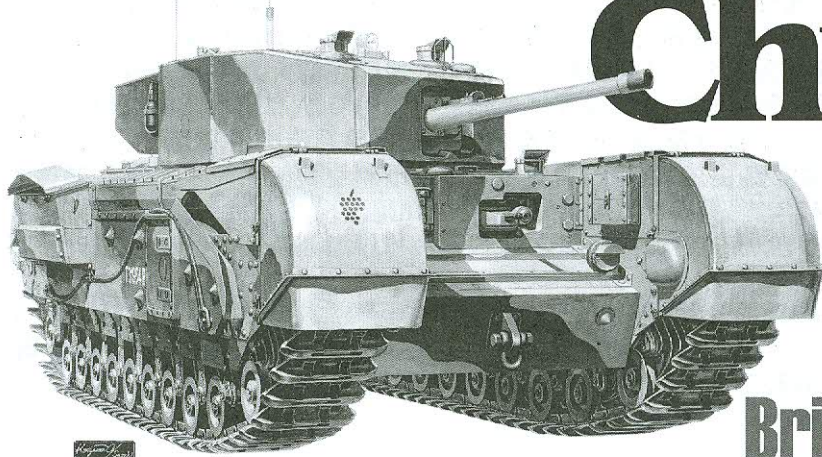

**SPECIAL THANKS: Ossie Orsbourn



Churchill Mk III

British infantry tank

The British tank design concept established in 1930s resulting tanks in three very different aspects: light tanks for reconnaissance, cruiser tanks which were fast and mobile and infantry tanks to accompany infantry to help them break through heavily defended areas in the enemy lines.

Although the Matilda's performance was proven in the Battle of France in 1940, yet its small turret made a heavier gun impossible. Furthermore, its limited off-road speed was never considered satisfied. Designed as the successor of Matilda, a new tank infantry prototype was introduced in November 1940, and the first batch of mass production tanks saw service in June the following year. This series of tanks was named after Winston Churchill, who was appointed First Lord of the Admiralty at that time, due to his contribution to the development of the tank as a weapon. As an infantry tank, the Churchill features with heavy armours and reliable suspension systems, equipped with 11 bogies each side, dispersing ground pressure. Initial Mk.I equipped with a 2 pounder gun in the cast turret, also a 3 inch howitzer in the hull. Nevertheless, the 3 inch howitzer was limited by a poor fire arc, therefore was replaced with a 7.92 mm machine gun on Mk.II. The Mk. III was introduced in February 1942, came with a larger welded turret and a upgraded 6 pounder gun. By April, new Mk.III's came with new pattern tracks covered on the top run and new air intakes which improving its fording capability.

The Mk.III's saw actions in North Africa and Italy with the British Army, and the Soviet Union received some 300 Churchill tanks as part of the Lend-Lease program, some of them participated in Battle of Kursk. Probably the most action that the Churchill III's have participated in was the disastrous Dieppe Raid in August, 1942. Yet lessons learned at Dieppe in 1942 were put to good use later in the war, especially Operation Overlord.

イギリス陸軍の戦車設計の方針は1930年代に、まったく異なる用途の3種類の戦車によって確立された。すなわち、偵察用の軽戦車、機動性と速度を重視した巡航戦車、そして歩兵に同行し、彼らの敵陣突破を助ける歩兵戦車の3種であった。

1940年のフランス戦において、マチルダ歩兵戦車の問題点が浮き彫りになった。小さな砲塔は大口徑の火砲の搭載ができず、さらに路外速度の低さは到底納得できるものではなかったのである。

マチルダ戦車の後継となる新型歩兵戦車の試作型は、1940年11月に完成し、最初の量産型は、翌年の6月に配備がはじまった。この新型歩兵戦車シリーズは、海軍大臣時代に戦車を兵器として開発することに貢献したウィンストン・チャーチルにちなんで、チャーチル歩兵戦車と名づけられた。

歩兵戦車としてのチャーチル戦車の特徴は、重装甲と信頼性の高いサスペンション(両側面の11個のボギーで接地圧を分散させる)であった。最初の生産型のMk. Iは鑄造砲塔に2ポンド砲を搭載し、車体には3インチ榴弾砲を装備していた。しかし、3インチ榴弾砲は威力に乏しかったため、次のMk. IIでは、7.92mm機銃に取って代わられた。Mk. IIIは、1942年2月に登場、溶接タイプの大型砲塔に性能の向上した6ポンド砲を装備していた。さらに4月までに、新パターンのキャタピラを履き、足回りの接地面以外を重装甲で覆い、新しい空気取り入れ口を採用することで、渡渉能力を向上させた新型Mk. IIIが導入された。

チャーチルMK. IIIは、イギリス軍とともに北アフリカ、イタリアで戦い、またレンドリース法によって、約300輛のチャーチル戦車がソビエト軍に供与され、その一部は、クルスク戦に投入されている。恐らく、最も大量にチャーチルMk. IIIが参加した戦闘は、英軍の惨敗に終わった1942年8月のディエップ上陸作戦であろう。連合軍は、このディエップでの戦いで得た教訓をその後の戦闘に生かし、特にオーバーロード作戦を成功に導いていったのであった。

在1930年代,英國的戰車運用理論中確立了戰車的三種截然不同角色,包括了執行偵查任務的輕戰車、能夠快速突破擴大戰果的巡航戰車,與伴隨步兵能提供步兵火力支援,並清除障礙與工事的步兵戰車。

經過了1940年的法國戰役後,儘管參與戰役的Matilda步兵戰車面對德國戰車有著傑出的表現,但過小的砲塔環限制了將來提升火炮口徑可能,另外它過於緩慢的越野性能也未能讓人滿意。因此英國政府委託設計一種新的步兵戰車用來取代Matilda步兵戰車。1940年的11月新型步兵戰車的試作車完成,1941年6月第一批量產車進入陸軍服役,由於當時的英國首相邱吉爾在擔任海軍大臣期間對戰車這種新武器開發的大力支持,為表彰他的貢獻,因此新的步兵戰車遂命以邱吉爾之名。邱吉爾步兵戰車延續著步兵戰車既有的特點,有著厚重的裝甲與可靠的懸吊系統,車身兩側每側均有11組承載輪以分散接地壓,最初的量產車Mk.I型採用鑄造砲塔,砲塔上安裝一門2磅主砲,車身前方同時也配置一門3吋口徑的榴彈砲,由於3吋砲的射界受車體的限制使得使用效率不佳,在隨後的Mk.II型當中便被7.92mm的機槍所取代。1942年2月更換大型焊接砲塔的Mk.III型出現,主要武裝也提升至6磅砲,及至4月,新生產的Mk.III型車體將接地以外的大部履帶包覆在裝甲之下,並藉由引擎進氣系統的改良,也提升了車體的涉水能力。

Mk.III隨英軍布署在北非及義大利戰場;在英國軍援蘇聯的清單中邱吉爾步兵戰車的數量亦達300輛之譜,其後部分戰車並參與了庫斯克戰役;1942年8月,邱吉爾Mk.III參加對法國北部港口第厄普(Dieppe)的一次登陸作戰,雖然登陸行動以失敗收場,但卻為日後諾曼地登陸的成功提供了許多寶貴的經驗與教訓。

Illustration:圖示說明



Method For Applying Decals:

1. Clean Model Surface With Wet Cloth.
2. Cut Out Of Decal Sheet And Dip Them In Water For 15 Seconds.
3. Place it on proper position on model.
4. Slide off base paper leaving decals On Model With Wet Finger Tip.
5. Move Decals To Exact Position, Push Out Excess Water Under Decal With Soft Cotton Cloth.
6. When Decals Get Dry Then Complete.

水貼紙使用說明:

1. 將模型表面擦乾淨
2. 將貼紙剪下泡入清水中約15秒
3. 將泡濕之貼紙取出置於欲貼處旁
4. 用指尖輕推貼紙表面使其滑出底紙
5. 將貼紙調整至適當位置並輕擦拭水份
6. 待其自然乾燥後即完成

Color list: 塗料表

Color	Brand	Gunze Sangyo			Humbrol	Revell	Life Color
		Hobby Color	Mr. Color	Mr. Color Spray			
Khaki green	卡其綠	H-80	C-54				
Sandy Yellow	沙黃	H-66	C-119		168	UA020	
Steel	黑鐵	H-18	C-28	J-28	53	91	LC76
Tire black	輪胎黑	H-77	C-33+C-62		85	302	LC02
Red	紅	H-3	C-3	J-3	19	31	LC56
Flat white	消光白	H-11	C-62	J-62	34	05	LC01
Red brown	紅褐	H-47	C-41	J-44	160	383	UA085
Brass	黃銅	H-9	C-9	J-9	54	92	LC75
Wood brown	木棕	H-37	C-43	J-43	10	81	UA085/ UA125
Olive drab(2)	橄欖綠	H-78	C-38	J-38	66	46	UA106

Churchill Infantry Tank

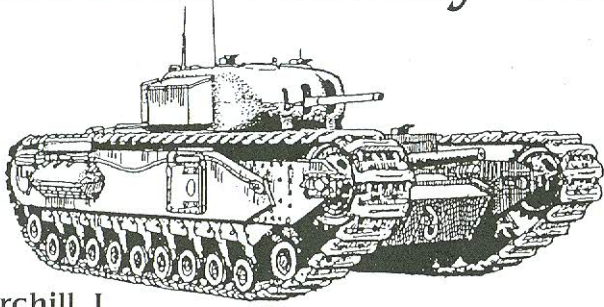

Churchill I
2-pdr gun x 1
3 inch howitzer x 1

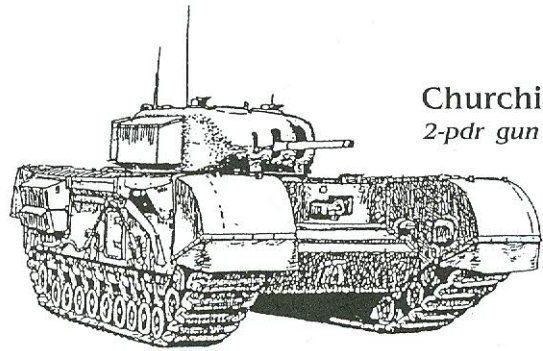

Churchill II
2-pdr gun x 1

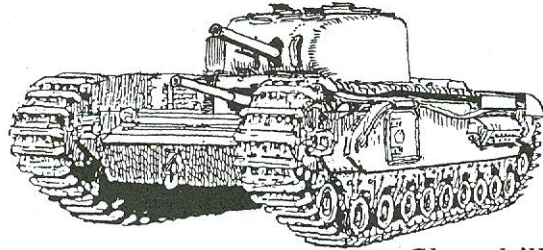

Churchill II CS
3 inch howitzer x 1
2-pdr gun x 1

**3 inch howitzer in turret, 2-pdr in hull. Few built.

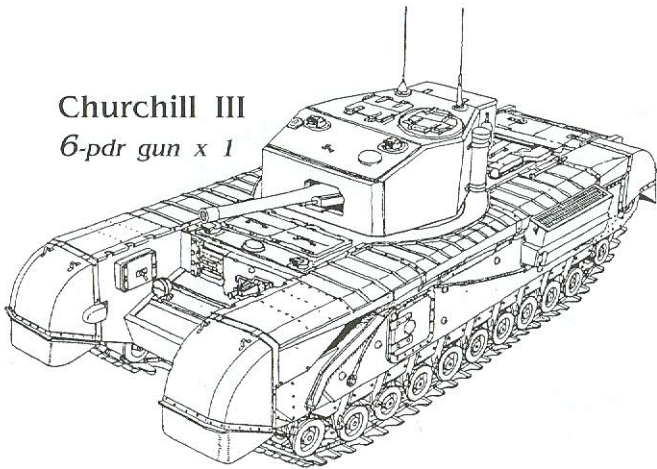

Churchill III
6-pdr gun x 1

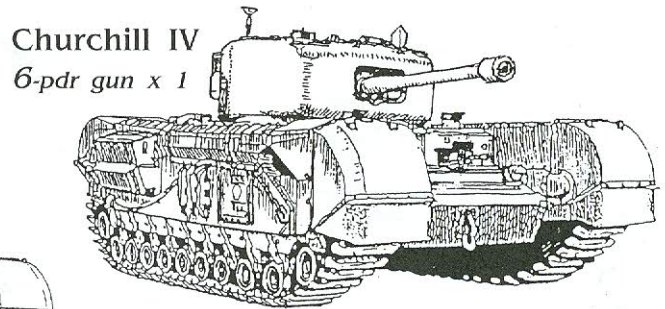

Churchill IV
6-pdr gun x 1

Box Section Spudded

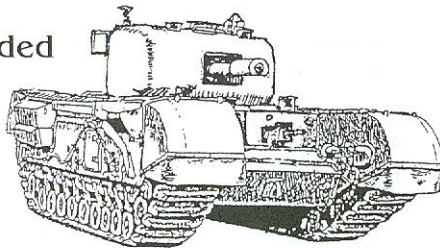
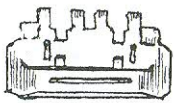

Churchill V
95mm howitzer x 1



Webbed & Studded

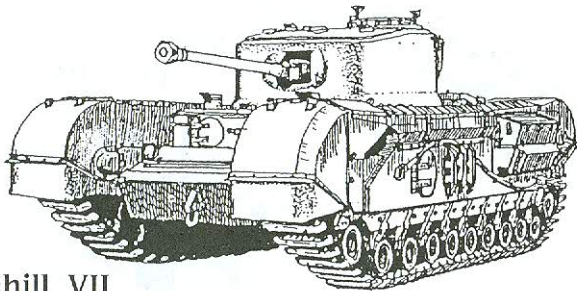

Churchill VII
75mm gun x 1

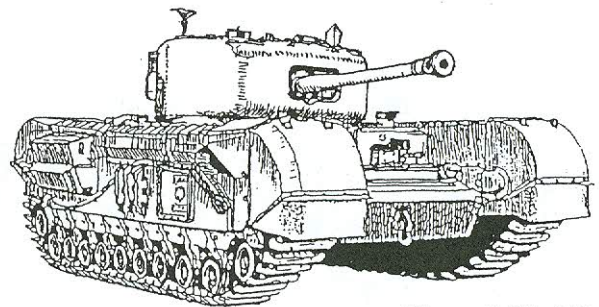

Churchill VI
75mm gun x 1

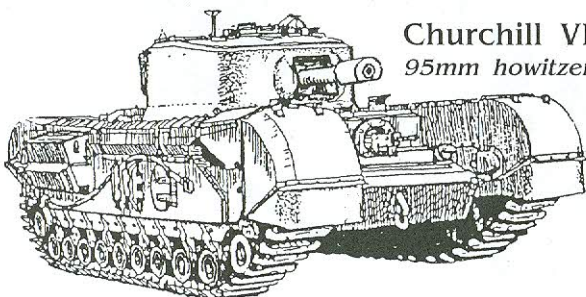

Churchill VIII
95mm howitzer x 1

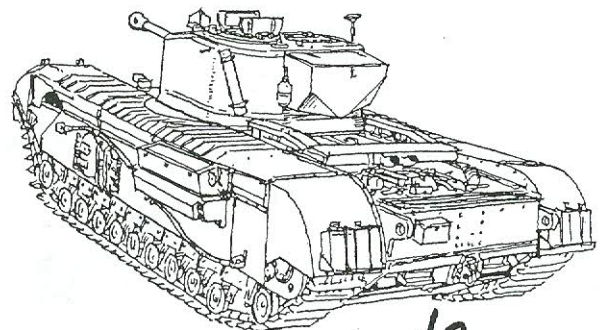

Shin. Ueda

上田 信

1

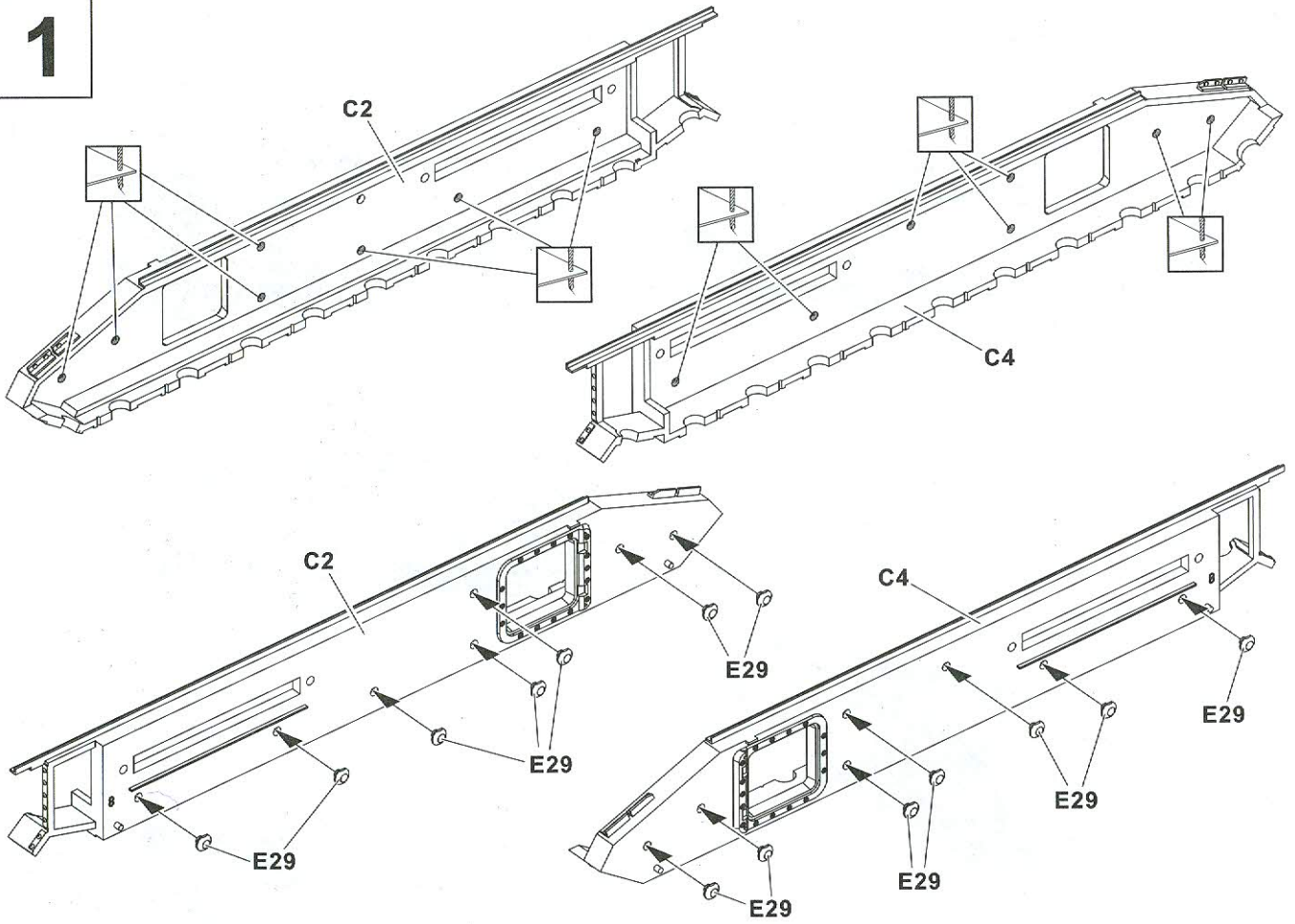

2

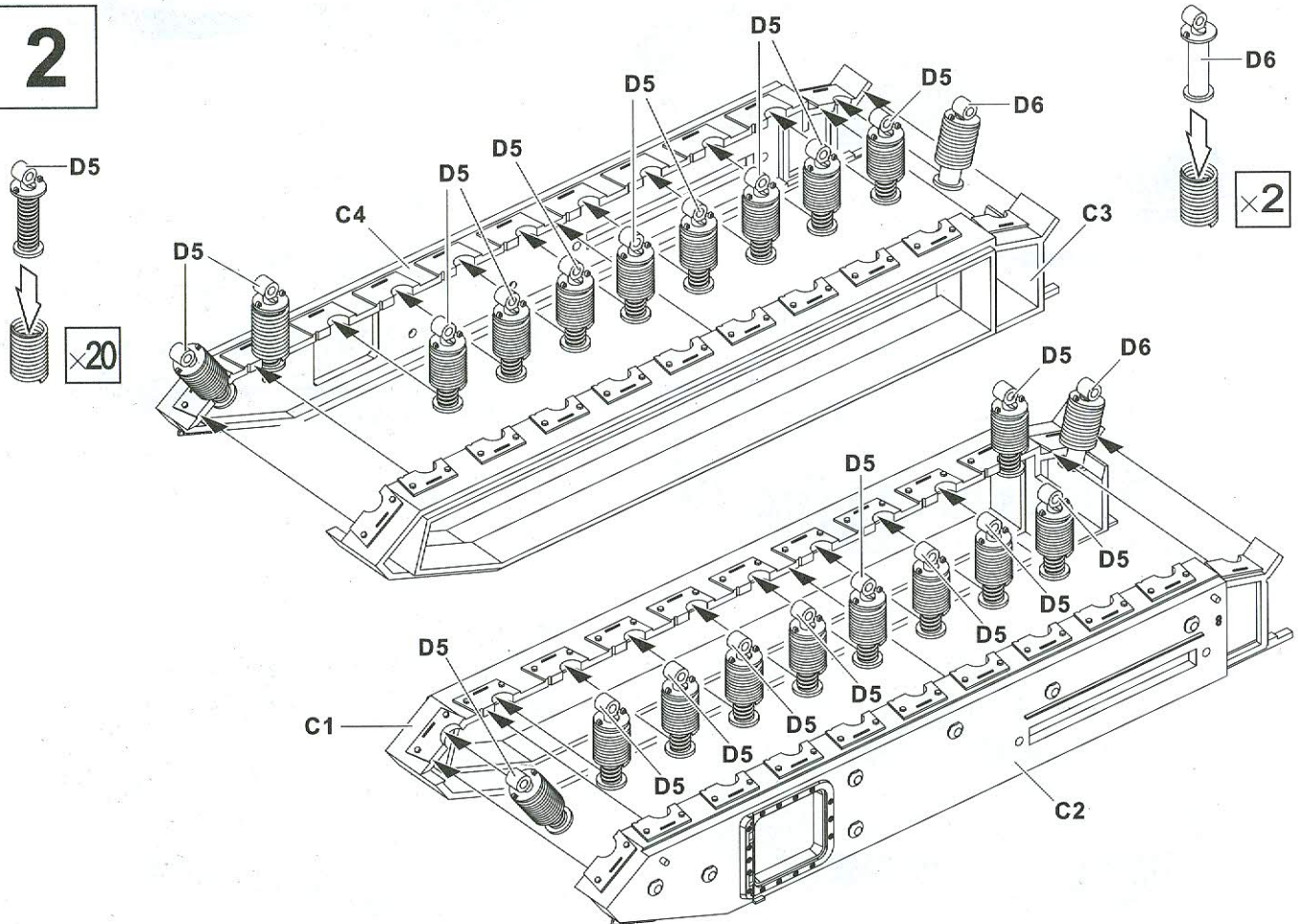

3

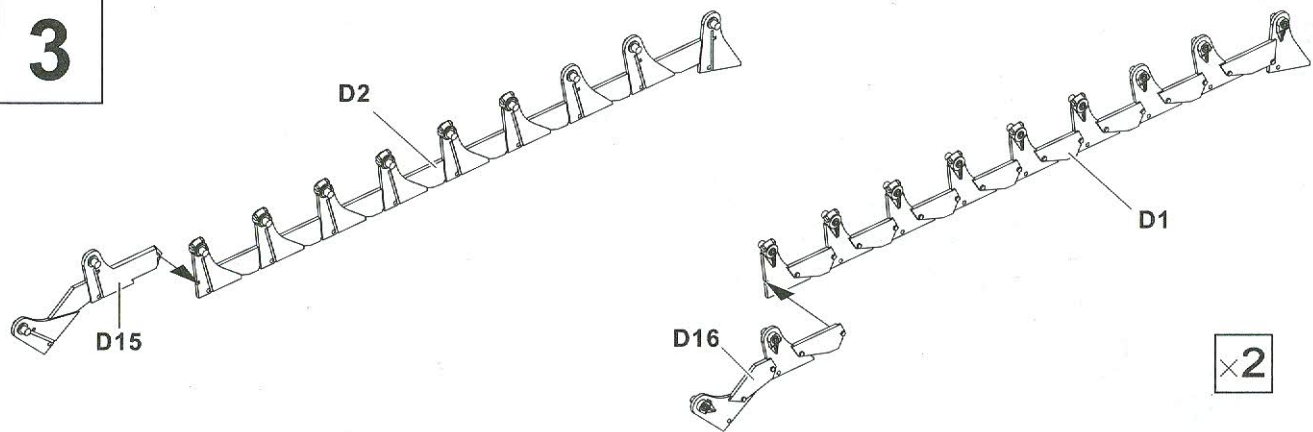

4

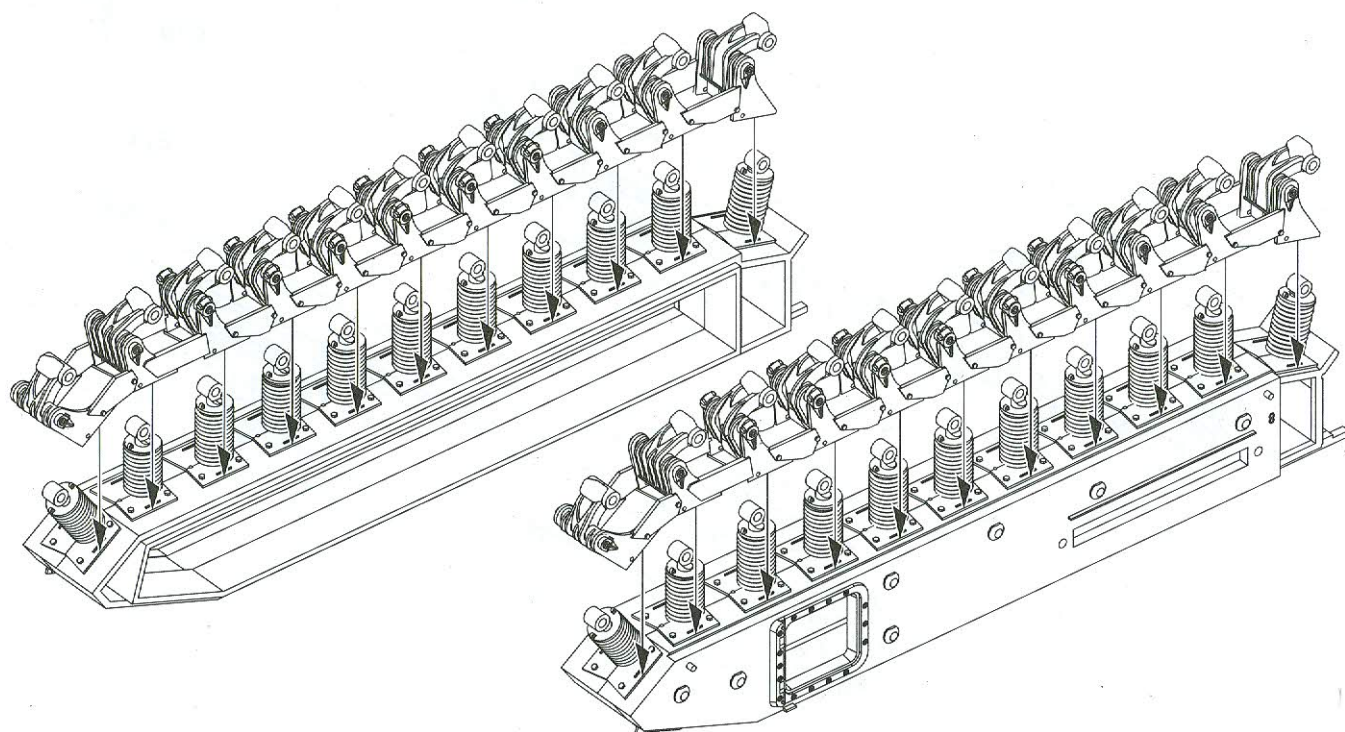
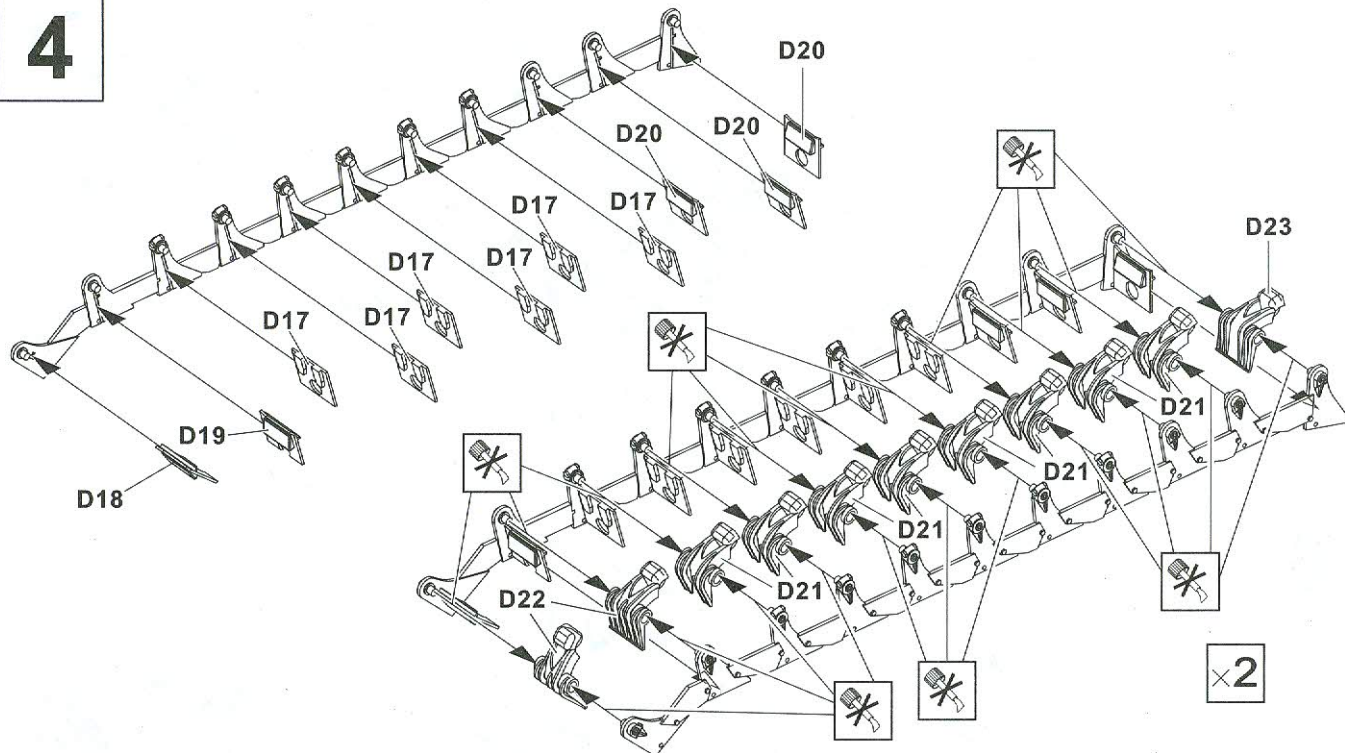

5

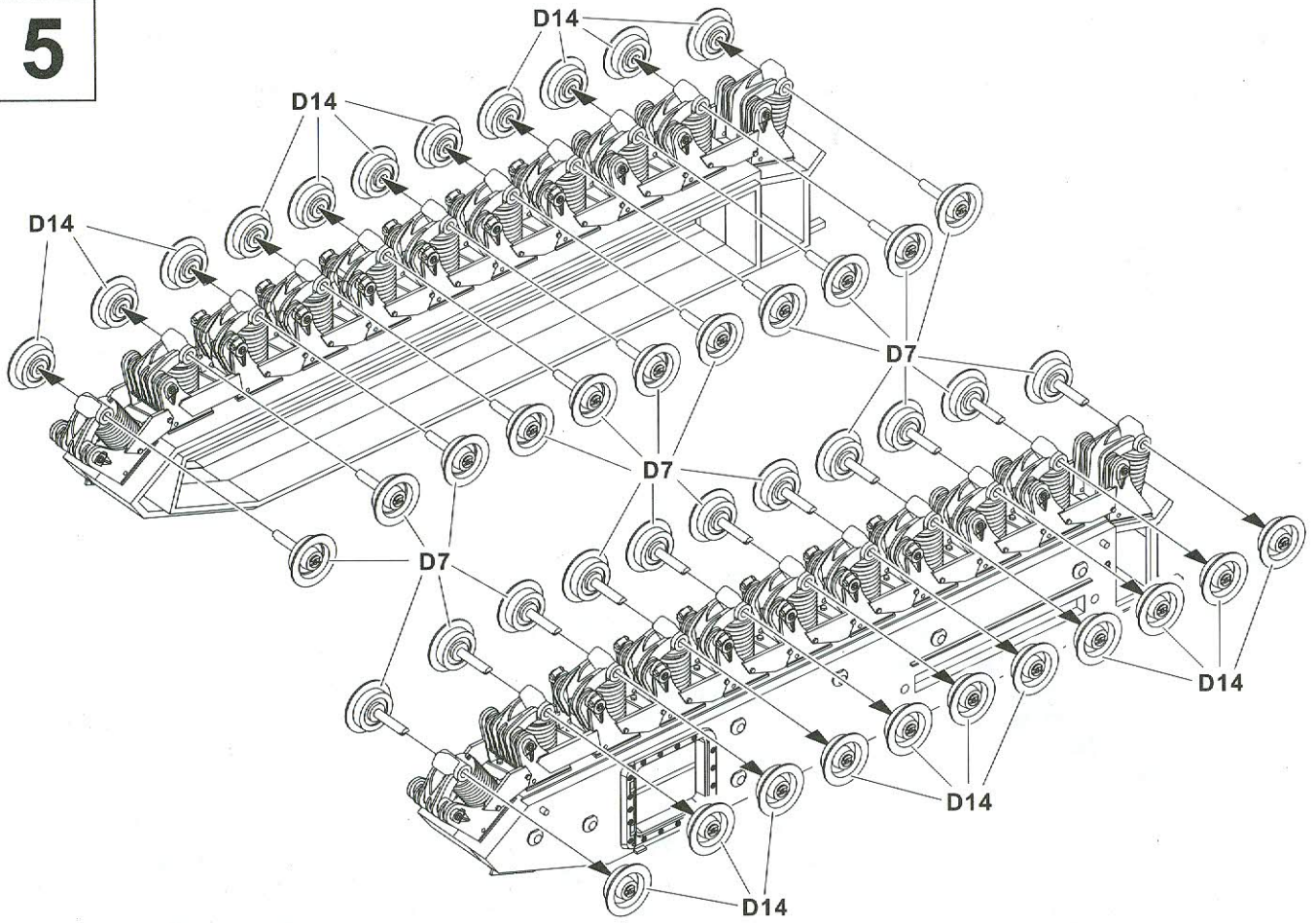

6

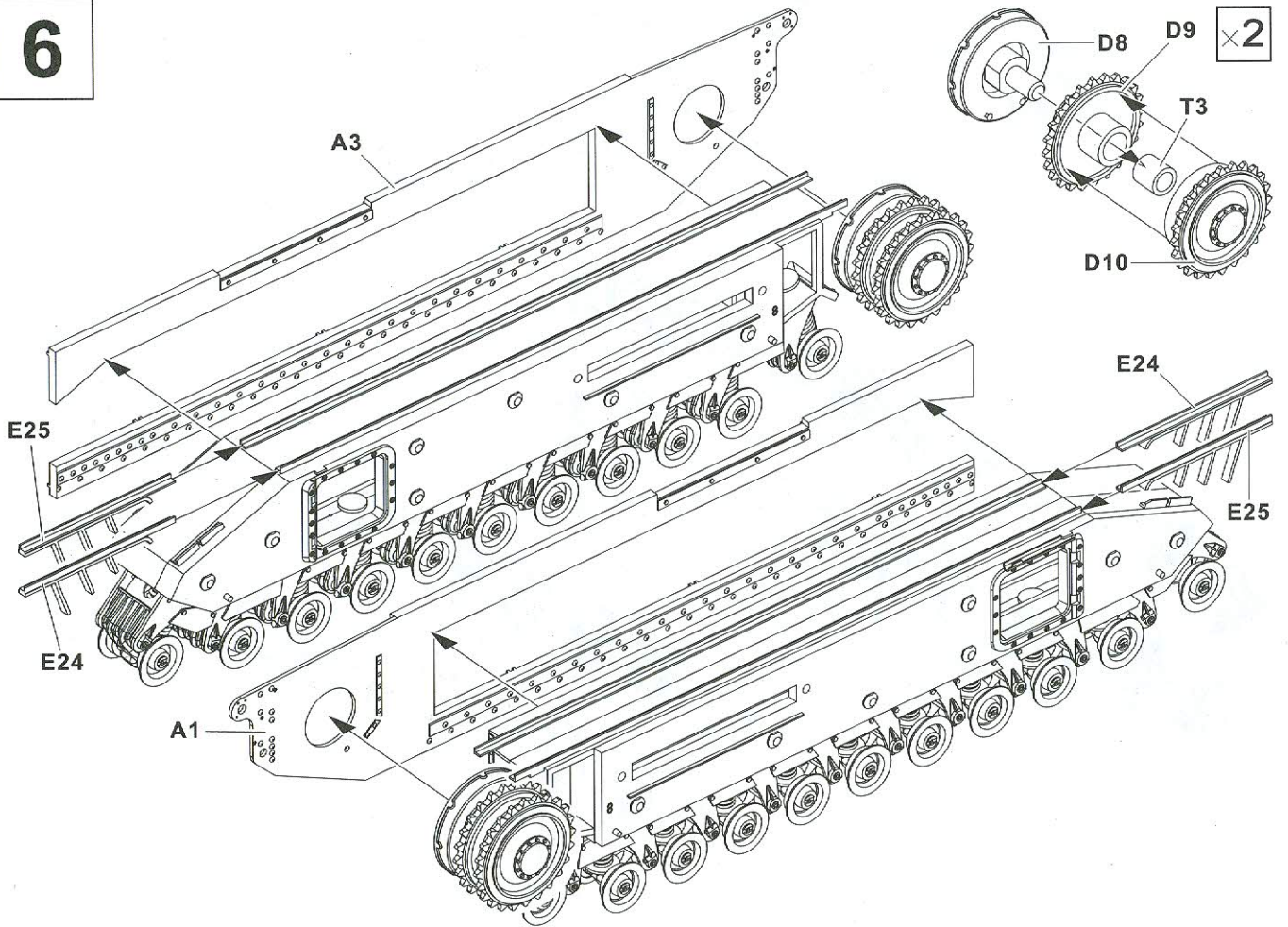

7

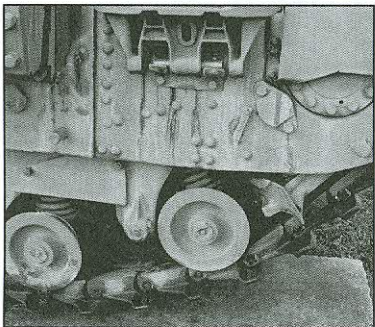
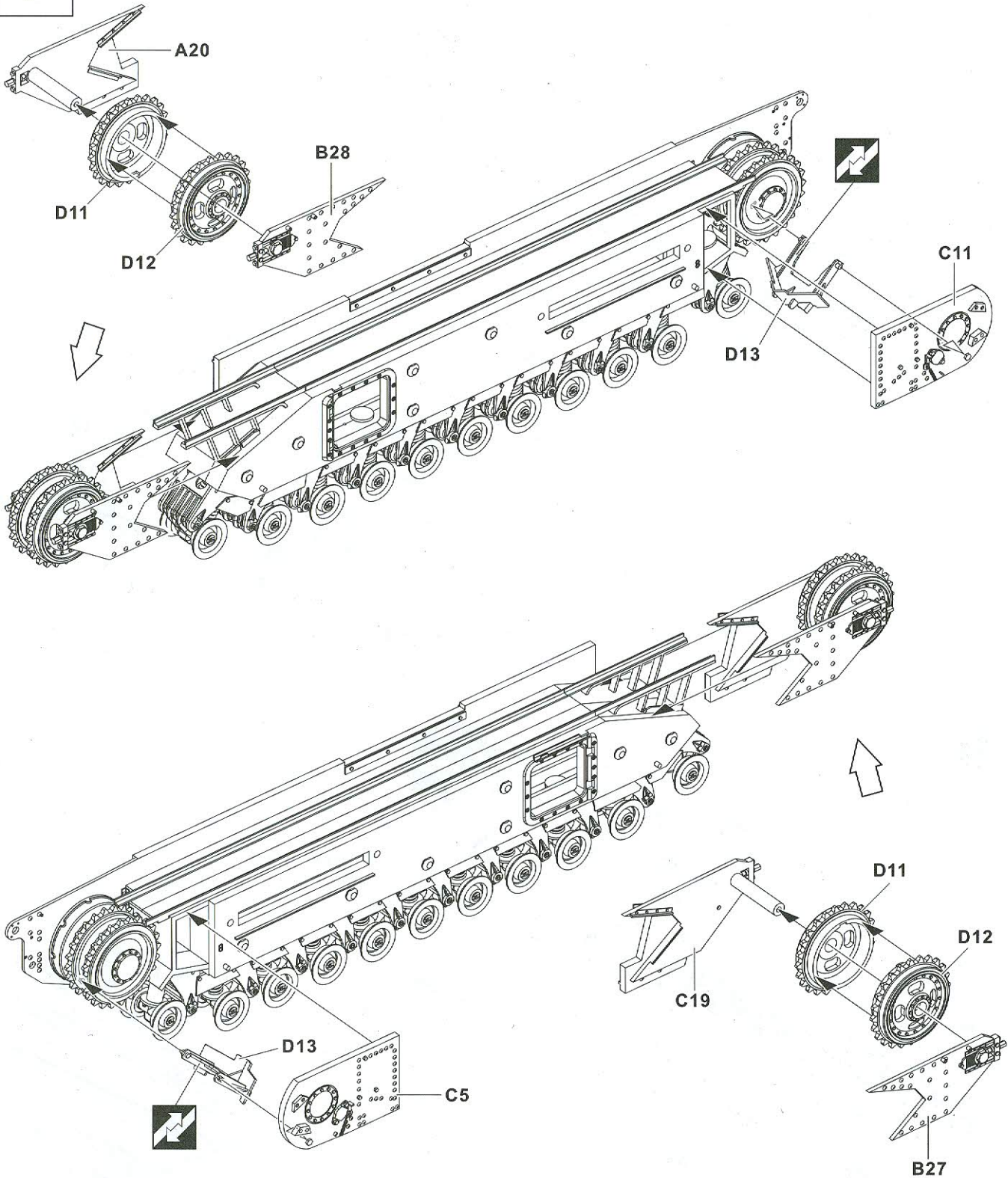

8

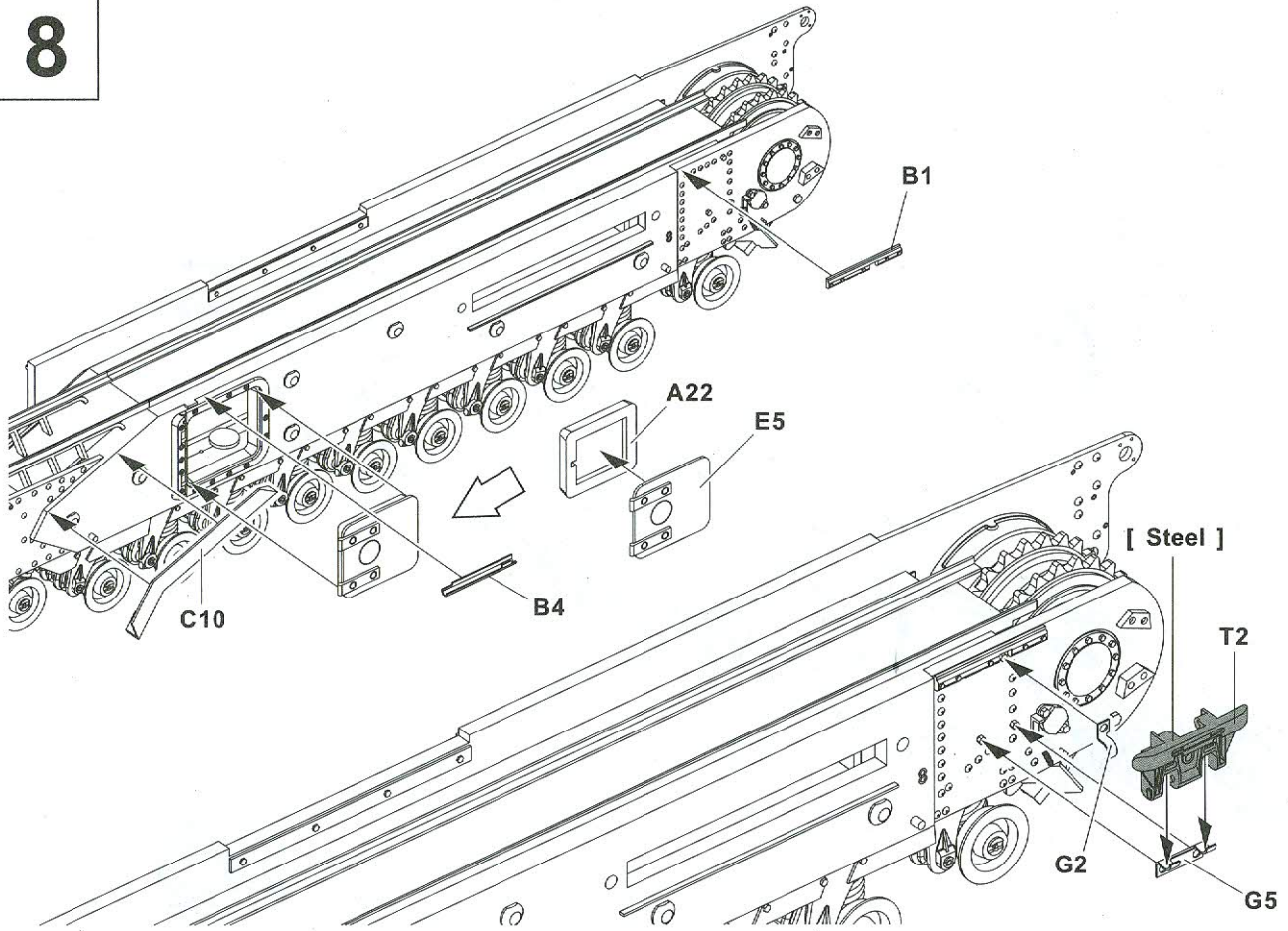

9

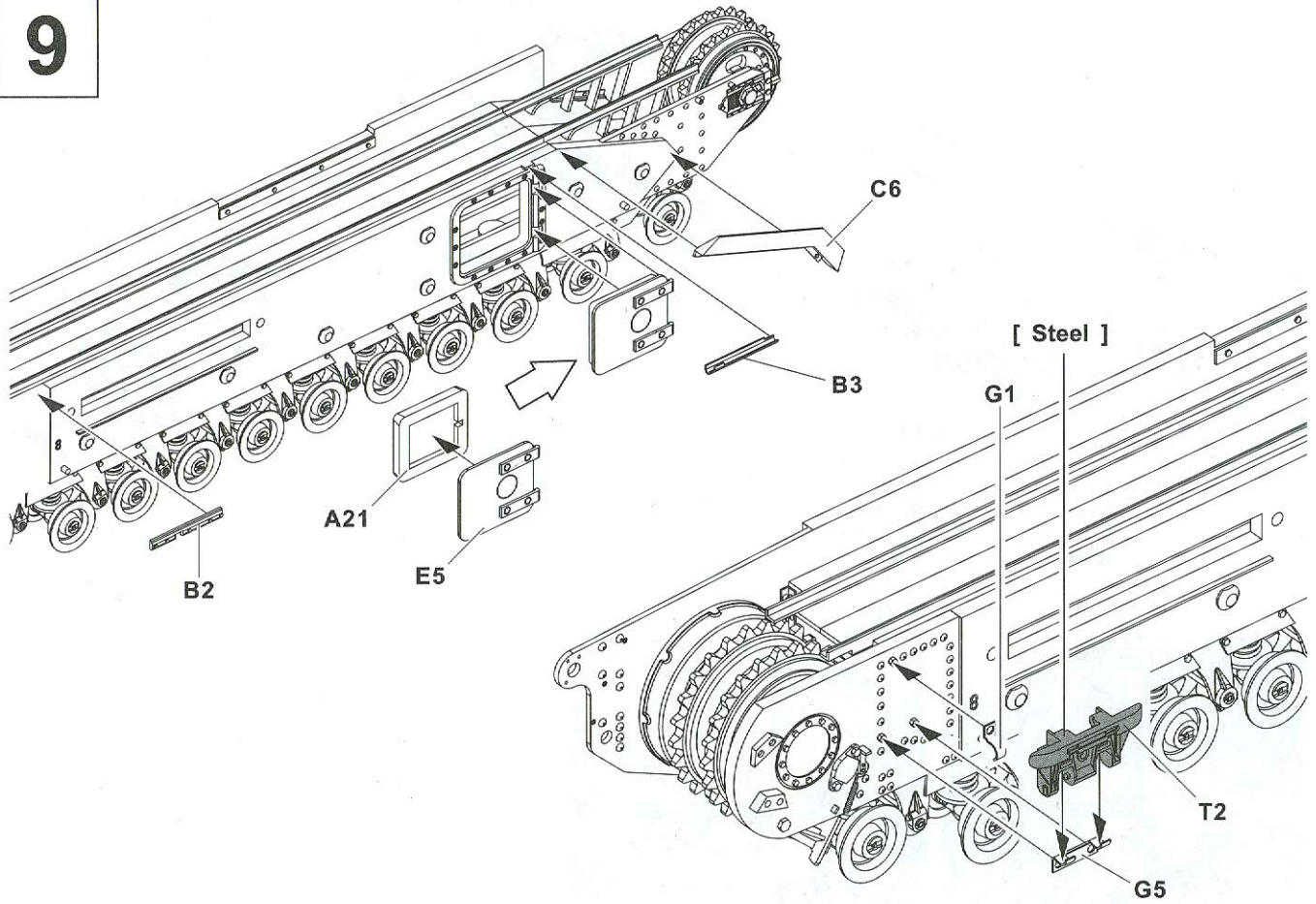

10

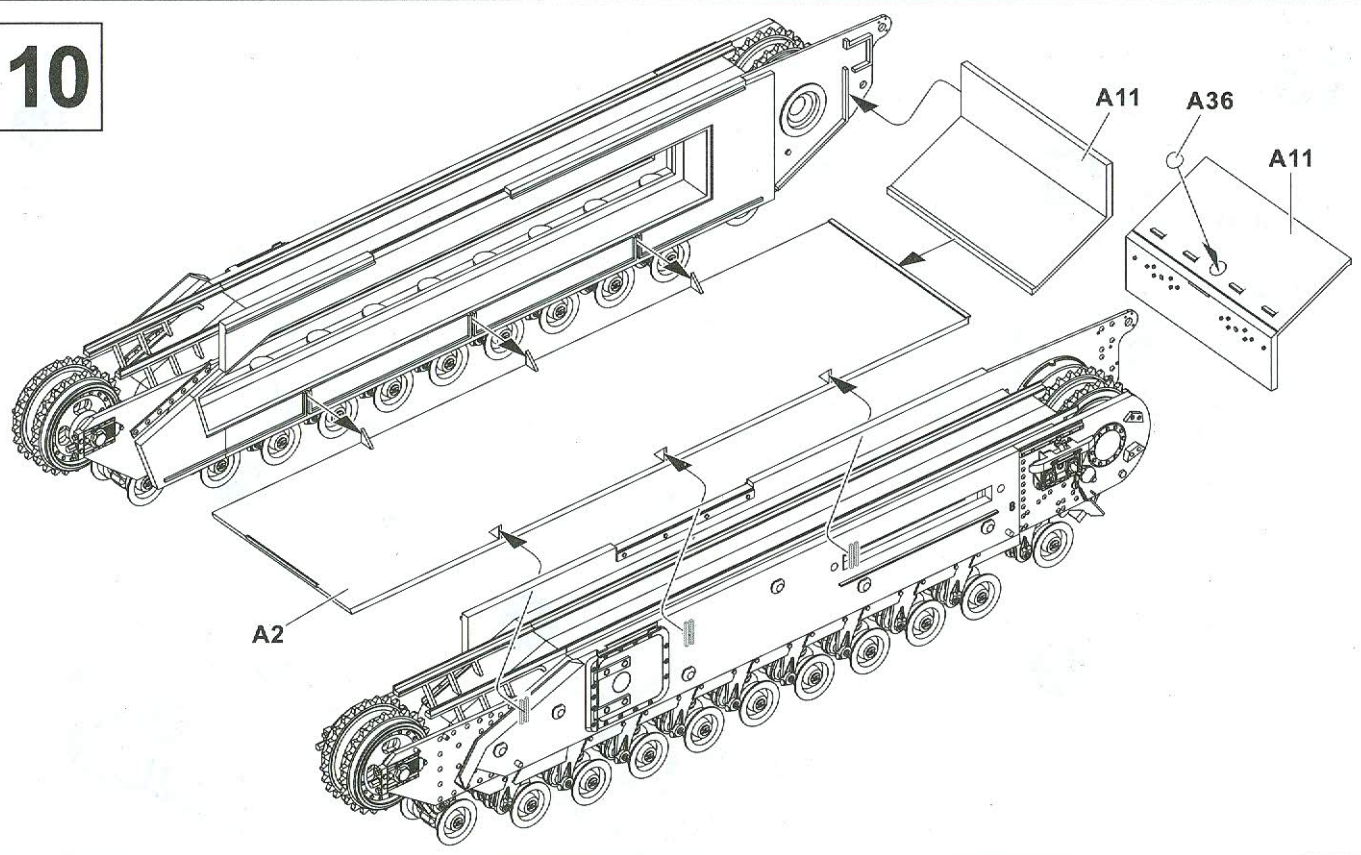

11

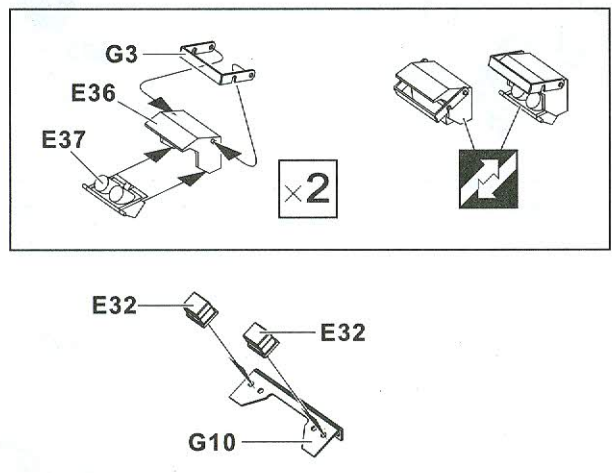

12

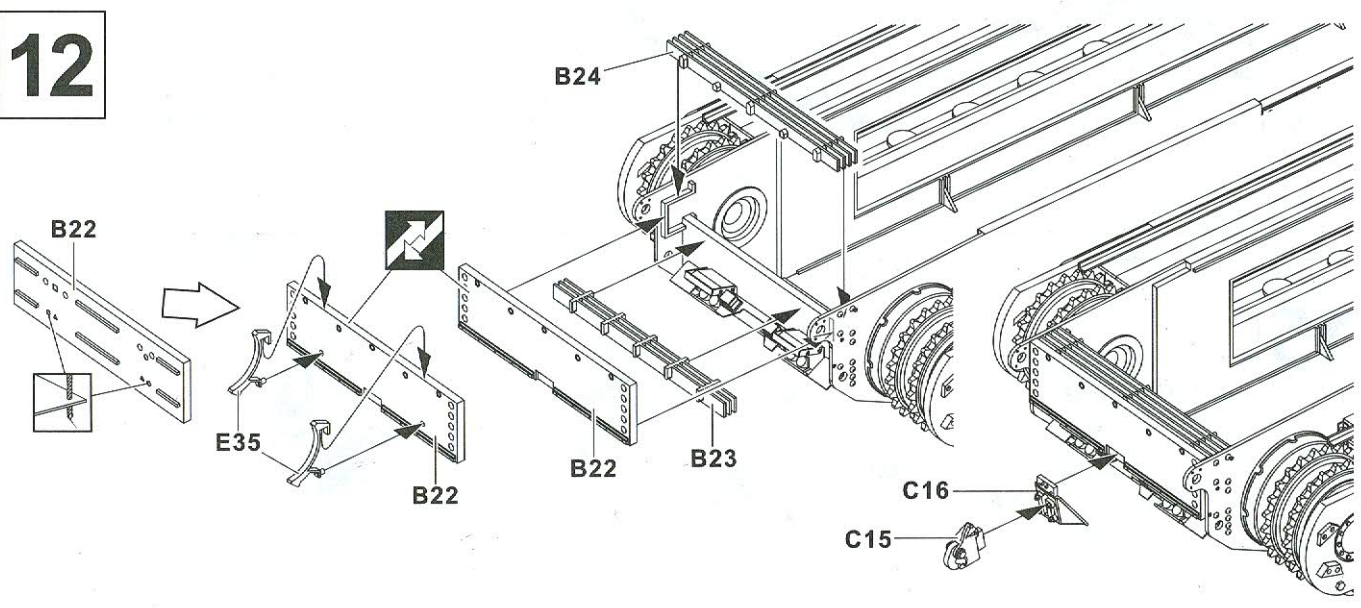

13

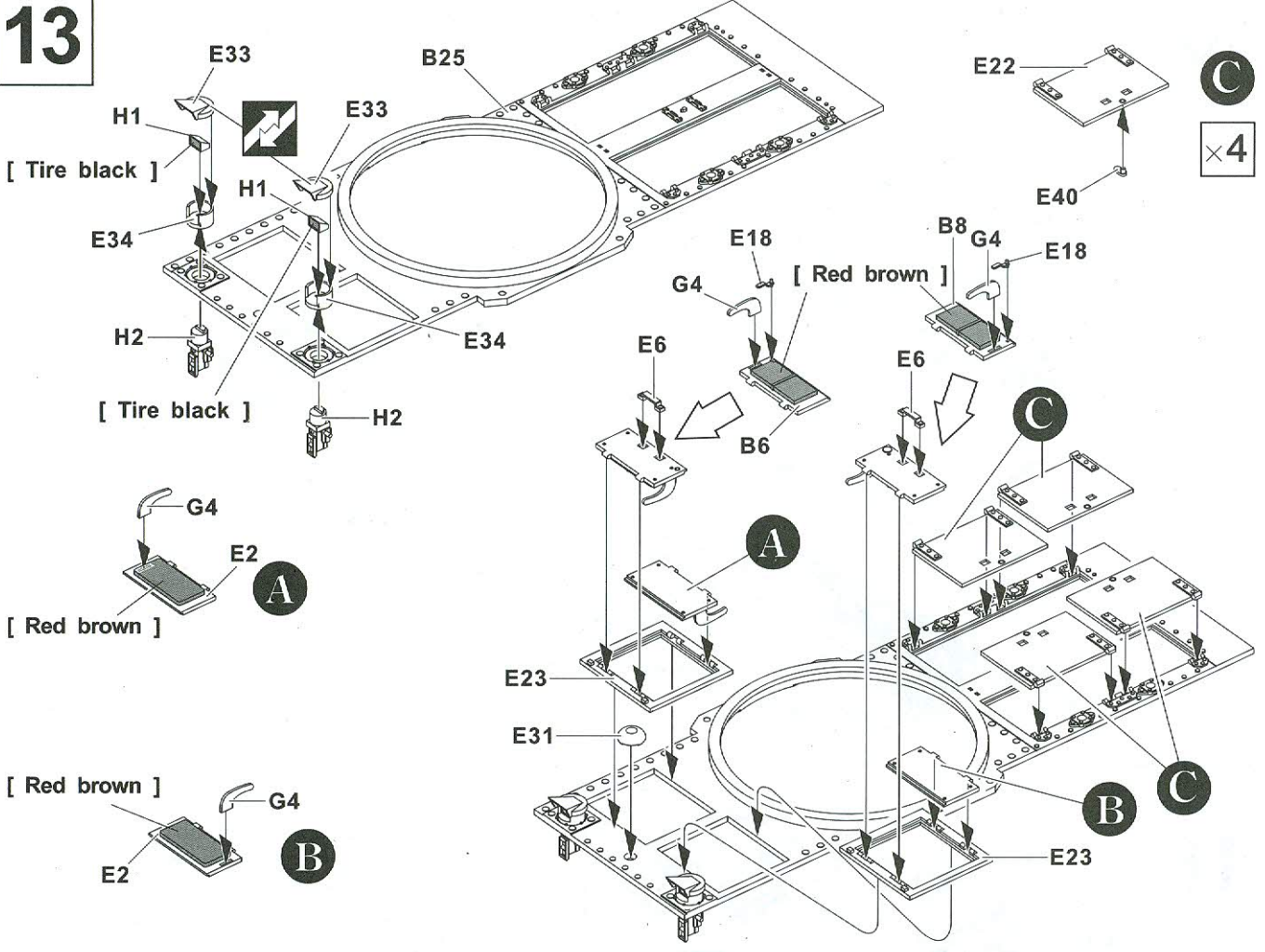

14

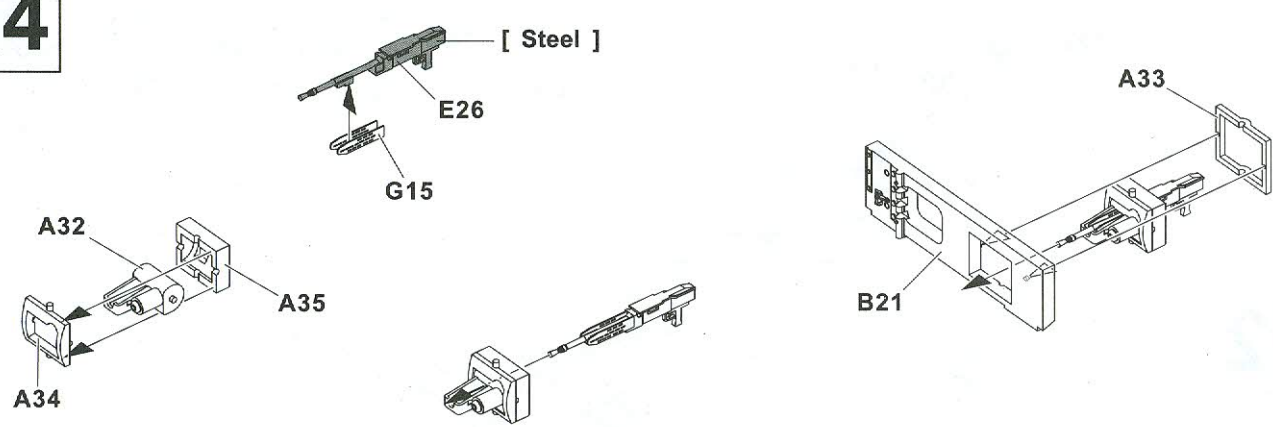

15

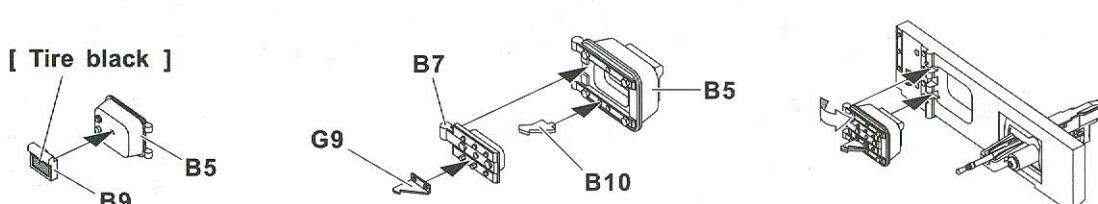

16

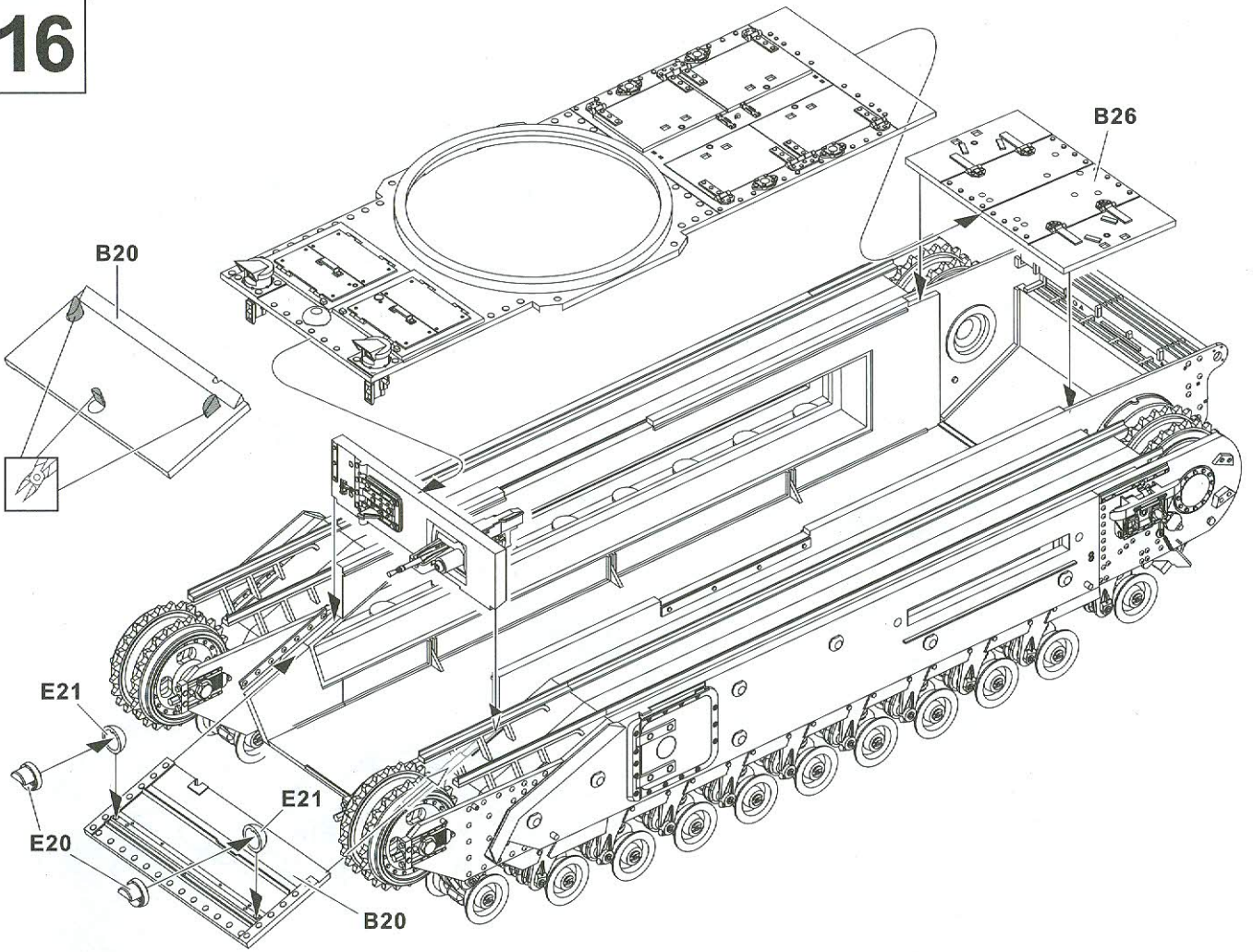

17

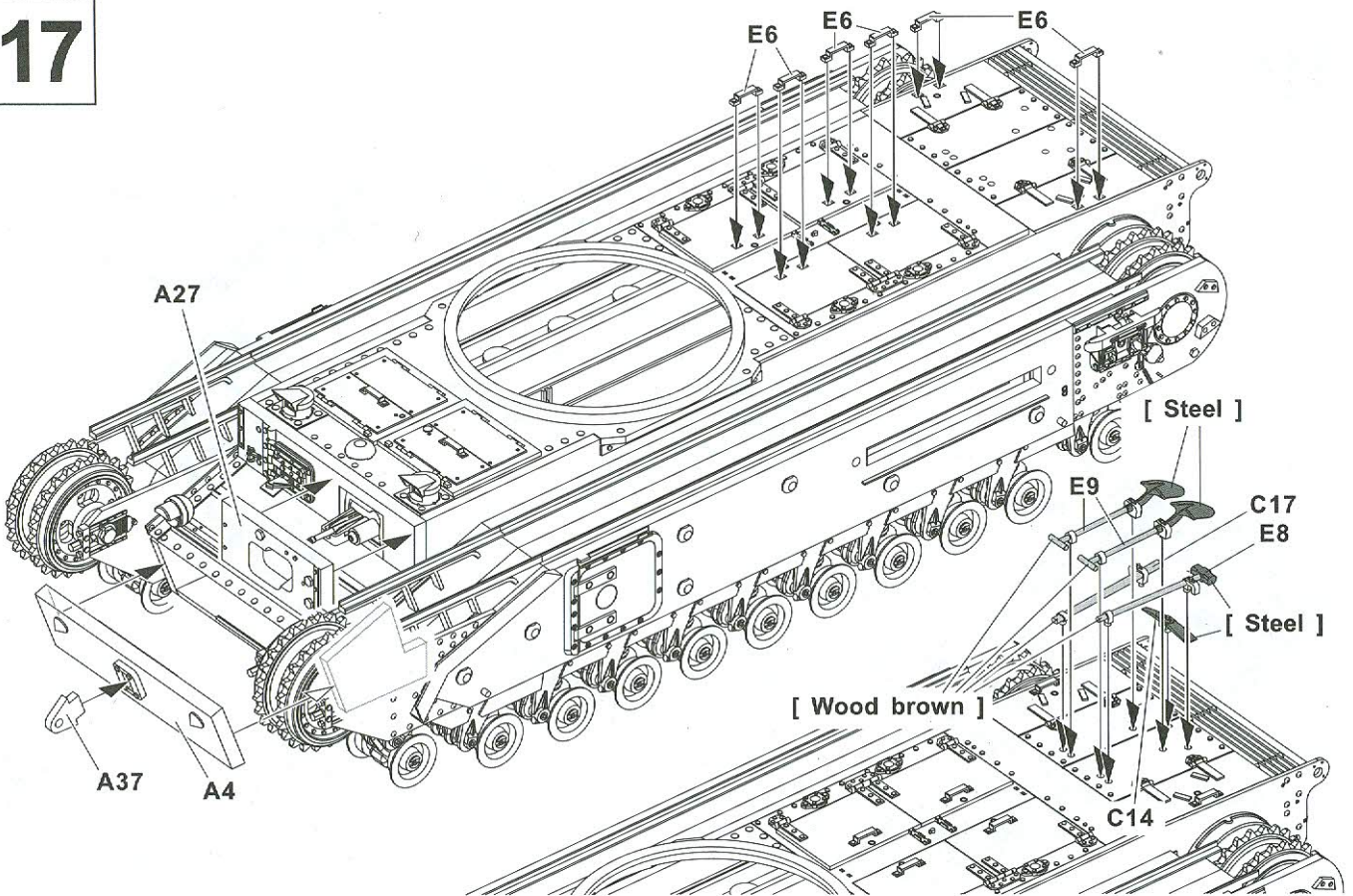

18

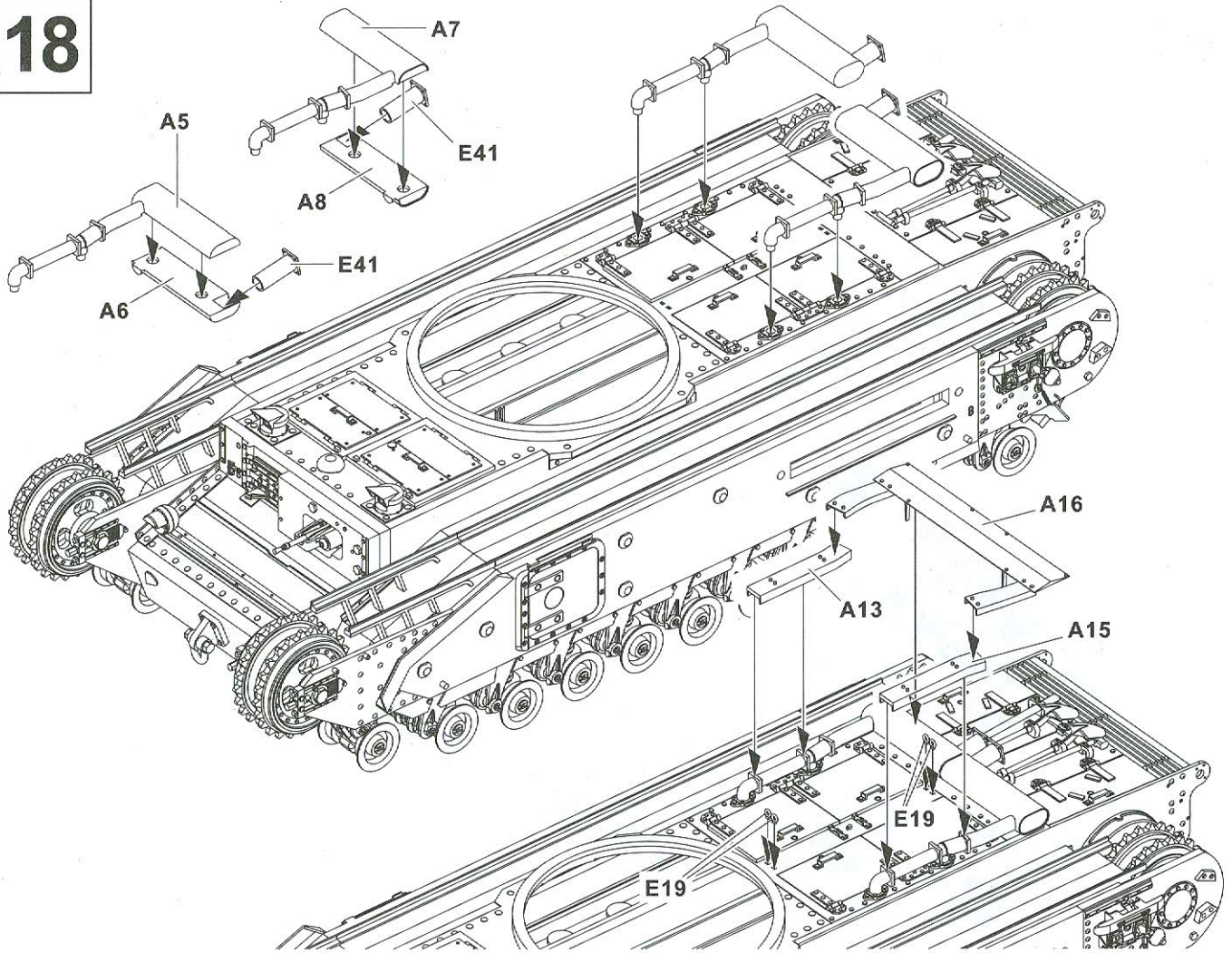

19

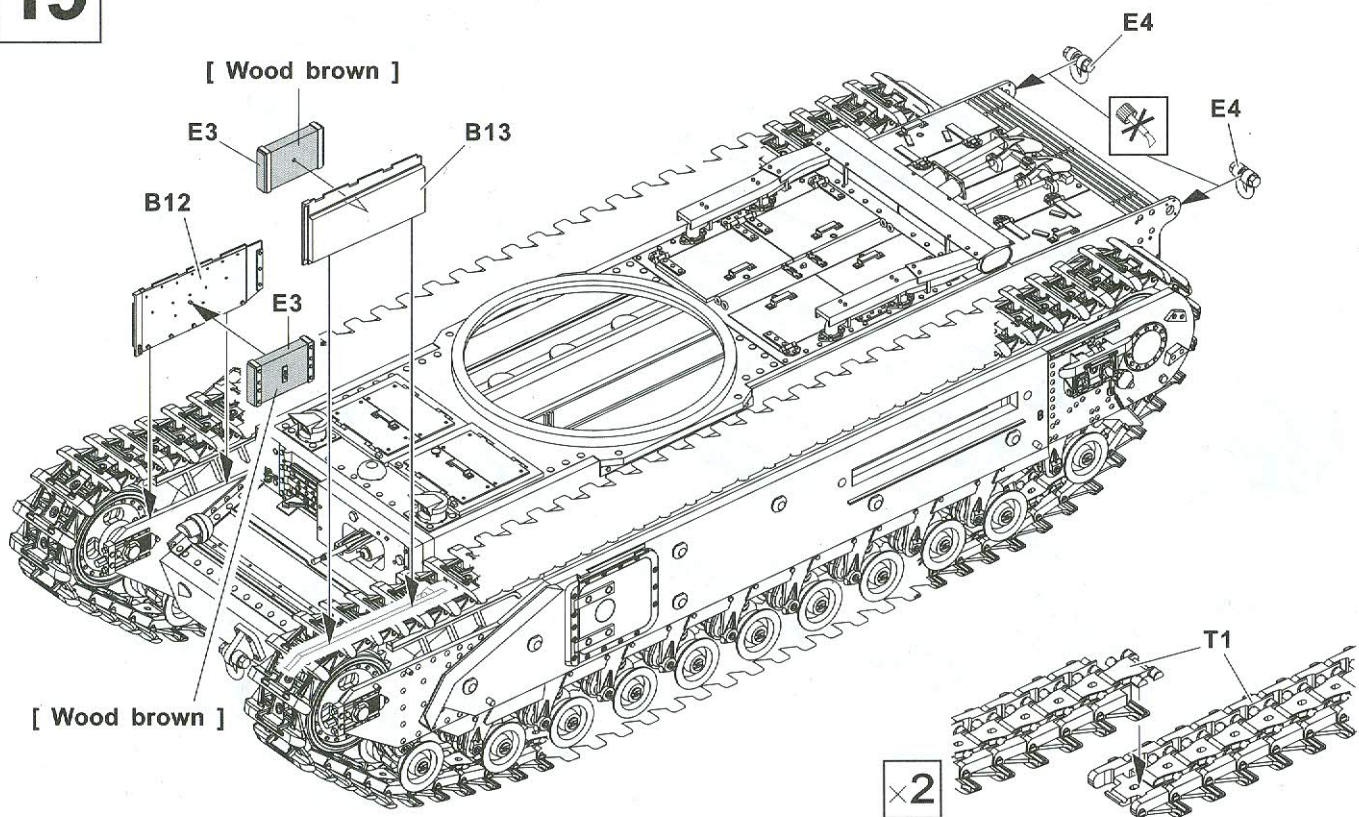

20

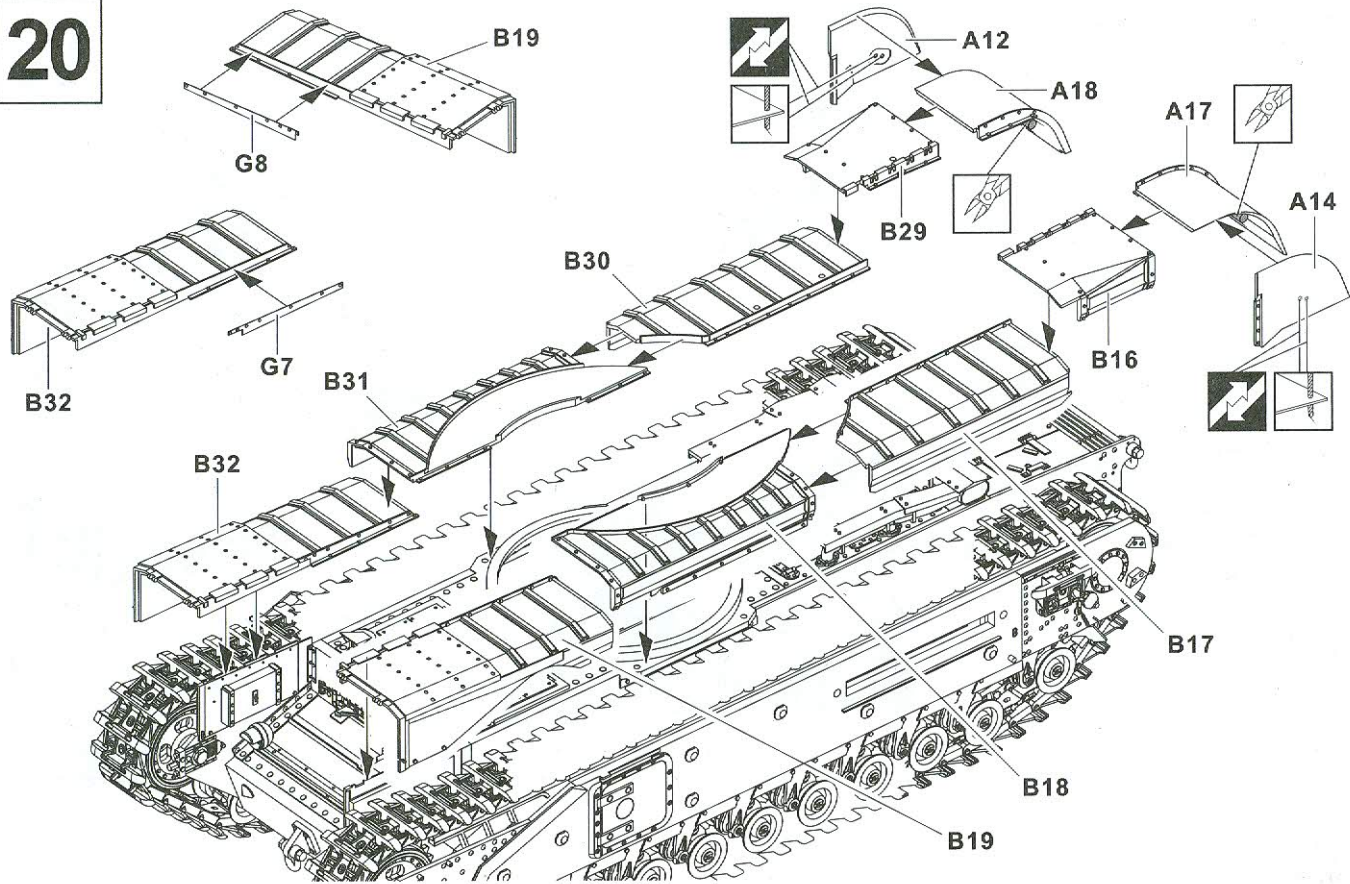

21

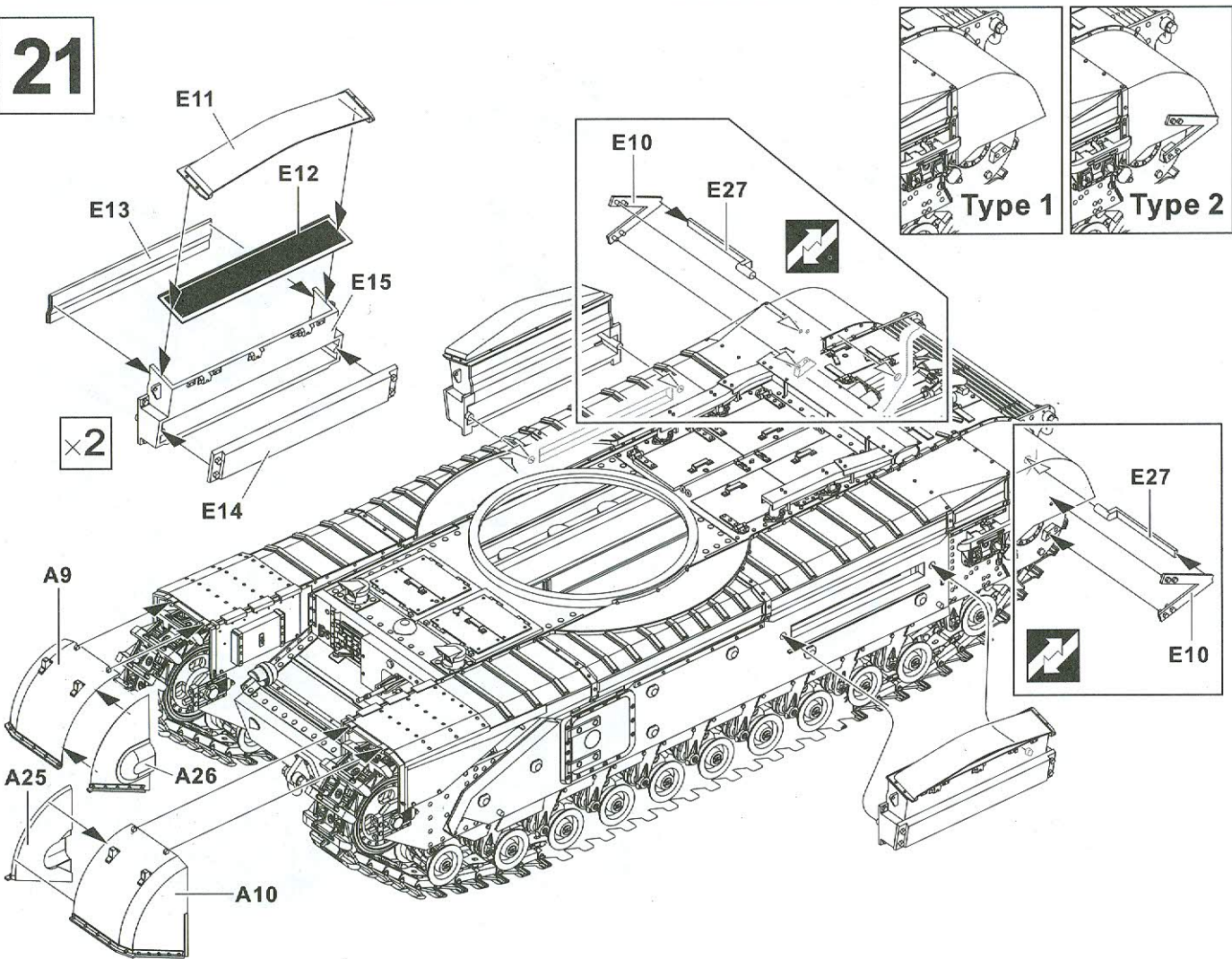

22

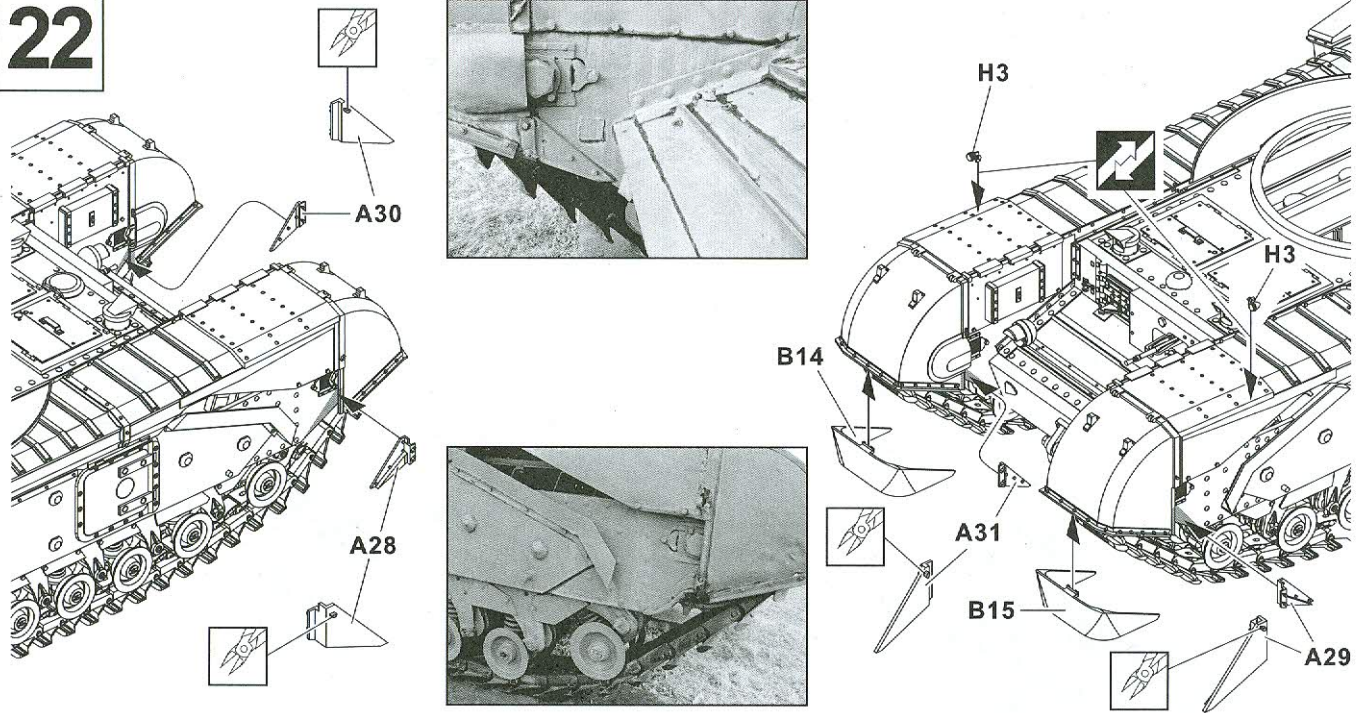

23

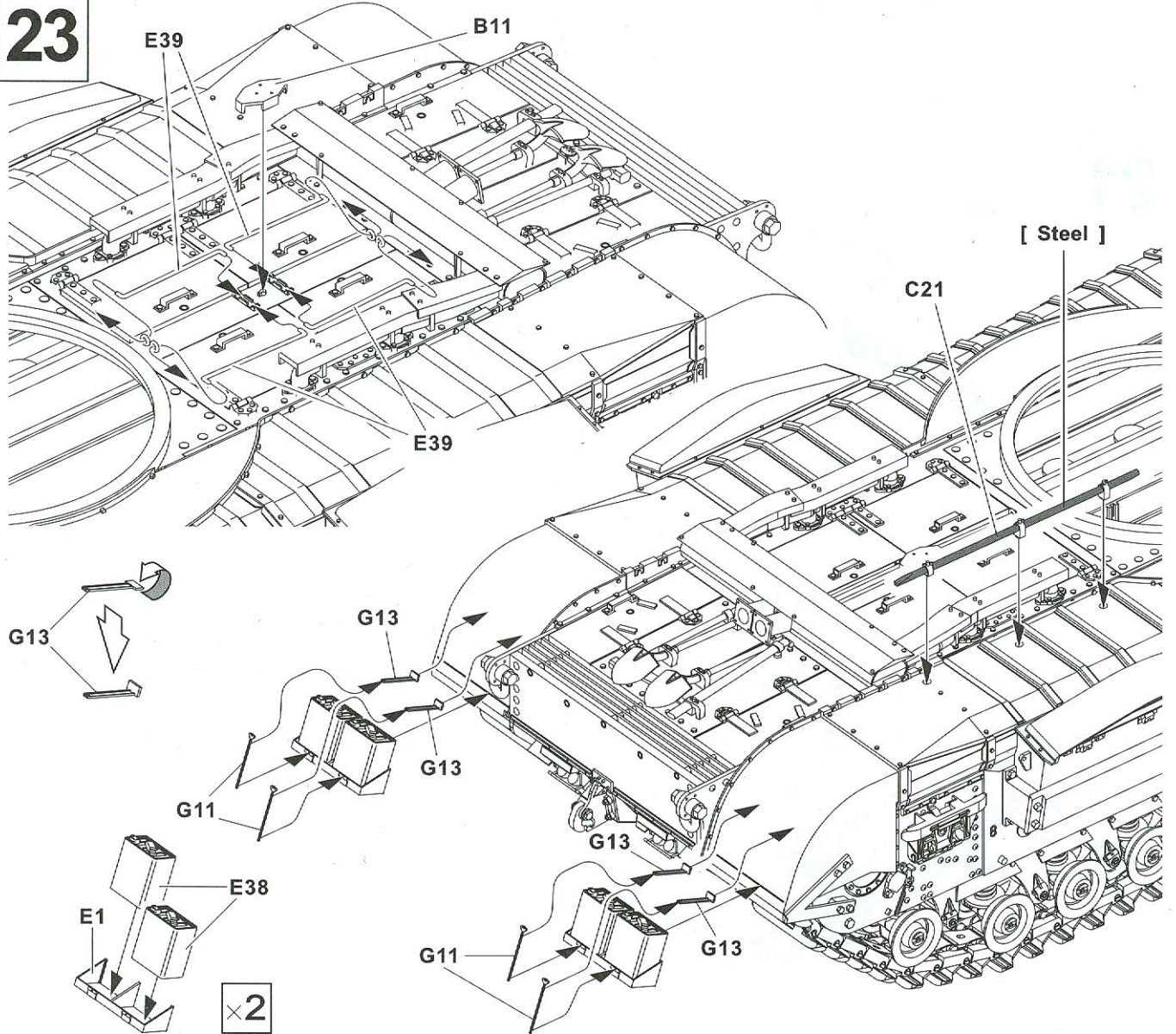

24

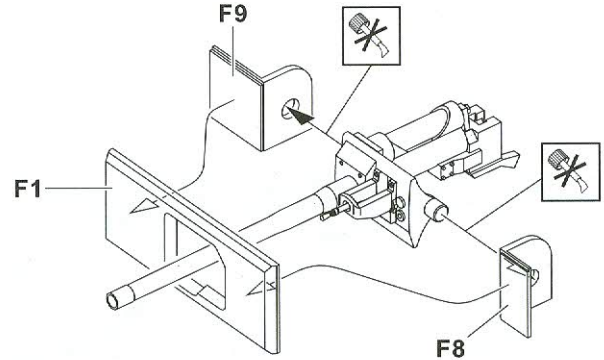
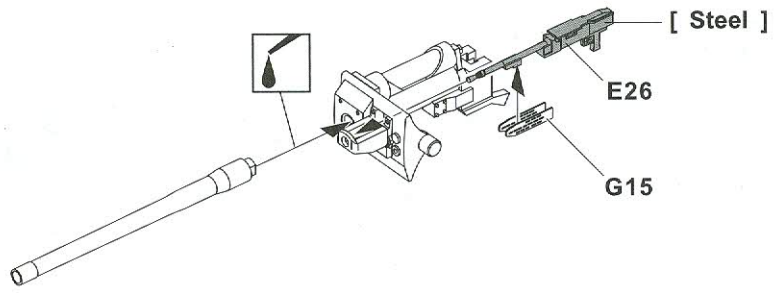
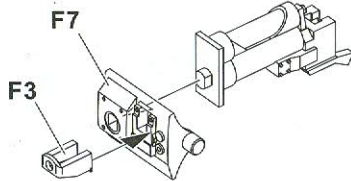
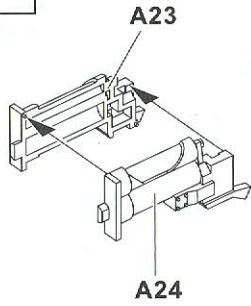

25

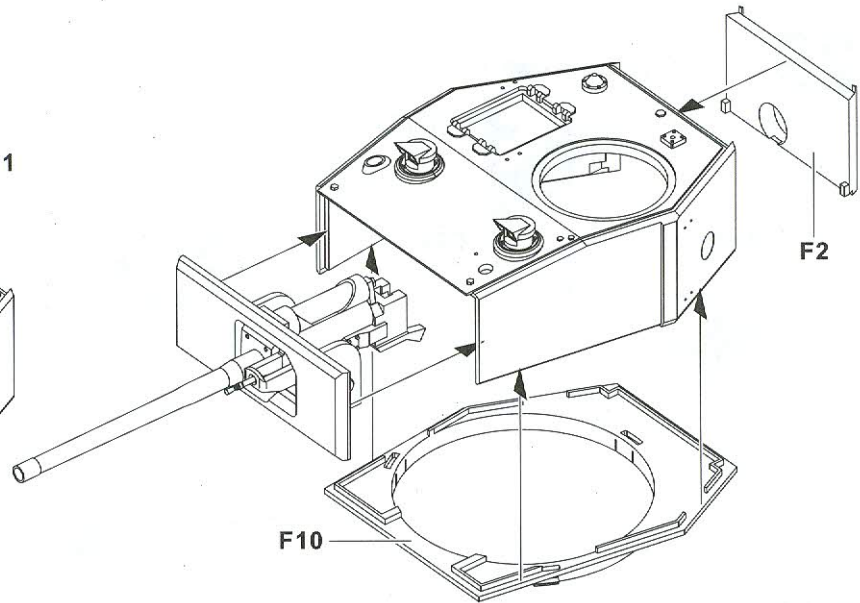
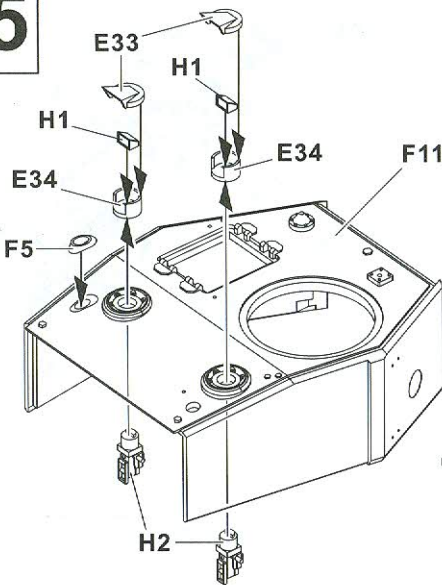

26

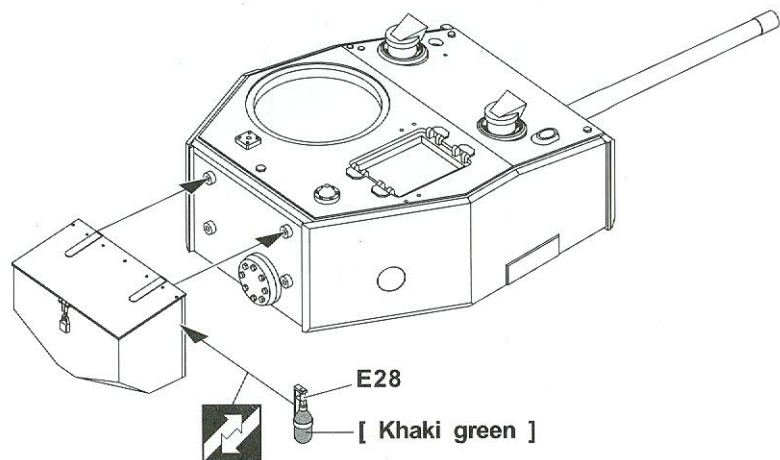
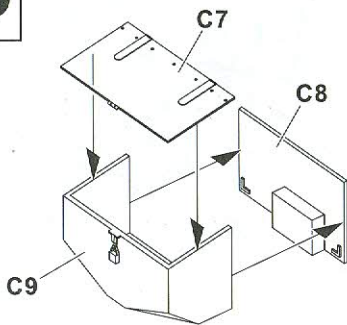

27

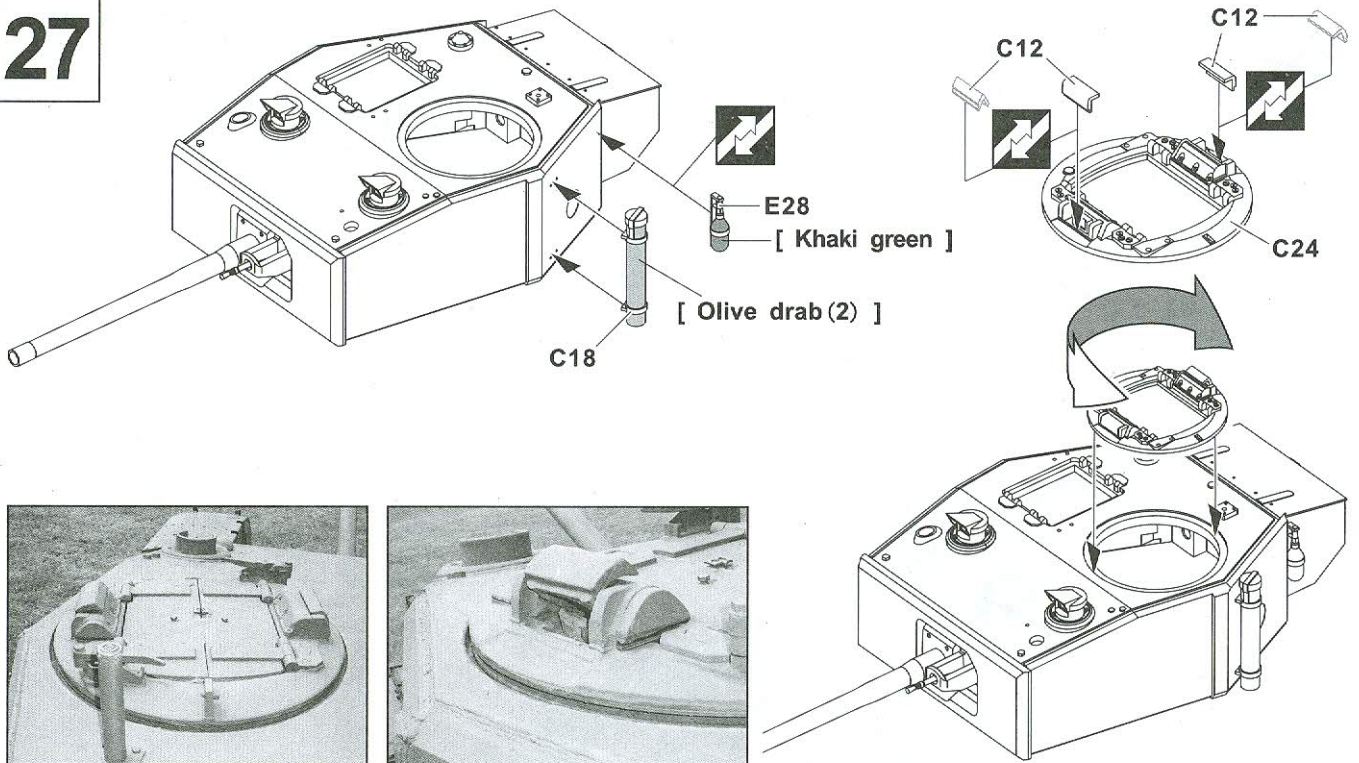

28

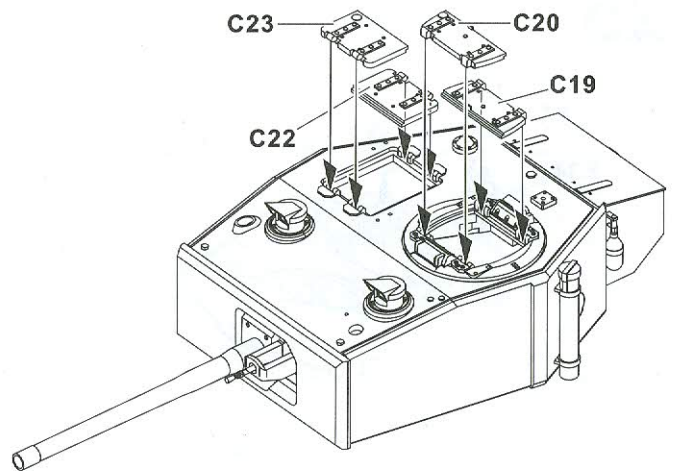
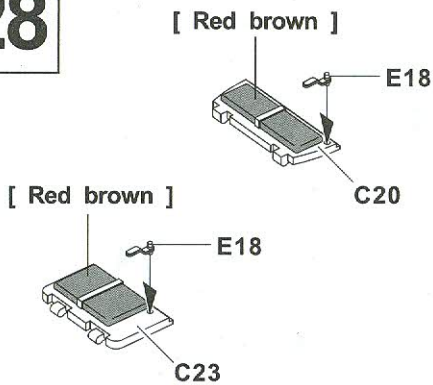

29

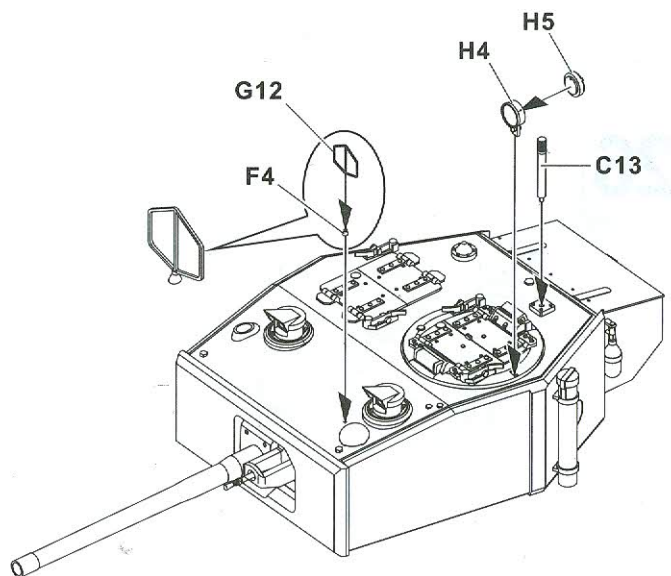
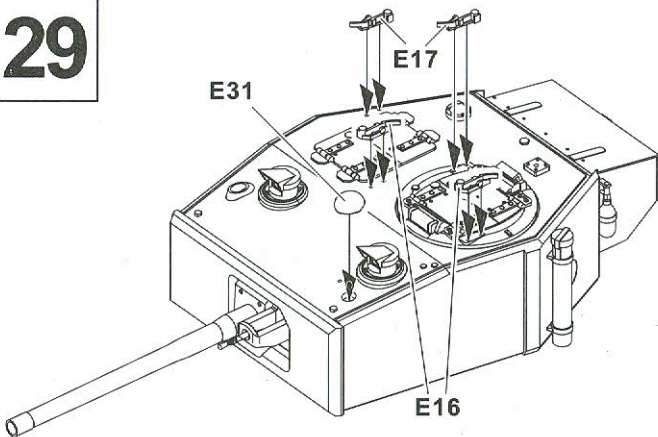

30

0mm

110mm

[Steel]

×2

E42

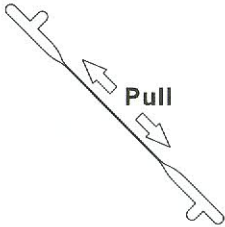
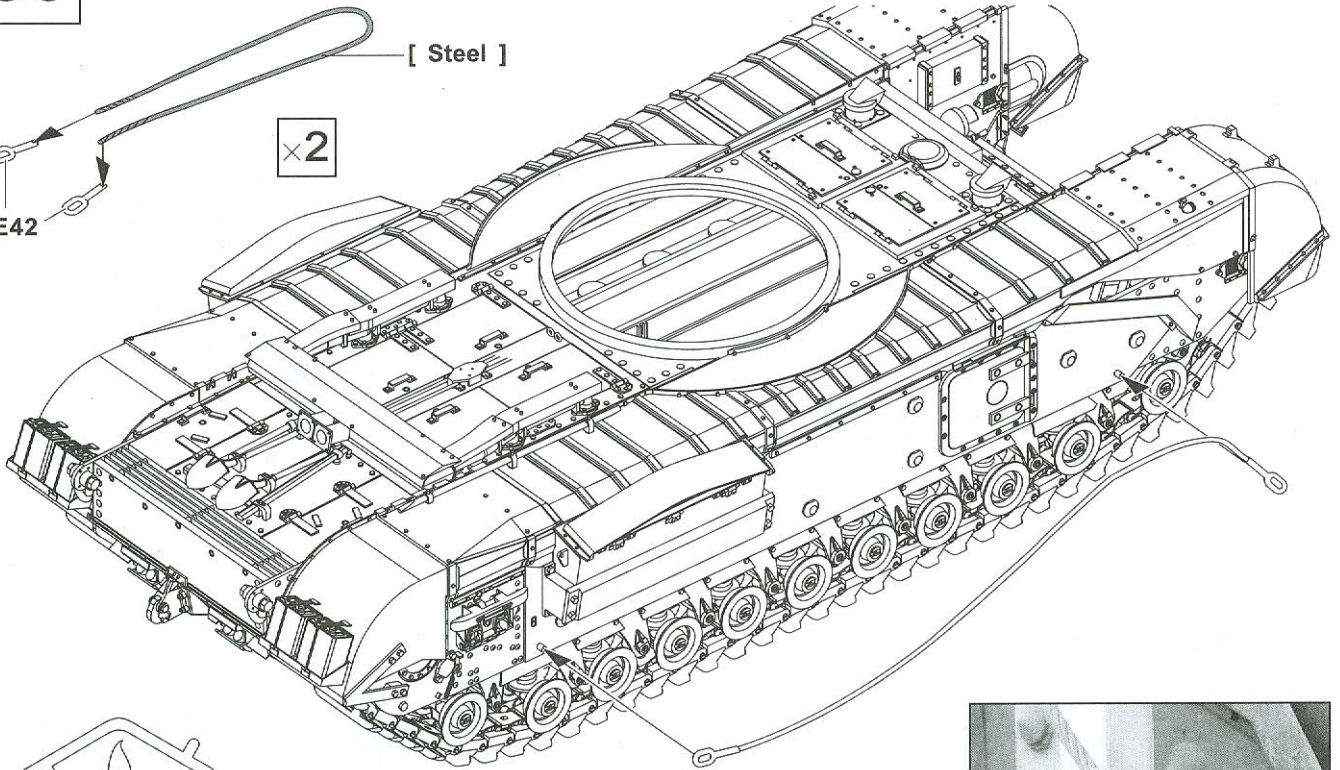

3cm

2cm

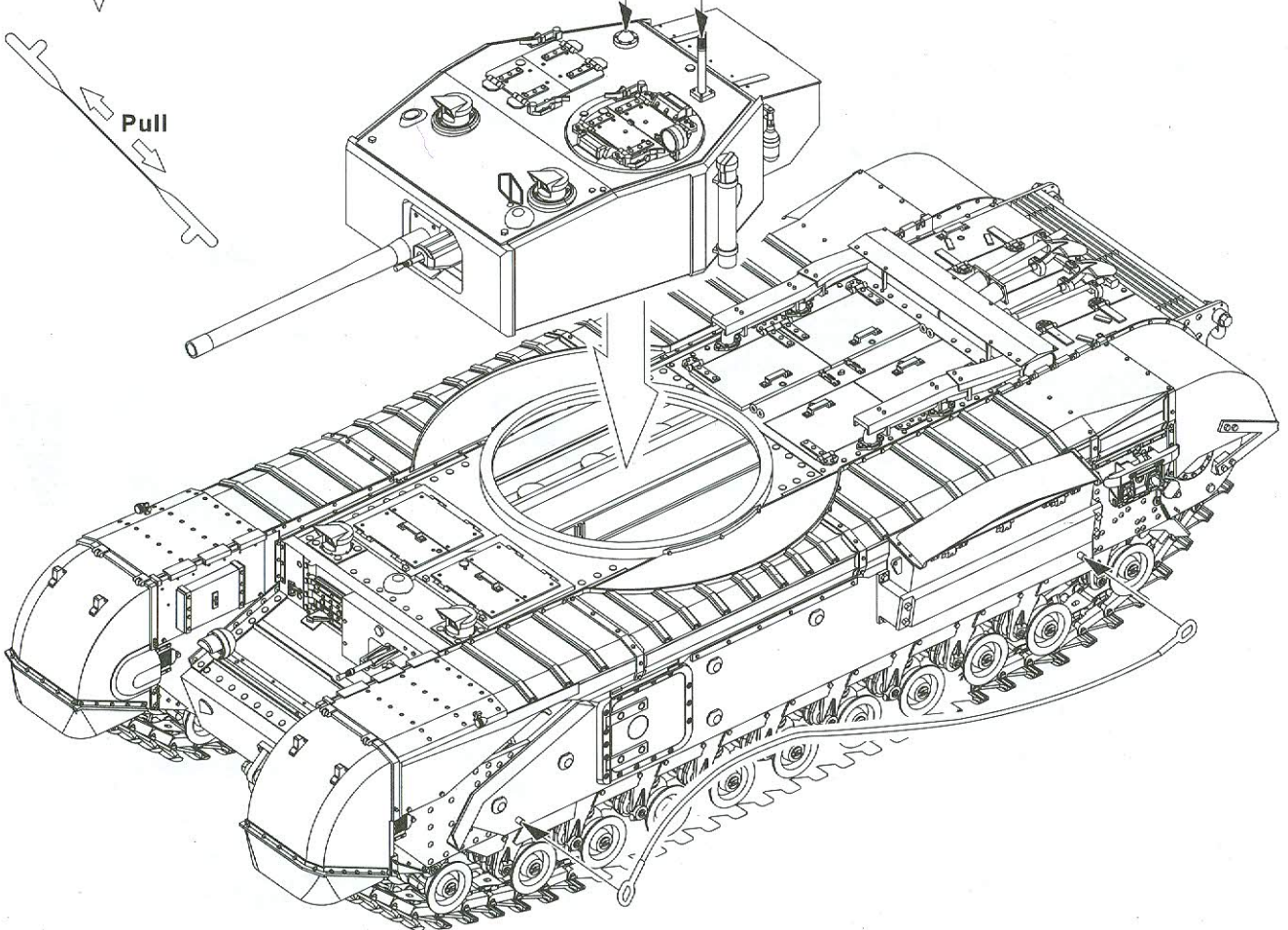
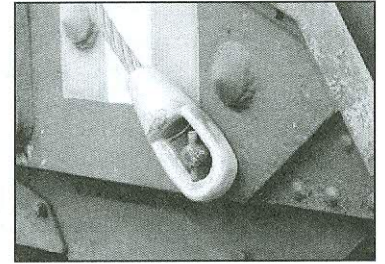

A British Army "Kingforce", El Alamein, Oct. 1942
 英國陸軍"Kingforce",艾爾.阿拉敏,1942年10月

 Body Color: Sandy Yellow 
 Dark Green 

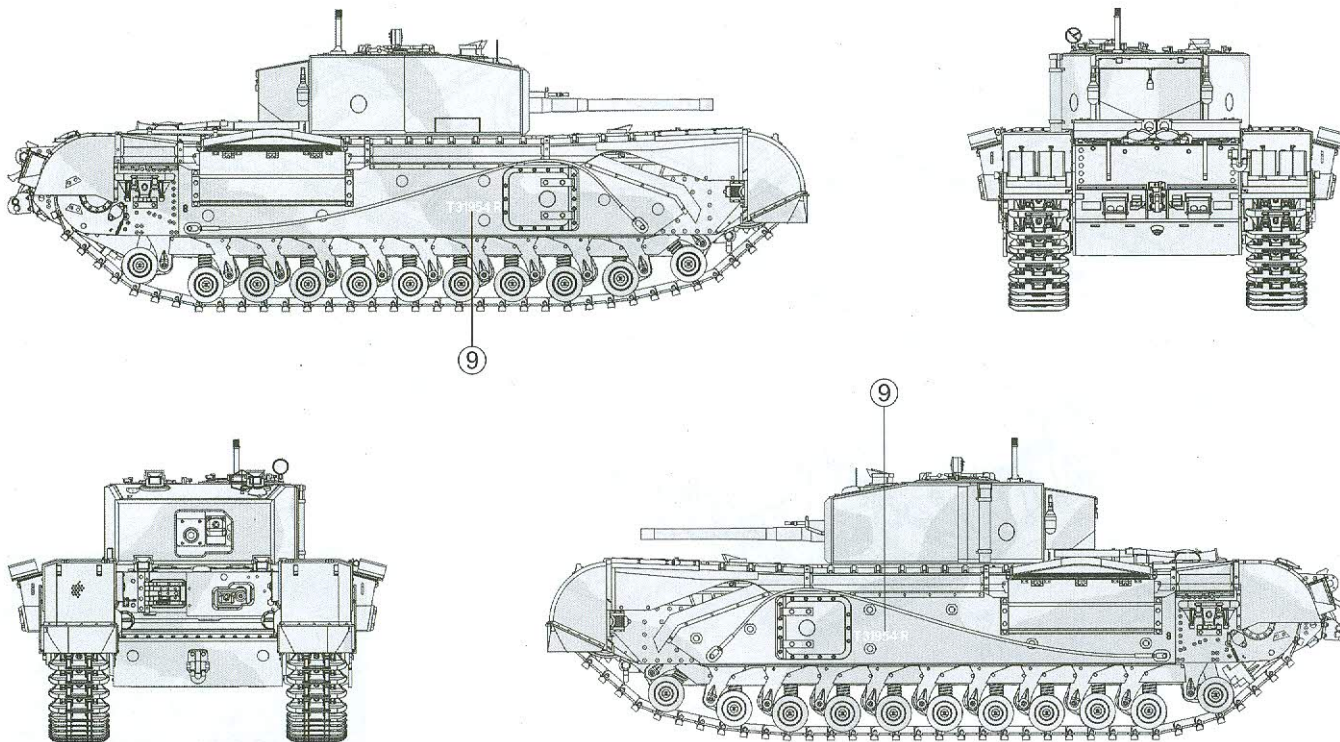

B Soviet Army, Winter 1942~43
 蘇聯陸軍,1942~43年冬

 Body Color: Flat White 
 Dark Green 

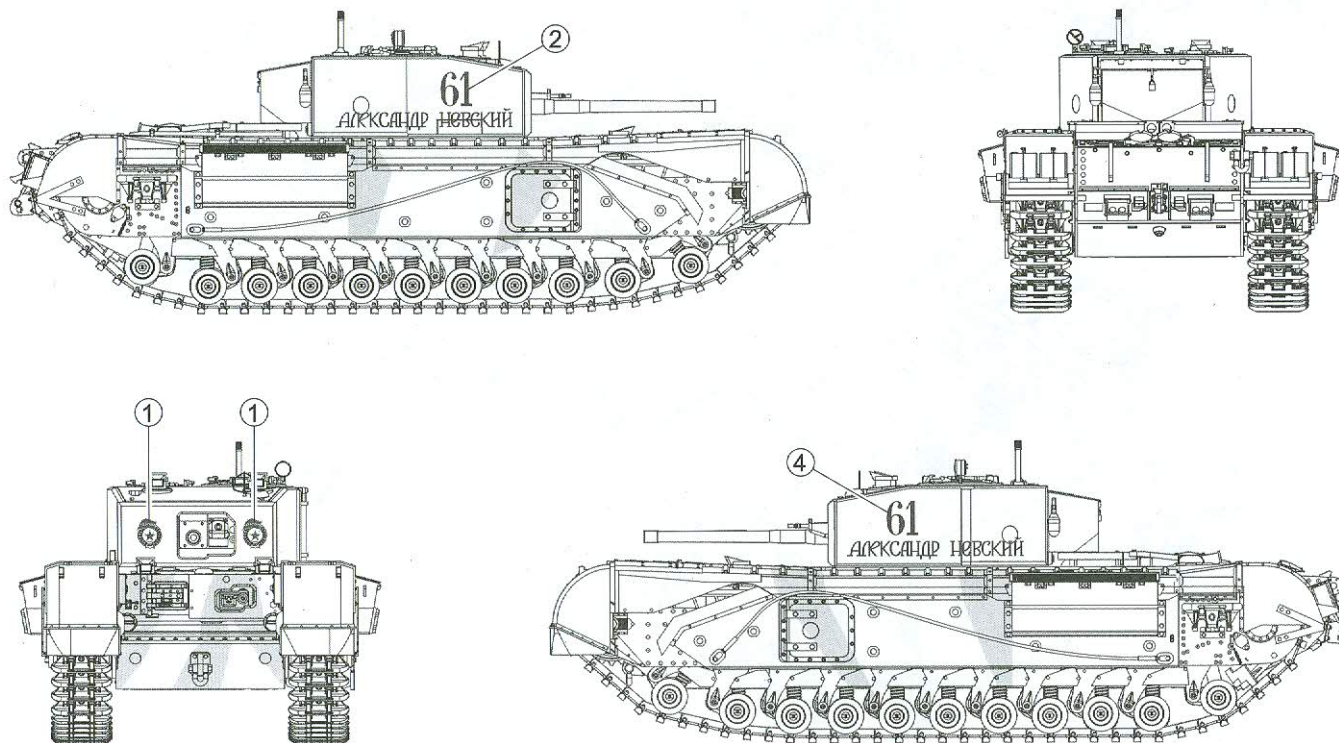

C 14th Canadian Army Tank Regiment (Calgary Regiment), Britain, 1942
 加拿大陸軍第十四(卡爾加里)戰車團,英國本土,1942年

 Body Color: Dark Green

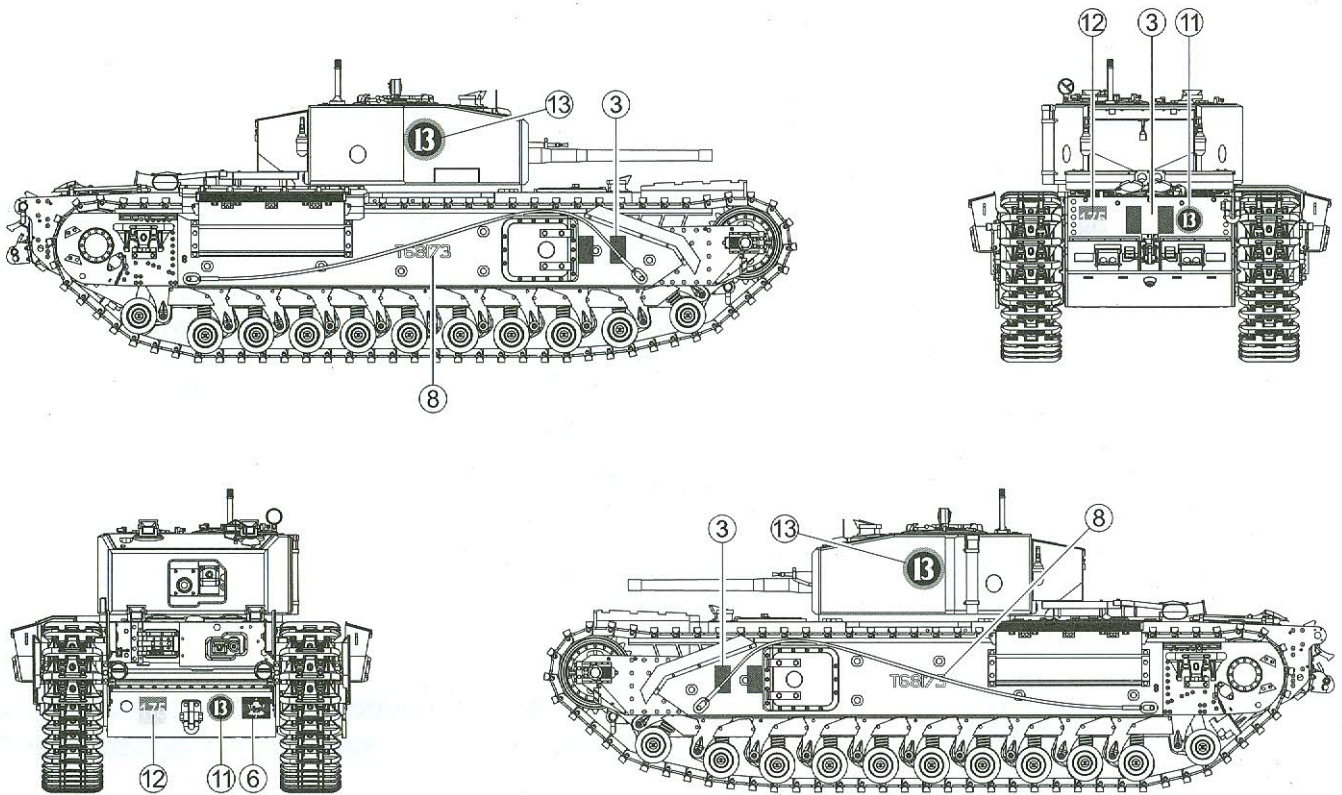

D 51st Royal Tank Regiment, Tunisia, Feb. 1943
 第五十一皇家戰車團,突尼西亞,1943年2月

 Body Color: Dark Green

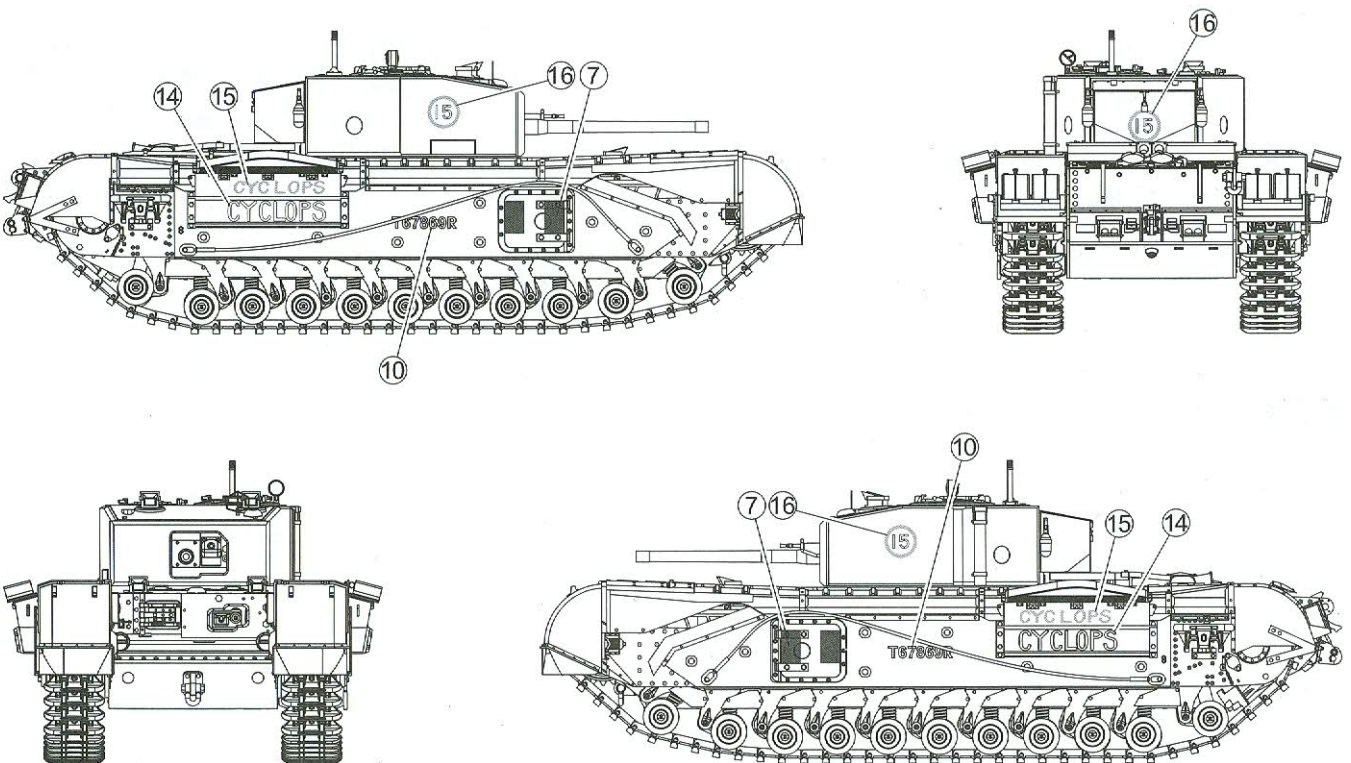

PARTS LIST 零件表

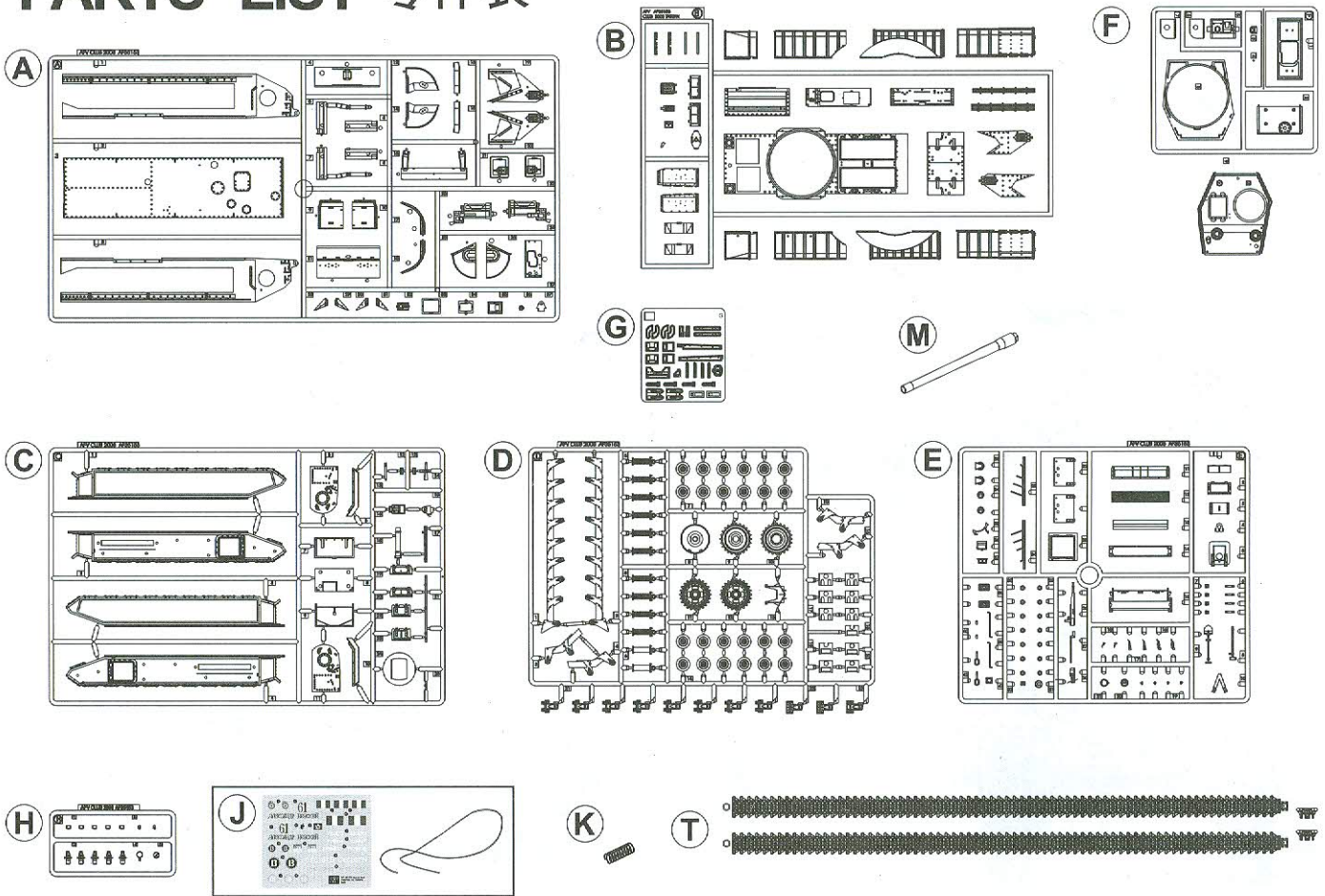

- A — 1 D — 2 G — 1 K — 22
- B — 1 E — 2 H — 1 M — 1
- C — 1 F — 1 J — 1 T — 1



Instructions:

If for some reason, you are not fully satisfied or have questions concerning our product; Please use the form provide, and send it to our nearest representative or mail it directly to our office.

We will deal with that A.S.A.P.

限臺灣地區使用 For Taiwanese use only!

AF 35153 零件補充申請表	申請人 姓名 地址 電話
<input type="checkbox"/> A 部品零件 — NT\$ 280 <input type="checkbox"/> B 部品零件 — NT\$ 280 <input type="checkbox"/> C 部品零件 — NT\$ 240 <input type="checkbox"/> D 部品零件 — NT\$ 320 <input type="checkbox"/> E 部品零件 — NT\$ 210 <input type="checkbox"/> F 部品零件 — NT\$ 180 <input type="checkbox"/> G 部品零件 — NT\$ 180 <input type="checkbox"/> H 部品零件 — NT\$ 80 <input type="checkbox"/> J 部品零件 — NT\$ 160 <input type="checkbox"/> K 部品零件 — NT\$ 100 <input type="checkbox"/> M 部品零件 — NT\$ 200 <input type="checkbox"/> T 部品零件 — NT\$ 280	+郵寄費 — NT\$ 80 (請填)總計NT\$ _____
零件補充原因:(請於 <input type="checkbox"/> 打√) 原包裝即 <input type="checkbox"/> 遺失或 <input type="checkbox"/> 毀損, 製作途中 <input type="checkbox"/> 遺失或 <input type="checkbox"/> 毀損, 其他原因 _____	

總代理戰鷹企業有限公司收本公司將儘速為您處理。
 請將本表與該部品相同金額之郵政匯票一同寄至

AF 35153 Parts Replacement Form												
<table style="width: 100%;"> <tr> <td><input type="checkbox"/> A parts</td> <td><input type="checkbox"/> E parts</td> <td><input type="checkbox"/> J parts</td> </tr> <tr> <td><input type="checkbox"/> B parts</td> <td><input type="checkbox"/> F parts</td> <td><input type="checkbox"/> K parts</td> </tr> <tr> <td><input type="checkbox"/> C parts</td> <td><input type="checkbox"/> G parts</td> <td><input type="checkbox"/> M parts</td> </tr> <tr> <td><input type="checkbox"/> D parts</td> <td><input type="checkbox"/> H parts</td> <td><input type="checkbox"/> T parts</td> </tr> </table> <p>Reason for replacement: <input type="checkbox"/> Missing <input type="checkbox"/> Broken</p> <p>Signature: _____</p>	<input type="checkbox"/> A parts	<input type="checkbox"/> E parts	<input type="checkbox"/> J parts	<input type="checkbox"/> B parts	<input type="checkbox"/> F parts	<input type="checkbox"/> K parts	<input type="checkbox"/> C parts	<input type="checkbox"/> G parts	<input type="checkbox"/> M parts	<input type="checkbox"/> D parts	<input type="checkbox"/> H parts	<input type="checkbox"/> T parts
<input type="checkbox"/> A parts	<input type="checkbox"/> E parts	<input type="checkbox"/> J parts										
<input type="checkbox"/> B parts	<input type="checkbox"/> F parts	<input type="checkbox"/> K parts										
<input type="checkbox"/> C parts	<input type="checkbox"/> G parts	<input type="checkbox"/> M parts										
<input type="checkbox"/> D parts	<input type="checkbox"/> H parts	<input type="checkbox"/> T parts										

