

7

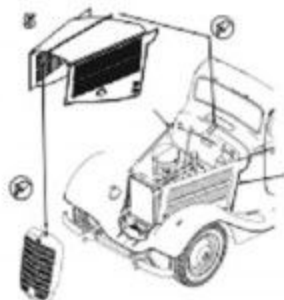

8

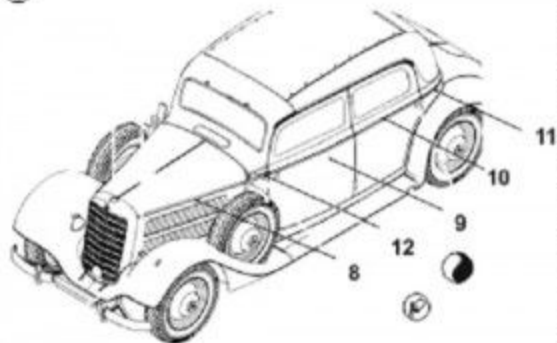

Mercedes-Benz Typ 320 (W142) Saloon
 WWII German Staff Car (hood) (VCM™ model kit)
35028

1/35

Photoetched parts

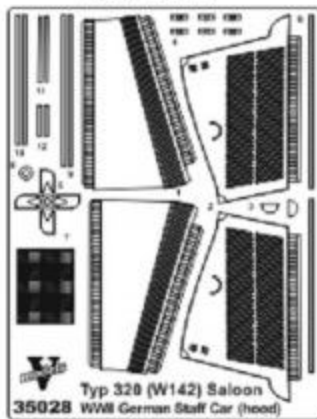

Typ 320 (W142) Saloon
35028 WWII German Staff Car (hood)

- Bend
- Glue
- Symmetrical assembly
- Remove
- Do not glue
- Open hole

<http://vmodels-art.com/>
vmodels2015@gmail.com

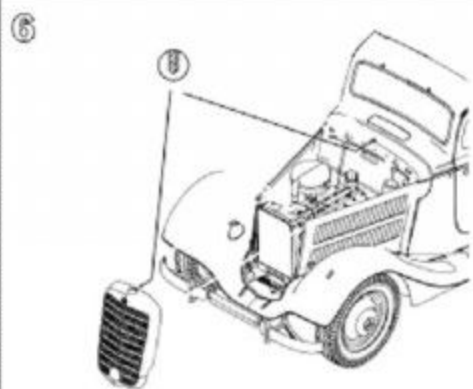
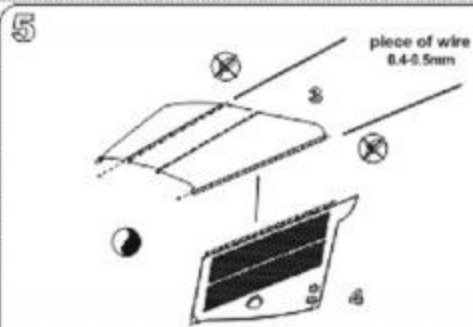
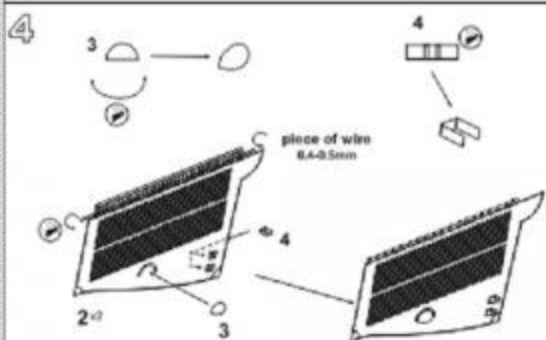
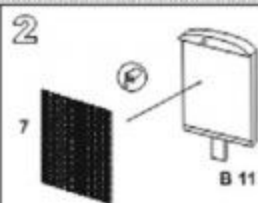
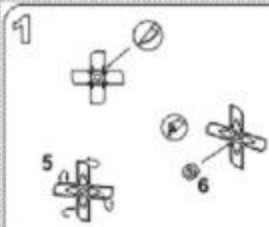

11

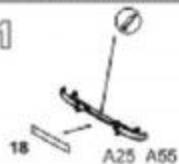

12



13

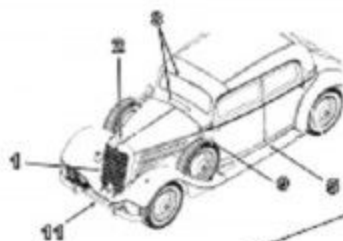

14

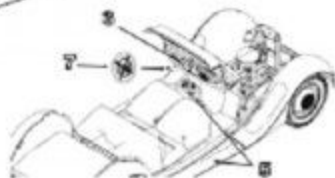

Mercedes-Benz Typ 320 (W142) Saloon
 WWII German Staff Car (ICM model kit)

35027

1/35

Photoetched parts

Film parts

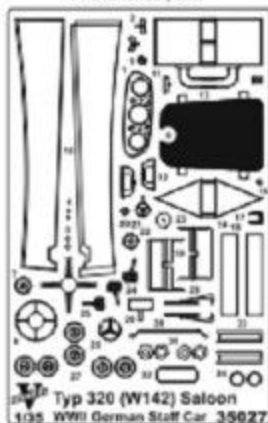

Vmodels Typ 320 (W142) Saloon
 1/35 WWII German Staff Car 35027



Bend



Glue



Symmetrical assembly



Remove



Do not glue

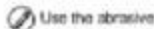

Use the abrasive

<http://vmodels-art.com/>
vmodels2015@gmail.com

