



VERLINDEN PRODUCTIONS

Ondernemersstraat, 4
B-2500 Lier/BELGIUM

CE **MADE IN BELGIUM**

AGE 14 AND UP/ ET PLUS

P-38J LIGHTNING

Update Set

1:48
892

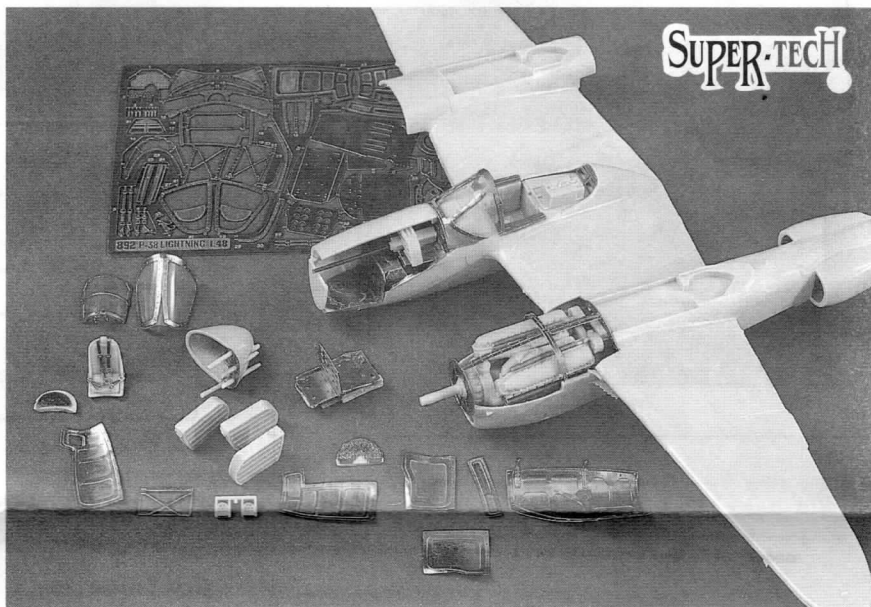

Remove carriers with VP Razor Saw (Set 778)
Available in the VP model accessory range

PHOTO-ETCHED PARTS

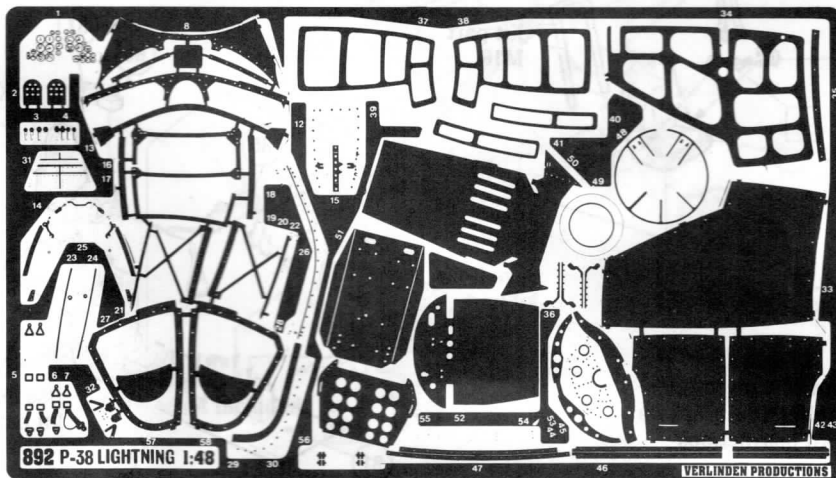

RESIN PARTS

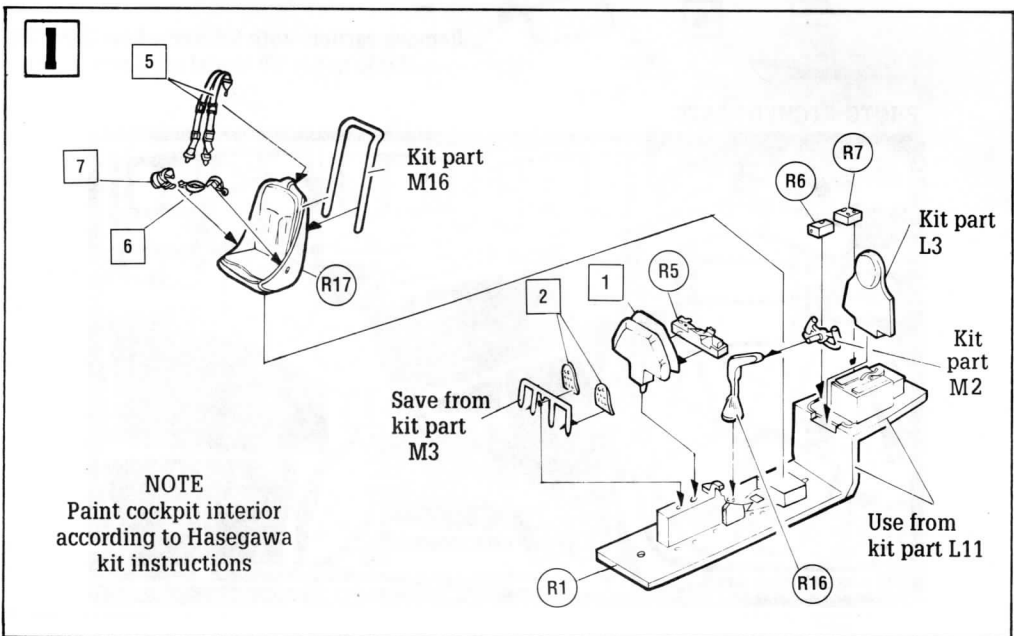
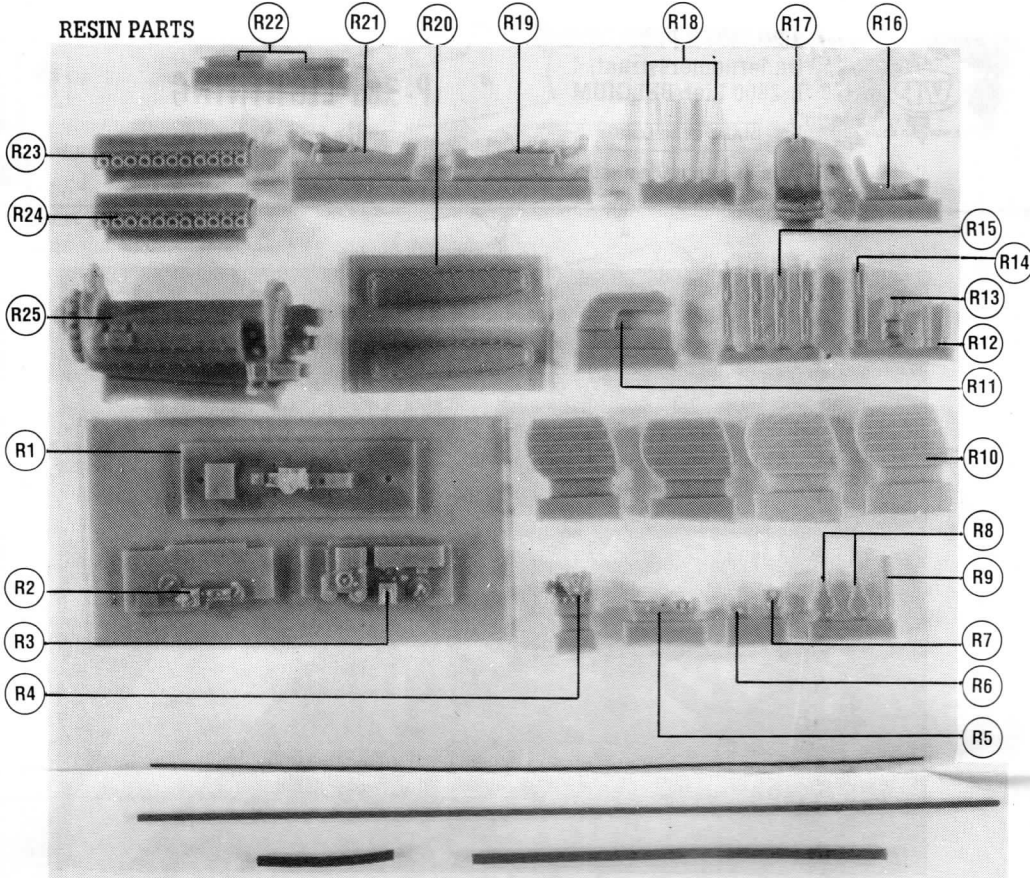

2

DETAIL A

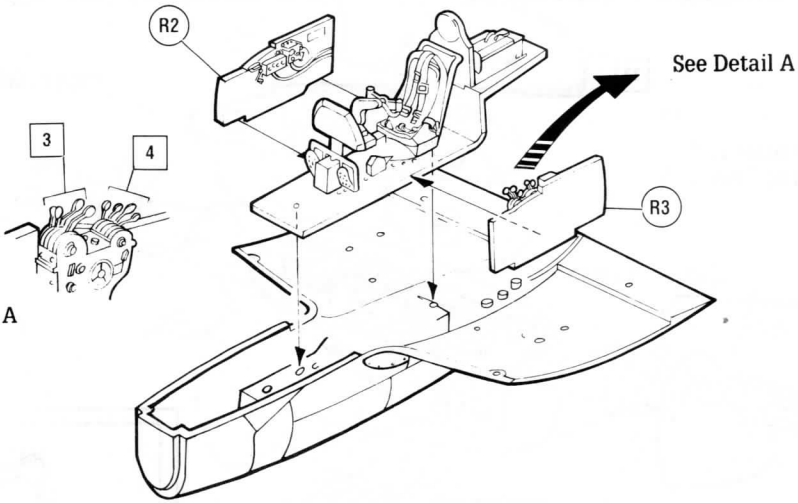
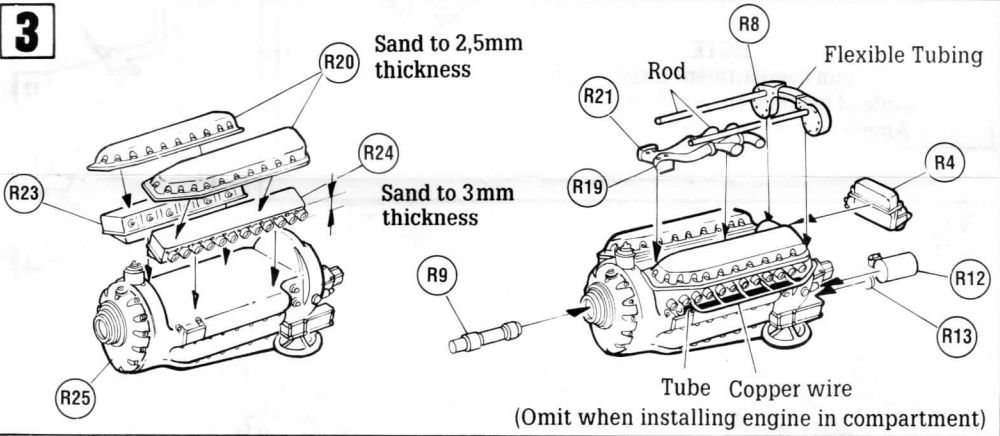
**3****4**

Remove from kit

Remove from kit

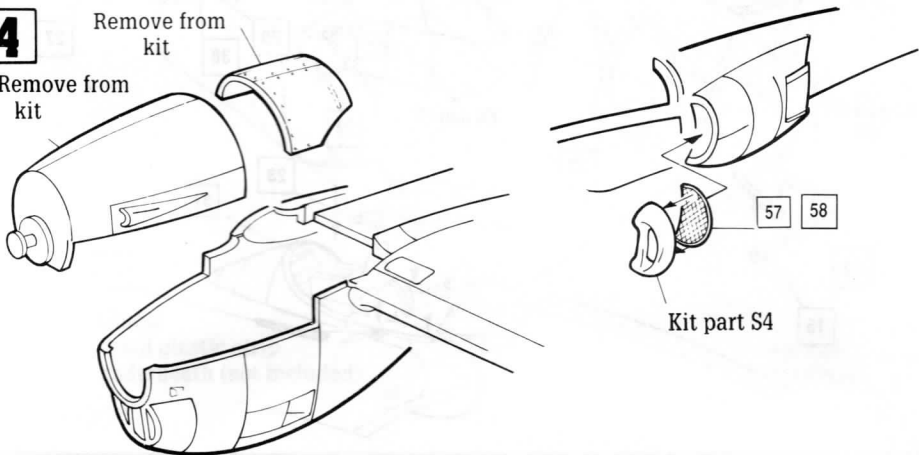

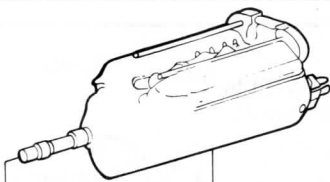
5

NOTE
When installing engine in compartment, remove bottom part of engine for better fit

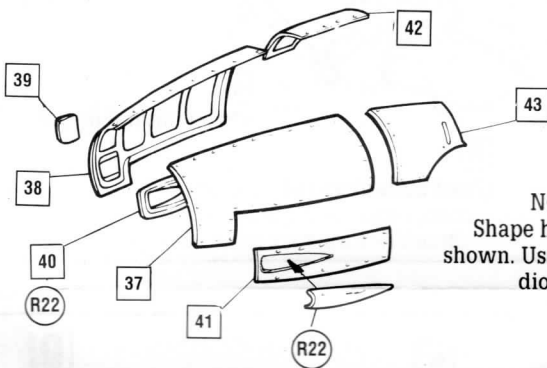
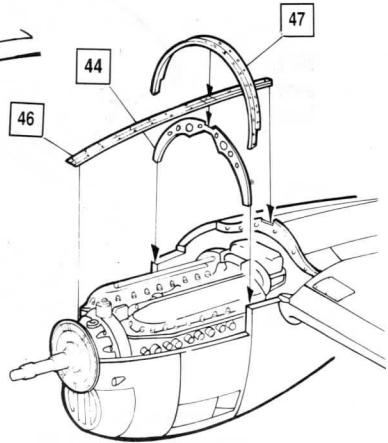
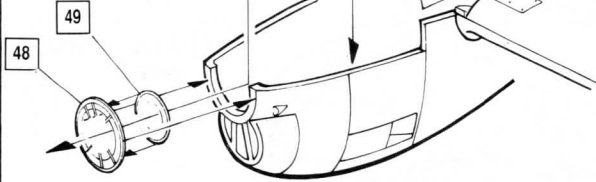

NOTE
Shape hatches as shown. Use to decorate diorama

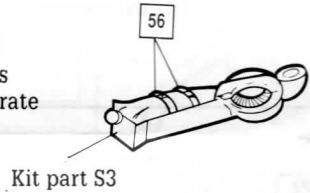

Kit part S3

6

PREPARING NOSE COMPARTMENT

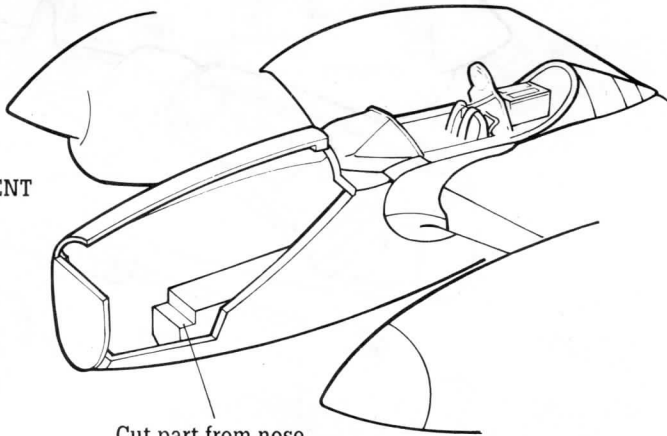

Cut part from nose wheel well to align with panel

OPTION

Choose either port or starboard gun compartment to be shown open. Inside framing of both port & starboard gun hatches are provided (part 33 & 34)

Remove areas from kit as shown

7

Make a saw cut to fit part 52 (see detail)

Make saw cut here



DETAIL

Remove with scissors until part 50 fits in fuselage

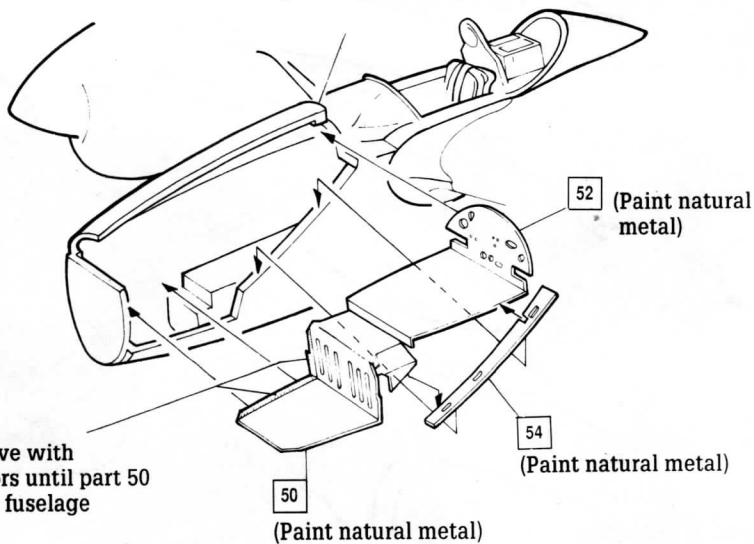
**8**

Glue a small plastic strip underneath (not included)

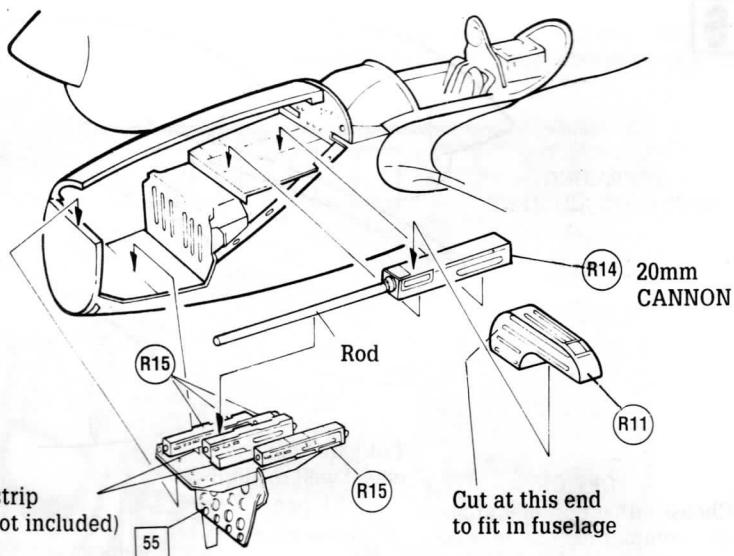

9

Enlarge holes and
insert R18. Glue to
guns

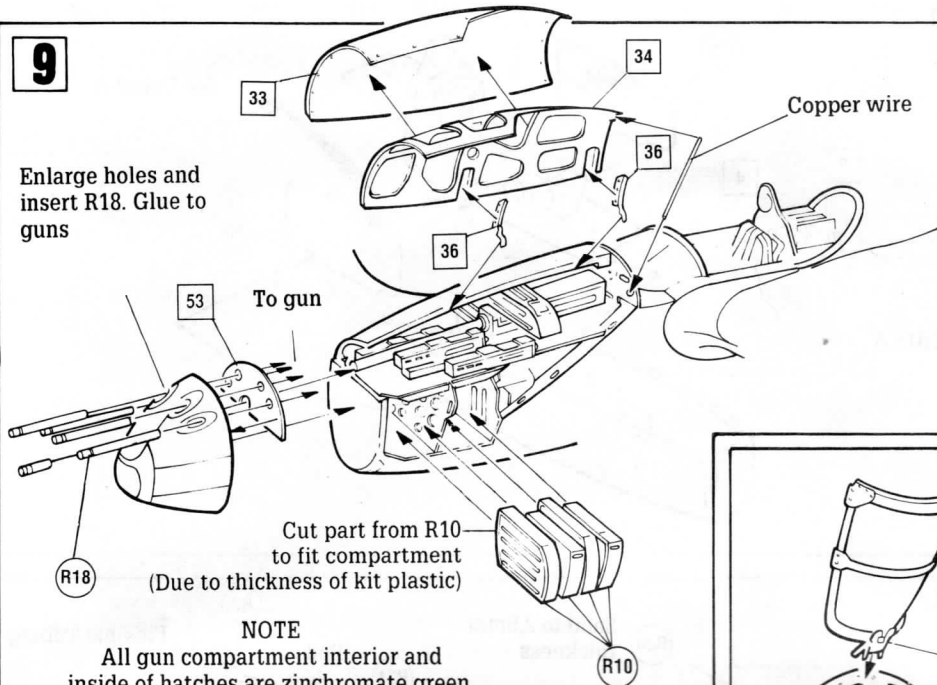
**NOTE**

All gun compartment interior and
inside of hatches are zinchromate green.
Ammo containers are bare aluminum.

10