

BEDFORD QLR

Wireless









Cat. no. 35017

Scale 1/35



Project, design & artwork: Jarosław Leoniec
Research: IBG crew

-  Element złożony we wcześniejszym etapie
Element assembled in previous step
-  Element po złożeniu w aktualnym etapie
Element after assembly in actual step
-  Wersja do wyboru
Version to choose
-  Kalkomania
Decal
-  Kolor farby
Paint colour
-  Część nie do użycia
Part not for use

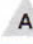
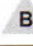
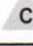
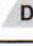
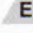
		Vallejo Model Air	Vallejo Model Color
black		71057	70950
rust		71080	70846
gunmetal		71072	70863
olive drab		71043	70889
light green		71006	70942

Przed montażem przeczytać instrukcję. Przestrzegać kolejności montażu podanego w instrukcji! Klej i farby nie wchodzi w skład zestawu.

Please read instruction before assembly. Obey sequence of assembly like in instruction. Glue and paints not included.

Ramka przezroczysta / Frame clear

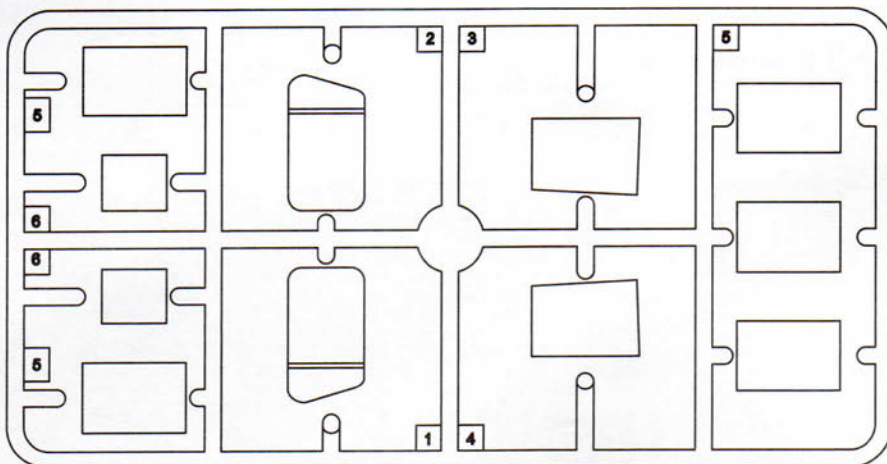

International Business Group
ul. Benedykta Hertza 2
04-603 Warszawa
Poland

tel +48 22 8159150
fax +48 22 8159151
ibgsc@ibg.com.pl
www.ibg.com.pl

Ramka A / Frame A

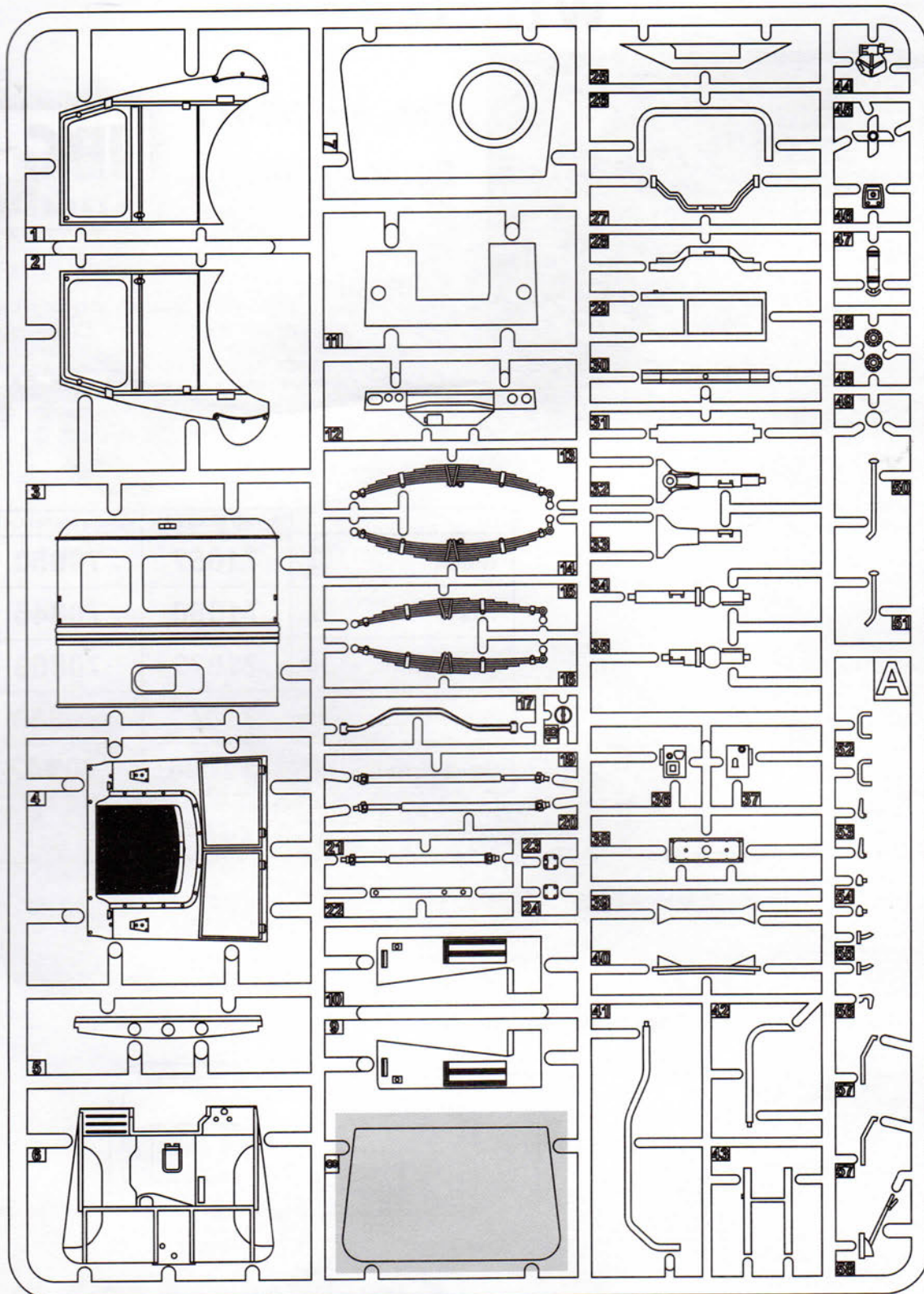

Ramka B / Frame B

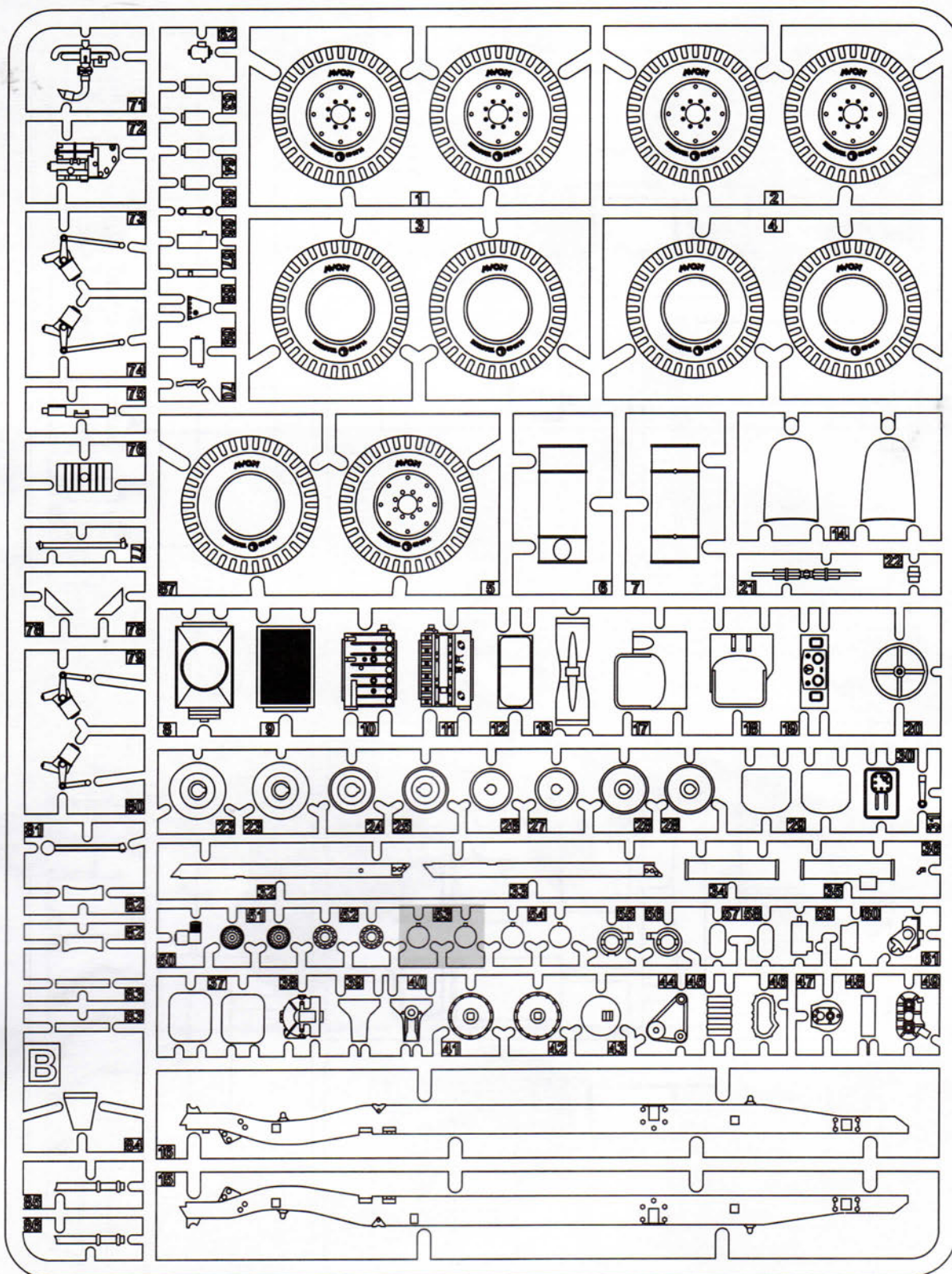

Ramka E / Frame E

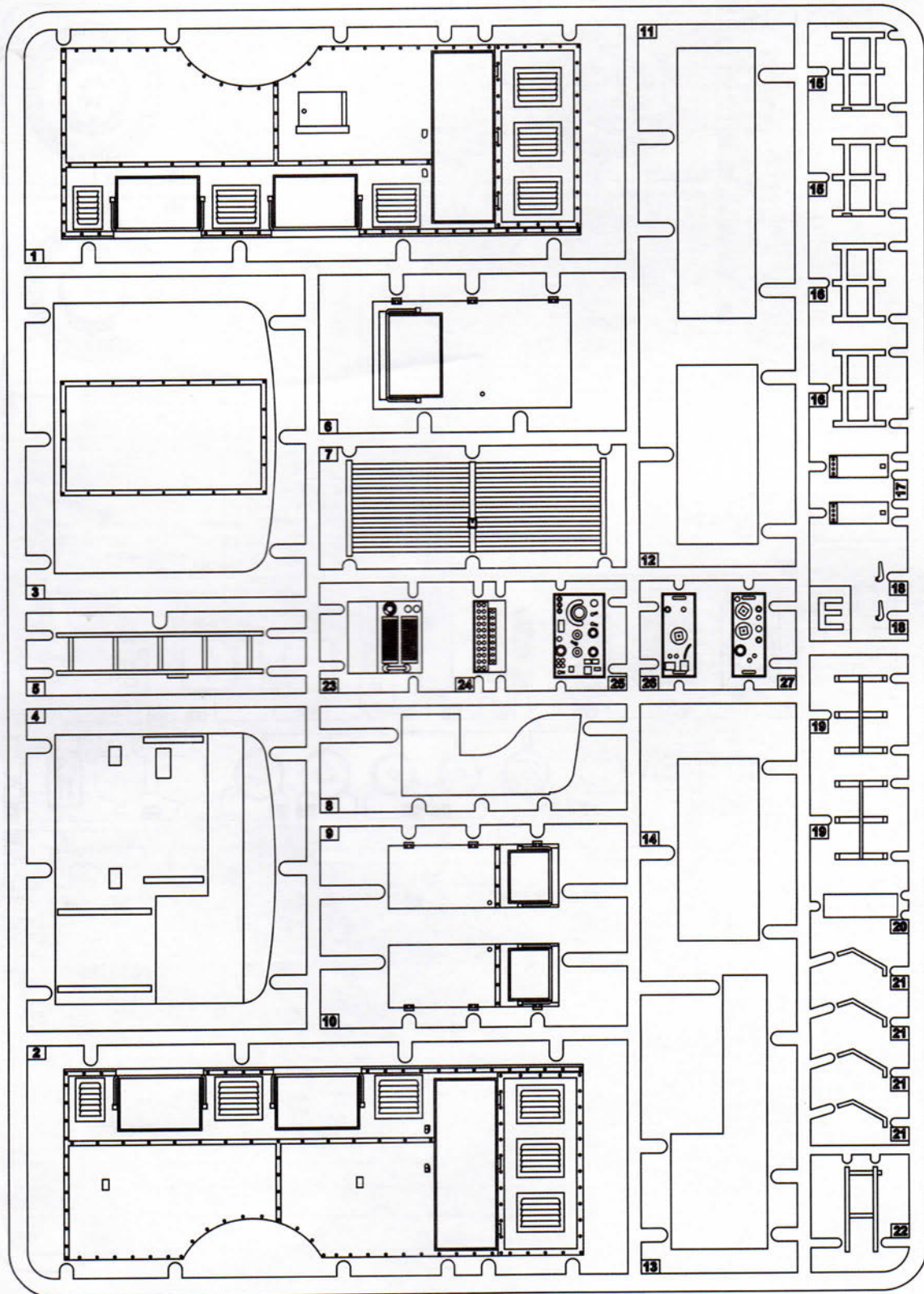

Ramka F / Frame F

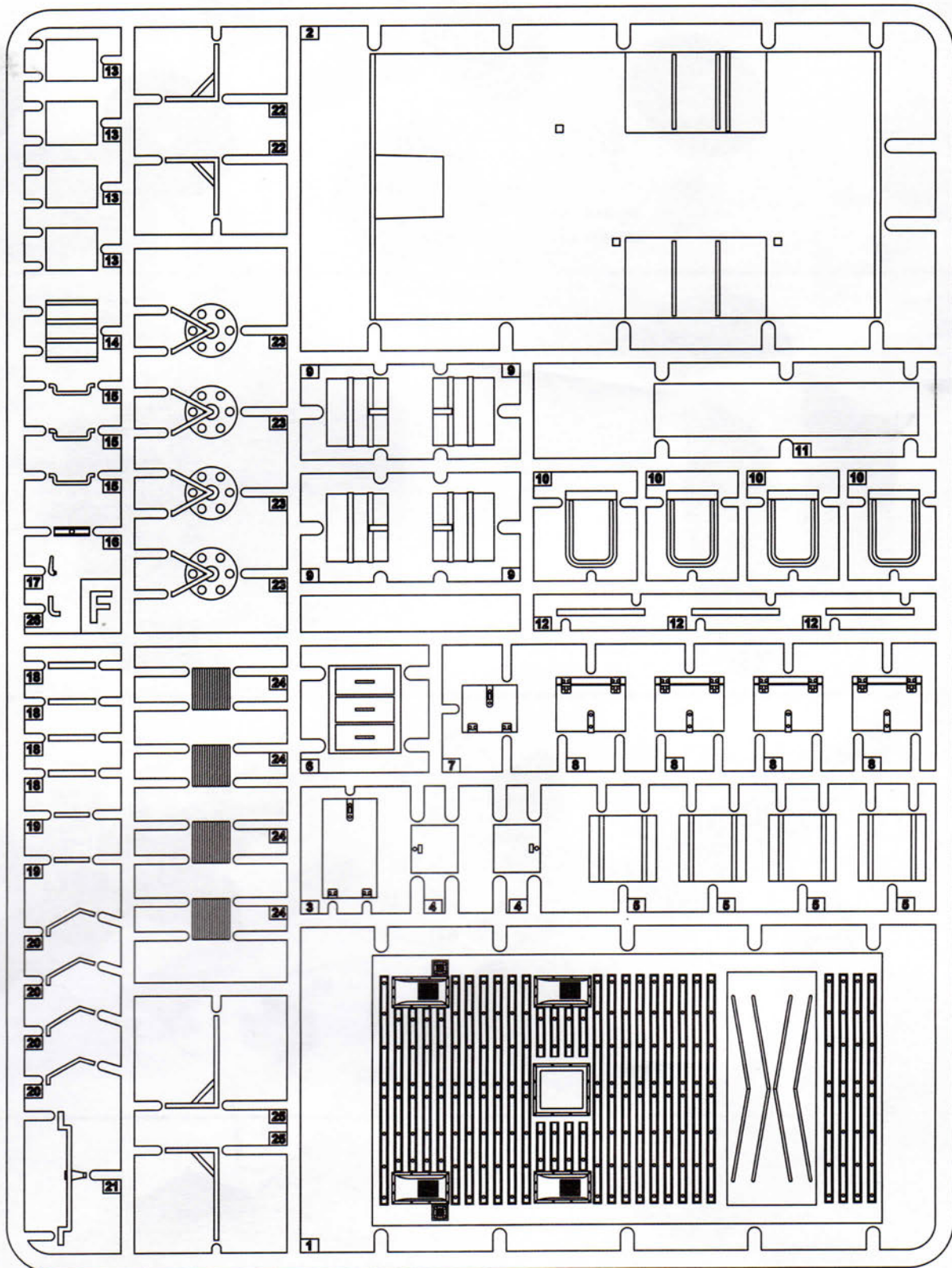

ETAP 1
STEP 1

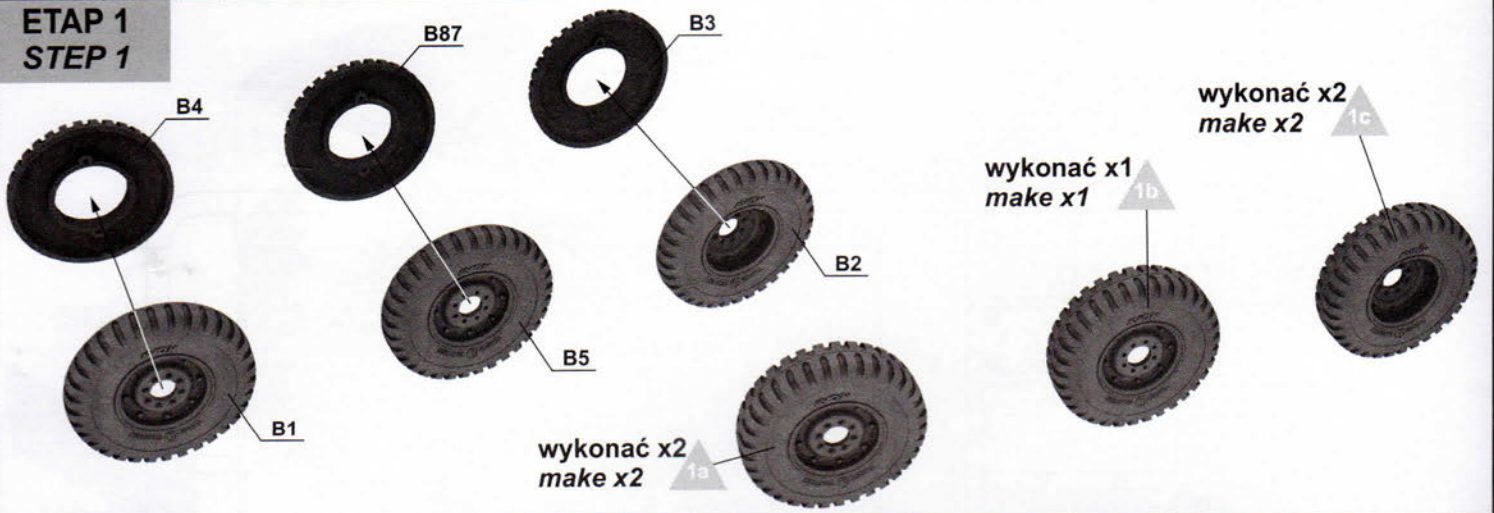

ETAP 2
STEP 2

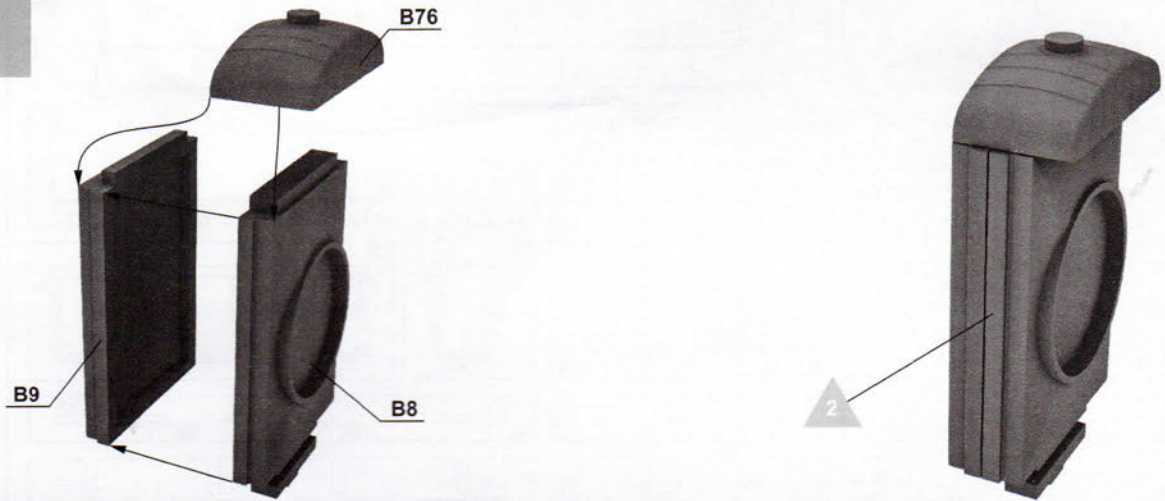

ETAP 3
STEP 3

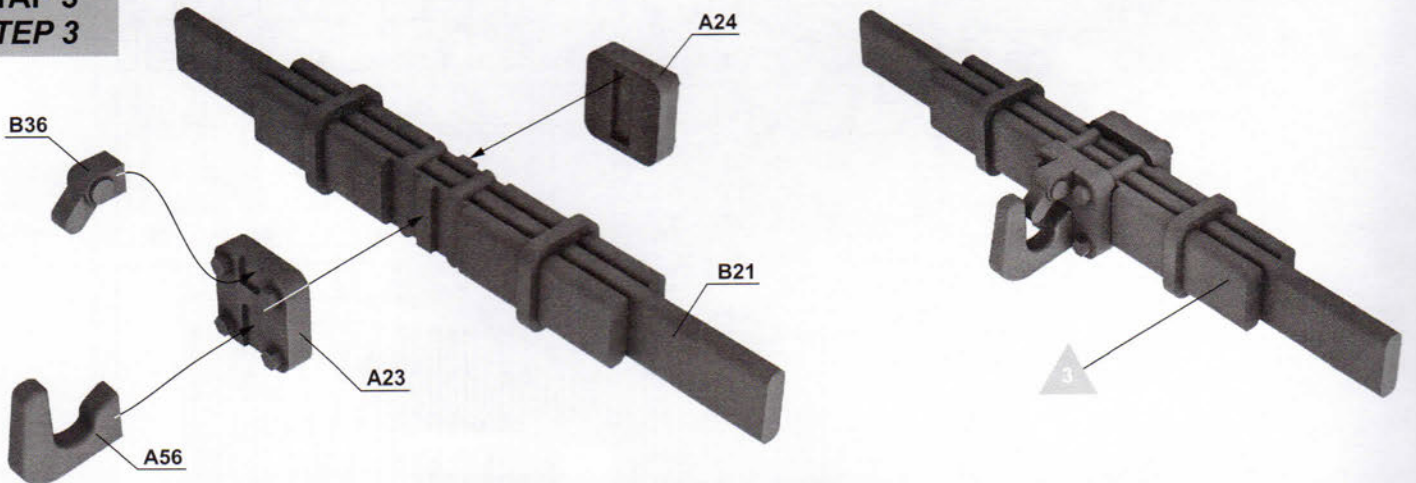

ETAP 4
STEP 4

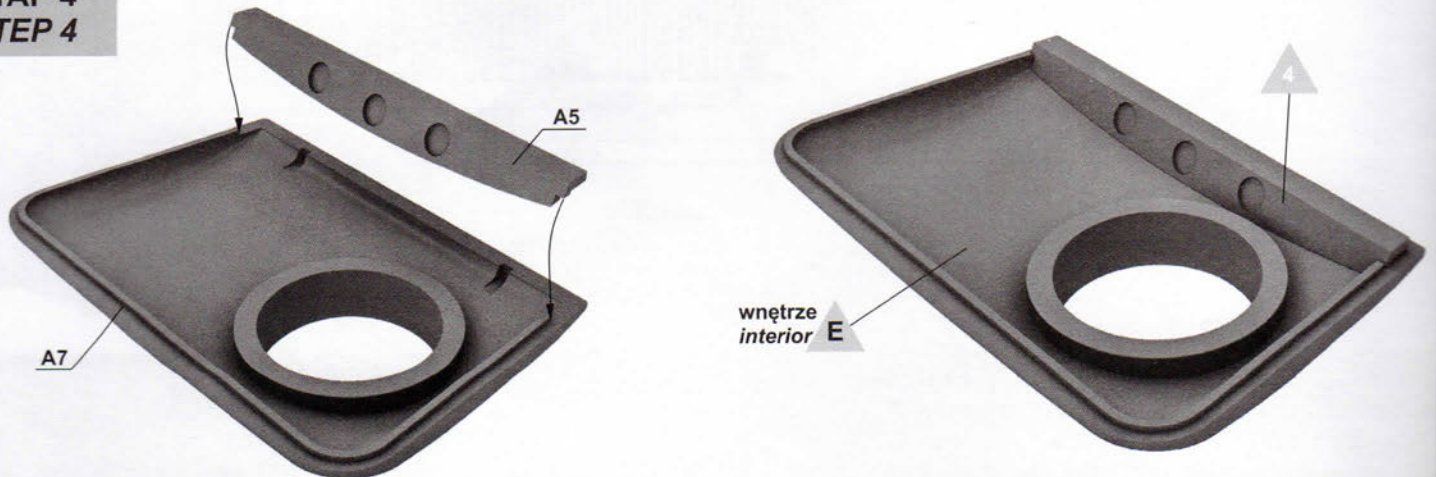

**ETAP 5
STEP 5**

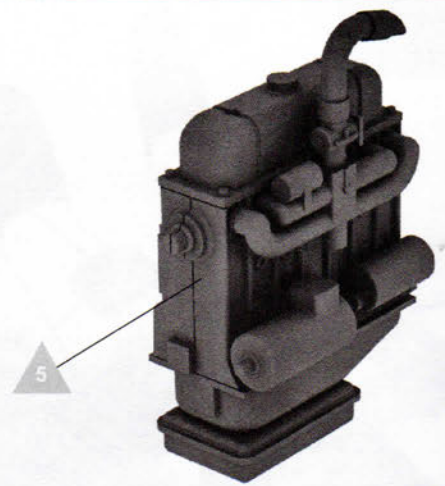
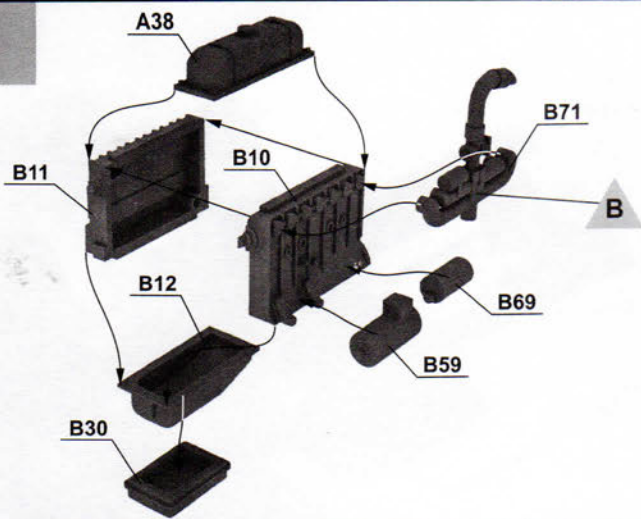

**ETAP 6
STEP 6**

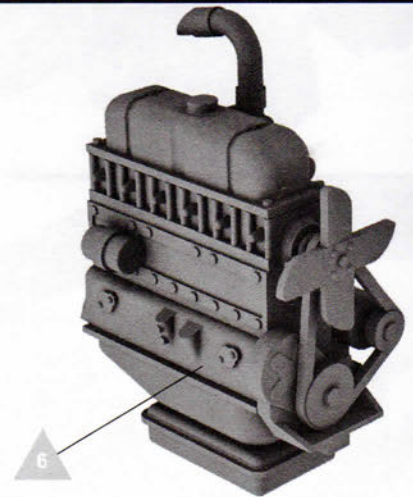
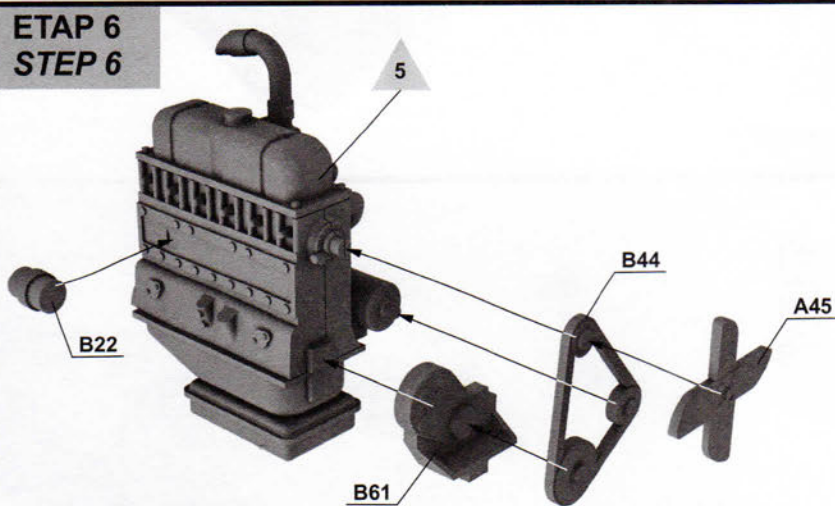

**ETAP 7
STEP 7**

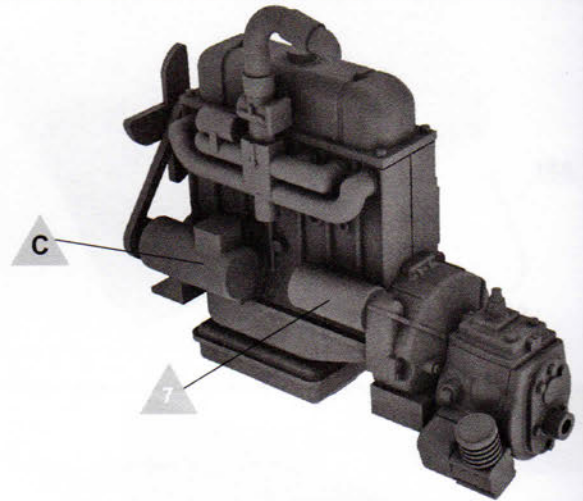
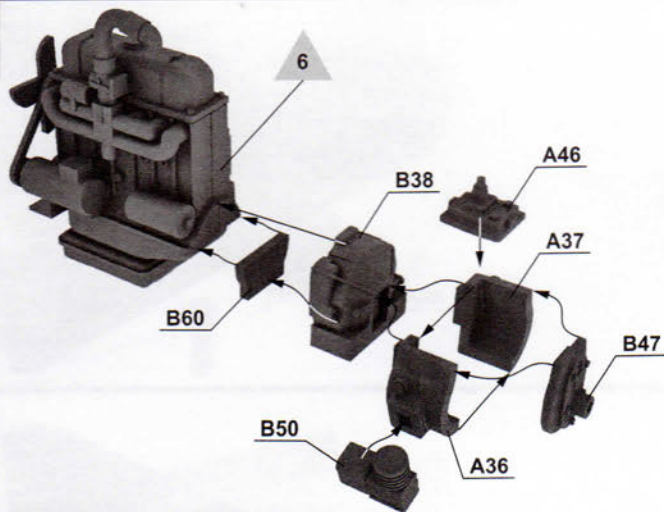

**ETAP 8
STEP 8**

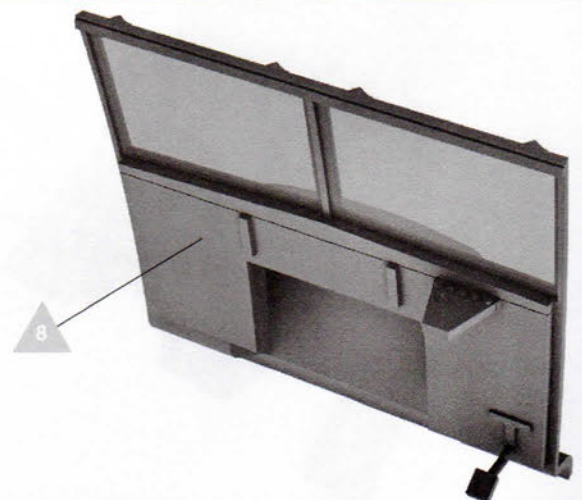
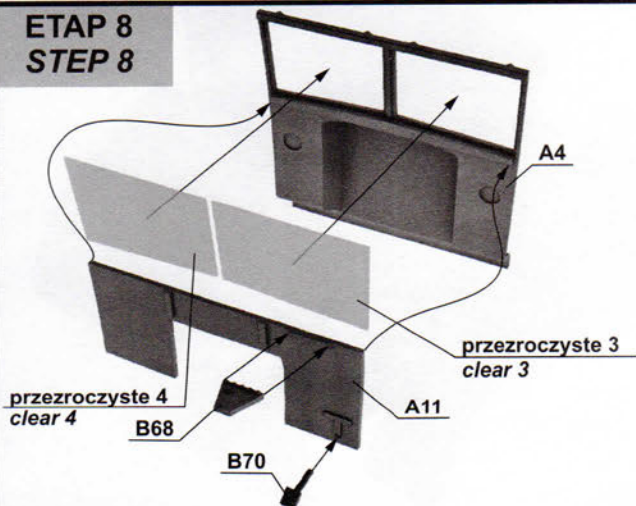

ETAP 9
STEP 9

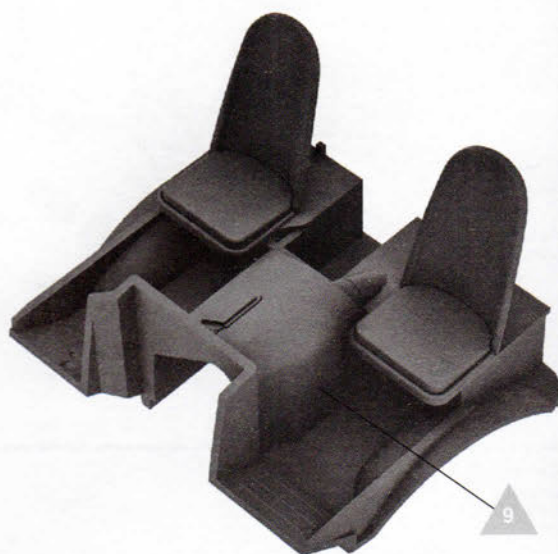
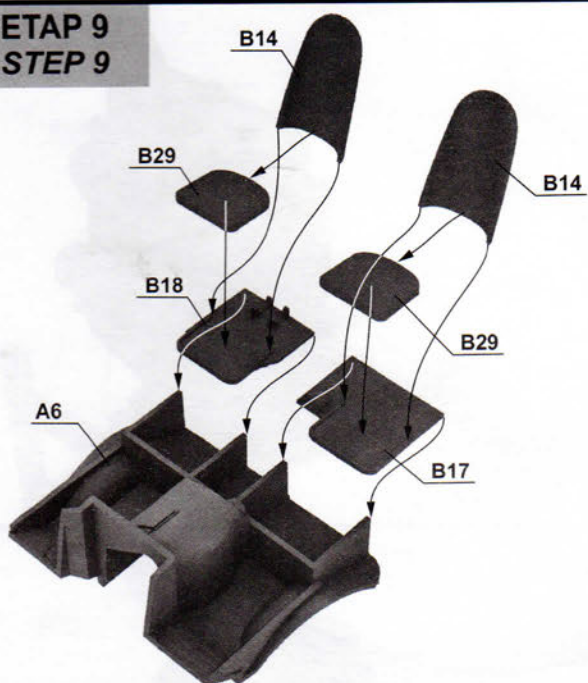

ETAP 10
STEP 10

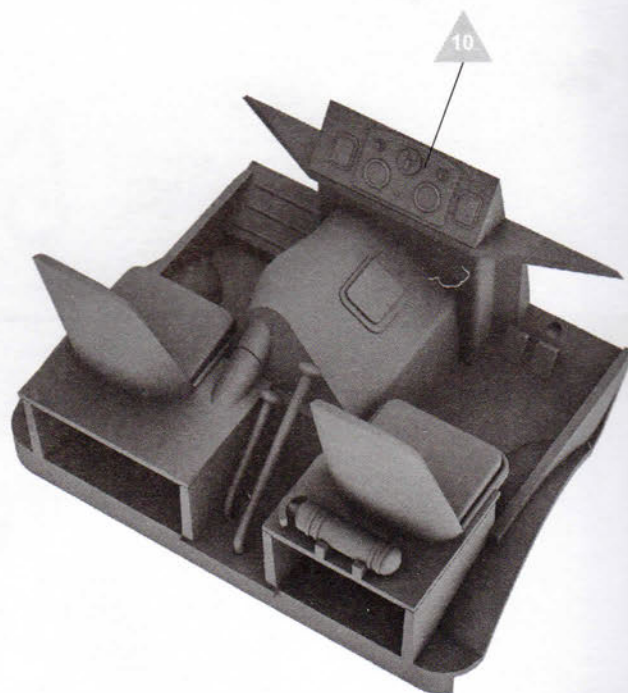
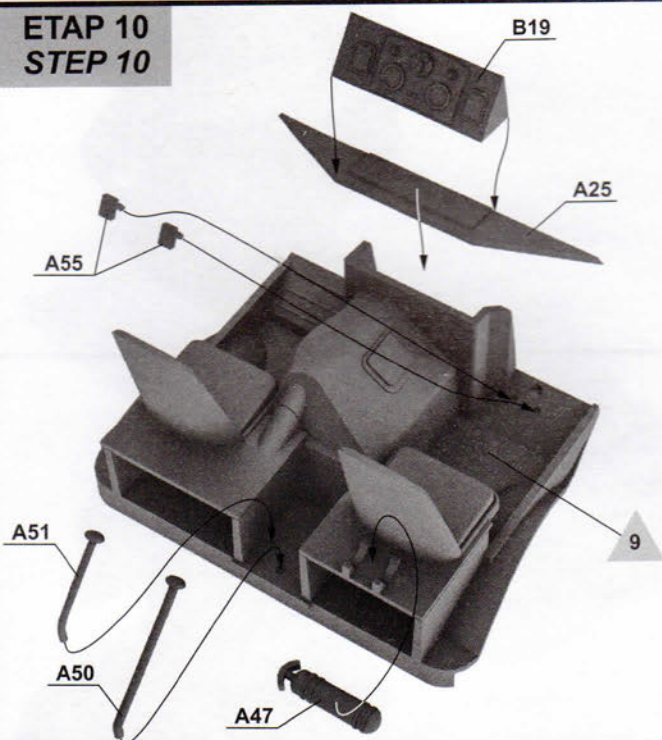

ETAP 11
STEP 11

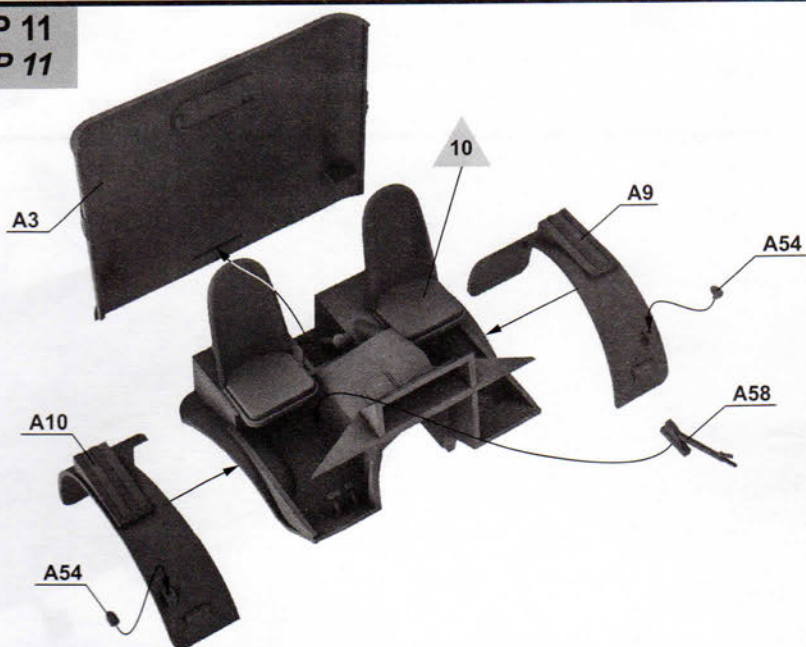

**ETAP 12
STEP 12**

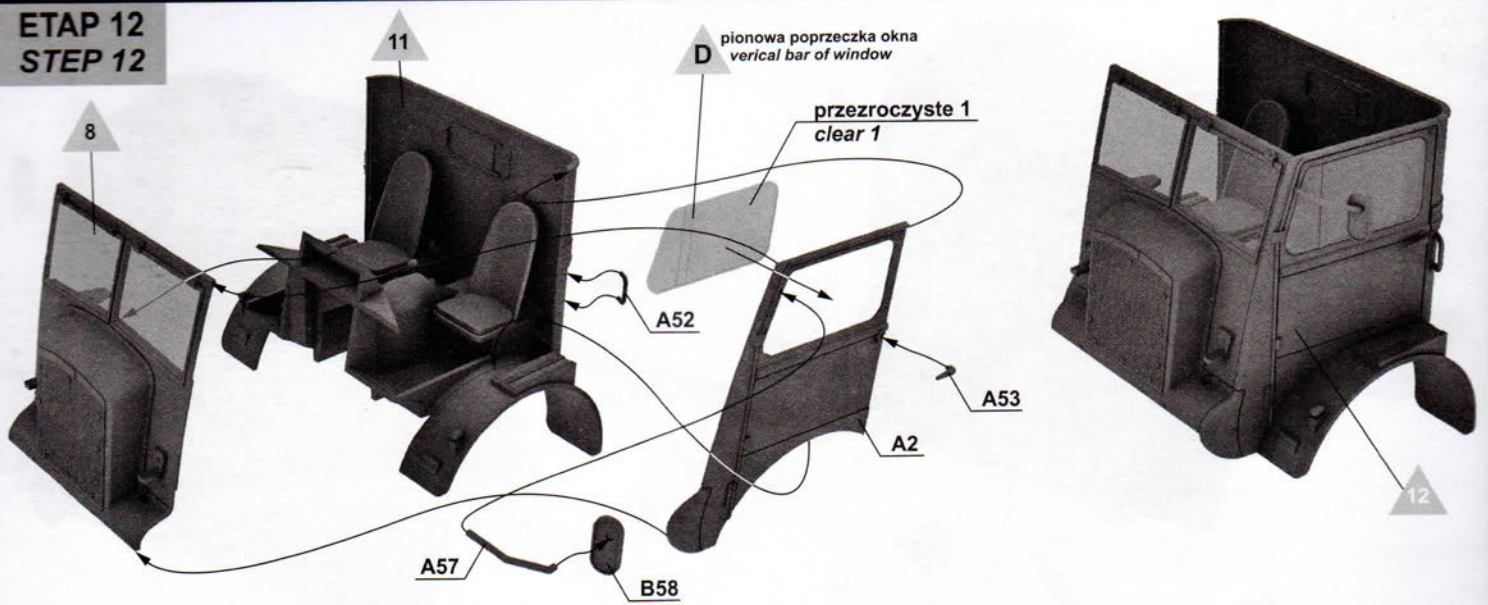

**ETAP 13
STEP 13**

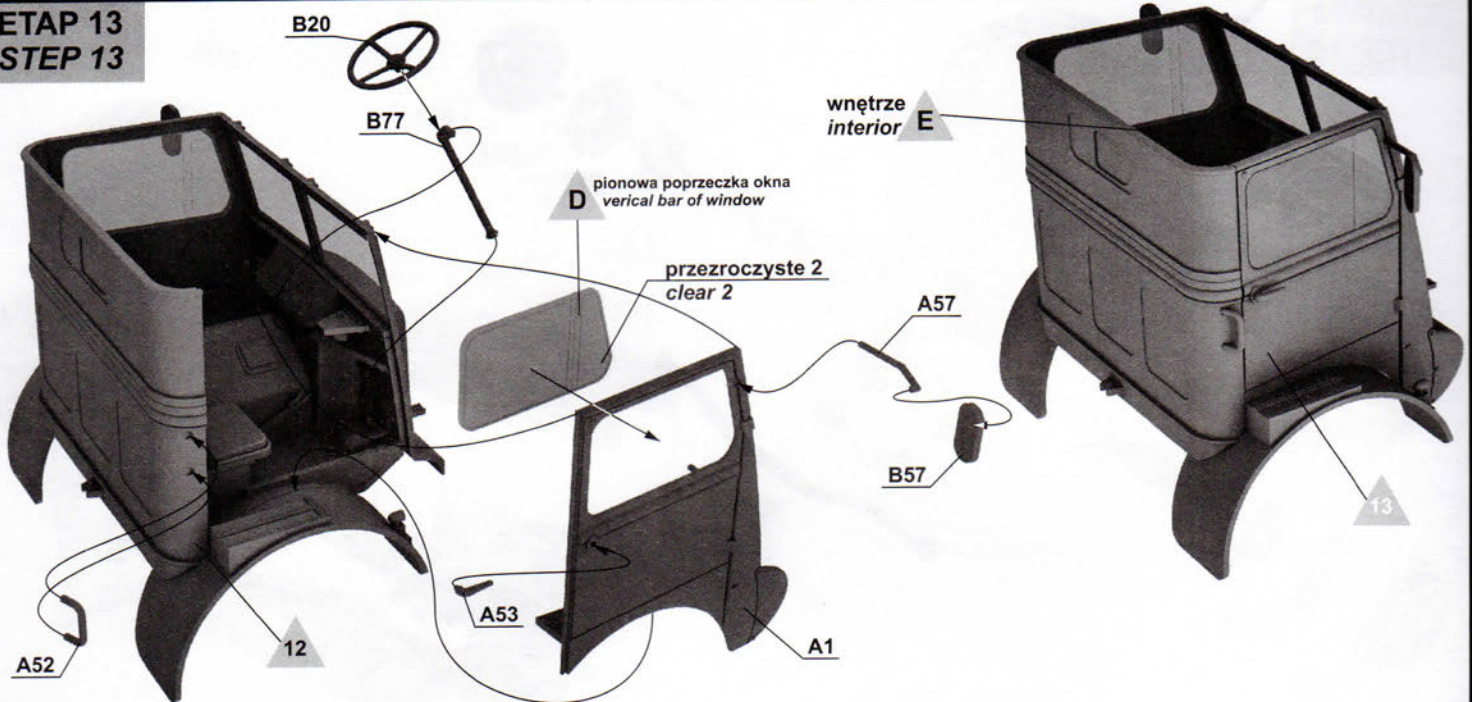

**ETAP 14
STEP 14**

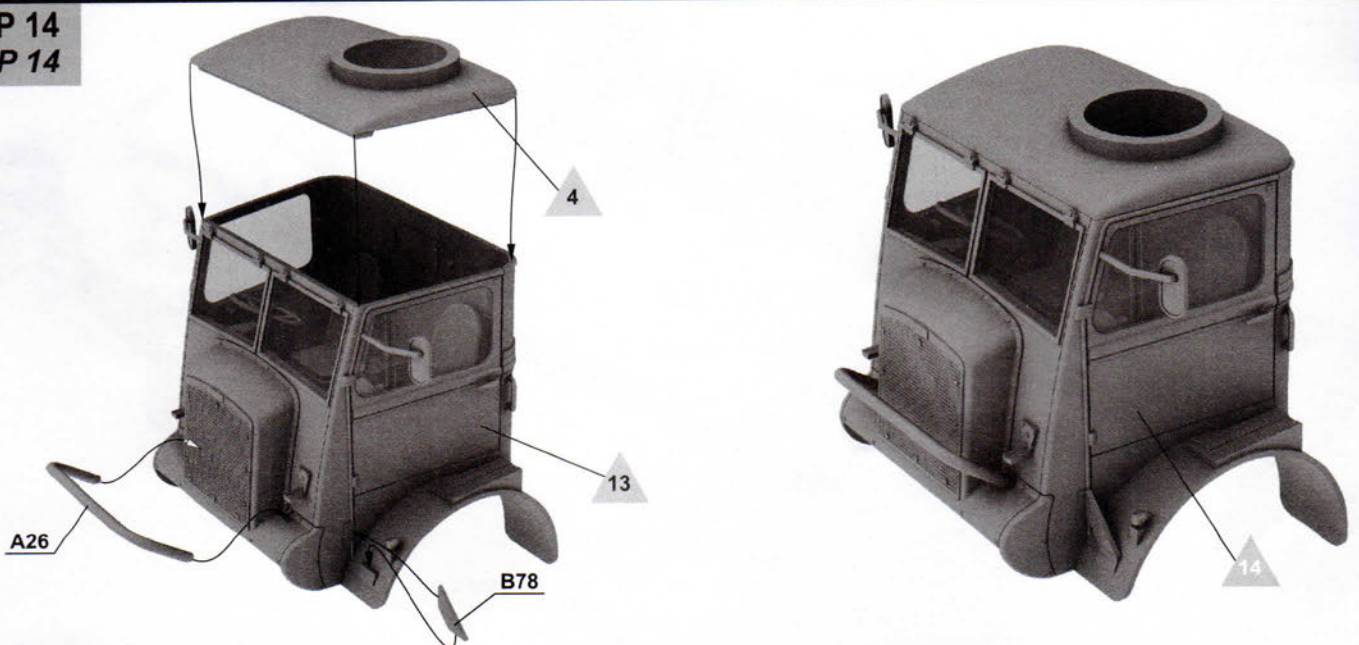

ETAP 15
STEP 15

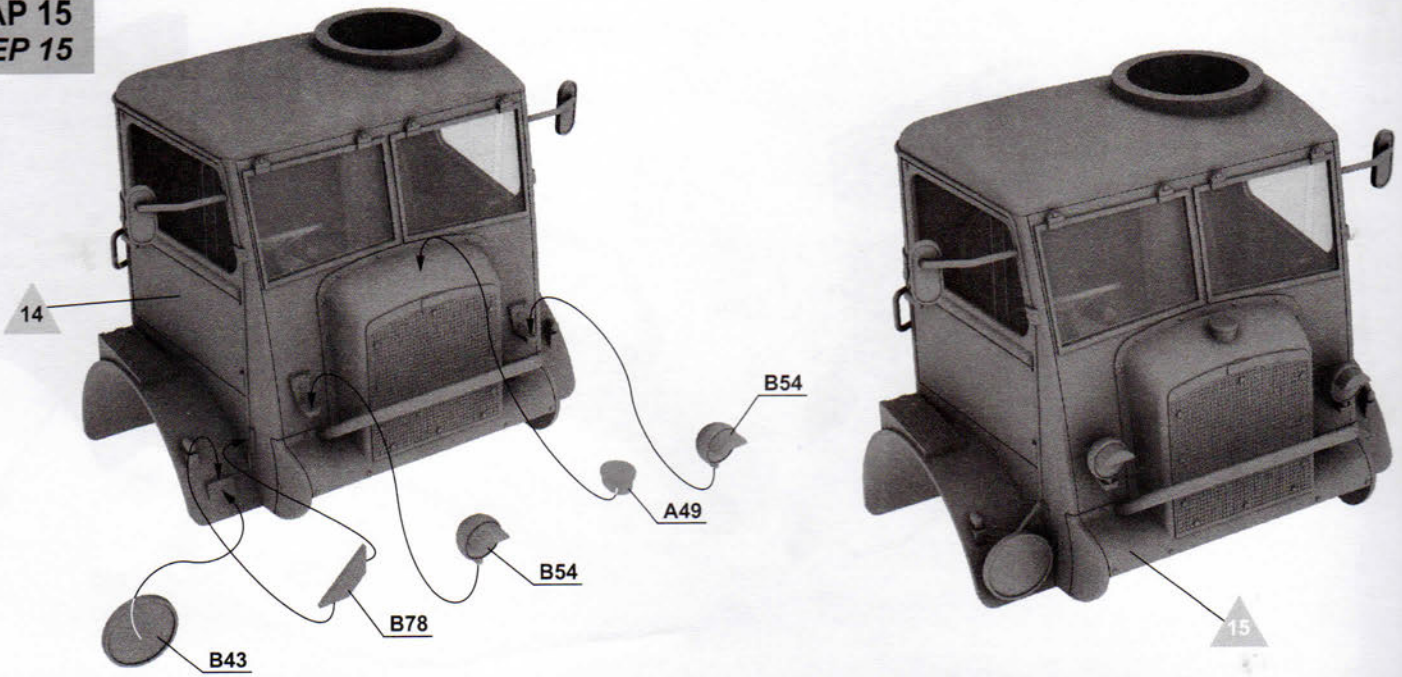

ETAP 16
STEP 16

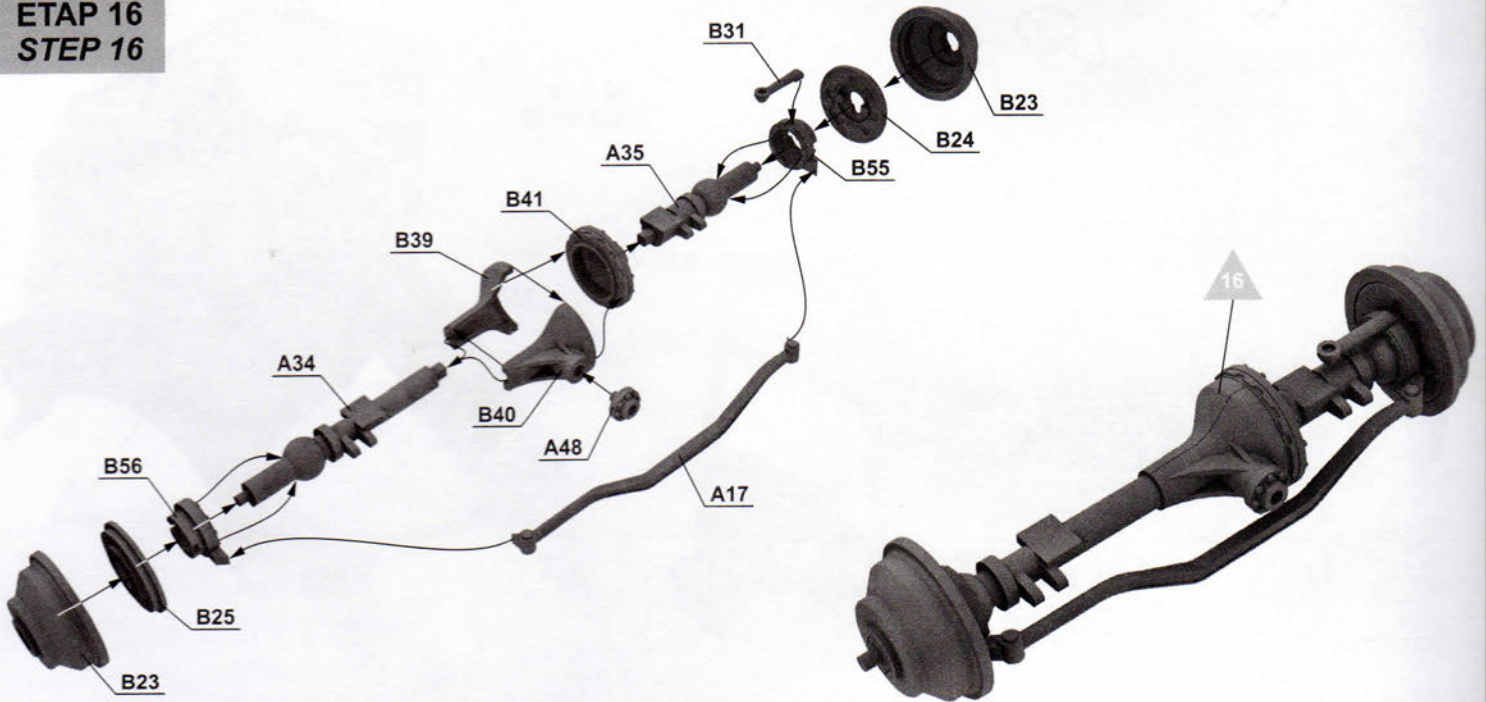

ETAP 17
STEP 17

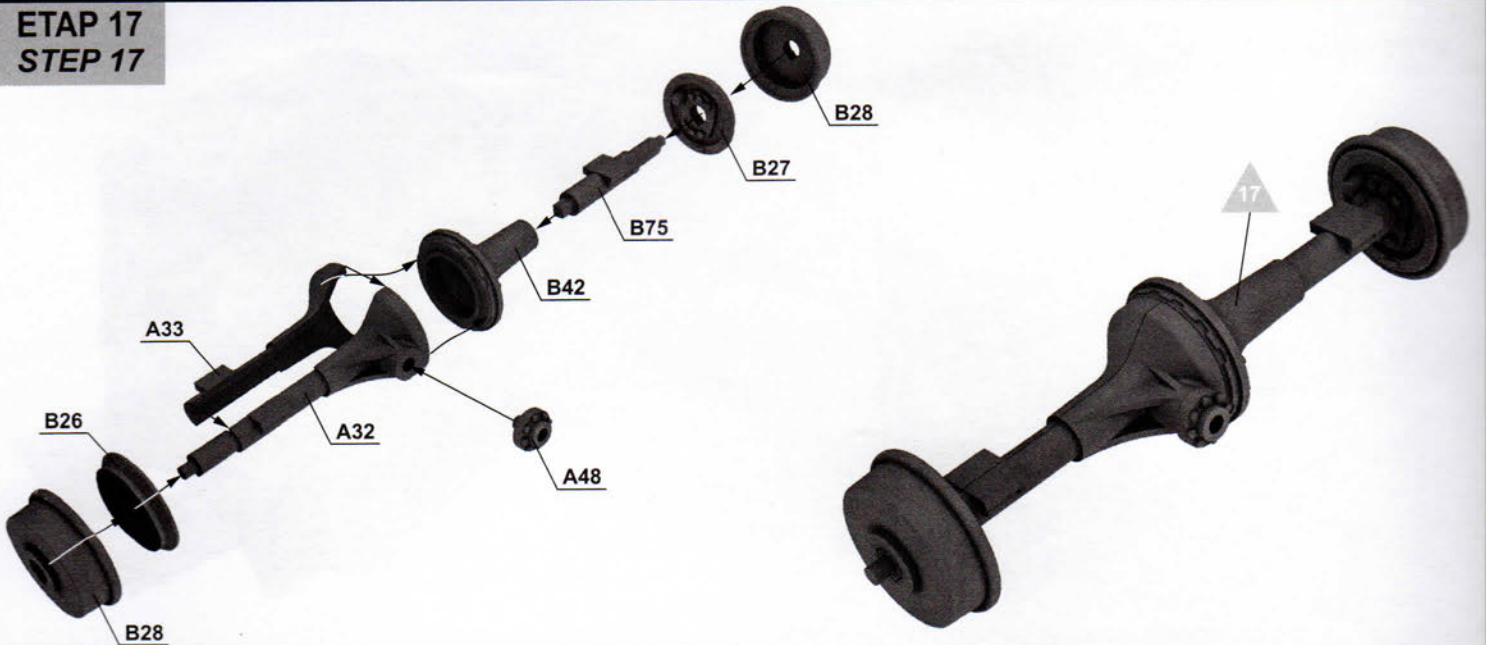

ETAP 18
STEP 18

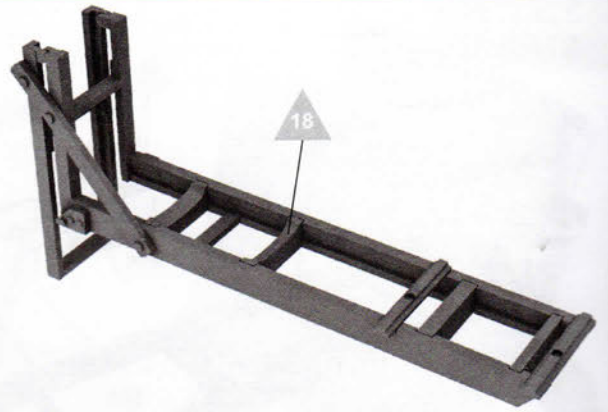
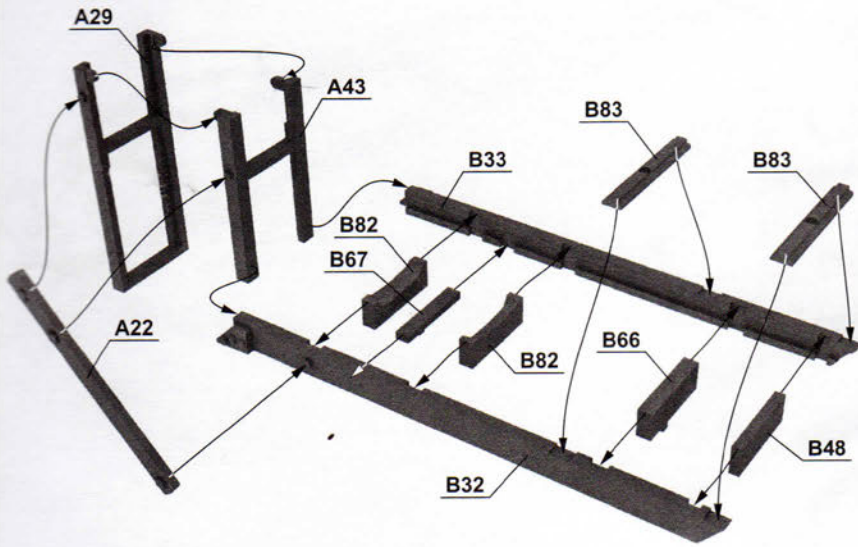

ETAP 19
STEP 19

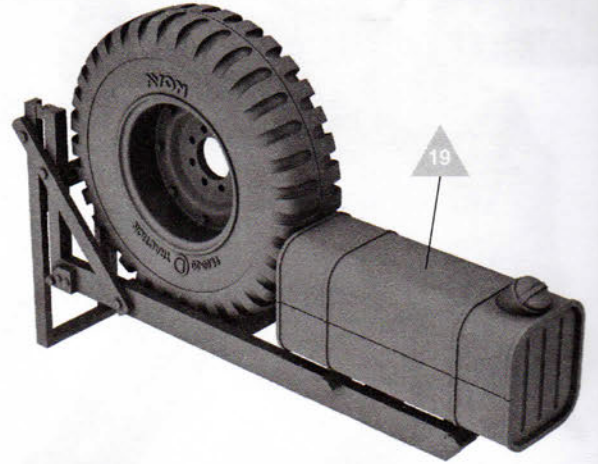
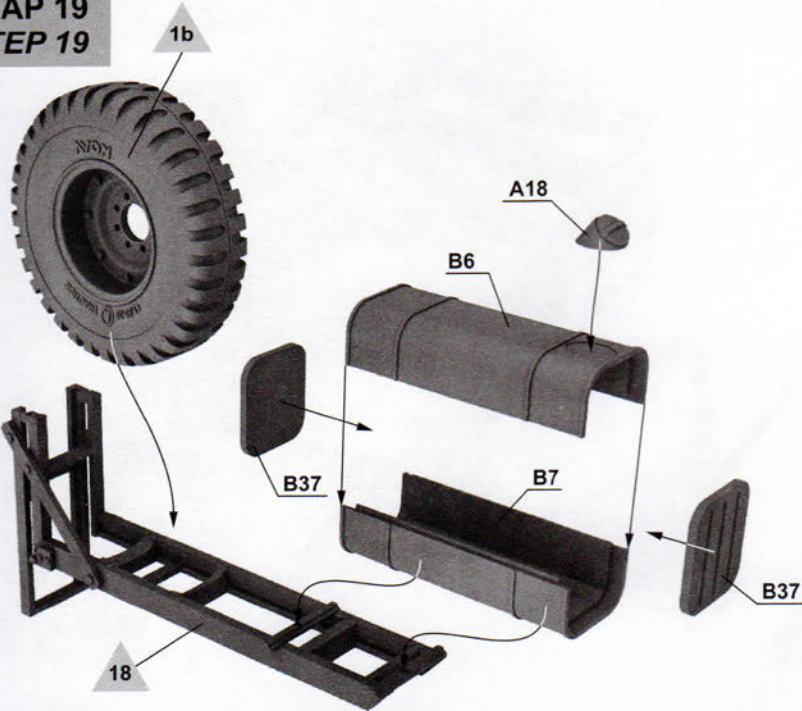

ETAP 20
STEP 20

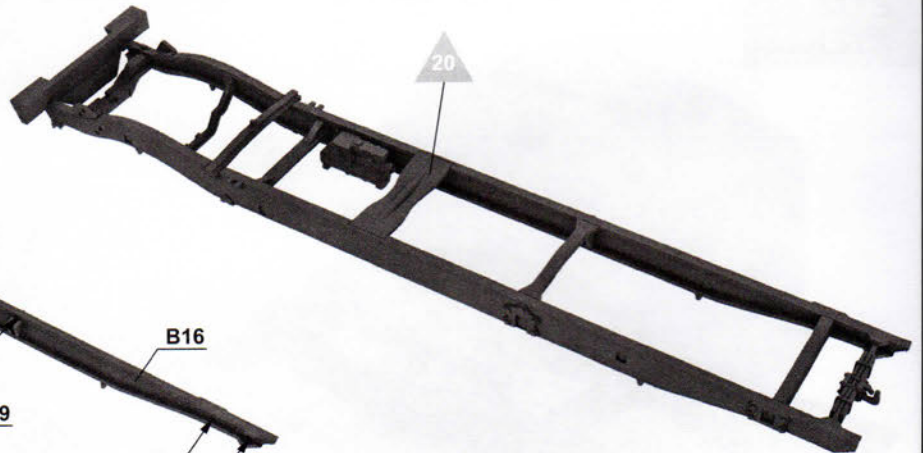
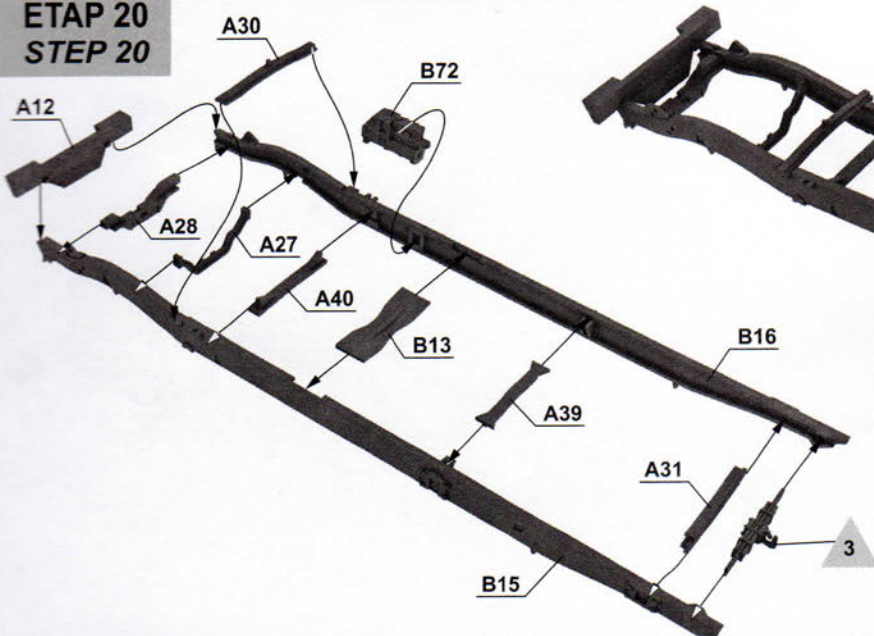

**ETAP 12
STEP 12**

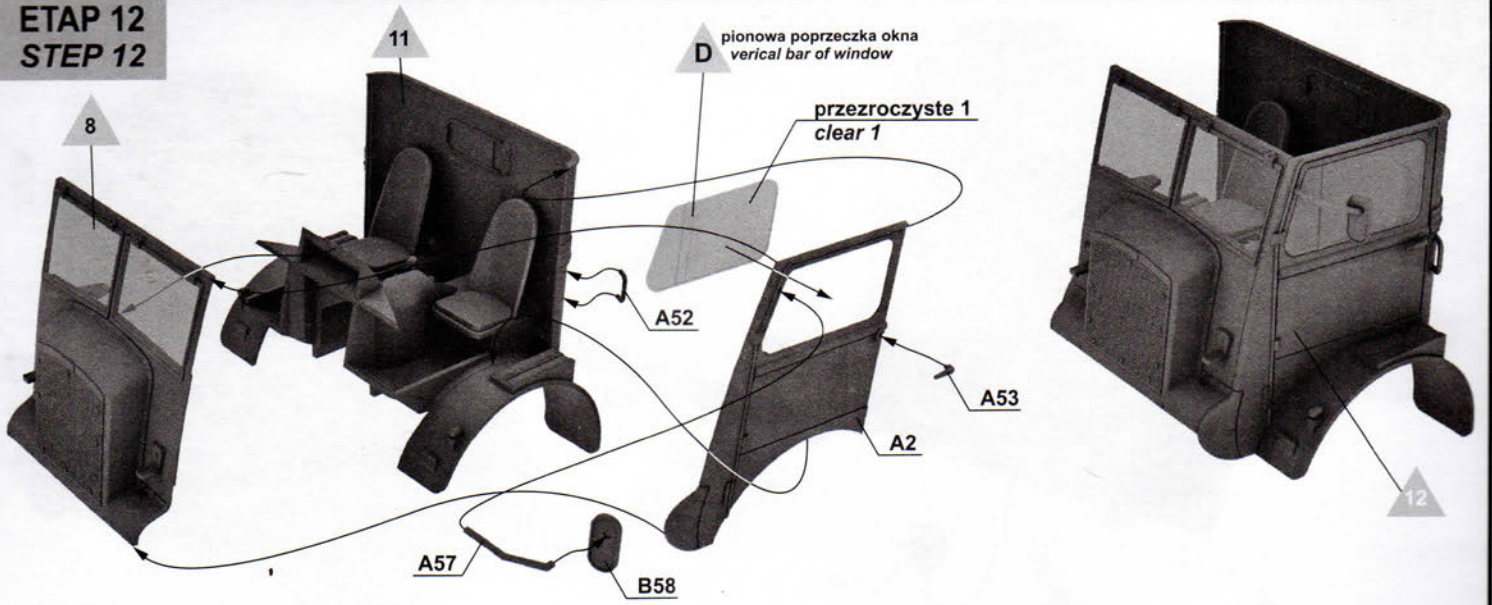

**ETAP 13
STEP 13**

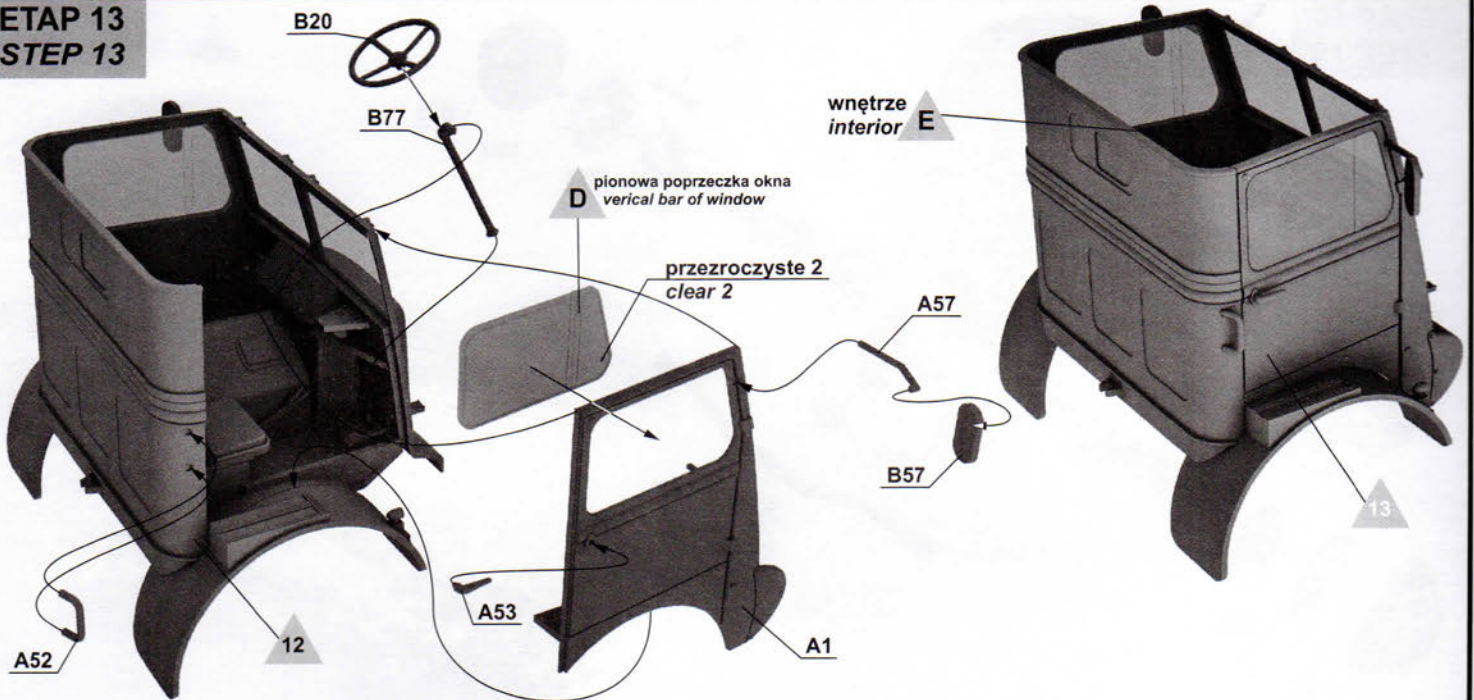

**ETAP 14
STEP 14**

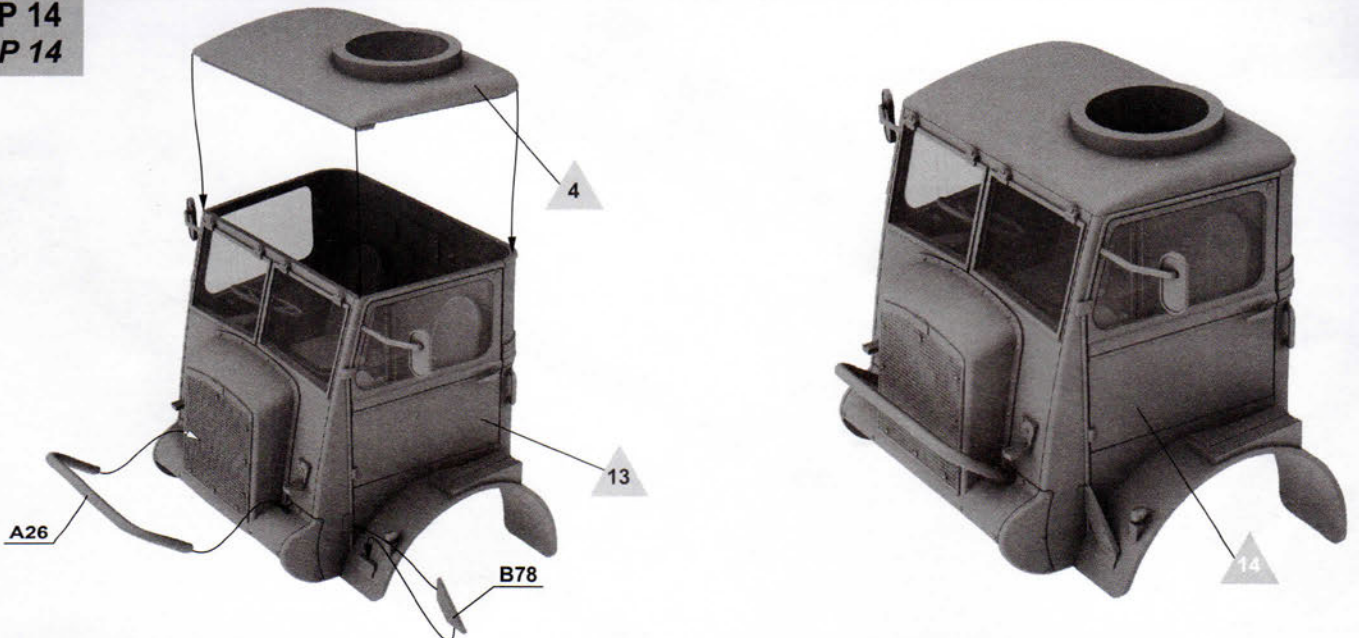

ETAP 24
STEP 24

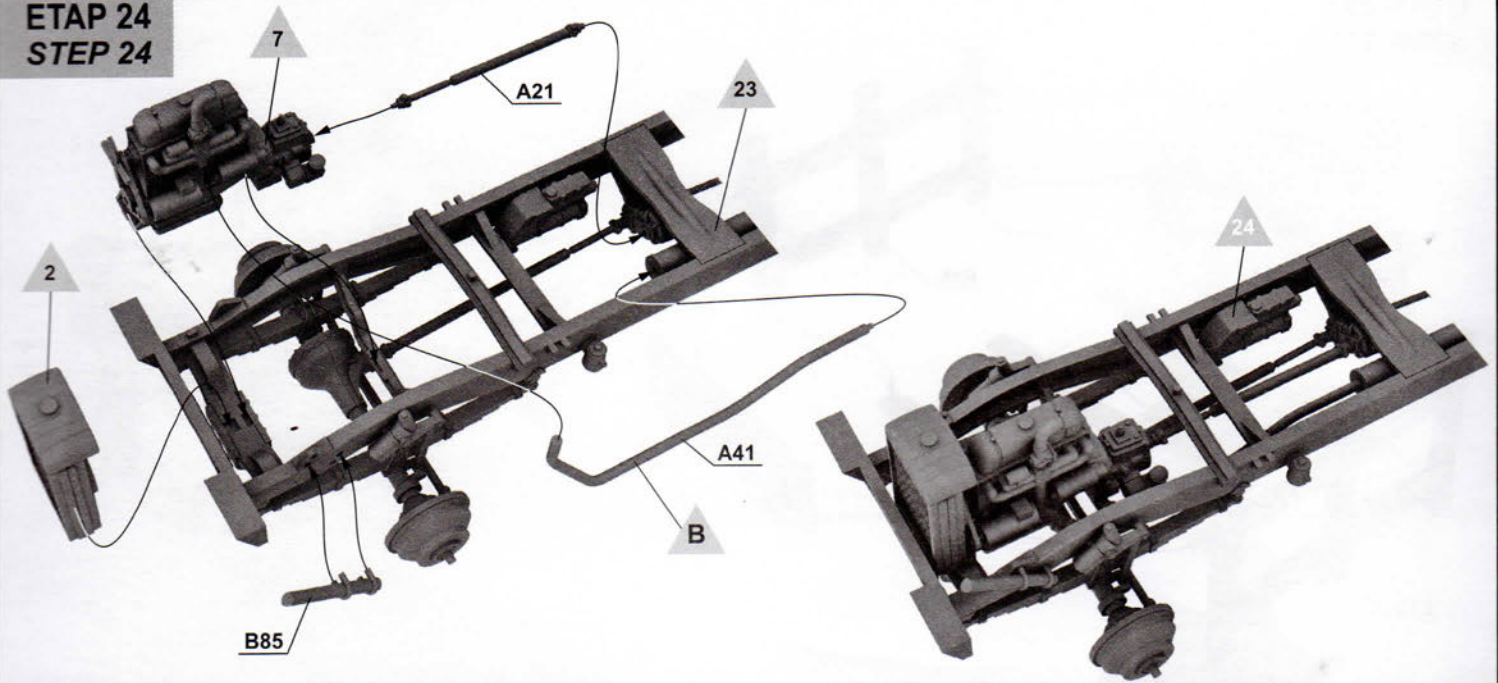

ETAP 25
STEP 25

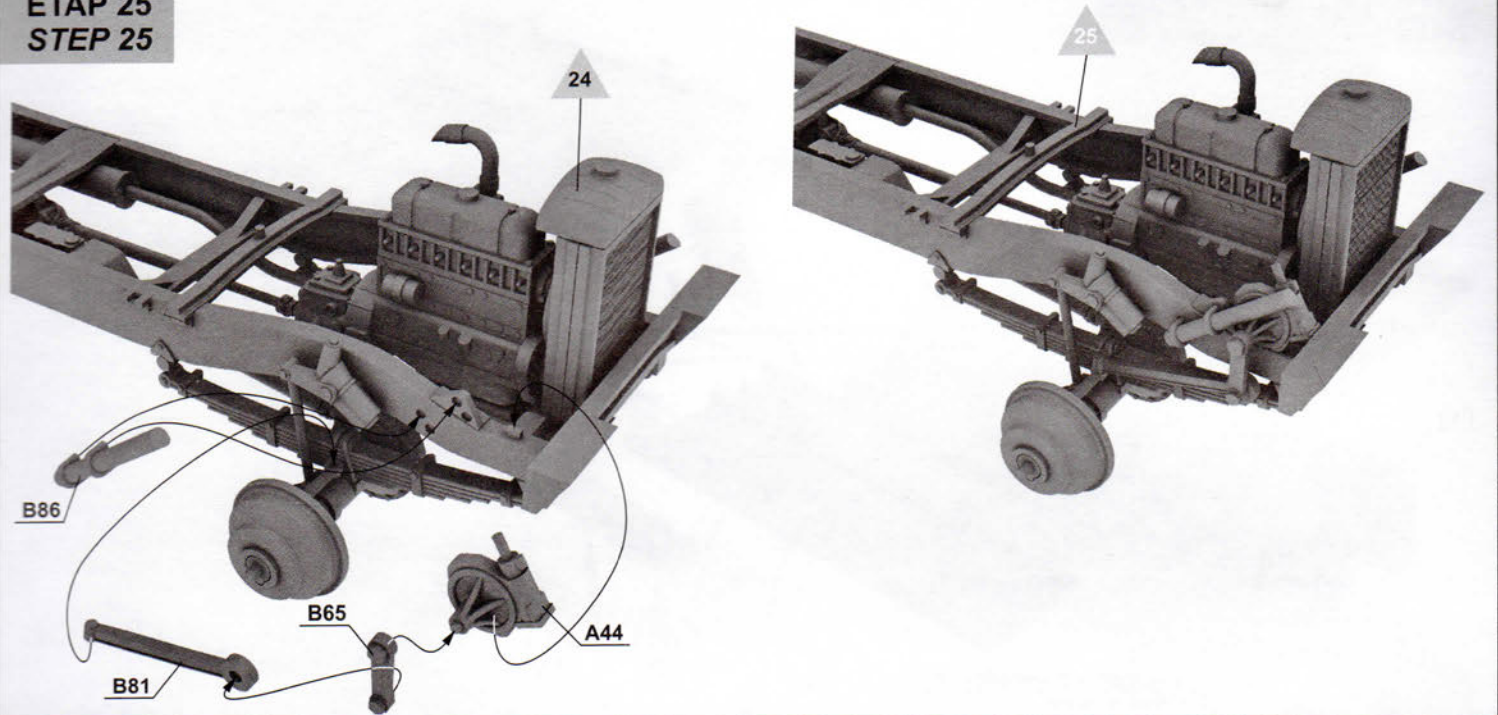

ETAP 26
STEP 26

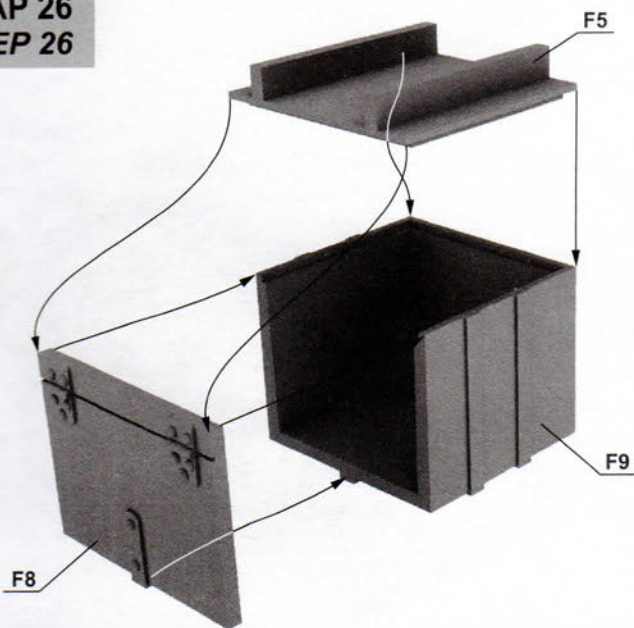

wykonać x4
make x4

26

ETAP 27
STEP 27

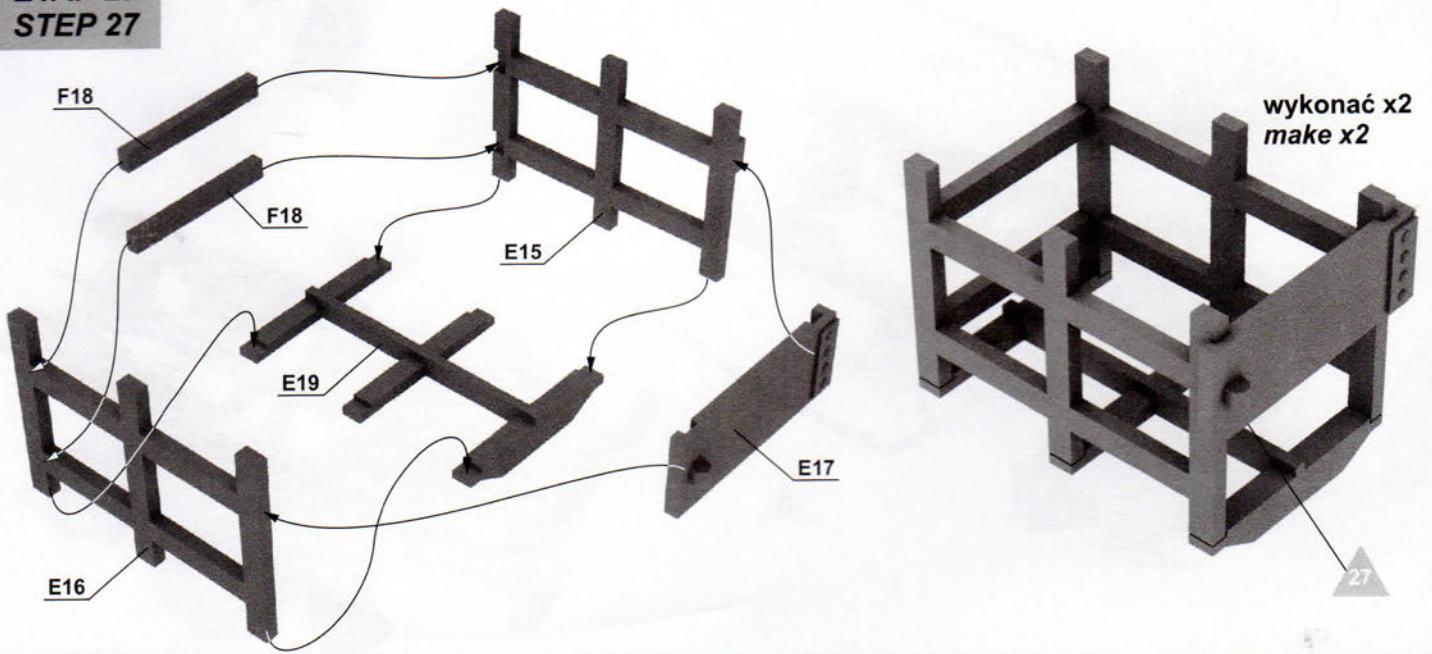

ETAP 28
STEP 28

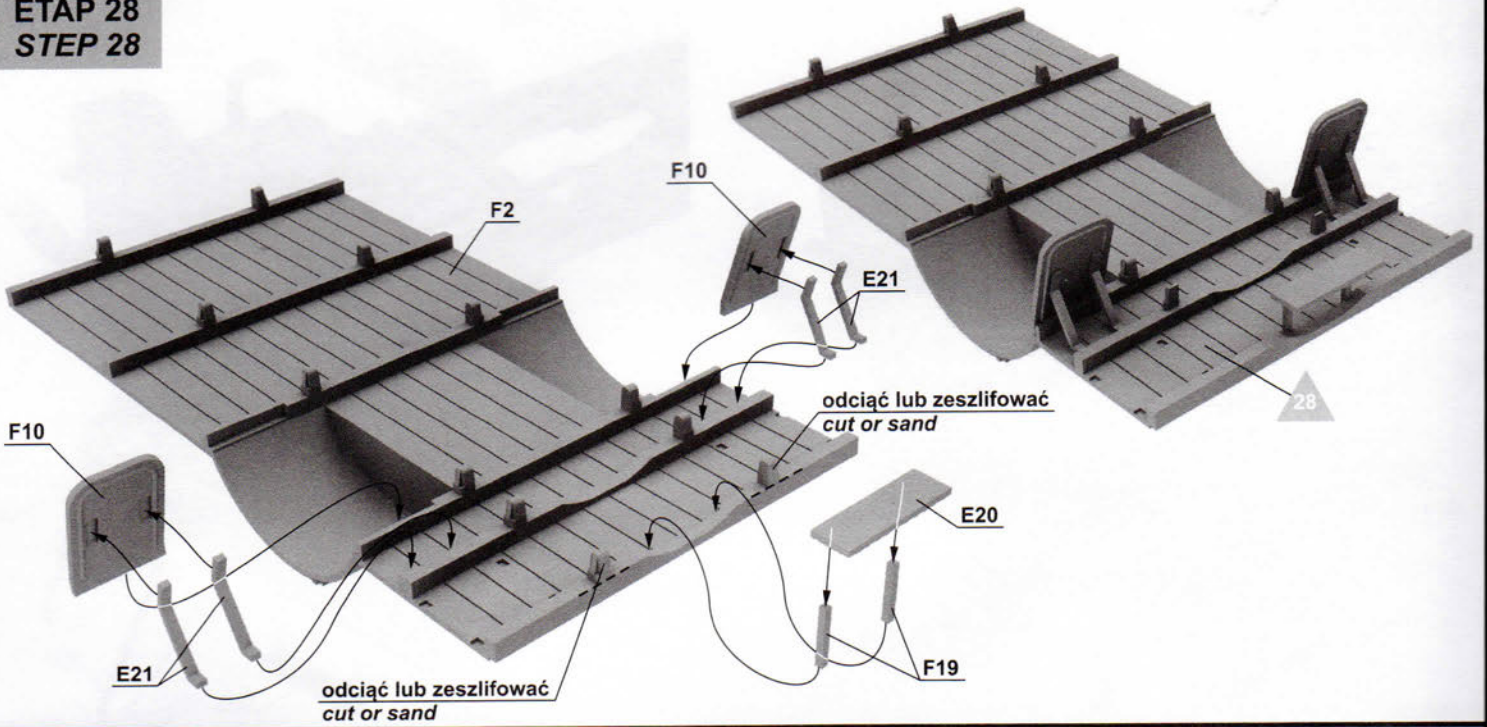

ETAP 29
STEP 29

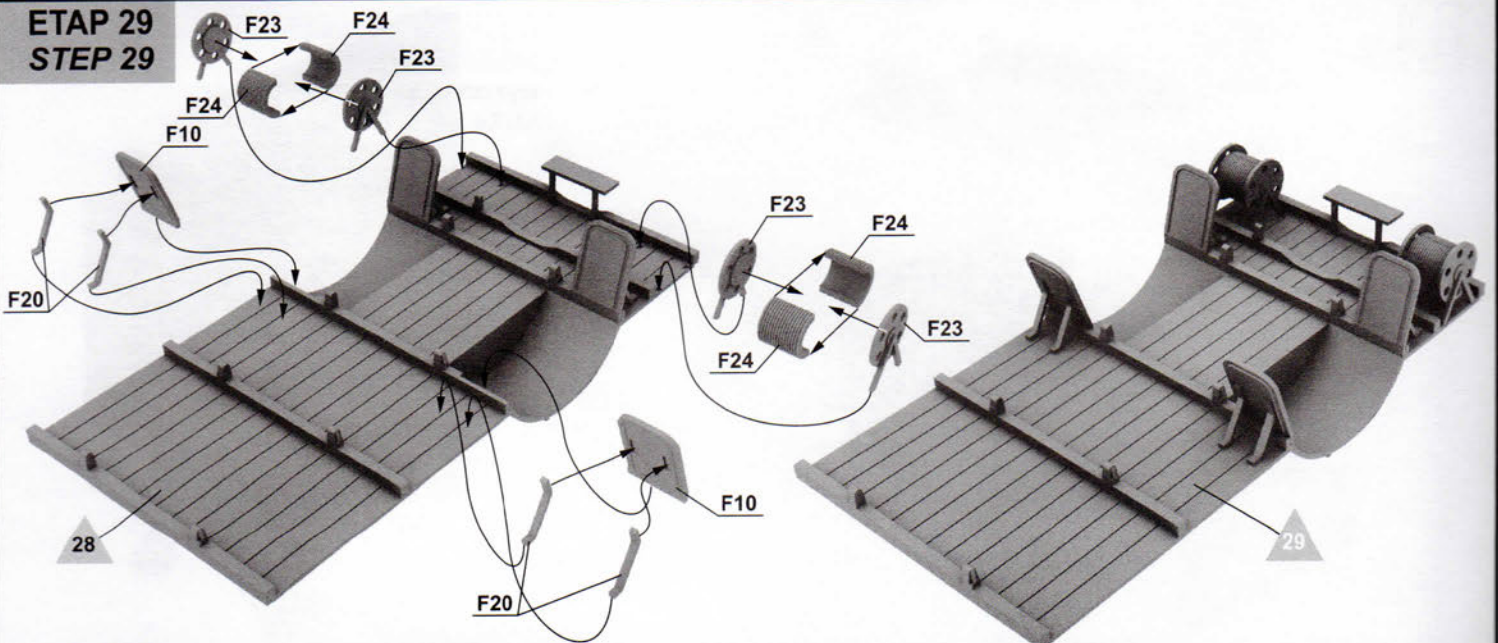

**ETAP 30
STEP 30**

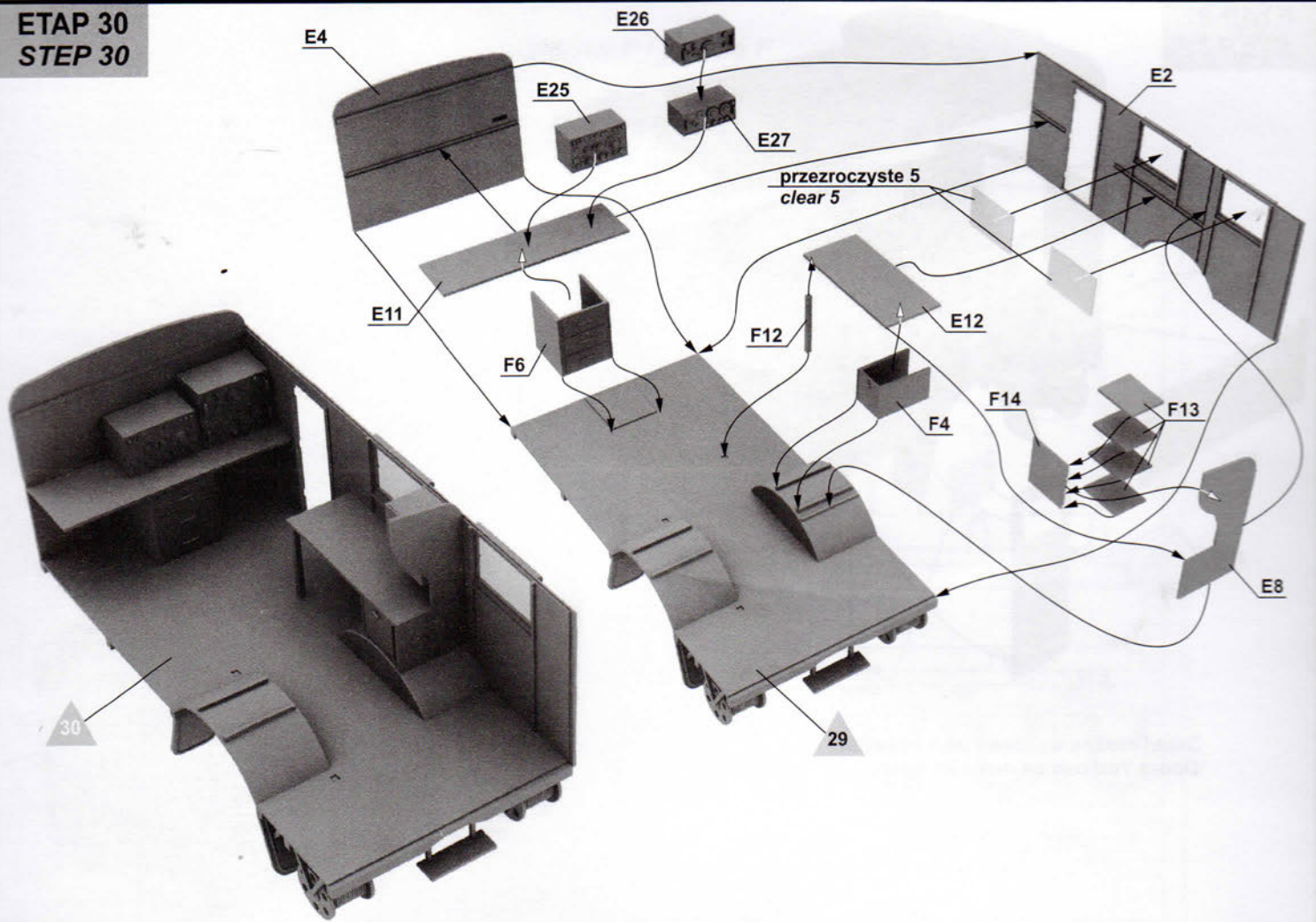

**ETAP 31
STEP 31**

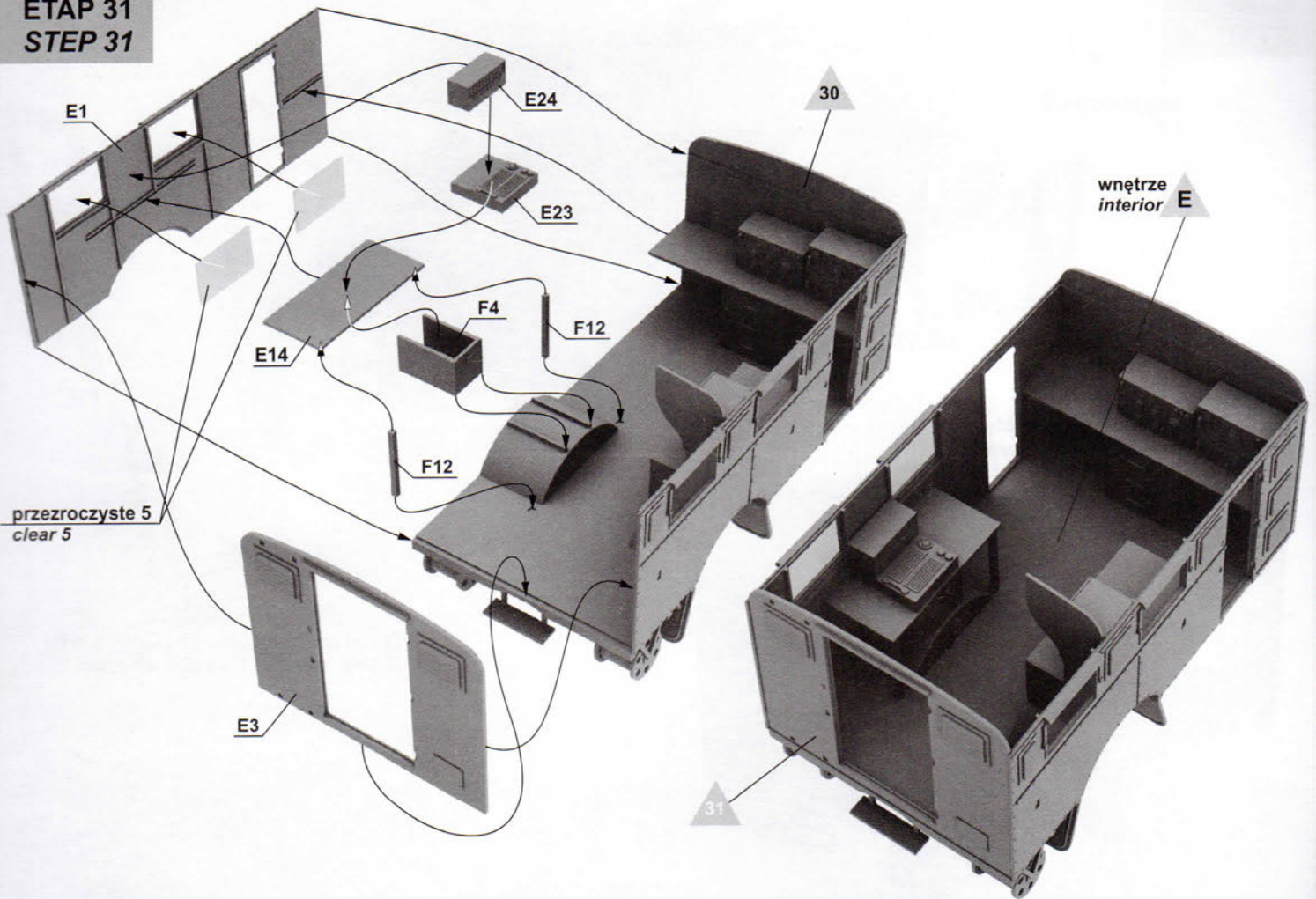

ETAP 32
STEP 32

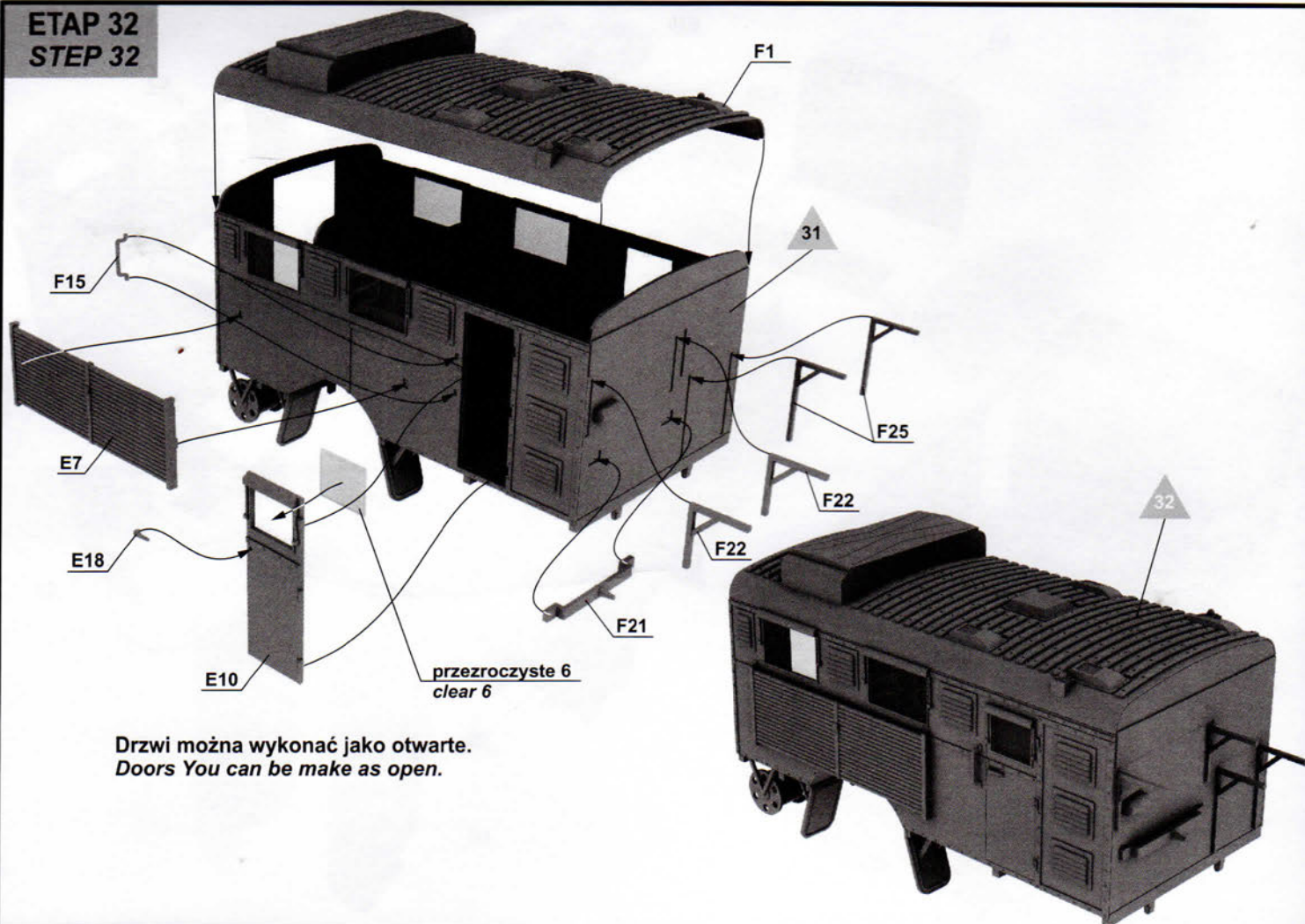

Drzwi można wykonać jako otwarte.
Doors You can be make as open.

ETAP 33
STEP 33

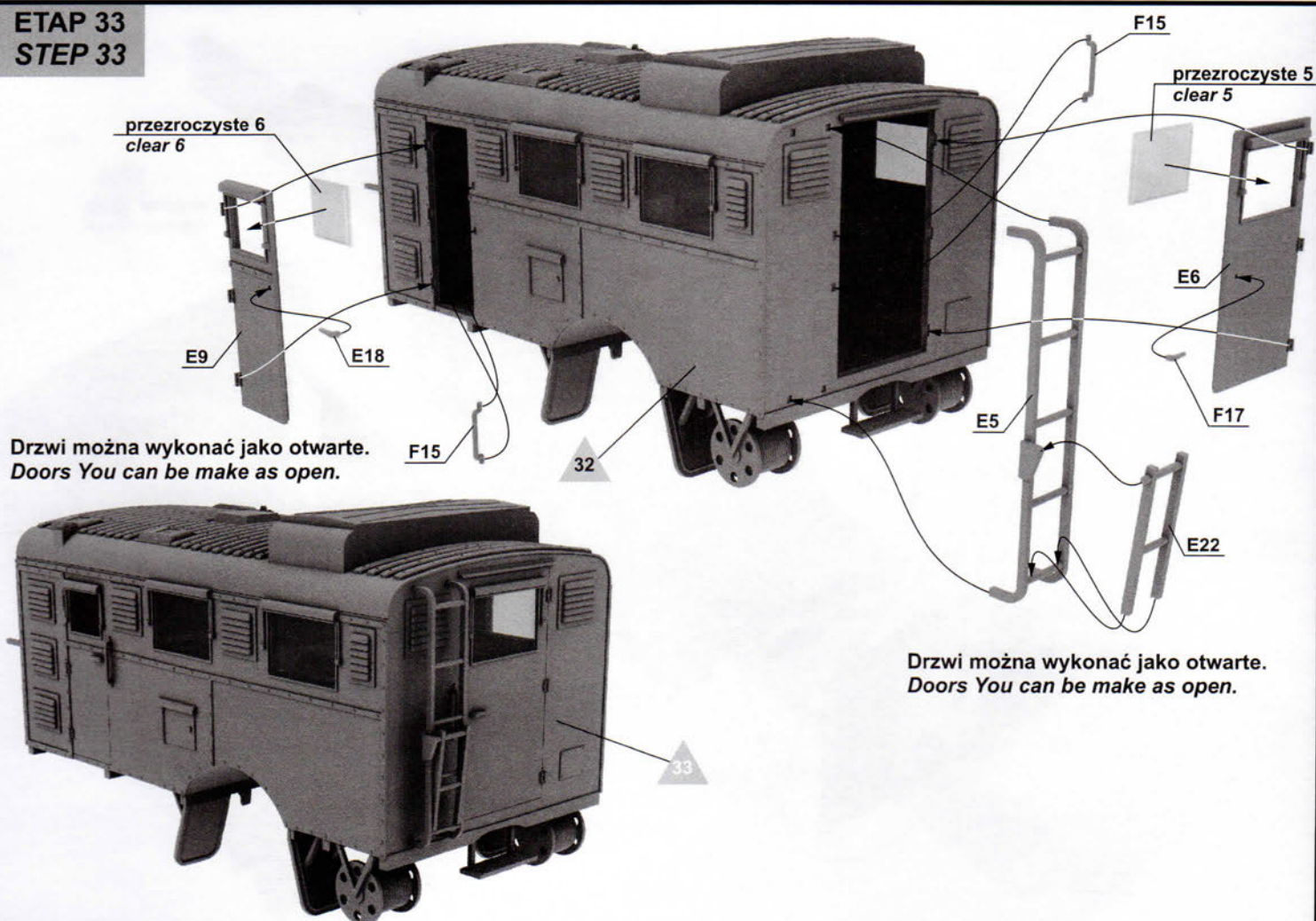

Drzwi można wykonać jako otwarte.
Doors You can be make as open.

Drzwi można wykonać jako otwarte.
Doors You can be make as open.

ETAP 34
STEP 34

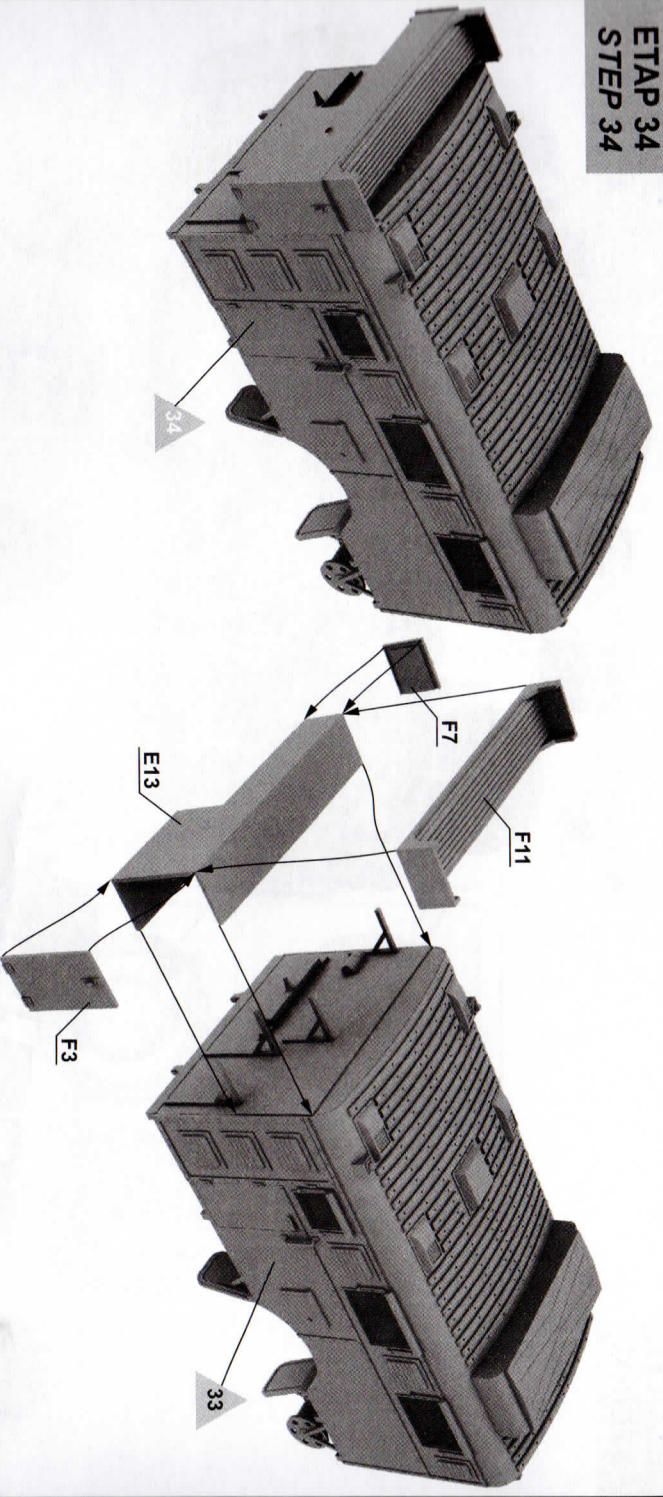

ETAP 35
STEP 35

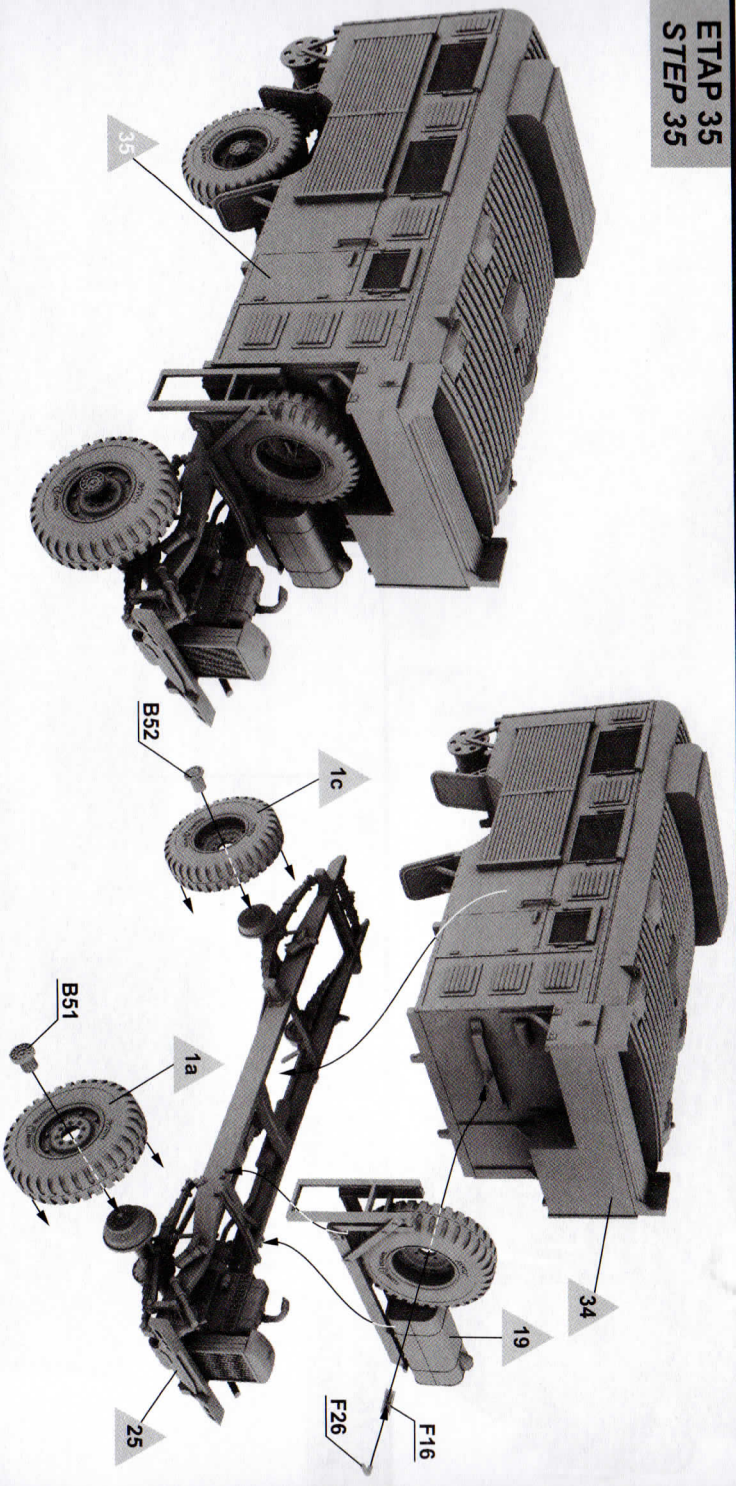

ETAP 36
STEP 36

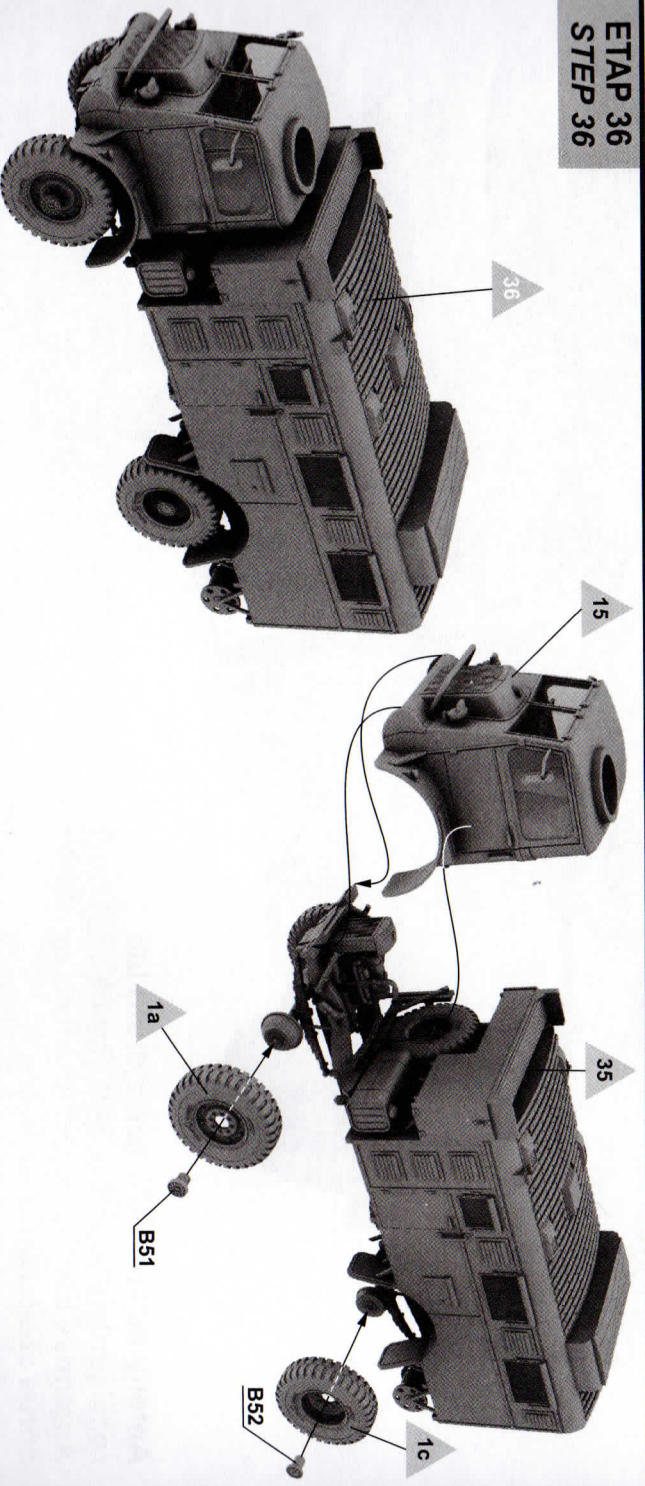

ETAP 37
STEP 37

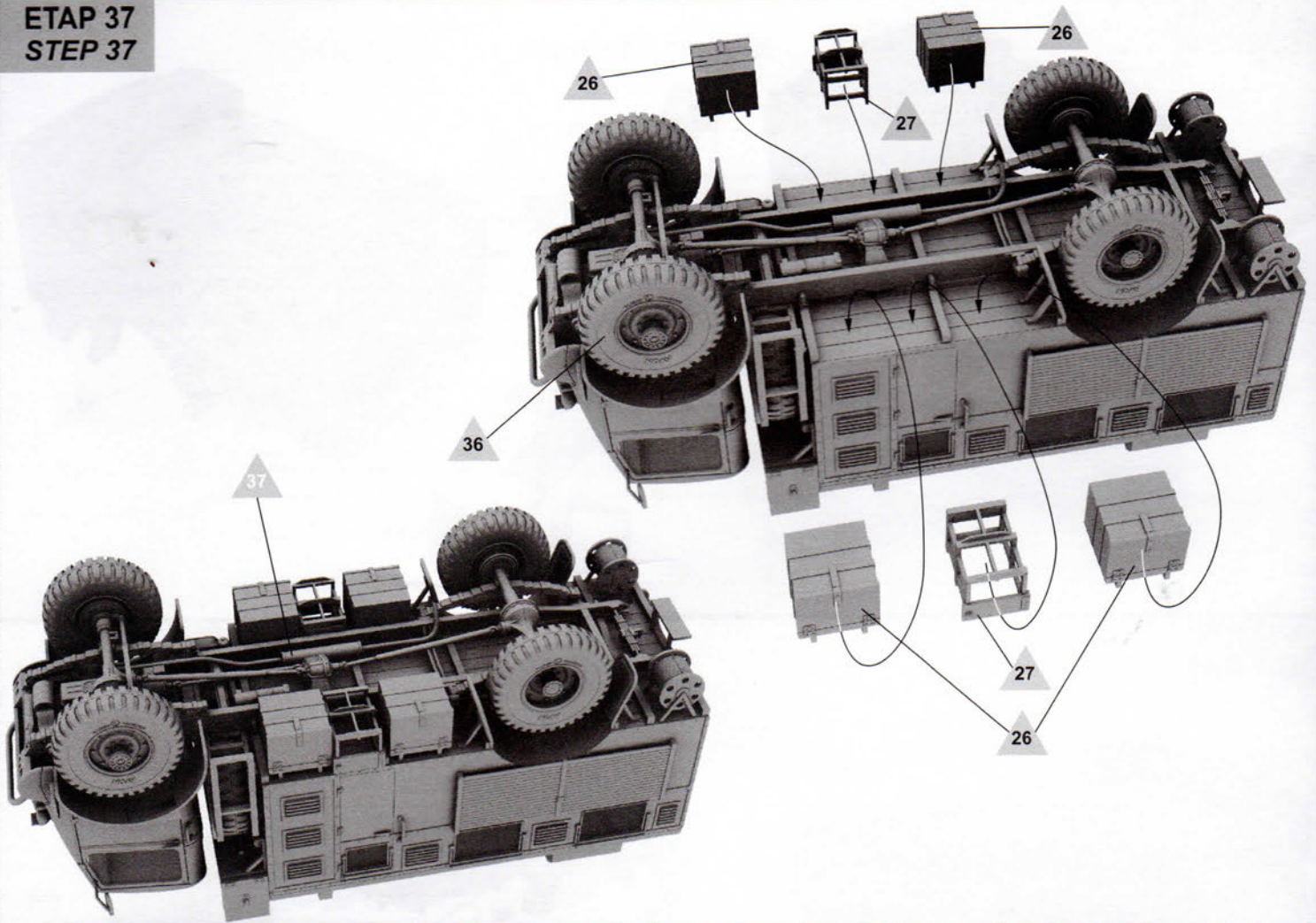

WYKONANY MODEL
FINISHED MODEL



Anteny można wykonać z drutu lub rozciągniętej nad ogniem plastikowej ramki.
Antennas can be done from wire or plastic sprue stretched over flame.

MALOWANIE I KALKOMANIE
COLOURS AND DECALS

Bedford QLR z Dowództwa 1 Polskiej Dywizji
Pancernej
Anglia, wiosna 1944
Bedford QLR from Polish 1st Armoured Division HQ
England, spring 1944

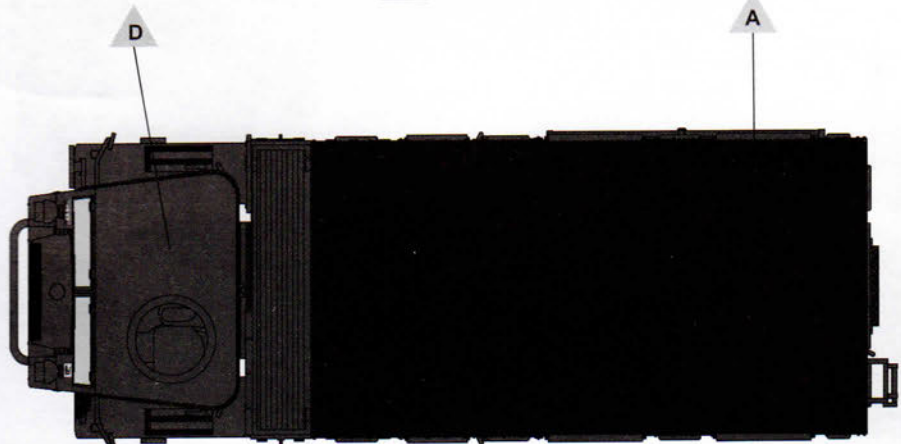
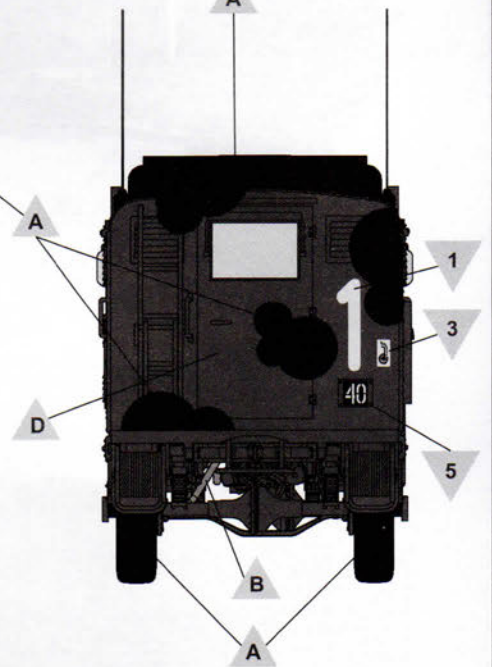
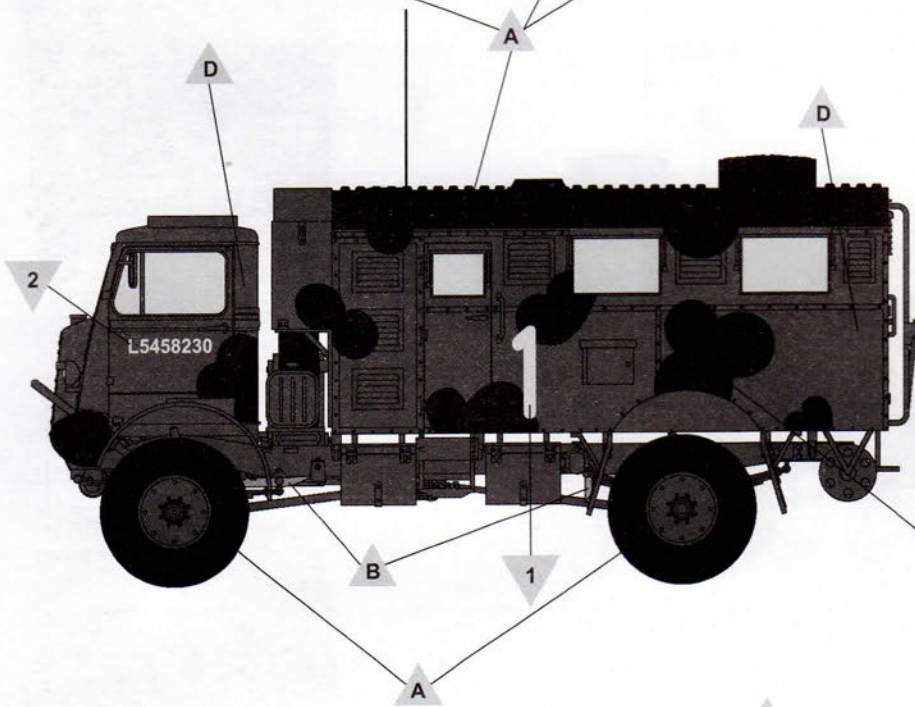
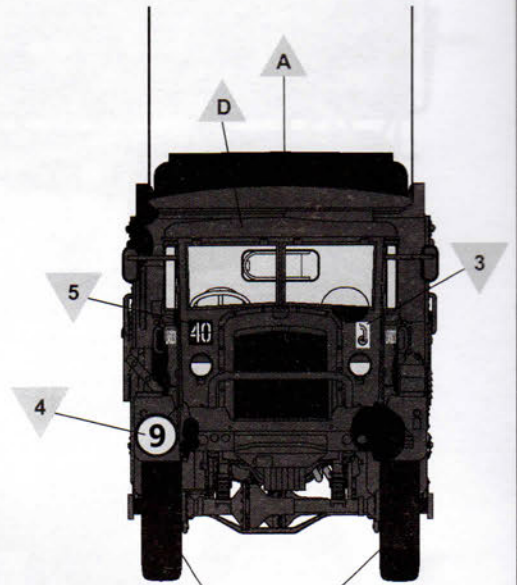
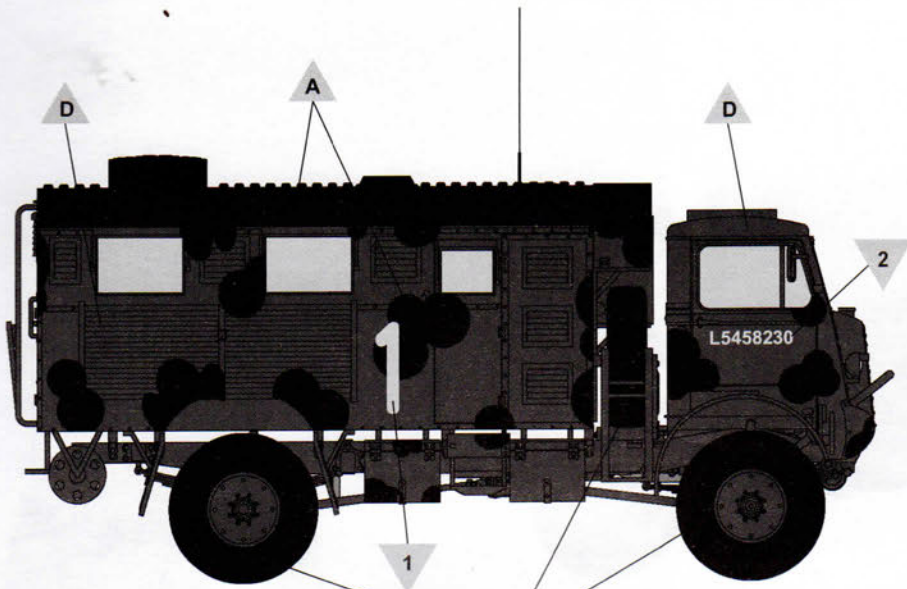

MALOWANIE I KALKOMANIE
COLOURS AND DECALS

Bedford QLR z Dowództwa Artylerii Dywizyjnej 15
Szkockiej Dywizji Piechoty
Niemcy, kwiecień 1945
*Bedford QLR from Divisional Artillery HQ, 15th
(Scottish) Infantry Division
Germany, April 1945*

