

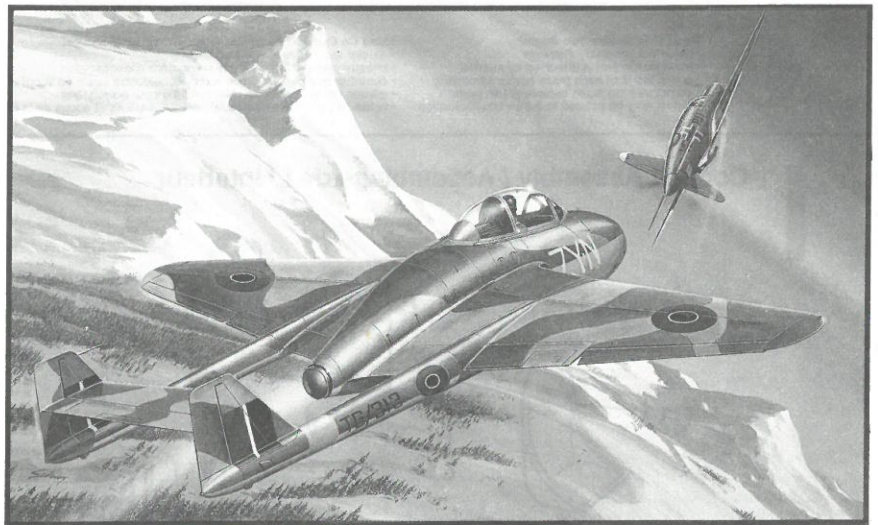

# Vampire Mk.I



## HCI573 • 1:48 • WWII Jet Fighter

One of the world's most advanced interceptors of World War II! Kit features: • detailed cockpit • landing gear • authentic markings.

Un des intercepteurs des plus performants de la 2<sup>e</sup> guerre mondiale! Particularités du kit: • l'intérieur détaillé • train d'atterrissage très détaillé • moulage précis • les marques authentiques.

Einer der modernsten Jäger des 2. Weltkrieges! Der Bausatz enthält: • detailliertes Cockpit und Fahrwerk • fein eingravierte Details • authentische Abziehbilder.

Uno dei caccia intercettatori più avanzati durante la 2<sup>a</sup> guerra mondiale! Caratteristiche del modello: • carlinga dettagliata e carrello di atterraggio • dettagli incisi • decals autentici.

Uno de los interceptores del mundo más avanzado de la 2<sup>a</sup> guerra mundial! Características del kit: • se detallan la cabina del piloto y el aterrizador • marcas auténticas.

 cyanoacrylate glue coller cyanoacrylate Cyanoacrylate kleben incollare cyanoacrylate pegar cyanoacrylate	 cut couper Schneiden tagliare cortar	 bend plier sich biegen piegare doblar	 file / sand poncer verspachteln levigare lijar	 weight a lester Gewicht zavorra lastre	 drill or pierce percer bohren forare agujerear	 two deux zwei due dos
 painting instructions mode d'emploi Anleitungen der Farben Istruzioni per la verniciatura instrucciones sobre la pintura	 caution! attention! vorsicht! attenzione! atención	 alternative en option Alternativ alternativo alternativa	 cement coller kleben incollare pegar	 paint peindre bemalen verniciare pintar	 decal decalcomania Abziehbild decalcomania calcomanias	 no! no! nein! no! ¡no!



**Read This Before You Begin!**

- study the assembly drawings
- each plastic part is identified by number
- check the fit of each piece before cementing
- do not use too much cement to join parts
- model may be painted to match box illustration

**Lisez Ce Qui Suit Avant De Commencer Le Montage!**

- étudier les schémas d'assemblage
- chaque pièce plastique porte un numéro d'identification
- contrôler que chaque pièce soit bien conforme avant de la coller à sa place
- utilisez uniquement une colle spéciale pour polystyrène
- le modèle peut être peint conformément aux illustrations de la boîte

**Vor Zusammenbau lesen sie bitte!**

- studiere die Bauanleitung
- die Plastikteile sind gekennzeichnet durch ihre Nummern
- vor dem Kleben prüfe ob die Teile zusammenpassen können
- benutze nicht zuviel Klebstoff
- die Bemalung des Modells kann auf dem Becketbild zeigen

# 1 Cockpit Assembly / Assemblage de L' Interieur

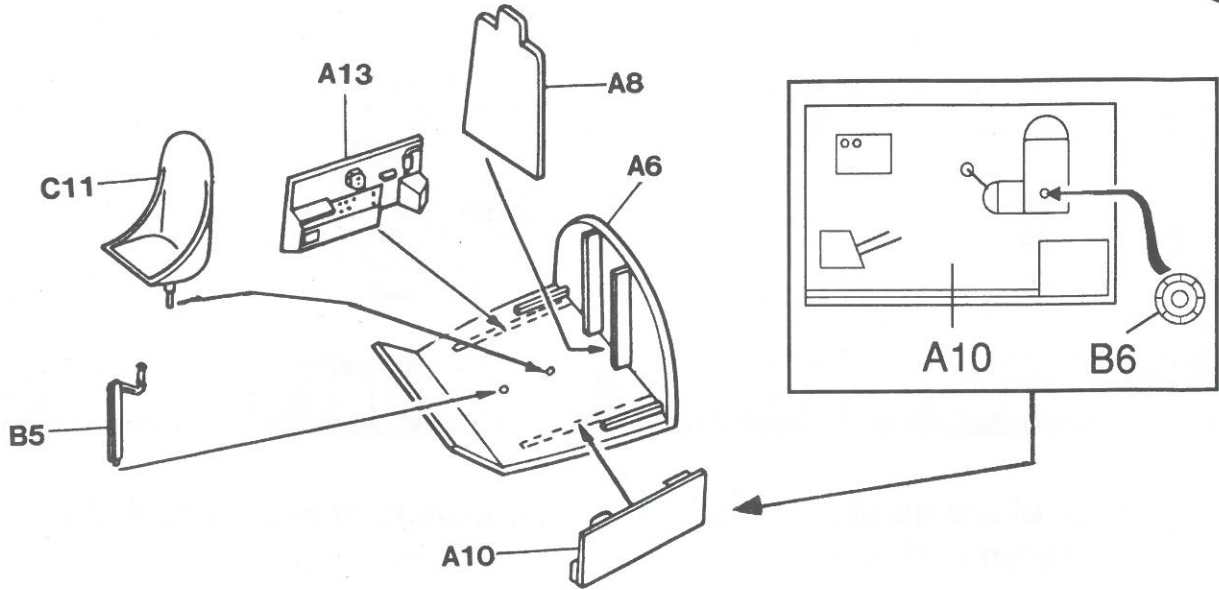

# 2 Fuselage & Canopy Assembly / Assemblage du Fuselage & Partie Verriere et Alles

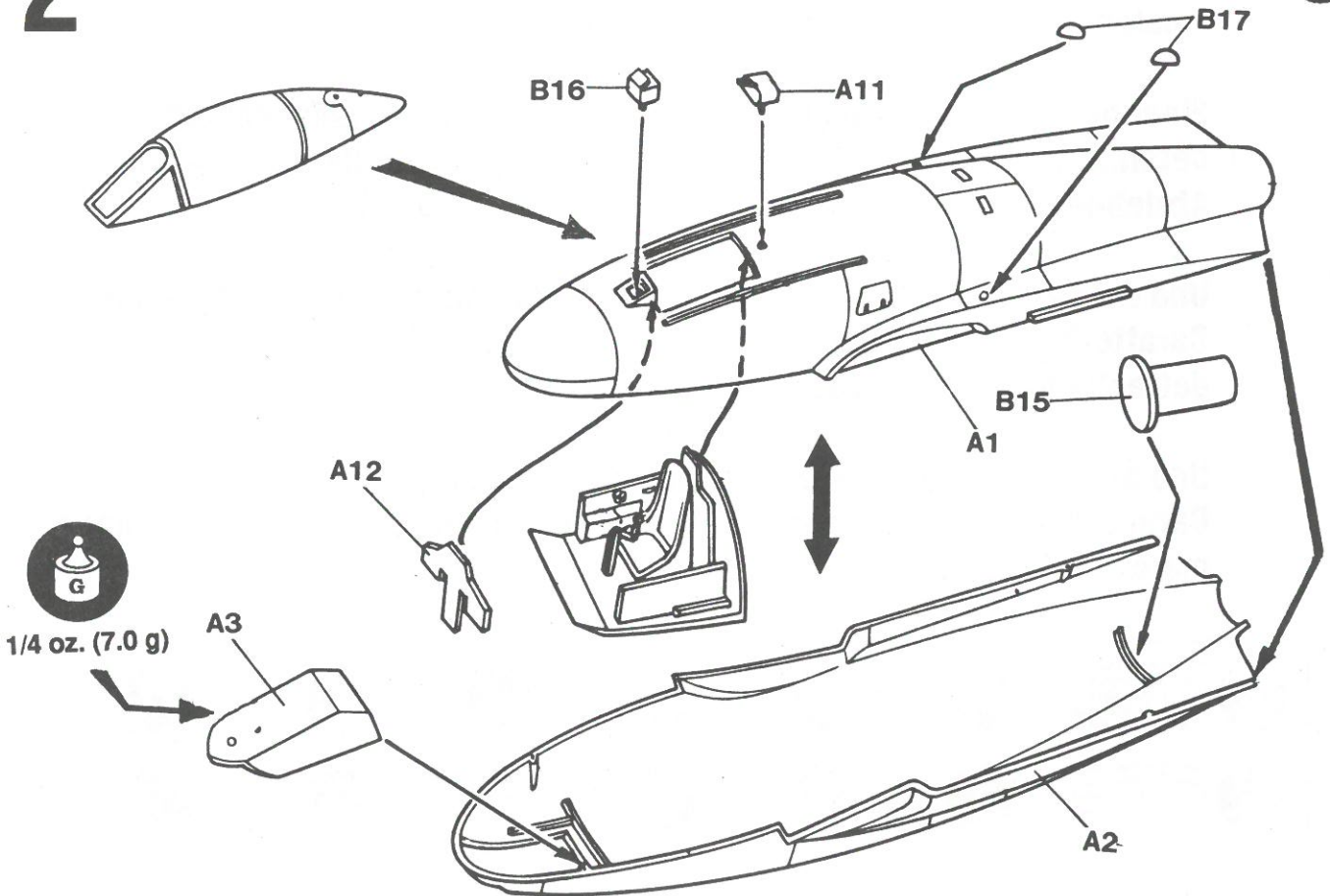

### 3 Wing Assembly / Assemblage Alles

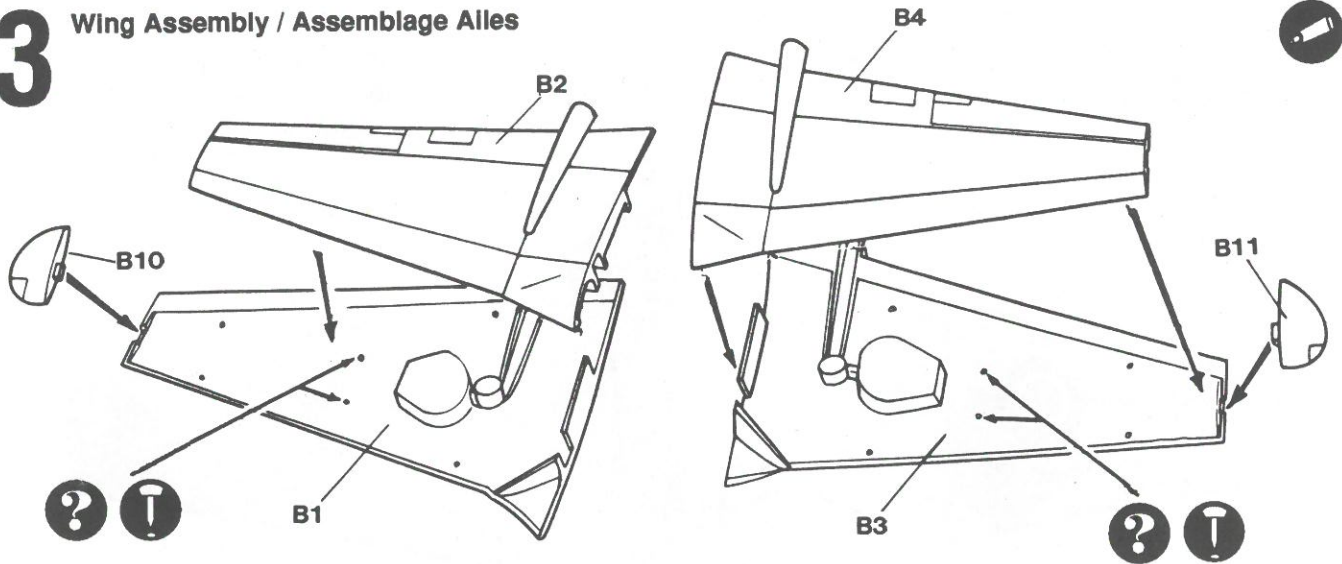

### 4 Wing & Fuselage Assembly / Assemblage Alles & Fuselage

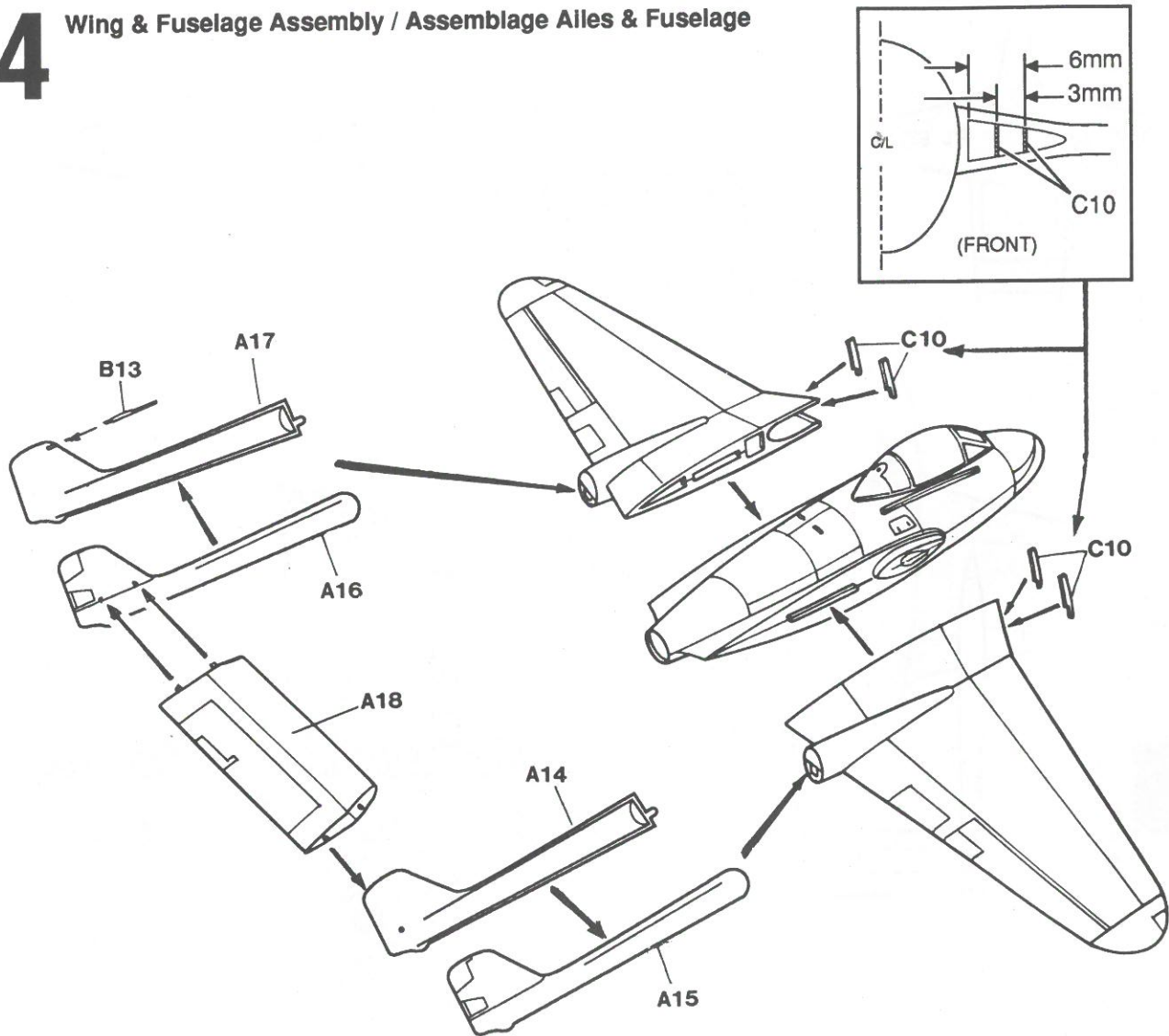

# 5

## Landing Gear & Cover Assembly / Train D' Atterrissage & Covercle

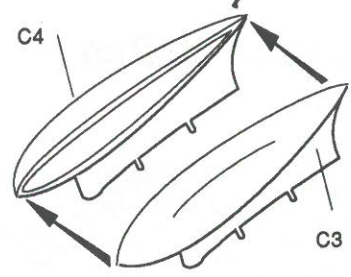
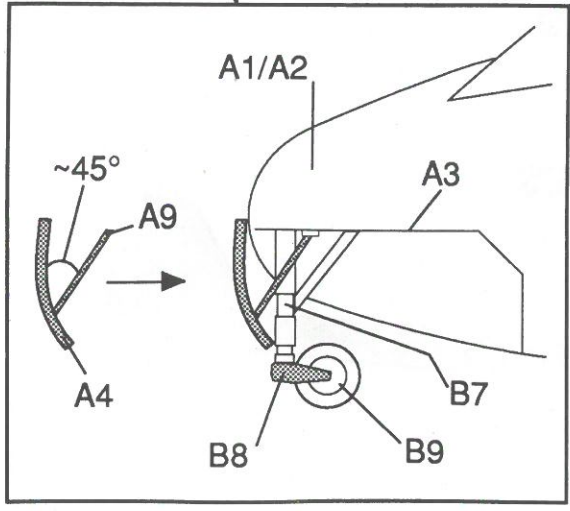
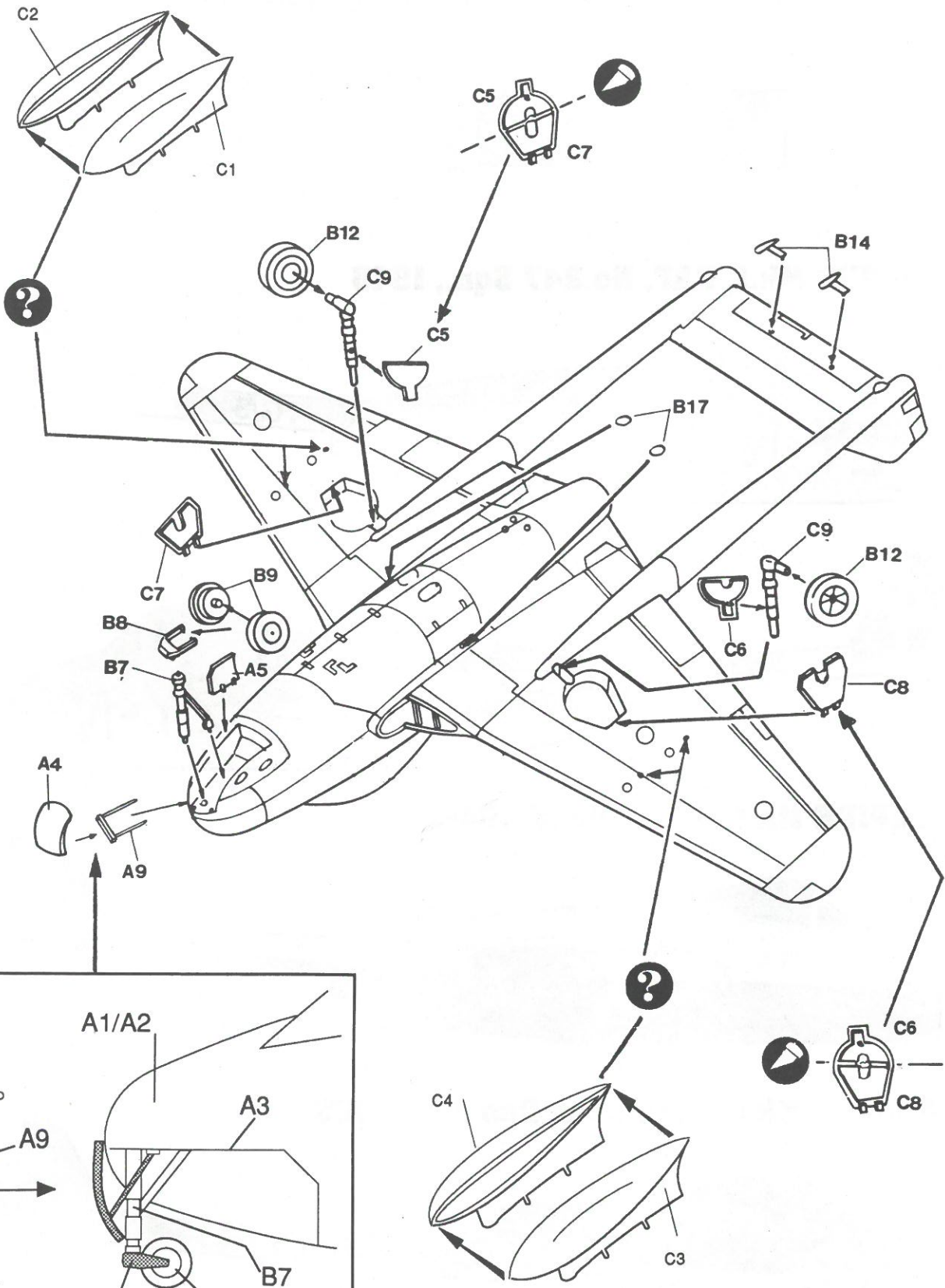

# VAMPIRE Mk.I

## Markings • Appliques

 FS16270  
med. sea gray  
gris  
Grau  
griggio  
gris

 FS16152  
ocean gray  
gris  
Grau  
griggio  
gris

 FS14079  
dark green  
vert  
Grün  
verde  
verde

 FS15622  
sky blue  
bleu  
Hellblau  
azzurro  
azul

 FS15189  
PRU blue  
bleu  
Hellblau  
azzurro  
azul

### VAMPIRE Mk.I, RAF, No.247 Sqn., 1946

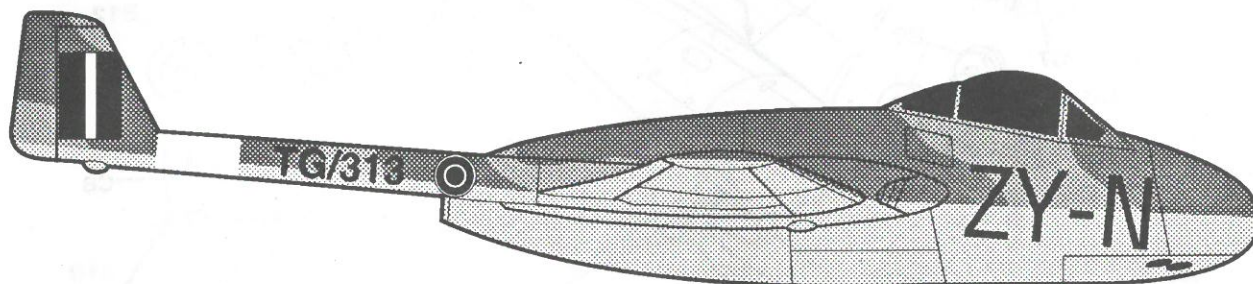
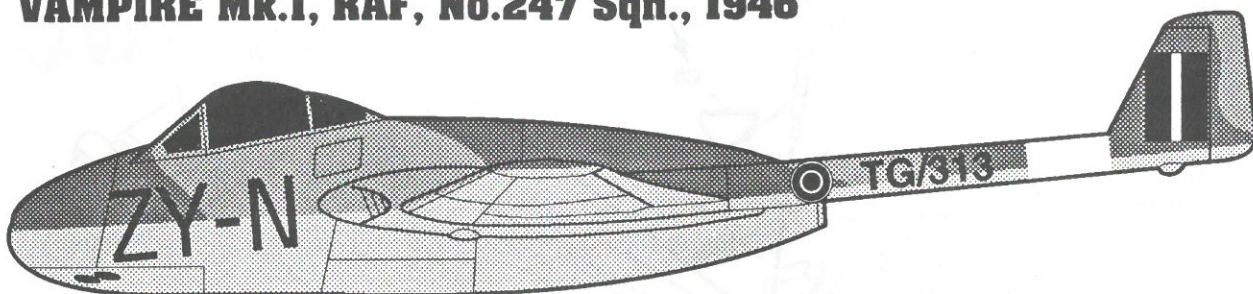

### VAMPIRE Mk.I, Switzerland, 1946

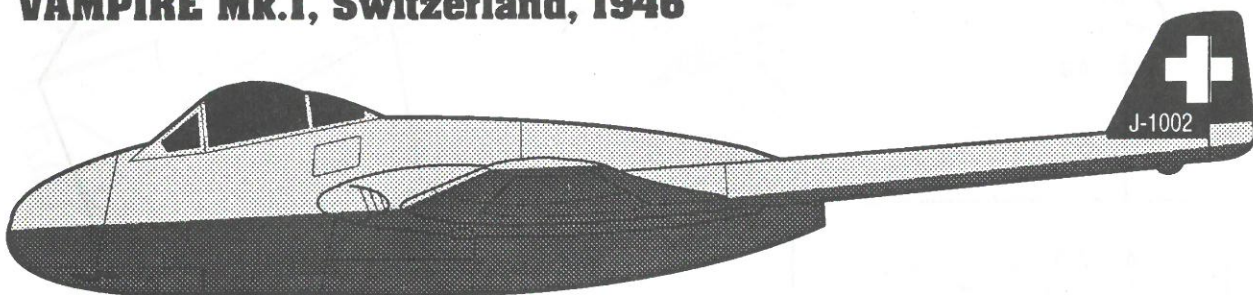

### VAMPIRE Mk.I, Dominican Republic, 1955

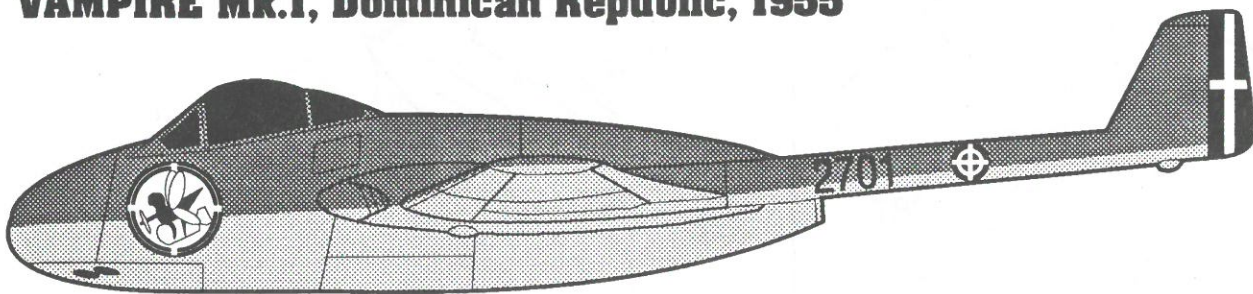



paint  
peindre  
bemalen  
verniciare  
pintar



decal  
decalcomania  
Abziehbild  
decalcomania  
calcomanías

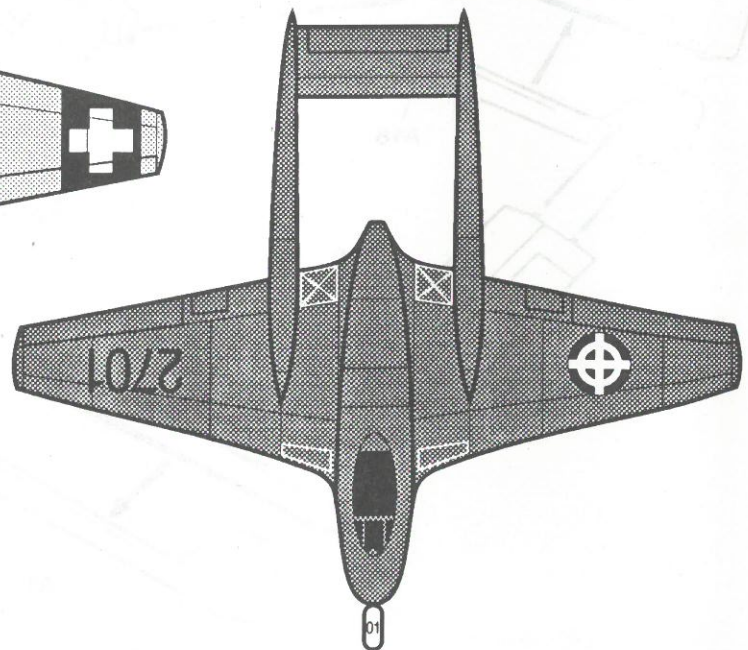
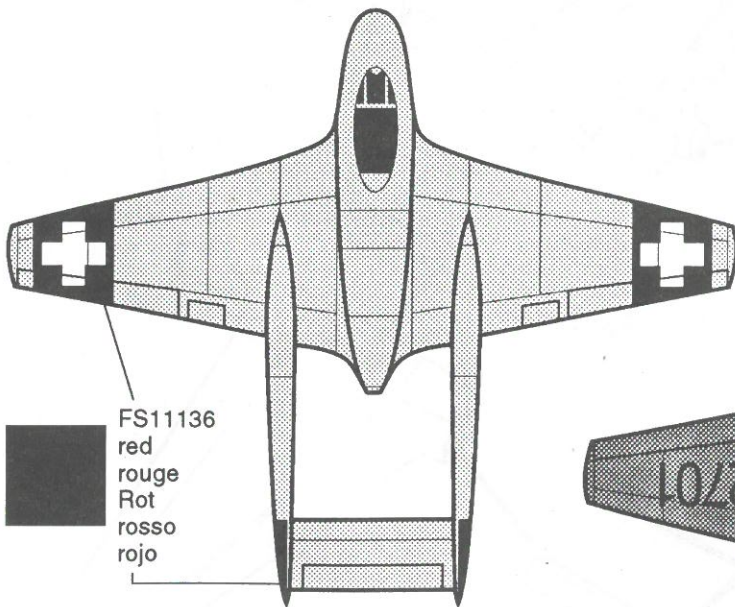
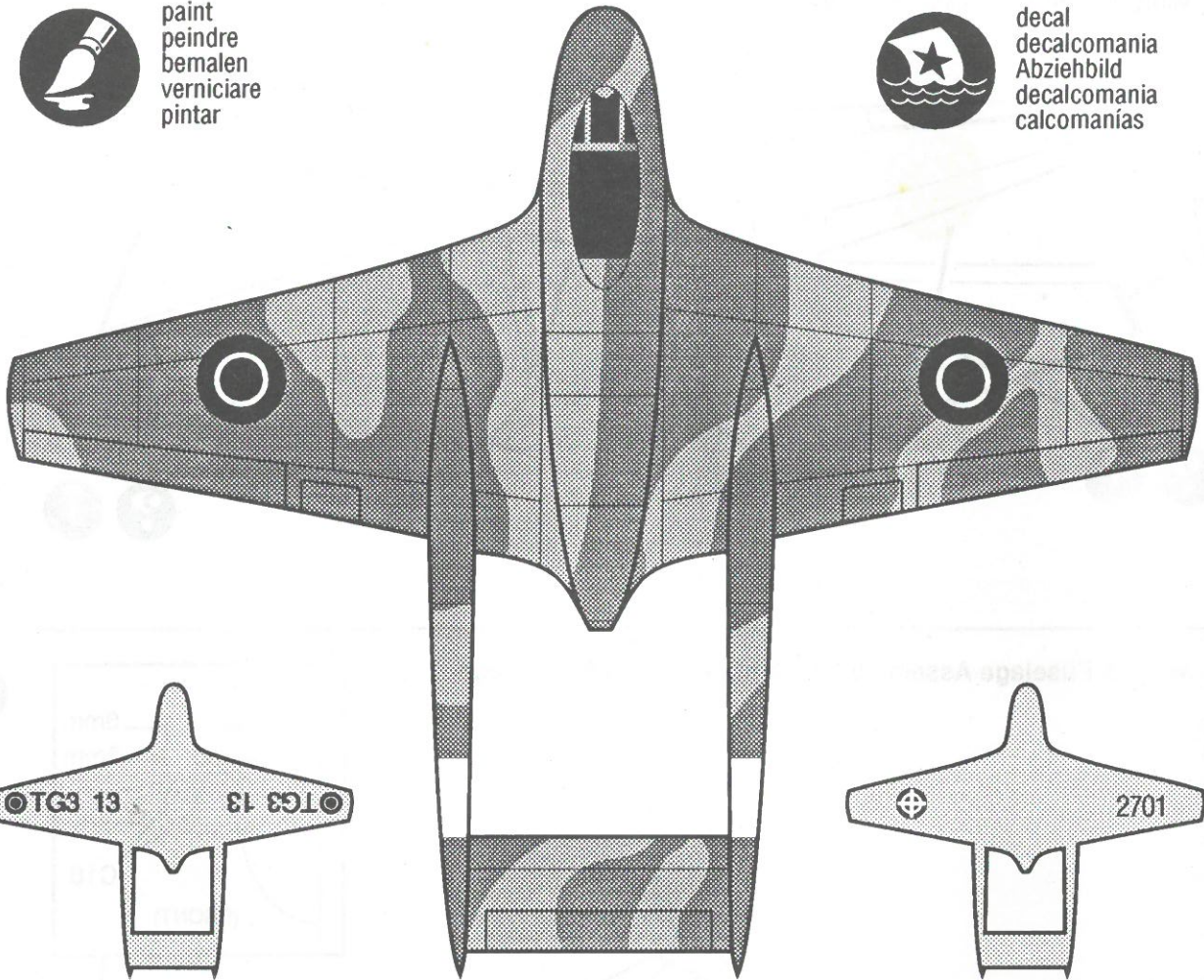

# HC1573 VAMPIRE MK.1

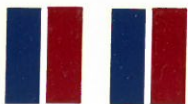

# TG3 13



# TG3 13



J-1002

J-1002



(right)



(left)

TG/313

ZY-N ZY-N

TG/313



(EARLY BOOM SERIALS:)



(EARLY BOOM MARKINGS)



EARLY RUDDER MARKINGS:  
(outsides only)



EARLY WING SERIALS  
(upper right, lower left)

2701 1234567890

2701 1234567890

NOSE DOOR: 01 14 1234567890

NOSE DOOR: 01 14 1234567890

(LATE MARKINGS)

FAD 2714  
1234567890

FAD 2714  
1234567890



EARLY WING MARKINGS  
(upper left, lower right)

2701 1073  
2701